

FED. RD. DIVISION	STATE	PROJECT	FISCAL YEAR	8 17
2	OHIO	HIF	1962	

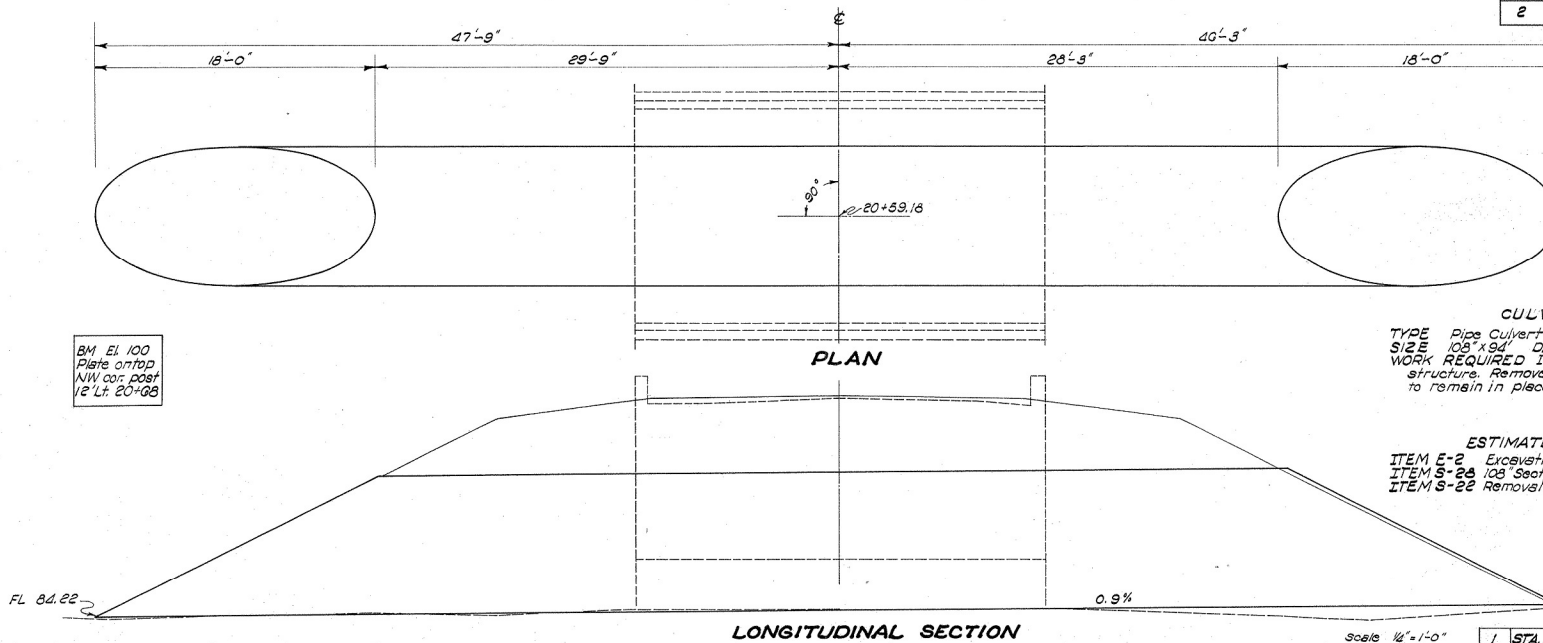

LIC-19-(2.05-5.22)

MINIMUM GAGES OF PLATES  
 1 1/2" depth corrugations - 8 gage  
 1 3/4" " " 10 "  
 2" " " 10 "

The bottom row of plates shall be at least two gages heavier than the remainder of the plates.

BM EL. 100  
 Plate on top  
 NW cor. post  
 12' Lt. 20+08

**CULVERT DATA**  
 TYPE Pipe Culvert  
 SIZE 108' x 94' Drainage Area 600A<sup>9</sup> - 520cfs - 25 yr.  
 WORK REQUIRED Install new pipe through existing structure. Remove existing slab. Existing wells to remain in place.

**ESTIMATED QUANTITIES**  
 ITEM E-2 Excavation for Structure 5 C.Y.  
 ITEM S-28 108 Sections Corrugated Pipe Str. 94 L.F.  
 ITEM S-22 Removal of existing slab Lump

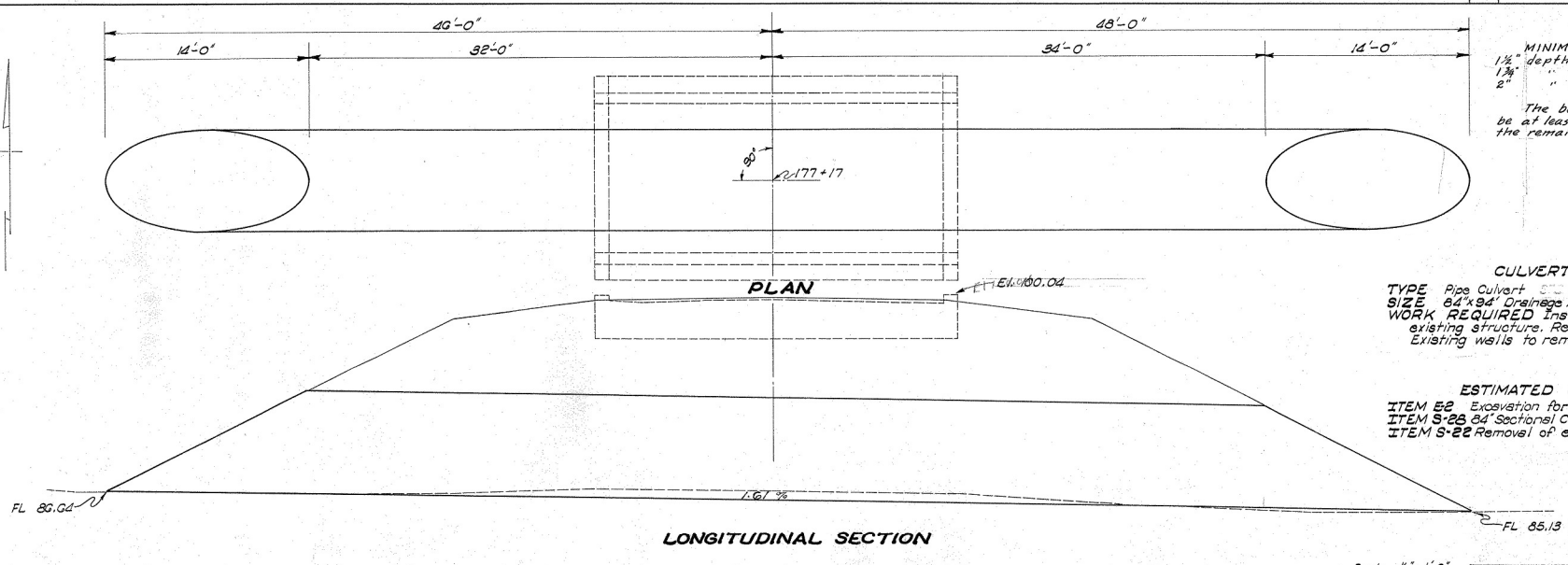

MINIMUM GAGES OF PLATES  
 1 1/2" depth corrugations - 8 gage  
 1 3/4" " " 10 "  
 2" " " 10 "

The bottom row of plates shall be at least two gages heavier than the remainder of the plates.

**CULVERT DATA**  
 TYPE Pipe Culvert  
 SIZE 64' x 94' Drainage Area 300A<sup>9</sup> - 340cfs - 25 yr.  
 WORK REQUIRED Install new pipe through existing structure. Remove existing slab. Existing wells to remain in place.

**ESTIMATED QUANTITIES**  
 ITEM E2 Excavation for Structure 10 C.Y.  
 ITEM S-28 64 Sections Corrugated Pipe Str. 94 L.F.  
 ITEM S-22 Removal of existing slab Lump