

MER-29-15.52
 AUG-29-0.00
 MER-429-2.91
 0.4 MILES NE. OF CELINA, O.

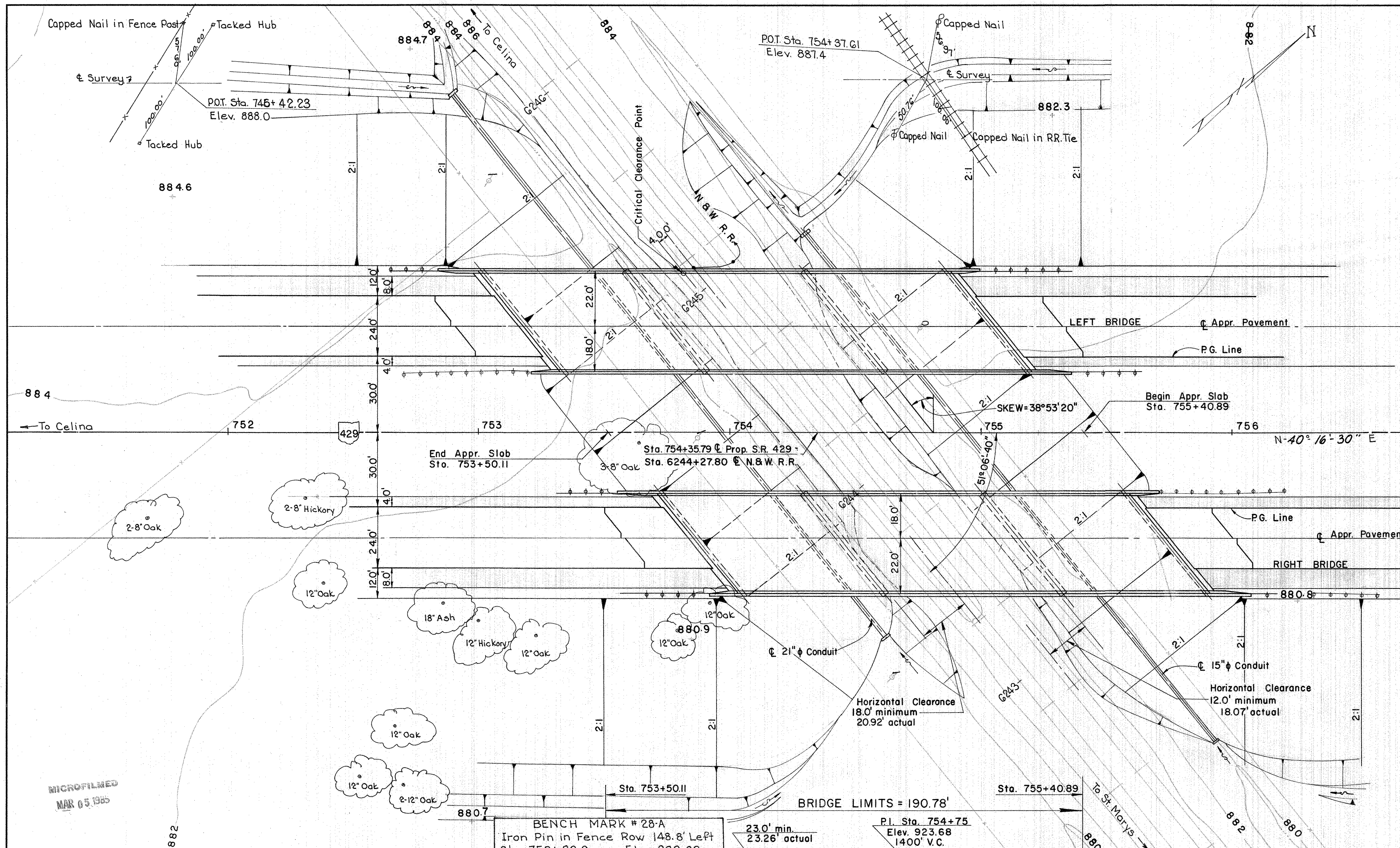

EARTHWORK LIMITS shown are schematic. Actual slopes shall conform to Plan-Cross Sections.

RAILROAD TRAFFIC
 8-Freight at 60 MPH daily seven days per week.
 2-Local freight at 60 M.P.H. daily six days per week.

1987 Design Traffic P=4100
 C=220

PROPOSED STRUCTURE
 TYPE: Continuous steel beams with reinforced concrete deck and substructure
 SPANS: 57.0'-71.0'-57.0' %/c brgs.
 ROADWAY: 2 at 40.0' f/f parapets
 LOADING: HS 20-44
 SKEW: 38° 53' 20" R.F.
 WEARING SURFACE: 1" monolithic concrete
 APPROACH SLABS: AS-1-67 (25' long)
 ALIGNMENT: Tangent

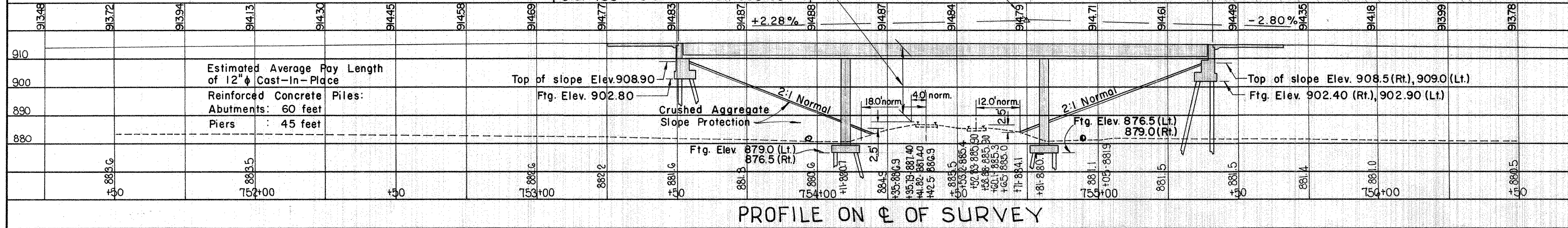

PROFILE ON C OF SURVEY

STATE OF OHIO DEPARTMENT OF HIGHWAYS BUREAU OF BRIDGES					
SITE PLAN					
BRIDGE NO. MER-429-0395 L & R			N & W RAILROAD		
PROP. SR. 429 OVER			S.R. 429		
MERGER CO			STA. 753+50.11		
SEC.			755+40.89		
SCALE 1" = 20'					
PRESENT TOPOGRAPHY			PROPOSED WORK		
SURVEYED	DRAWN	DESIGNED	DRAWN	CHECKED	REVIEWED
AERIAL SURVEY	AERIAL SURVEY	D.H.S.	D.H.S.	B.D.H.	P.E.S.

APPROACH ROADWAY: 45', 2 at 24' with 60' median and 8' and 12' berms

MICROFILMED
MAR 05 1985