

FED. RD. DIVISION	STATE	PROJECT	
2	OHIO	429	371

MER-29-15.52  
 AUG-29-0.00  
 MER-429-2.91  
 0.4 MILES NE. OF CELINA, O.

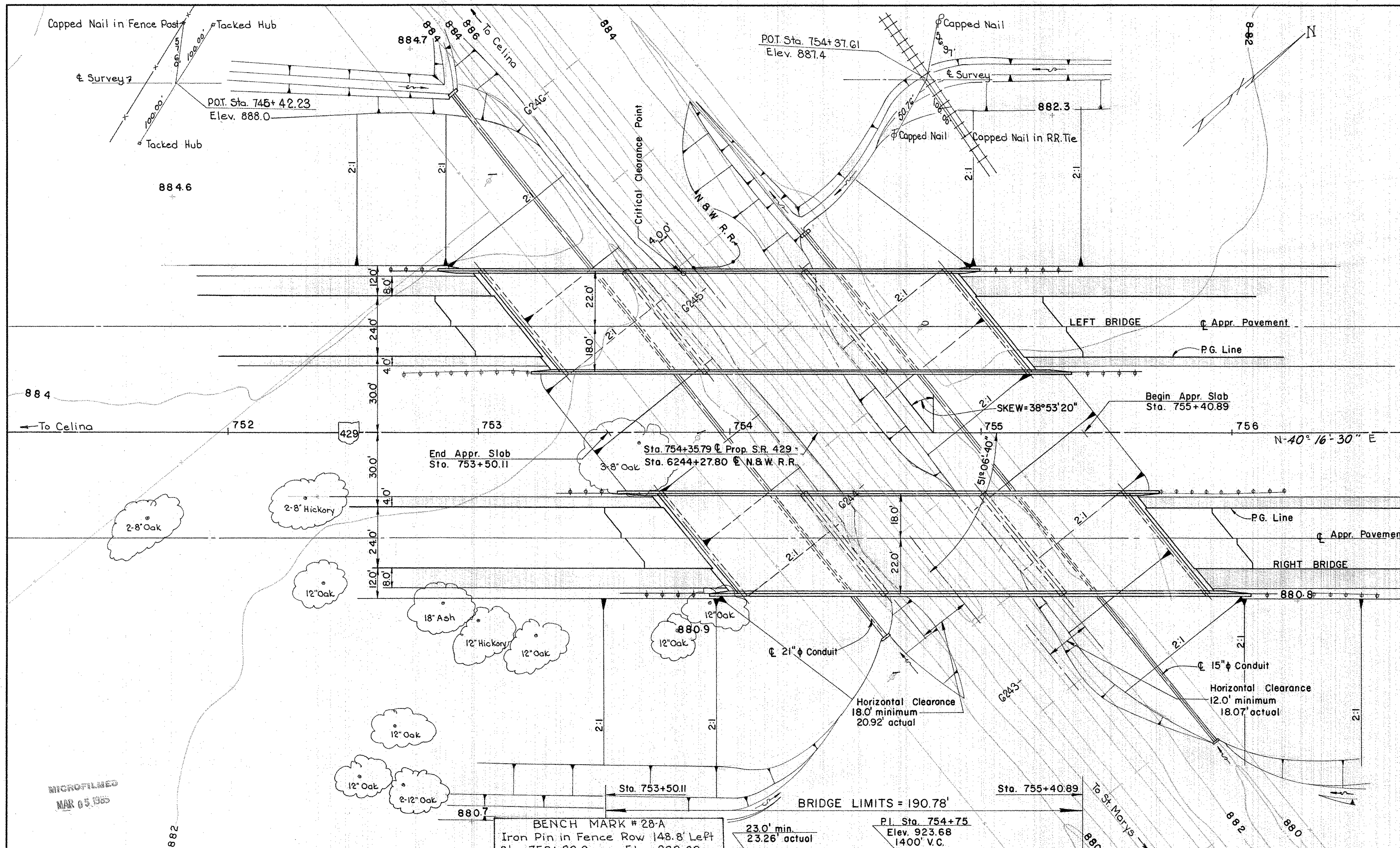

EARTHWORK LIMITS shown are schematic. Actual slopes shall conform to Plan-Cross Sections.

**RAILROAD TRAFFIC**  
 8-Freight at 60 MPH daily seven days per week.  
 2-Local freight at 60 M.P.H. daily six days per week.

1987 Design Traffic P=4100  
 C=220

**PROPOSED STRUCTURE**  
 TYPE: Continuous steel beams with reinforced concrete deck and substructure  
 SPANS: 57.0'-71.0'-57.0' brgs.  
 ROADWAY: 2 at 40.0' f/t parapets  
 LOADING: HS 20-44  
 SKEW: 38°53'20" R.F.  
 WEARING SURFACE: 1" monolithic concrete  
 APPROACH SLABS: AS-1-67 (25' long)  
 ALIGNMENT: Tangent

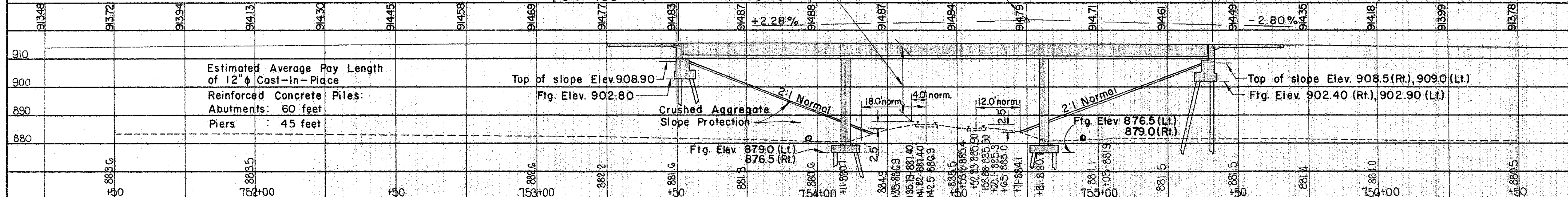

PROFILE ON C OF SURVEY

STATE OF OHIO  
 DEPARTMENT OF HIGHWAYS  
 BUREAU OF BRIDGES

**SITE PLAN**  
 BRIDGE NO. MER-429-0395 L & R  
 PROP. SR. 429 OVER N & W RAILROAD  
 MERGER CO S.R. 429  
 STA. 753+50.11  
 755+40.89

PRESENT TOPOGRAPHY		PROPOSED WORK			
SURVEYED	DRAWN	DESIGNED	DRAWN	CHECKED	REVIEWED
AERIAL SURVEY	AERIAL SURVEY	D.H.S.	D.H.S.	B.O.H.	P.E.S.

APPROACH ROADWAY: 45', 2 at 24' with 60' median and 8' and 12' berms

MICROFILMED  
 MAR 05 1965

878.4

878.6

1 / 9

B.G.M.