

STATE OF OHIO  
DEPARTMENT OF TRANSPORTATION

**MOT-70-0.00**

**CITY OF BROOKVILLE, CLAY TOWNSHIP  
MONTGOMERY COUNTY**

**PROJECT DESCRIPTION**

MICROSURFACE IR70 FROM THE PREBLE COUNTY LINE (0.00) TO SLM 6.71 IN MONTGOMERY COUNTY.

**MAINTENANCE PROJECT**

PROJECT EARTH DISTURBED AREA: N/A  
ESTIMATED CONTRACTOR EARTH DISTURBED AREA: N/A  
NOTICE OF INTENT EARTH DISTURBED AREA: N/A

**LIMITED ACCESS**

THIS IMPROVEMENT IS ESPECIALLY DESIGNED FOR THROUGH TRAFFIC AND HAS BEEN DECLARED A LIMITED ACCESS HIGHWAY OR FREEWAY BY ACTION OF THE DIRECTOR IN ACCORDANCE WITH THE PROVISIONS OF SECTION 5511.02 OF THE OHIO REVISED CODE.

**2016 SPECIFICATIONS**

THE STANDARD SPECIFICATIONS OF THE STATE OF OHIO, DEPARTMENT OF TRANSPORTATION, INCLUDING CHANGES AND SUPPLEMENTAL SPECIFICATIONS LISTED IN THE PROPOSAL SHALL GOVERN THIS IMPROVEMENT.

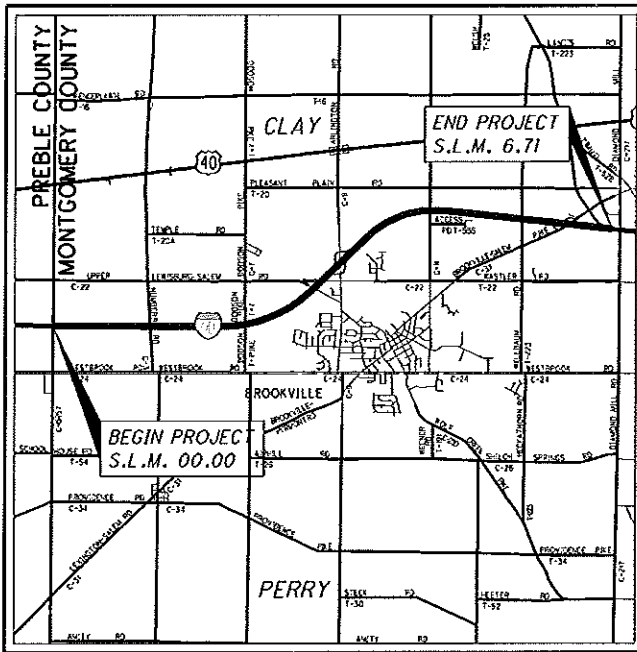

LOCATION MAP

LATITUDE: N 39° 50' 50.58" LONGITUDE: W 84° 25' 36.07"

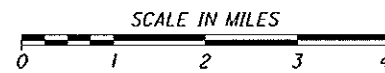

PORTION TO BE IMPROVED	—————
INTERSTATE HIGHWAY	—————
FEDERAL ROUTES	—————
STATE ROUTES	—————
COUNTY & TOWNSHIP ROADS	—————
OTHER ROADS	—————

**DESIGN DESIGNATION**

	S.L.M. 0.00-3.34	3.34-6.04	6.04-6.54	6.54-8.21
CURRENT ADT (2017)	37000	42000	41000	53000
DESIGN YEAR ADT (2037)	41000	47000	47000	58000
DESIGN HOURLY VOLUME (2037)	4100	4700	4700	5800
DIRECTIONAL DISTRIBUTION	52%	53%	53%	6%
TRUCKS (24 HOUR B&C)	32%	28%	28%	25%
DESIGN SPEED	70 MPH	70 MPH	70 MPH	70 MPH
LEGAL SPEED	65 MPH	65 MPH	65 MPH	65 MPH
DESIGN FUNCTIONAL CLASSIFICATION:				
RURAL/URBAN INTERSTATE				
NHS PROJECT	NO			

**DESIGN EXCEPTIONS**

NONE

**UNDERGROUND UTILITIES**

CONTACT BOTH SERVICES  
CALL TWO WORKING DAYS  
BEFORE YOU DIG

CALL  
**1-800-362-2764**  
(TOLL FREE)

OHIO UTILITIES PROTECTION SERVICE  
NON-MEMBERS  
MUST BE CALLED DIRECTLY

OIL & GAS PRODUCERS PROTECTIVE  
SERVICE CALL: 1-800-925-0988

PLAN PREPARED BY:  
OHIO DEPT. OF TRANSPORTATION  
DISTRICT 7 - PLANNING & ENGINEERING  
SIDNEY, OH

ENGINEERS SEAL:

SIGNED: Ryan P. Hanke  
DATE: 12/25/16

STANDARD CONSTRUCTION DRAWINGS				SUPPLEMENTAL SPECIFICATIONS	SPECIAL PROVISIONS
BP-3.1	7/18/14	TC-72.20	7/15/16	800-2016 1/20/17	
MT-95.30	7/15/16			821 4/20/12	
MT-95.50	10/16/15			832 1/17/14	
MT-98.10	7/18/14			921 4/20/12	
MT-98.20	7/18/14				
MT-99.20	7/19/13				
MT-104.10	10/16/15				
MT-105.10	7/19/13				
TC-41.20	10/18/13				
TC-42.20	10/18/13				
TC-52.10	10/18/13				
TC-52.20	7/15/16				
TC-65.10	1/17/14				
TC-65.11	7/15/16				

APPROVED: Randy Christy, P.E. P.S. / JWC  
DATE: 2-25-16 DISTRICT DEPUTY DIRECTOR

APPROVED: Amy Wray  
DATE: 12-27-16 DIRECTOR, DEPARTMENT OF TRANSPORTATION

MOT - IR-IR 70-0.00  
170141 PID - 75941  
Dist 7 3/2/2017

Contract Proposal Available @ www.Contracts.dot.state.oh.us/home

FEDERAL PROJECT NO.  
**E035 (942)**

PID NO.  
**75941**

CONSTRUCTION PROJECT NO.

RAILROAD INVOLVEMENT  
**NONE**

**MOT-70-0.00**

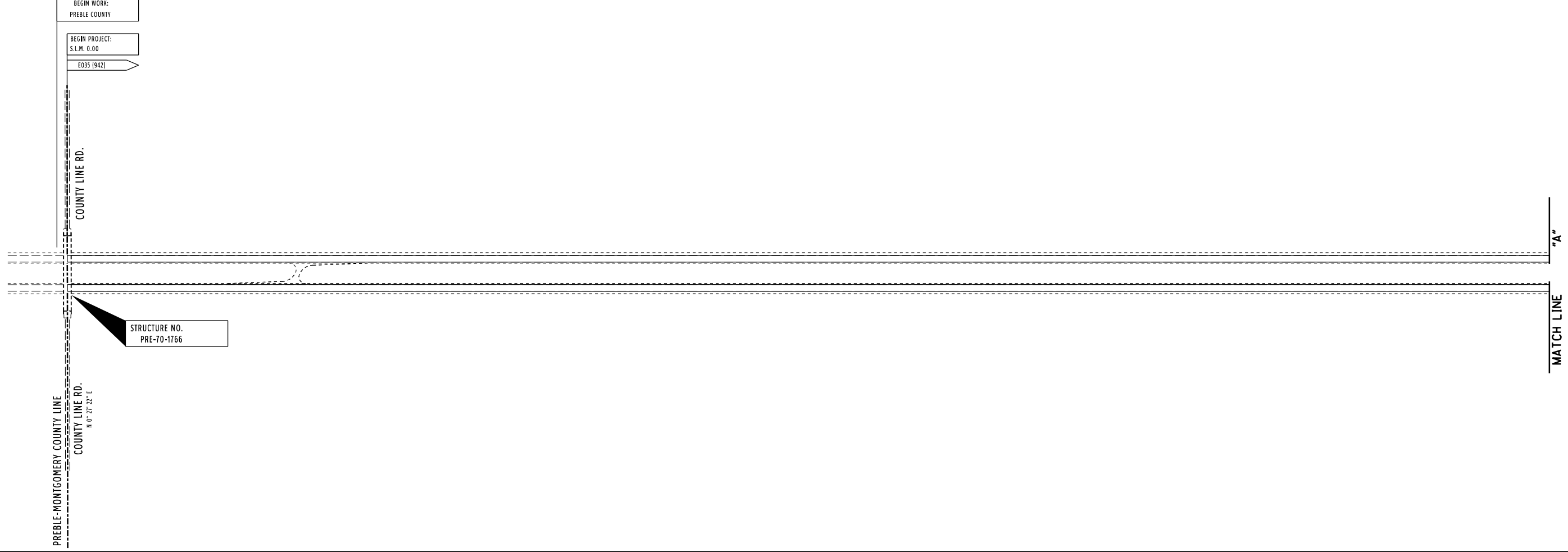
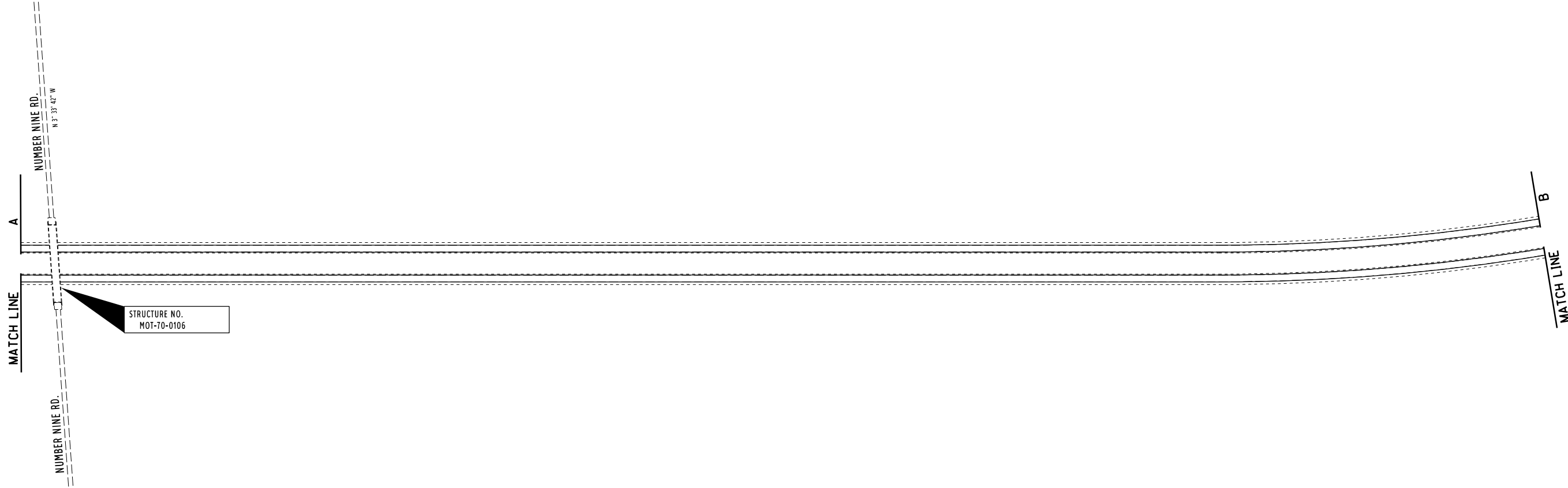

BEGIN WORK:  
PREBLE COUNTY

BEGIN PROJECT:  
S.L.M. 0.00

E035 (942)

COUNTY LINE RD.

COUNTY LINE RD.

MATCH LINE

NUMBER NINE RD.



I:\ProjectData\MOT\IR70-0000\Design\Roadway\Sheets\759416B002.dgn\_Sheet 12/22/2016 2:22:35 PM rhanke

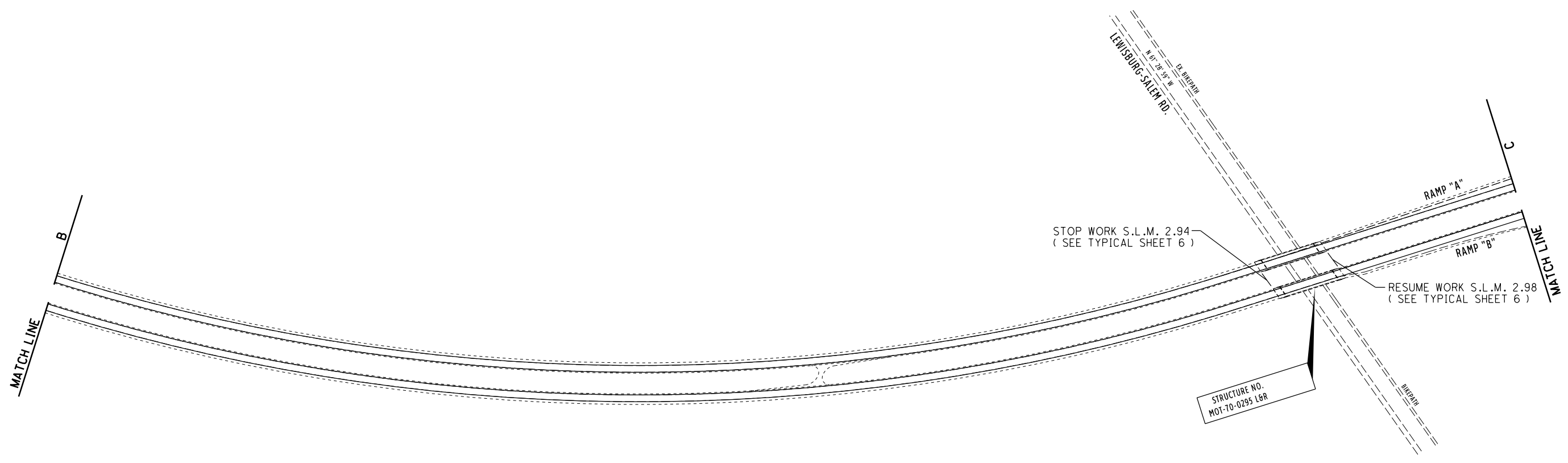
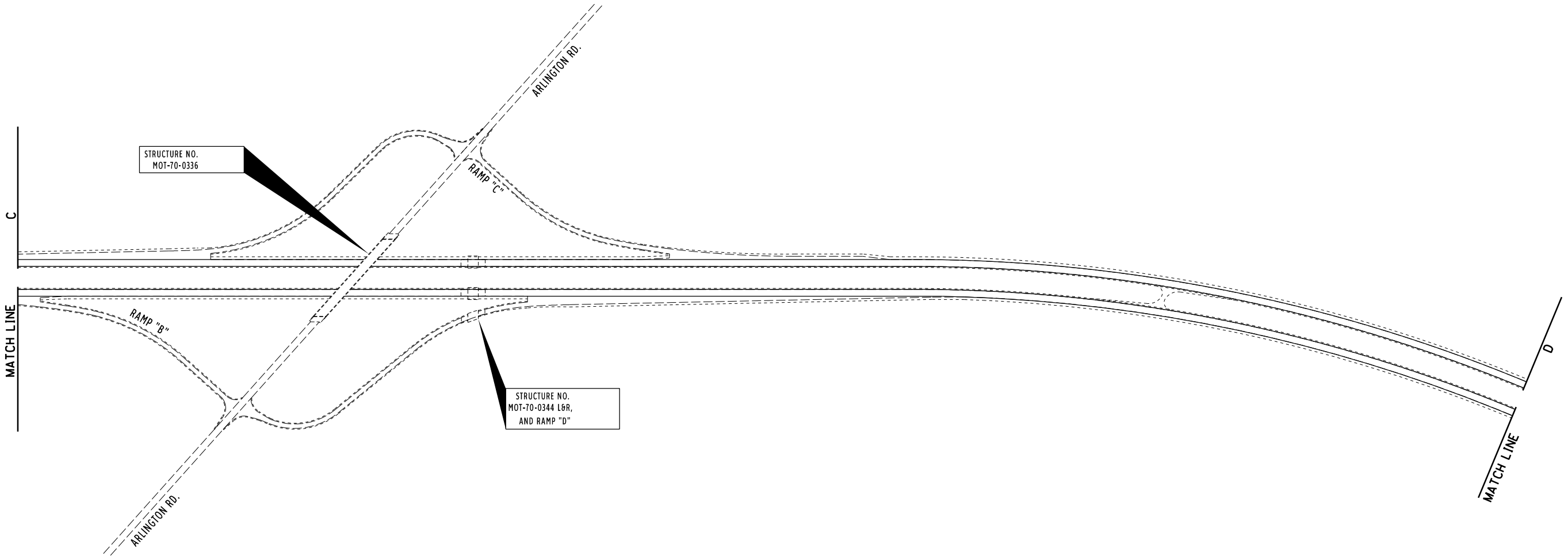

CALCULATED	REB	CHECKED	TMK
------------	-----	---------	-----



I:\ProjectData\MOT\75941\_IR70-0000\Design\Roadway\Sheets\759416B003.dgn\_Sheet 12/22/2016 2:22:36 PM rhanke

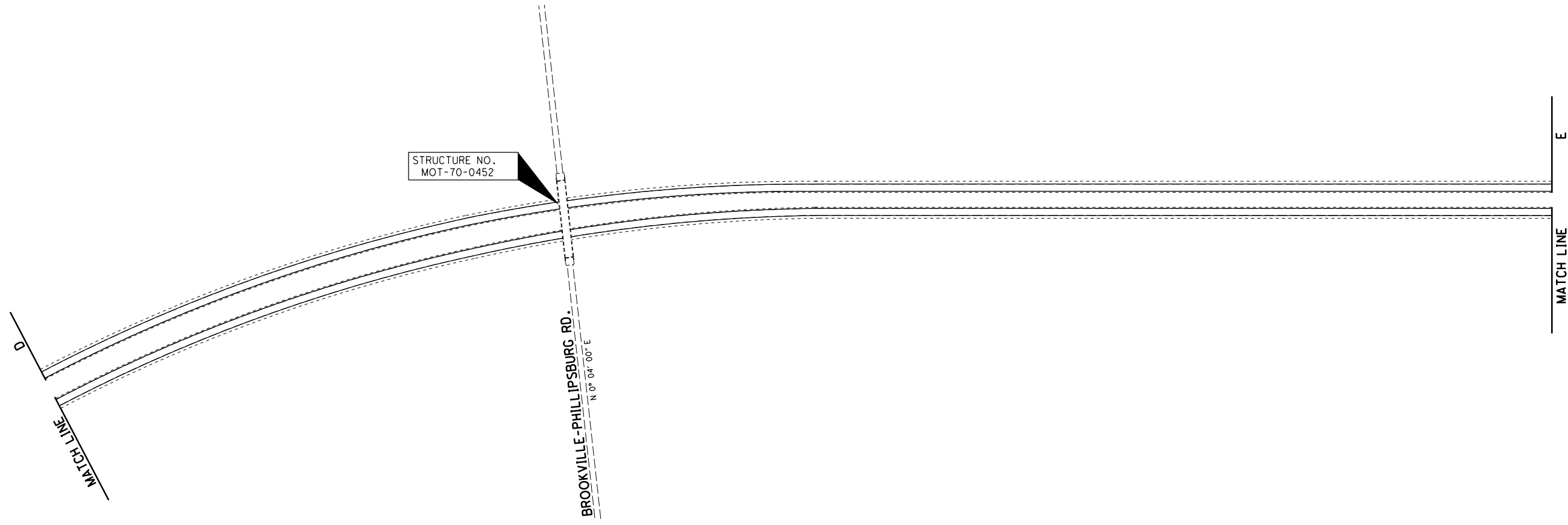
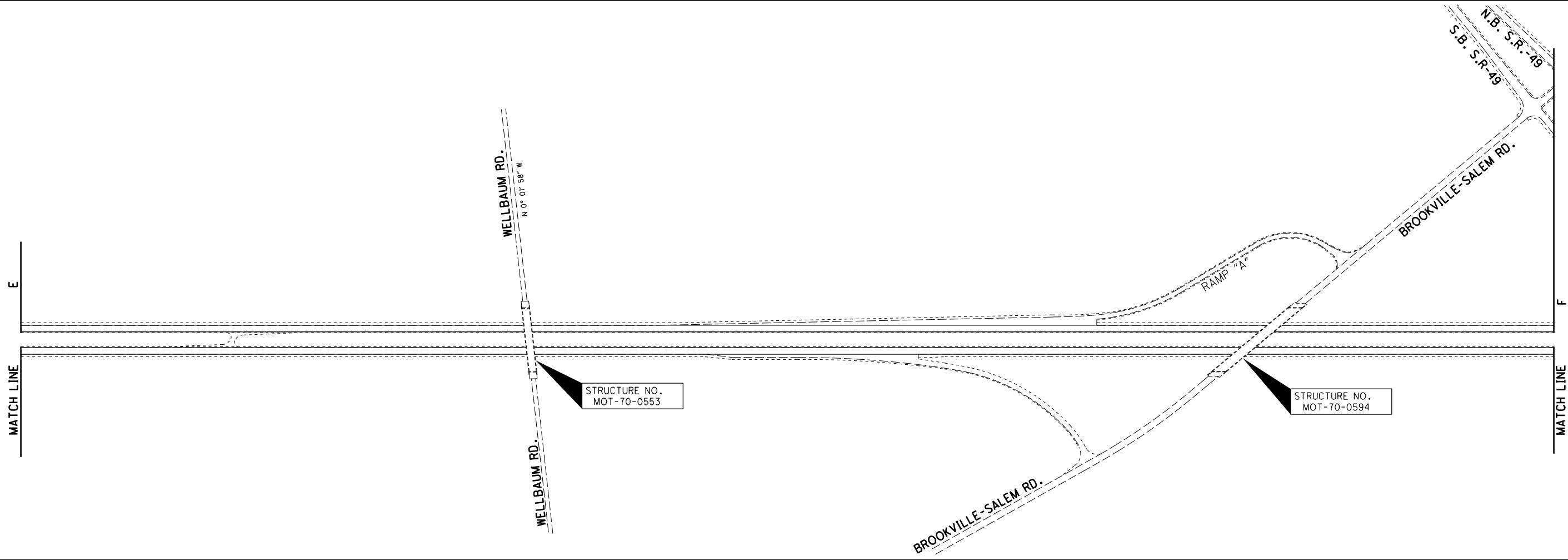

I:\ProjectData\MOT\75941\_IR70-0000\Design\Roadway\Sheets\759416B004.dgn\_Sheet 12/22/2016 2:22:37 PM rhanke

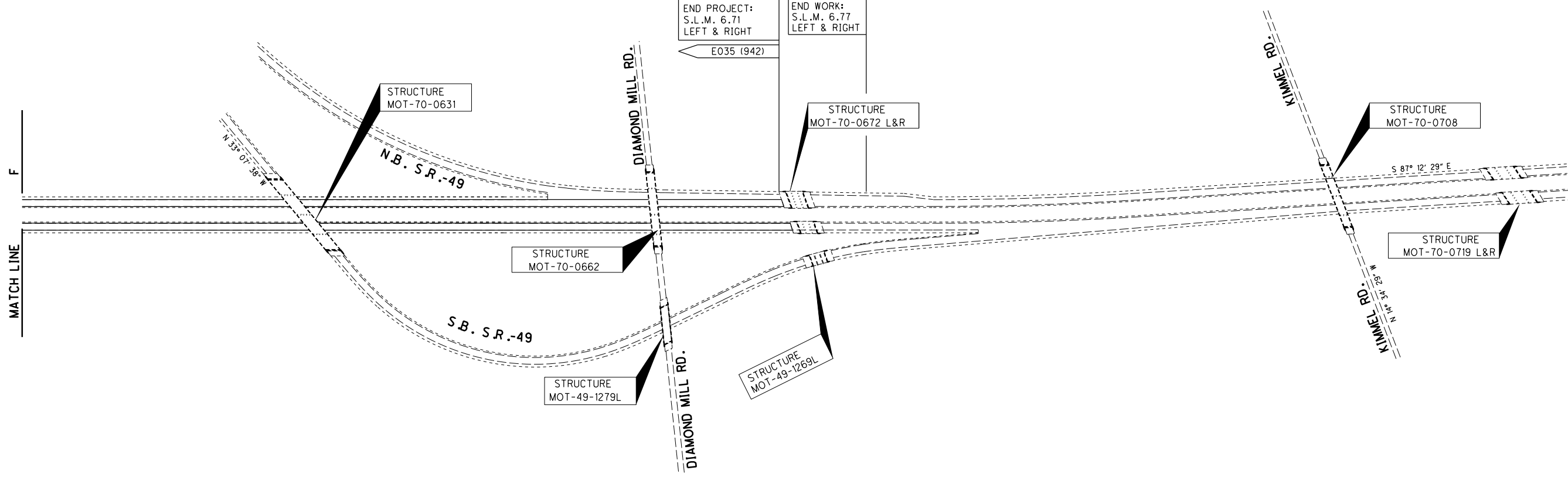

I:\ProjectData\MOT\_75941\_IR70-0000\Design\Roadway\Sheets\75941\001.dgn Sheet 12/22/2016 2:22:39 PM rhanke

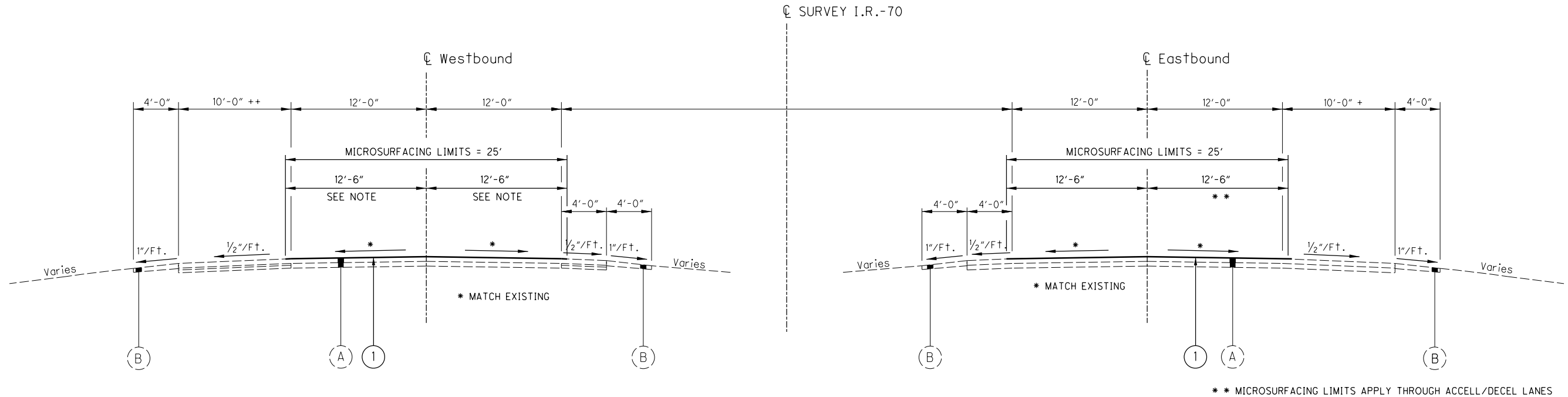

\*\* MICROSURFACING LIMITS APPLY THROUGH ACCELL/DECEL LANES

**TYPICAL**

**LIMITING STATIONS**

(STATION EQUATION) PREBLE COUNTY S.L.M. 17.80 BACK = MONTGOMERY COUNTY S.L.M. 0.00 AHEAD  
 S.L.M. 0.00 TO S.L.M 2.94 = 2.94 MILES  
 S.L.M. 2.94 TO S.L.M 2.98 = STRUCTURE MOT-70-0295 L&R AND APPROACHES (NO WORK)  
 S.L.M. 2.98 TO S.L.M 6.71 = 3.73 MILES

**NOTES:**

- 1). THIS TYPICAL IS FOR INFORMATION ONLY FOR THE APPLICATION OF THE MICROSURFACING. SUPERELEVATED SECTIONS ARE NOT SHOWN.
- 2). THE AREA TO BE MICROSURFACED SHALL STAY BETWEEN THE EXISTING RUMBLE STRIPS.
- 3). STRUCTURES ( MOT-70-0295 L&R ) AND (MOT-70-0344 L&R ) HAVE AN ASPHALT WEARING COURSE, AND SHALL BE MICROSURFACED THE SAME AS MAINLINE.

**EXISTING LEGEND**

- (A) EXISTING ASPHALT CONCRETE
- (B) EXISTING COMPACTED AGGREGATE

**PROPOSED LEGEND**

- (1) ITEM 421 - MICROSURFACING, SURFACE COURSE, AS PER PLAN

**PAVEMENT SYMBOLS**

———— = MICROSURFACING AREA

TYPICAL SECTIONS

MOT-70-0.00

ITEM 253, PAVEMENT REPAIR, AS PER PLAN

PAVEMENT REPAIR SHALL BE IN ACCORDANCE WITH ITEM 253, PAVEMENT REPAIR, AND 2016 CM&S, WITH THE FOLLOWING ADDITIONS:

THE PAVEMENT REPAIR AREAS SHALL BE ROUGHLY RECTANGULAR IN SHAPE AND SAWED OR MILLED TO A NEAT LINE. THE DEPTH OF REMOVAL, AS DIRECTED BY THE ENGINEER, SHALL BE SUFFICIENT TO REMOVE ALL DETERIORATED PAVEMENT. THE REPLACEMENT MATERIAL SHALL BE ITEM 441, ASPHALT CONCRETE INTERMEDIATE COURSE, TYPE 2, (448).

THE ESTIMATED PAVEMENT REPAIR AREAS SHALL BE FOUR FEET (4') IN WIDTH AND TWO INCHES (2") IN DEPTH AND SHALL BE FINISHED TO ACCOMMODATE THE PROPOSED OVERLAY.

A QUANTITY OF 750 SQ. YD. OF ITEM 253, PAVEMENT REPAIR, AS PER PLAN HAS BEEN CARRIED TO THE GENERAL SUMMARY TO BE USE AS DIRECTED BY THE ENGINEER.

ITEM 253, PAVEMENT REPAIR, AS PER PLAN 750 SQ. YD.

ALIGNMENT AND PROFILE

THE WORK PROPOSED BY THIS PROJECT CONSISTS OF MICROSURFACING OF THE EXISTING PAVEMENT. ALIGNMENT OF THE EXISTING PAVEMENT WILL NOT BE CHANGED AND THE PROFILE OF THE PROPOSED SURFACE WILL BE SIMILAR TO THAT OF THE EXISTING PAVEMENT.

PERMITTED LANE CLOSURE TIMES

LANE CLOSURE SHALL ONLY BE IMPLEMENTED AT THE TIMES LISTED ON THE OHIO DEPARTMENT OF TRANSPORTATION'S PERMITTED LANE CLOSURE WEB SITE WHICH IS LOCATED AT:

<http://plmc.dot.state.oh.us/>

THE PERMITTED LANE CLOSURE TIMES LISTED ON THE WEB SITE, 14 CALENDAR DAYS PRIOR THE THE BID LETTING DATE, SHALL BE IN EFFECT FOR THIS PROJECT.

NO WORK WITHIN ACTIVE TRAVEL LANES OR WHICH WILL SLOW TRAFFIC IS PERMITTED AT ANY OTHER TIMES.

IF THE CONTRACTOR VIOLATES THE BEGINNING OR ENDING TIMES OR FAILS TO MEET ANY OF THESE REQUIREMENTS, THE CONTRACTOR SHALL BE ASSESSED A DISINCENTIVE IN THE AMOUNT OF \$50 FOR EACH MINUTE THE REQUIREMENTS ARE VIOLATED.

THE CONTRACTOR WILL NOT BE PERMITTED TO PERFORM ANY MOVING OPERATIONS DURING DAYLIGHT HOURS. FOR 644 ITEMS, THE CONTRACTOR WILL ONLY BE PERMITTED TO UTILIZE MOVING OPERATIONS AT NIGHT FOR THE PLACEMENT OF EDGE LINES. THE TEMPORARY PAINT APPLICATION THAT WILL OCCUR THROUGHOUT THE PROJECT WILL FOLLOW SCD MT-99.20, EXCEPT THAT IT WILL NOT BE PERMITTED DURING DAYLIGHT HOURS. ALL OTHER OPERATIONS WILL REQUIRE THE USE OF LANE CLOSURES AS ALLOWED BY THE LANE CLOSURE POLICY.

NOTIFICATION

THE CONTRACTOR SHALL NOTIFY THE OHIO DEPARTMENT OF TRANSPORTATION DISTRICT 7 CONSTRUCTION ADMINISTRATOR, PHONE: (937) 497-6722, TWO (2) WEEKS PRIOR TO BEGINNING ANY WORK.

PAVEMENT MARKINGS

IT SHALL BE THE RESPONSIBILITY OF THE CONTRACTOR TO DOCUMENT THE LAYOUT OF THE EXISTING PAVEMENT MARKINGS AND REPLACE IN KIND THOSE MARKING DISTURBED BY THE MICROSURFACING, UNLESS OTHERWISE SHOWN IN THESE PLANS. ALL TRAFFIC CONTORL SHALL BE IN ACCORDANCE WITH 2016 CM&S AND CURRENT STANDARD DRAWINGS. SEE TRAFFIC CONTROL DETAIL SHEETS.

THE CONTRACTOR WILL BE REQUIRED TO REPLACE ANY AREA WITH MICROSURFACING IF DAMAGED BY THE REMOVAL OF TEMPORARY OR PERMANENT STRIPING DUE TO NEGLIGENCE BY THE CONTRACTOR WHEN PLACING ANY STRIPING ON THE PROJECT. THIS WOULD INCLUDE STRIPING NOT BEING PLACED IN THE CORRECT LOCATION OR STRIPING PLACED OUTSIDE THE LIMITS OF THE SPECIFICATION REQUIRING REMOVAL.

ITEM 614 - LAW ENFORCEMENT OFFICER (WITH PATROL CAR) FOR ASSISTANCE DURING CONSTRUCTION OPERATIONS

USE OF LAW ENFORCEMENT OFFICERS (LEOS) BY CONTRACTORS OTHER THAN THE USES SPECIFIED BELOW WILL NOT BE PERMITTED AT PROJECT COST. LEOS SHOULD NOT BE USED WHERE THE Omutcd INTENDS THAT FLAGGERS BE USED.

IN ADDITION TO THE REQUIREMENTS OF C&MS 614 AND THE Omutcd, A UNIFORMED LEO WITH AN OFFICIAL PATROL CAR (CAR WITH TOP-MOUNTED EMERGENCY FLASHING LIGHTS AND COMPLETE MARKINGS OF THE APPROPRIATE LAW ENFORCEMENT AGENCY) SHALL BE PROVIDED FOR THE FOLLOWING TRAFFIC CONTROL TASKS:

DURING THE ENTIRE ADVANCE PREPARATION AND CLOSURE SEQUENCE WHERE COMPLETE BLOCKAGE OF TRAFFIC IS REQUIRED.

DURING A TRAFFIC SIGNAL INSTALLATION WHEN IMPACTING THE NORMAL FUNCTION OF THE SIGNAL OR THE FLOW OF TRAFFIC OR WHEN TRAFFIC NEEDS TO BE DIRECTED THROUGH AN ENERGIZED TRAFFIC SIGNAL CONTRARY TO THE SIGNAL DISPLAY (E.G., DIRECTING MOTORISTS THROUGH A RED LIGHT).

IN ADDITION TO THE REQUIREMENT OF C&MS 614 AND THE Omutcd, A UNIFORMED LEO WITH AN OFFICIAL PATROL CAR (CAR WITH TOP-MOUNTED EMERGENCY FLASHING LIGHTS AND COMPLETE MARKINGS OF THE APPROPRIATE LAW ENFORCEMENT AGENCY) SHOULD BE PROVIDED FOR THE FOLLOWING TRAFFIC CONTROL TASKS AS APPROVED BY THE ENGINEER:

FOR LANE CLOSURES: DURING INITIAL SET-UP PERIODS, TEAR DOWN PERIODS, SUBSTANTIAL SHIFTS OF A CLOSURE POINT OR WHEN NEW LANE CLOSURE ARRANGEMENTS ARE INITIATED FOR LONG-TERM LANE CLOSURES/SHIFTS (FOR THE FIRST AND LAST DAY OF MAJOR CHANGES IN TRAFFIC CONTROL SETUP). IN GENERAL, LEOS SHOULD BE POSITIONED AT THE POINT OF LANE RESTRICTION OR ROAD CLOSURE AND TO MANUALLY CONTROL TRAFFIC MOVEMENTS THROUGH INTERSECTIONS IN WORK ZONES.

IN GENERAL, LEOS SHOULD BE POSITIONED IN ADVANCE OF AND ON THE SAME SIDE AS THE LANE RESTRICTION OR AT THE POINT OF ROAD CLOSURE, AND TO MANUALLY CONTROL TRAFFIC MOVEMENTS THROUGH SIGNALIZED INTERSECTIONS IN WORK ZONES.

ITEM 614, MAINTAINING TRAFFIC

TRAFFIC SHALL BE MAINTAINED AT ALL TIMES. THE LENGTH OF RESTRICTED TRAFFIC WORK ZONES SHALL BE KEPT TO A MAXIMUM TWO (2) MILE WORK ZONE CONSISTENT WITH THE SPECIFICATION REQUIREMENTS FOR A PROTECTION OF COMPLETED COURSES. IN ADDITION TO THE REQUIREMENTS AS INDICATED IN THE "OHIO MANUAL OF UNIFORM TRAFFIC CONTROL DEVICES FOR STREETS AND HIGHWAYS", AND PERTINENT ITEMS OF THE CONSTRUCTION AND MATERIALS SPECIFICATIONS, THE FOLLOWING REQUIREMENTS SHALL APPLY.

IT IS THE INTENTION TO PERFORM THE REQUIRED WORK WITH THE LEAST INCONVENIENCE TO AND THE MAXIMUM SAFETY OF THE CONTRACTOR AND THE TRAVELING PUBLIC. ANY VARIANCES FROM THESE MAINTENANCE OF TRAFFIC NOTES MUST BE APPROVED IN ADVANCE IN WRITING BY THE DIRECTOR. TRAFFIC IS TO BE MAINTAINED IN A UNIFORM PATTERN THROUGHOUT THE ENTIRE LENGTH OF THE PROJECT AND NOT BE SUBJECTED TO CONSTANT LANE SHIFTS.

THE CONTRACTOR'S OPERATIONS SHALL BE ARRANGED TO PREVENT ANY INTERFERENCE TO THE CONTINUOUS FLOW OF TRAFFIC. ALL VEHICLES, EQUIPMENT, WORKERS AND THEIR ACTIVITIES ARE RESTRICTED AT ALL TIMES TO ONE SIDE OF THE PAVEMENT UNLESS OTHERWISE APPROVED BY THE ENGINEER.

THE CONTRACTOR SHALL BE REQUIRED TO PROVIDE, ERECT, MAINTAIN (IN PROPER POSITION, CLEAN, LEGIBLE AND GOOD WORKING CONDITION) AND REMOVE ALL LIGHTS, SIGNS, BARRICADES, CONES AND OTHER TRAFFIC CONTROL DEVICES NECESSARY FOR THE MAINTENANCE OF TRAFFIC, INCLUDING PAVEMENT MARKINGS.

ALL WORK AND TRAFFIC CONTROL DEVICES SHALL BE IN ACCORDANCE WITH CM&S 614 AND OTHER APPLICABLE PORTIONS OF THE SPECIFICATIONS, AS WELL AS THE "OHIO MANUAL OF UNIFORMED TRAFFIC CONTROL DEVICES". PAYMENT FOR ALL LABOR, EQUIPMENT AND MATERIALS SHALL BE INCLUDED IN THE LUMP SUM CONTRACT PRICE FOR ITEM 614, MAINTAINING TRAFFIC, UNLESS SEPARATELY ITEMIZED IN THE PLAN.

ITEM 614 - LAW ENFORCEMENT OFFICER (WITH PATROL CAR) FOR ASSISTANCE DURING CONSTRUCTION OPERATIONS (cont.)

LEOS SHOULD NOT FORGO THEIR TRAFFIC CONTROL RESPONSIBILITIES TO APPREHEND MOTORISTS FOR ROUTINE TRAFFIC VIOLATIONS. HOWEVER, IF A MOTORIST'S ACTIONS ARE CONSIDERED TO BE RECKLESS, THEN PURSUIT OF THE

MOTORIST IS APPROPRIATE.

THE LEOS WORK AT THE DIRECTION OF THE CONTRACTOR. THE CONTRACTOR IS RESPONSIBLE FOR SECURING THE SERVICES OF THE LEOS WITH THE APPROPRIATE AGENCIES AND COMMUNICATING THE INTENTIONS OF THE PLANS WITH RESPECT TO DUTIES OF THE LEOS. THE ENGINEER SHALL HAVE FINAL CONTROL OVER THE LEOS' DUTIES AND PLACEMENT, AND WILL RESOLVE ANY ISSUES THAT MAY ARISE BETWEEN THE TWO PARTIES.

THE LEO SHALL REPORT IN TO THE CONTRACTOR PRIOR TO THE START OF THE SHIFT, IN ORDER TO RECEIVE INSTRUCTIONS REGARDING SPECIFIC WORK ASSIGNMENTS DURING HIS/HER SHIFT. THE LEO IS EXPECTED TO STAY AT THE PROJECT SITE FOR THE ENTIRE DURATION OF HIS/HER SHIFT. THE LEO SHALL REPORT TO THE CONTRACTOR AT THE END OF HIS/HER SHIFT. ONCE THE LEO HAS COMPLETED THE DUTIES DESCRIBED ABOVE AND STILL HAS TIME REMAINING ON HIS/HER SHIFT, THE LEO MAY BE ASKED TO PATROL THROUGH THE WORK ZONE (WITH FLASHING LIGHTS OFF) OR BE PLACED AT A LOCATION TO DETER MOTORISTS FROM SPEEDING. SHOULD IT BE NECESSARY TO LEAVE THE PROJECT SITE, THE LEO SHALL NOTIFY THE ENGINEER. THE CONTRACTOR SHALL PROVIDE THE LEO WITH A TWO-WAY COMMUNICATION DEVICE WHICH SHALL BE RETURNED TO THE CONTRACTOR AT THE END OF HIS/HER SHIFT.

LEOS (WITH PATROL CAR) REQUIRED BY THE TRAFFIC MAINTENANCE TASKS ABOVE SHALL BE PAID FOR ON A UNIT PRICE (HOURLY) BASIS UNDER ITEM 614, LAW ENFORCEMENT OFFICER (WITH PATROL CAR) FOR ASSISTANCE. THE FOLLOWING ESTIMATED QUANTITIES HAVE BEEN CARRIED TO THE GENERAL SUMMARY.

ITEM 614, LAW ENFORCEMENT OFFICER WITH PATROL CAR FOR ASSISTANCE 200 HOURS

THE HOURS PAID SHALL INCLUDE ANY MINIMUM SHOW-UP TIME REQUIRED BY THE LAW ENFORCEMENT AGENCY INVOLVED.

ANY ADDITIONAL COSTS (ADMINISTRATIVE OR OTHERWISE) INCURRED BY THE CONTRACTOR TO OBTAIN THE SERVICES OF AN LEO ARE INCLUDED WITH THE BID UNIT PRICE FOR ITEM 614, LAW ENFORCEMENT OFFICER WITH PATROL CAR FOR ASSISTANCE.

CALCULATED  
REB  
CHECKED  
TMK

GENERAL NOTES

MOT-70-0.00

7  
13

I:\ProjectData\MOT\75941\_IR70-0000\Design\Roadway\Sheets\75941GN001.dgn Sheet 12/22/2016 2:22:40 PM rhanke

I:\ProjectData\MOT\75941\_IR70-0000\Design\Roadway\Sheets\75941GG001.dgn Sheet 12/22/2016 2:22:41 PM rhanke

SHEET NUM.										PART.		ITEM	ITEM	GRAND	UNIT	DESCRIPTION	SEE
						7		9		01/IMS/PV			EXT	TOTAL			NO.
<b>PAVEMENT</b>																	
						750						253	01001	750	SY	PAVEMENT REPAIR, AS PER PLAN	7
								195,664				421	10010	195,664	SY	MICROSURFACING, SURFACE COURSE	
<b>TRAFFIC CONTROL</b>																	
								640				621	00100	640	EACH	RPM	
								656				621	54000	656	EACH	RAISED PAVEMENT MARKER REMOVED	
								7,819				644	30000	7,819	FT	REMOVAL OF PAVEMENT MARKING	
								38.67				644	30030	38.67	MILE	REMOVAL OF PAVEMENT MARKING	
								25.25				646	10010	25.25	MILE	EDGE LINE, 6"	
								13.42				646	10110	13.42	MILE	LANE LINE, 6"	
								3,119				646	10310	3,119	FT	CHANNELIZING LINE, 12"	
								4,700				646	20504	4,700	FT	DOTTED LINE, 6"	
<b>MAINTENANCE OF TRAFFIC</b>																	
						200						614	11110	200	HOUR	LAW ENFORCEMENT OFFICER WITH PATROL CAR FOR ASSISTANCE	
								34				614	12460	34	EACH	WORK ZONE MARKING SIGN	
								13.42				614	20550	13.42	MILE	WORK ZONE LANE LINE, CLASS III, 642 PAINT	
								25.25				614	22350	25.25	MILE	WORK ZONE EDGE LINE, CLASS III, 642 PAINT	
								3,119				614	23680	3,119	FT	WORK ZONE CHANNELIZING LINE, CLASS III, 642 PAINT	
								4,700				614	24610	4,700	FT	WORK ZONE DOTTED LINE, CLASS III, 642 PAINT	
<b>INCIDENTALS</b>																	
										LS		614	11000	LS		MAINTAINING TRAFFIC	
										LS		623	10000	LS		CONSTRUCTION LAYOUT STAKES AND SURVEYING	
										LS		624	10000	LS		MOBILIZATION	

CALCULATED	REB	CHECKED	TMK
<b>GENERAL SUMMARY</b>			
<b>MOT-70-0.00</b>			
8			
13			



I:\ProjectData\MOT\75941\_IR70-0000\Design\Roadway\Sheets\75941CS001.dgn Sheet 12/22/2016 2:22:42 PM rhanke

ROUTE	S.L.M.		SIDE	LENGTH (L)		AVERAGE WIDTH (W)	PAVEMENT AREA (A = L x W)	421	614	614	614	614	614	614	621	621		644	644	646	646	646	646	646	CALCULATED REB CHECKED TMK
	FROM	TO		SO. YD.	EACH			MILE	FEET	SO. FT.	SO. YD.	EACH	MILE	MILE	MILE	FEET	FEET	EACH	ONE-WAY WHITE	TWO-WAY WHITE/RED	FEET	MILE	MILE	MILE	
<b>PAVEMENT</b>																									
IR-70 EB	0.00	2.94	L/R	2.94	15524	25	388100	43123																	
<b>STOP WORK S.L.M 2.94 AND RESUME WORK S.L.M 2.98 FOR STRUCTURE MOT-70-0295 L&amp;R</b>																									
IR-70 EB	2.98	6.71	L/R	3.73	19695	25	492375	54709																	
<b>STOP WORK S.L.M 2.94 AND RESUME WORK S.L.M 2.98 FOR STRUCTURE MOT-70-0295 L&amp;R</b>																									
IR-70 WB	0.00	2.94	L/R	2.94	15524	25	388100	43123																	
<b>STOP WORK S.L.M 2.94 AND RESUME WORK S.L.M 2.98 FOR STRUCTURE MOT-70-0295 L&amp;R</b>																									
IR-70 WB	2.98	6.71	L/R	3.73	19695	25	492375	54709																	
<b>PAVEMENT MARKINGS</b>																									
IR-70 EB	0.00	6.71		6.71	35429					6.71		6.71		296	296				13.42		6.71	6.71			
IR-70 WB	0.00	6.71		6.71	35429					6.71		6.71		296	296				13.42		6.71	6.71			
IR-70 EB	0.00	2.99		2.99	15788							2.99							2.99	2.99					
	2.99	3.09		0.10	528																				528
	3.09	3.13		0.04	212																				212
	3.13	3.47		0.34	1796							0.34							0.34	0.34					634
	3.47	3.59		0.12	634									634											634
	3.59	3.79		0.20	1056									1056											1056
	3.79	5.66		1.87	9874							1.87							1.87	1.87					528
	5.66	5.76		0.10	528									528											528
	5.76	5.81		0.05	264									264											264
	5.81	6.71		0.90	4752							0.90							0.90	0.90					
IR-70 WB	0.00	2.95		2.95	15576							2.95							2.95	2.95					
	2.95	3.14		0.19	1004																				1004
	3.14	3.26		0.12	634									634											634
	3.26	3.57		0.31	1637							0.31							0.31	0.31					634
	3.57	3.62		0.05	265									265											265
	3.62	3.72		0.10	528									528											528
	3.72	5.62		1.90	10032							1.90							1.90	1.90					
	5.62	5.82		0.20	1056									1056											1056
	5.82	5.94		0.12	634									634											634
	5.94	6.51		0.57	3010							0.57							0.57	0.57					476
	6.51	6.60		0.09	476									476											476
IR-70 EB	0.00	6.71	L/R	6.71	35429																				14
IR-70 WB	0.00	6.71	L/R	6.71	35429																				14
RAMP "A"	BROOKVILLE-SALEM RD																								
RAMP "A"	ARLINGTON RD																								
RAMP "D"	ARLINGTON RD																								
TOTALS CARRIED TO GENERAL SUMMARY								195,664	34	13.42	25.25	3,119	4,700	656	640	7,819	38.67	25.25	13.42	3,119	4,700				

**PAVEMENT DATA**

**MOT-70-0.00**

I:\ProjectData\MOT\7594\1\_IR70-0000\Design\Roadway\Sheets\7594\TD001.dgn\_Sheet 12/22/2016 2:22:44 PM rhanke

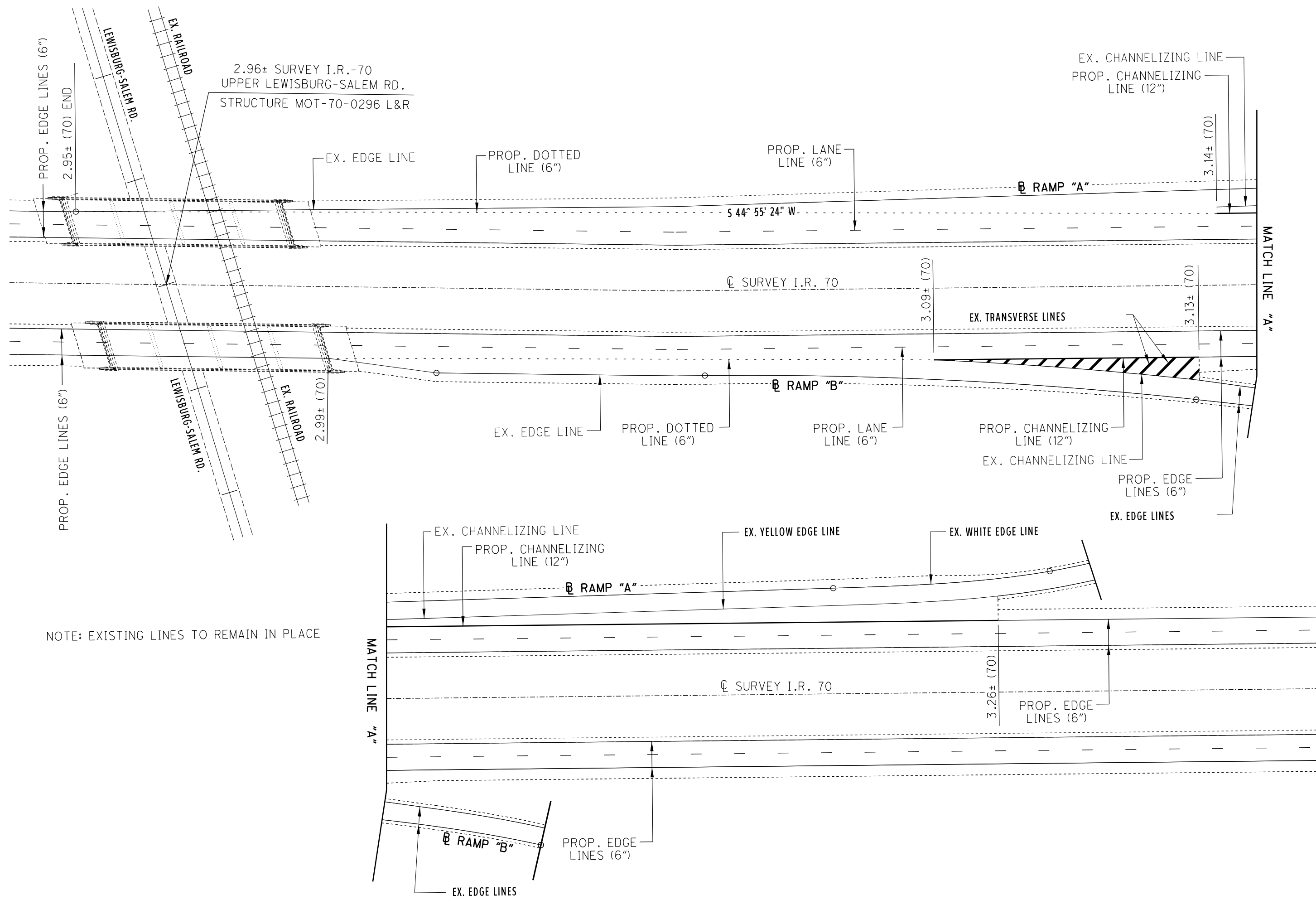

NOTE: EXISTING LINES TO REMAIN IN PLACE

CALCULATED	
REB	CHECKED
BAB	BAB

0 20 40 80  
HORIZONTAL SCALE IN FEET

↑  
N

**TRAFFIC CONTROL DETAIL**  
**ARLINGTON ROAD - RAMP "A" & "B"**

**MOT-70-0.00**

I:\ProjectData\MOT\75941\_IR70-0000\Design\Roadway\Sheets\75941TD002.dgn Sheet 12/22/2016 2:22:45 PM rhanke

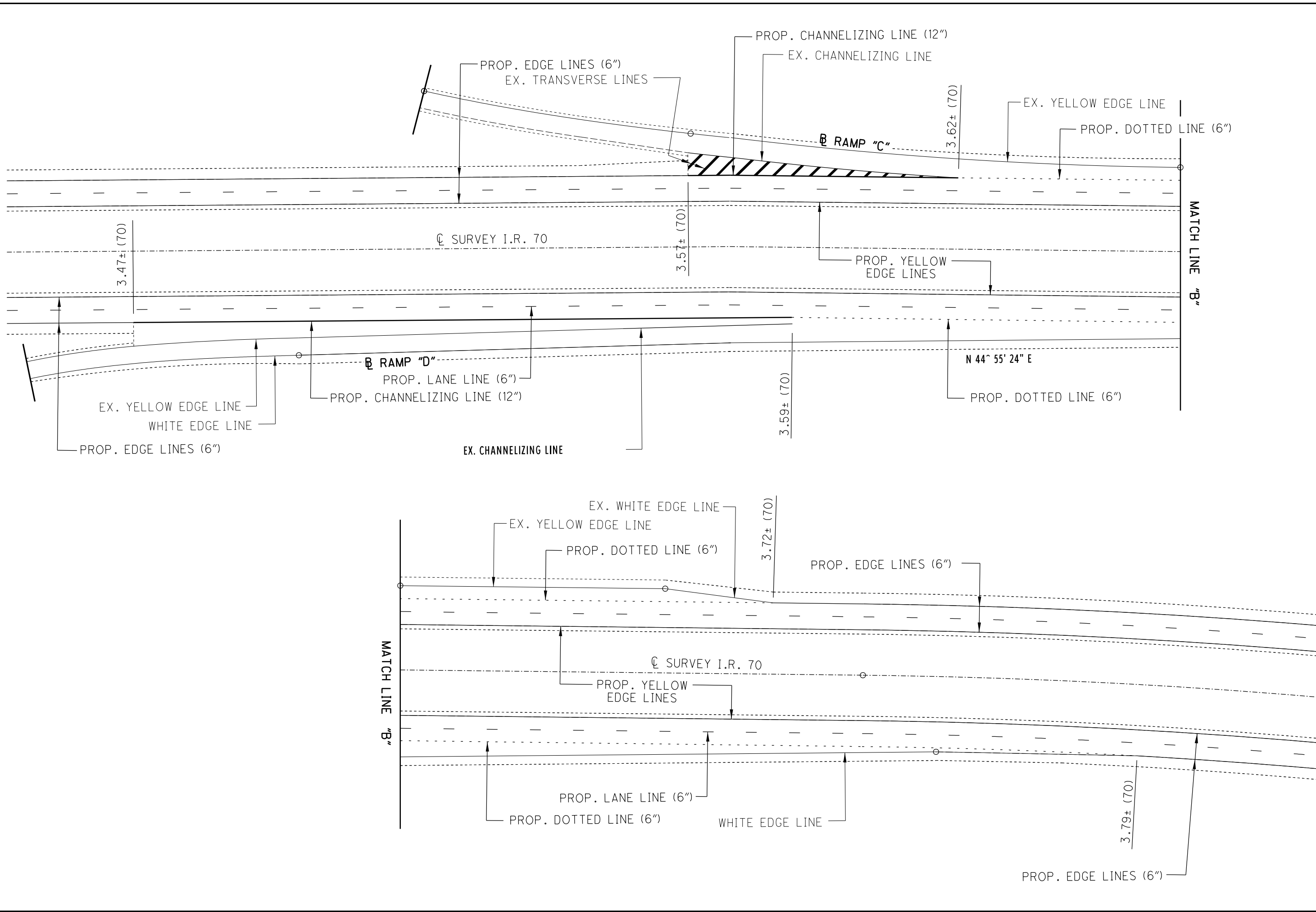

CALCULATED  
 REB  
 CHECKED  
 BAB

0 20 40 80  
 HORIZONTAL  
 SCALE IN FEET

**TRAFFIC CONTROL DETAIL**  
**ARLINGTON ROAD - RAMPS "C" & "D"**

**MOT-70-0.00**

I:\ProjectData\MOT\75941\_IR70-0000\Design\Roadway\Sheets\75941TD003.dgn Sheet 12/22/2016 2:22:46 PM rhanke

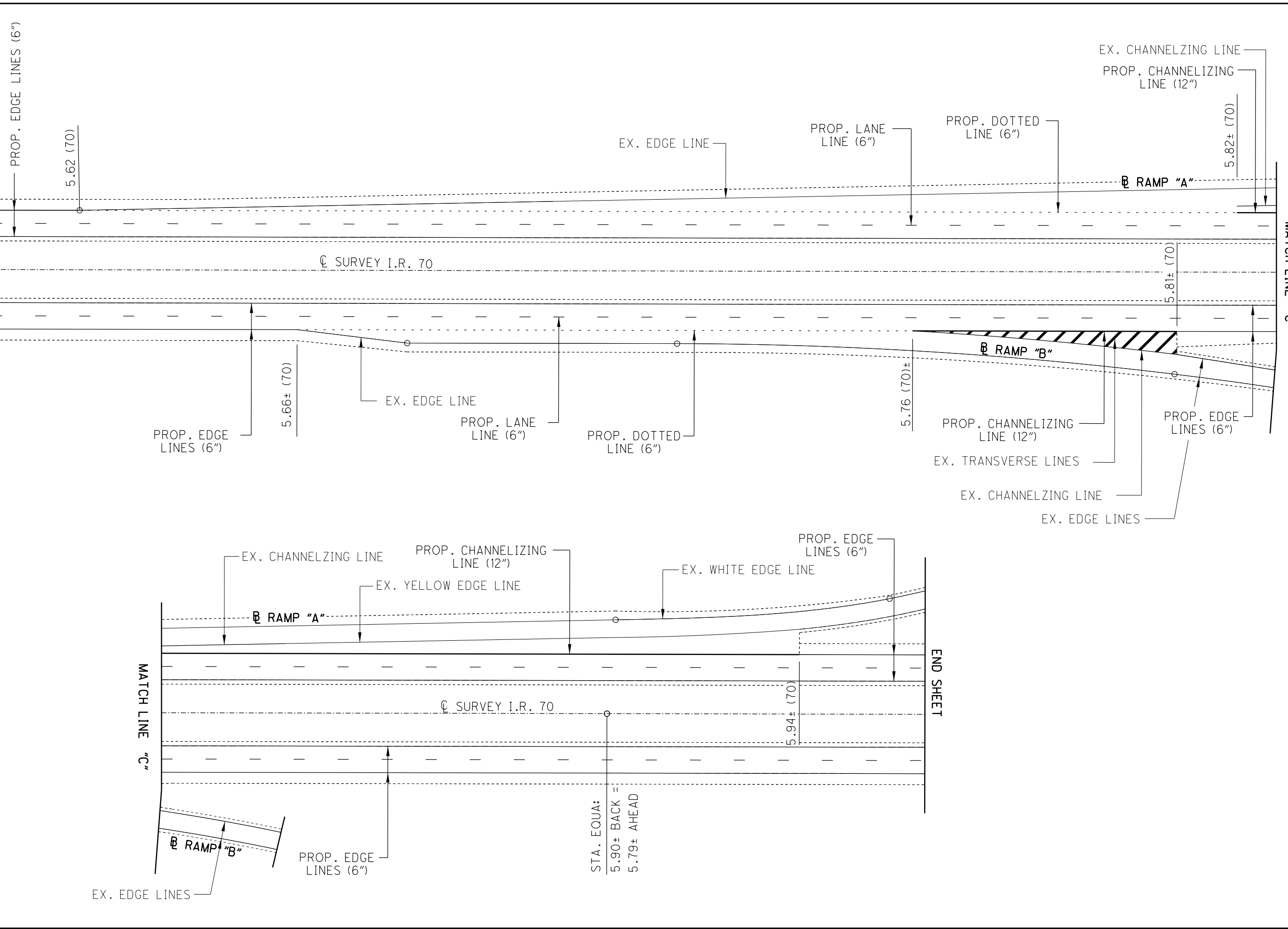

CALCULATED  
REB  
CHECKED  
TMK

**TRAFFIC CONTROL DETAIL**  
**BROOKVILLE - SALEM ROAD - RAMP "A" & "B"**

**MOT-70-0.00**

I:\ProjectData\MOT\7594\1\_IR70-0000\Design\Roadway\Sheets\7594\TD004.dgn Sheet 12/22/2016 2:22:47 PM rhanke

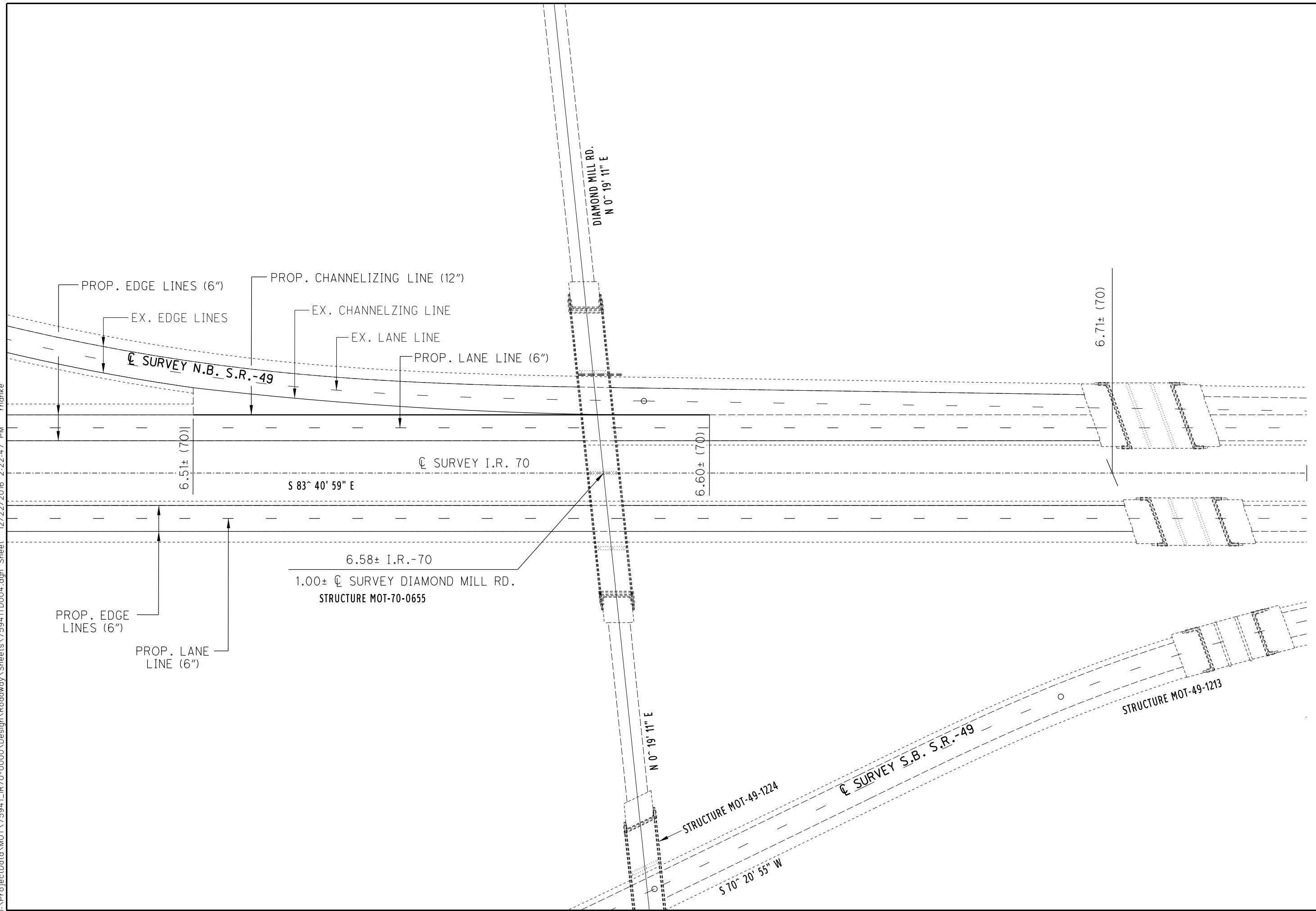

CALCULATED  
REB  
CHECKED  
TMK

0 20 40 80  
HORIZONTAL  
SCALE IN FEET

↑  
N

**TRAFFIC CONTROL DETAIL**  
**SR 49 NORTHBOUND**