

**ITEM 614, MAINTAINING TRAFFIC**

MAINTAIN ALL THE EXISTING LANES OF TRAFFIC AT ALL TIMES, EXCEPT LANE CLOSURES ARE PERMITTED IN ACCORDANCE WITH THE LANE VALUE TABLE, BY USE OF THE EXISTING PAVEMENT.

LENGTH AND DURATION OF LANE CLOSURES AND RESTRICTIONS SHALL BE AT THE APPROVAL OF THE ENGINEER. IT IS THE INTENT TO MINIMIZE THE IMPACT TO THE TRAVELING PUBLIC. LANE CLOSURES OR RESTRICTIONS OVER SEGMENTS OF THE PROJECT IN WHICH NO WORK IS ANTICIPATED WITHIN A REASONABLE TIME FRAME, AS DETERMINED BY THE ENGINEER, SHALL NOT BE PERMITTED. THE LEVEL OF UTILIZATION OF MAINTENANCE OF TRAFFIC DEVICES SHALL BE COMMENSURATE WITH THE WORK IN PROGRESS.

NOTICE OF CLOSURE SIGNS (W20-H13) SHALL BE ERECTED BY THE CONTRACTOR PRIOR TO THE SCHEDULED ROAD OR RAMP CLOSURE IN ACCORDANCE WITH THE NOTICE OF CLOSURE TIME TABLE BELOW. AT THE APPROVAL OF THE ENGINEER, PORTABLE CHANGEABLE MESSAGE SIGNS MAY BE USED IN LIEU OF THE STANDARD FLATSHEET SIGN FOR CLOSURE DURATIONS OF LESS THAN 1 WEEK.

THE SIGNS SHALL BE ERECTED ON THE RIGHT-HAND SIDE OF THE ROAD/RAMP FACING TRAFFIC. THEY SHALL BE PLACED SO AS NOT TO INTERFERE WITH THE VISIBILITY OF ANY OTHER TRAFFIC CONTROL SIGNS. ON ROADWAYS, THEY SHOULD BE ERECTED AT OR NEAR THE POINT OF CLOSURE. THE SIGNS MAY BE ERECTED ANYWHERE ON RAMPS AS LONG AS THEY ARE VISIBLE TO THE MOTORISTS USING THE RAMP. ON ENTRANCE RAMPS, THE SIGN SHALL BE ERECTED WELL IN ADVANCE OF THE MERGE AREA TO AVOID DISTRACTING MOTORISTS.

NOTICE OF CLOSURE SIGN TIME TABLE  
ITEM DURATION SIGN DISPLAYED  
OF CLOSURE TO PUBLIC

RAMP & >=2 WEEKS 14 CALENDAR DAYS PRIOR  
TO CLOSURE

ROAD > 12 HOURS 7 CALENDAR DAYS PRIOR  
& < 2 WEEKS TO CLOSURE

CLOSURES < 12 HOURS 2 BUSINESS DAYS PRIOR  
TO CLOSURE

THE SIGN SHALL DISPLAY THE DATE OF THE CLOSURE IN MMM-DD FORMAT AND THE NUMBER OF DAYS OF THE CLOSURE. THE LAST LINE OF THE W20-H13 SIGN LISTS A PHONE NUMBER WHICH A MOTORIST MAY CALL FOR ADDITIONAL INFORMATION. THIS IS TO BE A SPECIFIC OFFICE WITHIN THE DISTRICT RATHER THAN THE GENERAL SWITCHBOARD NUMBER.

NO WORK SHALL BE PERFORMED AND ALL EXISTING LANES SHALL BE OPEN TO TRAFFIC DURING THE FOLLOWING DESIGNATED HOLIDAYS OR EVENTS:

- CHRISTMAS FOURTH OF JULY
- NEW YEARS LABOR DAY
- MEMORIAL DAY THANKSGIVING
- FLYING PIG MARATHON
- OKTOBERFEST ZINZINNATI
- RIVERFEST, ETC.

THE PERIOD OF TIME THAT THE LANES ARE TO BE OPEN DEPENDS ON THE DAY OF THE WEEK ON WHICH THE HOLIDAY OR EVENT FALLS. THE FOLLOWING SCHEDULE SHALL BE USED TO DETERMINE THIS PERIOD:

**ITEM 614, MAINTAINING TRAFFIC (CONT'D)**

DAY OF HOLIDAY TIME ALL LANES  
OR EVENT MUST BE OPEN TO TRAFFIC

SUNDAY 12:00N FRIDAY THROUGH 6:00AM MONDAY  
MONDAY 12:00N FRIDAY THROUGH 6:00AM TUESDAY  
TUESDAY 12:00N MONDAY THROUGH 6:00AM WEDNESDAY  
WEDNESDAY 12:00N TUESDAY THROUGH 6:00AM THURSDAY  
THURSDAY 12:00N WEDNESDAY THROUGH 6:00AM FRIDAY  
THURSDAY (THANKSGIVING ONLY)  
6:00AM WEDNESDAY THROUGH 6:00AM MONDAY  
FRIDAY 12:00N THURSDAY THROUGH 6:00AM MONDAY  
SATURDAY 12:00N FRIDAY THROUGH 6:00AM MONDAY

SHOULD THE CONTRACTOR FAIL TO MEET ANY OF THESE REQUIREMENTS, THE CONTRACTOR SHALL BE ASSESSED A DISINCENTIVE PER THE LANE VALUE CONTRACT (PN 127).

ALL WORK AND TRAFFIC CONTROL DEVICES SHALL BE IN ACCORDANCE WITH C&MS 614 AND OTHER APPLICABLE PORTIONS OF THE SPECIFICATIONS, AS WELL AS THE OHIO MANUAL OF UNIFORM TRAFFIC CONTROL DEVICES. PAYMENT FOR ALL LABOR, EQUIPMENT AND MATERIALS SHALL BE INCLUDED IN THE LUMP SUM CONTRACT PRICE FOR ITEM 614, MAINTAINING TRAFFIC, UNLESS SEPARATELY ITEMIZED IN THE PLAN.

**DELINEATION OF PORTABLE AND PERMANENT BARRIER**

BARRIER REFLECTORS AND OBJECT MARKERS SHALL BE INSTALLED ON ALL PORTABLE BARRIER (PB) USED FOR TRAFFIC CONTROL; AND, ON PERMANENT CONCRETE BARRIER (INCLUDING BRIDGE PARAPETS) LOCATED WITHIN 5 FEET OF THE EDGE OF THE ADJACENT TRAVEL LANE.

BARRIER REFLECTORS SHALL CONFORM TO C&MS 626, EXCEPT THAT THE SPACING SHALL BE AS PER TRAFFIC SCD MT-101.70. OBJECT MARKERS AND THEIR INSTALLATION SHALL CONFORM TO C&MS 614.03 AND SCD MT-101.70. WHEN THE PB CONTAINS GLARE SCREEN, ONE SET OF THREE VERTICAL STRIPES OF SHEETING SHALL BE CONSIDERED EQUIVALENT TO AN OBJECT MARKER, ONE-WAY.

PAYMENT SHALL BE FULL COMPENSATION FOR ALL MATERIAL, LABOR, INCIDENTALS AND EQUIPMENT NECESSARY FOR FURNISHING, INSTALLING, MAINTAINING AND REMOVING EACH OF THE ABOVE ITEMS.

**PRE-127-0227 SITE ACCESS**

THE CONTRACTOR SHALL EITHER ACCESS THE UNDERSIDE OF THE BRIDGE IN ORDER TO PERFORM PIER REPAIRS BY USE OF A CONSTRUCTION DRIVEWAY OR FROM SWANN-BEATTY ROAD AND BY USE OF TEMPORARY ACCESS FILLS PER THE WATERWAY PERMIT. THE USE OF A CONSTRUCTION DRIVEWAY AND THE REMOVAL OF GUARDRAIL SHALL BE PER THE DIAGRAM INCLUDED BELOW.

ALL MATERIALS, LABOR, ETC. FOR CONSTRUCTION DRIVEWAY INCLUDING GUARDRAIL MODIFICATIONS ARE TO BE INCLUDED IN THE LUMP SUM ITEM 614, MAINTAINING TRAFFIC.

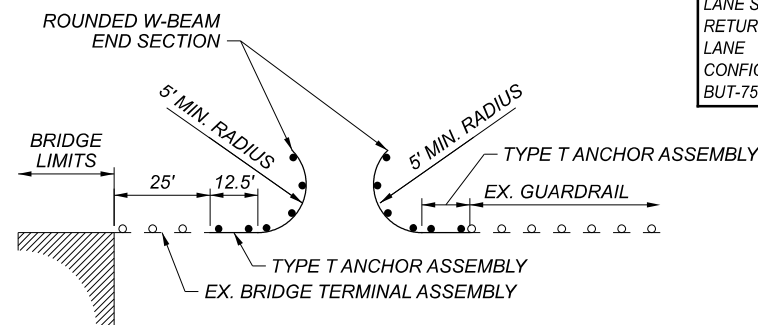

**NOTIFICATION OF TRAFFIC RESTRICTIONS**

THROUGHOUT THE DURATION OF THE PROJECT, THE CONTRACTOR SHALL NOTIFY THE PROJECT ENGINEER IN WRITING OF ALL TRAFFIC RESTRICTIONS AND UPCOMING MAINTENANCE OF TRAFFIC CHANGES. THE CONTRACTOR SHALL ENSURE THE WRITTEN NOTIFICATION IS SUBMITTED IN A TIMELY MANNER TO ALLOW THE PROJECT ENGINEER TO MEET THE REQUIRED TIME FRAMES SET FORTH IN THE TABLE BELOW TO INFORM THE LISTED CONTACTS.

THIS NOTIFICATION SHALL BE RECEIVED BY THE PROJECT ENGINEER PRIOR TO THE PHYSICAL SETUP OF ANY APPLICABLE SIGNS OR MESSAGE BOARDS. INFORMATION SHOULD INCLUDE, BUT IS NOT LIMITED TO, ALL CONSTRUCTION ACTIVITIES THAT IMPACT OR INTERFERE WITH TRAFFIC AND SHALL LIST THE SPECIFIC LOCATION, TYPE OF WORK, ROAD STATUS, DATE AND TIME OF RESTRICTION, DURATION OF RESTRICTION, NUMBER OF LANES MAINTAINED, NUMBER OF LANES CLOSED, MINIMUM VERTICAL CLEARANCE, MINIMUM WIDTH OF DRIVABLE PAVEMENT, DETOUR ROUTES, IF APPLICABLE, AND ANY OTHER INFORMATION REQUESTED BY THE PROJECT ENGINEER.

| NOTIFICATION TIME TABLE                         |                        |  |
|---|------------------------|--|
| ITEM  | DURATION OF CLOSURE    | NOTICE DUE TO LISTED CONTACTS            |
| RAMP & ROAD CLOSURES                            | >= 2 WEEKS             | 21 CALENDAR DAYS PRIOR TO CLOSURE        |
|   | > 12 HOURS & < 2 WEEKS | 14 CALENDAR DAYS PRIOR TO CLOSURE        |
|   | < 12 HOURS             | 4 BUSINESS DAYS PRIOR TO CLOSURE         |
| LANE CLOSURES & RESTRICTIONS                    | >= 2 WEEKS             | 14 CALENDAR DAYS PRIOR TO CLOSURE        |
|   | < 2 WEEKS              | 5 BUSINESS DAYS PRIOR TO CLOSURE         |
| START OF CONSTRUCTION & TRAFFIC PATTERN CHANGES | N/A                    | 14 CALENDAR DAYS PRIOR TO IMPLEMENTATION |

ANY UNFORESEEN CONDITIONS NOT SPECIFIED IN THE PLANS REQUIRING TRAFFIC RESTRICTIONS SHALL ALSO BE REPORTED TO THE PROJECT ENGINEER USING THE NOTIFICATION TIME TABLE.

CONTACT THE FOLLOWING:  
-DISTRICT PUBLIC INFORMATION OFFICER BY EMAIL AT DOT.D08.PIO@DOT.OHIO.GOV  
-DISTRICT PERMIT SECTION BY EMAIL AT D08.PERMITS@DOT.OHIO.GOV  
-CENTRAL OFFICE SPECIAL HAUL PERMITS SECTION BY EMAIL AT HAULING.PERMITS@DOT.OHIO.GOV

**ITEM SPECIAL - WORK ZONE GUARDRAIL**

THIS WORK SHALL CONSIST OF REMOVING AND SUBSEQUENTLY RE-ERECTING THE EXISTING FLARED END SECTION, AND GUARDRAIL ON RADIUS FOR THE DRIVE OPENING AT THE ALLEN RD. LOCATION AS SPECIFIED IN THE PLANS. INSTALL TEMPORARY TYPE 5 GUARDRAIL TANGENT TO THE ROADWAY. INSTALL TEMPORARY TYPE 5 GUARDRAIL PER PIS GR-1.1 AND PIS GR-2.1 ON SHEETS 29 - 33. RE-ERECT THE GUARDRAIL RADIUS AND FLARED END SECTIONS TO RESTORE THE GUARDRAIL TO THE ORIGINAL CONFIGURATION.

**WINDOW CONTRACT TABLE**

USE THE FOLLOWING TABLE AS REFERRED TO IN THE PROPOSAL:

| DESCRIPTION OR LOCATION OF CRITICAL WORK  | CALENDER DAYS TO COMPLETE | DISINCENTIVE \$ PER DAY | WORK WINDOW             |                         |
|---|---------------------------|-------------------------|-------------------------|-------------------------|
|   |                           |                         | START                   | END                     |
| COMPLETE ALL WORK USING LANE SHIFTS & RETURN ORIGINAL LANE CONFIGURATION AT BUT-75-0219 | 120                       | PER C&MS 108.07         | CONTRACT EXECUTION DATE | PROJECT COMPLETION DATE |

**ITEM 614, WORK ZONE IMPACT ATTENUATOR FOR 24" WIDE HAZARDS (BIDIRECTIONAL)**

THIS ITEM SHALL CONSIST OF FURNISHING AND INSTALLING A NON-GATING IMPACT ATTENUATOR. FURNISH AN IMPACT ATTENUATOR FROM THE OFFICE OF ROADWAY ENGINEERING'S APPROVED LIST FOR WORK ZONE IMPACT ATTENUATORS, FROM THE ROADWAY STANDARDS APPROVED PRODUCTS WEB PAGE.

INSTALLATION SHALL BE AT THE LOCATIONS SPECIFIED IN THE PLANS IN ACCORDANCE WITH THE MANUFACTURER'S SPECIFICATIONS.

THE CONTRACTOR SHALL REPAIR OR REPLACE A DAMAGED UNIT WITHIN 24 HOURS OF A DAMAGING IMPACT.

WHEN BIDIRECTIONAL DESIGNS ARE SPECIFIED, THE CONTRACTOR SHALL SUPPLY APPROPRIATE TRANSITIONS.

WHEN GATING IMPACT ATTENUATORS ARE DESIRED, THE CONTRACTOR SHALL SUBMIT DOCUMENTATION TO THE ENGINEER FOR ACCEPTANCE.

THE COST FOR THE ADDITIONAL BARRIER REQUIRED FOR A GATING IMPACT ATTENUATOR SHALL BE INCLUDED IN THE COST OF THE GATING IMPACT ATTENUATOR.

PAYMENT FOR THE ABOVE WORK SHALL BE MADE AT THE UNIT PRICE BID AND SHALL INCLUDE ALL LABOR, TOOLS, EQUIPMENT AND MATERIALS NECESSARY TO CONSTRUCT AND MAINTAIN A COMPLETE AND FUNCTIONAL IMPACT ATTENUATOR SYSTEM, INCLUDING ALL RELATED BACKUPS, TRANSITIONS, LEVELING PADS, HARDWARE AND GRADING, NOT SEPARATELY SPECIFIED, AS REQUIRED BY THE MANUFACTURER.

**LANE VALUE CONTRACT**

THE CONTRACTOR SHALL BE ASSESSED DISINCENTIVES AS DESIGNATED IN THE LANE VALUE CONTRACT TABLE FOR EACH UNIT OF TIME THE DESCRIBED CRITICAL LANE/RAMP IS RESTRICTED FROM FULL USE BY THE TRAVELING PUBLIC WITHIN THE RESTRICTED TIME PERIOD. THE LANE VALUE CONTRACT TABLE IS LOCATED IN THE PLAN GENERAL NOTES. THE DISINCENTIVES WILL BE ASSESSED FOR ALL RESTRICTIONS OF THE CRITICAL WORK. CRITICAL WORK IS SHOWN IN THE LANE VALUE CONTRACT TABLE. CRITICAL WORK IS DEFINED AS HAVING THE DESIGNATED SECTIONS OPEN TO UNRESTRICTED TRAFFIC AS SHOWN IN THE TABLE, OR THE ENTIRE PROJECT IF NOT OTHERWISE LISTED. UNRESTRICTED TRAFFIC IS DEFINED AS ALL TRAFFIC LANES BEING AVAILABLE FOR USE WITH SPECIFIED STRIPING AND SAFETY FEATURES IN PLACE.

**LANE VALUE CONTRACT TABLE**

| DESCRIPTION OF CRITICAL LANE/RAMP TO BE MAINTAINED | RESTRICTED TIME PERIOD              | TIME UNIT | DISINCENTIVE \$ PER TIME UNIT PER LANE |
|--|-------------------------------------|-----------|--|
| ALL LANES ON I-75 OPEN TO TRAFFIC                  | SEE PERMITTED LANE CLOSURE SCHEDULE | 1 MINUTE  | \$335                                  |
| 1 LANE CLOSED EACH DIRECTION MEHRING WAY           | 4 PM TO 8 AM                        | 1 MINUTE  | \$15                                   |
| 1 LANE TWO WAY TRAFFIC US 127                      | NONE                                | 1 MINUTE  | \$65                                   |
| ALL LANES ON I-71 OPEN TO TRAFFIC                  | SEE PERMITTED LANE CLOSURE SCHEDULE | 1 MINUTE  | \$380                                  |

**NOTE:**

1. THE PERMITTED LANE CLOSURE SCHEDULE IS LOCATED ON THE ODOT WEBSITE <http://plcm.dot.state.oh.us/> THE LATEST REVISION, 14 DAYS PRIOR TO THE BID, SHALL BE IN EFFECT FOR THIS PROJECT.
2. NO CLOSURES 2 HOURS BEFORE THE EVENT START TIME NOR 2 HOURS AFTER THE EVENT END TIME FOR EVENTS AT GREAT AMERICAN BALL PARK, PAUL BROWN STADIUM, OR HERITAGE BANK CENTER. THIS RESTRICTION ALSO APPLIES TO ANY OTHER LOCAL VENUE GENERATING AN EVENT ATTENDANCE OF 10,000+.

DESIGN AGENCY



DESIGNER

GTF

REVIEWER

SK 10/15/21

PROJECT ID

102754

SHEET

TOTAL

4 40