

FIRST PART OF PHASE

WORK AREA	614	614	615	622	622
	WORK ZONE IMPACT ATTENUATOR, 24" WIDE HAZARDS, (UNIDIRECTIONAL)	WORK ZONE EDGE LINE, CLASS I, 6"	PAVEMENT FOR MAINTAINING TRAFFIC, TYPE B	PORTABLE BARRIER, UNANCHORED	PORTABLE BARRIER, ANCHORED
	EACH	MILE	SY	FT	FT
CULVERT 3	2	0.37	233	650	60
CULVERT 3A	2	0.48	640	650	60
CULVERT 4A	2	0.35	103	650	60
CULVERT 5	2	0.35	103	650	60
CULVERT 5A	2	0.35	103	650	60
CULVERT 6	2	0.35	103	650	60
TOTALS CARRIED TO GENERAL SUMMARY	12	2.25	1285	3900	360

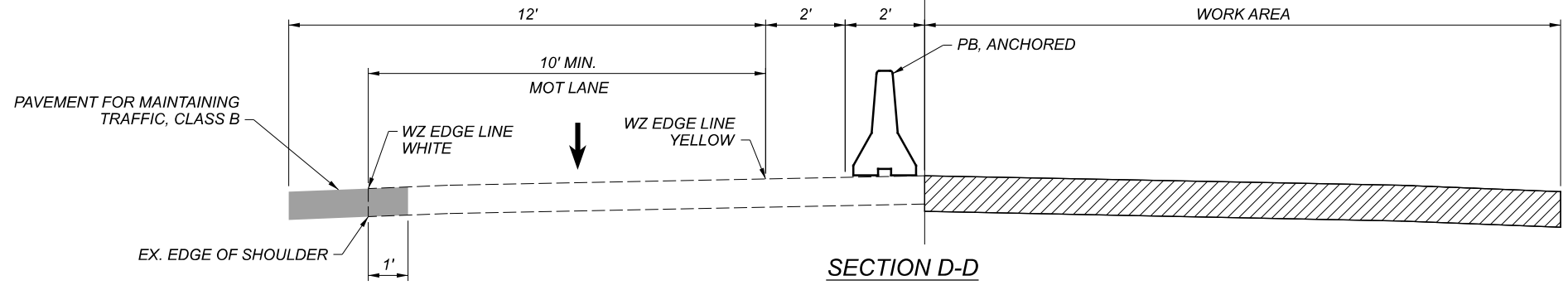

CULVERTS SHALL BE CONSTRUCTED IN THE SAME PHASE AS THE ROAD RECONSTRUCTION/WIDENING. EXCAVATION SHALL BE PROTECTED WITH PORTABLE BARRIER IN ACCORDANCE WITH SCD MT-95.41 AND THIS SHEET.

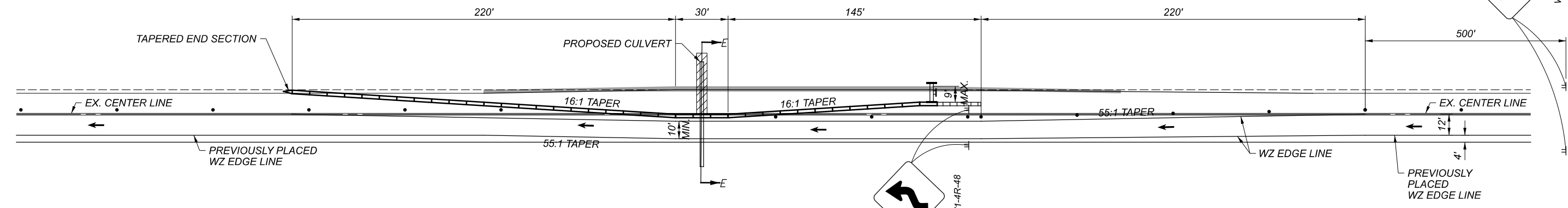

SECOND PART OF PHASE

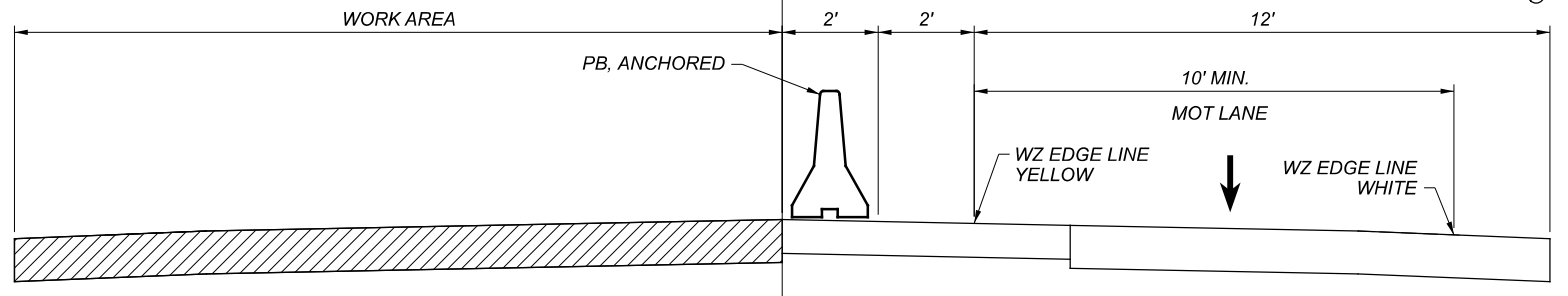

LEGEND

WORK AREA	
DRUMS	
REMOVE EXISTING MARKINGS	
DIRECTION OF TRAVEL	
TYPE III BARRICADE	
IMPACT ATTENUATOR	
PORTABLE BARRIER (PB)	



MAINTENANCE OF TRAFFIC
CULVERT CONSTRUCTION

GENERAL SUMMARY

SHEET NUM.										PART.				ITEM	ITEM EXT	GRAND TOTAL	UNIT	DESCRIPTION	SEE SHEET NO.
11	12	13	17	36	37	38	39	10	OFFICE CALCS	01/NHS/PV	02/NHS/PV	03/S>2/PV	04/NHS/CV						
TRAFFIC CONTROL																			
				1.7	2.29									618	41000	3.99	MILE	RUMBLE STRIPES, EDGE LINE (ASPHALT CONCRETE)	
				0.86	1.11									618	43000	1.97	MILE	RUMBLE STRIPES, CENTER LINE (ASPHALT CONCRETE)	
				124	229	178					195	336		621	00100	531	EACH	RPM	
								340			280	60		621	54000	340	EACH	RAISED PAVEMENT MARKER REMOVED	
														630	02101	159	FT	GROUND MOUNTED SUPPORT, NO. 2 POST, AS PER PLAN	
								159			159			630	03101	27	FT	GROUND MOUNTED SUPPORT, NO. 3 POST, AS PER PLAN	
								27			27			630	04100	27	FT	GROUND MOUNTED SUPPORT, NO. 4 POST	
								103			103			630	80100	103	SF	SIGN, FLAT SHEET	
								18			18			630	84900	18	EACH	REMOVAL OF GROUND MOUNTED SIGN AND DISPOSAL	
								18			18			630	86002	18	EACH	REMOVAL OF GROUND MOUNTED POST SUPPORT AND DISPOSAL	
		2									2			642	00300	2	MILE	CENTER LINE, TYPE I	
				1.7	3.78	2.12					4.83	2.77		644	00104	7.6	MILE	EDGE LINE, 6"	
				0.86	2.13	1.18					1.86	2.31		644	00300	4.17	MILE	CENTER LINE	
												1,815		644	00400	1,815	FT	CHANNELIZING LINE, 8"	
				19	13	119					16	135		644	00500	151	FT	STOP LINE	
					337	277						614		644	00700	614	FT	TRANSVERSE/DIAGONAL LINE	
						14						14		644	01300	14	EACH	LANE ARROW	
				0.68		0.14					0.82			646	10010	0.82	MILE	EDGE LINE, 6"	
				0.51		0.4					0.91			646	10200	0.91	MILE	CENTER LINE	
				430		225					655			646	10300	655	FT	CHANNELIZING LINE, 8"	
				74							74			646	10400	74	FT	STOP LINE	
				269							462			646	10600	462	FT	TRANSVERSE/DIAGONAL LINE	
					6	2					8			646	20300	8	EACH	LANE ARROW	
MAINTENANCE OF TRAFFIC																			
225											225			304	20000	225	CY	AGGREGATE BASE	
50											50			410	11000	50	CY	TRAFFIC COMPACTED SURFACE, TYPE B	
	60													614	11110	60	hour	LAW ENFORCEMENT OFFICER WITH PATROL CAR FOR ASSISTANCE	
		990												614	11630	990	FT	INCREASED BARRIER DELINEATION	
			12						8					614	12380	20	EACH	WORK ZONE IMPACT ATTENUATOR, 24" WIDE HAZARDS, (UNIDIRECTIONAL)	
		LS									LS			614	12420	LS	EACH	DETOUR SIGNING	
20											20			614	12600	20	EACH	REPLACEMENT DRUM	
											200			614	13000	200	CY	ASPHALT CONCRETE FOR MAINTAINING TRAFFIC	
											48			614	13310	48	EACH	BARRIER REFLECTOR, TYPE (ONE-WAY) OR BI-DIRECTIONAL	
											42			614	13350	42	EACH	OBJECT MARKER, ONE WAY	
											12			614	18601	12	SNMT	PORTABLE CHANGEABLE MESSAGE SIGN, AS PER PLAN	
											5.46	7.46		614	22010	12.92	MILE	WORK ZONE EDGE LINE, CLASS I, 6"	
												3.73		614	21000	3.73	MILE	WORK ZONE CENTER LINE, CLASS I	
											1,285			615	25000	1,285	SY	PAVEMENT FOR MAINTAINING TRAFFIC, CLASS B	
5	28										33			616	10000	33	MGAL	WATER	
											3,900			622	41100	3,900	FT	PORTABLE BARRIER, UNANCHORED	
											360			622	41110	360	FT	PORTABLE BARRIER, ANCHORED	
											0.2			644	30030	0.2	MILE	REMOVAL OF PAVEMENT MARKING	
											3			646	50000	3	EACH	REMOVAL OF PAVEMENT MARKING	
											0.63			646	50300	0.63	MILE	REMOVAL OF PAVEMENT MARKING	
INCIDENTALS																			
									LS	LS	LS	LS	LS	614	11000	LS	MNTH	MAINTAINING TRAFFIC	
											7			619	16010	7		FIELD OFFICE, TYPE B	
											LS	LS	LS	623	10000	LS		CONSTRUCTION LAYOUT STAKES AND SURVEYING	
											LS	LS	LS	624	10000	LS		MOBILIZATION	

DEL-42-2.28

MODEL: Sheet PAPER: 17x11 (in.) DATE: 2/7/2022 TIME: 10:32:00 AM USER: mcdellan pvc\jim-pw-benley.com\jim-pw-01\Documents\Projects\2019\19-03798-001\109074\400-Engineering\Roadway\Sheets\109074_GG003.dgn

DESIGN AGENCY
JMT
 2800 Corporate Exchange Drive, Suite 250,
 Columbus, OH 43221

DESIGNER
JAG
 REVIEWER
RJM 09/27/21

PROJECT ID
109074
 SHEET TOTAL
26 153