

STATE OF OHIO DEPARTMENT OF TRANSPORTATION

FRA-3-20.40 CLINTON TOWNSHIP FRANKLIN COUNTY

FEDERAL PROJECT NUMBER

E191(620)

RAILROAD INVOLVEMENT

NONE

PROJECT DESCRIPTION

THIS PROJECT INCLUDES MODIFYING LANE CONFIGURATIONS OF APPROXIMATELY 0.31 MILES OF SR 3 FROM S.L.M. 20.40 TO S.L.M. 20.71 AND APPROXIMATELY 0.08 MILES OF OAKLAND PARK AVENUE FROM S.L.M. 1.64 TO S.L.M. 1.72. THE PROJECT ALSO INCLUDES MILLING AND FILLING THE EXISTING PAVEMENT TRAVEL LANES WITHIN THE WORK ZONE DESCRIBED ABOVE. MINOR PAVEMENT WIDENING OF APPROXIMATELY 0.03 MILES OF SR 3 FROM S.L.M. 20.64 TO S.L.M. 20.67 IS ALSO INCLUDED.

EARTH DISTURBED AREAS

PROJECT EARTH DISTURBED AREA: 0.02 ACRES
ESTIMATED CONTRACTOR EARTH DISTURBED AREA: 0.00 ACRES
NOTICE OF INTENT EARTH DISTURBED AREA: N/A (NOI NOT REQUIRED)

2019 SPECIFICATIONS

THE STANDARD SPECIFICATIONS OF THE STATE OF OHIO, DEPARTMENT OF TRANSPORTATION, INCLUDING SUPPLEMENTAL SPECIFICATIONS LISTED IN THE PLANS AND CHANGES LISTED IN THE PROPOSAL SHALL GOVERN THIS IMPROVEMENT.

FRANKLIN COUNTY APPROVALS

SIGNATURES BELOW SIGNIFY ONLY CONCURRENCE WITH THE GENERAL PURPOSE AND GENERAL LOCATION OF THE PROJECT. ALL TECHNICAL DETAILS REMAIN THE RESPONSIBILITY OF THE ENGINEER PREPARING THE PLANS. APPROVAL ON THE PART OF THE FRANKLIN COUNTY ENGINEER'S OFFICE IS GIVEN FOR WORK WITHIN THE FRANKLIN COUNTY RAW ONLY.

FRANKLIN COUNTY ENGINEER DATE

FRANKLIN COUNTY CHIEF DEPUTY ENGINEER DATE

I HEREBY APPROVE THESE PLANS AND DECLARE THAT THE MAKING OF THIS IMPROVEMENT WILL NOT REQUIRE THE CLOSING TO TRAFFIC OF THE HIGHWAY AND THAT PROVISIONS FOR THE MAINTENANCE AND SAFETY OF TRAFFIC WILL BE AS SET FORTH ON THE PLANS AND ESTIMATES.

I HEREBY APPROVE THESE PLANS AND DECLARE THAT THE MAKING OF THIS IMPROVEMENT WILL NOT REQUIRE THE CLOSING TO TRAFFIC OF THE HIGHWAY AND THAT PROVISIONS FOR THE MAINTENANCE AND SAFETY OF TRAFFIC WILL BE AS SET FORTH ON THE PLANS AND ESTIMATES.

APPROVED _____
DATE _____ DISTRICT DEPUTY DIRECTOR

APPROVED _____
DATE _____ DIRECTOR, DEPARTMENT OF TRANSPORTATION

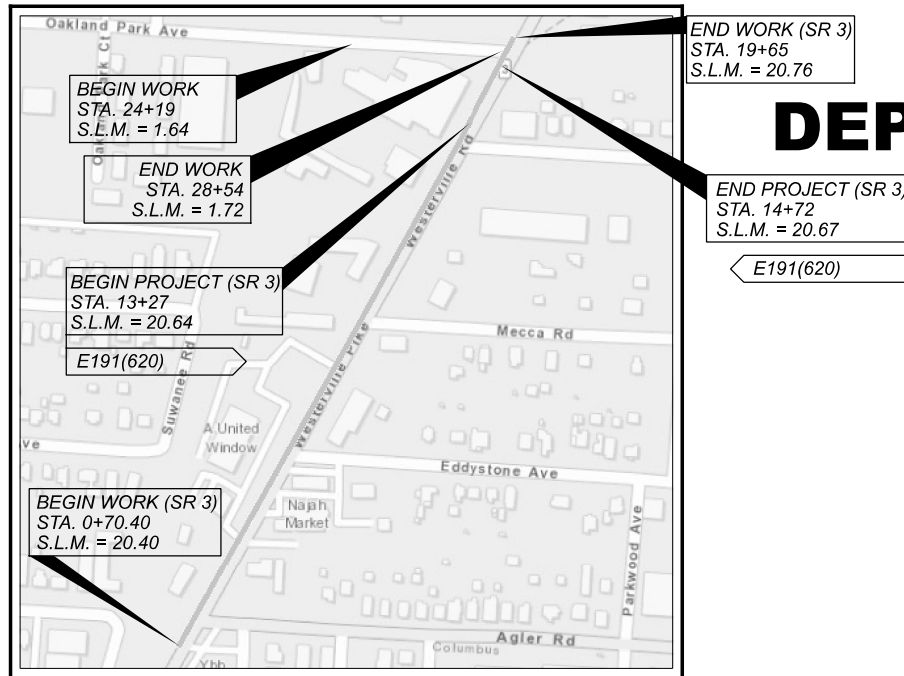

LOCATION MAP

LATITUDE: N 40° 01' 52" LONGITUDE: W 83° 57' 26"



PORTION TO BE IMPROVED	—————
INTERSTATE HIGHWAY	=====
FEDERAL ROUTES	=====
STATE ROUTES	=====
COUNTY & TOWNSHIP ROADS	=====
OTHER ROADS	-----

DESIGN DESIGNATION	WESTERVILLE RD (SR 3)	OAKLAND PARK
CURRENT ADT (2022)	19,000	10,400
DESIGN YEAR ADT (2042)	26,500	12,400
DESIGN HOURLY VOLUME (2042)	2,600	1,200
DIRECTIONAL DISTRIBUTION	56%	55%
TRUCKS (24 HOUR B&C)	4%	4%
DESIGN SPEED	35/45 MPH	35 MPH
LEGAL SPEED	35/45 MPH	35 MPH
DESIGN FUNCTIONAL CLASSIFICATION:		
04 MINOR ARTERIAL (URBAN)		
NHS PROJECT	NO	

DESIGN EXCEPTIONS

NONE REQUIRED

ADA DESIGN WAIVERS

NONE REQUIRED

UNDERGROUND UTILITIES

Contact Two Working Days
Before You Dig

OHIO811.org
Before You Dig

OHIO 811, 8-1-1, or 1-800-362-2764
(Non members must be called directly)

PLAN PREPARED BY:



ENGINEER'S SEAL:

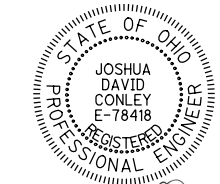

SIGNED: _____
DATE: 2/23/2022

INDEX OF SHEETS:

TITLE SHEET	1
SCHEMATIC PLAN	2
TYPICAL SECTIONS	3
GENERAL NOTES	4
MAINTENANCE OF TRAFFIC	5, 5A, 6
GENERAL SUMMARY	7-8
SUBSUMMARIES	9-12
PAVEMENT CALCULATIONS	13
PLAN	14-18
SIGNAL NOTES	19
TRAFFIC DETAILS	20
SIGNING AND PAVEMENT MARKINGS	21-23

STANDARD CONSTRUCTION DRAWINGS						SUPPLEMENTAL SPECIFICATIONS		SPECIAL PROVISIONS	
BP-3.1	1/17/20	TC-16.22	7/16/21			800-2019	10/15/21		
		TC-21.11	7/16/21			832	10/19/18		
CB-6	1/21/22	TC-22.20	1/17/14			861	1/15/21		
		TC-41.20	10/18/13			821	4/20/12		
DM-1.1	7/17/20	TC-42.20	10/18/13			921	4/20/12		
		TC-52.10	10/18/13						
MT-95.31	7/19/19								
		TC-65.10	1/17/14						
MT-95.60	4/19/19	TC-65.11	7/21/17						
MT-95.61	4/19/19	TC-71.10	1/19/18						
		TC-74.10	7/16/21						
MT-101.90	7/17/20								
MT-102.20	4/19/19	TC-84.20	10/18/13						
MT-105.10	1/17/20	TC-84.21	10/18/13						
		TC-85.22	1/19/18						

TITLE SHEET

DESIGN AGENCY



2800 Corporate Exchange Drive, Suite 250,
Columbus, OH 43221

DESIGNER
VLC

REVIEWER
RJM 12-17-21

PROJECT ID
110799

SHEET TOTAL
1 23

FRA-3-20.40

MODEL: Sheet PAPER SIZE: 17x11 (in.) DATE: 2/24/2022 TIME: 10:36:51 AM USER: jconley C:\2019\1902666_001_District_6_Safety_De\CADD\110799\400-Engineering\Roadway\Sheets\110799_GT001.dgn

UTILITIES

LISTED BELOW ARE ALL UTILITIES LOCATED WITHIN THE PROJECT CONSTRUCTION LIMITS TOGETHER WITH THEIR RESPECTIVE OWNERS:

AEP OHIO
 700 MORRISON ROAD
 GAHANNA, OH 43230
 ATTN.: BRENT GATES
 P. 614.883.6802

CITY OF COLUMBUS
 DIVISION OF SEWERAGE
 AND DRAINAGE
 1250 FAIRWOOD AVE.
 COLUMBUS, OH 43206
 P. 614.645.0483

ODOT D6 TRAFFIC
 400 EAST WILLIAMS ST.
 DELAWARE, OH 43015
 P. 740.833.8024

FRANKLIN COUNTY
 ENGINEERS OFFICE
 970 DUBLIN ROAD
 COLUMBUS, OH 43215
 ATTN.: STEVE BUSKIRK
 P. 614.525.3063

COLUMBIA GAS OF OHIO
 3550 JOHNNY APPLESEED CT.
 COLUMBUS, OH 43231
 ATTN.: STEPHANIE THOMAS
 P. 614.818.2123

MCI (VERIZON BUSINESS)
 120 RAVINE ST.
 AKRON, OH 44303
 ATTN.: AL GUEST
 P. 330.253.8267

CITY OF COLUMBUS
 DEPARTMENT OF PUBLIC
 SERVICE - TRAFFIC MANAGEMENT
 1820 17TH AVE.
 COLUMBUS, OH 43219
 P. 614.645.7393

CITY OF COLUMBUS
 DIVISION OF WATER
 910 DUBLIN ROAD
 COLUMBUS, OH 43215
 P. 614.645.7787

CITY OF COLUMBUS
 DIVISION OF POWER
 3500 INDIANOLA AVE.
 COLUMBUS, OH 43214
 P. 614.645.7534
 P (24HR). 614.645.7627

ROUNDING

THE ROUNDING AT SLOPE BREAKPOINTS SHOWN ON THE TYPICAL SECTIONS APPLIES TO ALL CROSS-SECTIONS, EVEN THOUGH OTHERWISE SHOWN.

WORK LIMITS

THE WORK LIMITS SHOWN ON THESE PLANS ARE FOR PHYSICAL CONSTRUCTION ONLY. PROVIDE THE INSTALLATION AND OPERATION OF ALL WORK ZONE TRAFFIC CONTROL AND WORK ZONE TRAFFIC CONTROL DEVICES REQUIRED BY THESE PLANS WHETHER INSIDE OR OUTSIDE THESE WORK LIMITS.

REVIEW OF DRAINAGE FACILITIES

BEFORE ANY WORK IS STARTED ON THE PROJECT AND AGAIN BEFORE FINAL ACCEPTANCE BY THE STATE, REPRESENTATIVES OF THE STATE AND THE CONTRACTOR, ALONG WITH LOCAL REPRESENTATIVES, SHALL MAKE AN INSPECTION OF ALL EXISTING SEWERS WHICH ARE TO REMAIN IN SERVICE AND WHICH MAY BE AFFECTED BY THE WORK. THE CONDITION OF THE EXISTING CONDUITS AND THEIR APPURTENANCE SHALL BE DETERMINED FROM FIELD OBSERVATIONS. RECORDS OF THE INSPECTION SHALL BE KEPT IN WRITING BY THE STATE.

ALL NEW CONDUITS, INLETS, CATCH BASINS, AND MANHOLES CONSTRUCTED AS A PART OF THE PROJECT SHALL BE FREE OF ALL FOREIGN MATTER AND IN A CLEAN CONDITION BEFORE THE PROJECT WILL BE ACCEPTED BY THE STATE.

ALL EXISTING SEWERS INSPECTED INITIALLY BY THE ABOVE MENTIONED PARTIES SHALL BE MAINTAINED AND LEFT IN A CONDITION REASONABLY COMPARABLE TO THAT DETERMINED BY THE ORIGINAL INSPECTION. ANY CHANGE IN THE CONDITION RESULTING FROM THE CONTRACTOR'S OPERATIONS SHALL BE CORRECTED BY THE CONTRACTOR TO THE SATISFACTION OF THE ENGINEER.

PAYMENT FOR ALL OPERATIONS DESCRIBED ABOVE SHALL BE INCLUDED IN THE CONTRACT PRICE FOR THE PERTINENT 611 CONDUIT ITEMS.

MANHOLES, CATCH BASINS AND INLETS REMOVED OR ABANDONED

ALL CASTINGS SHALL BE CAREFULLY REMOVED AND STORED WITHIN THE RIGHT OF WAY FOR SALVAGE BY CITY OR STATE FORCES.

PAYMENT FOR ALL OF THE ABOVE SHALL BE INCLUDED IN THE CONTRACT PRICE FOR THE PERTINENT 202 ITEM.

CONTRACTOR'S USE OF ODOT RIGHT-OF-WAY

THE CONTRACTOR SHALL NOT BORROW FROM A SITE KNOWN, OR SUSPECTED OF HAVING, CONTAMINATED SOIL OR WATER.

SURVEYING PARAMETERS

PRIMARY PROJECT CONTROL MONUMENTS GOVERN ALL POSITIONING ON ODOT PROJECTS. SEE SHEET 2 OF THE PLANS FOR A TABLE CONTAINING PROJECT CONTROL INFORMATION.

USE THE FOLLOWING PROJECT CONTROL, VERTICAL POSITIONING, AND HORIZONTAL POSITIONING PARAMETERS FOR ALL SURVEYING:

PROJECT CONTROL

POSITIONING METHOD: ODOT VRS
 MONUMENT TYPE: TYPE B

VERTICAL POSITIONING

ORTHOMETRIC HEIGHT DATUM: NAVD 88
 GEOID: 12A

HORIZONTAL POSITIONING

REFERENCE FRAME: NAD83 (2011)
 ELLIPSOID: GRS-80
 MAP PROJECTION: LAMBERT CONFORMAL CONIC
 COORDINATE SYSTEM: OHIO STATE PLAN SOUTH ZONE
 COMBINED SCALE FACTOR: 0.9999631481
 ORIGIN OF COORDINATE SYSTEM: 0,0,0

SCALE FACTOR IN DRAWINGS: 1.00003685325

USE THE POSITIONING METHODS AND MONUMENT TYPE USED IN THE ORIGINAL SURVEY TO RESTORE ALL MONUMENTS RELATED TO PRIMARY PROJECT CONTROL THAT ARE DAMAGED OR DESTROYED BY CONSTRUCTION ACTIVITIES. RESTORE THE DAMAGED OR DESTROYED MONUMENTS IN ACCORDANCE WITH CMS 623.

UNITS ARE IN U.S. SURVEY FEET. USE THE FOLLOWING CONVERSION FACTOR: 1 METER = 3.280833333 U.S. SURVEY FEET.

HORIZONTAL POSITIONING

THE HORIZONTAL COORDINATES EXPRESSED HEREIN ARE BASED ON THE OHIO STATE PLANE COORDINATE SYSTEM, SOUTH ZONE ON NAD83 (CORS2011) DATUM BY GPS OBSERVATIONS TO THE ODOT CORS NETWORK.

ITEM 304 - AGGREGATE BASE, AS PER PLAN

TO PROVIDE POSITIVE SUBSURFACE DRAINAGE WITHIN THE AREAS DEPICTED IN THE ENGINEERING PLANS OF THE WIDENED, FULL-DEPTH PAVEMENT AREA, THE THICKNESS OF THE AGGREGATE BASE MAY BE VARIABLE THICKNESS, DEPENDENT ON THE EXISTING PAVEMENT BUILDUP. FOR QUANTITY CALCULATION PURPOSES, THE ENGINEERING PLANS HAVE UTILIZED A UNIFORM THICKNESS OF 6 INCHES.

ALL MATERIAL SPECIFICATIONS AND INSTALLATION METHODS SHALL CONFORM TO ITEM 304 OF THE C&MS.

ITEM 611 - CATCH BASIN, NO. 6, AS PER PLAN

IN ADDITION TO THE MATERIAL SPECIFICATIONS AND INSTALLATION METHODS PER THE PERTINENT ITEM 611 OF THE C&MS, THE CONTRACTOR SHALL INSTALL A HEAVY DUTY, TRAFFIC AND BICYCLE SAFE GRATE AND FRAME.

THE CONTRACTOR SHALL HAVE THE FRAME AND GRATE APPROVED BY THE ODOT PROJECT ENGINEER PRIOR TO ORDERING AND INSTALLATION DURING CONSTRUCTION.

FRANKLIN COUNTY PERMIT

THE CONTRACTOR SHALL CONTACT UTILITIES COORDINATOR AT (614) 525-3063 TO SECURE A WRITTEN PERMIT FROM THE FRANKLIN COUNTY ENGINEER'S OFFICE, 970 DUBLIN RD, A MINIMUM OF TWO WORKING DAYS PRIOR TO BEGINNING WORK WITHIN FRANKLIN COUNTY R/W. THE CONTRACTOR MAY BE REQUIRED TO POST A BOND WITH THE FRANKLIN COUNTY ENGINEER PRIOR TO ISSUANCE OF THE PERMIT TO INSURE PROPER RESTORATION OF THE PAVEMENT AND R/W. THE CONTRACTOR SHALL PROVIDE THE FRANKLIN COUNTY ENGINEER'S OFFICE A 24-HOUR TELEPHONE NUMBER TO BE USED IN CASE OF AN EMERGENCY.

DESIGN AGENCY



DESIGNER
 JDC

REVIEWER
 RJM 12-17-21

PROJECT ID
 110799

SHEET	TOTAL
4	23

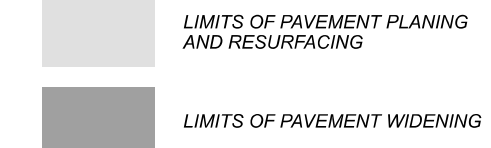
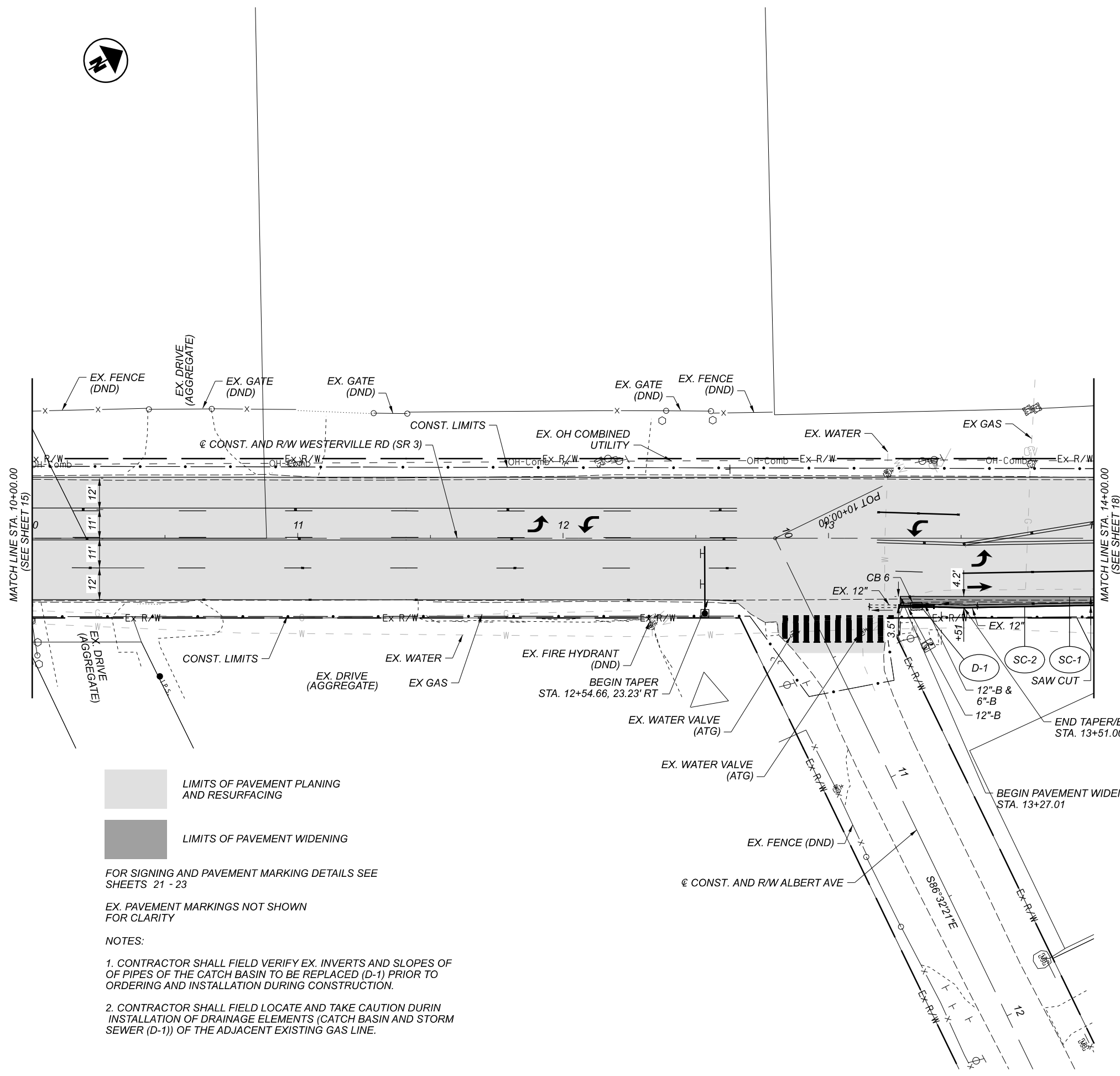

FOR SIGNING AND PAVEMENT MARKING DETAILS SEE SHEETS 21 - 23

EX. PAVEMENT MARKINGS NOT SHOWN FOR CLARITY

NOTES:

- CONTRACTOR SHALL FIELD VERIFY EX. INVERTS AND SLOPES OF OF PIPES OF THE CATCH BASIN TO BE REPLACED (D-1) PRIOR TO ORDERING AND INSTALLATION DURING CONSTRUCTION.
- CONTRACTOR SHALL FIELD LOCATE AND TAKE CAUTION DURIN INSTALLATION OF DRAINAGE ELEMENTS (CATCH BASIN AND STORM SEWER (D-1)) OF THE ADJACENT EXISTING GAS LINE.

D-1 CATCH BASIN, NO. 6, APP STA. 13+33.15, 26.34' RT.
 E GRATE 868.62
 E 6" (N) 865.84 ±
 E 12" (N) 861.62 ±
 E 12" (S) 861.62 ±

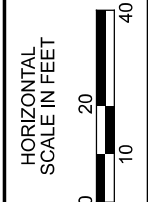

PLAN - WESTERVILLE ROAD (SR 3)
 STA. 10+00.00 TO STA. 14+00.00

DESIGN AGENCY



DESIGNER
 JDC

REVIEWER
 RJM 12-17-21

PROJECT ID
 110799

SHEET	TOTAL
16	23