

STATE OF OHIO
DEPARTMENT OF TRANSPORTATION

FRA-LANDSCAPE MAINTENANCE-FY21

MAINTENANCE PROJECT TO INCLUDE LANDSCAPE MAINTENANCE,
LITTER PICKUP, INTERCHANGE MOWING AND FENCE LINE MOWING
AT SPECIFIC LOCATIONS WITHIN FRANKLIN COUNTY.

GENERAL CLEAN UP TO INCLUDE TREE AND BRUSH REMOVAL
AT LOCATIONS THROUGHOUT FRANKLIN COUNTY

CONSTRUCTION PROJECT NO:
PID NO: 111514
FEDERAL PROJECT NO: NON-FEDERAL

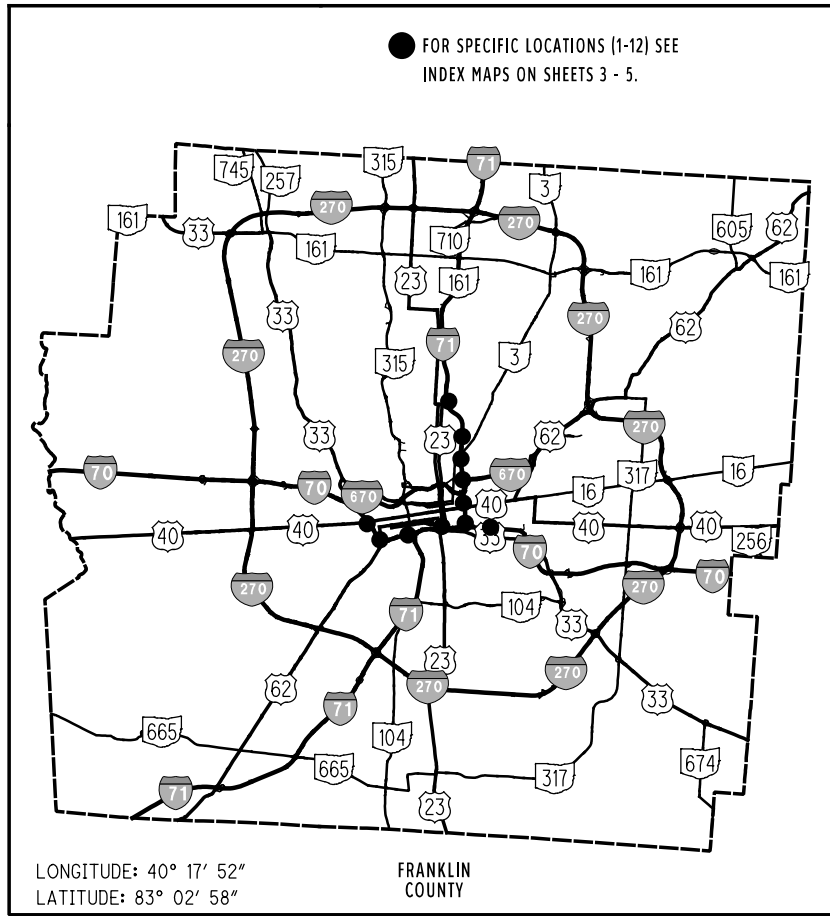

INDEX OF SHEETS	
TITLE	1
GENERAL NOTES	2 - 5, 2A, 2B, 2C, 2D
MAINTENANCE OF TRAFFIC NOTES	6 - 7
GENERAL SUMMARY	8
SUBSUMMARY	9
HERBICIDAL SPRAYING SUBSUMMARY	8A
MAINTENANCE PLAN	10 - 22, 22A
NOT USED	17, 23
EARTH DISTURBED AREA	
PROJECT EARTH DISTURBED AREA:	N/A*
EST. CONTRACTOR EARTH DISTURBED AREA:	N/A*
NOTICE OF INTENT DISTURBED AREA:	N/A*
RAILROAD INVOLVEMENT:	NONE

LIMITED ACCESS
THIS IMPROVEMENT IS ESPECIALLY DESIGNED FOR
THROUGH TRAFFIC AND HAS BEEN DECLARED A
LIMITED ACCESS HIGHWAY OR FREEWAY BY ACTION
OF THE DIRECTOR IN ACCORDANCE WITH THE
PROVISIONS OF SECTION 5511.02 OF THE OHIO
REVISED CODE.

2019 SPECIFICATIONS
THE STANDARD SPECIFICATIONS OF THE STATE OF OHIO,
DEPARTMENT OF TRANSPORTATION, INCLUDING CHANGES
AND SUPPLEMENTAL SPECIFICATIONS LISTED IN THE
PROPOSAL SHALL GOVERN THIS PROJECT.

*MAINTENANCE PROJECT

UNDERGROUND UTILITIES
CONTACT BOTH SERVICES TWO WORKING DAYS
BEFORE YOU DIG.

Call Before You Dig
1-800-362-2764
(Non-members must be called directly)

OIL & GAS PRODUCERS
UNDERGROUND PROTECTION SERVICE
1-800-925-0988

ENGINEERS SEAL:

SIGNED: *[Signature]*
DATE: 11/25/20

STANDARD CONSTRUCTION DRAWINGS		SUPPLEMENTAL SPECIFICATIONS	
MT-95.30	07/19/19	800	01/15/21
MT-95.31	07/19/19	821	04/20/12
MT-95.32	04/19/19	832	10/19/18
MT-97.10	04/19/19	921	04/20/12
LA-1.1	10/15/10		
LA-1.2	01/16/09		
		SPECIAL PROVISIONS	

I HEREBY APPROVE THESE PLANS AND DECLARE THAT
THE MAKING OF THIS IMPROVEMENT WILL NOT REQUIRE
THE CLOSING TO TRAFFIC OF THE HIGHWAY AND THAT
PROVISIONS FOR THE MAINTENANCE OF TRAFFIC AND
SAFETY WILL BE AS SET FORTH ON PLANS AND ESTIMATES.

APPROVED *[Signature]*
DISTRICT DEPUTY DIRECTOR

DATE 11/27/2020

APPROVED _____
DIRECTOR, DEPARTMENT OF TRANSPORTATION

DATE _____



I:\ProjectData\111514_FRA-LNDSCP-MNT\Design\Roadway\Sheets\PLAN SHEETS.dgn LETTER_GT101 2/16/2021 9:23:48 AM rmcneill

ITEM SPECIAL - MISC.: INTERCHANGE MOWING:
 THIS WORK SHALL CONSIST OF CONTROLLING VEGETATIVE GROWTH WITHIN THE INTERCHANGE RIGHT-OF-WAY BY MULTIPLE MOWINGS WITH THESE SPECIFICATIONS AT LOCATIONS SHOWN ON THE PLANS.
 THE INTENT OF THIS ITEM IS TO PROVIDE A NEAT AND REGULARLY GROOMED INTERCHANGE (FENCE TO FENCE). IDEALLY, GRASS SHALL BE CUT TO A 3" HEIGHT AND NEVER EXCEED GROWTH OF 6" THROUGHOUT THE SEASON. IN ADDITION TO THE GRASS REQUIREMENT, IT MAY BE NECESSARY FOR THE CONTRACTOR TO MOW ROUGHER VEGETATION ON THE BACKSIDE OF DITCH AS DIRECTED. THIS MAY INCLUDE SMALL SAPPLINGS SMALLER THAN 1/2" DIAMETER AS DIRECTED. ANY GROWTH DEEMED UNDESIRABLE BY THE ENGINEER THAT EXCEEDS 1/2" DIAMETER OR A SLOPE STEEPER THAN 3:1 SHALL BE INITIALLY REMOVED AS PER ITEM 656 - ROADSIDE CLEANUP.
 CUTTING BLADES SHALL BE KEPT SHARP AT ALL TIMES AND EQUIPMENT PROPERLY MAINTAINED TO PRODUCE CLEAN CUTS ON ALL VEGETATION. AREAS TO BE MOWED SHALL BE SUFFICIENTLY DRY SO AS NOT TO CAUSE RUTTING OR OTHER DAMAGE AS DIRECTED BY THE ENGINEER.

ALL MOWING ALONG PAVEMENT EDGE INCLUDING FRONT OF GUARDRAIL SHALL BE PERFORMED WITH THE EQUIPMENT MOVING IN THE DIRECTION OF TRAFFIC FLOW. MOWING THESE INTERCHANGES SHALL INCLUDE ANY POWER HAND TRIMMING AROUND ITEMS SUCH AS ALL SIGN POSTS, GUARDRAIL, DELINEATOR POSTS, LIGHT POLE FOUNDATIONS, RIGHT-OF-WAY FENCING, ETC AS DIRECTED. ANY TRIMMING WORK SHALL BE DONE SIMULTANEOUSLY CLOSELY FOLLOWING THE TRACTOR MOWING AND SHALL NOT LAG BEHIND THE TRACTOR MOWING BY MORE THAN TWO (2) WORKING DAYS.
 AN ESTIMATE OF 10 MOWINGS HAVE BEEN PROVIDED AT EACH INTERCHANGE TO MEET THIS REQUIREMENT BUT MAY BE ADJUSTED BY THE ENGINEER IF UNFORESEEN WEATHER CONDITIONS AFFECT GROWTH.
 NO PARTIAL PAYMENT SHALL BE MADE FOR AREAS WHICH HAVE BEEN MOWED BUT NOT TRIMMED TO THE SATISFACTION OF THE ENGINEER. PAYMENT WILL BE MADE FOR THE QUANTITY OF ACRES PROVIDED ON PLAN SHEETS 10-32.

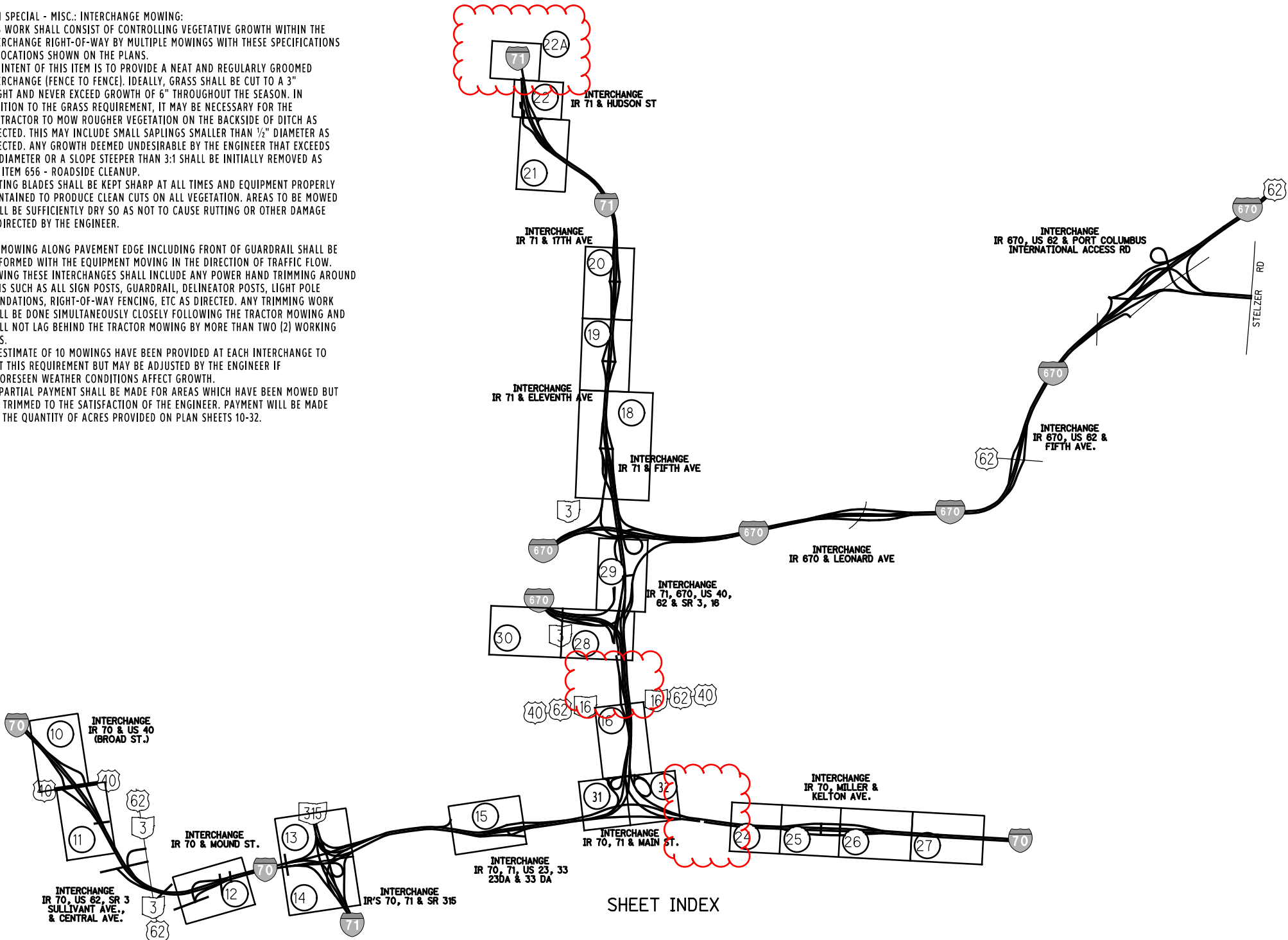

SHEET INDEX

**GENERAL NOTES
MOW**

SHEET NUMBER				01/NFP/OT	ITEM	ITEM EXT	GRAND TOTAL	UNIT	DESCRIPTION	SEE SHEET NO.
	2-7	9	9A							
									ROADWAY	
				LUMP	201	11001	LUMP		CLEARING AND GRUBBING, AS PER PLAN	2
		526.5		526.5	653	10000	526.5	CY	TOPSOIL FURNISHED AND PLACED	
	3			3	654	11000	3	TONS	COMMERCIAL FERTILIZER	
	162			162	656	10001	162	M SQ FT	ROADSIDE CLEANUP, AS PER PLAN	2
	24,450			24,450	659	10000	24,450	SY	SEEDING AND MULCHING	
	2,445			2,445	659	15000	2,445	SY	INTER-SEEDING	
	100			100	659	35000	100	MGAL	WATER	
	3,200			3,200	SPECIAL	69098600	3,200	HOUR	MISC.:LITTER PICKUP	3
	1,314.30			1,314.30	SPECIAL	69099000	1,314.30	ACRE	MISC.:INTERCHANGE MOWING	5
									EROSION CONTROL	
				18953	671	14000	18953	SQ YD	EROSION CONTROL MAT	
				7,500	838	30000	7,500	EACH	EROSION CONTROL	
									LANDSCAPING	
		675		675	661	00501	675	CU YD	MULCH, AS PER PLAN	2
	1,000			1,000	SPECIAL	69098000	1,000	EACH	MISC.: PRUNING EXISTING SHRUB, 30" SPREAD	4
		5		5	SPECIAL	69099550	5	MONTH	MISC.: LANDSCAPING MAINTENANCE	4
			4.82	4.82	SPECIAL	69110000	4.82	ACRE	HERBICIDAL SPRAYING, WEED AND BRUSH CONTROL FROM ROAD	2A
									MAINTENANCE OF TRAFFIC	
	24			24	614	11110	24	HR	LAW ENFORCEMENT OFFICER WITH PATROL CAR FOR ASSISTANCE	7
									INCIDENTALS	
				LUMP	614	11000	LUMP		MAINTAINING TRAFFIC	
				LUMP	624	10000	LUMP		MOBILIZATION	

S H E E T	L O C	C O U N T Y	R O U T E	659	SPECIAL		661	SPECIAL	671
				TOPSOIL	MISC.: INTERCHANGE MOWING		MULCH, AS PER PLAN	MISC.: LANDSCAPING MAINTENANCE	EROSION CONTROL MAT
				CY	ACRE		CU YD	MONTH	SQ YD
10	1	FRA	IR-70		80.70				
11	1	FRA	IR-70		115.50				
12	2	FRA	IR-70	153.40	57.60				5522
13	3	FRA	IR-70 & IR-71		94.80				
14	3	FRA	IR-70 & IR-71		125.60				
15	4	FRA	IR-70 & IR-71		53.10				
16	5	FRA	IR-71		68.40		101	0.150	
18	6	FRA	IR-71	258.2	145.50				9294
19	7	FRA	IR-71		61.90		346	2.565	
20	8	FRA	IR-71		63.10		169	1.245	
21	9	FRA	IR-71	114.9	60.20				4137
22	9	FRA	IR-71		26.30				
22A	9	FRA	IR-71		12.80				
24	10	FRA	IR-70		24.90				
25	10	FRA	IR-70		25.50				
26	10	FRA	IR-70		31.40				
27	10	FRA	IR-70		12.90				
28	11	FRA	IR-670 & IR-71		83.60		52	0.385	
29	11	FRA	IR-670 & IR-71		39.10		7	0.055	
30	11	FRA	IR-670 & IR-71		13.50				
31	12	FRA	INTERCHANGE IR-71		58.70				
32	12	FRA	INTERCHANGE IR-71		65.20				
TOTALS CARRIED TO GENERAL SUMMARY				526.5	1,314.30		675	5.00	18953

SUBSUMMARY



LEGEND

- AREA TO BE MAINTAINED
- VEGETATION CLUSTER (TREES, BUSHES, ETC.)

MARK	LOCATION		ROADWAY		SPECIAL		EROSION CONTROL MAT		
	AREA		201	659	MISC.: INTERCHANGE MOWING				
	SQ FT	ACRE	CLEARING AND GRUBBING	TOPSOIL	# TIMES	ACRE		SY	
2A		1.25			10	12.50			
2B		1.51	27.45	84.7	10	15.10		3050	
2C		0.68	22.25	68.7	10	6.80		2472	
2D		0.97			10	9.70			
2E		1.09			10	10.90			
2F		0.06			10	0.60			
2G		0.07			10	0.70			
2H		0.05			10	0.50			
2I		0.08			10	0.80			
TOTALS CARRIED TO SUBSUMMARY					153.40		57.60		5522

MAINTENANCE PLAN
INTERCHANGE IR-70 & W. MOUND ST.

LOCATION		201		659		SPECIAL	
MARK	AREA	CLEARING AND GRUBBING		TOPSOIL		MISC.: INTERCHANGE MOWING	
		MSF		CY		# TIMES	ACRE
	SQ FT	ACRE					
5A		1.18				10	11.80
5B		0.22				10	2.20
5C		0.83				10	8.30
5D		1.77				10	17.70
5E		1.22				10	12.20
5F		1.02				10	10.20
TOTALS CARRIED TO SUBSUMMARY							62.40

LOCATION		ROADWAY		LANDSCAPING	
MARK	AREA			661	SPECIAL
				MULCH, AS PER PLAN (2" DEPTH)	MISC.: LANDSCAPING MAINTENANCE
	SQ FT	ACRE		CU YD	MONTH
L1	1,187			7	0.055
L2	3,612			22	0.165
L3	3,379			21	0.155
L4	3,161			20	0.145
L5	2,288			14	0.105
L6	2,714			17	0.125
TOTALS CARRIED TO SUBSUMMARY				101	0.750

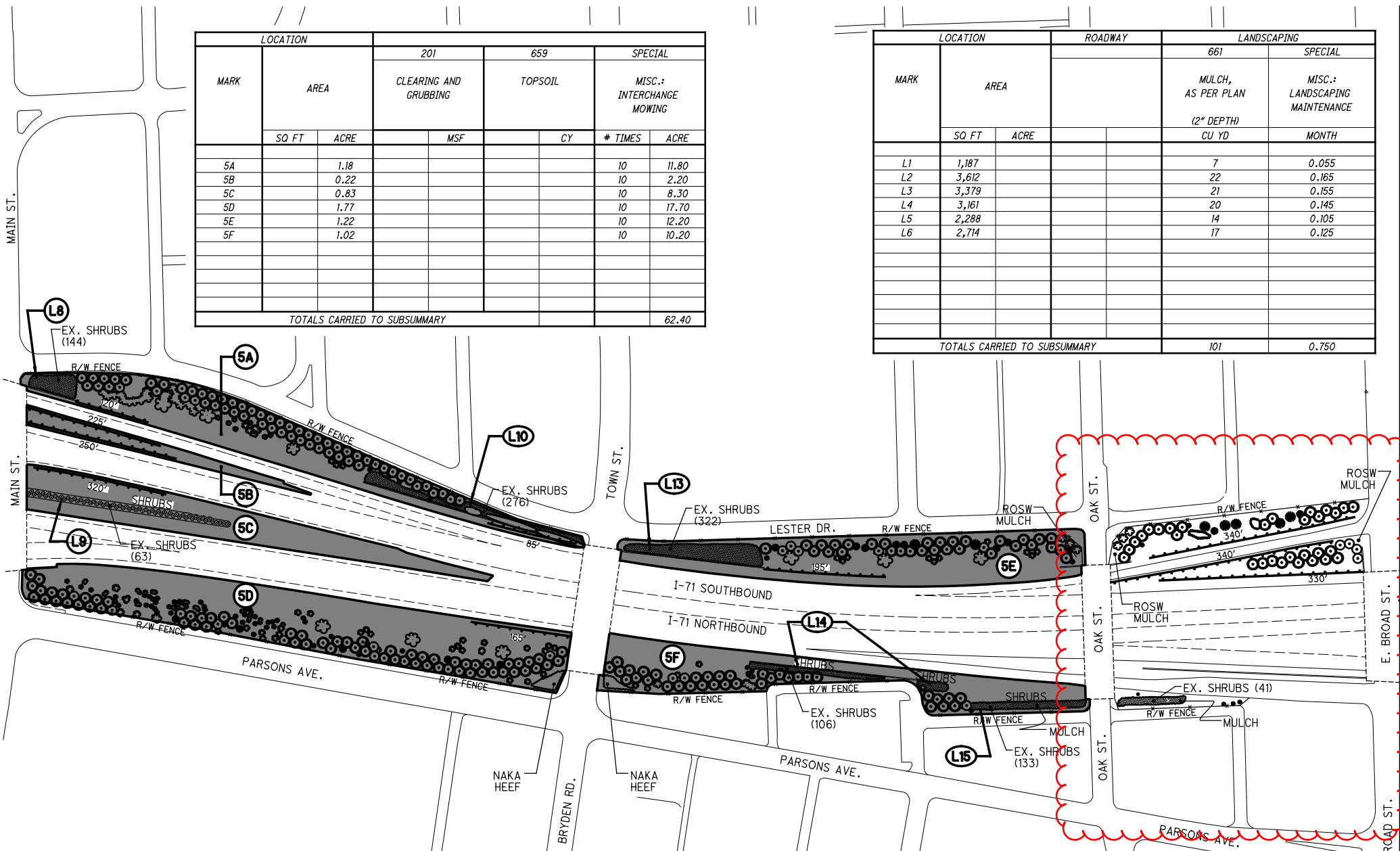

LEGEND	
	AREA TO BE MAINTAINED
	VEGETATION CLUSTER (TREES, BUSHES, ETC.)

EXISTING PLANT LEGEND		
ABBREV	BOTANICAL	COMMON
ROSW	ROSA WICHRIANA	MEMORIAL ROSE
NAKA	NARCISSUS "KING ALFRED"	KING ALFRED DAFFODIL
HEEF	HERMEROCALLIS	EENIE FANFARE DAYLILIES

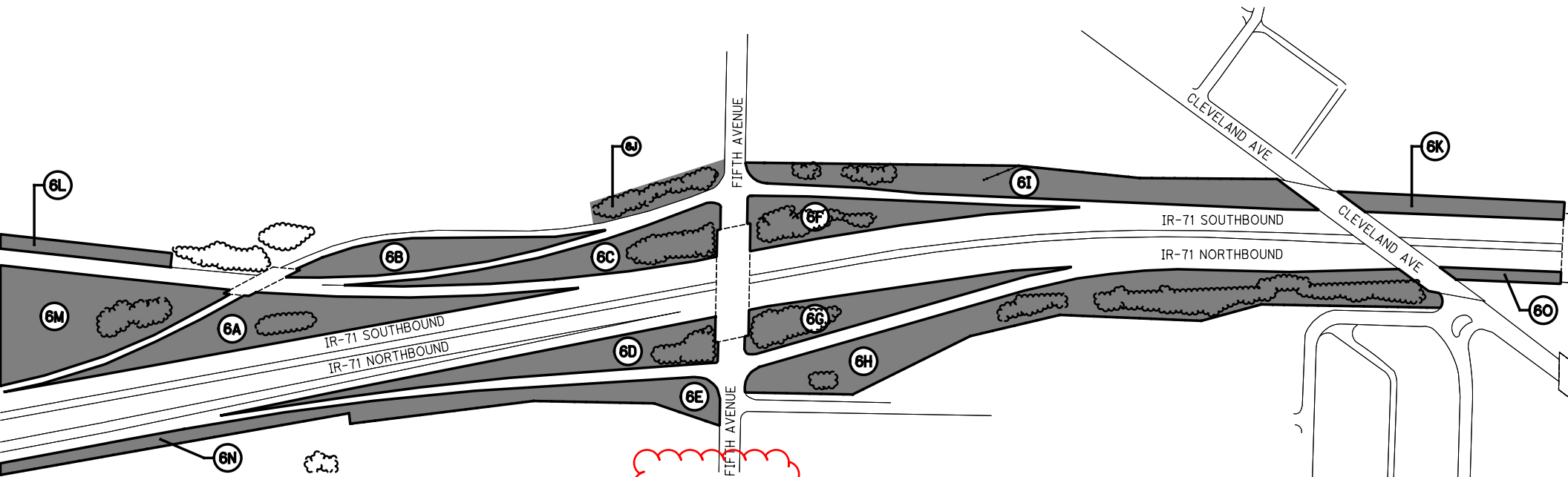

MARK	LOCATION		ROADWAY		SPECIAL		671	
	AREA		201	659	MISC.: INTERCHANGE MOWING		EROSION CONTROL MAT	
	SQ FT	ACRE	CLEARING AND GRUBBING	TOPSOIL	# TIMES	ACRE	SQ YD	
6A		1.28		32.6	10	12.80		1172
6B		0.68	10.55		10	6.80		
6C		0.93			10	9.30		
6D		0.98			10	9.80		
6E		0.80			10	8.00		
6F		0.82			10	8.20		
6G		0.80			10	8.00		
6H		2.70	73.10	225.6	10	27.00		8122
6I		1.51			10	15.10		
6J		0.35			10	3.50		
6K		0.40			10	4.00		
6L		0.25			10	2.50		
6M		1.63			10	16.30		
6N		1.28			10	12.80		
6O		0.14			10	1.40		
TOTALS CARRIED TO SUBSUMMARY				258.2		145.50		9294

LEGEND

- AREA TO BE MAINTAINED
- VEGETATION CLUSTER (TREES, BUSHES, ETC.)

LOCATION		ROADWAY		SPECIAL		SPECIAL	
MARK	AREA	201	659	MISC.: INTERCHANGE MOWING		EROSION CONTROL MAT	
		CLEARING AND GRUBBING	TOPSOIL	# TIMES	ACRE	SQ YD	
	SQ FT	ACRE	MSF	CY			
9A		1.15			10	11.50	
9B		2.52			10	25.20	
9C		1.08	37.23	114.9	10	10.80	4137
9D		1.21			10	12.10	
9E		0.06			10	0.60	
TOTALS CARRIED TO SUBSUMMARY				114.9		60.20	4137

LEGEND

- AREA TO BE MAINTAINED
- VEGETATION CLUSTER (TREES, BUSHES, ETC.)

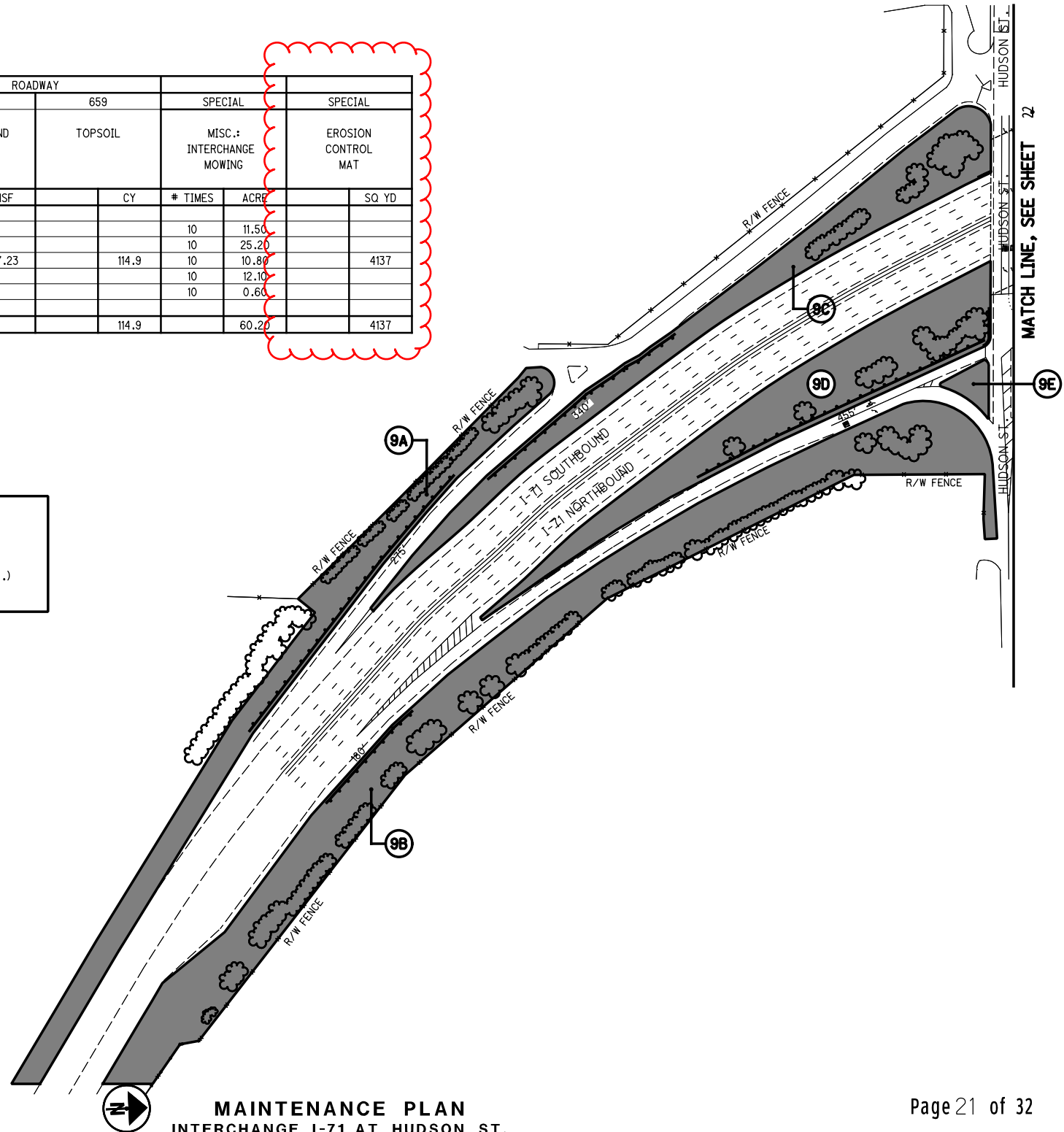



MATCH LINE, SEE SHEET 22

MAINTENANCE PLAN
INTERCHANGE I-71 AT HUDSON ST.

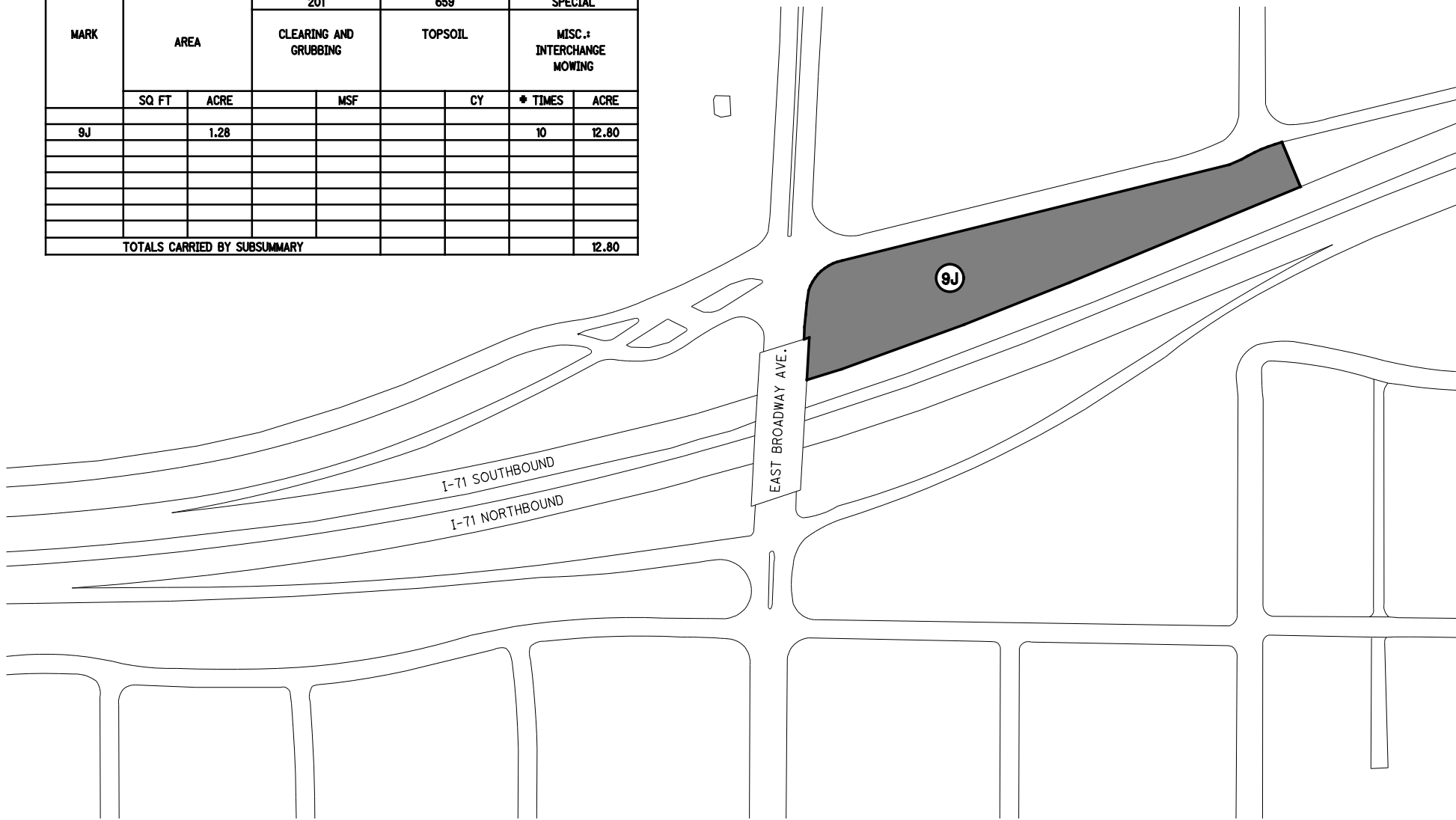
MARK	LOCATION		ROADWAY				SPECIAL	
	AREA		201		659		MISC. + INTERCHANGE MOWING	
	SQ FT	ACRE	CLEARING AND GRUBBING	MSF	TOPSOIL	CY	* TIMES	ACRE
9J		1.28					10	12.80
TOTALS CARRIED BY SUBSUMMARY								12.80



LEGEND

-  AREA TO BE MAINTAINED
-  VEGETATION CLUSTER (TREES, BUSHES, ETC.)

