

G:\ProjectData\2021\FRA\4985_FRA-315-4.15\Design\Roadway\Sheets\4985_GG001.dgn 3/7/2022 10:06:40 AM kevinj

SHEET NUM.										PART.	ITEM	ITEM	GRAND	UNIT	DESCRIPTION	SEE SHEET NO.	
					9	11			14	01/NFA/BR		EXT	TOTAL				
ROADWAY																	
									LUMP	LUMP	202	11203	LS			PORTIONS OF STRUCTURE REMOVED, OVER 20 FOOT SPAN, AS PER PLAN	14
						39				39	202	22900	39	SY		APPROACH SLAB REMOVED	
EROSION CONTROL																	
										1,500	832	30000	1,500	EACH	EROSION CONTROL		
TRAFFIC CONTROL																	
					82					82	621	00100	82	EACH	RPM		
					82					82	621	54000	82	EACH	RAISED PAVEMENT MARKER REMOVED		
					0.56					0.56	644	00104	0.56	MILE	EDGE LINE, 6"		
					1					1	644	00204	1	MILE	LANE LINE, 6"		
					1,240					1,240	644	00404	1,240	FT	CHANNELIZING LINE, 12"		
					0.03					0.03	646	10010	0.03	MILE	EDGE LINE, 6"		
					0.04					0.04	646	10110	0.04	MILE	LANE LINE, 6"		
LIGHTING																	
						2				2	625	00451	2	EACH	CONNECTION, FUSED PULL APART, AS PER PLAN	11	
						2				2	625	00461	2	EACH	CONNECTION, UNFUSED PULL APART, AS PER PLAN	11	
						2				2	625	00480	2	EACH	CONNECTION, UNFUSED PERMANENT		
						1				1	625	10503	1	EACH	LIGHT POLE (INSTALLATION ONLY), AS PER PLAN	11	
						4				4	625	10614	4	EACH	LIGHT POLE ANCHOR BOLTS ON STRUCTURE		
						818				818	625	23200	818	FT	NO. 4 AWG 2400 VOLT DISTRIBUTION CABLE		
						182				182	625	25910	182	FT	CONDUIT CLEANED AND CABLES REMOVED		
						2				2	625	27561	2	EACH	LUMINAIRE, INSTALLATION ONLY, AS PER PLAN	11	
						1				1	625	29930	1	EACH	MEDIAN JUNCTION BOX		
						1				1	SPECIAL	62540010	1	EACH	REPLACEMENT OF EXISTING LIGHTING UNIT	11	
						1				1	625	75410	1	EACH	LIGHT POLE REMOVED FOR REUSE		
						2				2	625	75508	2	EACH	LUMINAIRE REMOVED FOR REUSE		
						2				2	625	75800	2	EACH	DISCONNECT CIRCUIT		
STRUCTURE REPAIR (SFN: 2515512)																	
									25,881	25,881	509	10000	25,881	LB	EPOXY COATED REINFORCING STEEL		
									259	259	509	20001	259	LB	REINFORCING STEEL, REPLACEMENT OF EXISTING REINFORCING STEEL, AS PER PLAN	14	
									2,176	2,176	509	30030	2,176	FT	NO. 5 GFRP DEFORMED BARS		
									66	66	511	34447	66	CY	CLASS QC2 CONCRETE WITH QC/QA, BRIDGE DECK, AS PER PLAN	14	
									70	70	511	34448	70	CY	CLASS QC2 CONCRETE, BRIDGE DECK (PARAPET)		
									253	253	512	10100	253	SY	SEALING OF CONCRETE SURFACES (EPOXY-URETHANE)		
									19	19	516	13600	19	SF	1" PREFORMED EXPANSION JOINT FILLER		
									19	19	516	13900	19	SF	2" PREFORMED EXPANSION JOINT FILLER		
									10	10	518	12300	10	EACH	SCUPPERS, INCLUDING SUPPORTS		
									39	39	526	25000	39	SY	REINFORCED CONCRETE APPROACH SLABS (T=15")		
									70	70	847	50000	70	SY	HAND CHIPPING		

GENERAL SUMMARY

FRA - 315 - 4.15

CALCULATED
JAS
CHECKED
BBB

G:\ProjectData\2021\FRA\4985_FRA-315-4.15\Design\Traffic\Sheets\4985_IP001.dgn 3/7/2022 10:07:30 AM kevinj

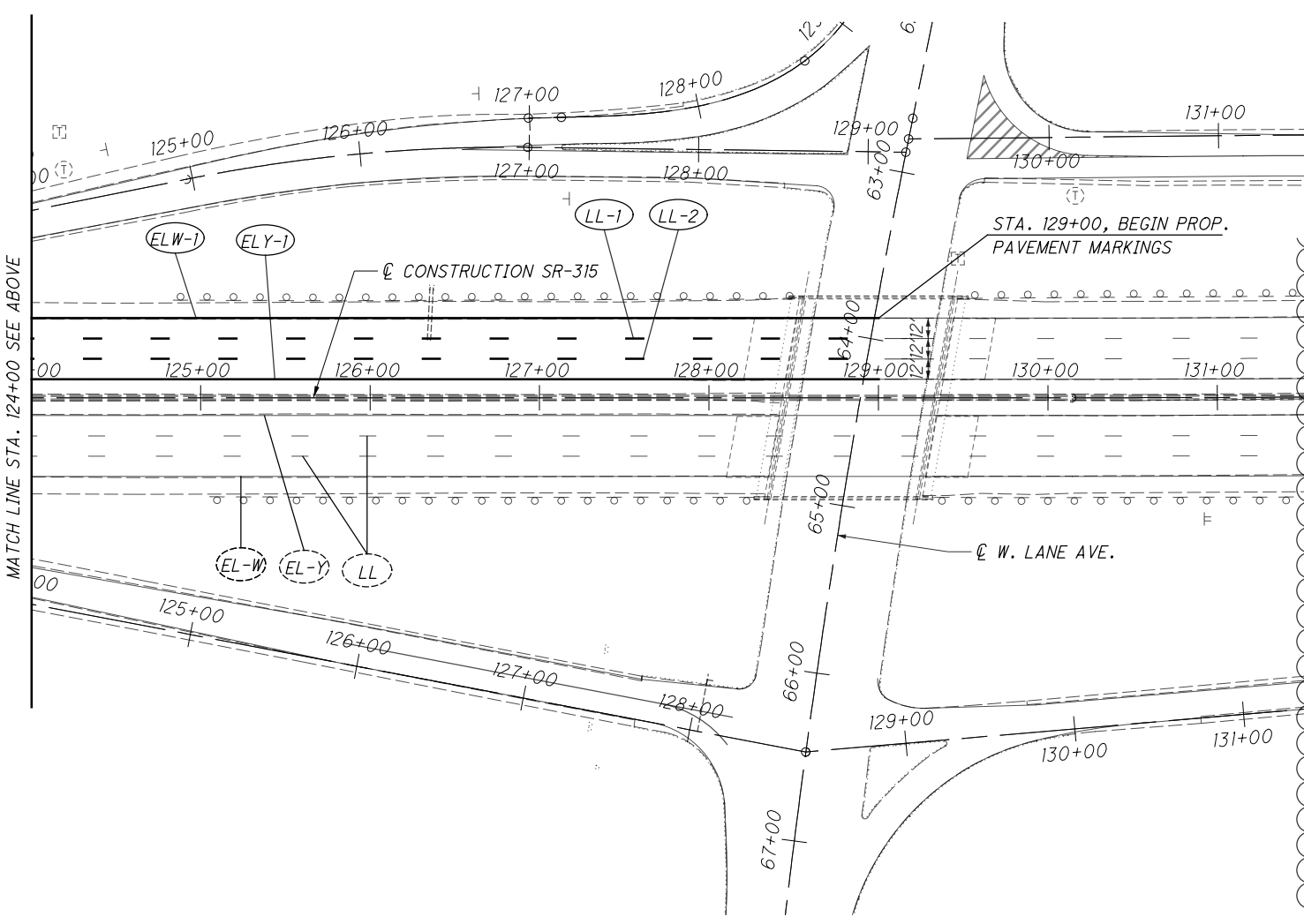
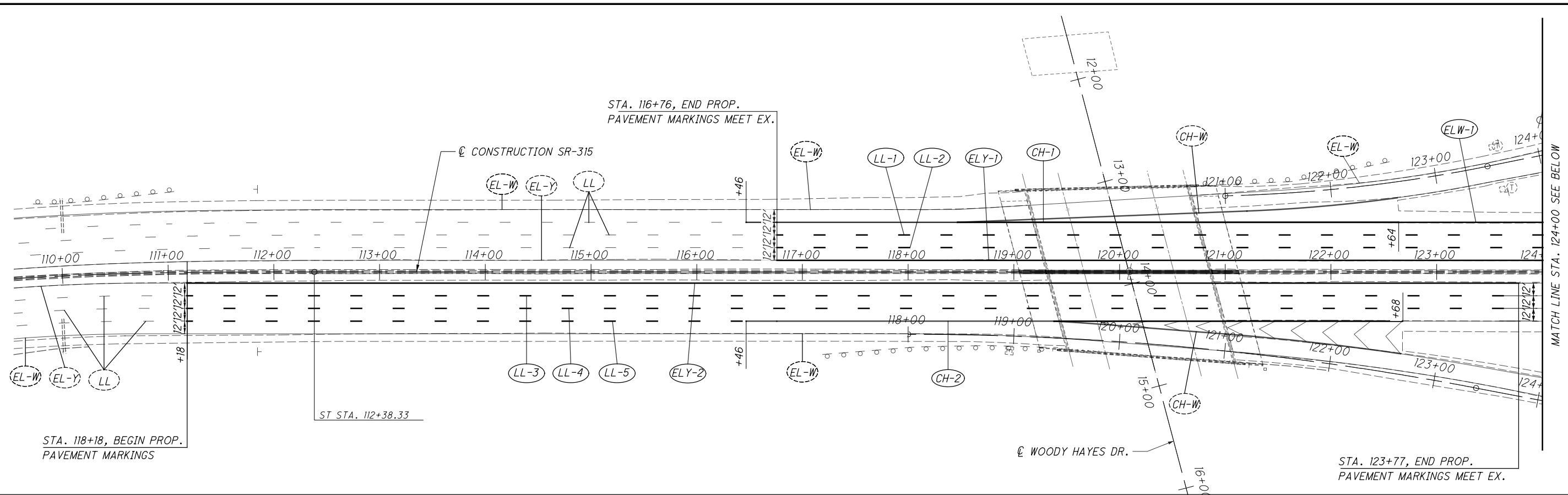

PAVEMENT MARKING LEGEND

- (ELW-X) ITEM 644 - EDGE LINE, 6", WHITE
- (ELY-X) ITEM 644 - EDGE LINE, 6", YELLOW
- (LL-X) ITEM 644 - LANE LINE, 6"
- (CH-X) ITEM 644 - CHANNELIZING LINE, 12"
- (EL-W) EXISTING EDGE LINE WHITE
- (EL-Y) EXISTING EDGE LINE YELLOW
- (LL) EXISTING LANE LINE
- (CH) EXISTING CHANNELIZING LINE

REFERENCE NO.	LOCATION	STATION		SIDE	RPM	RAISED PAVEMENT MARKER REMOVED	EDGE LINE, 6" (WHITE)		EDGE LINE, 6" (YELLOW)		LANE LINE, 6"		CHANNELIZING LINE, 12"		EDGE LINE, 6" (WHITE)		EDGE LINE, 6" (YELLOW)		LANE LINE, 6"			
		FROM	TO				EACH	EACH	MILE	MILE	MILE	FT	MILE	MILE	MILE	MILE	MILE	MILE	MILE	MILE	MILE	
CH-1	SR-315	116+46.00	122+64.00	LT.	4	4							618									
CH-2	SR-315	116+46.00	122+68.00	RT.	7	7							622									
ELW-1	SR-315	122+64.00	129+00.00	LT.			0.11									0.01						
ELY-1	SR-315	116+76.00	129+00.00	LT.				0.21											0.02			
ELY-2	SR-315	111+18.00	123+77.00	RT.				0.24														
LL-1	SR-315	116+76.00	129+00.00	LT.	16	16					0.21										0.02	
LL-2	SR-315	116+76.00	129+00.00	LT.	16	16					0.21										0.02	
LL-3	SR-315	111+18.00	123+77.00	RT.	16	16					0.24											
LL-4	SR-315	111+18.00	123+77.00	RT.	16	16					0.24											
LL-5	SR-315	111+18.00	116+46.00	RT.	7	7					0.10											
SUB-TOTAL								0.11	0.45							0.01	0.02					
TOTALS CARRIED TO SUB-SUMMARY					82	82		0.56	1.00	1,240				0.03	0.04							

25
50
100
HORIZONTAL
SCALE IN FEET

CALCULATED JAS
CHECKED BBB

TRAFFIC CONTROL PLAN
STA. 110+00 TO STA. 131+50

FRA-315-4.15

10
21