

# STATE OF OHIO DEPARTMENT OF TRANSPORTATION

## FRA-161-15.80 NOISE ABATEMENT

CITY OF COLUMBUS AND NEW ALBANY  
PLAIN TOWNSHIP  
FRANKLIN COUNTY

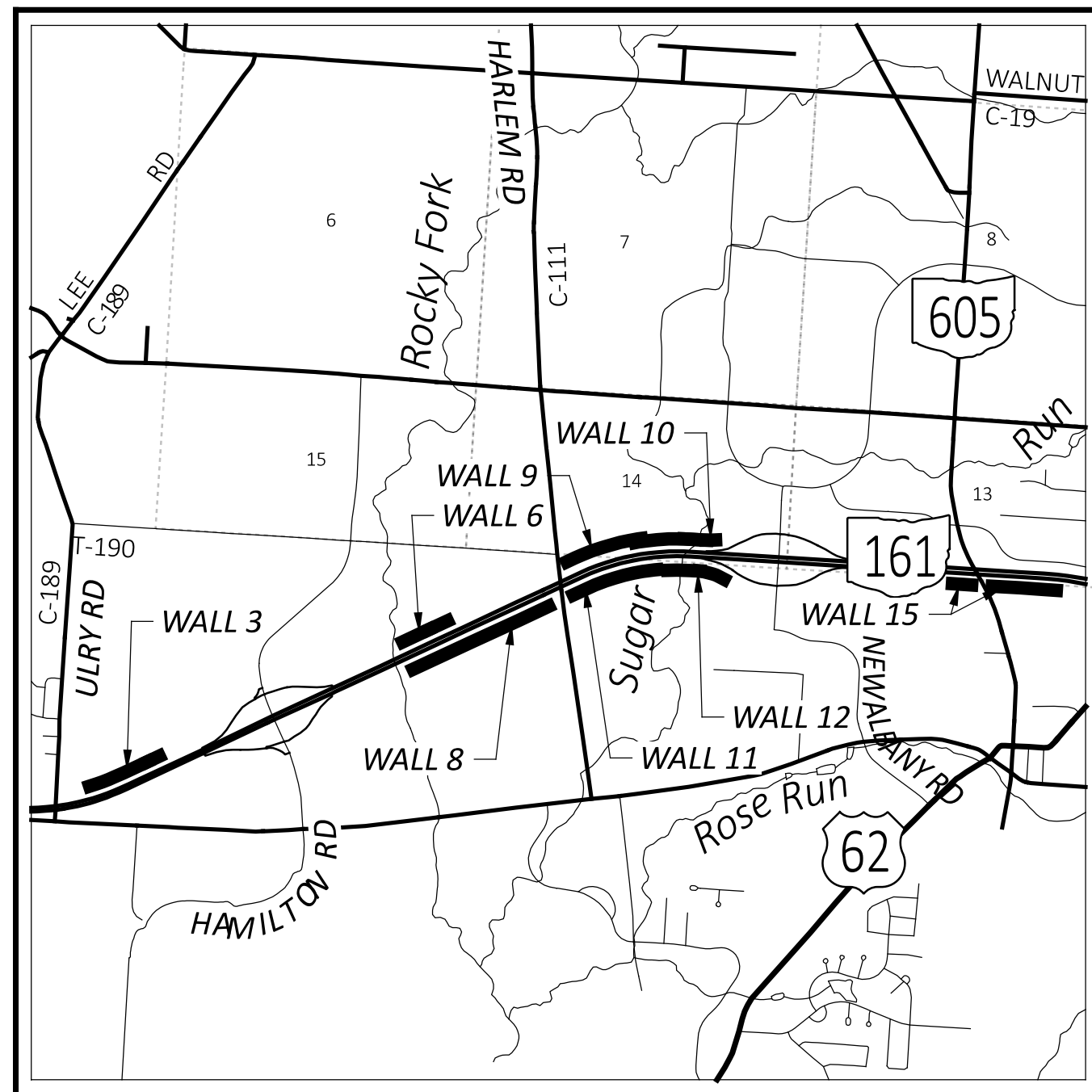

**LOCATION MAP**

LATITUDE: N 40°05'29" LONGITUDE: W 82°49'56"

PORTION TO BE IMPROVED	
INTERSTATE HIGHWAY	
FEDERAL ROUTES	
STATE ROUTES	
COUNTY & TOWNSHIP ROADS	
OTHER ROADS	

**DESIGN DESIGNATION**

CURRENT ADT (2024)	64,716
DESIGN YEAR ADT (2045)	86,550
DESIGN HOURLY VOLUME (2045)	9,080
DIRECTIONAL DISTRIBUTION	50%
TRUCKS (24 HOUR B&C)	8%
DESIGN SPEED	70 MPH
LEGAL SPEED	65 MPH
DESIGN FUNCTIONAL CLASSIFICATION:	
02 OTHER FREEWAY & EXPRESSWAY (URBAN)	
NHS PROJECT	YES

**DESIGN EXCEPTIONS**

NONE REQUIRED

**ADA DESIGN WAIVERS**

NONE REQUIRED

**UNDERGROUND UTILITIES**  
Contact Two Working Days  
Before You Dig

Before You Dig

**OHIO811, 8-1-1, or 1-800-362-2764**  
(Non members must be called directly)

PLAN PREPARED BY:  
ARCADIS - IBI GROUP  
8101 North High Street  
Columbus, OH 43235  
tel 614 818 4900 fax 614 818 4901

**INDEX OF SHEETS:**

TITLE SHEET	P.1
SCHEMATIC PLAN	P.2 - P.5
TYPICAL SECTIONS	P.6 - P.8
GENERAL NOTES	P.9 - P.11
MAINTENANCE OF TRAFFIC	P.12 - P.23
GENERAL SUMMARY	P.24 - P.25
SUBSUMMARIES	P.26 - P.28
PROJECT SITE PLAN	P.29 - P.32
PLAN AND PROFILE - WALL 3 / 81" BARRIER 3	P.33 - P.35
PLAN AND PROFILE - WALL 6 / 81" BARRIER 6	P.36 - P.38
PLAN AND PROFILE - WALL 8	P.39 - P.43
PLAN AND PROFILE - WALL 9	P.44 - P.46
PLAN AND PROFILE - 81" BARRIER 10	P.47 - P.50
PLAN AND PROFILE - WALL 11	P.51 - P.54
PLAN AND PROFILE - WALL 12 / 81" BARRIER 12	P.55 - P.57
PLAN AND PROFILE - WALL 15	P.58 - P.62
CROSS SECTIONS - WALL 3 / 81" BARRIER 3	P.63 - P.75
CROSS SECTIONS - WALL 6 / 81" BARRIER 6	P.76 - P.93
CROSS SECTIONS - WALL 8	P.94 - P.123
CROSS SECTIONS - WALL 9	P.124 - P.139
CROSS SECTIONS - 81" BARRIER 10	P.140 - P.156
CROSS SECTIONS - WALL 11	P.157 - P.173
CROSS SECTIONS - WALL 12 / 81" BARRIER 12	P.174 - P.189
CROSS SECTIONS - WALL 15	P.190 - P.213
NOISE WALL DETAILS	P.214 - P.221
81" SINGLE SLOPE BARRIER DETAILS	P.222 - P.231
SOIL PROFILES	P.232 - P.297

FIRM PANELS: 39049C0203K  
MAP EFFECTIVE DATE: JUNE 17, 2008  
BFE: 957.40  
FLOOD ZONES AE & X

FIRM PANELS: 39049C0204K  
MAP EFFECTIVE DATE: JUNE 17, 2008  
BFE: 974  
FLOOD ZONES AE & X

NO FILL WILL BE ADDED IN THE  
100-YEAR FLOOD PLAIN.

**NOTE:**  
FOR CITY OF COLUMBUS AND CITY OF NEW ALBANY SIGNATURES, SEE SEPARATE SIGNATURE PAGE

STANDARD CONSTRUCTION DRAWINGS						SUPPLEMENTAL SPECIFICATIONS		SPECIAL PROVISIONS	
BP-3.1	1/19/24	NBS-1-09	7/15/22	TC-41.10	7/19/13	800-2023	1/19/24		
BP-5.1	7/15/22			TC-41.20	10/18/13	821	4/20/12		
		MT-95.30	7/19/19	TC-42.10	10/18/13	832	7/21/23		
DM-1.1	7/17/20	MT-95.40	7/21/23	TC-42.20	10/18/13	878	1/21/22		
DM-1.2	7/16/21	MT-95.45	7/21/23	TC-51.11	1/15/16				
DM-4.1	7/17/20	MT-95.50	7/21/17	TC-61.30	7/19/19	921	4/20/12		
F-1.1	7/19/13	MT-98.10	1/17/20	HL-30.31	1/19/24				
F-3.3	7/19/13	MT-98.11	1/17/20						
F-3.4	7/19/13	MT-98.21	7/21/23	BR-1 REV.	4/03/90				
		MT-98.22	1/17/20						
MGS-1.1	7/16/21			RM-4.3	1/21/22				
MGS-2.1	1/19/18	MT-98.29	1/17/20	RM-4.5	7/21/17				
MGS-3.1	1/19/18	MT-99.20	4/19/19	RM-4.6	7/19/13				
MGS-5.3	7/15/16	MT-101.70	4/21/23						
		MT-101.75	7/21/23						

**FEDERAL PROJECT NUMBER**

NON-FEDERAL

**RAILROAD INVOLVEMENT**

NONE

**PROJECT DESCRIPTION**

INSTALLATION OF 8,406 FEET OF NOISE WALL AND 4,836 FEET OF 81" SINGLE SLOPE BARRIER AT VARIOUS LOCATIONS ALONG STATE ROUTE 161 BETWEEN ULRY ROAD AND US 62. THIS PROJECT SUPPLEMENTS THE FRA-161-15.80 WIDENING PROJECT.

**EARTH DISTURBED AREAS**

PROJECT EARTH DISTURBED AREA:	7.95 ACRES
ESTIMATED CONTRACTOR EARTH DISTURBED AREA:	0.25 ACRES
NOTICE OF INTENT EARTH DISTURBED AREA:	8.20 ACRES

**LIMITED ACCESS**

THIS IMPROVEMENT IS ESPECIALLY DESIGNED FOR THROUGH TRAFFIC AND HAS BEEN DECLARED A LIMITED ACCESS HIGHWAY OR FREEWAY BY ACTION OF THE DIRECTOR IN ACCORDANCE WITH THE PROVISIONS OF SECTION 5511.02 OF THE OHIO REVISED CODE.

**2023 SPECIFICATIONS**

THE STANDARD SPECIFICATIONS OF THE STATE OF OHIO, DEPARTMENT OF TRANSPORTATION, INCLUDING SUPPLEMENTAL SPECIFICATIONS LISTED IN THE PLANS AND CHANGES LISTED IN THE PROPOSAL SHALL GOVERN THIS IMPROVEMENT.

I HEREBY APPROVE THESE PLANS AND DECLARE THAT THE MAKING OF THIS IMPROVEMENT WILL NOT REQUIRE THE CLOSING TO TRAFFIC OF THE HIGHWAY AND THAT PROVISIONS FOR THE MAINTENANCE AND SAFETY OF TRAFFIC WILL BE AS SET FORTH ON THE PLANS AND ESTIMATES.

Anthony C. Turowski, P.E.  
District 06 Deputy Director

Jack Marchbanks, PhD  
Director, Department of Transportation

7-08-2024 - MOVED NOTE UNDER INDEX PER COLUMBUS DIRECTION

8-12-2024 - UPDATED COORDINATES

ENGINEER'S SEAL	ENGINEER'S SEAL
	FOR WALL 11 

DESIGN AGENCY  
**ARCADIS**  
8101 NORTH HIGH STREET SUITE 100  
COLUMBUS, OH 43235  
www.arcadis.com

DESIGNER  
**JMK**

REVIEWER  
**JDH 05-22-24**

PROJECT ID  
**117607**

SHEET TOTAL  
3973-E P.1 | P.297  
DOW#23-107

FOR LEGEND AND STEP DETAIL, SEE SHEET P.6

CONST. PROPOSED 81" BARRIER

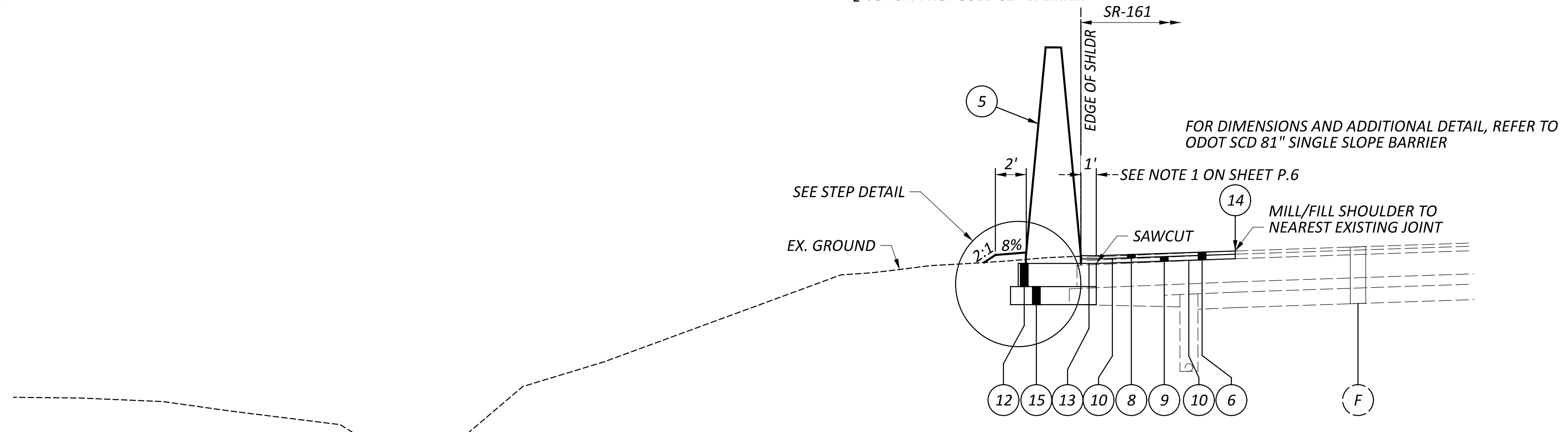

BARRIER, MISC.: 81" SINGLE SLOPE BARRIER (LEFT SIDE)

81" BARRIER 6 - STA. 5999+90.38 TO STA. 6008+25.00  
81" BARRIER 10 - STA. 1000+00.00 TO STA. 1012+70.07

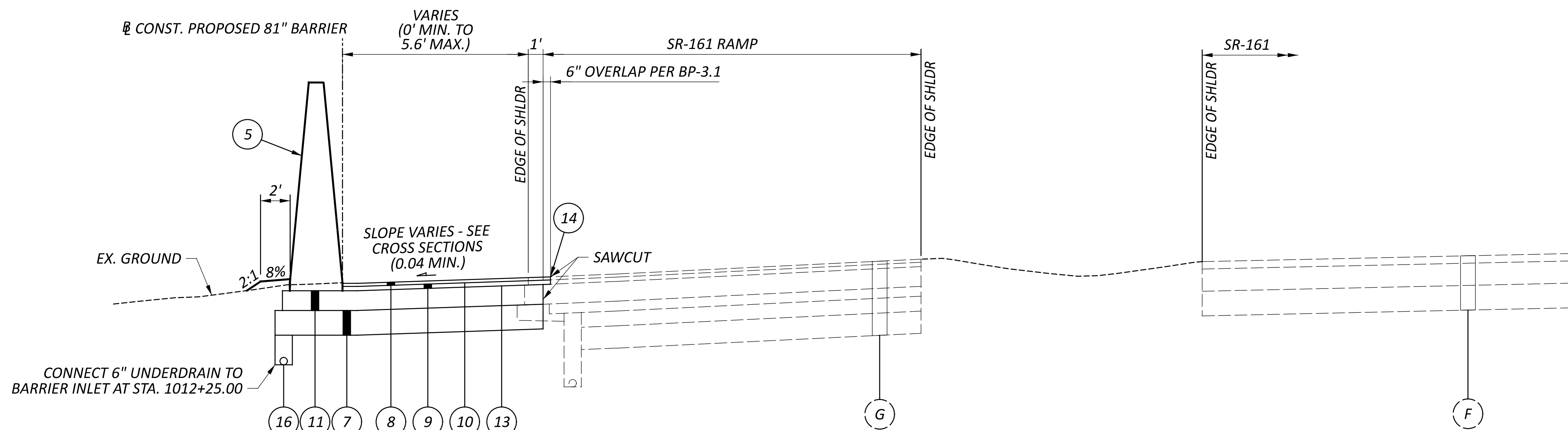

BARRIER, MISC.: 81" SINGLE SLOPE BARRIER  
(LEFT SIDE SHIFTED FROM EXISTING PAVEMENT EDGE)

81" BARRIER 10 - STA. 1012+70.07 TO STA. 1014+15.44

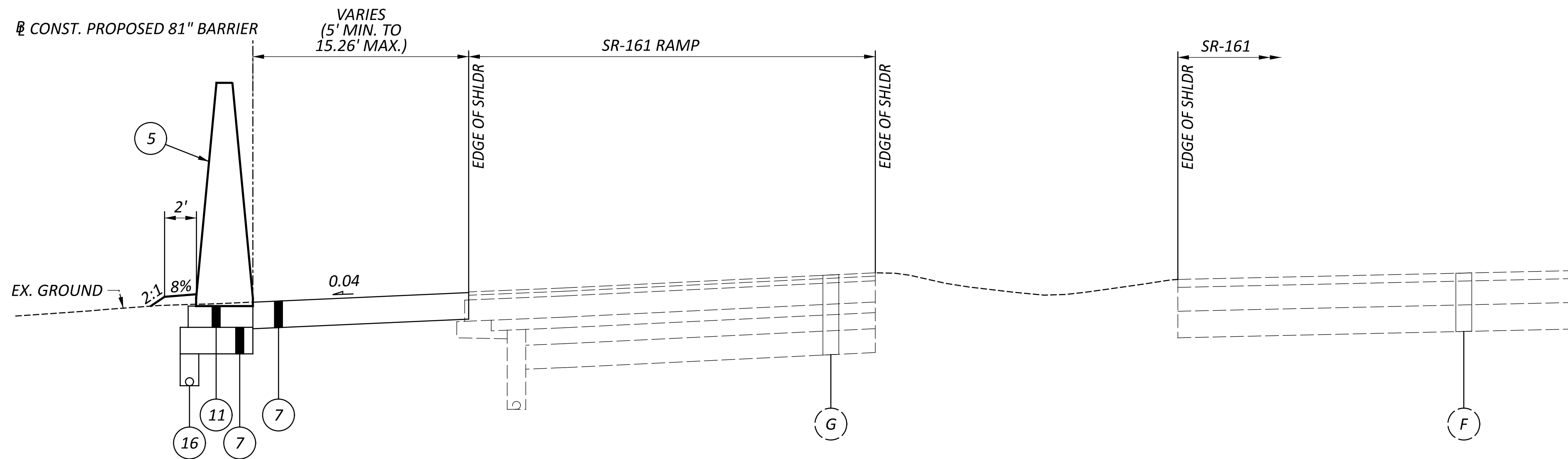

BARRIER, MISC.: 81" SINGLE SLOPE BARRIER  
(LEFT SIDE SHIFTED FROM EXISTING PAVEMENT EDGE)

81" BARRIER 10 - STA. 1014+15.44 TO STA. 1016+49.64

TYPICAL SECTIONS

FRA-161-15.80 NOISE ABATEMENT

MODEL: GY002 PAPER SIZE: 34x22 (in.) DATE: 2024-07-08 TIME: 5:26:18 PM USER: danny.tran  
p:\arcadis-us-pw\benley.com\arcadis-us-01\Documents\01\_Active\Projects\143720\400\_CAD\400-Engineering\Roadway\Sheets\17607\_GY000.dgn

DESIGN AGENCY

ARCADIS  
8101 NORTH HIGGINS SUITE 100  
COLUMBIA, MO 65203  
616.448.4900  
www.arcadis.com

DESIGNER

NRS

REVIEWER

JDH 05-22-24

PROJECT ID

117607

SHEET TOTAL

P.7 P.297

7-08-2024 - UPDATED TEXT MISSING FROM TYPICAL SECTIONS





**FRA-161-15.80 NOISE ABATEMENT**

MODEL: GG001 PAPER: 34x22 (in.) DATE: 2024-08-14 TIME: 2:32:22 PM USER: danny.tran  
 p:\arcadis-us-pw\benley.com\arcadis-us-01\Documents\01 Active Projects\143720\400\_CAD\400-Engineering\Roadway\Sheets\11760Z\_GG001.dgn

SHEET NUM.										PART.			ITEM	ITEM EXT	GRAND TOTAL	UNIT	DESCRIPTION	SEE SHEET NO.
P.9	P.10	P.26	P.27	P.28	P.222					01/NHS/20								
LS			1,262							LS			201	11001	LS	CLEARING AND GRUBBING, AS PER PLAN	P.9	
			1							1,262			202	38000	1,262	FT	GUARDRAIL REMOVED	
			4,001							1			202	42040	1	EACH	ANCHOR ASSEMBLY REMOVED, TYPE T	
			1,229	2,229						4,001			202	75000	4,001	FT	FENCE REMOVED	
										3,458			203	10000	3,458	CY	EXCAVATION	
				684						684			203	20000	684	CY	EMBANKMENT	
				67						67			203	98000	67	CY	ROADWAY, MISC.: TEMPORARY OVER-STEEPENED FILL	P.10
		362								362			606	15050	362	FT	GUARDRAIL, TYPE MGS	
		3								3			606	26150	3	EACH	ANCHOR ASSEMBLY, MGS TYPE E (MASH 2016)	
		4								4			606	35002	4	EACH	MGS BRIDGE TERMINAL ASSEMBLY, TYPE 1	
		1								1			606	35102	1	EACH	MGS BRIDGE TERMINAL ASSEMBLY, TYPE 2	
		1								1			606	60002	1	EACH	IMPACT ATTENUATOR, TYPE 1 (UNIDIRECTIONAL)	
			201							201			607	35000	201	FT	FENCE REMOVED AND REBUILT	
			80							80			607	98000	80	FT	FENCE, MISC.: WHITE SPLIT RAIL FENCE	P.10
4,202										4,202			607	98000	4,202	FT	FENCE, MISC.: TEMPORARY FENCE	P.9
		3,743								3,743			622	90000	3,743	FT	BARRIER, MISC.: 81" SINGLE SLOPE BARRIER	P.224
										29			622	90200	29	EACH	BARRIER, MISC.: 81" SINGLE SLOPE BARRIER END ANCHORAGE, REINFORCED	P.224
										6			622	90200	6	EACH	BARRIER, MISC.: BARRIER DRAINAGE WINDOW SECTION	P.230
										6			622	90200	6	EACH	BARRIER, MISC.: 81" CONCRETE BARRIER END SECTION	P.223
										LS			878	25000	LS		INSPECTION AND COMPACTION TESTING OF UNBOUND MATERIALS	
																	EROSION CONTROL	
1										1			659	00100	1	EACH	SOIL ANALYSIS TEST	
887			1,012							1,899			659	00300	1,899	CY	TOPSOIL	
			955							955			659	00590	955	SY	SEEDING AND MULCHING, CLASS 6	
7,985										7,985			659	10000	7,985	SY	SEEDING AND MULCHING	
400										400			659	14000	400	SY	REPAIR SEEDING AND MULCHING	
										400			659	15000	400	SY	INTER-SEEDING	
400										1,08			659	20000	1,08	TON	COMMERCIAL FERTILIZER	
1.08										1.65			659	31000	1.65	ACRE	LIME	
1.65										45			659	35000	45	MGAL	WATER	
45			9,090							9,090			670	00500	9,090	SY	SLOPE EROSION PROTECTION	
										LS			832	15000	LS		STORM WATER POLLUTION PREVENTION PLAN	
										LS			832	15002	LS		STORM WATER POLLUTION PREVENTION INSPECTIONS	
										LS			832	15010	LS		STORM WATER POLLUTION PREVENTION INSPECTION SOFTWARE	
										142,257			832	30000	142,257	EACH	EROSION CONTROL	
																	DRAINAGE	
	10		237							247			601	21050	247	SY	TIED CONCRETE BLOCK MAT WITH TYPE 1 UNDERLAYMENT	
		2.97								2.97			602	20000	2.97	CY	CONCRETE MASONRY	
	50		9,333							9,383			605	13300	9,383	FT	6" UNCLASSIFIED PIPE UNDERDRAINS	
	50									50			605	31100	50	FT	AGGREGATE DRAINS	
	25		532							557			611	00510	557	FT	6" CONDUIT, TYPE F FOR UNDERDRAIN OUTLETS	
										279			611	06100	279	FT	15" CONDUIT, TYPE C	
										83			611	06700	83	FT	15" CONDUIT, TYPE F	
										11			611	99500	11	EACH	INLET, MISC.: INLET NO. 3 FOR 81" SINGLE SLOPE BARRIER	P.226
	5		26							31			611	99710	31	EACH	PRECAST REINFORCED CONCRETE OUTLET	
																	PAVEMENT	
		4,822								4,822			254	01000	4,822	SY	PAVEMENT PLANING, ASPHALT CONCRETE, 3"	
		998								998			304	20000	998	CY	AGGREGATE BASE	
		219								219			407	10000	219	GAL	TACK COAT	
		760								760			407	20000	760	GAL	NON-TRACKING TACK COAT	
		189								189			442	10001	189	CY	ASPHALT CONCRETE SURFACE COURSE, 12.5 MM, TYPE A (446), AS PER PLAN, PG70-22M	P.10
										189			442	10080	189	CY	ASPHALT CONCRETE INTERMEDIATE COURSE, 12.5 MM, TYPE A (446)	
		1,803								1,803			452	12010	1,803	SY	8" NON-REINFORCED CONCRETE PAVEMENT, CLASS QC 1P	
		1,147								1,147			452	13010	1,147	SY	9" NON-REINFORCED CONCRETE PAVEMENT, CLASS QC 1P	
		108								108			609	24000	108	FT	CURB, TYPE 4-A	
		4,401								4,401			872	10000	4,401	FT	VOID REDUCING ASPHALT MEMBRANE (VRAM)	
																	NOISE BARRIERS	
										4			519	11101	4	SF	PATCHING CONCRETE STRUCTURE, AS PER PLAN	P.222
										115,010			SPECIAL	60610210	115,010	SF	NOISE BARRIER (REFLECTIVE)	P.9

8-12-2024 ADDED TEMPORARY FENCE ITEM

**GENERAL SUMMARY**

DESIGN AGENCY  
**ARCADIS**  
 8101 NORTH HIGH ST SUITE 100  
 COLUMBUS, OHIO 43235  
 (614) 884-8000  
 www.arcadis.com

DESIGNER  
**JMK**

REVIEWER  
**JDH 05-22-24**

PROJECT ID  
**117607**

SHEET TOTAL  
 P.24 P.297

**FRA-161-15.80 NOISE ABATEMENT**

MODEL: CLP\_SR161 - Plan 1 [Sheet] PAPER SIZE: 34x22 (in.) DATE: 2024-08-13 TIME: 3:39:26 PM USER: danny.tran  
 pw:\arcadis-us-pw.bentley.com\arcadis-us-01\Documents\01 Active Projects\143720\400\_CAD\400-Engineering\Drainage\Sheets\117607\_DE001.dgn

PROJECT DATA			
TOTAL AREA (RIGHT-OF-WAY):	42.77 ACRES	RUNOFF COEFFICIENT FOR PRE-CONSTRUCTION SITE:	0.56
PROJECT EARTH DISTURBED AREA:	7.95 ACRES	RUNOFF COEFFICIENT FOR POST-CONSTRUCTION SITE:	0.58
ESTIMATED CONTRACTOR EARTH DISTURBED AREA:	0.25 ACRES	POST CONSTRUCTION BMP: VEGETATED FILTER STRIPS	
NOTICE OF INTENT EARTH DISTURBED AREA:	8.20 ACRES	IMMEDIATE RECEIVING WATERS: SPRING RUN, BIG WALNUT CREEK, ROCKY FORK CREEK, AND SUGAR RUN CREEK	
IMPERVIOUS (PAVED) AREA FOR PRE-CONSTRUCTION SITE:	20.40 ACRES		
IMPERVIOUS (PAVED AND NEW WALL AREA) FOR POST-CONSTRUCTION SITE:	20.85 ACRES		

8-12-2024 - UPDATED COORDINATES

USGS MAPS:  
 NORTHEAST COLUMBUS, OH TNM GEOSPATIAL  
 NEW ALBANY, OH TNM GEOSPATIAL

LATITUDE: N 40°05'29"  
 LONGITUDE: W 82°49'56"

\*LATITUDE AND LONGITUDE TO APPROX. CENTER OF PROJECT

**PROJECT DESCRIPTION**

INSTALLATION OF 8,406 FEET OF NOISE WALL AND 4,836 FEET OF 81" SINGLE SLOPE BARRIER AT VARIOUS LOCATIONS ALONG STATE ROUTE 161 BETWEEN ULRY ROAD AND US 62. THIS PROJECT SUPPLEMENTS THE FRA-161-15.80 WIDENING PROJECT.

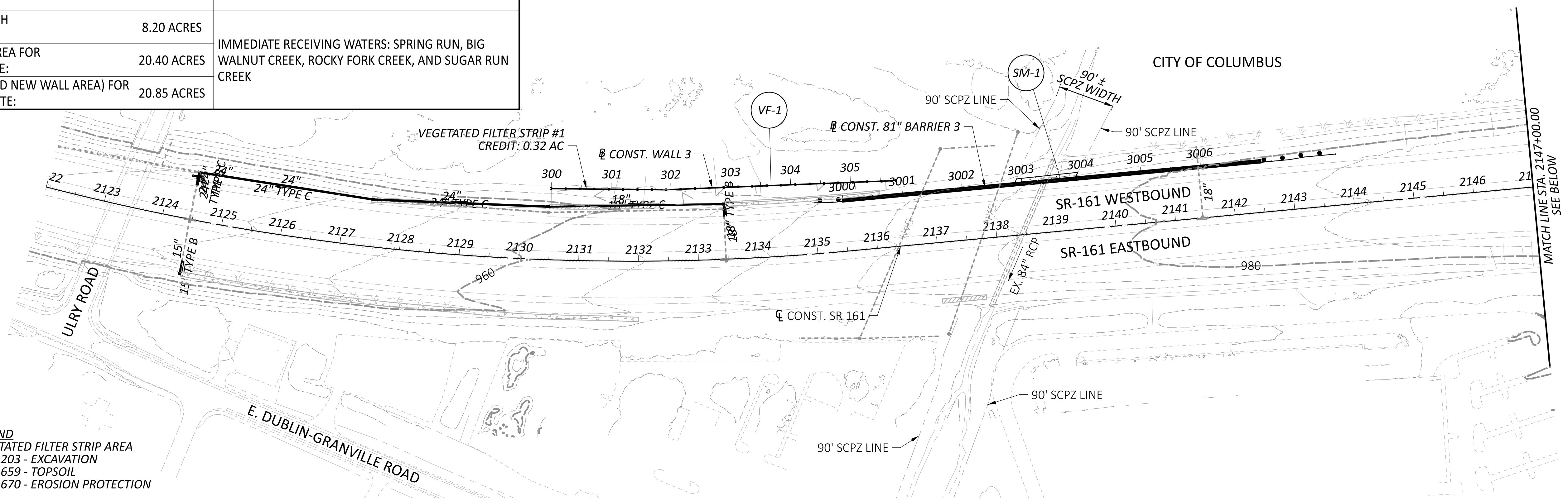
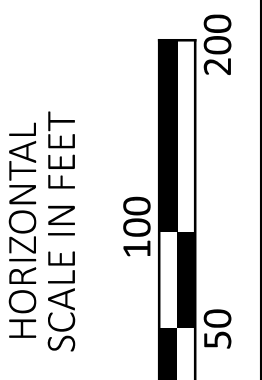
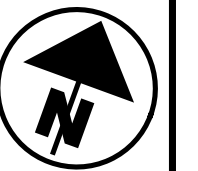

**LEGEND**

- VEGETATED FILTER STRIP AREA
- ITEM 203 - EXCAVATION
- ITEM 659 - TOPSOIL
- ITEM 670 - EROSION PROTECTION

Maintenance Ownership	BMP TYPE	NORTHING		EASTING		BMP WIDTH	EDA TREATMENT CREDIT
		BEGIN	END	BEGIN	END		
CITY OF COLUMBUS	VEGETATED FILTER STRIP 1	612181.7892	612385.2908	229916.4923	230437.1461	15' MIN.	0.32
CITY OF COLUMBUS	VEGETATED FILTER STRIP 2	614971.5085	615112.1153	235908.4312	236204.7643	24' MIN.	0.19
CITY OF COLUMBUS	VEGETATED FILTER STRIP 3	615276.6007	615588.5647	237036.7344	237726.4929	23' MIN.	0.70
CITY OF COLUMBUS	VEGETATED FILTER STRIP 4	615909.0762	237882.0507	616316.8878	239006.7099	21' MIN.	0.66
TREATMENT PROVIDED							1.87
TREATMENT REQUIRED							1.51

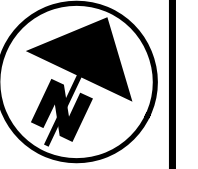
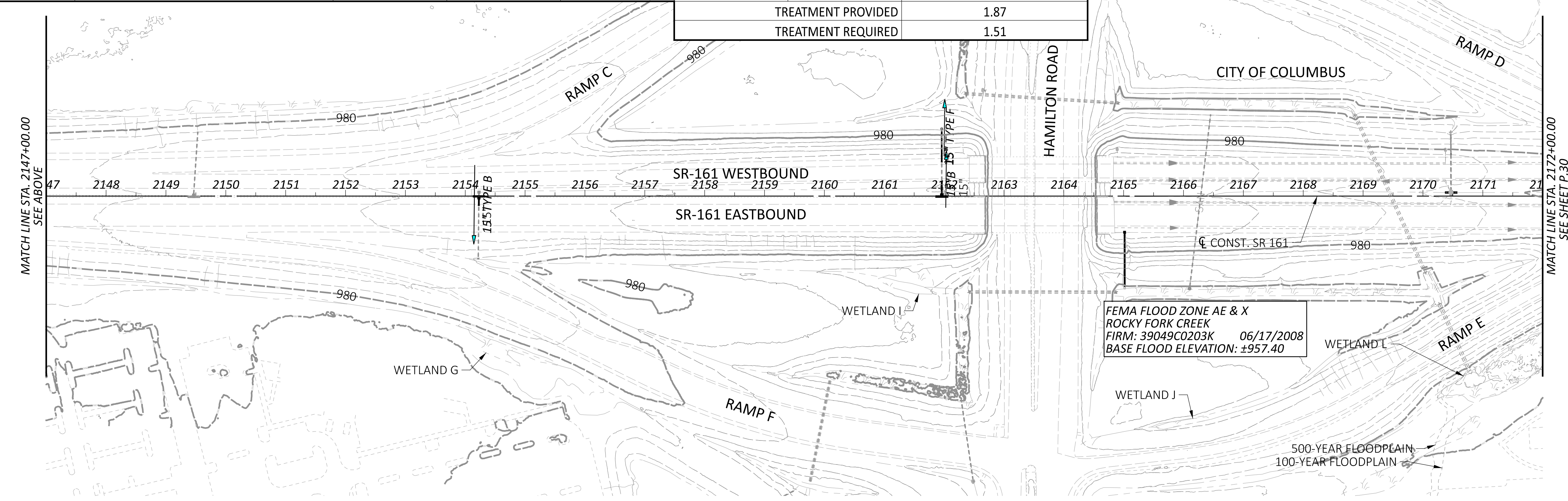

**PROJECT SITE PLAN**  
 STA. 2122+00.00 TO STA. 2172+00.00

DESIGN AGENCY

**ARCADIS**  
 8101 NORTH HIGHWAY 100  
 COLUMBUS, OH 43235  
 (614) 810-4900  
 www.arcadis.com

DESIGNER

**JMK**

REVIEWER

**JDH** 05-22-24

PROJECT ID

**117607**

SHEET TOTAL

P.29 P.297

**FRA-161-15.80 NOISE ABATEMENT**

MODEL: CLP\_SR161 - Plan 3 [Sheet] PAPER SIZE: 34x22 (in.) DATE: 2024-08-13 TIME: 3:46:19 PM USER: danny.tran  
 pw:\arcadis-us-pw\Bentley.com\arcadis-us-01\Documents\143720\400\_CAD\400-Engineering\Drainage\Sheets\117607\_DE001.dgn

**USGS MAPS:**  
 NORTHEAST COLUMBUS, OH TNM GEOSPATIAL  
 NEW ALBANY, OH TNM GEOSPATIAL  
 LATITUDE: N 40°05'29"  
 LONGITUDE: W 82°49'56"  
 \*LATITUDE AND LONGITUDE TO APPROX. CENTER OF PROJECT

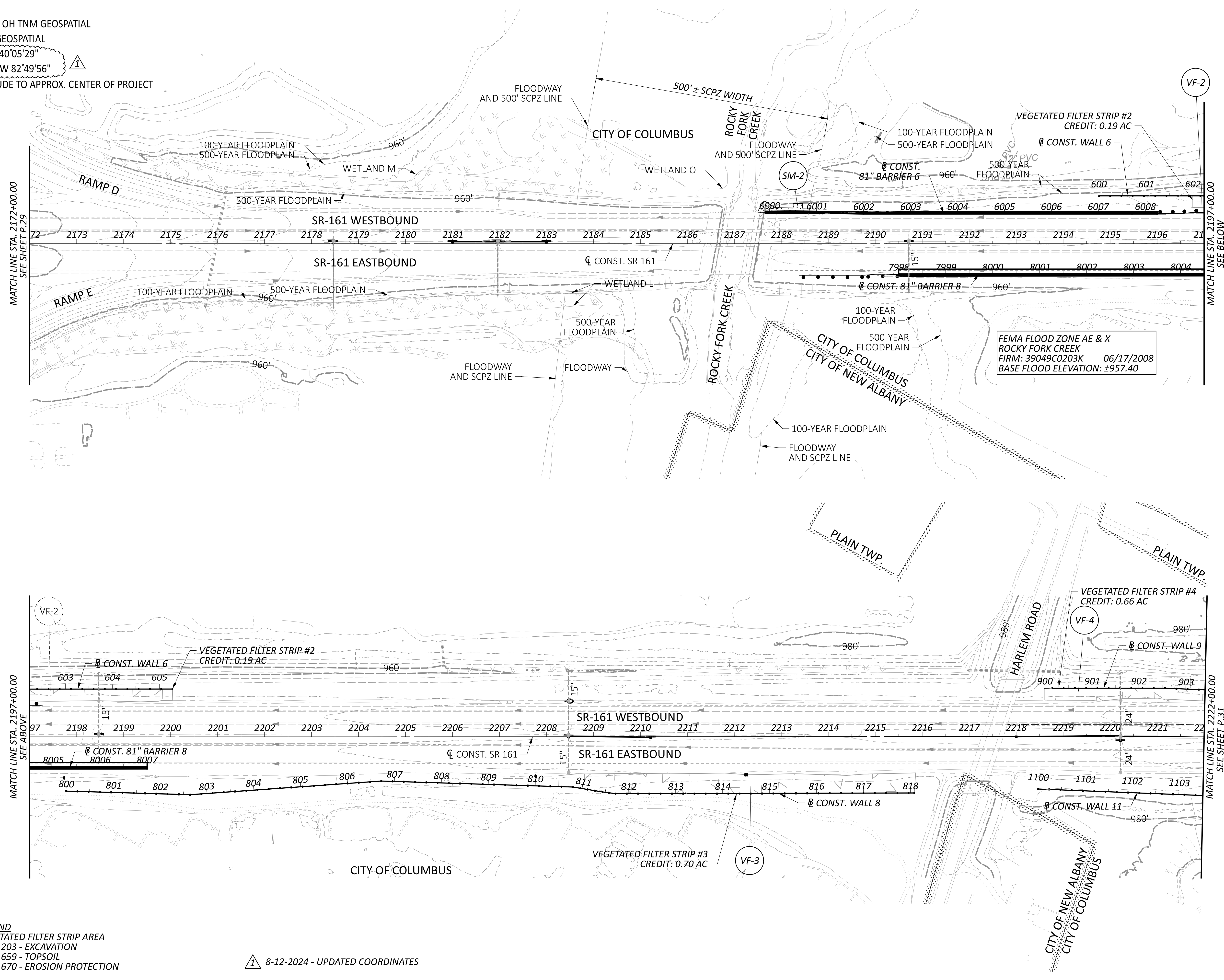

**LEGEND**  
 VEGETATED FILTER STRIP AREA  
 ITEM 203 - EXCAVATION  
 ITEM 659 - TOPSOIL  
 ITEM 670 - EROSION PROTECTION

8-12-2024 - UPDATED COORDINATES

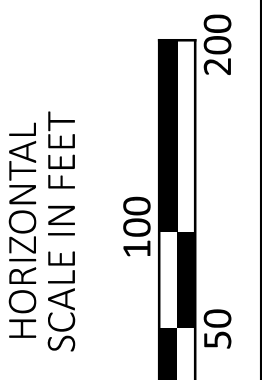
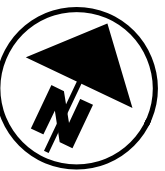

**PROJECT SITE PLAN**  
 STA. 2172+00.00 TO STA. 2222+00.00

DESIGN AGENCY	
<b>ARCADIS</b>	8101 NORTH HIGHWAY 100 COLUMBUS, OH 43240 614.814.4900 www.arcadis.com
DESIGNER	
JMK	
REVIEWER	
JDH 05-22-24	
PROJECT ID	
117607	
SHEET	TOTAL
P.30	P.297

USGS MAPS:  
 NORTHEAST COLUMBUS, OH TNM GEOSPATIAL  
 NEW ALBANY, OH TNM GEOSPATIAL  
 LATITUDE: N 40°05'29"  
 LONGITUDE: W 82°49'56"  
 \*LATITUDE AND LONGITUDE TO APPROX. CENTER OF PROJECT

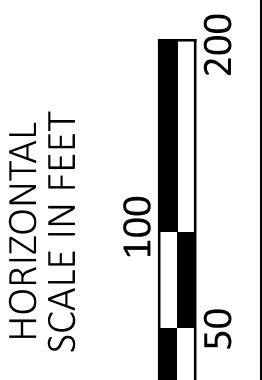

PROJECT SITE PLAN  
 STA. 2222+00.00 TO STA. 2272+00.00

DESIGN AGENCY	
	8101 NORTH HIGHWAY 70, SUITE 100 COLUMBUS, OH 43240 614.810.4900 www.arcadis.com
DESIGNER	
JMK	
REVIEWER	
JDH 05-22-24	
PROJECT ID	
117607	
SHEET TOTAL	
P.31	P.297

- LEGEND**
- VEGETATED FILTER STRIP AREA
  - ITEM 203 - EXCAVATION
  - ITEM 659 - TOPSOIL
  - ITEM 670 - EROSION PROTECTION

8-12-2024 - UPDATED COORDINATES

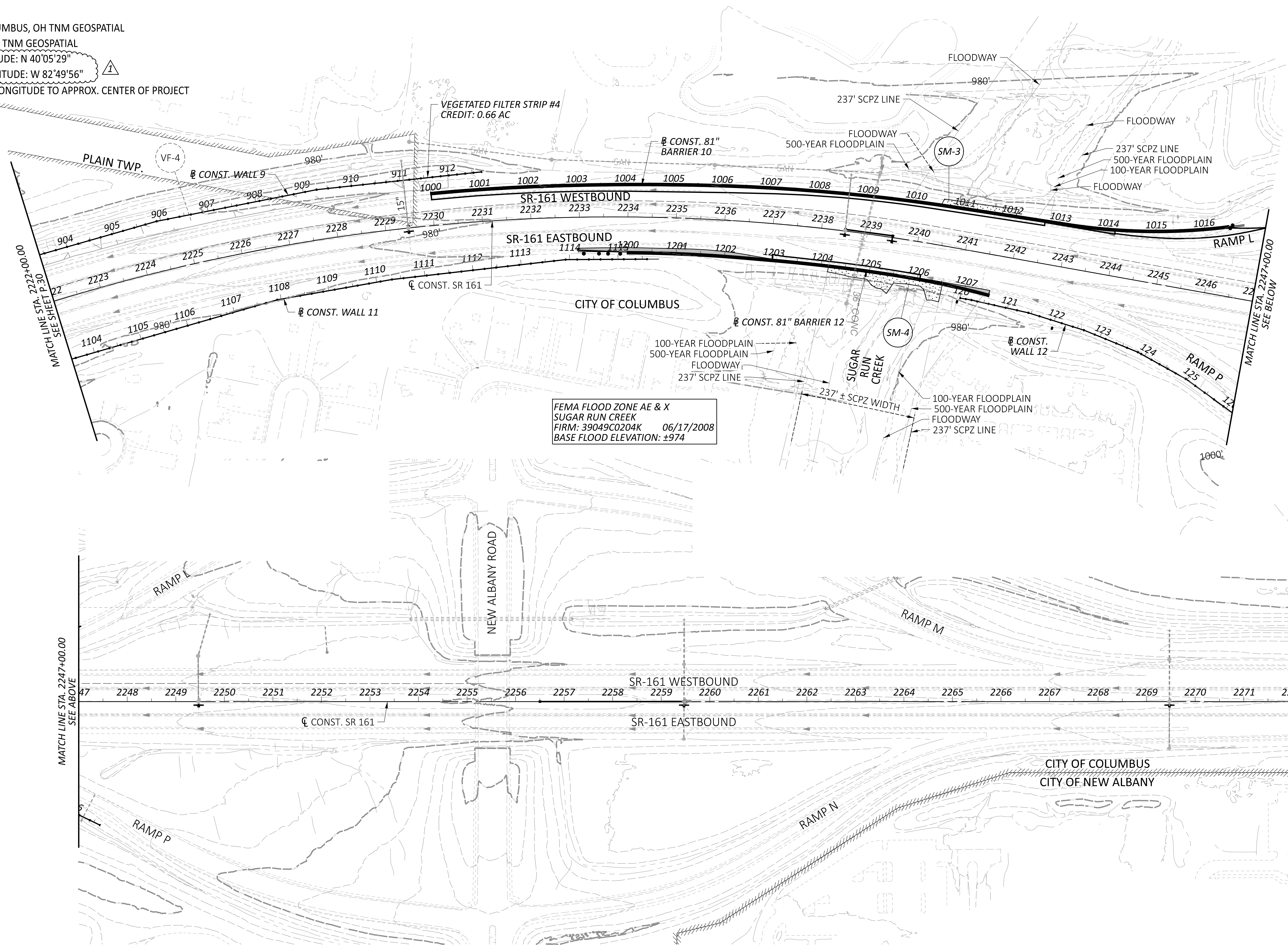

FEMA FLOOD ZONE AE & X  
 SUGAR RUN CREEK  
 FIRM: 39049C0204K 06/17/2008  
 BASE FLOOD ELEVATION: ±974



MODEL: CLP\_SR161 - Plan 7 [Sheet] PAPER SIZE: 34x22 (in.) DATE: 2024-08-13 TIME: 3:56:20 PM USER: danny.tran  
pw:\arcadis-us-pw.bentley.com\arcadis-us-01\Documents\01 Active Projects\143720\400\_CAD\400-Engineering\Drainage\Sheets\117607\_DE001.dgn

**NOTE:**  
NO BMPS ARE LOCATED ON THIS SHEET.

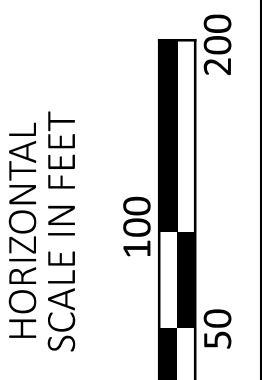
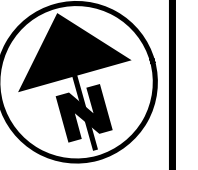
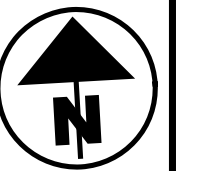
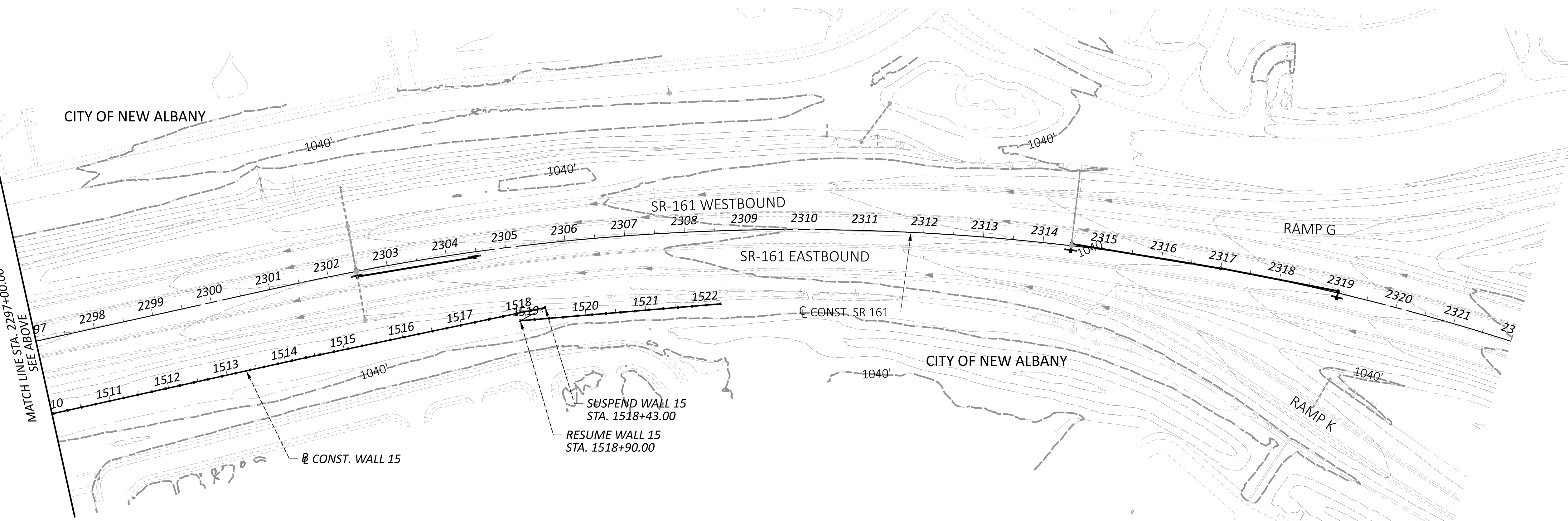
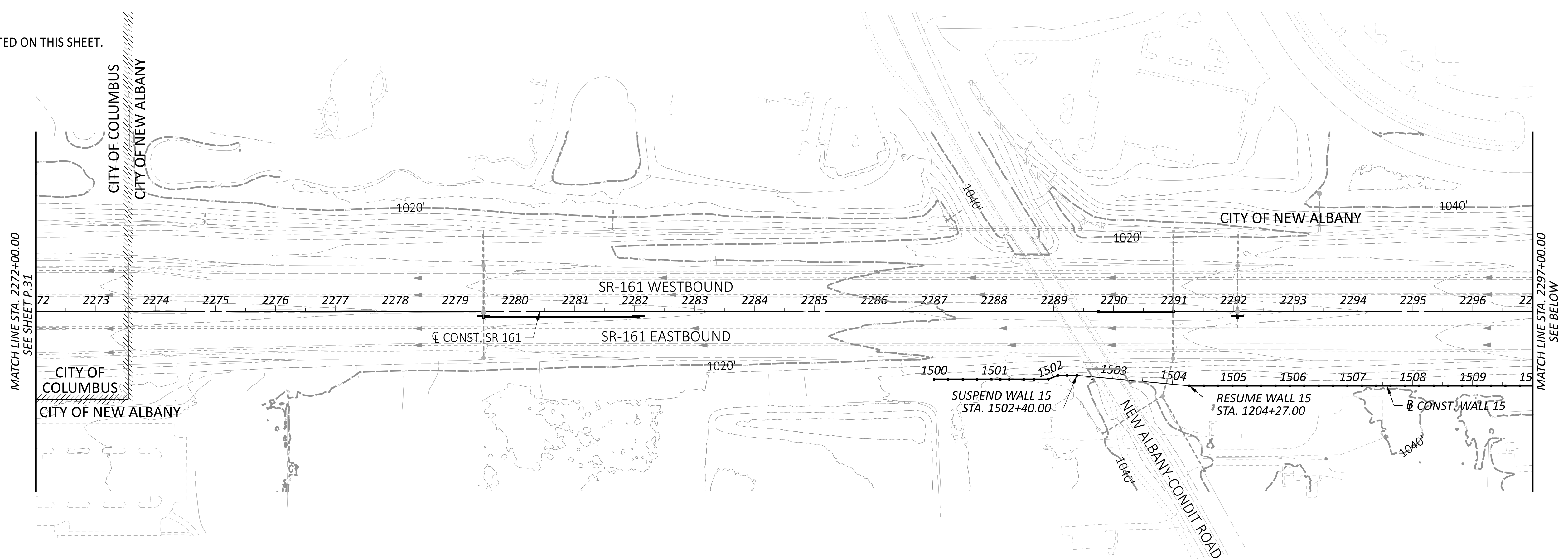

**USGS MAPS:**  
NORTHEAST COLUMBUS, OH TNM GEOSPATIAL  
NEW ALBANY, OH TNM GEOSPATIAL

LATITUDE: N 40°05'29"  
LONGITUDE: W 82°49'56"

\*LATITUDE AND LONGITUDE TO APPROX. CENTER OF PROJECT

8-12-2024 - UPDATED COORDINATES

**PROJECT SITE PLAN**  
STA. 2272+00.00 TO STA. 2322+00.00

DESIGN AGENCY



DESIGNER  
**JMK**

REVIEWER  
JDH 05-22-24

PROJECT ID  
117607

SHEET TOTAL  
P.32 P.297

**10D CURVE DATA**  
 CONST. 81" BARRIER 10  
 P.I. = STA. 1014+82.35  
 $\Delta = 15^{\circ}41'58''$  LT  
 $Dc = 04^{\circ}46'29''$   
 $R = 1,200.00'$   
 $T = 165.44'$   
 $L = 328.81'$   
 $E = 11.35'$

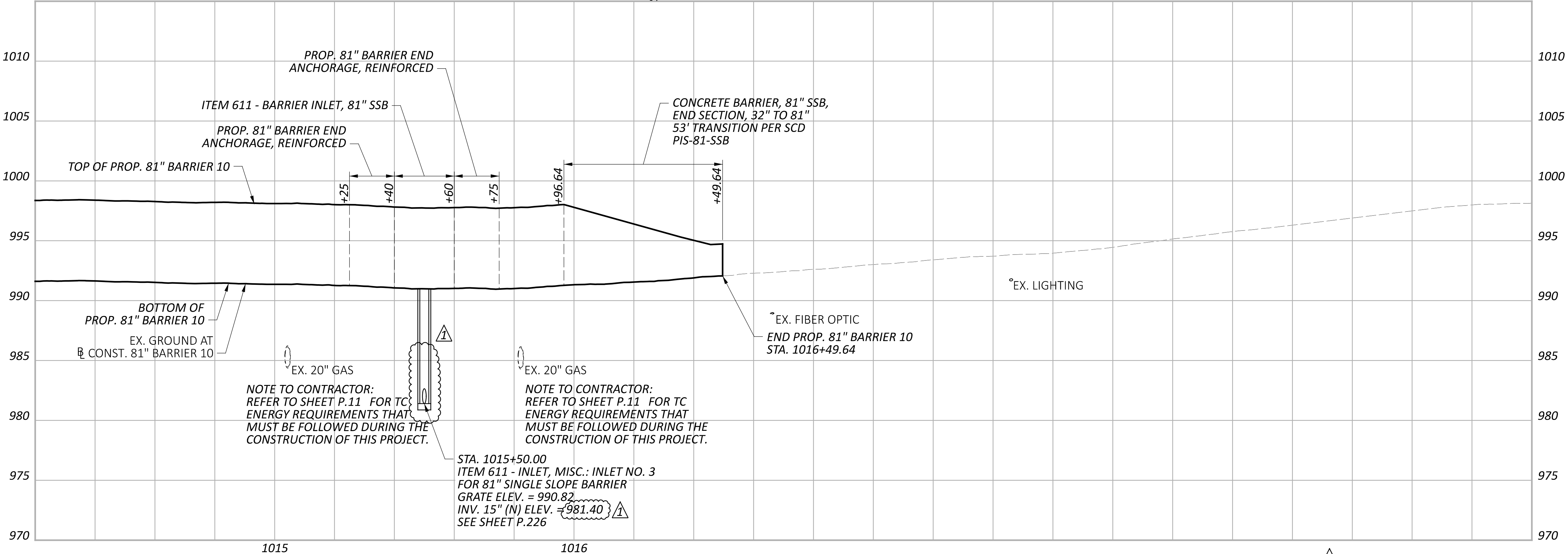
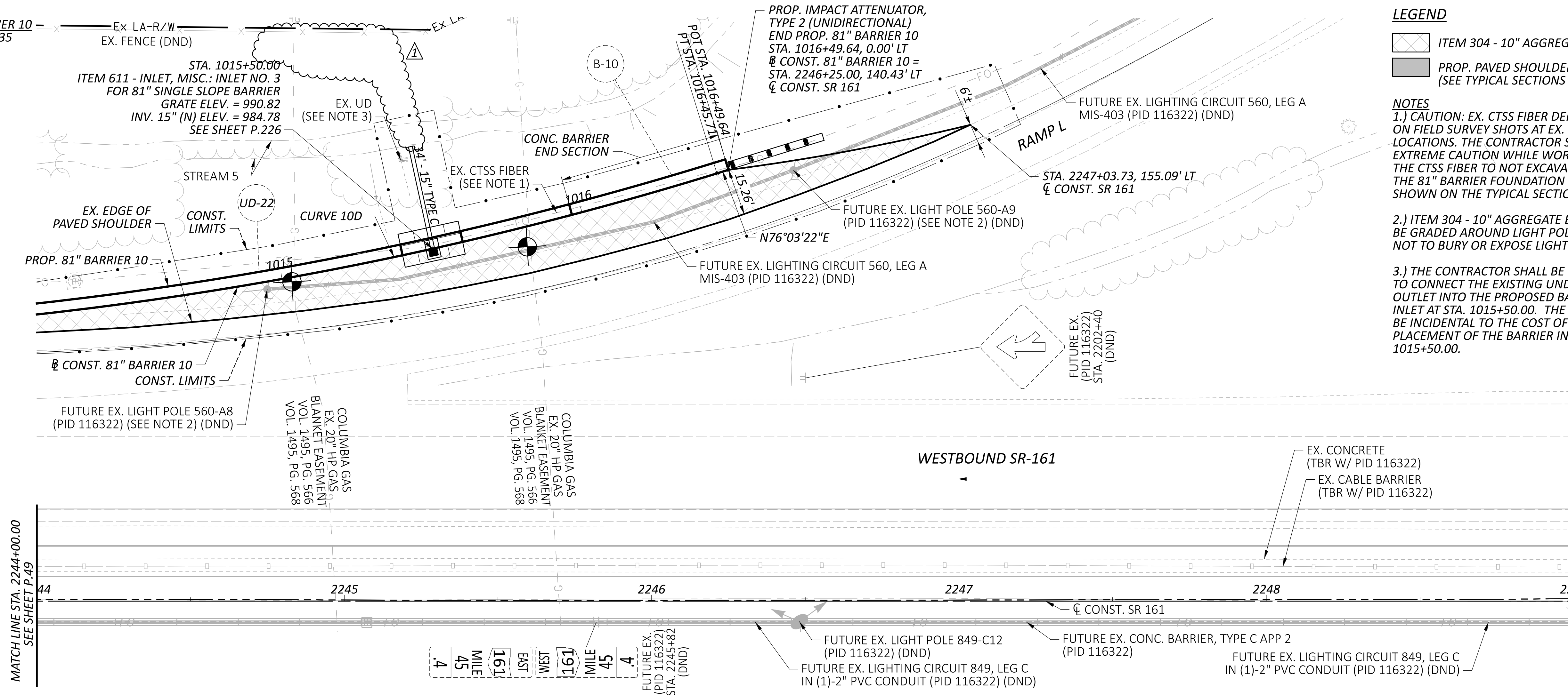

**LEGEND**

- ITEM 304 - 10" AGGREGATE BASE
- PROP. PAVED SHOULDER (SEE TYPICAL SECTIONS FOR PAVEMENT BUILDUP)

**NOTES**

- CAUTION: EX. CTSS FIBER DEPTH BASED ON FIELD SURVEY SHOTS AT EX. PULL BOX LOCATIONS. THE CONTRACTOR SHALL USE EXTREME CAUTION WHILE WORKING NEAR THE CTSS FIBER TO NOT EXCAVATE BELOW THE 81" BARRIER FOUNDATION LIMITS SHOWN ON THE TYPICAL SECTIONS.
- ITEM 304 - 10" AGGREGATE BASE SHALL BE GRADED AROUND LIGHT POLE SO AS NOT TO BURY OR EXPOSE LIGHT POLE BASE.
- THE CONTRACTOR SHALL BE REQUIRED TO CONNECT THE EXISTING UNDERDRAIN OUTLET INTO THE PROPOSED BARRIER INLET AT STA. 1015+50.00. THE COST SHALL BE INCIDENTAL TO THE COST OF THE PLACEMENT OF THE BARRIER INLET AT STA. 1015+50.00.

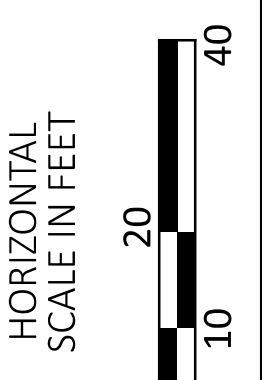
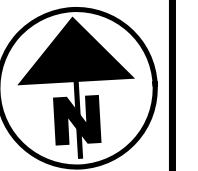

**PLAN & PROFILE - 81" BARRIER 10  
 STA. 2244+00.00 TO STA. 2249+00.00**

DESIGN AGENCY	
ARCADIS	
8101 NORTH HIGHTOWER SUITE 100 COLUMBIA, MO 64114-4900 www.arcadis.com	
DESIGNER	
JMK	
REVIEWER	
JDH 05-22-24	
PROJECT ID	
117607	
SHEET	TOTAL
P.50	P.297

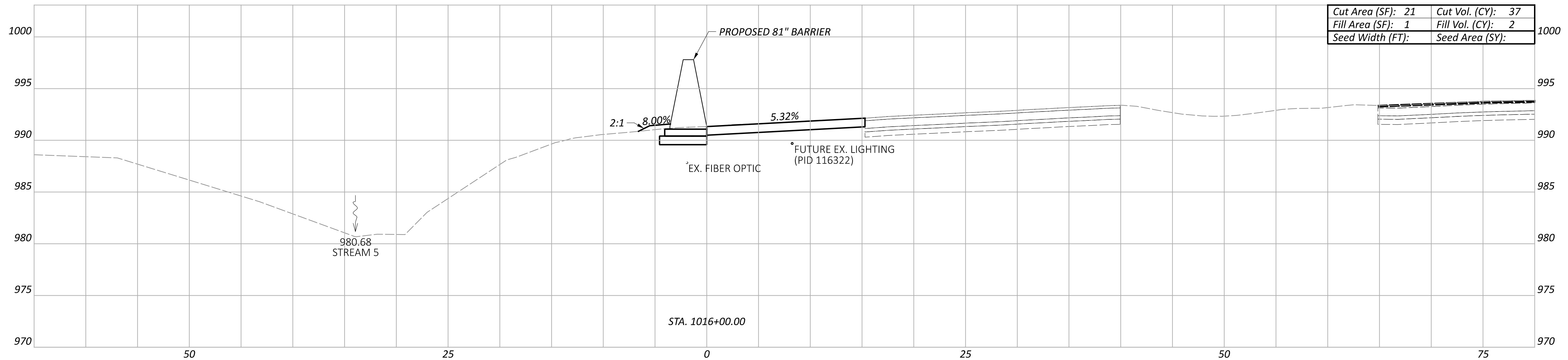

Cut Area (SF):	21	Cut Vol. (CY):	37
Fill Area (SF):	1	Fill Vol. (CY):	2
Seed Width (FT):		Seed Area (SY):	

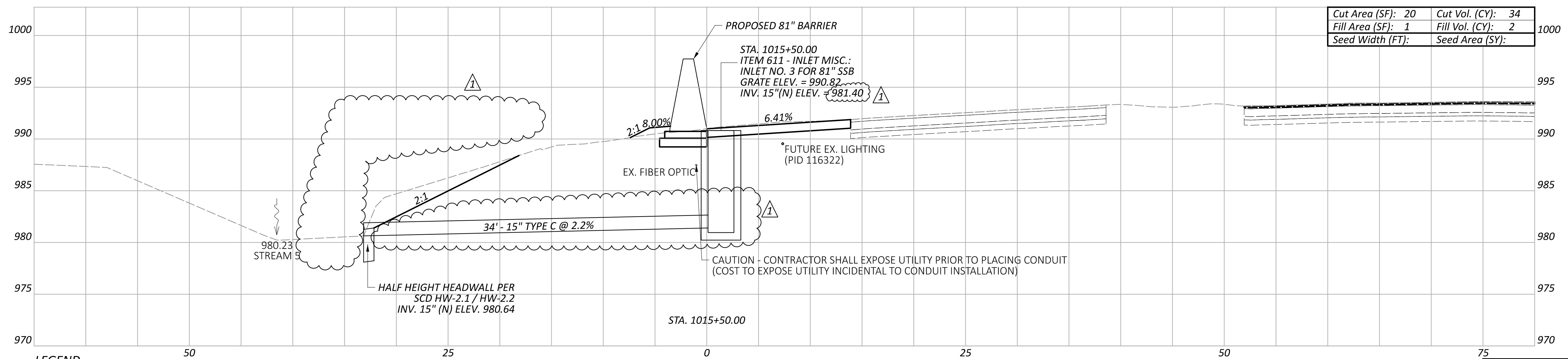

Cut Area (SF):	20	Cut Vol. (CY):	34
Fill Area (SF):	1	Fill Vol. (CY):	2
Seed Width (FT):		Seed Area (SY):	

**LEGEND**

- - - EXISTING SR-161 PRIOR TO PID 116322
- - - FUTURE EXISTING SR-161 AFTER CONSTRUCTION OF PID 116322

7-08-2024 - REVISED CONDUIT INVERT AND SLOPE, REMOVED RCP.

Sheet Totals			117607
Seeding	Cut	Fill	SHEET TOTAL
71	4		P.155 P.297

CROSS SECTIONS - 81" BARRIER 10  
 STA. 1015+50.00 TO STA. 1016+00.00

DESIGN AGENCY  
**ARCADIS**  
 8101 NORTH HIGGINS SUITE 100  
 COLUMBIANA, OH 43085  
 (614) 810-4900  
 www.arcadis.com

DESIGNER  
**JMK**

REVIEWER  
**JDH 05-22-24**

PROJECT ID  
**117607**

Table with 7 columns: DRILLED SHAFT NO., WORKPOINT STATION, DEFLECTION ANGLE, TOP OF DRILLED SHAFT ELEVATION, SHAFT LENGTH (FEET), BOTTOM OF BARRIER ELEVATION, TOP OF BARRIER ELEVATION. Titled 'NOISE WALL 9'.

Table with 13 columns: DRILLED SHAFT NO., WORKPOINT STATION, DEFLECTION ANGLE, TOP OF DRILLED SHAFT ELEVATION, SHAFT LENGTH (FEET), BOTTOM OF BARRIER ELEVATION, TOP OF BARRIER ELEVATION. Titled 'NOISE WALL 11'.

Table with 13 columns: DRILLED SHAFT NO., WORKPOINT STATION, DEFLECTION ANGLE, TOP OF DRILLED SHAFT ELEVATION, SHAFT LENGTH (FEET), BOTTOM OF BARRIER ELEVATION, TOP OF BARRIER ELEVATION. Titled 'NOISE WALL 12'.

NOTES:  
1.) FOR POST TYPE SPECIFICATIONS, SEE SHEETS P.218 - P.221

2.) VALUES LISTED FOR BOTTOM OF BARRIER ELEVATION AND TOP OF BARRIER ELEVATION CORRESPOND WITH THE BOTTOMMOST AND TOPMOST PANEL AT EACH DRILLED SHAFT LOCATION.

$\triangle$  8-12-2024 - UPDATED DRILLED SHAFT LENGTH

NOISE WALL DETAILS - WALLS 9, 11 & 12