

STANDARD DRAWINGS AND SUPPLEMENTAL SPECIFICATIONS

REFER TO THE FOLLOWING STANDARD BRIDGE DRAWING(S):

SBR-1-13 DATED/REVISED 7/20/2018
 EXJ-4-87 DATED/REVISED 1/19/2018
 GSD-1-19 DATED/REVISED 1/18/2019
 VPF-1-90 DATED/REVISED 7/20/2018

AND THE FOLLOWING SUPPLEMENTAL SPECIFICATION(S):

848 DATED/REVISED 1/20/2017

DESIGN SPECIFICATIONS

DESIGN SPECIFICATIONS: THESE STRUCTURES CONFORM TO "STANDARD SPECIFICATIONS FOR HIGHWAY BRIDGES" ADOPTED BY THE AMERICAN ASSOCIATION OF STATE HIGHWAY AND TRANSPORTATION OFFICIALS, 17TH EDITION 2002, AND THE ODOT BRIDGE DESIGN MANUAL, 2004.

DESIGN DATA

CONCRETE CLASS, QC2 - COMPRESSIVE STRENGTH 4.5 KSI
 (BRIDGE DECK AND PARAPETS)
 CONCRETE CLASS, QC1 - COMPRESSIVE STRENGTH 4.0 KSI
 (SUBSTRUCTURE)
 REINFORCING STEEL - MINIMUM YIELD STRENGTH 60 KSI

DECK PROTECTION METHOD

NEW SDC OVERLAY:
 FRA-270-5090 - 1 3/4" THICKNESS

EXISTING STRUCTURE VERIFICATION

EXISTING STRUCTURE VERIFICATION: DETAILS AND DIMENSIONS SHOWN ON THESE PLANS PERTAINING TO THE EXISTING STRUCTURE HAVE BEEN OBTAINED FROM PLANS OF THE EXISTING STRUCTURE AND FROM FIELD OBSERVATIONS AND MEASUREMENTS. CONSEQUENTLY, THEY ARE INDICATIVE OF THE EXISTING STRUCTURE AND THE PROPOSED WORK BUT THEY SHALL BE CONSIDERED TENTATIVE AND APPROXIMATE. THE CONTRACTOR IS REFERRED TO CMS SECTIONS 102.05, 105.02 AND 513.04. BASE CONTRACT BID PRICES UPON A RECOGNITION OF THE UNCERTAINTIES DESCRIBED ABOVE AND UPON A PREBID EXAMINATION OF THE EXISTING STRUCTURE. HOWEVER, THE DEPARTMENT WILL PAY FOR ALL PROJECT WORK BASED UPON ACTUAL DETAILS AND DIMENSIONS WHICH HAVE BEEN VERIFIED IN THE FIELD.

REMOVED MATERIALS

ALL REMOVED MATERIALS EXCEPT AS NOTED ELSEWHERE IN THE PLANS SHALL BECOME THE PROPERTY OF THE CONTRACTOR AND SHALL BE REMOVED BY HIM FROM THE JOB SITE.

MAINTAIN VERTICAL CLEARANCE

THE CONTRACTOR IS RESPONSIBLE FOR MEASURING VERTICAL CLEARANCE AFTER COMPLETION OF THE PROJECT. MEASUREMENTS ARE TO BE RECORDED AT EACH EDGE LINE, LANE LINE AND CROWN AT THE LOWEST POINT UNDER THE BRIDGE AND SUBMITTED TO THE DISTRICT BRIDGE ENGINEER.

ITEM 516 - STRUCTURAL EXPANSION JOINT INCLUDING ELASTOMERIC STRIP SEAL, AS PER PLAN

THIS WORK CONSISTS OF REMOVAL AND REPLACEMENT OF EXISTING ELASTOMERIC STRIP SEAL GLAND BETWEEN THE SUPERSTRUCTURE AND REAR ABUTMENT ACCORDING TO EXJ-4-87. EXISTING JOINT ARMOR IS TO REMAIN. THE REQUIRED GLAND SIZE IS 3". THE CONTRACTOR IS DIRECTED TO SEAL INSTALLATION PROCEDURE ACCORDING TO EXJ-4-87.

THE DEPARTMENT WILL PAY FOR THE ABOVE WORK AT THE CONTRACT BID PRICE FOR ITEM 516 STRUCTURAL EXPANSION JOINT INCLUDING ELASTOMERIC STRIP SEAL, AS PER PLAN.

ITEM 519 - PATCHING CONCRETE STRUCTURE, AS PER PLAN, PIER PATCHING:

PRIOR TO THE SURFACE CLEANING SPECIFIED IN 519.04 AND WITHIN 24 HOURS OF PLACING PATCHING MATERIAL, BLAST CLEAN ALL SURFACES TO BE PATCHED INCLUDING THE EXPOSED REINFORCING STEEL. ACCEPTABLE METHODS INCLUDE HIGH-PRESSURE WATER BLASTING WITH OR WITHOUT ABRASIVES IN THE WATER, ABRASIVE BLASTING WITH CONTAINMENT, OR VACUUM ABRASIVE BLASTING.

THIS ITEM INCLUDES ALL PIER PATCHING IDENTIFIED IN THE PLANS AND ALSO INCLUDES A 20% CONTINGENCY TO BE USED AS DIRECTED BY THE ENGINEER FOR OTHER SUBSTRUCTURE PATCHING AS NEEDED.

THE FOLLOWING CONTINGENCY QUANTITY HAS BEEN PROVIDED AND HAS BEEN CARRIED TO THE GENERAL SUMMARY:

ITEM 519 - PATCHING CONCRETE STRUCTURE, AS PER PLAN, PIER PATCHING = 13 SF

ITEM 519 - PATCHING CONCRETE STRUCTURE, AS PER PLAN, BACKWALL PATCHING:

THIS ITEM IS A CONTINGENCY QUANTITY INTENDED FOR BACKWALL PATCHING ON STRUCTURE FRA-270-5090. THE QUANTITY IS FOR PATCHING THE TOP ±6" OF THE BACKWALL. SEE DETAIL ON THIS SHEET FOR MORE INFORMATION. ALL REPAIRS ARE TO BE DONE AT THE DIRECTION OF THE ENGINEER.

THE CONTRACTOR HAS THE OPTION TO USE THE SAME CONCRETE AS THE SDC OVERLAY OF FRA-270-5090, OR THE CONCRETE DESCRIBED IN C&MS 519.02. WHICHEVER MATERIAL USED, WILL BE PAID UNDER THIS ITEM, AND MEASURED BY THE TOP SURFACE AREA OF THE REPAIR.

THE FOLLOWING CONTINGENCY QUANTITY HAS BEEN PROVIDED AND HAS BEEN CARRIED TO THE STRUCTURE ESTIMATED QUANTITIES TABLE:

ITEM 519 - PATCHING CONCRETE STRUCTURE, AS PER PLAN, BACKWALL PATCHING = 27 SF

ITEM 530 - SPECIAL - STRUCTURES: STRUCTURE CLEANING

DESCRIPTION: AFTER REPAIR WORK IS COMPLETE ON THE STRUCTURE, AS NECESSARY. THE CONTRACTOR SHALL CLEAN SCUPPERS, DOWNSPOUTS, BACKWALLS, AND BEAM SEATS WITH THE USE OF HAND OPERATED EQUIPMENT AND HIGH PRESSURE WASHERS TO REMOVE SALT, DIRT, AND DEBRIS AS DIRECTED BY THE ENGINEER.

MEASUREMENT AND PAYMENT: THE DEPARTMENT WILL MEASURE THE ABOVE WORK ON A LUMP SUM BASIS PER BRIDGE.

ITEM 202 - PORTIONS OF STRUCTURE REMOVED, AS PER PLAN

THIS ITEM SHALL BE BID TO INCLUDE ALL REMOVALS AS DETAILED ON SHEETS 74 AND 77 AS WELL AS THE EXISTING DEBRIS NETTING ON BOTH PARAPETS. THIS ITEM SHALL BE PAID PER THE LUMP SUM BID PRICE FOR ITEM 202 - PORTIONS OF STRUCTURE REMOVED, AS PER PLAN.

THE FOLLOWING QUANTITY HAS BEEN PROVIDED AND CARRIED TO THE STRUCTURES SUMMARY:

ITEM 202 - PORTIONS OF STRUCTURE REMOVED, AS PER PLAN = LUMP SUM

ITEM 503 - UNCLASSIFIED EXCAVATION

THIS ITEM SHALL BE BID TO INCLUDE ALL EXCAVATION AND BACKFILL FOR WINGWALL, BACKWALL, AND ANY OTHER MISCELLANEOUS REPAIRS REQUIRED BY THE PLANS. THIS ITEM SHALL BE PAID PER THE LUMP SUM BID PRICE FOR ITEM 503 - UNCLASSIFIED EXCAVATION.

THE FOLLOWING QUANTITY HAS BEEN PROVIDED AND CARRIED TO THE STRUCTURES SUMMARY:

ITEM 503 - UNCLASSIFIED EXCAVATION = LUMP SUM

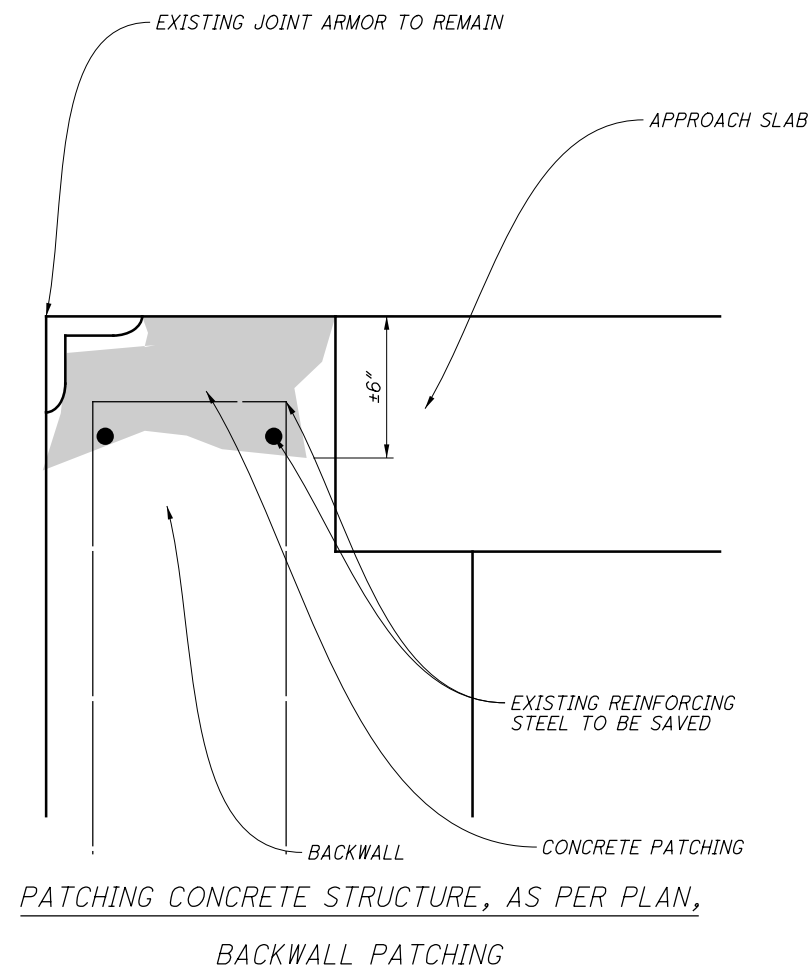

I:\ProjectData\079666_FRA-270-48.47\Design\Structures\FRA270_5090\Sheets\079666_SNO01.dgn 079666_SNO01 7/20/2020 3:21:57 PM bflris

