

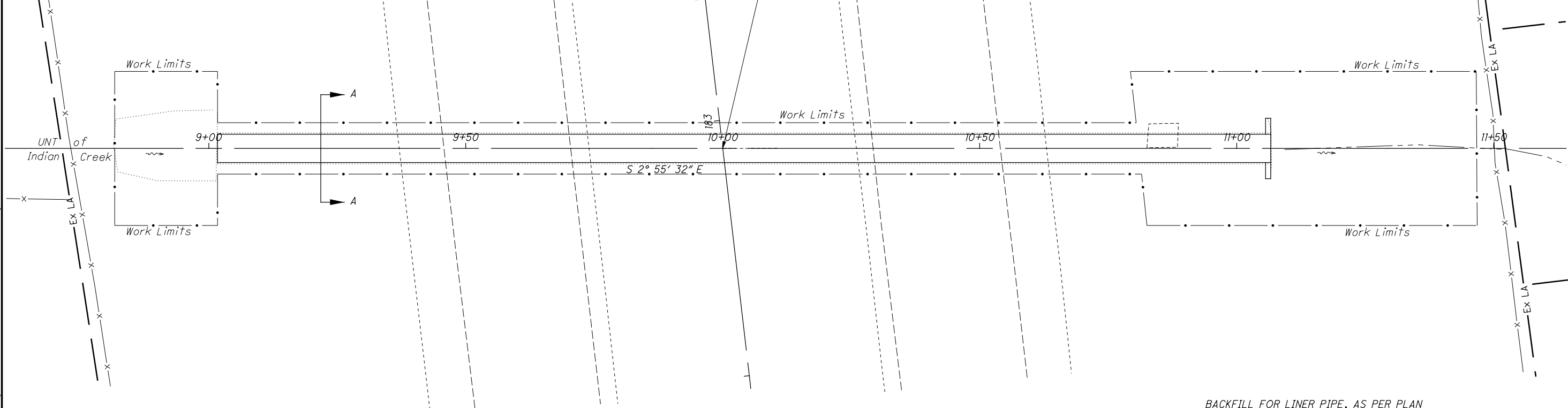

I:\ProjectData\GAL\11392\_GAL-35-3.47\Design\Roadway\Sheets\Gal-35-0347-GP.dgn Design 7/23/2020 12:44:45 PM dhague

ESTIMATED QUANTITIES				
ITEM	ITEM EXT.	QUANTITY	UNIT	DESCRIPTION
201	11000	LUMP		CLEARING AND GRUBBING
202	20010	1	EA	HEADWALL REMOVED
202	35200	18	FT	PIPE REMOVED, OVER 24"
SPECIAL	20270130	187	FT	PIPE CLEANOUT OVER 48"
203	10000	25	CU YD	EXCAVATION
203	20000	25	CU YD	EMBANKMENT
503	11100	LUMP		COFFERDAMS AND EXCAVATION BRACING
602	20000	2.1	CU YD	CONCRETE MASONRY
614	11001	LUMP		MAINTAINING TRAFFIC, AS PER PLAN
837	10000	205	FT	LINER PIPE, 70" CONDUIT, TYPE A, 748.06
837	20001	187	FT	BACKFILL FOR LINER PIPE, AS PER PLAN

Drainage Area: 99 Ac.  
 Q(50): 133 cfs  
 HW(50): 603.2'  
 V(50): 12.8 fps  
 Q(100): 156 cfs  
 HW(100): 603.6'  
 OHW: 601.4'



Existing Culvert (To Be Lined)  
 Type: 78" Diameter Corrugated Metal Pipe (L= 205')  
 Skew: 6° 40' ± Rt Fwd  
 Alignment: Tangent  
 Ex.CFN: 1820878

- Remove Damaged Portion of Existing Culvert (L=18'±), As Directed.

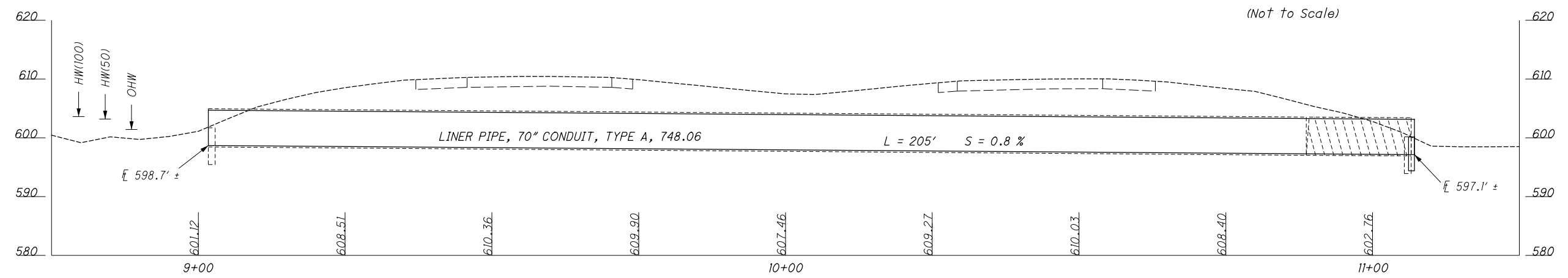
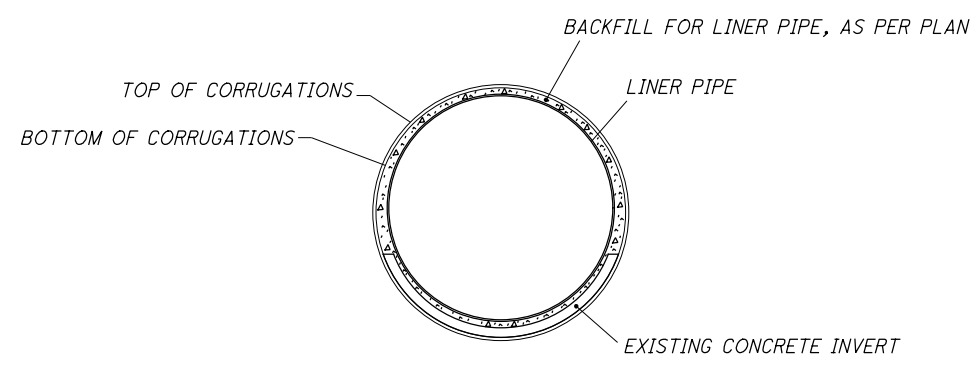

**Culvert Details**  
**GAL-35-3.47**

**GAL-35-3.47**

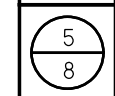

I:\ProjectData\GAL\111392\_GAL-35-3.47\Design\Roadway\Sheets\Gal-35-0354-GP.dgn Design 7/23/2020 12:44:10 PM dhague

ESTIMATED QUANTITIES				
ITEM	ITEM EXT.	QUANTITY	UNIT	DESCRIPTION
201	11000	LUMP		CLEARING AND GRUBBING
SPECIAL	20270130	194	FT	PIPE CLEANOUT OVER 48"
503	11100	LUMP		COFFERDAMS AND EXCAVATION BRACING
614	11001	LUMP		MAINTAINING TRAFFIC, AS PER PLAN
837	10000	194	FT	LINER PIPE, 66" CONDUIT, TYPE A, 748.06, 707.12
837	20001	194	FT	BACKFILL FOR LINER PIPE, AS PER PLAN

Drainage Area: 67 Ac.  
 Q(50): 103 cfs  
 HW(50): 602.8'  
 V(50): 9.1 fps  
 Q(100): 122 cfs  
 HW(100): 603.2'  
 OHW: 600.6'

Station 186+94.55, U.S. 35  
 Station 20+00 Channel @  
 Skew: 90°

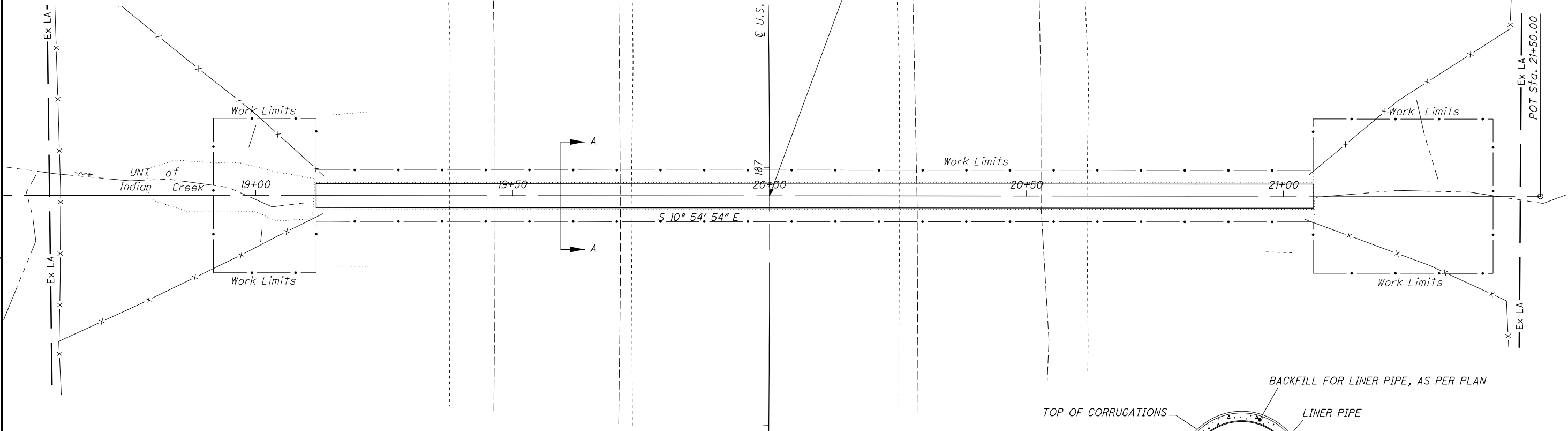

Existing Culvert (To Be Lined)  
 Type: 72" Diameter Corr. Metal Pipe (Field Paved ; L= 194')  
 Skew: 90°  
 Alignment: Curve (Lt)  
 Ex.CFN: 1820879

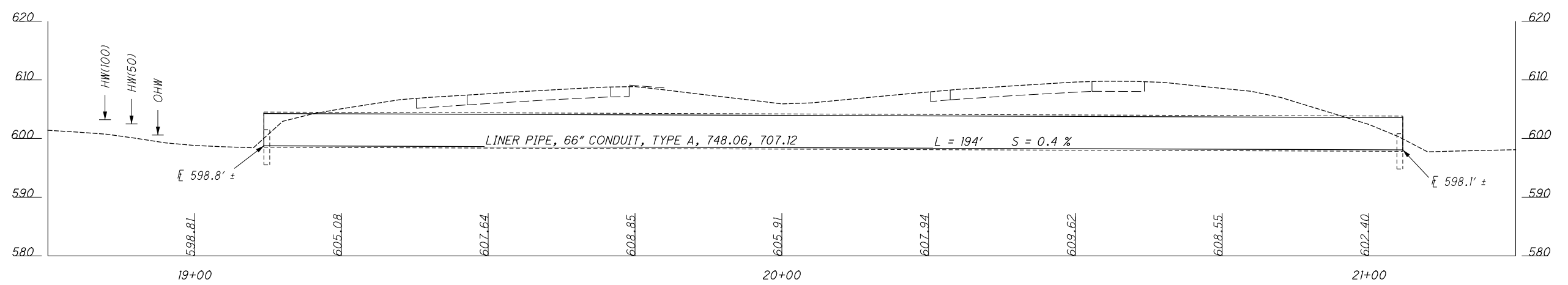
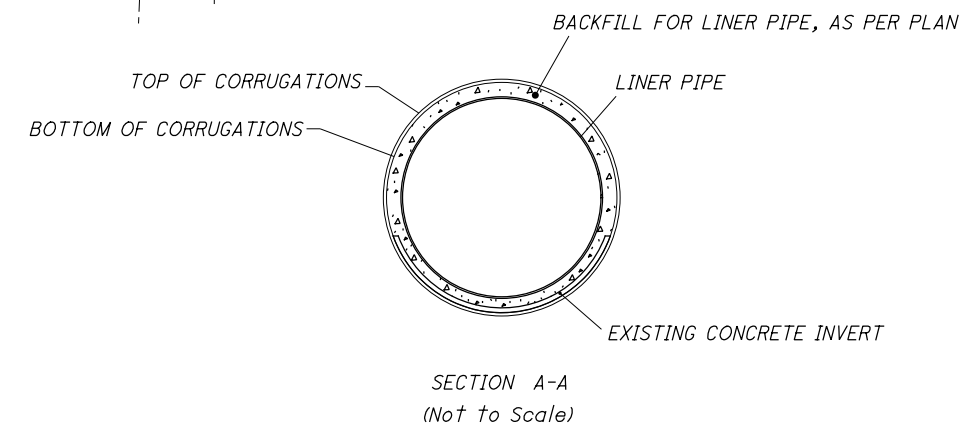

**Culvert Details**  
**GAL-35-3.54**

**GAL-35-3.47**

