

**SUPERELEVATED SECTION - REAR APPROACH SLAB RAMP C**  
STA. 1005+26.21 - STA. 1005+51.21

(5\*) ITEM 304 - 13" AGGREGATE BASE

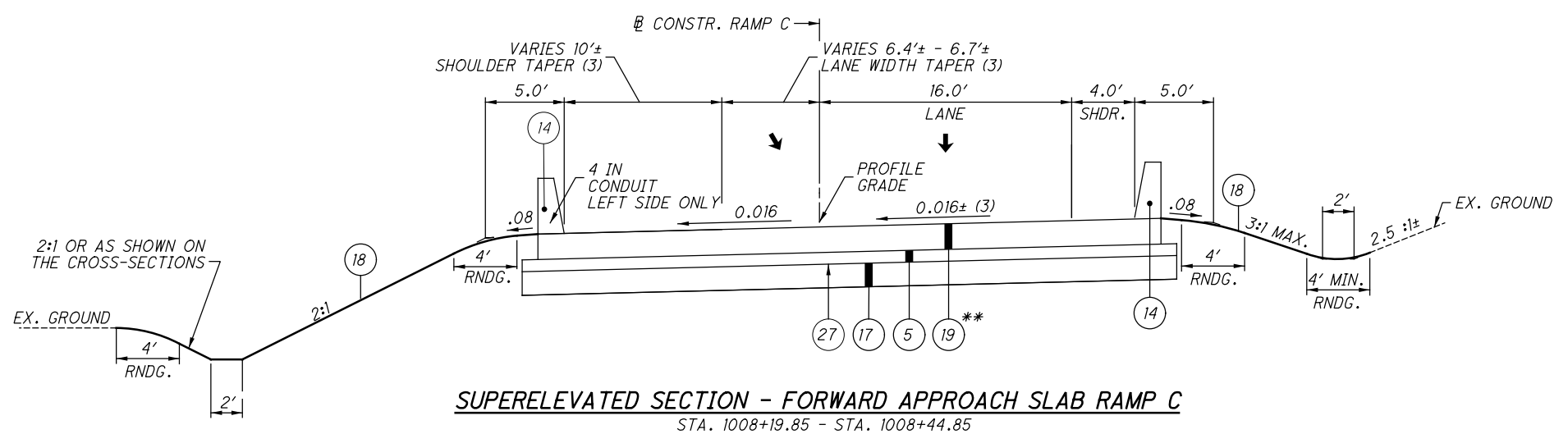

**SUPERELEVATED SECTION - FORWARD APPROACH SLAB RAMP C**  
STA. 1008+19.85 - STA. 1008+44.85

**\*\* APPROACH SLAB INSTALLATION**  
DETAILS FOR APPROACH SLAB INSTALLATION TYPE A ARE NOT SHOWN: INCLUDING SLEEPER SLAB, POLYMER MODIFIED ASPHALT JOINT SYSTEM AND ASPHALT PAVEMENT TRANSITIONS. SEE STD. DWG. AS-2-15 FOR ADDITIONAL INFORMATION. INTEGRAL LT/RT CURBS ARE REQUIRED, TRANSVERSE UNDERDRAIN IS NOT REQUIRED.

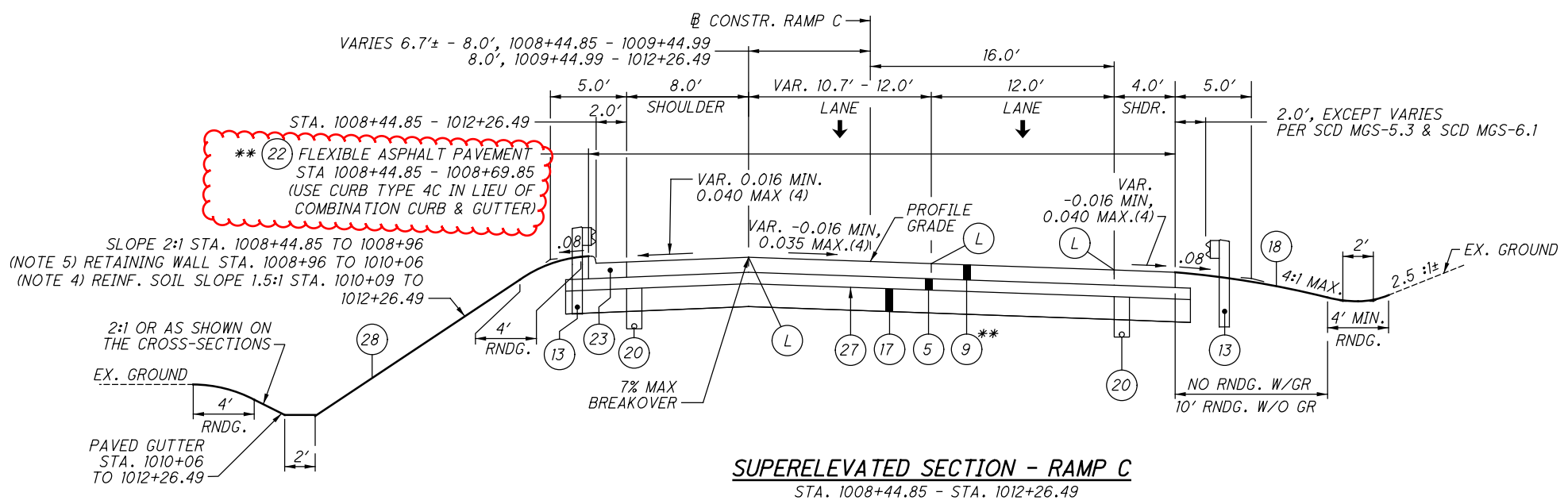

**SUPERELEVATED SECTION - RAMP C**  
STA. 1008+44.85 - STA. 1012+26.49

**\*\* (22) FLEXIBLE ASPHALT PAVEMENT**  
STA 1008+44.85 - 1008+69.85  
(USE CURB TYPE 4C IN LIEU OF COMBINATION CURB & GUTTER)

SLOPE 2:1 STA. 1008+44.85 TO 1008+96  
(NOTE 5) RETAINING WALL STA. 1008+96 TO 1010+06  
(NOTE 4) REINF. SOIL SLOPE 1.5:1 STA. 1010+09 TO 1012+26.49

- NOTES**
1. FOR LEGEND SEE SHEET 3
  2. TRIM AND CUT EXISTING PAVEMENT EDGE, PER CMS SECTION 203.04 E. ONE INCH ASSUMED FOR ESTIMATING PURPOSES.
  3. FOR ADDITIONAL DETAILS, SEE PAVEMENT DETAIL SHEET 65.
  4. FOR REINFORCED SOIL SLOPE SEE SHEETS 70 & 71
  5. FOR RETAINING WALL, SEE SHEET 69
  6. REFER TO SUPERELEVATION TABLE, SHEET 64

L:\DCS\Projects\TRN\60546197\_WCTIDFEINT\000\104844\Design\Roadway\Sheets\104844\_GY003.dgn Sheet 5/10/2021 10:04:39 AM dave.wormaid

**ITEM 614, MAINTAINING TRAFFIC**

THREE LANES OF TRAFFIC ALONG I-71 SB, TWO LANES OF TRAFFIC ALONG RAMP B, AND ALL ORIGINAL LANES OF TRAFFIC ALONG FIELDS- ERTEL ROAD, MASON- MONTGOMERY ROAD, AND ESCORT DRIVE SHALL BE MAINTAINED AT ALL TIMES EXCEPT AS NOTED IN THESE PLANS, BY USE OF THE EXISTING PAVEMENT, THE COMPLETED PAVEMENT, ITEM 615 PAVEMENT FOR MAINTAINING TRAFFIC CLASS A OR B AND TEMPORARY SURFACES USING ITEM 614.

SEE PERMITTED LANE CLOSURE TIMES AND UNAUTHORIZED LANE USE TABLE.

NO WORK SHALL BE PERFORMED AND ALL EXISTING LANES SHALL BE OPEN TO TRAFFIC DURING THE FOLLOWING DESIGNATED HOLIDAYS OR EVENTS:

CHRISTMAS FOURTH OF JULY  
NEW YEARS LABOR DAY  
MEMORIAL DAY THANKSGIVING

THE PERIOD OF TIME THAT THE LANES ARE TO BE OPEN DEPENDS ON THE DAY OF THE WEEK ON WHICH THE HOLIDAY OR EVENT FALLS. THE FOLLOWING SCHEDULE SHALL BE USED TO DETERMINE THIS PERIOD:

DAY OF HOLIDAY OR EVENT	TIME ALL LANES MUST BE OPEN TO TRAFFIC
SUNDAY	12:00N FRIDAY THROUGH 6:00AM MONDAY
MONDAY	12:00N FRIDAY THROUGH 6:00AM TUESDAY
TUESDAY	12:00N MONDAY THROUGH 6:00AM WEDNESDAY
WEDNESDAY	12:00N TUESDAY THROUGH 6:00AM THURSDAY
THURSDAY	12:00N WEDNESDAY THROUGH 6:00AM FRIDAY (THANKSGIVING ONLY)
FRIDAY	6:00AM WEDNESDAY THROUGH 6:00AM MONDAY
FRIDAY	12:00N THURSDAY THROUGH 6:00AM MONDAY
SATURDAY	12:00N FRIDAY THROUGH 6:00AM MONDAY

SHOULD THE CONTRACTOR FAIL TO MEET ANY OF THESE REQUIREMENTS, THE CONTRACTOR SHALL BE ASSESSED A DISINCENTIVE PER THE PERMITTED LANE CLOSURE TIMES AND UNAUTHORIZED LANE USE TABLE.

NOTICE OF CLOSURE SIGNS, AS DETAILED IN THESE PLANS, SHALL BE ERECTED BY THE CONTRACTOR AT LEAST ONE WEEK IN ADVANCE OF THE SCHEDULED ROAD CLOSURE.

THE SIGNS SHALL BE ERECTED ON THE RIGHT-HAND SIDE OF THE ROAD FACING TRAFFIC. THEY SHALL BE PLACED SO AS NOT TO INTERFERE WITH THE VISIBILITY OF ANY OTHER TRAFFIC CONTROL SIGNS. ON ROADWAYS, THEY SHOULD BE ERECTED AT THE POINT OF CLOSURE.

FIELDS ERTEL WILL BE CLOSED FOR DAYS  
OHIO DEPT OF TRANSPORTATION

W20-H14-60

THE CONTRACTOR SHALL PROVIDE, ERECT AND MAINTAIN STANDARD 48 X 30 INCH ROAD CLOSED SIGNS, SIGN SUPPORTS, BARRICADES, GATES AND LIGHTS, AS DETAILED IN SCD MT-101.60 AT THE FOLLOWING LOCATIONS DURING PERIODS IN WHICH THE AFFECTED ROADS ARE CLOSED TO TRAFFIC:

FIELDS ERTEL ROAD JUST EAST OF ESCORT DRIVE AND JUST WEST OF MASON- MONTGOMERY ROAD.

LENGTH AND DURATION OF LANE CLOSURES AND RESTRICTIONS SHALL BE AT THE APPROVAL OF THE ENGINEER. IT IS THE INTENT TO MINIMIZE THE IMPACT TO THE TRAVELING PUBLIC. LANE CLOSURES OR RESTRICTIONS OVER SEGMENTS OF THE PROJECT IN WHICH NO WORK IS ANTICIPATED WITHIN A REASONABLE TIME FRAME, AS DETERMINED BY THE ENGINEER, SHALL NOT BE PERMITTED. THE LEVEL OF UTILIZATION OF MAINTENANCE OF TRAFFIC DEVICES SHALL BE COMMENSURATE WITH THE WORK IN PROGRESS.

ALL WORK AND TRAFFIC CONTROL DEVICES SHALL BE IN ACCORDANCE WITH C&MS 614 AND OTHER APPLICABLE PORTIONS OF THE SPECIFICATIONS, AS WELL AS THE OHIO MANUAL OF UNIFORM TRAFFIC CONTROL DEVICES. PAYMENT FOR ALL LABOR, EQUIPMENT AND MATERIALS SHALL BE INCLUDED IN THE LUMP SUM CONTRACT PRICE FOR ITEM 614, MAINTAINING TRAFFIC, UNLESS SEPARATELY ITEMIZED IN THE PLAN.

**ITEM 611, CATCH BASIN RECONSTRUCTED TO GRADE, AS PER PLAN**

THIS WORK CONSISTS OF REMOVING THE UPPER PORTION OF THE EXISTING CATCH BASIN, COVERING THE OPENING WITH A STEEL PLATE SUITABLE FOR TRAFFIC, THEN WHEN TRAFFIC IS RETURNED TO THE ORIGINAL TRAFFIC PATTERN RECONSTRUCT THE CATCH BASIN TO MEET THE REQUIREMENTS OF CATCH BASIN NO. 3 OR 3A, AS APPROPRIATE.

REMOVED PORTIONS SHALL INCLUDE THE CURB AND CASTINGS, AND IF NECESSARY THE FRAME, GRATE(S), AND STEEL BEAM.

COVER THE INLET WITH A STEEL PLATE SUITABLE FOR TRAFFIC. PLATES SHALL BE 1" MINIMUM THICKNESS IN SMOOTH CONDITION WITHOUT BOWS OR ROUGH EDGES. PLATES SHALL BE RECESSED TO FIT NEATLY IN THE PAVEMENT AS SHOWN ON THE SKETCH ON SHEET 18 SUITABLE FOR PASSAGE OF TRAFFIC AND SNOW REMOVAL EQUIPMENT.

RECONSTRUCT CATCH BASIN ACCORDING TO SCD CB-2.1 OR CB-2.2 AS APPROPRIATE. IF EXISTING CONCRETE WAS SAWCUT AND/OR BROKEN, PROVIDE STEEL DOWELS HAVING DIAMETER >=0.5", LENGTH >=8" (HALF EMBEDDED), SPACING <=18".

ALL MATERIALS, EQUIPMENT, LABOR, AND INCIDENTALS REQUIRED TO PERFORM THIS WORK SHALL BE INCLUDED IN THE PRICE BID PER EACH FOR ITEM 611, CATCH BASIN RECONSTRUCTED TO GRADE, AS PER PLAN.

**ITEM 615, PAVEMENT FOR MAINTAINING TRAFFIC, CLASS B**

THIS WORK SHALL INCLUDE ANY NEEDED RESTORATION OF PERMANENT FLEXIBLE PAVEMENT ALONG THE OUTSIDE EDGES OF FIELDS ERTEL ROAD. CONCRETE CURB AND GUTTER SHALL BE REPLACED IN THE SAME LOCATION AS ORIGINAL AND SHALL BE SEPARATELY ITEMIZED.

ALL MATERIALS, EQUIPMENT, LABOR, AND INCIDENTALS REQUIRED TO PERFORM THIS WORK SHALL BE INCLUDED IN THE PRICE BID PER SQUARE YARD FOR ITEM 615, PAVEMENT FOR MAINTAINING TRAFFIC, CLASS B, UNLESS OTHERWISE INCLUDED IN THESE PLANS.

**PLACEMENT OF ASPHALT CONCRETE**

TRAFFIC SHALL BE MAINTAINED AT ALL TIMES EXCEPT THAT LANE RESTRICTIONS WILL BE PERMITTED FOR MINIMUM PERIODS OF TIME CONSISTENT WITH THE REQUIREMENTS OF THE SPECIFICATIONS FOR PROTECTION OF COMPLETED ASPHALT CONCRETE COURSES.

**TRENCH FOR WIDENING**

TRENCH EXCAVATION FOR BASE WIDENING SHALL BE ONLY ON ONE SIDE OF THE PAVEMENT AT A TIME. THE OPEN TRENCH SHALL BE ADEQUATELY MAINTAINED AND PROTECTED WITH DRUMS OR BARRICADES AT ALL TIMES. PLACEMENT OF PROPOSED SUBBASE AND BASE MATERIAL SHALL FOLLOW AS CLOSELY AS POSSIBLE BEHIND EXCAVATION OPERATIONS. THE LENGTH OF WIDENING TRENCH WHICH IS OPEN AT ANY ONE TIME SHALL BE HELD TO A MINIMUM AND SHALL AT ALL TIMES BE SUBJECT TO APPROVAL OF THE ENGINEER.

**OVERNIGHT TRENCH CLOSING**

THE BASE WIDENING SHALL BE COMPLETED TO A DEPTH OF NO MORE THAN 13.25 INCHES BELOW THE EXISTING PAVEMENT BY THE END OF EACH WORK DAY. NO TRENCH SHALL BE LEFT OPEN OVERNIGHT EXCEPT FOR A SHORT LENGTH (25 FEET OR LESS) OF A WORK SECTION AT THE END OF THE TRENCH. IN CASE WORK MUST BE SUSPENDED BECAUSE OF INCLEMENT WEATHER OR OTHER REASONS, THE TRENCH FOR THE UNCOMPLETED BASE WIDENING SHALL BE BACKFILLED AT THE DIRECTION OF THE ENGINEER.

**DUST CONTROL**

THE CONTRACTOR SHALL FURNISH AND APPLY WATER FOR DUST CONTROL AS DIRECTED BY THE ENGINEER. THE FOLLOWING ESTIMATED QUANTITIES HAVE BEEN INCLUDED FOR DUST CONTROL PURPOSES:

ITEM 616, WATER 30 M. GAL.

**WORK ZONE MARKINGS AND SIGNS**

THE FOLLOWING ESTIMATED QUANTITIES HAVE BEEN CARRIED TO THE GENERAL SUMMARY FOR USE AT LOCATIONS IDENTIFIED BY THE ENGINEER FOR WORK ZONE PAVEMENT MARKINGS AND SIGNS PER THE REQUIREMENTS OF C&MS 614.04 AND 614.11.

ITEM 614 WORK ZONE LANE LINE, 4", 0.25 MILE  
ITEM 614 WORK ZONE EDGE LINE, 4", 0.50 MILE  
ITEM 614 WORK ZONE CENTERLINE, 0.10 MILE  
ITEM 614 WORK ZONE, CHANNELIZING LINE, 1,000 FT

**FLOODLIGHTING**

FLOODLIGHTING OF THE WORK SITE FOR OPERATIONS CONDUCTED DURING NIGHTTIME PERIODS SHALL BE ACCOMPLISHED SO THAT THE LIGHTS DO NOT CAUSE GLARE TO THE DRIVERS ON THE ROADWAY. TO ENSURE THE ADEQUACY OF THE FLOODLIGHT PLACEMENT, THE CONTRACTOR AND THE ENGINEER SHALL DRIVE THROUGH THE WORK SITE EACH NIGHT WHEN THE LIGHTING IS IN PLACE AND OPERATIVE PRIOR TO COMMENCING ANY WORK. IF GLARE IS DETECTED, THE LIGHT PLACEMENT AND SHIELDING SHALL BE ADJUSTED TO THE SATISFACTION OF THE ENGINEER BEFORE WORK PROCEEDS.

PAYMENT FOR ALL LABOR, EQUIPMENT AND MATERIALS SHALL BE INCLUDED IN THE LUMP SUM CONTRACT PRICE FOR ITEM 614, MAINTAINING TRAFFIC.

**ITEM 614, WORK ZONE IMPACT ATTENUATOR FOR MORE THAN 24" WIDE BUT LESS THAN 36" HAZARDS. HAZARDS (UNIDIRECTIONAL OR BIDIRECTIONAL)**

THIS ITEM SHALL CONSIST OF FURNISHING AND INSTALLING A NON GATING IMPACT ATTENUATOR. FURNISH AN IMPACT ATTENUATOR FROM THE OFFICE OF ROADWAY ENGINEERING'S APPROVED LIST FOR WORK ZONE IMPACT ATTENUATORS, FROM THE ROADWAY STANDARDS APPROVED PRODUCTS WEB PAGE.

INSTALLATION SHALL BE AT THE LOCATIONS SPECIFIED IN THE PLANS IN ACCORDANCE WITH THE MANUFACTURER'S SPECIFICATIONS.

THE CONTRACTOR SHALL REPAIR OR REPLACE A DAMAGED UNIT WITHIN 24 HOURS OF A DAMAGING IMPACT.

WHEN BIDIRECTIONAL DESIGNS ARE SPECIFIED, THE CONTRACTOR SHALL SUPPLY APPROPRIATE TRANSITIONS.

WHEN GATING IMPACT ATTENUATORS ARE DESIRED, THE CONTRACTOR SHALL SUBMIT DOCUMENTATION TO THE ENGINEER FOR ACCEPTANCE.

THE COST FOR THE ADDITIONAL BARRIER REQUIRED FOR A GATING IMPACT ATTENUATOR SHALL BE INCLUDED IN THE COST OF THE GATING IMPACT ATTENUATOR.

PAYMENT FOR THE ABOVE WORK SHALL BE MADE AT THE UNIT PRICE BID AND SHALL INCLUDE ALL LABOR, TOOLS, EQUIPMENT AND MATERIALS NECESSARY TO CONSTRUCT AND MAINTAIN A COMPLETE AND FUNCTIONAL IMPACT ATTENUATOR SYSTEM, INCLUDING ALL RELATED BACKUPS, TRANSITIONS, LEVELING PADS, HARDWARE AND GRADING, NOT SEPARATELY SPECIFIED, AS REQUIRED BY THE MANUFACTURER.

**ITEM 614, WORK ZONE IMPACT ATTENUATOR OVER 24" AND LESS THAN 36" HAZARDS, BIDIRECTIONAL, AS PER PLAN (GATING).**

THIS ITEM SHALL CONSIST OF FURNISHING AND INSTALLING A GATING IMPACT ATTENUATOR. FURNISH AN IMPACT ATTENUATOR FROM THE OFFICE OF ROADWAY ENGINEERING'S APPROVED LIST FOR WORK ZONE IMPACT ATTENUATORS, FROM THE ROADWAY STANDARDS APPROVED PRODUCTS WEB PAGE.

INSTALLATION SHALL BE AT THE LOCATION SPECIFIED IN THE PLANS IN ACCORDANCE WITH THE MANUFACTURER'S SPECIFICATIONS.

L:\DCS\Projects\TRN\60546197\_WCTDFEINT\0DOT\104844\Design\W0T\Sheets\104844\_MN002.dgn Sheet 5/7/2021 2:47:37 PM dave.wormaid

CALCULATED  
CAL  
CHECKED  
DLW

MAINTENANCE OF TRAFFIC GENERAL NOTES

HAM / WAR-71  
19.83 / 0.00

MATCHLINE STA. 22+00 FIELDS-ERTEL RD., SEE ABOVE

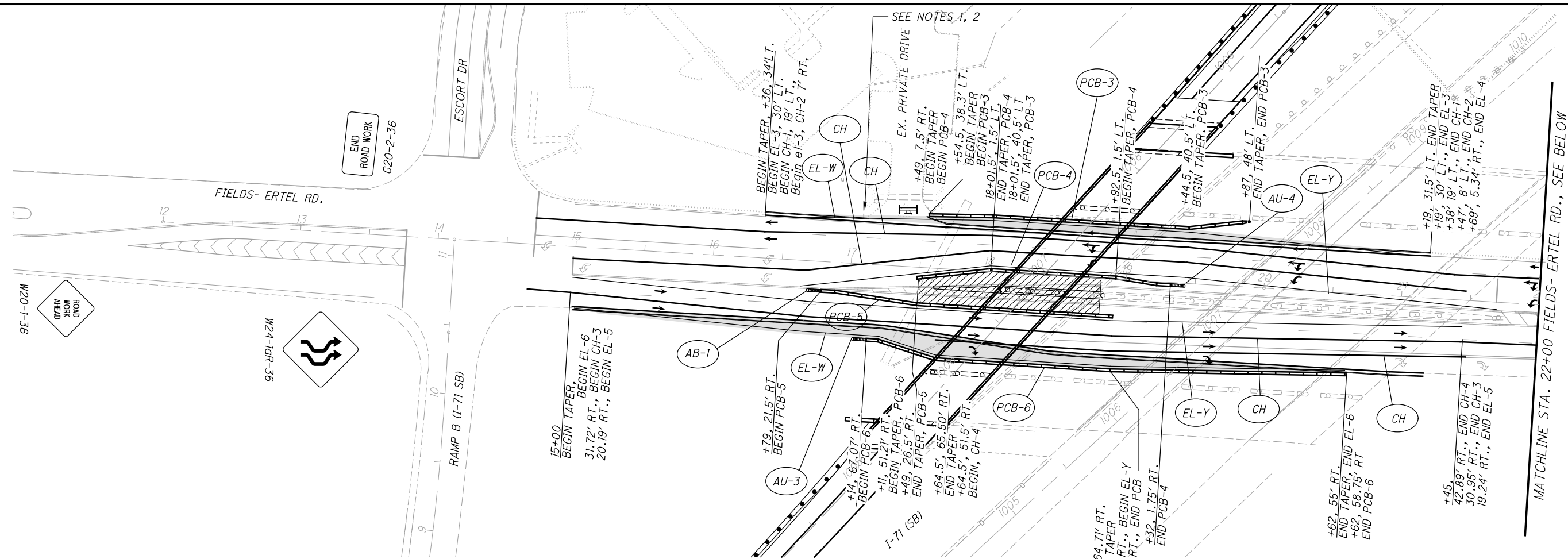
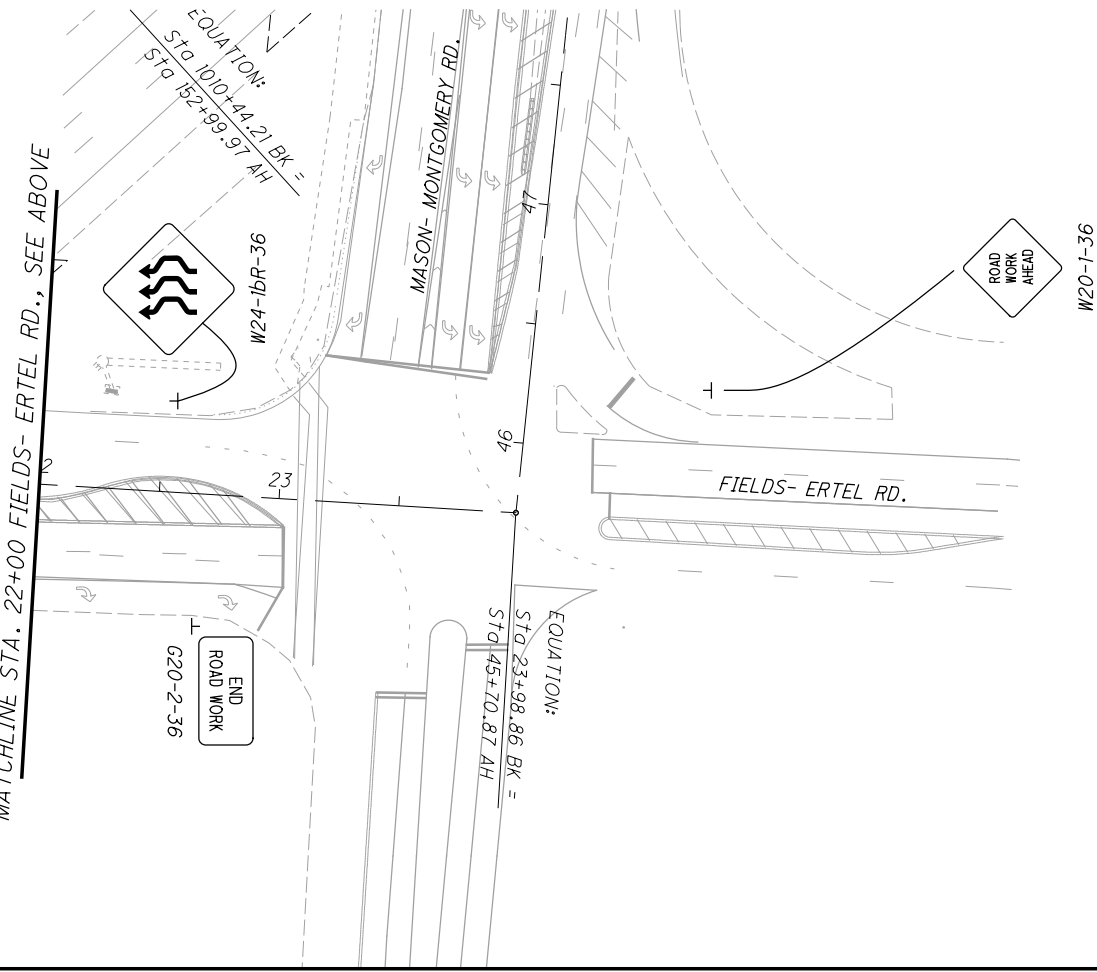

**MAINTENANCE OF TRAFFIC  
FIELDS ERTEL RD**

**HAM / WAR-71  
19.83 / 0.00**

NOTES:

- 1. EXISTING CATCH BASINS SHALL BE MODIFIED WITH DROP INLET FRAMES WHERE LOCATED WITHIN TEMPORARY PAVEMENT FOR MAINTAINING TRAFFIC. PROVIDE TEMPORARY ROADSIDE DITCH WHERE CURB IS REMOVED FOR PORTABLE CONCRETE BARRIER. DRAINAGE MODIFICATIONS AND RESTORATION TO ORIGINAL CONDITION ARE INCIDENTAL TO ITEM 611 CATCH BASIN RECONSTRUCTED TO GRADE, AS PER PLAN.
- 2. EARTHWORK SHALL BE INCLUDED WITH ITEM 615, PAVEMENT FOR MAINTAINING TRAFFIC, CLASS B.
- 3. PIERS 1 AND 3 MAY BE CONSTRUCTED PRIOR TO OR FOLLOWING CONSTRUCTION OF PIER 2 (MEDIAN). PORTABLE CONCRETE BARRIERS WILL BE LOCATED OUTSIDE OF THE EXISTING CURBS DURING CONSTRUCTION OF PIERS 1 AND 3. DAYTIME LANE REDUCTIONS ARE NOT PERMITTED FOR PIER 1 AND 3 CONSTRUCTION.
- 4. THE PROPERTY SERVICED BY THE DRIVEWAY PROPOSED FOR CLOSURE HAS TWO ALTERNATE ACCESS POINTS FROM ESCORT DRIVE. NOTIFY PROPERTY OWNER 14 DAYS PRIOR TO DRIVEWAY CLOSURE.
- 5. SEE STD. DRAWING MT-102.10 FOR SIGNS AND ADDITIONAL INFORMATION.
- 6. REFER TO GENERAL NOTES FOR TEMPORARY LANE OR ROAD CLOSURES.
- 7. SEE SHEET FOR TEMPORARY FIELDS-ERTEL RD. CLOSURE DETOUR PLAN.

- WORK AREA: PIER 2 CONSTRUCTION (PIERS 1 AND 3 NOT SHOWN)
- ITEM 615, PAVEMENT FOR MAINTAINING TRAFFIC, CLASS B
- PORTABLE CONCRETE BARRIER, 32" UNANCHORED
- BARRICADE, TYPE III

MATCHLINE STA. 22+00 FIELDS-ERTEL RD., SEE BELOW



SHEET NUM.										PART.			ITEM	ITEM EXT	GRAND TOTAL	UNIT	DESCRIPTION	SEE SHEET NO.	CALCULATED	CAL	CHECKED	SCC
28	29	71	130							01MPOOT	02ENHOT											
<b>ROADWAY</b>																						
LS										LS			201	11000	LS		CLEARING AND GRUBBING					
2										2			202	20010	2	EACH	HEADWALL REMOVED					
22										22			202	23000	22	SY	PAVEMENT REMOVED					
360											360		202	30000	360	SF	WALK REMOVED					
55										55			202	30700	55	FT	CONCRETE BARRIER REMOVED					
287										287			202	32000	287	FT	CURB REMOVED					
465										465			202	32500	465	FT	CURB AND GUTTER REMOVED					
93										93			202	34900	93	FT	PIPE REMOVED					
601										601			202	38000	601	FT	GUARDRAIL REMOVED					
2										2			202	58200	2	EACH	INLET REMOVED					
			835							835			202	75000	835	FT	FENCE REMOVED					
61										61			202	98200	61	FT	REMOVAL MISC.: PAVED GUTTER				28	
2,397		79								2,476			203	10000	2,476	CY	EXCAVATION					
23,096										23,096			203	20000	23,096	CY	EMBANKMENT					
		118								118			203	35120	118	CY	GRANULAR MATERIAL, TYPE C				11	
2										2			SPECIAL	20365000	2	EACH	SETTLEMENT PLATFORM				11	
2										2			204	45000	2	HOUR	PROOF ROLLING					
		768								768			204	50000	768	SY	GEOTEXTILE FABRIC					
149										149			206	10500	149	TON	CEMENT					
5,754										5,754			206	11000	5,754	SY	CURING COAT					
5,754										5,754			206	15010	5,754	SY	CEMENT STABILIZED SUBGRADE, 12 INCHES DEEP					
LS										LS			206	30000	LS		MIXTURE DESIGN FOR CHEMICALLY STABILIZED SOILS					
	1,038									1,038			606	15050	1,038	FT	GUARDRAIL, TYPE MGS					
	2									2			606	26150	2	EACH	ANCHOR ASSEMBLY, MGS TYPE E MASH 2016					
	1									1			606	26550	1	EACH	ANCHOR ASSEMBLY, MGS TYPE T					
	2									2			606	35002	2	EACH	MGS BRIDGE TERMINAL ASSEMBLY, TYPE 1					
	1									1			606	35102	1	EACH	MGS BRIDGE TERMINAL ASSEMBLY, TYPE 2					
	1									1			606	60028	1	EACH	IMPACT ATTENUATOR, TYPE 2 (BIDIRECTIONAL)					
			718							718			607	23000	718	FT	FENCE, TYPE CLT					
	2,495										2,495		608	10000	2,495	SF	4" CONCRETE WALK					
	428										428		608	52000	428	SF	CURB RAMP					
	148									148			622	10060	148	FT	CONCRETE BARRIER, SINGLE SLOPE, TYPE B					
	1									1			622	24841	1	EACH	CONCRETE BARRIER END SECTION, TYPE B, AS PER PLAN				67	
													623	38500	4	EACH	MONUMENT ASSEMBLY				132	
		1,745								1,745			863	00100	1,745	SY	GEOGRID, TYPE P1					
		462								462			863	00600	462	SY	GEOGRID, TYPE S1					
		1,295								1,295			863	00800	1,295	CY	REINFORCED EMBANKMENT					
LS										LS			878	25000	LS		INSPECTION AND COMPACTION TESTING OF UNBOUND MATERIALS					

**GENERAL SUMMARY**

**HAM / WAR-71**  
**19.83 / 0.00**

L:\DCS\Projects\TRN\6054697\_WCTDFEINT\000T\04844\Design\Roadway\Sheets\104844\_G600.dgn\_Sheet 5/10/2021 2:54:47 PM dave.worland

L:\DCS\Projects\TRN\6054697\_WCTDFEINT\000T\04844\Design\Roadway\Sheets\104844\_G6002.dgn Sheet 5/10/2021 9:54:41 AM dave.wormald

SHEET NUM.										PART.		ITEM	ITEM EXT	GRAND TOTAL	UNIT	DESCRIPTION	SEE SHEET NO.	CALCULATED	CAL	CHECKED	SCC
30	31	32	71							01MPOOT	02ENHOT										
<b>EROSION CONTROL</b>																					
		1.8								1.8		601	21050	1.8	SY	TIED CONCRETE BLOCK MAT WITH TYPE 1 UNDERLAYMENT					
9										13		601	21060	13	SY	TIED CONCRETE BLOCK MAT WITH TYPE 2 UNDERLAYMENT	9				
9										9		601	32200	9	CY	ROCK CHANNEL PROTECTION, TYPE C WITH FILTER					
20										20		601	32300	20	CY	ROCK CHANNEL PROTECTION, TYPE D WITH FILTER					
287										287		601	37500	287	FT	PAVED GUTTER, TYPE 1-2					
139										139		601	38400	139	FT	PAVED GUTTER, TYPE 2					
148										148		601	39500	148	FT	PAVED GUTTER, TYPE 5					
										62		616	10000	62	MGAL	WATER				10	
										2		659	00100	2	EACH	SOIL ANALYSIS TEST				10	
67			435							1,299		659	00300	1,299	CY	TOPSOIL				10	
										435		659	00530	435	SY	SEEDING AND MULCHING, CLASS 3B				10	
										11,533		659	10000	11,533	SY	SEEDING AND MULCHING				10	
										576		659	14000	576	SY	REPAIR SEEDING AND MULCHING				10	
										1.5		659	20000	1.5	TON	COMMERCIAL FERTILIZER				10	
										2.38		659	31000	2.38	ACRE	LIME					
										25		659	40000	25	MSF	MOWING					
600			435							1,035		670	00500	1,035	SY	SLOPE EROSION PROTECTION					
271										271		670	00700	271	SY	DITCH EROSION PROTECTION					
270										270		670	00710	270	SY	DITCH EROSION PROTECTION MAT, TYPE A					
										LS		832	15000	LS		STORM WATER POLLUTION PREVENTION PLAN					
										LS		832	15002	LS		STORM WATER POLLUTION PREVENTION INSPECTIONS					
										LS		832	15010	LS		STORM WATER POLLUTION PREVENTION INSPECTION SOFTWARE					
										74,280		832	30000	74,280	EACH	EROSION CONTROL					
<b>DRAINAGE</b>																					
	2									2		602	20000	2	CY	CONCRETE MASONRY					
		3,415								3,415		605	14000	3,415	FT	6" BASE PIPE UNDERDRAINS					
		377								387		611	00510	387	FT	6" CONDUIT, TYPE F FOR UNDERDRAIN OUTLETS				9	
		21								31		611	01500	31	FT	6" CONDUIT, TYPE F				9	
		1								2		611	99710	2	EACH	PRECAST REINFORCED CONCRETE OUTLET				9	
	46									46		611	04600	46	FT	12" CONDUIT, TYPE C					
	12									12		611	05200	12	FT	12" CONDUIT, TYPE F					
	185									185		611	05900	185	FT	15" CONDUIT, TYPE B					
	47									47		611	06100	47	FT	15" CONDUIT, TYPE C					
	65									65		611	06700	65	FT	15" CONDUIT, TYPE F, 707.05 TYPE C OR 707.21					
	249									249		611	07400	249	FT	18" CONDUIT, TYPE B					
	81									81		611	13400	81	FT	30" CONDUIT, TYPE B					
	663									663		611	16400	663	FT	36" CONDUIT, TYPE B					
	24									24		611	16600	24	FT	36" CONDUIT, TYPE C					
	173									173		611	22600	173	FT	54" CONDUIT, TYPE C					
	24									24		611	23800	24	FT	60" CONDUIT, TYPE B					
	8									8		611	53104	8	FT	43" X 68" CONDUIT, TYPE C, 706.04					
	26									26		611	97010	26	FT	SLOTTED DRAIN, TYPE 2 (15")					
	2									2		611	98150	2	EACH	CATCH BASIN, NO. 3					
	2									2		611	98180	2	EACH	CATCH BASIN, NO. 3A					
	2									2		611	98370	2	EACH	CATCH BASIN, NO. 6					
	2									2		611	98450	2	EACH	CATCH BASIN, NO. 2-2A					
	6									6		611	99574	6	EACH	MANHOLE, NO. 3					
	4									4		611	99155	4	EACH	INLET RECONSTRUCTED TO GRADE, AS PER PLAN				13	
	2									2		611	99654	2	EACH	MANHOLE ADJUSTED TO GRADE					

**GENERAL SUMMARY**

**HAM / WAR-71  
19.83 / 0.00**

SHEET NUM.										PART.		ITEM	ITEM EXT	GRAND TOTAL	UNIT	DESCRIPTION	SEE SHEET NO.	CALCULATED CAL	CHECKED	SCC
29	33	81	82	95	97					01MPOOT	02ENHOT									
<b>PAVEMENT</b>																				
	92									92		254	01000	92	SY	PAVEMENT PLANING, ASPHALT CONCRETE 1.5"				
	3,035									3,035		254	01000	3,035	SY	PAVEMENT PLANING, ASPHALT CONCRETE VARIABLE DEPTH				
	853									853		302	46000	853	CY	ASPHALT CONCRETE BASE, PG64-22				
	1,138									1,138		304	20000	1,138	CY	AGGREGATE BASE				
	438									438		407	10000	438	GAL	TACK COAT				
	289									289		442	20000	289	CY	ASPHALT CONCRETE SURFACE COURSE, 12.5 MM, TYPE A (448)				
	151									151		442	20200	151	CY	ASPHALT CONCRETE INTERMEDIATE COURSE, 19 MM, TYPE A (448)				
	2,329									2,329		452	12010	2,329	SY	8" NON-REINFORCED CONCRETE PAVEMENT, CLASS QC 1P				
	1,583									1,583		609	12000	1,583	FT	COMBINATION CURB AND GUTTER, TYPE 2				
	480									480		609	23001	480	FT	COMBINATION CURB AND GUTTER, TYPE 4, AS PER PLAN				10
	29									29		609	24510	29	FT	CURB, TYPE 4-C				10
	265									265		609	30001	265	FT	CURB, TYPE 8, AS PER PLAN				10
		1,021								1,021		618	40100	1,021	FT	RUMBLE STRIPS, SHOULDER (ASPHALT CONCRETE)				
	5									5		617	10100	5	CY	COMPACTED AGGREGATE				
										LS		SPECIAL	69098400	LS		CONSULTANT FOR CONCRETE QUALITY CONTROL INCLUDING TESTING AND INSPECTION				10
<b>LIGHTING</b>																				
					8					8		625	00450	8	EACH	CONNECTION, FUSED PULL APART				
					2					2		625	00460	2	EACH	CONNECTION, UNFUSED PULL APART				
					6					6		625	00480	6	EACH	CONNECTION, UNFUSED PERMANENT				
					3					3		625	10490	3	EACH	LIGHT POLE, CONVENTIONAL				
					3					3		625	14000	3	EACH	LIGHT POLE FOUNDATION, 24" X 6' DEEP				
					2					2		625	18200	2	EACH	BRACKET ARM, 15'				
					735					735		625	23400	735	FT	NO. 10 AWG POLE AND BRACKET CABLE				
					1,652					1,652		625	24000	1,652	FT	1-1/2" DUCT CABLE WITH TWO NO. 4 AWG 600 VOLT CABLES				
					62					62		625	25500	62	FT	CONDUIT, 3", 725.04				
					62					62		625	25900	62	FT	CONDUIT, JACKED OR DRILLED, 3"				
					8					8		625	26252	8	EACH	LUMINAIRE, CONVENTIONAL, SOLID STATE (LED), 150W				
					1,530					1,530		625	29002	1,530	FT	TRENCH, 24" DEEP				
					3					3		625	30706	3	EACH	PULL BOX, 725.08, 24"				
					3					3		625	32000	3	EACH	GROUND ROD				
					1					1		625	34001	1	EACH	POWER SERVICE, AS PER PLAN				96
					1,592					1,592		625	36010	1,592	FT	UNDERGROUND WARNING/MARKING TAPE				
					2					2		625	39520	2	EACH	PULL BOX CLEANED				
					LS					LS		SPECIAL	62540000	LS		MAINTAIN EXISTING LIGHTING				95
					3					3		625	75506	3	EACH	LUMINAIRE REMOVED				
					1					1		625	75801	1	EACH	DISCONNECT CIRCUIT, AS PER PLAN				96
					1					1		632	89300	1	EACH	WOOD POLE				
<b>TRAFFIC SURVEILLANCE</b>																				
					235					235		625	25752	235	FT	CONDUIT, 4", MULTICELL, 725.20 , EPC-80, AS PER PLAN				92
					1					1		625	25930	1	EACH	CONDUIT, MISC.:CONDUIT REMOVED				92
					44					44		625	29000	44	FT	TRENCH				
					1					1		625	30700	1	EACH	PULL BOX, 725.08, 18"				
					2					2		625	30710	2	EACH	PULL BOX, 725.08, 32"				
					1					1		625	31510	1	EACH	PULL BOX REMOVED				
					1					1		625	32000	1	EACH	GROUND ROD				
					44					44		625	36010	44	FT	UNDERGROUND WARNING/MARKING TAPE				92
					1					1		625	39520	1	EACH	PULL BOX CLEANED				
					1					1		633	67100	1	EACH	CABINET FOUNDATION				
					1					1		633	67200	1	EACH	CONTROLLER WORK PAD				
					1					1		804	30000	1	EACH	FAN-OUT KIT, 6 FIBER				
					2					2		804	32000	2	EACH	DROP CABLE, 6 FIBER				
					4					4		804	35000	4	EACH	FUSION SPLICE				
					1					1		809	60040	1	EACH	CCTV IP-CAMERA SYSTEM, QUAD MULTI-VIEW FIXED WITH PTZ				
					1					1		809	65000	1	EACH	ITS CABINET - GROUND MOUNTED				

**GENERAL SUMMARY**

**HAM / WAR-71  
19.83 / 0.00**

L:\DCS\Projects\TRN\6054697\_WCTDFEINT\000T\04844\Design\Roadway\Sheets\04844\_G6003.dgn Sheet 5/10/2021 11:33:29 AM dave.wormald

SHEET NUM.										PART.		ITEM	ITEM EXT	GRAND TOTAL	UNIT	DESCRIPTION	SEE SHEET NO.	CALCULATED	CHECKED	DLW
16										01MPOOT	02ENHOT									
<b>FOR STRUCTURE HAM 71 19.83 GENERAL SUMMARY SEE SHEET 102</b>																				
MAINTENANCE OF TRAFFIC																				
200										200		614	1110	200	HOUR	LAW ENFORCEMENT OFFICER WITH PATROL CAR FOR ASSISTANCE				
										1,461		614	11630	1,461	FT	INCREASED BARRIER DELINEATION				13
5										5		614	12394	5	EACH	WORK ZONE IMPACT ATTENUATOR, OVER 24" AND LESS THAN 36" WIDE HAZARDS, (BIDIRECTIONAL)				16
1										1		614	12400	1	EACH	WORK ZONE IMPACT ATTENUATOR, OVER 24" AND LESS THAN 36" WIDE HAZARDS, AS PER PLAN, GATING				16
LS										LS		614	12420	LS	LS	DETOUR SIGNING				
462										462		614	12800	462	EACH	WORK ZONE RAISED PAVEMENT MARKER				
										5		614	13000	5	CY	ASPHALT CONCRETE FOR MAINTAINING TRAFFIC				10
										15		614	13310	15	EACH	BARRIER REFLECTOR, TYPE 1 ONE-WAY				15
										15		614	13350	15	EACH	OBJECT MARKER, ONE WAY				15
12										12		614	18601	12	SNMT	PORTABLE CHANGEABLE MESSAGE SIGN, AS PER PLAN				14
0.25										0.5		614	20000	0.5	MILE	WORK ZONE LANE LINE, CLASS I, 4"				13
										0.77		614	20010	0.77	MILE	WORK ZONE LANE LINE, CLASS I, 6"				13
0.32										0.57		614	21000	0.57	MILE	WORK ZONE CENTER LINE, CLASS I				13
0.1										0.1		614	22010	0.1	MILE	WORK ZONE EDGE LINE, CLASS I, 6"				
3,252										4,252		614	23000	4,252	FT	WORK ZONE CHANNELIZING LINE, CLASS I, 8"				13
225										225		614	24000	225	FT	WORK ZONE DOTTED LINE, CLASS I				
44										44		614	26000	44	FT	WORK ZONE STOP LINE, CLASS I				
LS										LS		615	10000	LS		ROADS FOR MAINTAINING TRAFFIC				13
448										448		615	20000	448	SY	PAVEMENT FOR MAINTAINING TRAFFIC, CLASS A				
766										766		615	20000	766	SY	PAVEMENT FOR MAINTAINING TRAFFIC, CLASS B				13
										30		616	10000	30	MGAL	WATER				13
2,796										2,796		622	41100	2,796	FT	PORTABLE BARRIER, UNANCHORED				
INCIDENTALS																				
										LS		614	11001	LS		MAINTAINING TRAFFIC, AS PER PLAN				13
										22		619	16011	22	MNTH	FIELD OFFICE, TYPE B, AS PER PLAN				9
										LS		623	10000	LS		CONSTRUCTION LAYOUT STAKES AND SURVEYING				
										LS		624	10000	LS		MOBILIZATION				

L:\DCS\Projects\TRN\60546197\_WCTDFEINT\000T\04844\Design\Roadway\Sheets\04844\_G6006.dgn Sheet 5/7/2021 3:46:44 PM dave.wormald

**GENERAL SUMMARY**  
**HAM / WAR-71**  
**19.83 / 0.00**

L:\DCS\Projects\TRN\6054697\_WCTIDFEINT\DOT\104844\Design\Roadway\Sheets\104844\_GS002.dgn Sheet 5/10/2021 12:29:05 PM dave.wormald

REF NO.	SHEET NO.	STATION TO STATION				201	202	202	202	202	202	202	202	630	203	203	SPECIAL	202	202	204	206	206	206	206
						CLEARING AND GRUBBING	PAVEMENT REMOVED	WALK REMOVED	CONCRETE BARRIER REMOVED	CURB REMOVED	CURB AND GUTTER REMOVED	GUARDRAIL REMOVED	INLET REMOVED	PIPE REMOVED	REMOVAL OF WOOD POLE AND DISPOSAL	EXCAVATION	EMBANKMENT	SETTLEMENT PLATFORM	HEADWALL REMOVED	REMOVAL MISC.-PAVED GUTTER	PROOF ROLLING	CEMENT STABILIZED SUBGRADE, 12 INCHES DEEP	MIXTURE DESIGN FOR CHEMICALLY STABILIZED SOILS	CEMENT
					LS	SY	SF	FT	FT	FT	FT	EACH	FT	EACH	CY	CY	EACH	EACH	FT	HOUR	SY	LS	TON	SY
					1																			
R1	37	1000+38	RT	1005+72	RT						536													
R2	37	1003+82	LT	1004+20	LT														61					
R3	37	1003+83	LT	1004+12	LT													1						
R4	39	1005+25	LT	1006+15	LT								44											
R5	39	1005+25	LT	1005+25	LT													1						
R6	41	1012+21	LT	1012+50	LT		2.6																	
R7	41	1014+67	LT	1014+67	LT																			
R8	41	51+85	LT	52+66	LT					113														
R9	41	50+39	LT	51+03	LT						65													
R10	41	50+68	LT	51+27	LT			290																
R11	41	52+04	LT	52+04	LT							1												
R12	41	50+38	LT	54+56	LT						465													
R13	44	52+62	LT	52+62	LT																			
R14	44	53+34	LT	54+49	LT					129														
R15	44	53+54	LT	53+90	LT							1												
R16	41	51+95	LT	53+86	LT																			
R17	44	53+94	LT	53+94	LT																			
R18	44	54+01	LT	54+56	LT		19			45														
R19	44	54+35	LT	54+48	LT			70																
R20	41	51+39	LT	51+05	LT							49												
R21	41	1013+07	RT	1013+07	RT								1											
R22	41	51+44	LT	51+44	LT								1											
R23	45	18+28	RT	18+84	RT				55															
SP-1	41	1005+00	LT	1005+00	LT												1							
SP-2	41	1009+00	LT	1009+00	LT												1							
RAMP C	41	1008+44.85		1008+69.85																	115		3	115
	35,37,39	997+90.00		1005+26.21															1		2059		53	2059
	39,41	1005+26.21		1005+51.21																	120		3	120
	41	1008+19.85		1008+44.85																	114		3	114
	41,43	1008+69.85		1014+69.51															1		2689		70	2689
MMR	41,43	50+37.51	LT	51+25.54	LT																			
	43	51+25.54	LT	54+56.18	LT																657		17	657
FE	45	17+79.29	RT	18+86.42	RT																			
RAMP C	46	997+90		999+00										182	11									
	47	999+50		1001+00										155	643									
	48	1005+50		1002+50										292	1382									
	49	1003+00		1004+00										427	2889									
	50	1004+50		1005+00										124	2670									
	51	1005+50		1006+00										29	760									
	52	1006+50		1007+00										0	0									
	53	1007+50		1008+00										35	2819									
	54	1008+50		1009+00										7	4015									
	55	1009+50		1010+00										16	3187									
	56	1010+50		1111+00										25	2548									
	57	1111+50		1012+00										56	1625									
	58	1012+50		1013+00										83	487									
	59	1013+50		1014+50										298	44									
MMR																								
	60	50+00	LT	51+00	LT									129	15									
	61	51+50	LT	52+50	LT									327										
	62	53+00	LT	54+50	LT									212										
TOTALS CARRIED TO GENERAL SUMMARY					1	22	360	55	287	465	601	2	93	2	2397	23096	2	2	61	2	5754	LS	149	5754

**ROADWAY SUBSUMMARY**

**HAM / WAR-71**  
**19.83 / 0.00**

CALCULATED
CAL
CHECKED
SCC



REF NO.	SHEET NO.	STATION TO STATION			606	606	606	606	606	606	608	608	609		609	609	622		622				
			FT	EACH	EACH	EACH	EACH	EACH	EACH	SF	SF	FT		FT	FT	FT	FT		EACH				
			TO																				
C-1	39	1005+10.04	LT	1006+13.56	LT										4								
C-2	39	1008+69.85	LT	1013+50.31	LT									480									
C-3	41	1014+10.00	RT/LT	50+31.87	RT/LT							156											
C-4	41	1014+15.83	LT	54+24.24	LT							323											
C-11	39	1008+44.85	LT	1008+69.85	LT										25								
C-5	42	51+75.00	LT	54+00.00	LT											229							
C-6	44	54+39.99	LT	54+54.43	LT							42											
C10	44	54+01.00	LT	54+01.00	LT											36							
C-7	45	15+00.00	RT	21+19.00	RT								620										
C-8	45	16+36.00	LT	17+11.00	LT								75										
C-9	45	17+55.00	LT	21+19.00	LT								367										
G-1	35	1000+27.50	LT	1005+15.56	LT	475		1		1													
G-2	37	1008+30.90	LT	1013+79.63	LT	475	1		1														
G-3	37	1008+60.46	RT	1010+23.42	RT	87.5	1		1														
W-1	41	1014+06.00	RT								99												
W-2	41	1014+06.00	RT									101											
W-3	41	1014+06.00	LT									152											
W-4	44	1014+15.75	LT	54+23.12	LT						2396												
W-5	44	54+36.51	LT									175											
AU1	45	17+60.42	RT							1													
B-1	45	17+79.42	RT	18+09.42	RT																	1	
B-2	45	18+09.42	RT	18+83.63	RT												148						
TOTALS CARRIED TO GENERAL SUMMARY						1038	2	1	2	1	1	2495	428	1583		480	29	265	148			1	

L:\DCS\Projects\TRN\6054697\_WCTDFEINT\0DOT\04844\Design\Roadway\Sheets\104844\_GS003.dgn Sheet 5/10/2021 12:29:04 AM

<b>ROADWAY SUBSUMMARY</b>	CALCULATED CAL CHECKED SCC
<b>HAM / WAR-71</b> <b>19.83 / 0.00</b>	29 146

L:\DCS\Projects\TRN\6054697\_WCTDFEINT\000T\04844\Design\Drainage\Sheets\04844\_DS001.dgn Sheet 5/6/2021 5:59:08 PM dave.wor.mald

REF NO.	SHEET NO.	STATION TO STATION				601	601	601	601	601	601			659					670	670	670				
						TIED CONCRETE BLOCK MAT, TYPE 2	ROCK CHANNEL PROTECTION, TYPE C WITH FILTER	ROCK CHANNEL PROTECTION, TYPE D WITH FILTER	PAVED GUTTER, TYPE 1-2	PAVED GUTTER, TYPE 2	PAVED GUTTER, TYPE 5			TOPSOIL								SLOPE EROSION PROTECTION	DITCH EROSION PROTECTION	DITCH EROSION PROTECTION MAT, TYPE A	
						SY	CY	CY	FT	FT	FT			CY				SY	SY	SY					
E1	37	1000+00.00	LT	TO	1003+25.00	LT																			
E2	39	1004+04.00	LT		1005+33.30	LT													271						
E3	39	1005+06.00	LT		1005+06.00	LT		1.6													108				
E4	39	1007+51.00	LT		1007+61.74	LT		6.7																	
E5	39	1007+62.00	LT		1008+05.00	LT			19.8																
E6	39	1008+88.50	LT		1010+13.00	LT				139															
E7	41	1010+13.00	LT		1013+00.00	LT			287																
E8	41	1012+50.00	RT		1013+98.00	RT					148														
E9	41	1013+53.00	LT		1013+53.00	LT	9.2																		
E10	39	1010+03.00	RT		1010+03.00	RT		1.1																	
E11	39, 41	1010+06.00	RT		1012+00.00	RT															162				
E12	37	1003+50.00	LT		1004+50.00	LT							67					600							
TOTALS CARRIED TO GENERAL SUMMARY																									
						10	10	20	287	139	148			67				600	271	270					

<b>HAM / WAR - 71</b> <b>19.83 / 0.00</b>	<b>DRAINAGE SUBSUMMARY</b>	CALCULATED JNR CHECKED SCC
30 146		

L:\DCS\Projects\TRN\60546197\_wctidfeint\000T\04844\Design\Drainage\Sheets\04844\_DS003.dgn - 5/6/2021 4:54:32 PM - christopher.yjkins

REF NO.	SHEET NO.	STATION TO STATION				602	611	611	611	611	611	611	611	611	611	611	611	611	611	611	611	611	611	611	611	611	CALCULATED JNR CHECKED SCC	
						CONCRETE MASONRY CY	12" CONDUIT, TYPE C FT	12" CONDUIT, TYPE F FT	15" CONDUIT, TYPE B FT	15" CONDUIT, TYPE C FT	15" CONDUIT, TYPE F, 707.05 TYPE C OR 707.21 FT	18" CONDUIT, TYPE B FT	30" CONDUIT, TYPE B FT	36" CONDUIT, TYPE B FT	36" CONDUIT, TYPE C FT	54" CONDUIT, TYPE C FT	60" CONDUIT, TYPE B FT	43" X 68" CONDUIT, TYPE C, 706.04 FT	SLOTTED DRAIN, TYPE 2 (15") FT	CATCH BASIN, NO. 3 EACH	CATCH BASIN, NO. 3A EACH	CATCH BASIN, NO. 6 EACH	CATCH BASIN, NO. 2-2A EACH	MANHOLE, NO. 3 EACH	INLET RECONSTRUCTED TO GRADE, AS PER PLAN EACH	MANHOLE ADJUSTED TO GRADE EACH		
				TO																								
D3	44	54+19.00	LT	52+86.00	LT																							
D4	41	52+86.00	LT	51+70.00	LT																							
D5	41	51+70.61	LT																									
D6	41	51+38.75	LT	1013+90.00	RT																							
D9	41	1014+97.92	LT	1014+70.47	LT																							
D10	41	1014+70.47	LT	1014+21.25	LT																							
D11	41	1014+21.25	LT	1013+90.00	LT																							
D12	41	1013+90.00	RT	1013+90.00	LT																							
D13	41	1013+90.00	LT	1012+00.00	LT																							
D14	41	1013+90.00	LT	1013+90.00	LT																							
D15	41	1013+90.00	RT	1013+90.00	RT																							
D16	41	1012+00.00	LT	1012+00.00	LT																							
D17	41	1012+00.00	LT	1009+30.00	LT																							
D18	41	1012+00.00	RT	1012+00.00	LT																							
D19	39	1010+03.00	RT	1010+03.00	RT	0.21																						
D20	39	1009+30.00	LT	1007+61.74	LT	0.76																						
D21	39	1005+80.00	LT	1004+04.15	LT																							
D22	39	1006+17.50	LT	1005+80.00	LT																							
D23	39	1005+87.00	LT	1005+80.00	LT																							
D24	37	1004+04.15	LT	1003+96.00	LT																							
D25	37	1004+04.23	LT	1004+04.15	LT	0.76																						
D26	39	1005+61.60	RT	1005+35.60	RT																							
D27	39	1005+35.60	RT	1005+07.30	LT																							
D28	39	1005+07.30	LT	1005+06.10	LT	0.27																						
D29	45	17+07	LT	17+07	LT																							
D30	45	19+04	LT	19+04	LT																							
D31	45	17+75	RT	17+75	RT																							
D32	45	18+75	RT	18+75	RT																							
TOTALS CARRIED TO GENERAL SUMMARY						2	46	12	185	47	65		249		81	663	24	173	24	8	26	2	2	2	2	6	4	2



**DRAINAGE SUBSUMMARY**

**HAM / WAR-71**  
**19.83 / 0.00**

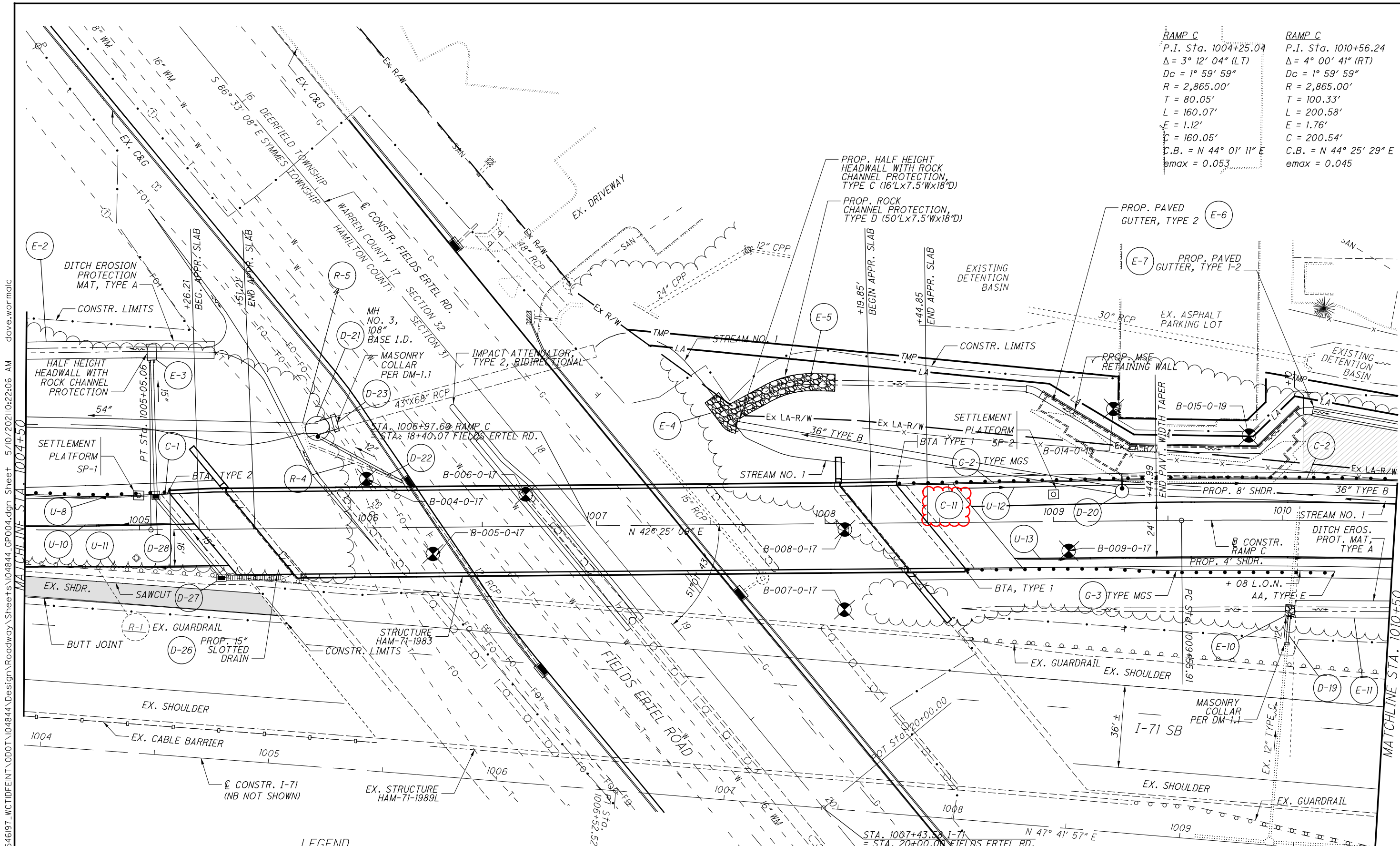
RAMP C	RAMP C
P.I. Sta. 1004+25.04	P.I. Sta. 1010+56.24
$\Delta = 3^\circ 12' 04''$ (LT)	$\Delta = 4^\circ 00' 41''$ (RT)
$D_c = 1^\circ 59' 59''$	$D_c = 1^\circ 59' 59''$
$R = 2,865.00'$	$R = 2,865.00'$
$T = 80.05'$	$T = 100.33'$
$L = 160.07'$	$L = 200.58'$
$E = 1.12'$	$E = 1.76'$
$C = 160.05'$	$C = 200.54'$
C.B. = N 44° 01' 11" E	C.B. = N 44° 25' 29" E
$e_{max} = 0.053$	$e_{max} = 0.045$



**LEGEND**

-  PAVEMENT RESURFACING
-  LIMITS OF REINFORCED SLOPE

**CROSS REFERENCES**

- FOR ADDITIONAL DETAILS, SEE BRIDGE SITE PLAN
- FOR PLAN FIELDS EREL RD, SEE SHEET 45
- FOR ESTIMATED QUANTITIES SEE SHEET 22
- FOR B & C REFERENCES SEE SHEET 2
- FOR PROJECT CONTROL SEE SHEET 10
- FOR ADDITIONAL DETAILS, SEE RETAINING WALL PLANS
- FOR REINFORCED SOIL SLOPE DETAILS, SEE SHEET 70
- SEE BRIDGE PLANS FOR APPROACH SLAB PARAPET DETAILS
- FOR FENCING PLAN, SEE SHEET 130

CONTRACTOR SHALL COORDINATE GUARDRAIL POST INSTALLATION TO AVOID DAMAGING GEOGRIDC FOR REINFORCED SOIL SLOPE

L:\DCS\Projects\TRN\60546197\_WCTDFEINT\0001\04844\Design\Roadway\Sheets\104844.GP004.dgn Sheet 5/10/2021 10:22:06 AM dave.wormald  
 MA CHINE S 1004+50

MATCHLINE STA. 1010+50



L:\DCS\Projects\TRN\60546197\_WCTIDFEINT\000T\104844\Design\Roadway\Sheets\104844\_GPO08.dgn Sheet 5/6/2021 3:48:24 PM dave.wormald

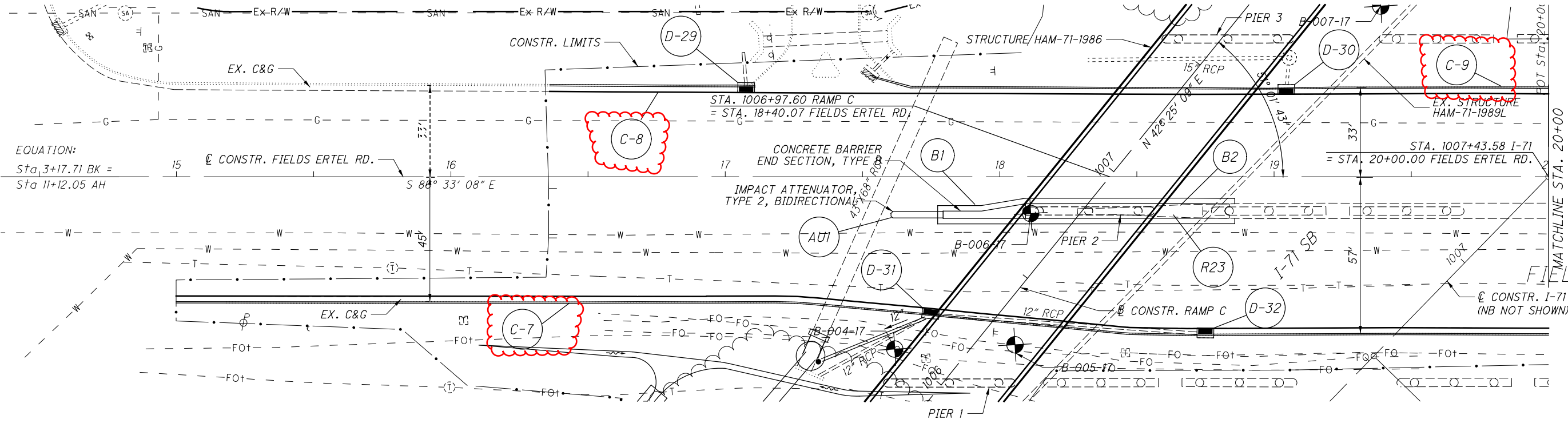

EQUATION:  
 Sta. 3+17.71 BK =  
 Sta. 11+12.05 AH

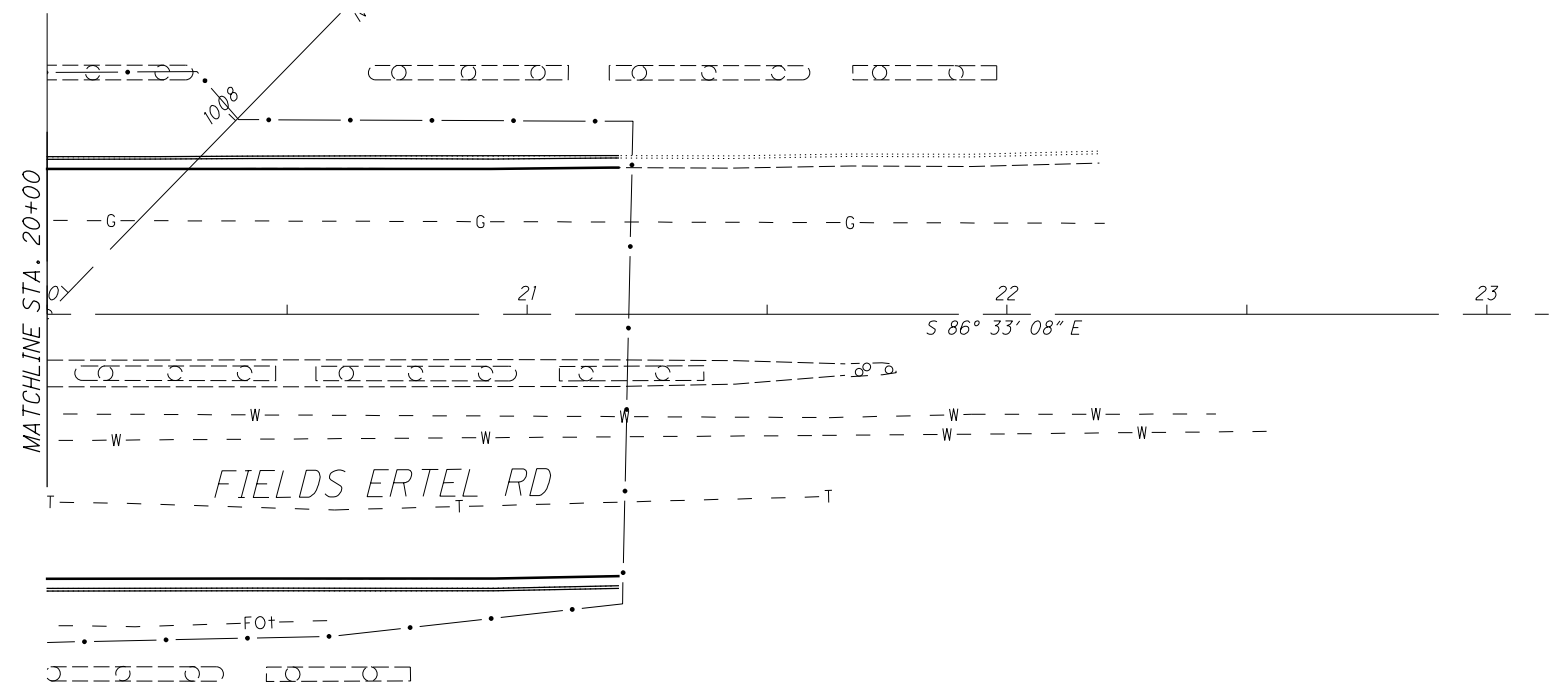

I-71  
 P.I. Sta. 999+93.14  
 $\Delta = 3^\circ 31' 04''$  (RT)  
 $Dc = 0^\circ 16' 00''$   
 $R = 21,485.88'$   
 $T = 659.79'$   
 $L = 1,319.17'$   
 $E = 10.13'$   
 $C = 1,318.96'$   
 $C.B. = N 45^\circ 56' 25'' E$

**CROSS REFERENCES**  
 SEE BRIDGE SITE PLAN FOR DETAILS  
 FOR PAVEMENT DETAILS, SEE SHEET 67  
 FOR ESTIMATED QUANTITIES SEE SHEET 22  
 FOR  $\square$  &  $\square$  REFERENCES SEE SHEET 2  
 FOR PROJECT CONTROL SEE SHEET 10



**PLAN - FIELDS-ERTEL ROAD**  
**STA. 15+00 - STA. 23+00**

**HAM / WAR-71**  
**19.83 / 0.00**

SEEDING  
END SO.  
WIDTH YDS.  
59  
267  
75  
372  
134 639

L:\DCS\Projects\TRN\60546197\_WCTIDFEINT\0DOT\104844\Design\Roadway\Sheets\104844\_X5009.dgn\_Sheet 5/10/2021 11:48:12 AM dave.wormald

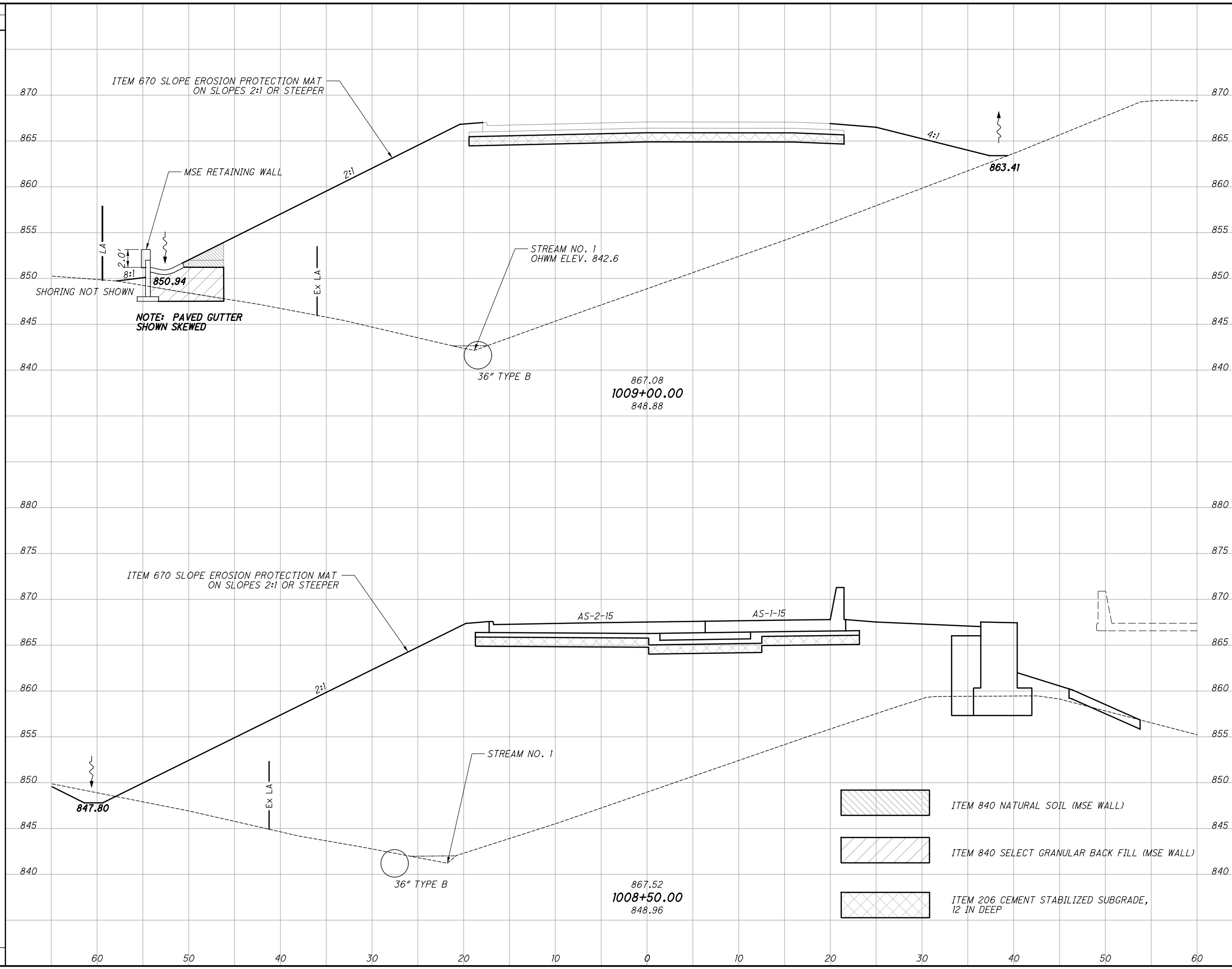

END AREA		VOLUME		CALCULATED CAL	CHECKED SCC
CUT	FILL	CUT	FILL		
0	1140	2	1699		
5	2316				
6	1361	6	1361		
6	2501	7	4015		

**HAM / WAR-71**  
**19.83 / 0.00**

**CROSS SECTIONS RAMP C**  
**STA. 1008+50.00 TO STA. 1009+00.00**

54  
146

L:\DCS\Projects\TRN\60546197\_WCTIDFEINT\0DOT\104844\Design\Roadway\Sheets\104844\_X5013.dgn\_Sheet 5/10/2021 11:50:59 AM dave.wormald

SEEDING	
END WIDTH	SO. YDS.
38	222
18	
117	
20	
106	

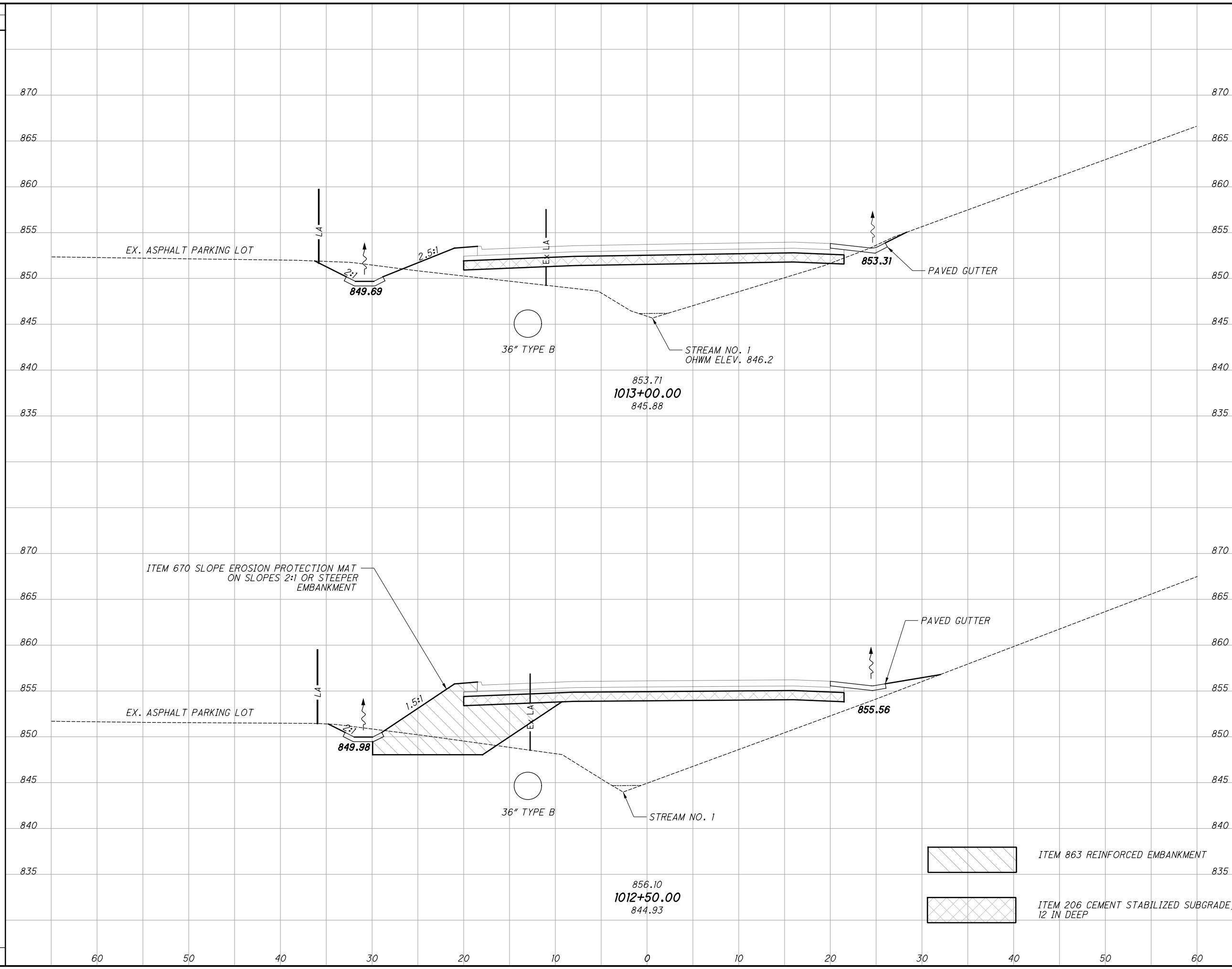

END AREA		VOLUME		CALCULATED CAL	CHECKED SCC
CUT	FILL	CUT	FILL		
14	124	50	144		
33	343				
22	246				
36	370	83	487	58	146

**CROSS SECTIONS RAMP C**  
**STA. 1012+50.00 TO STA. 1013+00.00**  
**HAM / WAR-71**  
**19.83 / 0.00**

- ITEM 670 SLOPE EROSION PROTECTION MAT ON SLOPES 2:1 OR STEEPER EMBANKMENT
- ITEM 863 REINFORCED EMBANKMENT
- ITEM 206 CEMENT STABILIZED SUBGRADE, 12 IN DEEP

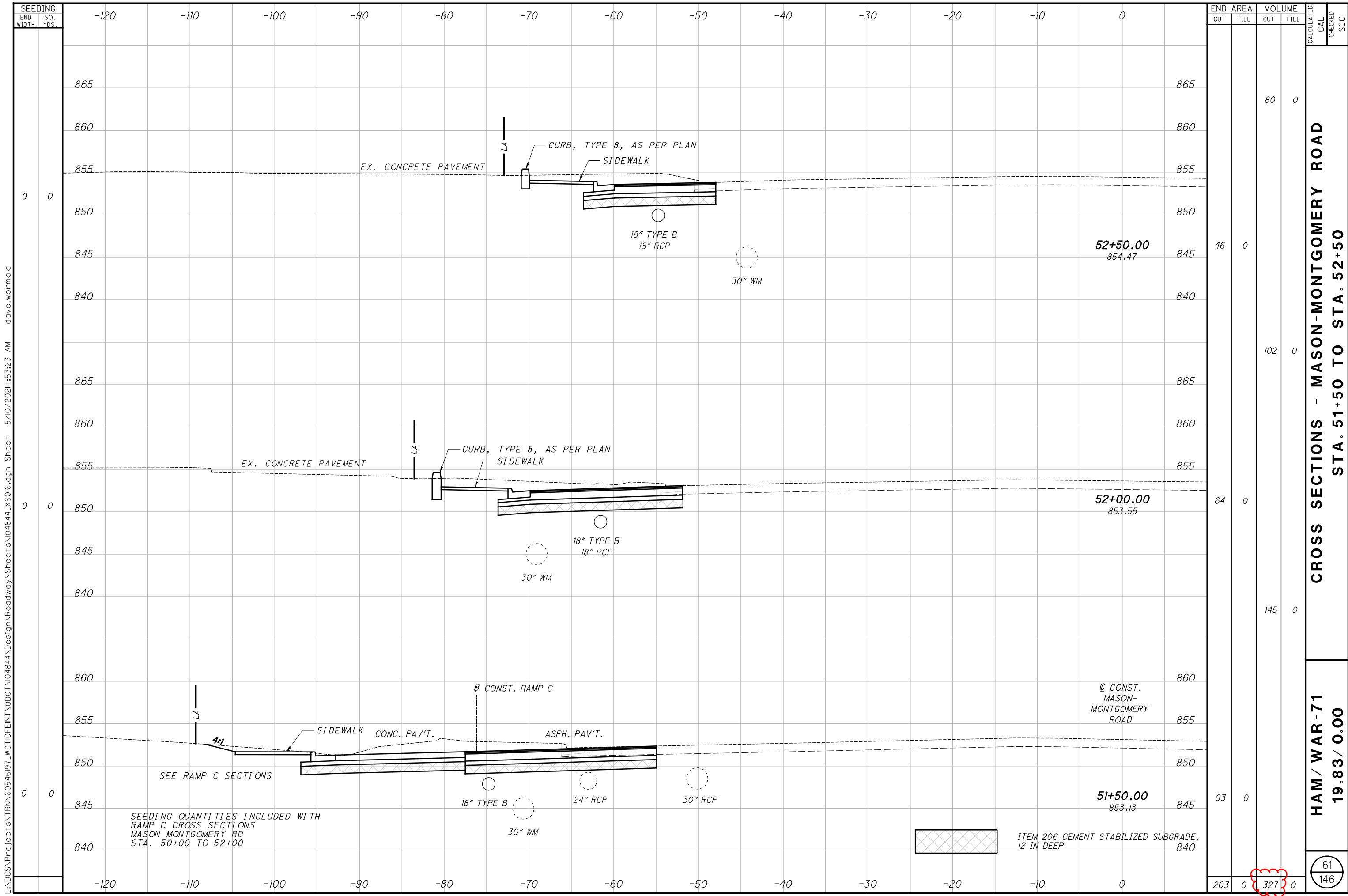

L:\DCS\Projects\TRN\60546197\_WCTIDFEINT\000T\04844\Design\Roadway\Sheets\104844\_X5016.dgn\_Sheet 5/10/2021 11:53:23 AM dave.wormald

SEEDING		END AREA		VOLUME		CALCULATED		CHECKED	
END WIDTH	SO. YDS.	CUT	FILL	CUT	FILL	CAL	SCC	CAL	SCC
0	0	46	0	80	0				
0	0	64	0	102	0				
0	0	93	0	145	0				
0	0	203	0	327	0			61	146

**CROSS SECTIONS - MASON-MONTGOMERY ROAD**  
**STA. 51+50 TO STA. 52+50**  
**HAM / WAR-71**  
**19.83 / 0.00**



L:\DCS\Projects\TRN\6054697\_WCTIDFEINT\0DOT\04844\Design\Structures\WAR071\_0000P\Sheets\04844\_S0001.dgn Sheet 5/7/2021 10:02:57 AM dave.wormald

ITEM ODOT	EXT.	PARTICIPATION 01/MPO/OT	TOTAL	UNIT	DESCRIPTION	QUANTITIES		CALC BY:	ERM	5/30/2019	
						HAM-71-19.83		CHECK BY:	ESH	11/18/2019	
						ABUTMENTS		PIERS	SUPER.	GENERAL	REF. SHEET
REAR	FWD.										
202	11301	24	24	CY	PORTIONS OF STRUCTURE REMOVED, AS PER PLAN					24	2/31 5/31
203	98500	LS	LS	LS	TEMPORARY SURCHARGE					LS	2/31 5/31
503	11101	LS	LS	LS	COFFERDAMS AND EXCAVATION BRACING, AS PER PLAN					LS	
509	10000	140,406	140,406	LB	EPOXY COATED REINFORCING STEEL	6238	7121	23943	101294	1810	
509	30020	6,362	6,362	FT	NO. 4 GFRP DEFORMED BARS				6267	95	
511	33500	4	4	EACH	SEMI-INTEGRAL DIAPHRAGM GUIDE	2	2				
511	53014	43	43	CY	CLASS QC3 CONCRETE WITH QC/QA, SUPERSTRUCTURE, AS PER PLAN				43		3/31
511	53014	308	308	CY	CLASS QC3 CONCRETE WITH QC/QA, BRIDGE DECK, AS PER PLAN				308		3/31
511	53014	90	90	CY	CLASS QC3 CONCRETE WITH QC/QA, BRIDGE DECK (PARAPET), AS PER PLAN				81	9	3/31
511	53014	110	110	CY	CLASS QC3 CONCRETE WITH QC/QA, PIER ABOVE FOOTINGS, AS PER PLAN			110			3/31
511	53014	136	136	CY	CLASS QC3 CONCRETE WITH QC/QA, ABUTMENT INCLUDING FOOTING, AS PER PLAN	59	77				3/31
512	10100	1,021	1,021	SY	SEALING OF CONCRETE SURFACES (EPOXY-URETHANE)	50	62	342	567		
513	10240	323,996	323,996	LB	STRUCTURAL STEEL MEMBERS, LEVEL 2				323996		
513	20000	3,875	3,875	EACH	WELDED STUD SHEAR CONNECTORS				3875		
514	00060	15,535	15,535	SF	FIELD PAINTING STRUCTURAL STEEL, INTERMEDIATE COAT				15535		
514	00066	15,535	15,535	SF	FIELD PAINTING STRUCTURAL STEEL, FINISH COAT				15535		
516	13600	14	14	SF	1" PREFORMED EXPANSION JOINT FILLER	5	9				
516	13900	130	130	SF	2" PREFORMED EXPANSION JOINT FILLER	75	55				
516	14020	105	105	FT	SEMI-INTEGRAL ABUTMENT EXPANSION JOINT SEAL	53	52				
516	44200	10	10	EACH	ELASTOMERIC BEARING WITH INTERNAL LAMINATES AND LOAD PLATE (NEOPRENE) (12" x 12" x 2.5" WITH 13" x 13" x 1.50" PLATE)	5	5				
516	44200	15	15	EACH	ELASTOMERIC BEARING WITH INTERNAL LAMINATES AND LOAD PLATE (NEOPRENE) (17" x 15" x 2.5" WITH 18" x 16" x 1.50" PLATE)			15			
518	21200	97	97	CY	POROUS BACKFILL WITH GEOTEXTILE FABRIC	47	50				
518	40000	164	164	FT	6" PERFORATED CORRUGATED PLASTIC PIPE	75	89				
518	40010	14	14	FT	6" NON-PERFORATED CORRUGATED PLASTIC PIPE, INCLUDING SPECIALS	8	6				
524	94605	86	86	FT	DRILLED SHAFTS, 30" DIAMETER INTO BEDROCK, AS PER PLAN	32	54				2/31
524	94703	696	696	FT	DRILLED SHAFTS, 36" DIAMETER, ABOVE BEDROCK, AS PER PLAN	264	432				2/31
524	94705	45	45	FT	DRILLED SHAFTS, 36" DIAMETER, INTO BEDROCK, AS PER PLAN			45			2/31
524	94803	486	486	FT	DRILLED SHAFTS, 42" DIAMETER, ABOVE BEDROCK, AS PER PLAN			486			2/31
526	25001	216	216	SY	REINFORCED CONCRETE APPROACH SLABS (T=15"), AS PER PLAN					216	26/31 27/31
526	90010	94	94	FT	TYPE A INSTALLATION					94	
601	20000	471	471	SY	CRUSHED AGGREGATE SLOPE PROTECTION	230	241				
625	25600	319	319	LF	CONDUIT, 4", 725.04				319		

DESIGN AGENCY: AECOM  
 DATE: 12/19  
 REVIEWED: TMB  
 STRUCTURE FILE NUMBER: 3107754  
 DRAWN: ERM  
 ERM  
 REVISIONS: ---  
 DESIGNED: ERM  
 ERM  
 CHECKED: ESH  
 ESH

**ESTIMATED QUANTITIES**  
 BRIDGE NO. HAM-71-19.83  
 I-71 SB RAMP C OVER FIELDS ETEL ROAD

**HAM / WAR - 71**  
 -19.83 / 0.00  
 PID No. 104844

4 / 31  
 102  
 146