

ITEM 614, MAINTAINING TRAFFIC

A MINIMUM OF 3 LANE(S) OF TRAFFIC IN EACH DIRECTION SHALL BE MAINTAINED AT ALL TIMES BY USE OF THE EXISTING PAVEMENT.

NO WORK SHALL BE PERFORMED AND ALL EXISTING LANES SHALL BE OPEN TO TRAFFIC DURING THE FOLLOWING DESIGNATED HOLIDAYS OR SPECIAL EVENTS:

- NEW YEAR'S (OBSERVED) GENERAL/REGULAR ELECTION DAY ((NOV) THANKSGIVING
- MEMORIAL DAY CHRISTMAS (OBSERVED)
- FOURTH OF JULY (OBSERVED)
- LABOR DAY

THE PERIOD OF TIME THAT THE LANES ARE TO BE OPEN DEPENDS ON THE DAY OF THE WEEK ON WHICH THE HOLIDAY OR SPECIAL EVENT FALLS. THE FOLLOWING SCHEDULE SHALL BE USED TO DETERMINE THIS PERIOD:

DAY OF HOLIDAY TIME ALL LANES
 OR SPECIAL EVENT MUST BE OPEN TO TRAFFIC

- SUNDAY 12:00N FRIDAY THROUGH 6:00 AM MONDAY
- MONDAY 12:00N FRIDAY THROUGH 6:00 AM TUESDAY
- MONDAY (TOTAL SOLAR ECLIPSE) 12:00N MONDAY THROUGH 6:00 AM WEDNESDAY
- TUESDAY 12:00N MONDAY THROUGH 6:00 AM WEDNESDAY
- TUESDAY (GEN./REG. ELECTION) 5:00 AM TUESDAY THROUGH 12:00 AM WEDNESDAY
- WEDNESDAY 12:00N TUESDAY THROUGH 6:00 AM THURSDAY
- THURSDAY 12:00N WEDNESDAY THROUGH 6:00 AM FRIDAY
- THURSDAY (THANKSGIVING ONLY) 6:00 AM WEDNESDAY THROUGH 6:00 AM MONDAY
- FRIDAY 12:00N THURSDAY THROUGH 6:00 AM MONDAY
- SATURDAY 12:00N FRIDAY THROUGH 6:00 AM MONDAY

DURING THE SAME PERIODS, MAINTAIN PEDESTRAIN ACCESS IF PEDESTRIAN ACCESS WAS PRESENT PRIOR TO CONSTRUCTION.

SHOULD THE CONTRACTOR FAIL TO MEET ANY OF THESE REQUIREMENTS, THE CONTRACTOR SHALL BE ASSESSED A DISINCENTIVE PER THE LANE VALUE CONTRACT (PN 127).

THE CONTRACTOR SHALL PROVIDE, ERECT AND MAINTAIN SIGNS AND SIGN SUPPORTS, AS DETAILED IN THE OHIO MANUAL OF UNIFORM TRAFFIC CONTROL DEVICES, AND TYPE III BARRICADES OF THE TYPE AND LOCATION SHOWN IN STANDARD CONSTRUCTION DRAWINGS.

ALL WORK AND TRAFFIC CONTROL DEVICES SHALL BE IN ACCORDANCE WITH C&MS 614 AND OTHER APPLICABLE PORTIONS OF THE SPECIFICATIONS, AS WELL AS THE OHIO MANUAL OF UNIFORM TRAFFIC CONTROL DEVICES. PAYMENT FOR ALL LABOR, EQUIPMENT AND MATERIALS SHALL BE INCLUDED IN THE LUMP SUM CONTRACT PRICE FOR ITEM 614, MAINTAINING TRAFFIC, UNLESS SEPARATELY ITEMIZED IN THE PLAN.

DRUM REQUIREMENTS

IN ADDITION TO THE REQUIREMENTS OF THE PLANS, SPECIFICATION AND PROPOSAL, DRUMS FURNISHED BY THE CONTRACTOR SHALL BE NEW AND UNUSED AT THE TIME OF ARRIVAL ON THE PROJECT. ANY DRUMS BROUGHT ON THE PROJECT, WHICH HAVE PREVIOUSLY BEEN USED ELSEWHERE, WILL NOT BE ACCEPTED.

PAYMENT FOR DRUMS SHALL BE INCLUDED IN THE LUMP SUM PRICE BID FOR MAINTAINING TRAFFIC UNLESS SEPARATELY ITEMIZED.

ITEM 622, PORTABLE BARRIER, 50", AS PER PLAN

THIS WORK SHALL CONSIST OF FURNISHING, MAINTAINING, AND SUBSEQUENTLY REMOVING A 50-INCH PORTABLE BARRIER AT THE LOCATIONS SHOWN ON THE PLANS. FOR DETAILS, SEE SCD RM-4.1.

PORTABLE STEEL BARRIER IS AN APPROVED ALTERNATIVE TO PORTABLE CONCRETE BARRIER. FOR INFORMATION ON APPROVED VENDORS, SEE THE APPROVED PRODUCTS LIST MAINTAINED BY THE OFFICE OF ROADWAY ENGINEERING.

PORTABLE BARRIER, 32 INCHES HIGH WITH AN 18-INCH MINIMUM HEIGHT GLARE SCREEN MAY BE USED AT THE OPTION OF THE CONTRACTOR. THE GLARE SCREEN SHALL BE CONSTRUCTED USING ONE OF THE SCREENS PROVIDED ON THE APPROVED LIST, AVAILABLE ON THE OFFICE OF ROADWAY ENGINEERING WEBSITE.

PADDLE OR INTERMITTENT TYPE GLARE SCREENS SHALL BE DESIGNED USING A 20 DEGREE CUT-OFF ANGLE BASED ON TANGENT ALIGNMENT. THAT SPACING SHALL BE USED THROUGHOUT THE BARRIER LENGTH WITHOUT REGARD TO BARRIER CURVATURE.

THE GLARE SCREEN SYSTEM SHALL BE SECURELY FASTENED TO THE 32-INCH PORTABLE BARRIER USING THE HARDWARE AND PROCEDURES SPECIFIED BY THE MANUFACTURER.

FOR DIRECTIONS ON HOW TO INSTALL THE GLARE SCREEN AND THE BARRIER, SEE THE MANUFACTURER'S INSTRUCTIONS.

PAYMENT SHALL INCLUDE ALL LABOR, MATERIAL, AND EQUIPMENT NECESSARY TO PERFORM THE WORK AND SHALL BE PAID FOR AT THE CONTRACT PRICE PER FOOT FOR ITEM 622, PORTABLE BARRIER, 50", AS PER PLAN.

ITEM 614, REPLACEMENT SIGN

FLATSHEET SIGNS FURNISHED BY THE CONTRACTOR IN ACCORDANCE WITH THE REQUIREMENTS OF THE PLANS, SPECIFICATIONS AND PROPOSAL WHICH BECOME DAMAGED BY TRAFFIC FOR REASONS BEYOND THE CONTROL OF THE CONTRACTOR SHALL BE REPLACED IN KIND WHEN ORDERED BY THE ENGINEER. REPLACEMENT SIGNS SHALL BE NEW. OTHER MATERIALS MAY BE IN USED, BUT GOOD, CONDITION SUBJECT TO APPROVAL BY THE ENGINEER.

PAYMENT FOR THE NEW SIGNS SHALL BE MADE AT THE CONTRACT PRICE PER EACH FOR ITEM 614, REPLACEMENT SIGN, AND SHALL INCLUDE THE COST OF REMOVING AND DISPOSING OF DAMAGED SIGNS, HARDWARE AND SUPPORTS, AND PROVIDING THE NECESSARY REPLACEMENT HARDWARE, SUPPORTS, ETC.

AN ESTIMATED QUANTITY OF 10 EACH HAS BEEN PROVIDED IN THE GENERAL SUMMARY.

PERMITTED LANE CLOSURE SCHEDULE (PLCS)

LANE CLOSURE(S) SHALL CONFORM TO THE PLCS. PUBLISHED PLCS INFORMATION CAN BE FOUND ON THE ODOT WEBSITE AT: [HTTPS://WWW.TRANSPORTATION.OHIO.GOV/WPS/PORTAL/GOV/ODOT/WORKING/DATA-TOOLS/RESOURCES/PERMITTED-LANE-CLOSURE](https://www.transportation.ohio.gov/wps/portal/gov/odot/working/data-tools/resources/permited-lane-closure)

THE MONTHLY PUBLISHED SCHEDULES REQUIRED TO BE USED, FOR EACH PLCS SEGMENT WITHIN THE PROJECT AREA, ARE THOSE THAT COMPRISE THE CONSECUTIVE 12-MONTH PERIOD BEGINNING 15 MONTHS PRIOR TO THE MONTH AND YEAR OF SALE AND ENDING 4 MONTHS PRIOR TO THE MONTH AND YEAR OF SALE. THESE SAME 12 MONTHS APPLY FOR THE LIFE OF THE PROJECT AND SHALL BE APPLIED TO EACH RESPECTIVE MONTH OF CONSTRUCTION (MONTH OF LANE CLOSURE(S) SHALL MATCH MONTH OF PLCS USED). LANE CLOSURE(S) IN PLACE FOR MULTIPLE MONTHS SHALL ALWAYS COMPLY WITH THE CURRENT RESPECTIVE MONTH.

(FOR EXAMPLE: IF THE SALE DATE FOR THE PROJECT WAS MARCH OF 2021, THE MONTHLY PUBLISHED SCHEDULES FOR EACH APPLICABLE PLCS SEGMENT WOULD BE DECEMBER 2019 TO NOVEMBER 2020. IF THIS WAS A THREE-YEAR PROJECT, YEAR THREE WOULD STILL BE USING THE DECEMBER 2019 TO NOVEMBER 2020 MONTHLY SCHEDULES. IF THE PROJECT DESIRED TO CLOSE TWO LANES IN JUNE 2021, REFERENCE WOULD BE MADE TO THE JUNE 2020 SCHEDULE(S) FOR THE RESPECTIVE PLCS SEGMENT(S). IF THE SAME TWO LANES WERE DESIRED TO BE CLOSED AGAIN IN JULY 2021, REFERENCE WOULD BE MADE TO THE JULY 2020 SCHEDULE(S) FOR THE RESPECTIVE PLCS SEGMENT(S).)

MORE RESTRICTIVE CHANGES TO THE ALLOWABLE LANE CLOSURE HOURS ARE AT THE DISCRETION OF THE ENGINEER IN ORDER TO COMPLY WITH THE TRAFFIC MANAGEMENT IN WORK ZONES POLICY (21-008(P)) AND STANDARD PROCEDURE (123-001(SP)).

LESS RESTRICTIVE CHANGES TO THE ALLOWABLE LANE CLOSURE HOURS ARE SUBJECT TO THE TRAFFIC MANAGEMENT IN WORK ZONES POLICY (21-008(P)) AND STANDARD PROCEDURE (123-001(SP)) AND SHALL NOT BE IMPLEMENTED UNTIL, AND UNLESS, APPROVED BY THE PROPER ODOT AUTHORITY.

ALLOWABLE LANE CLOSURE HOURS FOR FACILITIES NOT COVERED BY THE PLCS, IF ANY, SHALL BE AS SPECIFIED ELSEWHERE IN THE PLANS.

LANE VALUE CONTRACT TABLE			
DESCRIPTION OF CRITICAL LANE/RAMP TO BE MAINTAINED	PERMITTED TIME PERIOD	TIME UNIT	DISINCENTIVE \$ PER TIME UNIT
I-275 EAST BOUND			
ALL LANES OPEN TO TRAFFIC	9 PM TO 5 AM	1 MINUTE PERIOD	\$285
I-275 WEST BOUND			
ALL LANES OPEN TO TRAFFIC	11 PM TO 6 AM	1 MINUTE PERIOD	\$285

ITEM 614, WORK ZONE RAISED PAVEMENT MARKER, AS PER PLAN

WORK ZONE RAISED PAVEMENT MARKERS, AS PER PLAN, AND THEIR INSTALLATION SHALL CONFORM TO C&MS 614 OR C&MS 621 AS SPECIFIED HEREIN.

RAISED PAVEMENT MARKERS IN USE DURING THE SNOW-PLOWING SEASON SHALL CONFORM TO 621.

RAISED PAVEMENT MARKERS IN USE DURING THE NON-SNOW-PLOW SEASON SHALL CONFORM TO EITHER 614 OR TO 621.

THE SNOW-PLOWING SEASON SHALL RUN FROM OCTOBER 15TH THROUGH APRIL 1ST.

IF PROJECT DELAYS, NOT THE FAULT OF ODOT, CAUSE THE WORK TO EXTEND INTO THE SNOW-PLOWING SEASON, THE CONTRACTOR SHALL BE RESPONSIBLE FOR REPLACING WORK ZONE RAISED PAVEMENT MARKERS (WZRPMS) CONFORMING TO C&MS 614, WITH RAISED PAVEMENT MARKERS CONFORMING TO 621, AS DETERMINED BY THE ENGINEER, AT THE CONTRACTOR'S EXPENSE.

THIS ITEM SHALL INCLUDE PURCHASE, INSTALLATION AND REMOVAL OF ITEM 614 WORK ZONE RAISED PAVEMENT MARKER, AS PER PLAN, INCLUDING FILLING OF ANY DEPRESSIONS CREATED IN THE PAVEMENT AS PER C&MS 621.08.

RESURFACING AREA SHOWN ON PLAN SHEETS SHALL BE PERFORMED AT THE TIME THAT THE SURFACE COURSE IS BEING APPLIED TO THE ENTIRE PROJECT. PRIOR TO APPLICATION OF THE SURFACE COURSE ON THE PROJECT, THE EXISTING PAVEMENT WITHIN THE TRANSITION AREA SHALL BE REMOVED TO A DEPTH NECESSARY TO REACH THE LEVEL OF THE INTERMEDIATE COURSE OF THE PAVEMENT, AS DETERMINED BY THE ENGINEER.

THE FOLLOWING BID ITEMS SHOULD BE INCLUDED IN THE PLANS:

- ITEM 614 WORK ZONE RAISED PAVEMENT MARKER, AS PER PLAN 737 EACH
- ITEM 254 PAVEMENT PLANING, ASPHALT CONCRETE 72979 SQUARE YARDS
- ITEM 407 NON-TRACKING TACK COAT 6568 GALLON
- ITEM 442 ASPHALT CONCRETE SURFACE COURSE, 12.5 MM, TYPE A (446) 1.5" DEPTH 3039 CUBIC YARD
- ITEM 872 VOID REDUCING ASPHALT MEMBRANE 23,232 FT

PAYMENT FOR RESURFACING SHOWN ON THE PLAN SHEETS SHALL BE PAID FOR UNDER THE APPROPRIATE BID ITEMS FOR THE WORK REQUIRED, AS PROVIDED FOR IN THE PLANS.

DESIGN AGENCY



DESIGNER

GAT

REVIEWER

XXX MM-DD-YY

PROJECT ID







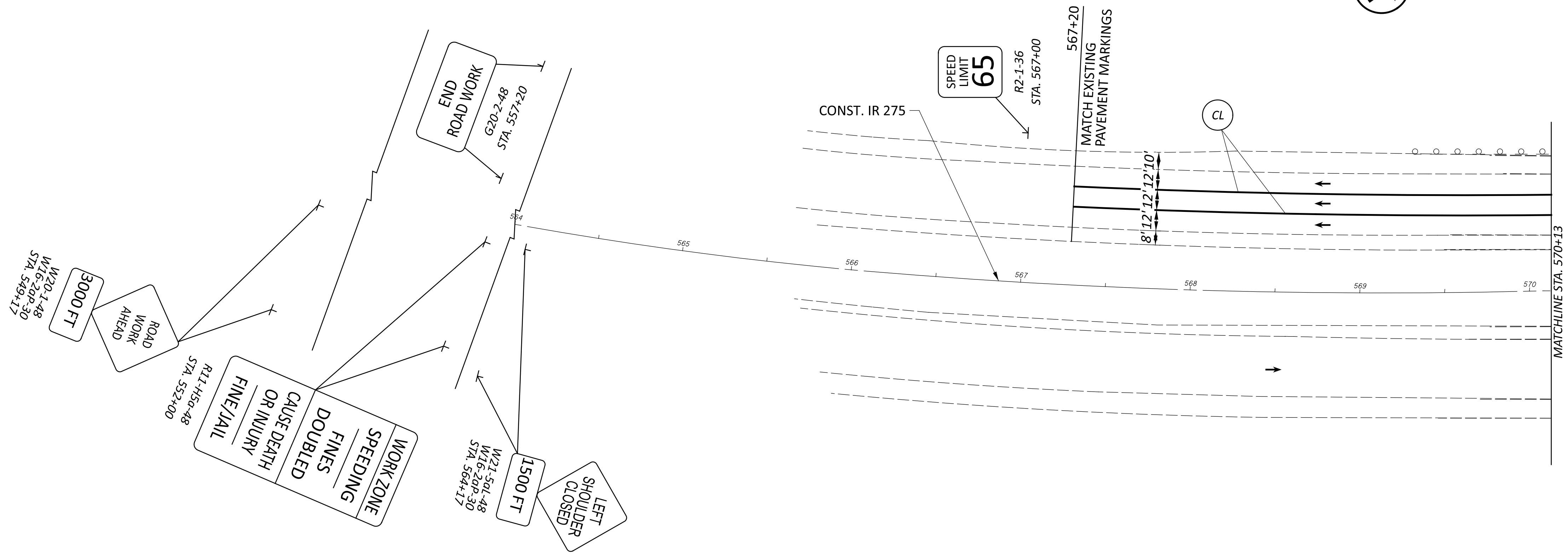

118051

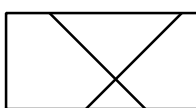
SHEET TOTAL

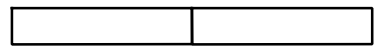
7 134



MAINTENANCE OF TRAFFIC LEGEND

-  WORK AREA
-  DIRECTION OF TRAVEL
-  DRUMS (SEE STANDARD DRAWINGS FOR SPACING)
-  PORTABLE CONCRETE BARRIER (UNANCHORED)
-  ITEM 614, WORK ZONE LANE LINE, CLASS I, 6"
-  ITEM 614, WORK ZONE CHANNELIZING LINE, CLASS I, 12"
-  ITEM 614, WORK ZONE DOTTED LINE, CLASS I, 6", 648
-  ITEM 614, WORK ZONE EDGE LINE, CLASS I, 6" (WHITE)
-  ITEM 614, WORK ZONE EDGE LINE, CLASS I, 6" (YELLOW)
-  ITEM 614, WORK ZONE IMPACT ATTENUATOR

SIGNING LEGEND

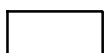
-  PROPOSED GROUND MOUNTED SIGN SUPPORT
-  PROPOSED SIGN

**MAINTENANCE OF TRAFFIC PLAN
 STA. 564+00 TO STA. 570+13**

DESIGN AGENCY



DESIGNER
 GAT

REVIEWER

XXX MM-DD-YY

PROJECT ID

118051

SHEET TOTAL

12 134

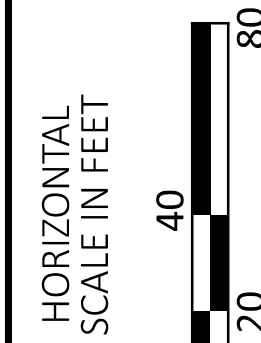

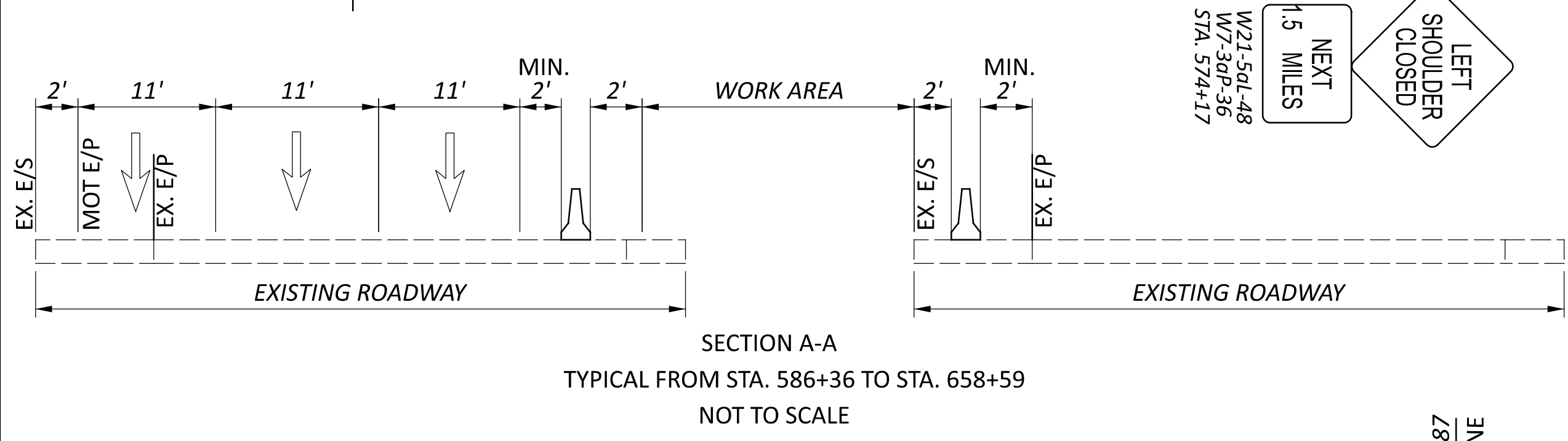
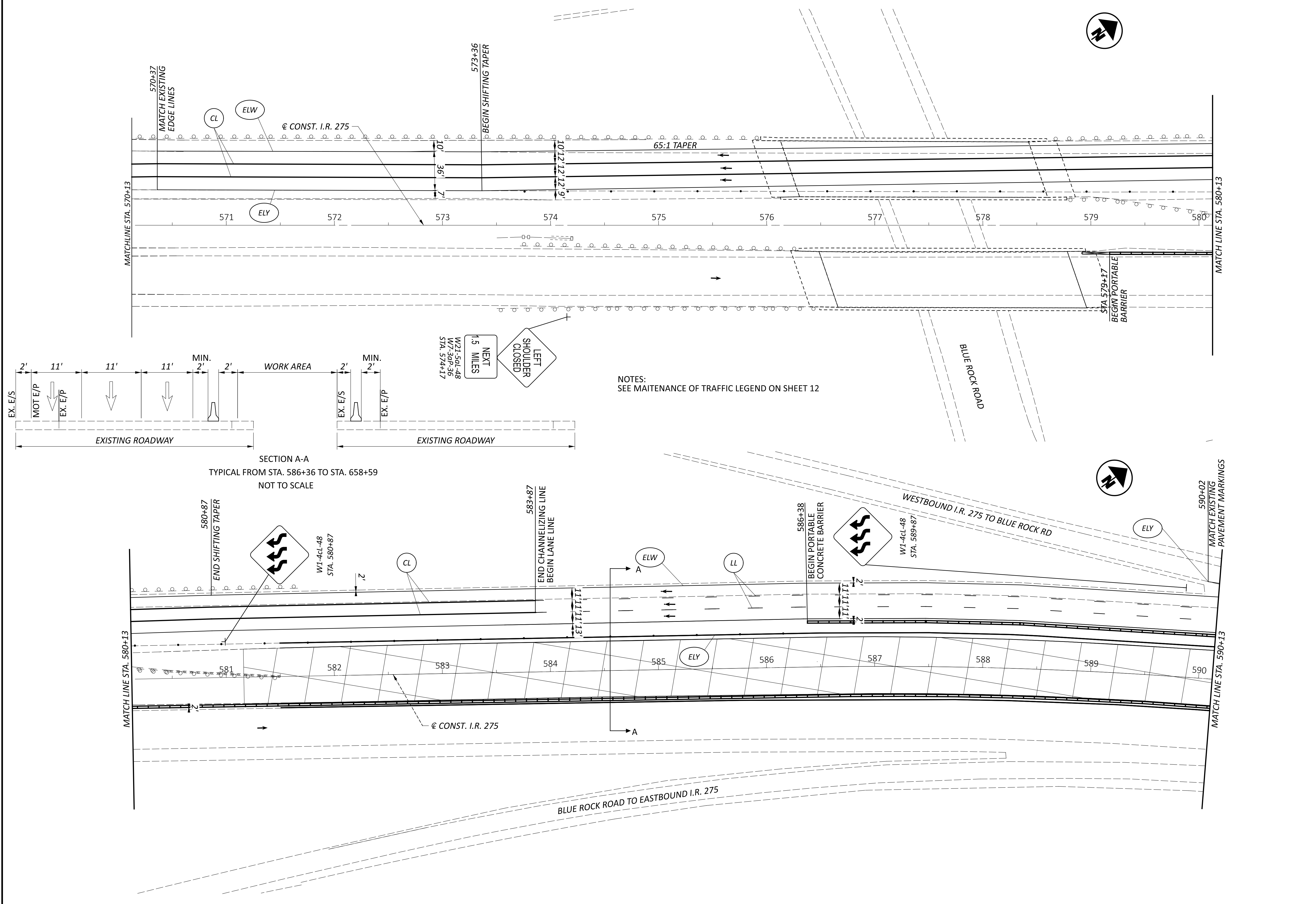

NOTES:
SEE MAINTENANCE OF TRAFFIC LEGEND ON SHEET 12

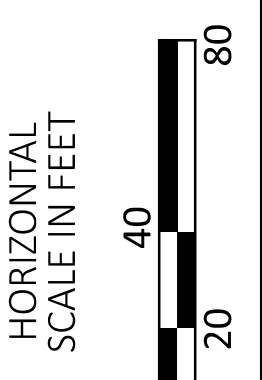
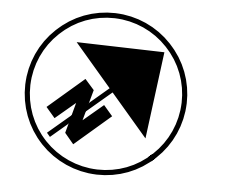
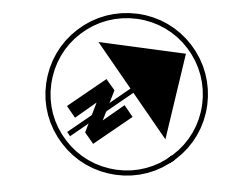

MAINTENANCE OF TRAFFIC PLAN
STA. 570+13.00 TO STA. 590+13.00

DESIGN AGENCY



DESIGNER	GAT
REVIEWER	XXX MM-DD-YY
PROJECT ID	118051
SHEET	TOTAL
13	134

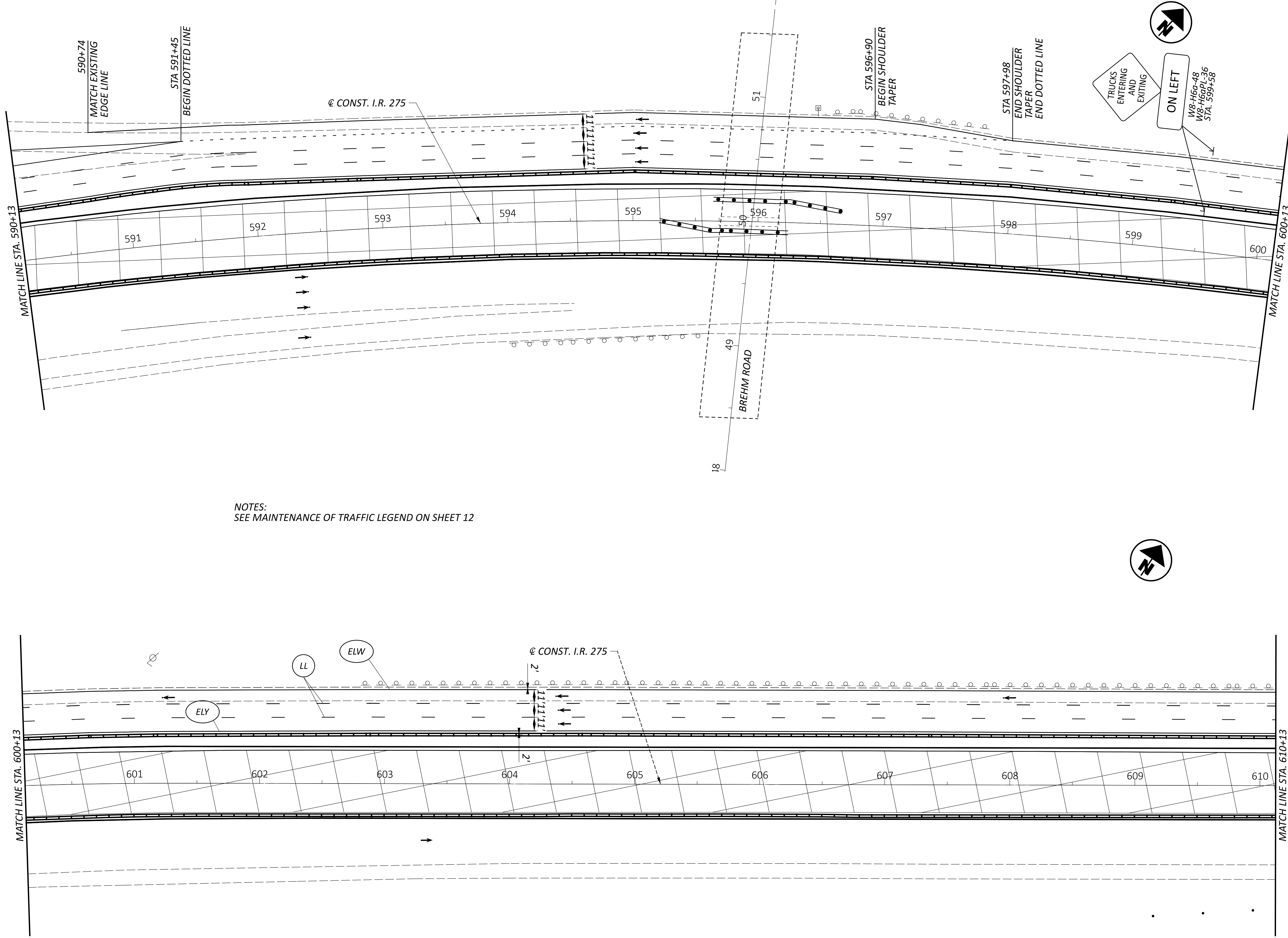

NOTES:
 SEE MAINTENANCE OF TRAFFIC LEGEND ON SHEET 12

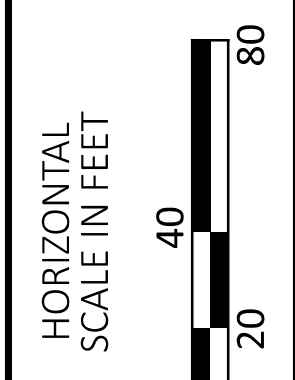

MAINTENANCE OF TRAFFIC PLAN
 STA. 590+13.00 TO STA. 610+13.00

DESIGN AGENCY



DESIGNER
 GAT

REVIEWER

XXX MM-DD-YY

PROJECT ID
 118051

SHEET	TOTAL
14	134

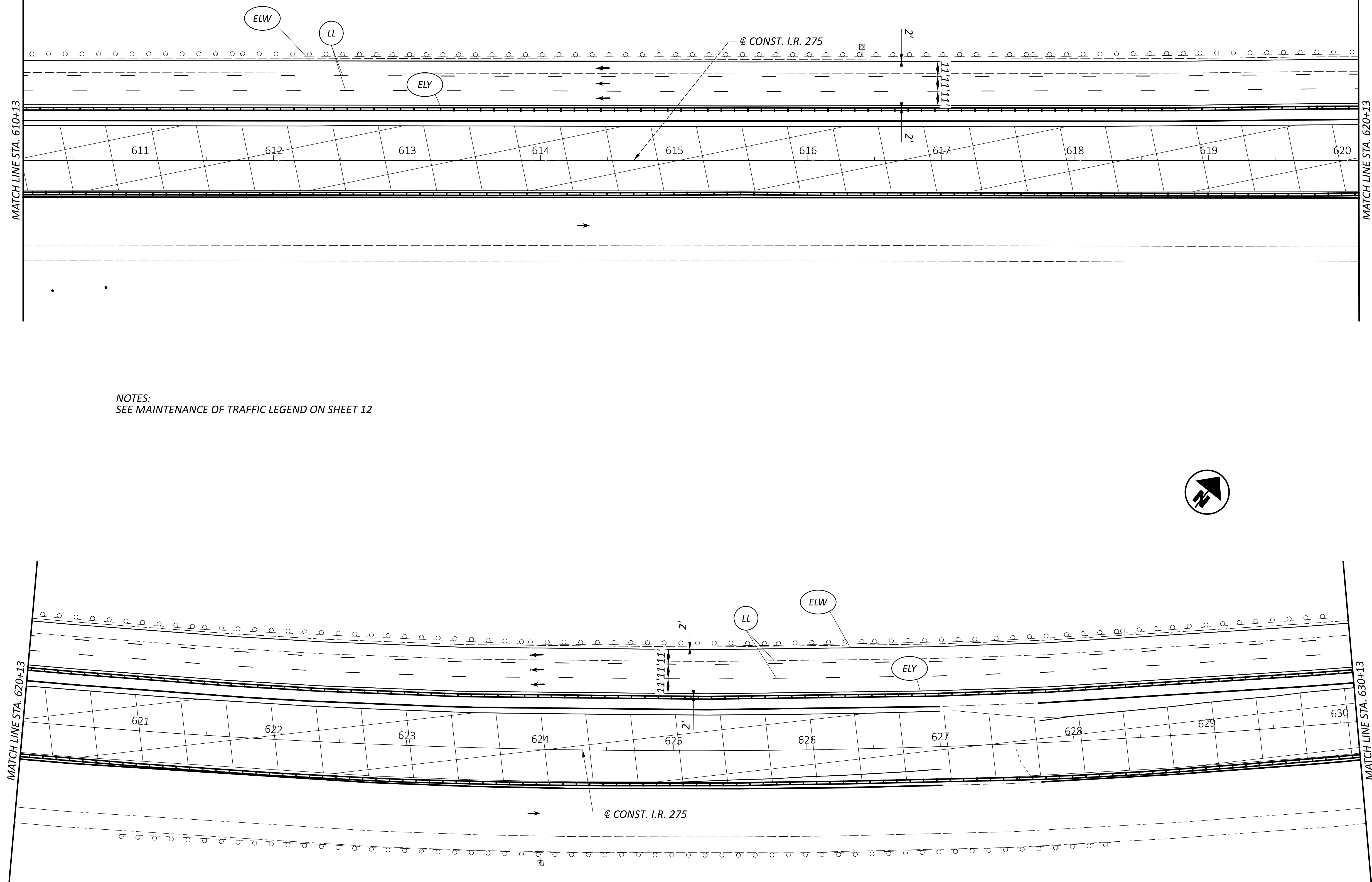

NOTES:
SEE MAINTENANCE OF TRAFFIC LEGEND ON SHEET 12

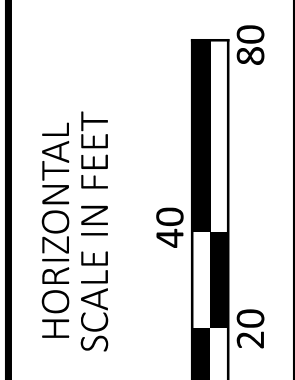

MAINTENANCE OF TRAFFIC PLAN
 STA. 610+13.00 TO STA. 630+13.00

DESIGN AGENCY



DESIGNER
GAT

REVIEWER

XXX MM-DD-YY

PROJECT ID
118051

SHEET	TOTAL
15	134

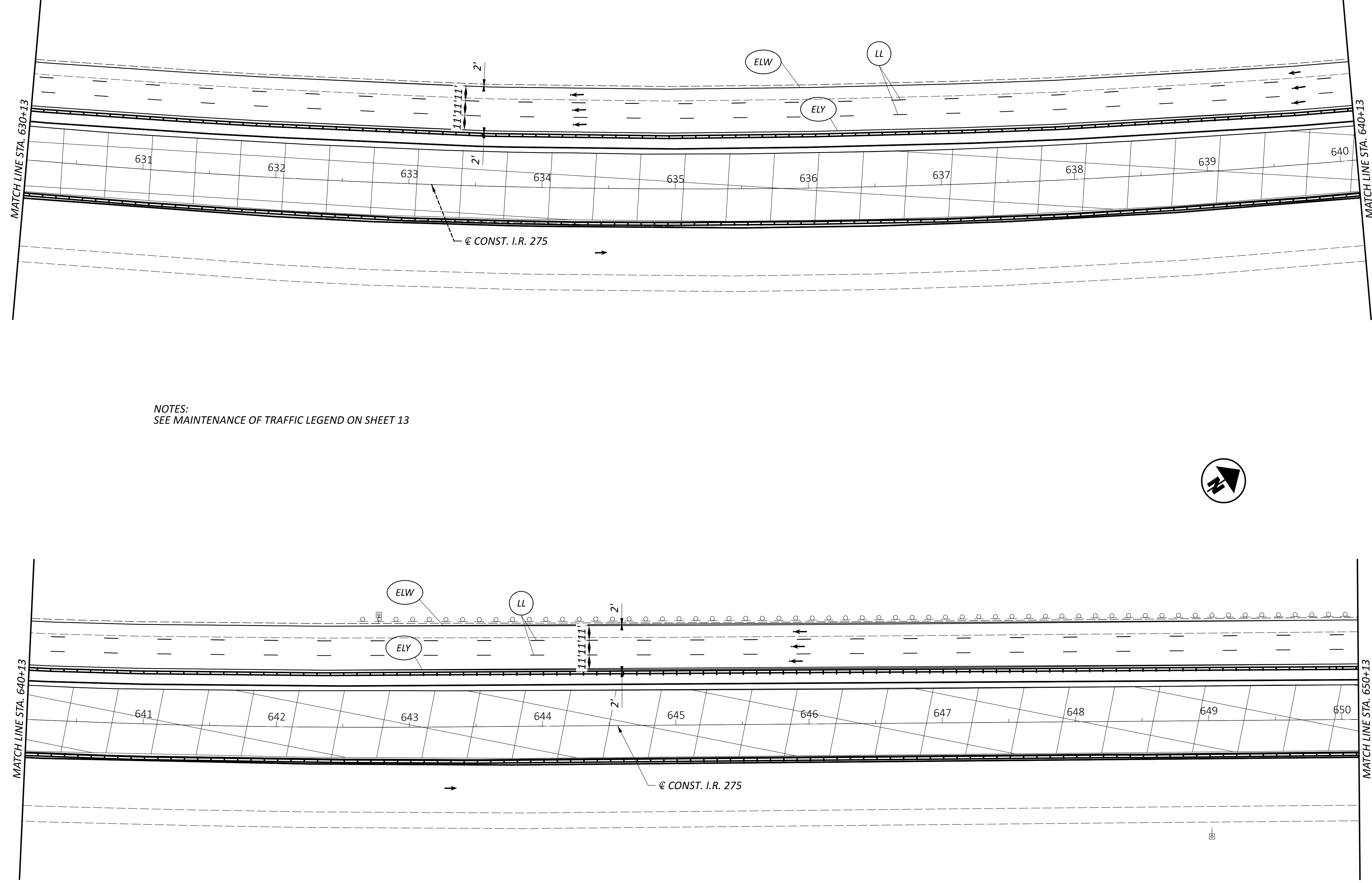

NOTES:
SEE MAINTENANCE OF TRAFFIC LEGEND ON SHEET 13

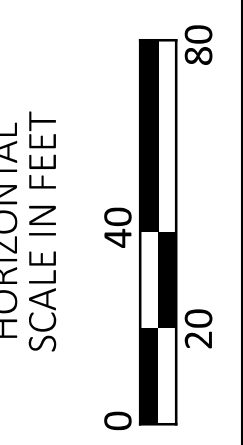

MAINTENANCE OF TRAFFIC PLAN
STA. 630+13.00 TO STA. 650+13.00

DESIGN AGENCY



DESIGNER

GAT

REVIEWER

XXX MM-DD-YY

PROJECT ID

118051

SHEET TOTAL

16 134

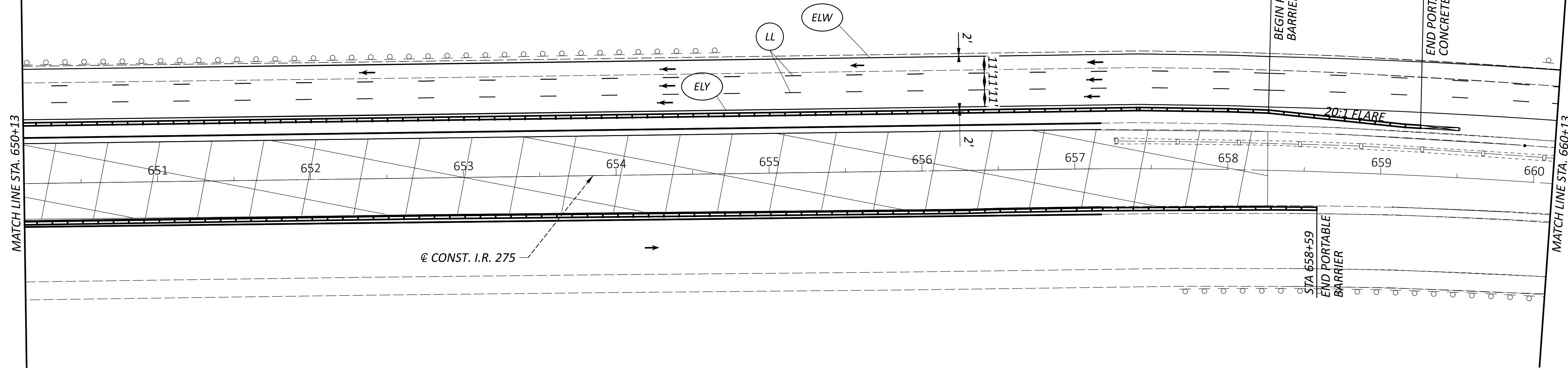

NOTES:
SEE MAINTENANCE OF TRAFFIC LEGEND ON SHEET 12

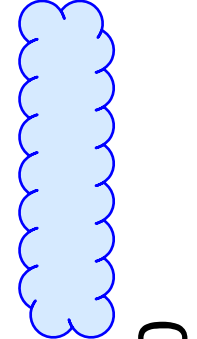
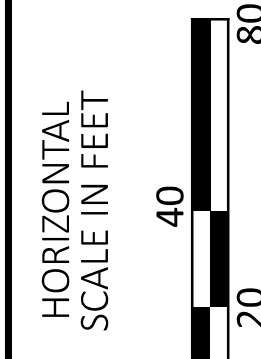
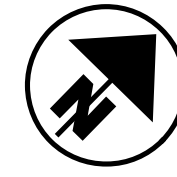
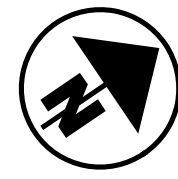
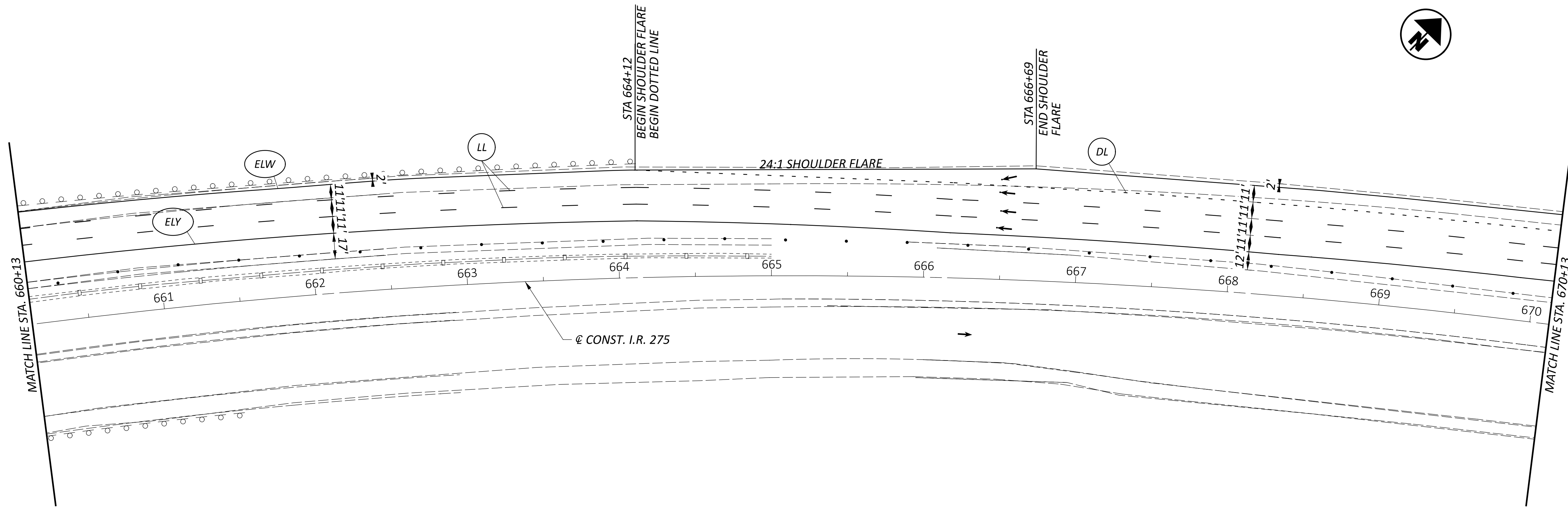

MAINTENANCE OF TRAFFIC PLAN
STA. 650+13.00 TO STA. 670+13.00

DESIGN AGENCY



DESIGNER

GAT

REVIEWER

XXX MM-DD-YY

PROJECT ID

118051

SHEET

17

TOTAL

134

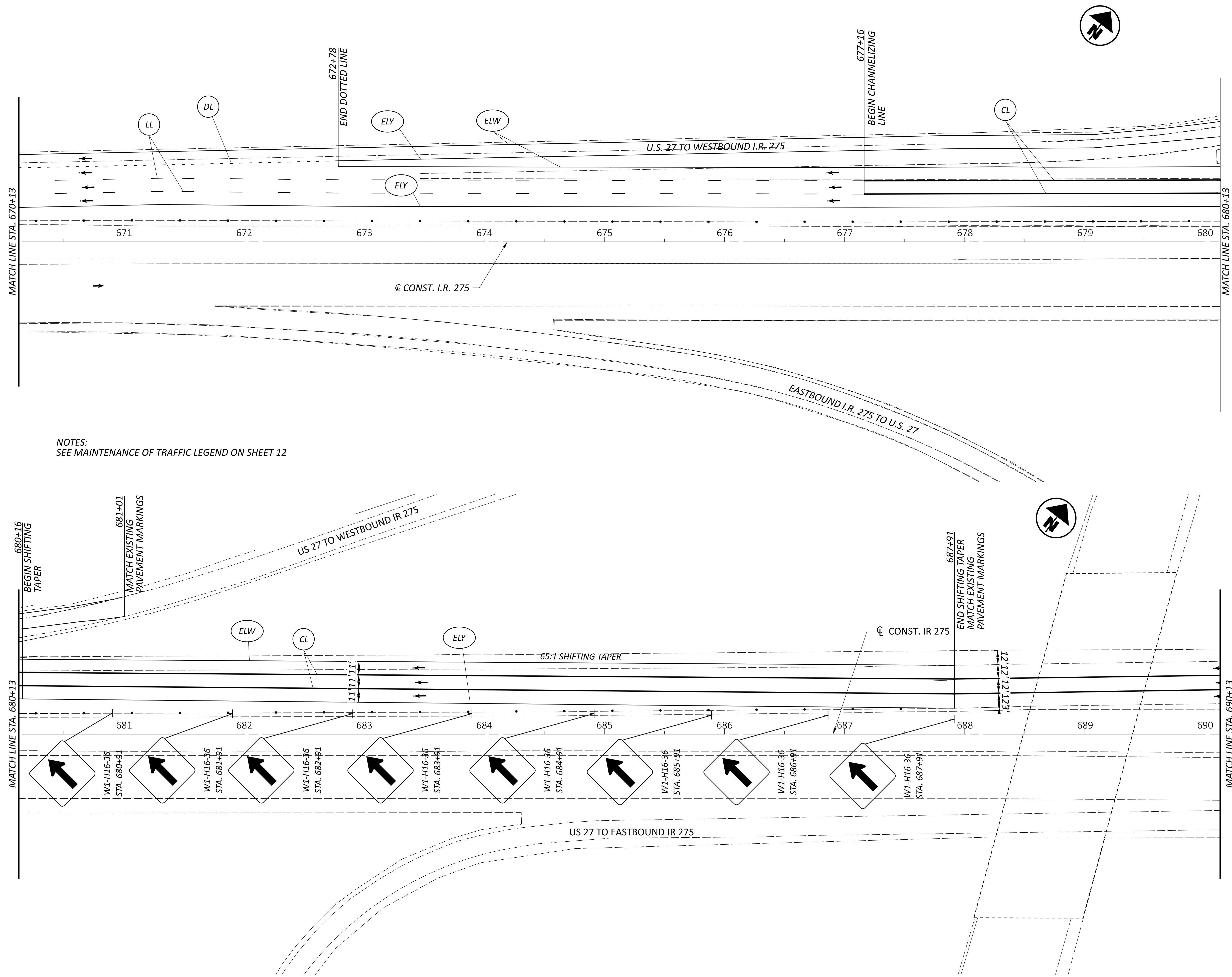

NOTES:
 SEE MAINTENANCE OF TRAFFIC LEGEND ON SHEET 12

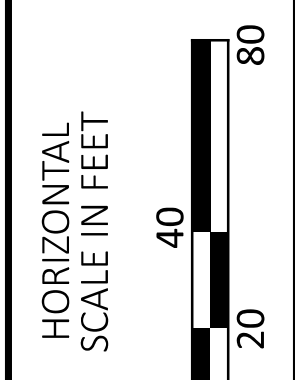

MAINTENANCE OF TRAFFIC PLAN
 STA. 670+13.00 TO STA. 690+13.00

DESIGN AGENCY



DESIGNER
 GAT

REVIEWER

XXX MM-DD-YY

PROJECT ID
 118051

SHEET TOTAL
 18 134

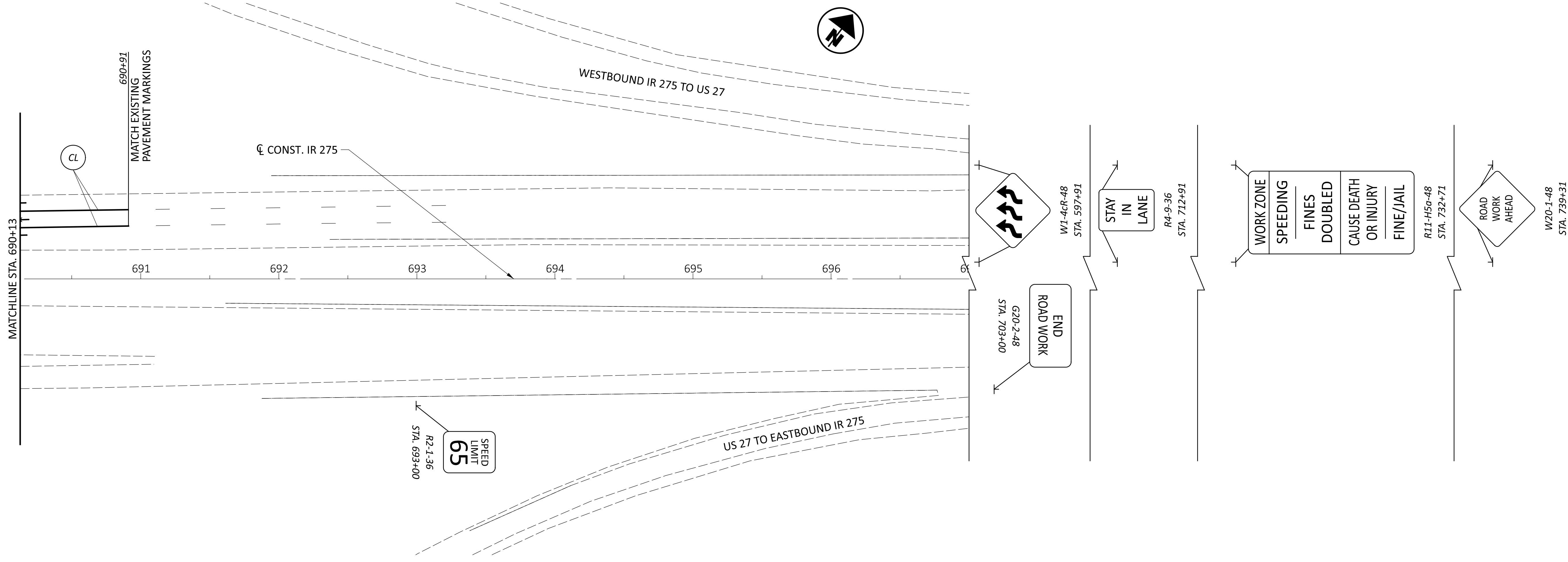

NOTES:
 SEE MAINTENANCE OF TRAFFIC LEGEND ON SHEET 12

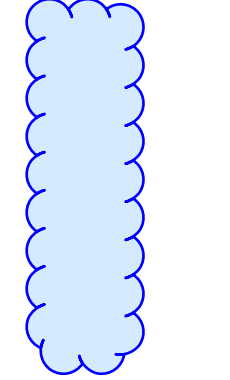
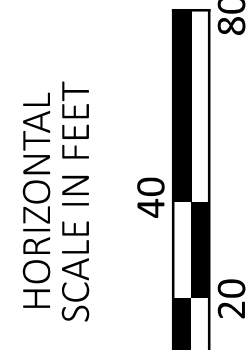

**MAINTENANCE OF TRAFFIC PLAN
 STA. 690+13 TO STA. 697+00**

DESIGN AGENCY



DESIGNER
GAT

REVIEWER

XXX MM-DD-YY

PROJECT ID
118051

SHEET	TOTAL
19	134

