

STATE OF OHIO

DEPARTMENT OF TRANSPORTATION

HAN-SR15/CR180-19.56/00.21

JACKSON TOWNSHIP HANCOCK COUNTY

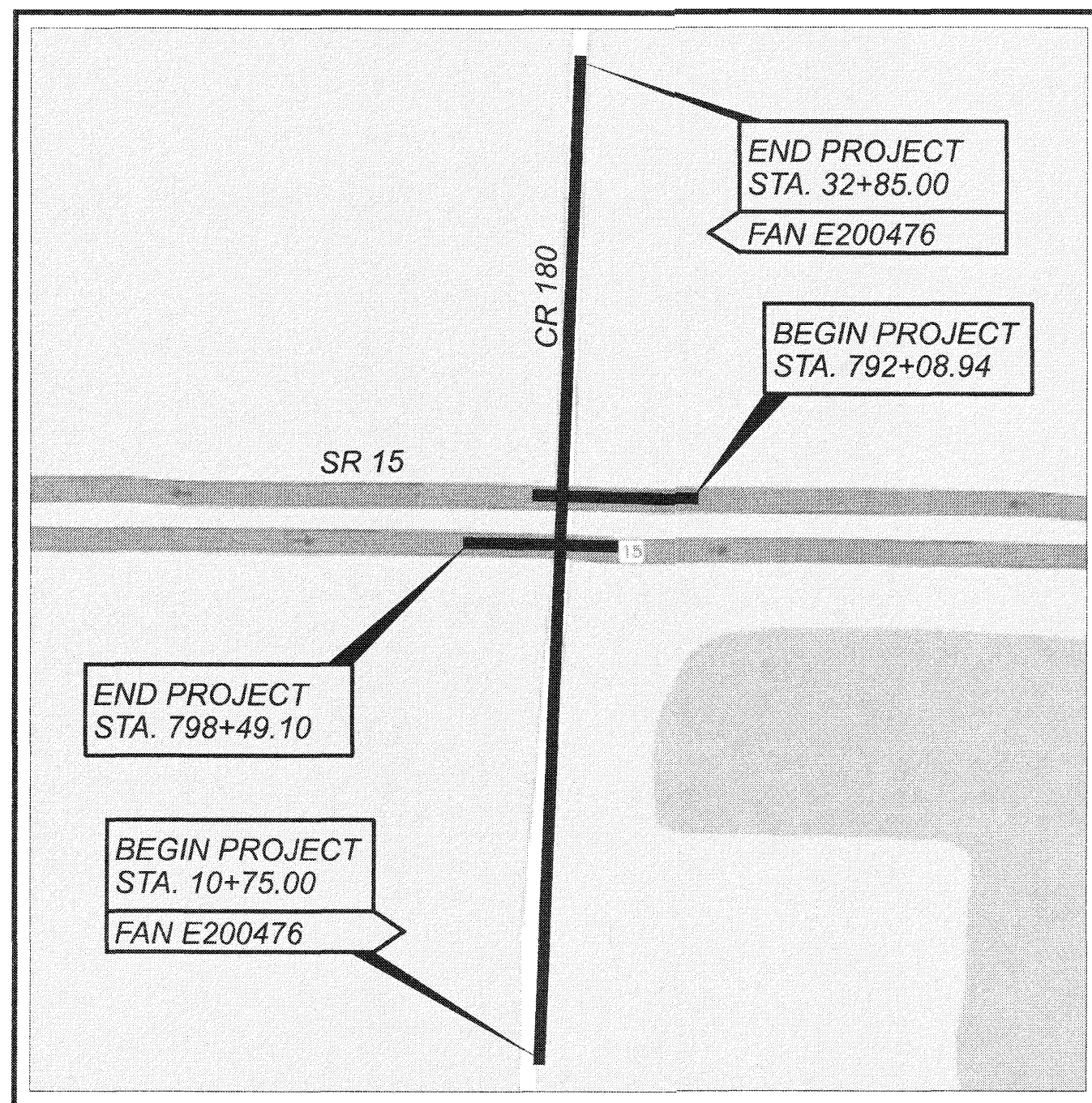

LOCATION MAP

LATITUDE: 40° 59' 10" LONGITUDE: 83° 36' 45"

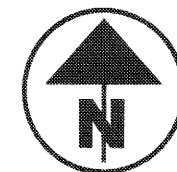

PORTION TO BE IMPROVED	—————	=====
INTERSTATE HIGHWAY	—————	=====
FEDERAL ROUTES	—————	=====
STATE ROUTES	—————	=====
COUNTY & TOWNSHIP ROADS	—————	=====
OTHER ROADS	—————	=====

DESIGN DESIGNATION

	<u>SR 15</u>	<u>CR 180</u>
CURRENT ADT (2022)	16,500	1,762
DESIGN YEAR ADT (2042)	20,000	1,937
DESIGN HOURLY VOLUME (2042)	2,400	213
DIRECTIONAL DISTRIBUTION	58%	55%
TRUCKS (24 HOUR B&C)	34%	2.2%
DESIGN SPEED	70 MPH	55 MPH
LEGAL SPEED	65 MPH	55 MPH
DESIGN FUNCTIONAL CLASSIFICATION:	RURAL PRINCIPAL ARTERIAL	RURAL MINOR COLLECTOR

NHS PROJECT YES

DESIGN EXCEPTIONS

DESIGN FEATURE	APPROVAL DATE	SHEET NUMBER
GRADED SHOULDER WIDTH	04-26-22	5

ADA DESIGN WAIVERS

NONE REQUIRED

UNDERGROUND UTILITIES

Contact Two Working Days
Before You Dig



OHIO811.org
Before You Dig

OHIO811, 8-1-1, or 1-800-362-2764
(Non members must be called directly)

RICHLAND ENGINEERING LTD
A WALLACEPANCHER GROUP COMPANY

29 NORTH PARK STREET
MANSFIELD OHIO 44902
PHONE: (419) 524-0074
www.wallacepancher.com

ENGINEER'S SEAL:



SIGNED: *[Signature]*
DATE: 10-11-2022

INDEX OF SHEETS:

TITLE SHEET	1
SCHEMATIC PLAN	2
TYPICAL SECTIONS	3-6
GENERAL NOTES	7-10
MAINTENANCE OF TRAFFIC	11-28
GENERAL SUMMARY	29-31
SUBSUMMARIES	32-37
CALCULATIONS	38-40
PROJECT SITE PLAN	41
PLAN AND PROFILE - CR 180	42-51
CROSS SECTIONS - CR 180	52-72
PLAN - SR 15	73-74
CROSS SECTIONS - SR 15	75-85
DRAINAGE DETAILS	86-89
TRAFFIC CONTROL	90-94
STRUCTURE (OVER 20')	95-117
RIGHT OF WAY	118-126
SOIL PROFILE - STRUCTURE FOUNDATION/ ROADWAY EXPLORATION	127-149

FEDERAL PROJECT NUMBER

E200 (476)

RAILROAD INVOLVEMENT

NONE

PROJECT DESCRIPTION

THE PROJECT CONSISTS OF ELIMINATING THE EXISTING CR 180 AT-GRADE INTERSECTION WITH SR 15 BY CONSTRUCTING A GRADE SEPARATION USING AN OVERPASS BRIDGE.

PROJECT LENGTH = 0.42 MILES.

EARTH DISTURBED AREAS

PROJECT EARTH DISTURBED AREA:	8.3 ACRES
ESTIMATED CONTRACTOR EARTH DISTURBED AREA:	5.2 ACRES
NOTICE OF INTENT EARTH DISTURBED AREA:	13.5 ACRES

LIMITED ACCESS

THIS IMPROVEMENT IS ESPECIALLY DESIGNED FOR THROUGH TRAFFIC ON SR 15 AND HAS BEEN DECLARED A LIMITED ACCESS HIGHWAY, OR FREEWAY, BY ACTION OF THE DIRECTOR IN ACCORDANCE WITH THE PROVISIONS OF SECTION 5511.02 OF THE OHIO REVISED CODE.

2019 SPECIFICATIONS

THE STANDARD SPECIFICATIONS OF THE STATE OF OHIO, DEPARTMENT OF TRANSPORTATION, INCLUDING SUPPLEMENTAL SPECIFICATIONS LISTED IN THE PLANS AND CHANGES LISTED IN THE PROPOSAL SHALL GOVERN THIS IMPROVEMENT.

I HEREBY APPROVE THESE PLANS AND DECLARE THAT THE MAKING OF THIS IMPROVEMENT WILL NOT REQUIRE THE CLOSING TO TRAFFIC OF SR 15, EXCEPT AS NOTED ON SHEET 11, AND THAT PROVISIONS FOR THE MAINTENANCE AND SAFETY OF TRAFFIC WILL BE AS SET FORTH ON THE PLANS AND ESTIMATES. THE MAKING OF THIS IMPROVEMENT WILL REQUIRE THE CLOSING TO TRAFFIC OF CR 180 AND DETOURS WILL BE PROVIDED AS INDICATED ON SHEET 18. THE MAKING OF THIS IMPROVEMENT WILL REQUIRE PARTIAL CLOSING TO TRAFFIC OF CR 8 BY PERMITTING RIGHT TURN ONLY MOVEMENTS AT THE INTERSECTION WITH SR 15.

STANDARD CONSTRUCTION DRAWINGS										SUPPLEMENTAL SPECIFICATIONS	SPECIAL PROVISIONS
BP-3.1	1-21-22	F-2.1	7-20-18	MH-3	7-16-21	RM-1.1	1-15-21	AS-1-15	7-17-15	800-2019 SEE PROPOSAL	
BP-3.2	1-18-19	F-3.4	7-19-13			RM-4.2	4-17-20	AS-2-15	1-18-19	832	7-15-22
BP-4.1	7-19-13			MT-95.30	7-19-19			GSD-1-19	1-15-21	840	4-15-22
BP-9.1	1-18-19	HL-50.11	1-16-15	MT-95.40	1-17-20	TC-61.30	7-19-19	SBR-1-20	7-17-20	902	7-19-19
				MT-95.45	1-17-20	TC-65.10	1-17-14	SICD-1-21	1-21-22		
CB-2-2ABC	7-15-22	HW-2.1	7-20-18	MT-95.50	7-21-17	TC-65.11	7-15-22	SICD-2-14	1-15-21		
CB-3A	7-16-21	HW-2.2	7-20-18	MT-97.10	4-19-19			VPF-1-90	7-20-18		
CB-5	7-16-21			MT-99.20	4-19-19						
CB-8	7-16-21	MGS-1.1	7-16-21	MT-99.60	7-15-16						
		MGS-2.1	1-19-18	MT-101.60	1-17-20						
DM-1.1	7-17-20	MGS-3.1	1-19-18	MT-101.70	1-17-20						
DM-1.2	7-16-21	MGS-4.2	7-19-13	MT-101.75	1-17-20						
DM-4.1	7-17-20	MGS-5.2	7-15-16	MT-101.90	7-17-20						
DM-4.3	1-15-16	MGS-5.3	7-15-16	MT-103.10	1-21-22						
DM-4.4	1-15-16	MGS-6.2	7-19-19								

TITLE SHEET

DESIGN AGENCY



DESIGNER

ALP

REVIEWER

PRS 4-21-22

PROJECT ID

111379

SHEET TOTAL

1 149

HAN-SR15/CR180-19.56/00.21

MODEL: Sheet PAPER SIZE: 17x11 (in.) DATE: 10/12/2022 TIME: 11:22:35 AM USER: smorr F:\2020\21481 HAN-SR15-19.56-HAN-180-0.21 - ODOT\111379\400-Engineering\Roadway\Sheets\111379_GT001.dgn

LEGEND

- DRAINAGE DIVIDE LINE
- * LONGITUDE AND LATITUDE TO APPROXIMATE CENTER OF PROJECT.
- ▲ CALCULATED PER L&D VOL. 2 SEC. 1111.7
- ⊗ VEGETATED FILTER STRIPS
- ▨ WEARING COURSE REMOVED AND RESURFACING
- ⊘ ITEM 670 - SLOPE EROSION
- ▩ DITCH CLEANOUT OR PLANING AND RESURFACING
- INCLUDE AREA IN ITEM 201 - CLEARING AND GRUBBING

BMP TYPE	LOCATION	LATITUDE/LONGITUDE		AVERAGE STRIP WIDTH (FT)	EDA TREATMENT CREDIT (ACRES)		
		BEGIN	END				
VEGETATED FILTER STRIP	CR 180	40.984835	83.613080	40.985521	83.613043	63.44	0.45
VEGETATED FILTER STRIP	CR 180	40.984832	83.612971	40.985518	83.612934	67.79	0.48
VEGETATED FILTER STRIP	CR 180	40.986755	83.612977	40.987303	83.612947	68.15	0.38
VEGETATED FILTER STRIP	CR 180	40.986752	83.612868	40.987300	83.612839	68.23	0.38
TREATMENT PROVIDED					1.69		
TREATMENT REQUIRED▲					1.67		

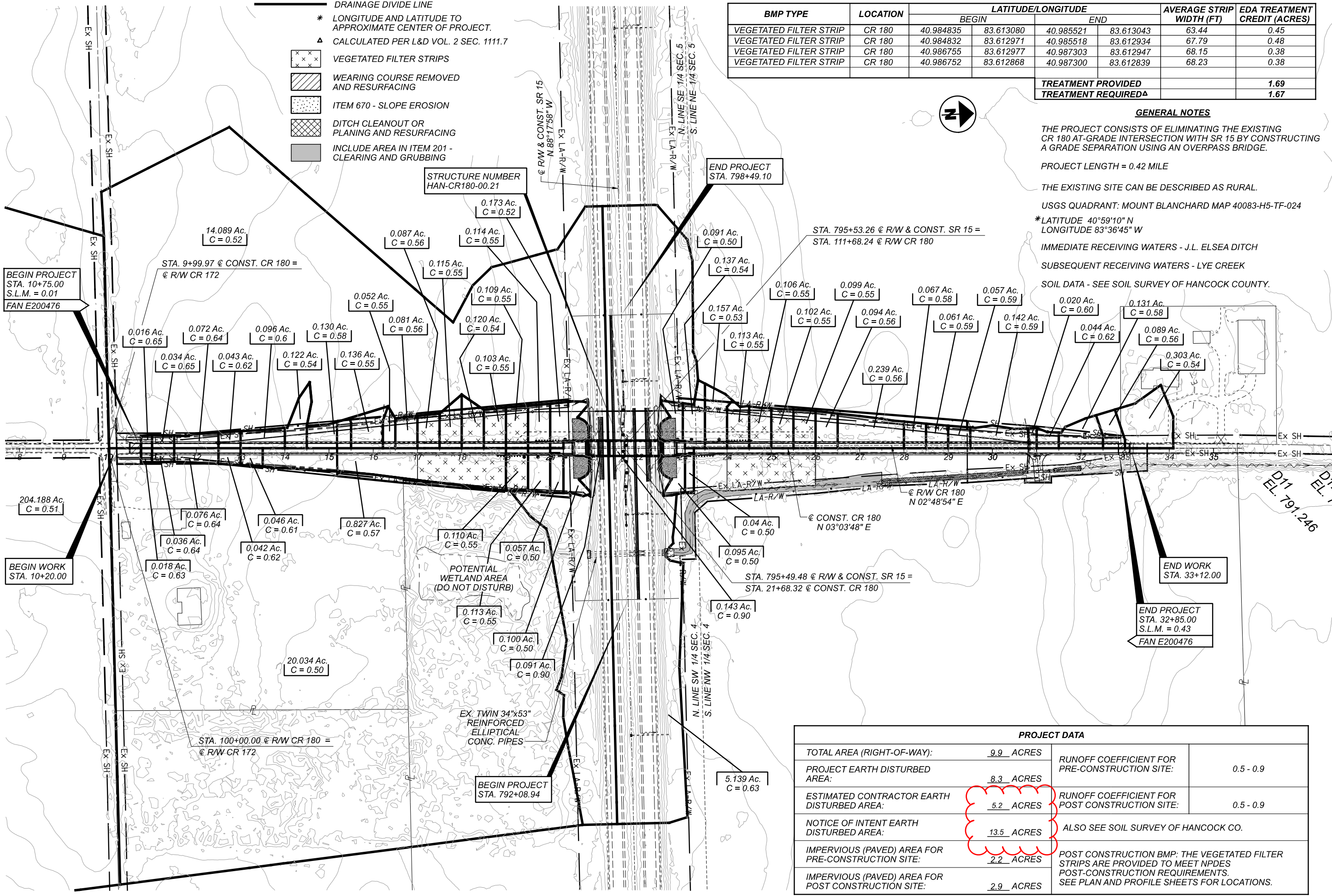
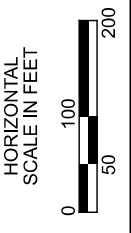

GENERAL NOTES

THE PROJECT CONSISTS OF ELIMINATING THE EXISTING CR 180 AT-GRADE INTERSECTION WITH SR 15 BY CONSTRUCTING A GRADE SEPARATION USING AN OVERPASS BRIDGE.

PROJECT LENGTH = 0.42 MILE

THE EXISTING SITE CAN BE DESCRIBED AS RURAL.

USGS QUADRANT: MOUNT BLANCHARD MAP 40083-H5-TF-024

*LATITUDE 40°59'10" N
 LONGITUDE 83°36'45" W

IMMEDIATE RECEIVING WATERS - J.L. ELSEA DITCH
 SUBSEQUENT RECEIVING WATERS - LYE CREEK

SOIL DATA - SEE SOIL SURVEY OF HANCOCK COUNTY.

PROJECT SITE PLAN

PROJECT DATA	
TOTAL AREA (RIGHT-OF-WAY):	9.9 ACRES
PROJECT EARTH DISTURBED AREA:	8.3 ACRES
ESTIMATED CONTRACTOR EARTH DISTURBED AREA:	5.2 ACRES
NOTICE OF INTENT EARTH DISTURBED AREA:	13.5 ACRES
IMPERVIOUS (PAVED) AREA FOR PRE-CONSTRUCTION SITE:	2.2 ACRES
IMPERVIOUS (PAVED) AREA FOR POST CONSTRUCTION SITE:	2.9 ACRES
RUNOFF COEFFICIENT FOR PRE-CONSTRUCTION SITE:	0.5 - 0.9
RUNOFF COEFFICIENT FOR POST CONSTRUCTION SITE:	0.5 - 0.9
ALSO SEE SOIL SURVEY OF HANCOCK CO.	
POST CONSTRUCTION BMP: THE VEGETATED FILTER STRIPS ARE PROVIDED TO MEET NPDES POST-CONSTRUCTION REQUIREMENTS. SEE PLAN AND PROFILE SHEETS FOR LOCATIONS.	

DESIGN AGENCY

DESIGNER
ALP

REVIEWER
PRS 4-21-22

PROJECT ID
111379

SHEET TOTAL
41 149