

- (A) - S 35° 22' 43" W
- (B) - N 40° 35' 27" W
- (C) - N 60° 09' 30" E
- (D) - N 52° 11' 40" E
- (E) - N 27° 47' 01" W

NOTE:
FOR CURVE DATA SEE SHEET 6.

* EXISTING 34:1 F.A.R.
APPROACH SURFACE

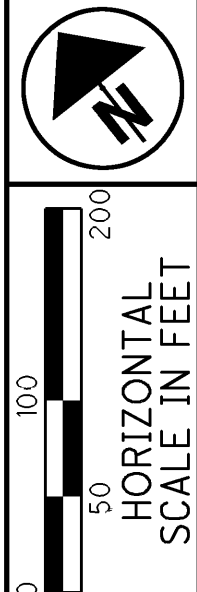
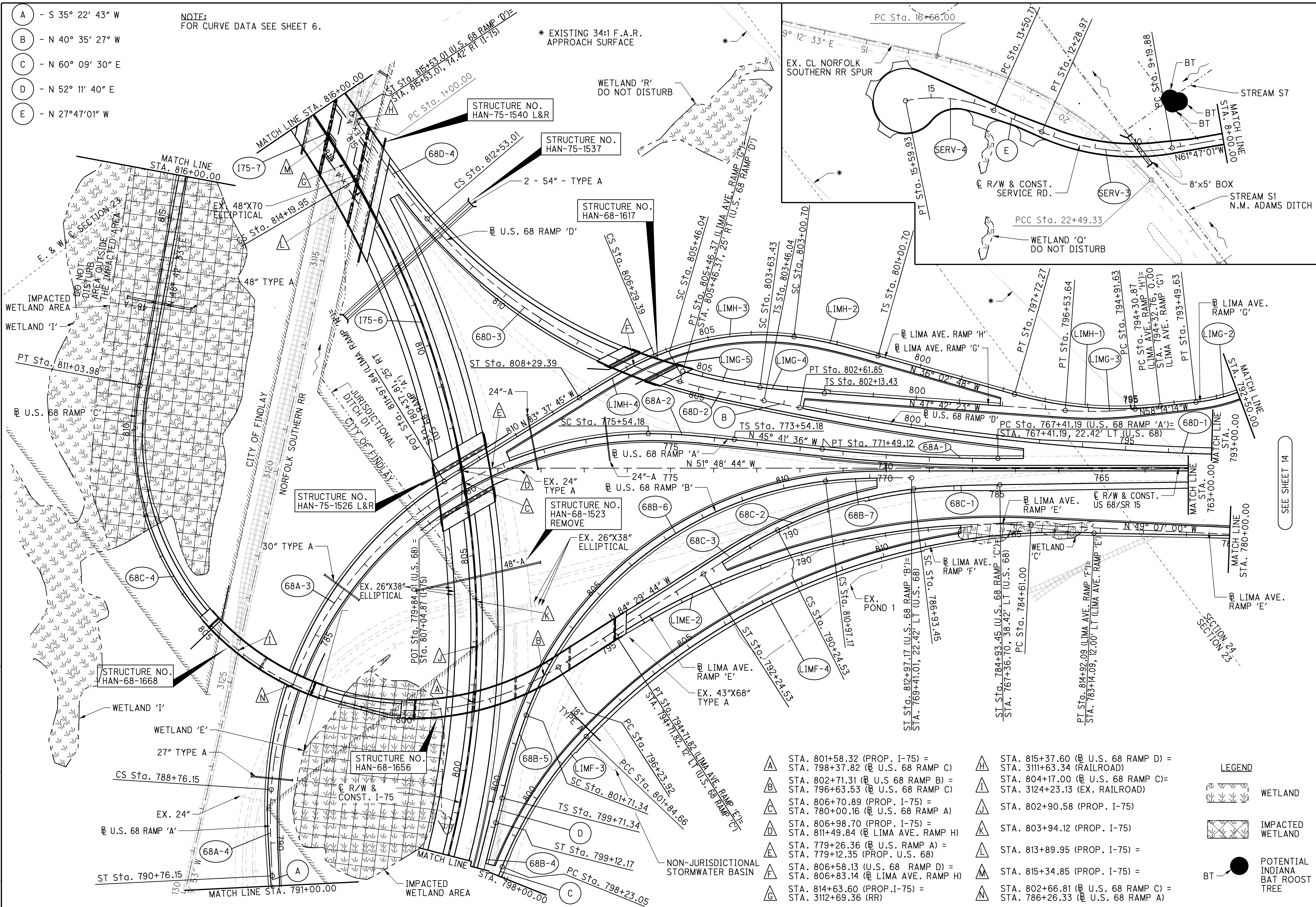

SCHEMATIC PLAN

HAN-75-14.39

T:\Projects\HAN\87005\roadway\sheets\87005GB003.dgn 21-AUG-2014 12:09 AM redderj

SEE SHEET 14

LEGEND	
	WETLAND
	IMPACTED WETLAND
	POTENTIAL INDIANA BAT ROOST TREE

	STA. 801+58.32 (PROP. I-75) =		STA. 815+37.60 (U.S. 68 RAMP D) =
	STA. 798+37.82 (U.S. 68 RAMP C)		STA. 3111+63.34 (RAILROAD)
	STA. 802+71.31 (U.S. 68 RAMP B) =		STA. 804+17.00 (U.S. 68 RAMP C) =
	STA. 796+63.53 (U.S. 68 RAMP C)		STA. 3124+23.13 (EX. RAILROAD)
	STA. 806+70.89 (PROP. I-75) =		STA. 802+90.58 (PROP. I-75)
	STA. 780+00.16 (U.S. 68 RAMP A)		STA. 803+94.12 (PROP. I-75)
	STA. 806+98.70 (PROP. I-75) =		STA. 813+89.95 (PROP. I-75) =
	STA. 811+49.84 (U.S. RAMP H)		STA. 815+34.85 (PROP. I-75) =
	STA. 779+26.36 (U.S. RAMP A) =		STA. 802+66.81 (U.S. 68 RAMP C) =
	STA. 779+12.35 (PROP. U.S. 68)		STA. 786+26.33 (U.S. 68 RAMP A)
	STA. 806+58.13 (U.S. 68 RAMP D) =		
	STA. 806+83.14 (U.S. RAMP H)		
	STA. 814+63.60 (PROP. I-75) =		
	STA. 3112+69.36 (RR)		

CURVE I75-6
 P.I. Sta. 806+27.29
 $\Delta = 65^\circ 53' 13''$ (LT)
 $Dc = 2^\circ 45' 00''$
 $R = 2,083.48'$
 $Ls = 500.00'$
 $\theta s = 6^\circ 52' 30''$
 $LT = 333.59'$
 $ST = 166.90'$
 $x = 499.28'$
 $y = 19.98'$
 $k = 249.88'$
 $p = 5.00'$
 $\Delta c = 52^\circ 08' 13''$ (LT)
 $Lc = 1,895.89'$
 $Ts = 1,603.22'$
 $Es = 405.15'$
 $C = 1,831.15'$
 $C1 = C2 = 499.68'$
 C.B.1 = N $64^\circ 45' 28''$ E
 C.B. = N $34^\circ 06' 21''$ E
 C.B.2 = S $3^\circ 27' 13''$ W
 $e_d = 0.060$

CURVE I75-7
 P.I. STA. 815+86.84
 $Ls = 500.00'$
 $f s = 6^\circ 52' 30''$
 $LT = 333.59'$
 $ST = 166.90'$
 $x = 499.28'$
 $y = 19.98'$
 $k = 249.88'$
 $p = 5.00'$

CURVE 68A-1
 P.I. Sta. 769+45.35
 $\Delta = 6^\circ 07' 08''$ (RT)
 $Dc = 1^\circ 30' 00''$
 $R = 3,819.72'$
 $T = 204.16'$
 $L = 407.93'$
 $E = 5.45'$
 $C = 407.74'$
 C.B. = N $48^\circ 45' 10''$ W
 $e_d = 0.037$

CURVE 68A-2
 P.I. STA. 774+87.60
 $Ls = 200.00'$
 $f s = 6^\circ 30' 00''$
 $LT = 133.42'$
 $ST = 66.75'$
 $x = 199.74'$
 $y = 7.56'$
 $k = 99.96'$
 $p = 1.89'$

CURVE 68A-3
 P.I. Sta. 784+87.11
 $\Delta = 98^\circ 55' 42''$ (LT)
 $Dc = 6^\circ 30' 00''$
 $R = 881.47'$
 $Ls = 200.00'$
 $\theta s = 6^\circ 30' 00''$
 $LT = 133.42'$
 $ST = 66.75'$
 $x = 199.74'$
 $y = 7.56'$
 $k = 99.96'$
 $p = 1.89'$
 $\Delta c = 85^\circ 55' 42''$ (LT)
 $Lc = 1,321.97'$
 $Ts = 1,132.93'$
 $Es = 477.71'$
 $C = 1,201.52'$
 $C1 = C2 = 199.89'$
 C.B.1 = N $47^\circ 51' 35''$ W
 C.B. = S $84^\circ 50' 34''$ W
 C.B.2 = N $37^\circ 32' 42''$ E
 $e_d = 0.060$

CURVE 68A-4
 P.I. STA. 789+42.90
 $Ls = 200.00'$
 $f s = 6^\circ 30' 00''$
 $LT = 133.42'$
 $ST = 66.75'$
 $x = 199.74'$
 $y = 7.56'$
 $k = 99.96'$
 $p = 1.89'$

CURVE 68B-4
 P.I. STA. 797+78.85
 $Ls = 200.00'$
 $f s = 2^\circ 45' 00''$
 $LT = 133.35'$
 $ST = 66.68'$
 $x = 199.95'$
 $y = 3.20'$
 $k = 99.99'$
 $p = 0.80'$

CURVE 68B-5
 P.I. STA. 801+04.77
 $Ls = 200.00'$
 $f s = 6^\circ 45' 00''$
 $LT = 133.43'$
 $ST = 66.75'$
 $x = 199.72'$
 $y = 7.85'$
 $k = 99.95'$
 $p = 1.96'$

CURVE 68B-6
 P.I. Sta. 807+35.92
 $\Delta = 75^\circ 59' 36''$ (RT)
 $Dc = 6^\circ 45' 00''$
 $R = 848.83'$
 $Ls = 200.00'$
 $\theta s = 6^\circ 45' 00''$
 $LT = 133.43'$
 $ST = 66.75'$
 $x = 199.72'$
 $y = 7.85'$
 $k = 99.95'$
 $p = 1.96'$
 $\Delta c = 62^\circ 29' 36''$ (RT)
 $Lc = 925.83'$
 $Ts = 764.58'$
 $Es = 230.79'$
 $C = 880.61'$
 $C1 = C2 = 199.88'$
 C.B.1 = N $54^\circ 26' 39''$ E
 C.B. = S $89^\circ 48' 32''$ E
 C.B.2 = N $54^\circ 03' 43''$ W
 $e_d = 0.060$

CURVE 68B-7
 P.I. Sta. 811+63.92
 $Ls = 200.00'$
 $f s = 6^\circ 45' 00''$
 $LT = 133.43'$
 $ST = 66.75'$
 $x = 199.72'$
 $y = 7.85'$
 $k = 99.95'$
 $p = 1.96'$

CURVE 68C-1
 P.I. STA. 816+26.86
 $Ls = 200.00'$
 $f s = 6^\circ 00' 00''$
 $LT = 133.41'$
 $ST = 66.74'$
 $x = 199.95'$
 $y = 6.98'$
 $k = 99.96'$
 $p = 1.74'$

CURVE 68C-2
 P.I. Sta. 788+66.52
 $\Delta = 31^\circ 51' 54''$ (LT)
 $Dc = 6^\circ 00' 00''$
 $R = 954.93'$
 $Ls = 200.00'$
 $\theta s = 6^\circ 00' 00''$
 $LT = 133.41'$
 $ST = 66.74'$
 $x = 199.78'$
 $y = 6.98'$
 $k = 99.96'$
 $p = 1.74'$
 $\Delta c = 19^\circ 51' 54''$ (LT)
 $Lc = 331.08'$
 $Ts = 373.06'$
 $Es = 39.96'$
 $C = 329.43'$
 $C1 = C2 = 199.90'$
 C.B.1 = N $54^\circ 37' 50''$ W
 C.B. = N $68^\circ 33' 47''$ W
 C.B.2 = S $82^\circ 29' 44''$ E
 $e_d = 0.059$

CURVE 68C-3
 P.I. STA. 790+91.27
 $Ls = 200.00'$
 $f s = 6^\circ 00' 00''$
 $LT = 133.41'$
 $ST = 66.74'$
 $x = 199.78'$
 $y = 6.98'$
 $k = 99.96'$
 $p = 1.74'$

CURVE 68C-4
 P.I. Sta. 810+95.23
 $\Delta = 133^\circ 12' 17''$ (RT)
 $Dc = 9^\circ 00' 00''$
 $R = 636.62'$
 $T = 1,471.31'$
 $L = 1,480.05'$
 $E = 966.51'$
 $C = 1,168.54'$
 C.B. = N $17^\circ 53' 35''$ W
 $e_d = 0.060$

CURVE 68D-1
 P.I. Sta. 797+02.59
 $\Delta = 11^\circ 13' 16''$ (RT)
 $Dc = 1^\circ 00' 00''$
 $R = 5,729.58'$
 $T = 562.86'$
 $L = 1,122.12'$
 $E = 27.58'$
 $C = 1,120.33'$
 C.B. = N $46^\circ 12' 06''$ W
 $e_d = 0.023$

CURVE 68D-2
 P.I. STA. 804+79.42
 $Ls = 200.00'$
 $f s = 4^\circ 45' 00''$
 $LT = 133.38'$
 $ST = 66.71'$
 $x = 199.86'$
 $y = 5.52'$
 $k = 99.98'$
 $p = 1.38'$

CURVE 68D-3
 P.I. Sta. 809+54.29
 $\Delta = 45^\circ 27' 22''$ (RT)
 $Dc = 4^\circ 45' 00''$
 $R = 1,206.23'$
 $\Delta c = 33^\circ 34' 52''$ (RT)
 $Lc = 706.97'$
 $Es = 103.98'$
 $C = 696.89'$
 C.B.1 = N $39^\circ 00' 28''$ W
 C.B. = N $19^\circ 03' 02''$ W
 C.B.2 = S $2^\circ 29' 25''$ W
 $e_d = 0.060$

CURVE 68D-4
 P.I. STA. 813+53.16
 $Ls = 300.00'$
 $f s = 7^\circ 07' 30''$
 $LT = 200.16'$
 $ST = 100.15'$
 $x = 299.54'$
 $y = 12.42'$
 $k = 149.92'$
 $p = 3.11'$

CURVE LIMF-2
 P.I. Sta. 789+83.11
 $\Delta = 35^\circ 22' 44''$ (LT)
 $Dc = 3^\circ 30' 00''$
 $R = 1,637.02'$
 $T = 522.11'$
 $L = 1,010.82'$
 $E = 81.24'$
 $C = 994.84'$
 C.B. = N $66^\circ 48' 22''$ W
 $e_d = 0.043$

CURVE LIMF-3
 P.I. Sta. 800+06.05
 $\Delta = 21^\circ 41' 47''$ (RT)
 $Dc = 6^\circ 00' 00''$
 $R = 954.93'$
 $T = 183.00'$
 $L = 361.61'$
 $E = 17.38'$
 $C = 359.45'$
 C.B. = N $71^\circ 00' 24''$ E
 $e_d = 0.060$

CURVE LIMF-4
 P.I. Sta. 808+81.42
 $\Delta = 49^\circ 01' 43''$ (RT)
 $Dc = 3^\circ 45' 00''$
 $R = 1,527.89'$
 $T = 696.76'$
 $L = 1,307.43'$
 $E = 151.37'$
 $C = 1,267.90'$
 C.B. = S $73^\circ 37' 51''$ E
 $e_d = 0.045$

CURVE LIMG-2
 P.I. Sta. 792+40.76
 $\Delta = 31^\circ 17' 06''$ (RT)
 $Dc = 14^\circ 00' 00''$
 $R = 409.26'$
 $T = 114.59'$
 $L = 223.46'$
 $E = 15.74'$
 $C = 220.70'$
 C.B. = N $73^\circ 52' 47''$ W
 $e_d = 0.059$

CURVE LIMG-3
 P.I. Sta. 795+72.87
 $\Delta = 10^\circ 31' 51''$ (RT)
 $Dc = 6^\circ 30' 00''$
 $R = 881.47'$
 $T = 81.24'$
 $L = 162.01'$
 $E = 3.74'$
 $C = 161.79'$
 C.B. = N $52^\circ 58' 19''$ W
 $e_d = 0.057$

CURVE LIMG-4
 P.I. STA. 803+13.44
 $Ls = 150.00'$
 $f s = 3^\circ 27' 00''$
 $LT = 100.02'$
 $ST = 50.02'$
 $x = 149.95'$
 $y = 3.01'$
 $k = 74.99'$
 $p = 0.75'$

CURVE LIMG-5
 P.I. Sta. 804+14.27
 $\Delta = 11^\circ 51' 56''$ (RT)
 $Dc = 4^\circ 36' 00''$
 $R = 1,245.56'$
 $\Delta c = 8^\circ 24' 56''$ (RT)
 $Lc = 182.95'$
 $Es = 7.09'$
 $C = 182.78'$
 C.B.1 = N $46^\circ 33' 23''$ W
 C.B. = N $40^\circ 02' 55''$ W
 $e_d = 0.056$

CURVE LIMH-1
 P.I. Sta. 796+03.73
 $\Delta = 22^\circ 11' 27''$ (RT)
 $Dc = 6^\circ 30' 00''$
 $R = 881.47'$
 $T = 172.86'$
 $L = 341.40'$
 $E = 16.79'$
 $C = 339.27'$
 C.B. = N $47^\circ 08' 31''$ W
 $e_d = 0.057$

CURVE LIMH-2
 P.I. STA. 802+34.20
 $Ls = 200.00'$
 $f s = 9^\circ 00' 00''$
 $LT = 133.51'$
 $ST = 66.82'$
 $x = 199.51'$
 $y = 10.45'$
 $k = 99.92'$
 $p = 2.62'$

CURVE LIMH-3
 P.I. Sta. 804+82.44
 $\Delta = 47^\circ 34' 57''$ (LT)
 $Dc = 9^\circ 00' 00''$
 $R = 636.62'$
 $Ls = 200.00'$
 $\theta s = 9^\circ 00' 00''$
 $LT = 133.51'$
 $ST = 66.82'$
 $x = 199.51'$
 $y = 10.45'$
 $k = 99.92'$
 $p = 2.62'$
 $\Delta c = 29^\circ 34' 57''$ (LT)
 $Lc = 328.69'$
 $Ts = 381.74'$
 $Es = 61.98'$
 $C = 325.06'$
 $C1 = C2 = 199.78'$
 C.B.1 = N $39^\circ 02' 45''$ W
 C.B. = N $59^\circ 50' 16''$ W
 C.B.2 = S $80^\circ 37' 47''$ E
 $e_d = 0.060$

CURVE LIMH-4
 P.I. STA. 806+96.22
 $Ls = 200.00'$
 $f s = 9^\circ 00' 00''$
 $LT = 133.51'$
 $ST = 66.82'$
 $x = 199.51'$
 $y = 10.45'$
 $k = 99.92'$
 $p = 2.62'$

CURVE SERV-3
 P.I. Sta. 10+79.12
 $\Delta = 34^\circ 00' 00''$ (RT)
 $Dc = 11^\circ 00' 00''$
 $R = 520.87'$
 $T = 159.25'$
 $L = 309.09'$
 $E = 23.80'$
 $C = 304.58'$
 C.B. = N $44^\circ 47' 01''$ W
 $e_d = N/C$

CURVE SERV-4
 P.I. Sta. 14+58.82
 $\Delta = 35^\circ 34' 01''$ (LT)
 $Dc = 17^\circ 00' 00''$
 $R = 337.03'$
 $T = 108.10'$
 $L = 209.22'$
 $E = 16.91'$
 $C = 205.87'$
 C.B. = N $45^\circ 34' 02''$ W
 $e_d = N/C$

A - N 48° 42' 33" E

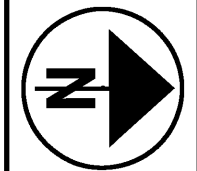

0 50 100 200
HORIZONTAL
SCALE IN FEET

LEGEND

- WETLAND
- IMPACTED WETLAND

T:\Projects\HAN\87005\roadway\sheets\87005GB004.dgn 21-AUG-2014 12:10AM redderj

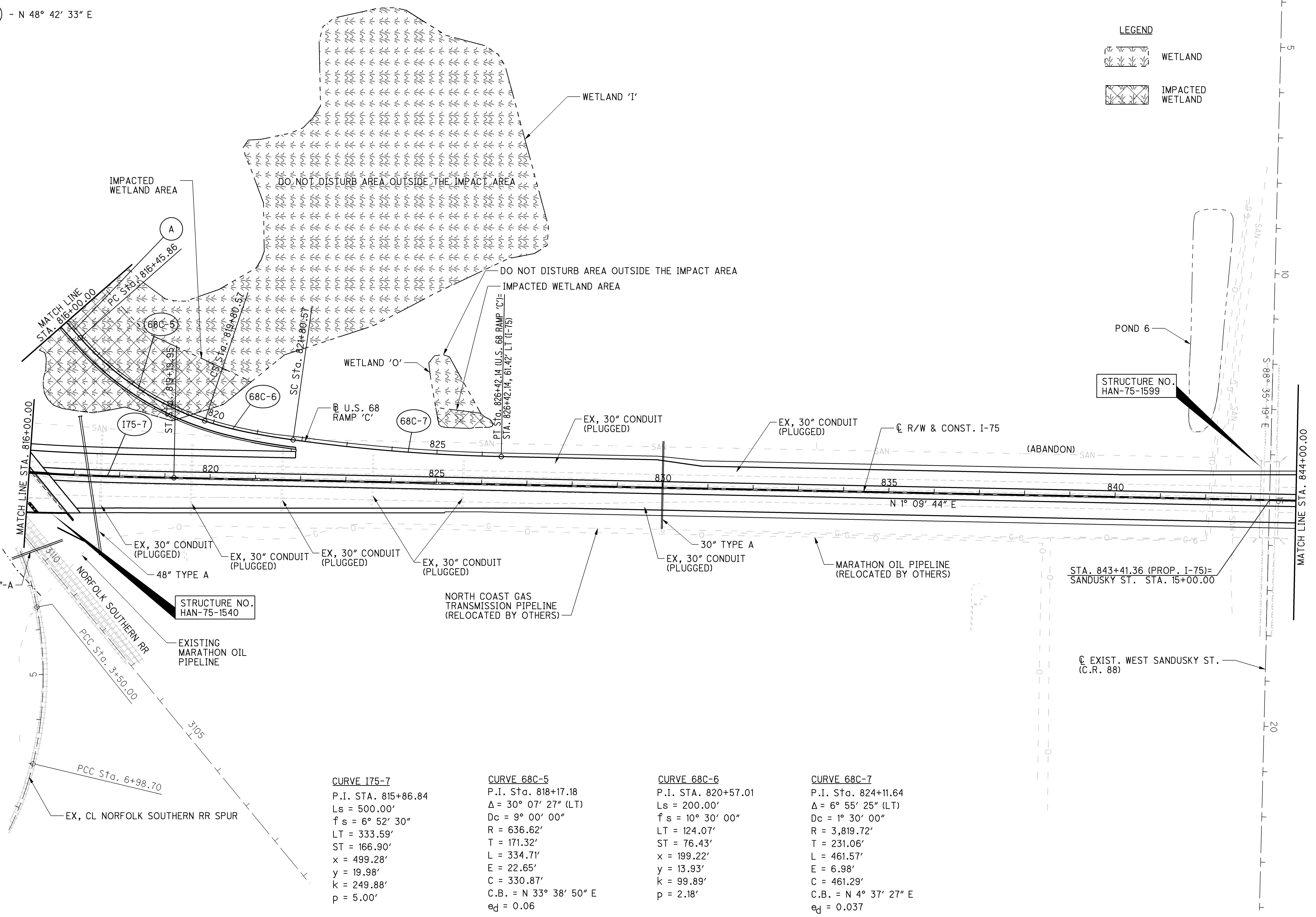

CURVE I75-7
 P.I. STA. 815+86.84
 Ls = 500.00'
 fs = 6° 52' 30"
 LT = 333.59'
 ST = 166.90'
 x = 499.28'
 y = 19.98'
 k = 249.88'
 p = 5.00'

CURVE 68C-5
 P.I. STA. 818+17.18
 Δ = 30° 07' 27" (LT)
 Dc = 9° 00' 00"
 R = 636.62'
 T = 171.32'
 L = 334.71'
 E = 22.65'
 C = 330.87'
 C.B. = N 33° 38' 50" E
 ed = 0.06

CURVE 68C-6
 P.I. STA. 820+57.01
 Ls = 200.00'
 fs = 10° 30' 00"
 LT = 124.07'
 ST = 76.43'
 x = 199.22'
 y = 13.93'
 k = 99.89'
 p = 2.18'

CURVE 68C-7
 P.I. STA. 824+11.64
 Δ = 6° 55' 25" (LT)
 Dc = 1° 30' 00"
 R = 3,819.72'
 T = 231.06'
 L = 461.57'
 E = 6.98'
 C = 461.29'
 C.B. = N 4° 37' 27" E
 ed = 0.037

SCHEMATIC PLAN

HAN-75-14.39

T:\Projects\HAN\87005\roadway\sheets\87005GB005.dgn 21-AUG-2014 12:10AM readenj

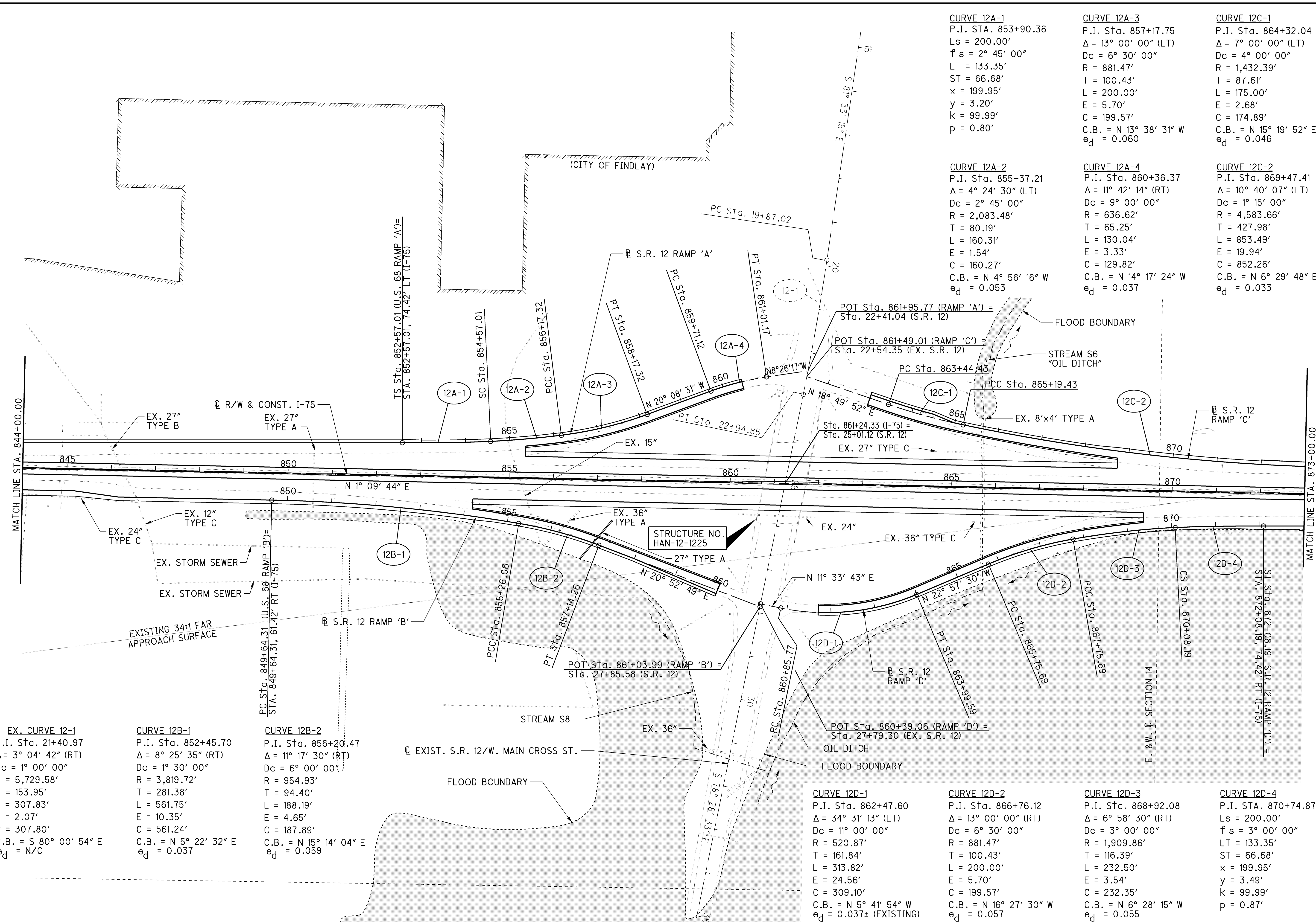

CURVE 12A-1
 P.I. Sta. 853+90.36
 Ls = 200.00'
 Δ = 2° 45' 00"
 LT = 133.35'
 ST = 66.68'
 x = 199.95'
 y = 3.20'
 k = 99.99'
 p = 0.80'

CURVE 12A-3
 P.I. Sta. 857+17.75
 Δ = 13° 00' 00" (LT)
 Δc = 6° 30' 00"
 R = 881.47'
 T = 100.43'
 L = 200.00'
 E = 5.70'
 C = 199.57'
 C.B. = N 13° 38' 31" W
 e_d = 0.060

CURVE 12C-1
 P.I. Sta. 864+32.04
 Δ = 7° 00' 00" (LT)
 Δc = 4° 00' 00"
 R = 1,432.39'
 T = 87.61'
 L = 175.00'
 E = 2.68'
 C = 174.89'
 C.B. = N 15° 19' 52" E
 e_d = 0.046

CURVE 12A-2
 P.I. Sta. 855+37.21
 Δ = 4° 24' 30" (LT)
 Δc = 2° 45' 00"
 R = 2,083.48'
 T = 80.19'
 L = 160.31'
 E = 1.54'
 C = 160.27'
 C.B. = N 4° 56' 16" W
 e_d = 0.053

CURVE 12A-4
 P.I. Sta. 860+36.37
 Δ = 11° 42' 14" (RT)
 Δc = 9° 00' 00"
 R = 636.62'
 T = 65.25'
 L = 130.04'
 E = 3.33'
 C = 129.82'
 C.B. = N 14° 17' 24" W
 e_d = 0.037

CURVE 12C-2
 P.I. Sta. 869+47.41
 Δ = 10° 40' 07" (LT)
 Δc = 1° 15' 00"
 R = 4,583.66'
 T = 427.98'
 L = 853.49'
 E = 19.94'
 C = 852.26'
 C.B. = N 6° 29' 48" E
 e_d = 0.033

EX. CURVE 12-1
 P.I. Sta. 21+40.97
 Δ = 3° 04' 42" (RT)
 Δc = 1° 00' 00"
 R = 5,729.58'
 T = 153.95'
 L = 307.83'
 E = 2.07'
 C = 307.80'
 C.B. = S 80° 00' 54" E
 e_d = N/C

CURVE 12B-1
 P.I. Sta. 852+45.70
 Δ = 8° 25' 35" (RT)
 Δc = 1° 30' 00"
 R = 3,819.72'
 T = 281.38'
 L = 561.75'
 E = 10.35'
 C = 561.24'
 C.B. = N 5° 22' 32" E
 e_d = 0.037

CURVE 12B-2
 P.I. Sta. 856+20.47
 Δ = 11° 17' 30" (RT)
 Δc = 6° 00' 00"
 R = 954.93'
 T = 94.40'
 L = 188.19'
 E = 4.65'
 C = 187.89'
 C.B. = N 15° 14' 04" E
 e_d = 0.059

CURVE 12D-1
 P.I. Sta. 862+47.60
 Δ = 34° 31' 13" (LT)
 Δc = 11° 00' 00"
 R = 520.87'
 T = 161.84'
 L = 313.82'
 E = 24.56'
 C = 309.10'
 C.B. = N 5° 41' 54" W
 e_d = 0.037± (EXISTING)

CURVE 12D-2
 P.I. Sta. 866+76.12
 Δ = 13° 00' 00" (RT)
 Δc = 6° 30' 00"
 R = 881.47'
 T = 100.43'
 L = 200.00'
 E = 5.70'
 C = 199.57'
 C.B. = N 16° 27' 30" W
 e_d = 0.057

CURVE 12D-3
 P.I. Sta. 868+92.08
 Δ = 6° 58' 30" (RT)
 Δc = 3° 00' 00"
 R = 1,909.86'
 T = 116.39'
 L = 232.50'
 E = 3.54'
 C = 232.35'
 C.B. = N 6° 28' 15" W
 e_d = 0.055

CURVE 12D-4
 P.I. Sta. 870+74.87
 Ls = 200.00'
 Δ = 3° 00' 00"
 LT = 133.35'
 ST = 66.68'
 x = 199.95'
 y = 3.49'
 k = 99.99'
 p = 0.87'

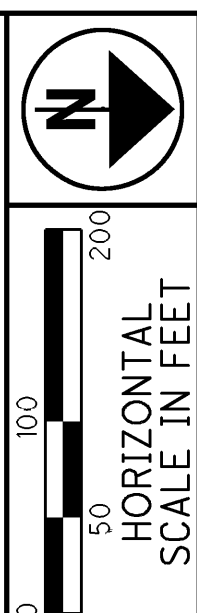

SCHEMATIC PLAN

HAN-75-14.39