

ENGINEERS
ARCHITECTS
SURVEYORS
SCIENTISTS



Farnsworth
GROUP

20 ALLEN AVENUE, ST. LOUIS, MISSOURI
314-962-7900, 314-962-1253 FAX
WWW.F-W.COM

CLIENT: MPL		
PROJECT: HEFI 8" PRODUCTS I-75 WIDENING		
FGI JOB#: 0121489.00	CLIENT JOB#: 78117	
DWG: REROUTE/RECLAIM SHEET 1 OF 3	DATE: 6/12/14	REV: 0
	DRWN BY: JPF	CKD BY:

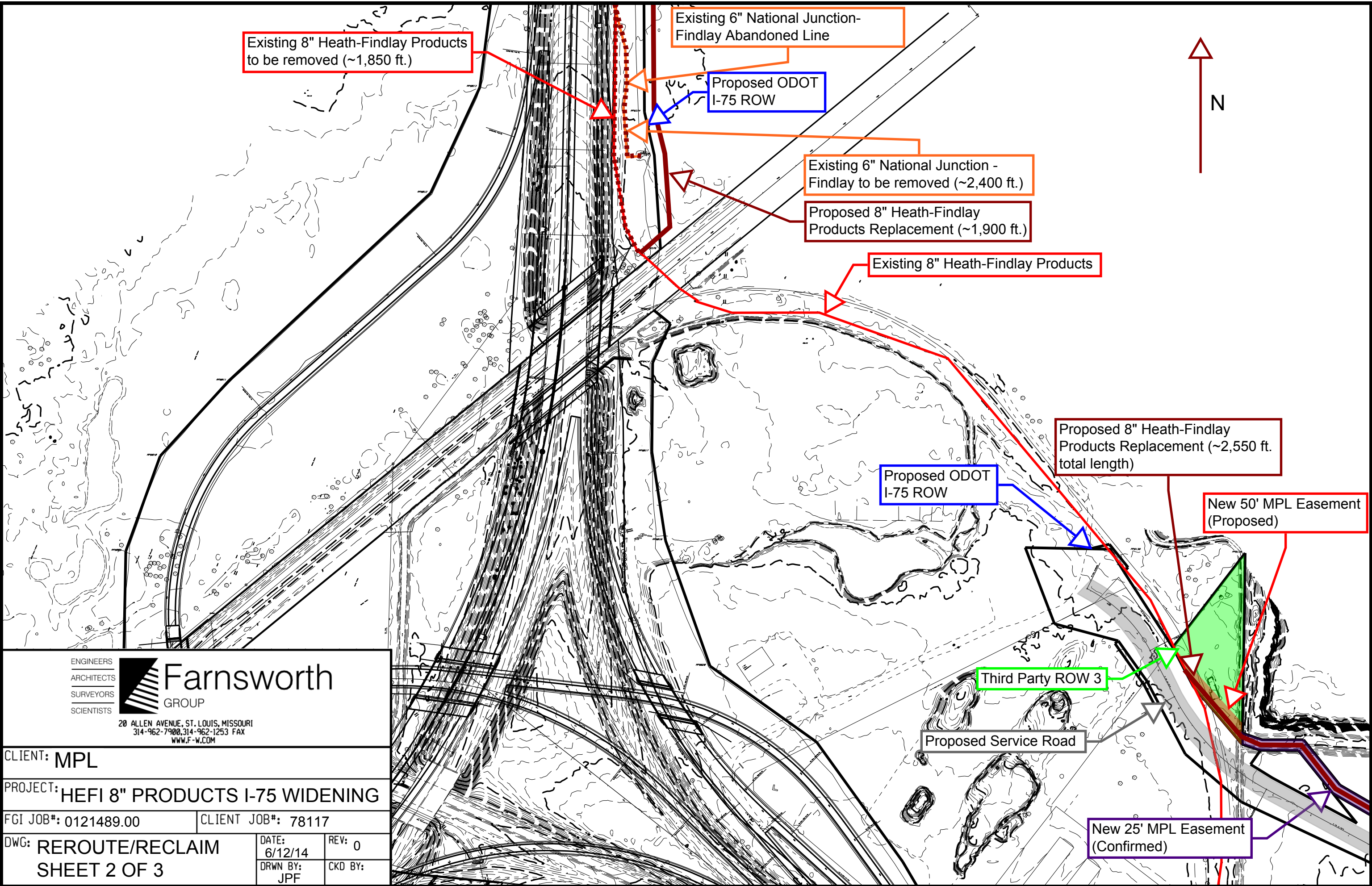

Existing 8" Heath-Findlay Products to be removed (~1,850 ft.)

Existing 6" National Junction-Findlay Abandoned Line

Proposed ODOT I-75 ROW

Existing 6" National Junction - Findlay to be removed (~2,400 ft.)

Proposed 8" Heath-Findlay Products Replacement (~1,900 ft.)

Existing 8" Heath-Findlay Products

Proposed 8" Heath-Findlay Products Replacement (~2,550 ft. total length)

Proposed ODOT I-75 ROW

New 50' MPL Easement (Proposed)

Third Party ROW 3

Proposed Service Road

New 25' MPL Easement (Confirmed)

ENGINEERS
ARCHITECTS
SURVEYORS
SCIENTISTS

Farnsworth
GROUP

20 ALLEN AVENUE, ST. LOUIS, MISSOURI
314-962-7900, 314-962-1253 FAX
WWW.F-W.COM

CLIENT: MPL

PROJECT: HEFI 8" PRODUCTS I-75 WIDENING

FGI JOB#: 0121489.00

CLIENT JOB#: 78117

DWG: REROUTE/RECLAIM
SHEET 2 OF 3

DATE: 6/12/14

REV: 0

DRWN BY: JPF

CKD BY:

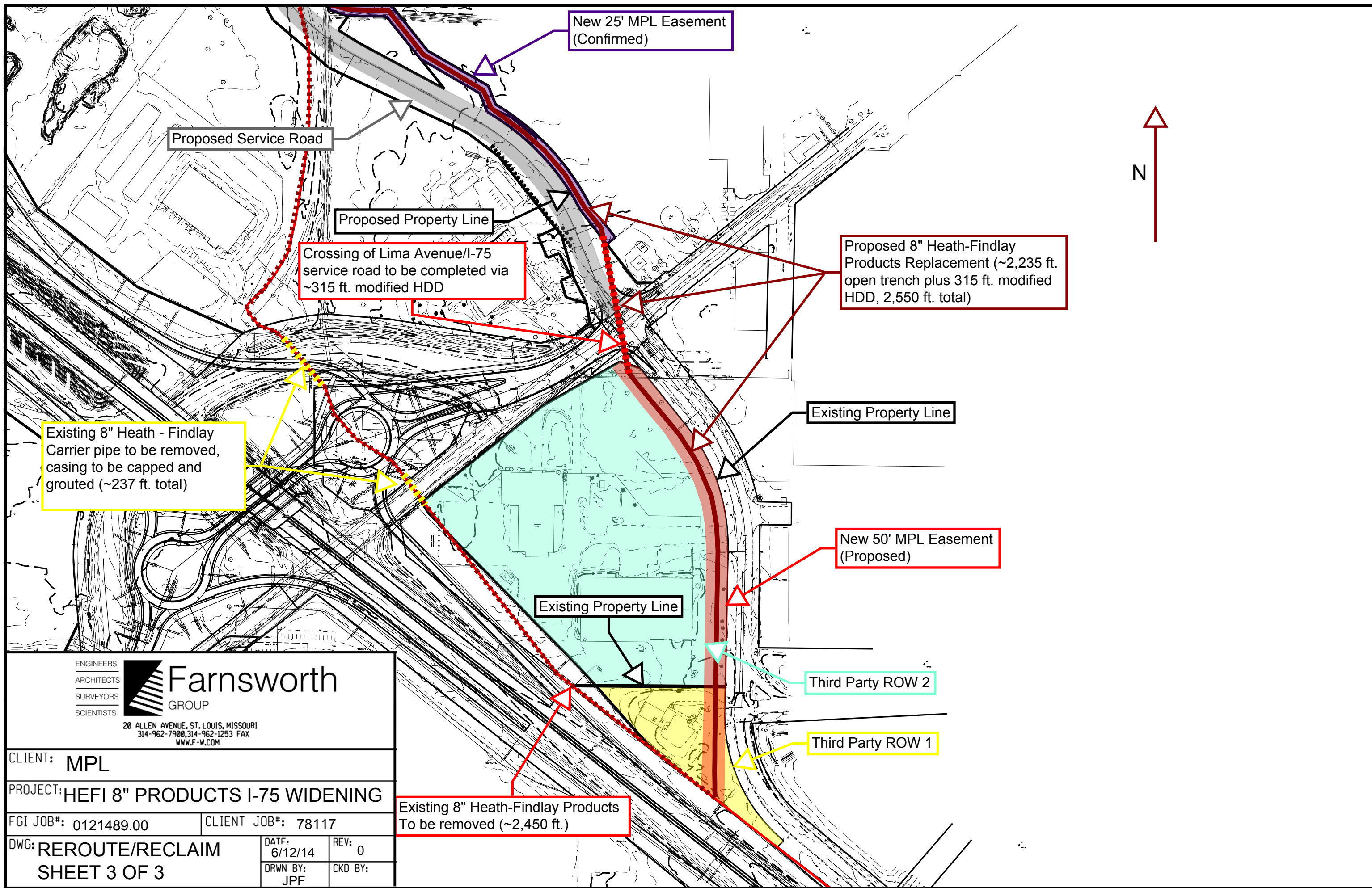

New 25' MPL Easement
(Confirmed)

Proposed Service Road

Proposed Property Line

Crossing of Lima Avenue/I-75
service road to be completed via
~315 ft. modified HDD

Proposed 8" Heath-Findlay
Products Replacement (~2,235 ft.
open trench plus 315 ft. modified
HDD, 2,550 ft. total)



Existing Property Line

Existing 8" Heath - Findlay
Carrier pipe to be removed,
casing to be capped and
grouted (~237 ft. total)

New 50' MPL Easement
(Proposed)

Existing Property Line

Third Party ROW 2

Third Party ROW 1

Existing 8" Heath-Findlay Products
To be removed (~2,450 ft.)

ENGINEERS
ARCHITECTS
SURVEYORS
SCIENTISTS



Farnsworth
GROUP

20 ALLEN AVENUE, ST. LOUIS, MISSOURI
314-962-7900, 314-962-1253 FAX
WWW.F-W.COM

CLIENT: MPL

PROJECT: HEFI 8" PRODUCTS I-75 WIDENING

FGI JOB#: 0121489.00

CLIENT JOB#: 78117

DWG: REROUTE/RECLAIM
SHEET 3 OF 3

DATE:
6/12/14

REV: 0

DRWN BY:
JPF

CKD BY:

MATERIALS LIST (PRELIMINARY)				
NUMBER	SIZE	QUANTITY	UNIT	DESCRIPTION
1	8.625"	3760	ft.	8.625"OD, 0.322"WT, API5L/PSL-2 X-42 (OR BETTER) ERW (OR EQUAL) LINE PIPE, PEB 30DEG, 14-16 MILS DFT FBE PER MPL-CON-00093-SPE
2	8.625"	1040	ft.	8.625"OD, 0.322"WT, API5L/PSL-2 X-42 (OR BETTER) ERW (OR EQUAL) LINE PIPE, PEB 30DEG, 30-40 MILS DFT FBE AND ARO TOPCOAT PER MPL-CON-00093-SPE
3	8.625"	4	ea.	ELL, WELD 8 NPS, 45 DEG 3R, STD, ASME B16.9, ASTM A234 WPB
4	8.625"	7	ea.	HOT INDUCTION BEND PER MPLMEQ012, 45 DEG, 8D BEND RADIUS, 8.625" OD, STD, API 5L/PSL2 X-42 MIN LINE PIPE, 14-16 MILS DFT FBE PER MPL-CON-00093-SPE, 2'-0" FRONT TANGENT, 2'-0" REAR TANGENT, PEB 30 DEG (BOTH ENDS), DESIGN FACTOR = 0.72
5	8.625"	3	ea.	HOT INDUCTION BEND PER MPLMEQ012, 22 DEG, 8D BEND RADIUS, 8.625" OD, STD, API 5L/PSL2 X-42 MIN LINE PIPE, 14-16 MILS DFT FBE PER MPL-CON-00093-SPE, 2'-0" FRONT TANGENT, 2'-0" REAR TANGENT, PEB 30 DEG (BOTH ENDS), DESIGN FACTOR = 0.72
6	8.625"	3	ea.	HOT INDUCTION BEND PER MPLMEQ012, 10 DEG, 8D BEND RADIUS, 8.625" OD, STD, API 5L/PSL2 X-42 MIN LINE PIPE, 14-16 MILS DFT FBE PER MPL-CON-00093-SPE, 2'-0" FRONT TANGENT, 2'-0" REAR TANGENT, PEB 30 DEG (BOTH ENDS), DESIGN FACTOR = 0.72
7	8.625"	2	ea.	HOT INDUCTION BEND PER MPLMEQ012, 30 DEG, 8D BEND RADIUS, 8.625" OD, STD, API 5L/PSL2 X-42 MIN LINE PIPE, 14-16 MILS DFT FBE PER MPL-CON-00093-SPE, 2'-0" FRONT TANGENT, 2'-0" REAR TANGENT, PEB 30 DEG (BOTH ENDS), DESIGN FACTOR = 0.72

Notes: Item counts are preliminary. Quantities for miscellaneous testing and nitrogen purge items (ie. Weld Caps, taps, purge pigs, frac tank piping, valves, and fittings) will require additional site investigation and coordination to accurately determine necessary quantities.

All Induction bend angles are approximate. Final bend angles will be determined based on further survey information to be obtained prior to construction.

ENGINEERS
ARCHITECTS
SURVEYORS
SCIENTISTS



Farnsworth
GROUP

20 ALLEN AVENUE, ST. LOUIS, MISSOURI
314-962-7900, 314-962-1253 FAX
WWW.F-W.COM

CLIENT: MPL

PROJECT: HEFI 8" PRODUCTS I-75 WIDENING

FGI JOB#: 0121489.00

CLIENT JOB#: 78117

DWG: REROUTE/RECLAIM
SHEET 4 OF 4

DATE:
6/12/14

REV: 0

DRWN BY:
JPF

CKD BY: