



# The Subsurface Utility Engineering Company

449 Munroe Falls Road  
Tallmadge, OH 44278  
(330) 794-4455

# Test Hole Certification Form Utility Quality Level A Data

ASCE C/I 38-02

Corporate Headquarters  
8397 Euclid Avenue  
Manassas Park, VA 20111  
(703) 361-6005

Control # **EZQE017**  
Test Hole # **151B**  
Plan Scale **1" = 50'**  
Sheet # **19**  
Proposed **GRADE CHANGE**  
Date **SEPTEMBER 9, 2013**

Condition of paving prior to work  
**NO PAVING**

City, County, State **HANCOCK CO., OHIO**  
Gen. Loc. **I-75 S. JUST N. OF W. BIGELOW AVE. OVERPASS**  
Recorded Size/Material/Type **8" STEEL PETROLEUM LINE**  
Foreman/Truck#/Form By **S. ERICKSON / 221 / P. REYNOLDS**

B.M. 1 Elev. = **834.68'**  
is **CALCULATED**

Description: **(TBM#23) 1/2" I.R. SET, 66'± LT OF PROPOSED CL  
STA 994+28±, I-75**

B.M. 2 Elev. = **831.75'**  
is **CALCULATED**

Description: **(TBM#22) 1/2" I.R. SET, 74'± LT OF PROPOSED CL  
STA 991+38±, I-75**

Benchmarks Check **BY 0.01'**  
Elevations are referenced to **B.M.#1**

Recorded Size/Type of utility **WAS FOUND**

There **WERE NOT** additional utilities in the test hole

The utility **WAS** in good condition

Paving Thickness and type **NO PAVING**

Color of ribbon installed **YELLOW**

Soil Type **WET STICKY CLAY**

Truck Location **GRASS R/W**

T.H. tied to **PEG**

**8 3/4" COATED STEEL PETROLEUM LINE \***  
Size/Material/Type  
Portion of pipe exposed  
for O.D. measurement:  
**FULL**

Remarks: **\* CREW FOUND THE 8 3/4" PETROLEUM LINE MAKING A  
NOTICEABLE VERTICAL GRADE CHANGE DOWNWARD TOWARD THE  
NORTHEAST AT THIS LOCATION.**

Existing Grade of **GRASS R/W**

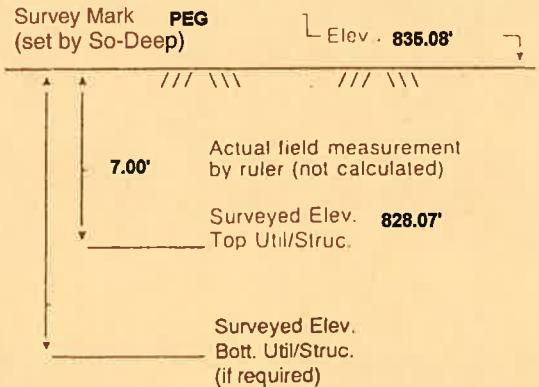

Facing  
**NORTHEAST**



TH DUG 95.3'± LT OF PROPOSED CL STA 993+07.9±, I-75

PROJECT COORDINATES  
N 515773.9  
E 1648729.8

TH 151B

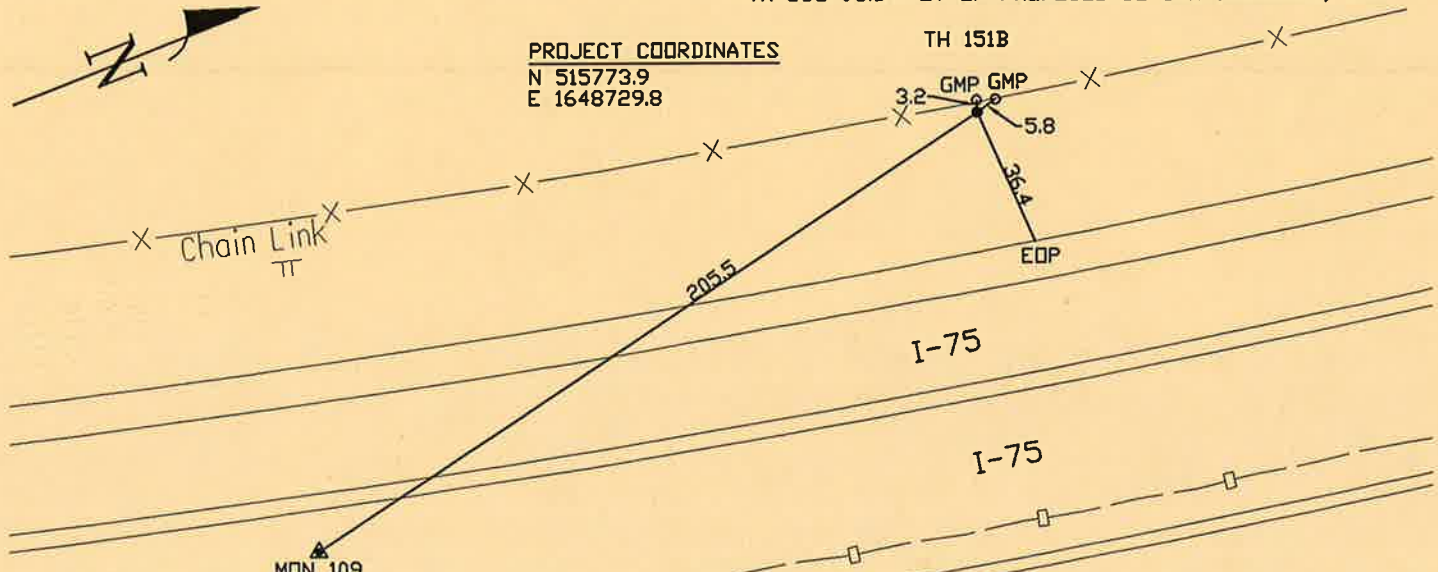

*Handwritten signature: David R. Cole*

- |                           |                    |
|---------------------------|--------------------|
| FO = Fiber-Optic Cable    | CL = Centerline    |
| MTD = Multi Tile Duct     | T.C. = Tera Cotta  |
| R/W = Rights of Way       | PLAS. = Plastic    |
| N.T.S. = Not to Scale     | BL = Base Line     |
| * = Not Shown on Plan     | ELEC. = Electric   |
| PCC = Precast Concrete    | TELE = Telephone   |
| COND. = Conduit           | T.H. = Test Hole   |
| CONC. = Concrete          | SW = Sidewalk      |
| O.D. = Outside Diameter   | DW = Driveway      |
| C.I. = Cast Iron          | BM = Benchmark     |
| D.I. = Ductile Iron       | C.B. = Catch Basin |
| RPC = Rough Pour Concrete | GV = Gas Valve     |

- |            |                             |
|------------|-----------------------------|
| .08" = 1"  | ○ = Sewer Manhole           |
| .16" = 2"  | ● = Test Hole               |
| .25" = 3"  | ⊙ = Fire Hydrant            |
| .33" = 4"  | □ = Pole                    |
| .42" = 5"  | —+— = Fence Line            |
| .50" = 6"  | ⊕ = Electric Manhole        |
| .58" = 7"  | ⊕ = T.S. = Traverse Station |
| .67" = 8"  | ⊕ = Valve                   |
| .75" = 9"  | ⊕ = Water Meter             |
| .83" = 10" | ⊕ = Telephone Manhole       |
| .92" = 11" | □ = Telephone Pedestal      |

*Performing out-of-sight work...with vision!*

Note: To Eliminate mistakes and check this work, So-Deep suggests you scale and plot all dimensions onto the plans and review all elevations carefully. So-Deep is responsible only for information shown on our forms.