

LATITUDE: 41°27'00" N LONGITUDE: 84°00'30" W

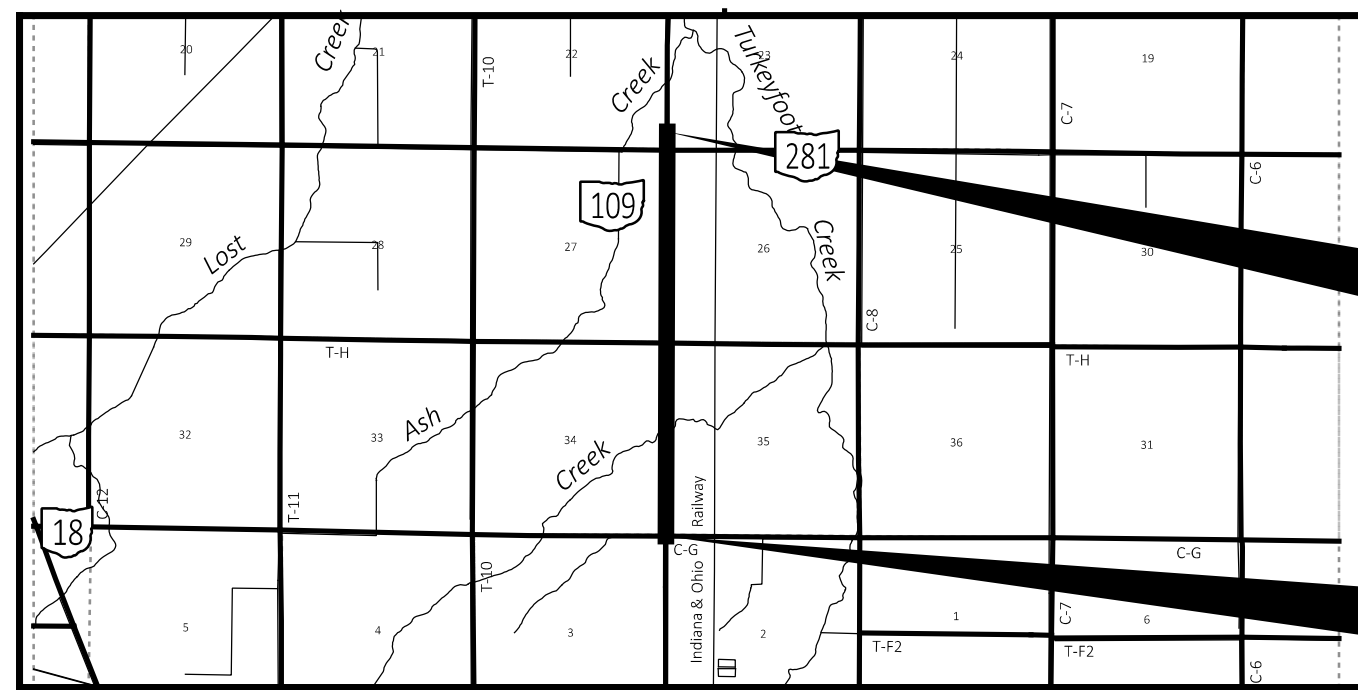

LOCATION MAP

LATITUDE: 41°16'05" N LONGITUDE: 84°02'10" W

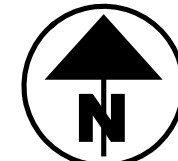

PORTION TO BE IMPROVED	=====
INTERSTATE HIGHWAY	=====
FEDERAL ROUTES	=====
STATE ROUTES	=====
COUNTY & TOWNSHIP ROADS	=====
OTHER ROADS	-----

DESIGN DESIGNATION	HEN-109-6.00	HEN-109-21.30
CURRENT ADT (2025)	2100	2900
DESIGN YEAR ADT (2045)	2300	3200
DESIGN HOURLY VOLUME (2045)	253	352
DIRECTIONAL DISTRIBUTION	60%	60%
TRUCKS (24 HOUR B&C)	13%	13%
DESIGN SPEED	60 MPH	60 MPH
LEGAL SPEED	55 MPH	55 MPH
DESIGN FUNCTIONAL CLASSIFICATION:	05 RURAL MAJOR COLLECTOR	05 RURAL MAJOR COLLECTOR
NHS PROJECT	NO	NO

DESIGN EXCEPTIONS

NONE REQUIRED

ADA DESIGN WAIVERS

NONE REQUIRED

UNDERGROUND UTILITIES
 Contact Two Working Days Before You Dig

OHIO811.org
 Before You Dig

OHIO 811, 8-1-1, or 1-800-362-2764
 (Non members must be called directly)

PLAN PREPARED BY:
CARPENTER MARTY transportation
 6612 SINGLE TREE DRIVE COLUMBUS, OH 43229
 614.656.2424 WWW.CMTRAN.COM

END PROJECT
 STA. 1257+12.36
 SLM 23.80

RESUME PROJECT
 STA. 1125+27.55
 SLM 21.30

SUSPEND PROJECT
 STA. 240+50.00
 SLM 8.35

BEGIN PROJECT
 STA. 117+52.80
 SLM 6.00

**STATE OF OHIO
 DEPARTMENT OF TRANSPORTATION**

HEN-109-6.00/21.30

MONROE TOWNSHIP
 LIBERTY TOWNSHIP
 HENRY COUNTY

INDEX OF SHEETS:

TITLE SHEET	P.1
SCHEMATIC PLAN	P.2-P.5
TYPICAL SECTIONS	P.6-P.7
GENERAL NOTES	P.8-P.9
MAINTENANCE OF TRAFFIC	P.10-P.11
GENERAL SUMMARY	P.12-P.13
PAVEMENT QUANTITIES	P.14-P.16
UNDERDRAIN QUANTITIES	P.17-P.19
PLAN - HEN-109-6.00	P.20-P.33
PLAN - HEN-109-21.30	P.34-P.47
TRAFFIC CONTROL QUANTITIES	P.48
TRAFFIC CONTROL - HEN-109-6.00	P.49-P.55
TRAFFIC CONTROL - HEN-109-21.30	P.56-P.62
R/W PLANS	RW.1-RW.10

FEDERAL PROJECT NUMBER

E161 (117)

RAILROAD INVOLVEMENT

NONE

PROJECT DESCRIPTION

PROJECT INVOLVES REHABILITATION OF S.R. 109 BETWEEN S.R. 18 AND S.R. 281. THE PROJECT ALSO INVOLVES REHABILITATION OF S.R. 109 BETWEEN THE LIBERTY CENTER NORTH CORPORATION LINE AND THE FULTON COUNTY LINE.

EARTH DISTURBED AREAS - HEN-109-6.00

PROJECT EARTH DISTURBED AREA:	3.23 ACRES
ESTIMATED CONTRACTOR EARTH DISTURBED AREA:	0.31 ACRES
NOTICE OF INTENT EARTH DISTURBED AREA:	3.54 ACRES (MAINTENANCE PROJECT - NO NOI REQUIRED)

EARTH DISTURBED AREAS - HEN-109-21.30

PROJECT EARTH DISTURBED AREA:	3.64 ACRES
ESTIMATED CONTRACTOR EARTH DISTURBED AREA:	0.32 ACRES
NOTICE OF INTENT EARTH DISTURBED AREA:	3.96 ACRES (MAINTENANCE PROJECT - NO NOI REQUIRED)

2023 SPECIFICATIONS

THE STANDARD SPECIFICATIONS OF THE STATE OF OHIO, DEPARTMENT OF TRANSPORTATION, INCLUDING SUPPLEMENTAL SPECIFICATIONS LISTED IN THE PLANS, AND CHANGES LISTED IN THE PROPOSAL SHALL GOVERN THIS IMPROVEMENT.

I HEREBY APPROVE THESE PLANS AND DECLARE THAT THE MAKING OF THIS IMPROVEMENT WILL REQUIRE THE CLOSING TO TRAFFIC OF THE HIGHWAY AND THAT DETOUR WILL BE PROVIDED AS INDICATED ON SHEET P.10.

Pat McColley, PE
 Pat McColley, P.E., S.I.
 District 02 Deputy Director

Jack Marchbanks
 Jack Marchbanks, PhD
 Director, Department of Transportation

ENGINEER'S SEAL

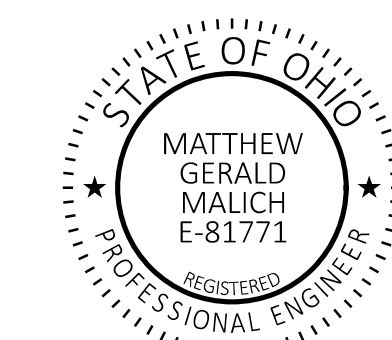

STANDARD CONSTRUCTION DRAWINGS				SUPPLEMENTAL SPECIFICATIONS		SPECIAL PROVISIONS	
BP-3.1	1/19/24	TC-41.20	10/18/13	800-2023	7/19/24	GEOTECHNICAL	
BP-3.2	1/18/19	TC-42.20	10/18/13	821	4/20/12	REPORT	
		TC-52.10	10/18/13	832	7/19/24	12/11/2024	
RM-1.1	1/20/23	TC-52.20	1/15/21	875	1/18/19		
		TC-65.10	1/17/14	921	7/19/24		
DM-1.1	7/17/20	TC-65.11	1/19/24				
DM-1.2	7/16/21	TC-71.10	4/21/23				
DM-4.3	1/15/16						
DM-4.4	1/15/16						
MT-97.10	4/19/19						
MT-97.12	1/20/17						
MT-99.20	4/19/19						
MT-101.60	4/21/23						
MT-101.90	7/17/20						
MT-105.10	1/17/20						

DESIGN AGENCY



DESIGNER	BAC
REVIEWER	TWG 12/13/24
PROJECT ID	95741
SHEET	P.1
TOTAL	62