

JACKSON COUNTY
JAC-35-(2.72-6.24)

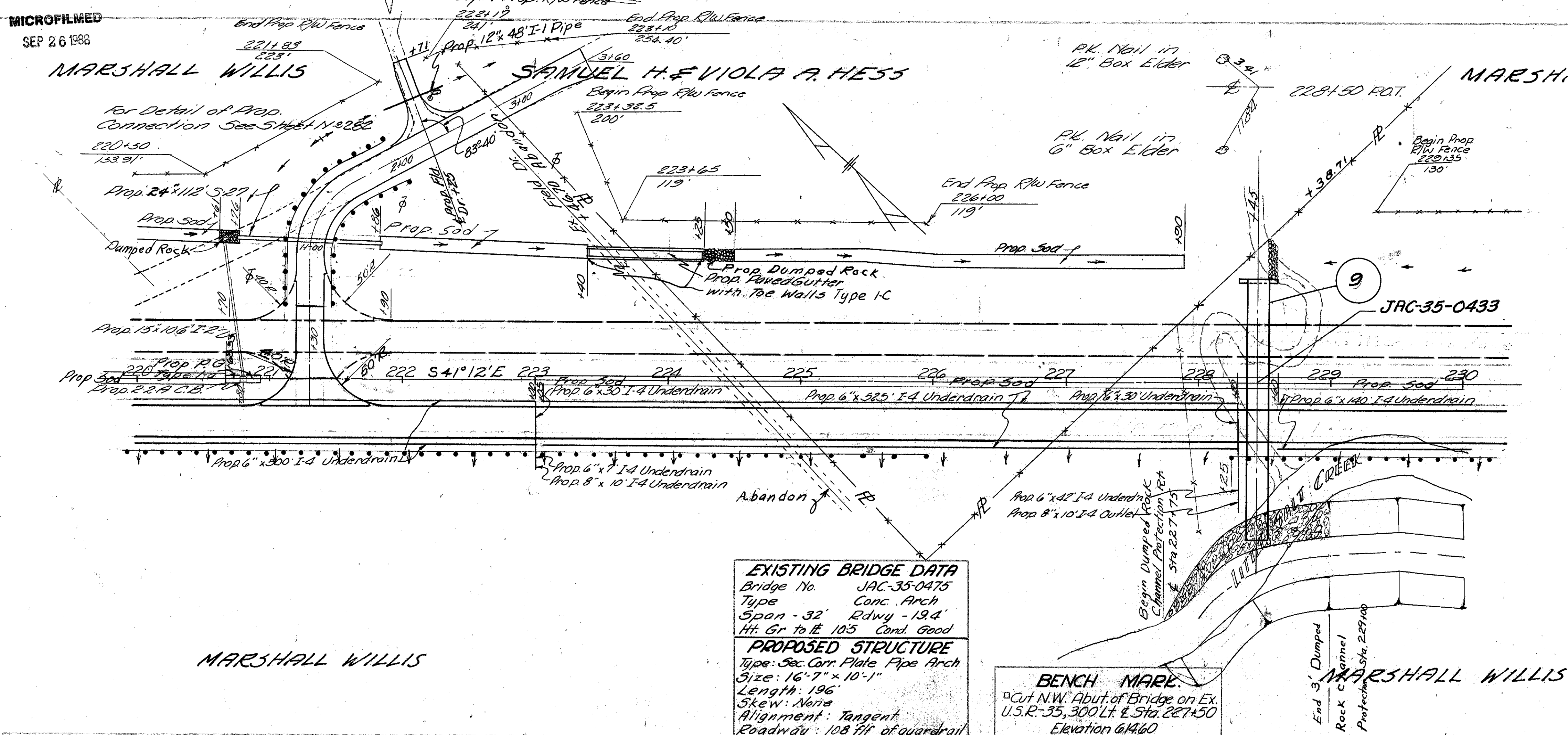

DRAINAGE

STATION TO STATION	Side	I-4 6" Under drain Lin Ft	I-4 8" Pipe Outlet for Under drain Lin Ft	I-5 6" Special Elbow TBranh Each	I-5 6" Special TBranh Each	I-2 Storm 15" Under Pav't Lin Ft	I-8 2'-0" Catch Basin (3-ft) Each
220+00-223+00	LER	600.0					
223+00	E	370	10	1	1		
223+05-228+30	LER	10500					
228+30	E	780	10	1	1		
228+60-230+00	LER	2820					
220+80	Lt					106	1
Total		2039	20	2	2	106	1

Quantities carried to Sheet No. 18 & 19

DRIVES & APPROACHES

STATION	Description	Side	F-70 9" Port. Cement Pav't 27 Yds	F-71 9" Rein Portland Cement Pav't 39 Yds	F-22 6" Subbase 39 Yds	F-18 6" 5" top Crushed Aggreg. 59 Yds	F-1 12" Pipe For Drive-way 48 Lin Ft	F-27 24" Pipe for Catch Basin 112 Lin Ft	E-2 Exten. for Street 75 Canals
221+30	Connection	Lt	133.3	818.3	103.7	118.03	48	112	75
Total			133.3	818.3	103.7	118.03	48	112	75

Quantities carried to Sheet No. 18 & 19

EXISTING BRIDGE DATA
 Bridge No. JAC-35-0475
 Type Conc. Arch
 Span - 32' Rdwy - 19.4'
 Ht. Gr. to E. 10.5' Cond. Good

PROPOSED STRUCTURE
 Type: Sec. Corr. Plate Pipe Arch
 Size: 16'-7" x 10'-1"
 Length: 196'
 Skew: None
 Alignment: Tangent
 Roadway: 108' ft of guardrail

BENCH MARK
 Cut N.W. Abut. of Bridge on Ex. U.S.R-35, 300 Lt. & Sta. 227+50
 Elevation 614.60

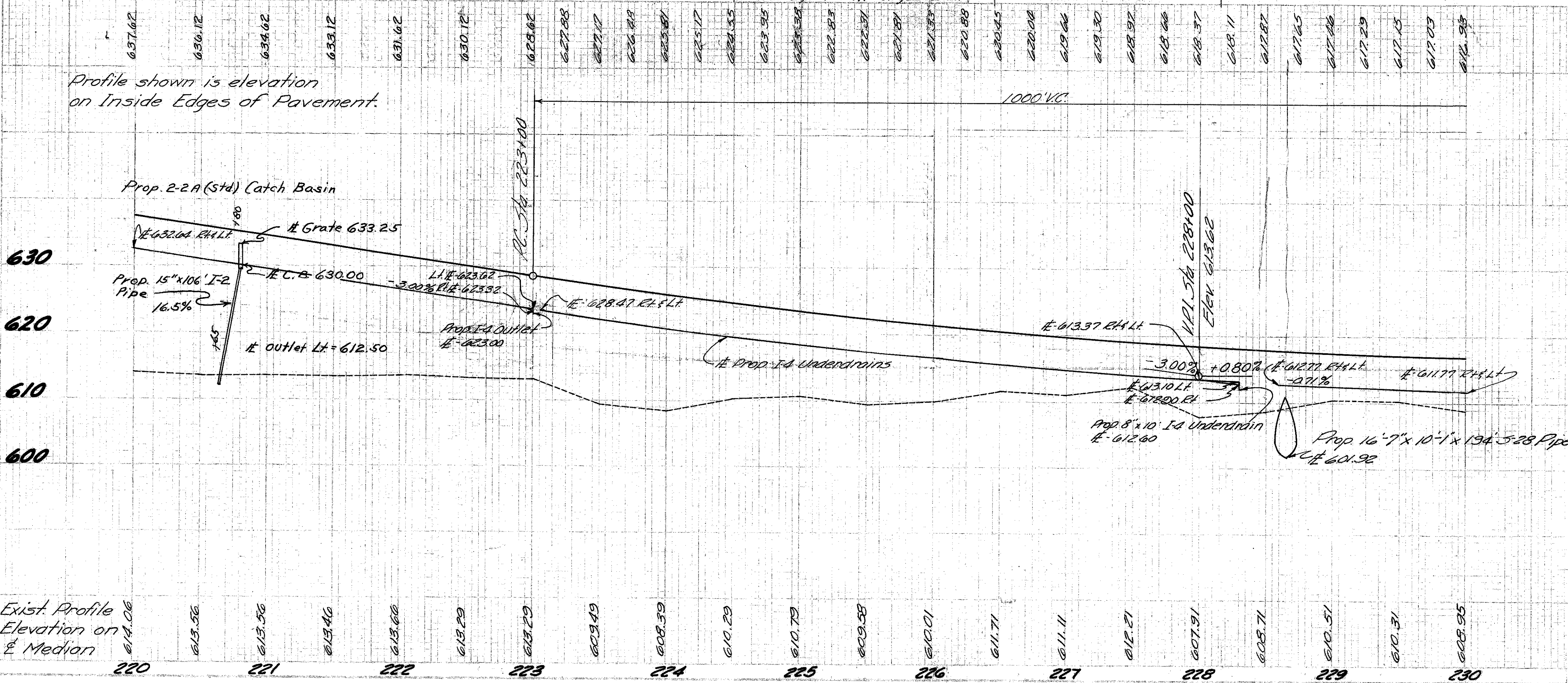

FOR DETAIL OF STRUCTURE No. 9
SEE SHEET No. 306

FOR DETAIL OF CONNECTION LT. & STA. 221+30 SEE SHEET No. 282

FOR ESTIMATED QUANTITIES SEE SHEET No. 11, 13 & 15

MICROFILMED
SER-27-1963

EXISTING BRIDGE DATA
 BRIDGE No. JAC-35-0475
 Type Conc. Arch
 Span - 32' Rdwy - 194'
 Ht. Gr. to \bar{E} = 10.5 Cond - Good

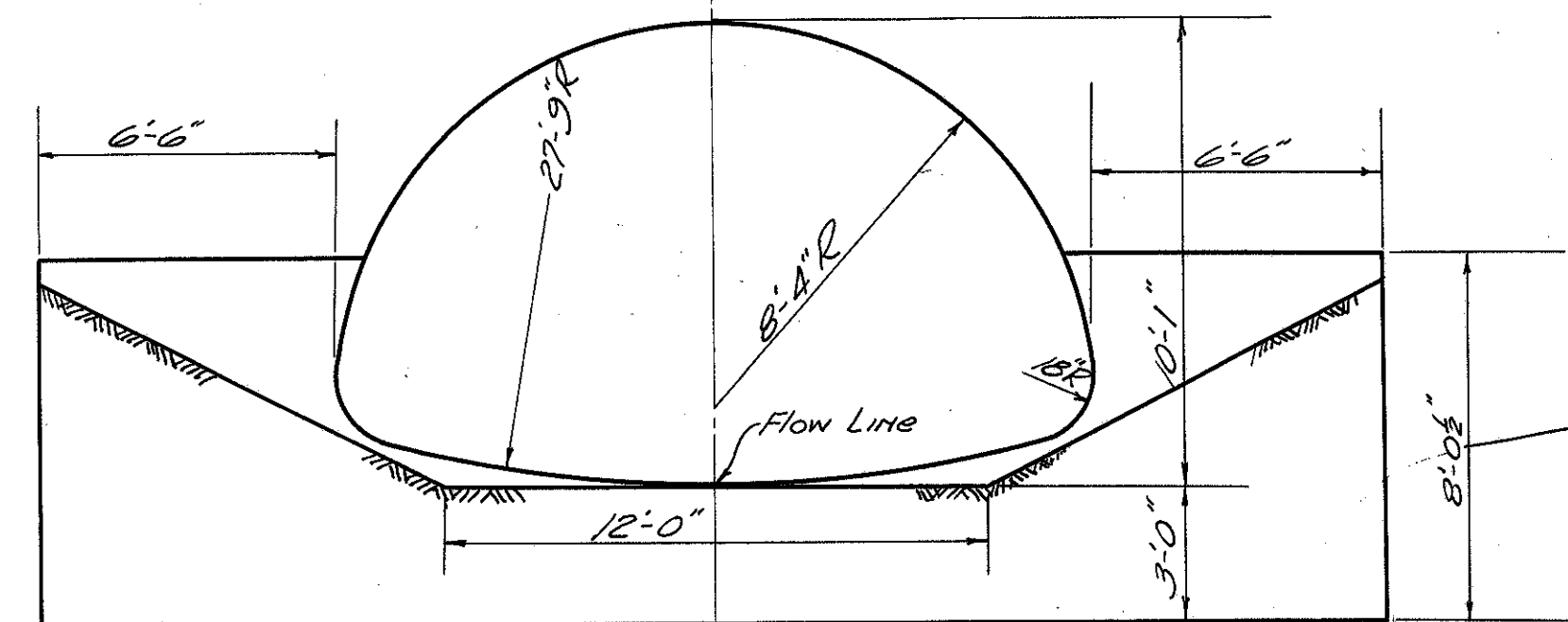

DRAINAGE AREA = 28 S.M.
 $Q_{25} = 1200 \text{ c.f.s.}$

INLET END
 Scale $\frac{1}{4}'' = 1'-0''$

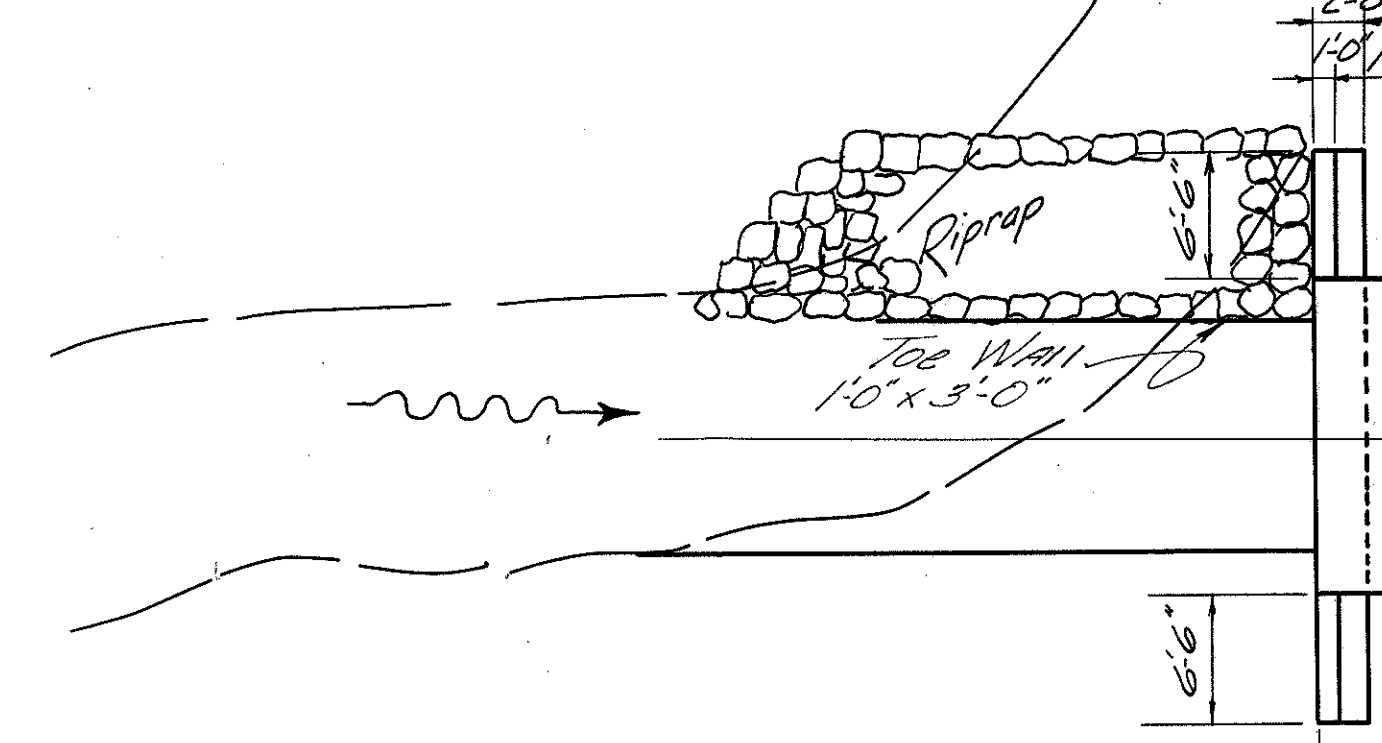

Culvert Data

Type: Sectional Corrugated Plate Pipe Arch
 Size: 16'-7" x 10'-1" x 196'
 Work Req'd: Build Std. 16'-7" x 10'-1" x 196' Sec. Corr. Pl. Pipe Arch with Std. Concrete End Wall (Std. Dwg. SP-53) at Inlet. Excavate Inlet, Place Riprap Inlet.

Notes:
 Tolerances of 1" plus or minus in the nominal Span and Rise will be permitted.
 Plates shall be No. 5 Gage, except the corner and the bottom plates which shall be No. 3 Gage.
 End Walls shall be constructed as specified in the Notes for End Walls - Std. Dwg. SP-53

PLAN
 Scale 1" = 10'

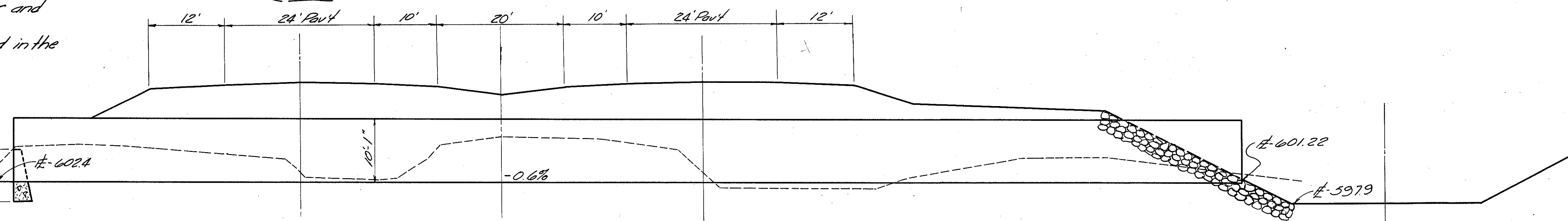

SECTION
 Scale 1" = 10'

ESTIMATED QUANTITIES

- Item E-2 Excavation for Structure ————— 500-C.Y.
- Item E-3 Channel Excavation ————— 7-C.Y.
- Item I-10 Riprap, Type A ————— 33-S.Y.
- Item S-1 Concrete for Structure - Class E" ————— 149-C.Y.
- Item S-2B 16'-7" x 10'-1" Sec. Corr. Pl. Pipe Arch; 5-3 ga. — 196-L.F.

Quantities carried to Sheet H-14

AREA SPIRAL CURVE
 P.I. 211+19.76
 Δ 28° 11' LT. Δ 309.56'
 L_a 3° 00' E_s 62.89'
 L_c 400' O_s 6° 00'
 L_b 680.24' L_s 530.44'
 L_e 13.95' R_s 1909.86'

SAVAGEVILLE M.E. CHURCH
 PARCEL 175 L.A.
 0.28 Acres

ROBERT WILLIS
 PARCEL 176A
 0.02 Acres

VIRGINIA GOULD
 PARCEL 174 L.A.
 5.62 Acres

MARSHALL WILLIS
 PARCEL 176 L.A.
 4.02 Acres
 PARCEL 176
 0.57 Acres

FED. RD. DIVISION	STATE	PROJECT
2	OHIO	

(341)
352

R/W PLAN
 JAG. 35-(272-6.24)
 JACKSON COUNTY
 LIMITED ACCESS

