

H:\2018\80743\0D0T\ProjectData\08665\_LAK\_20\_WEST\Design\Roadway\Sheets\08665\_GT001.dgn Sheet 7/10/2023 4:42:31 PM somogyi

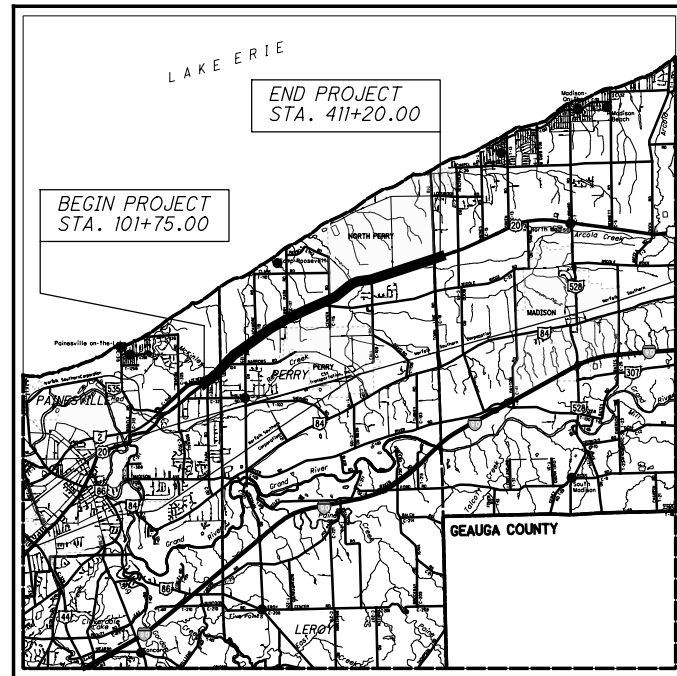

LOCATION MAP

LATITUDE: 41°45'58.7" LONGITUDE: 81°10'51.7"



PORTION TO BE IMPROVED	—————
INTERSTATE HIGHWAY	—————
FEDERAL ROUTES	—————
STATE ROUTES	—————
COUNTY & TOWNSHIP ROADS	—————
OTHER ROADS	—————

**DESIGN DESIGNATION: LAK-US-20-19.59**

CURRENT ADT (2022)	25,000
DESIGN YEAR ADT (2042)	31,850
DESIGN HOURLY VOLUME (2042)	3,185
DIRECTIONAL DISTRIBUTION	62%
TRUCKS (24 HOUR B&C)	10%
DESIGN SPEED	45 MPH
LEGAL SPEED	45 MPH
DESIGN FUNCTIONAL CLASSIFICATION:	
URBAN PRINCIPAL ARTERIAL	
NHS PROJECT	YES

**DESIGN EXCEPTIONS**

NONE REQUIRED

**ADA DESIGN WAIVERS**

NONE REQUIRED



PLAN PREPARED BY:



STATE OF OHIO  
DEPARTMENT OF TRANSPORTATION  
**LAK-US-20-19.59**  
**PART 1**  
PAINESVILLE TWP., PERRY TWP.,  
NORTH PERRY VILLAGE, MADISON TWP.,  
LAKE COUNTY, OHIO  
FOR PART 2, SEE LAK-20-24.99

**INDEX OF SHEETS:**

TITLE SHEET	1	INTERSECTION DETAILS	741-754
SCHEMATIC PLAN	2-7	DRIVEWAY DETAILS	755-761
TYPICAL SECTIONS	8-20, 20A, 21-22	DRIVEWAY PROFILES - U.S. 20	762-847
GENERAL NOTES	23-27, 27A	DRIVEWAY PROFILES - SIDEROADS	848-853
MAINTENANCE OF TRAFFIC	28-36, 36A-36B, 37-382	STORM SEWER PROFILES	854-855
GENERAL SUMMARY	383-388	CULVERT DETAILS	856-862
SUBSUMMARIES	389-411	CHANNEL CROSS SECTIONS	863-864
CALCULATIONS	412-418	RETAINING WALLS	865-868
PROJECT SITE PLAN	419-424	WATER WORKS	869
PLAN AND PROFILE - U.S. 20	425-485	CURB RAMP DETAILS	870-874
PLAN AND PROFILE - SIDEROADS	486-497	TRAFFIC CONTROL	875-1021
PLAN AND PROFILE - RAMPS	498-500	TRAFFIC SIGNALS	1022-1029
CROSS SECTIONS - U.S. 20	501-707	STRUCTURE (20 FOOT SPAN AND UNDER)	1030-1036
CROSS SECTIONS - SIDEROADS	708-722	SOIL PROFILES (PID 108665 & PID 109270)	1037-1088
CROSS SECTIONS - RAMPS	723-734	RIGHT OF WAY	RW.1 - RW.168
SUPERELEVATION TABLES	735-740		

**PROJECT DESCRIPTION**

MAJOR REHABILITATION OF 5.4 MILES OF NORTH RIDGE ROAD (US-20) FROM SR. 2 TO TOWNLINE ROAD IN PERRY TOWNSHIP. WORK WILL INCLUDE ROADWAY WIDENING, RESURFACING AND SIDEWALK, DRAINAGE AND TRAFFIC SIGNAL IMPROVEMENTS.

**EARTH DISTURBED AREAS**

PROJECT EARTH DISTURBED AREA:	55.1 ACRES
ESTIMATED CONTRACTOR EARTH DISTURBED AREA:	1.0 ACRES
NOTICE OF INTENT EARTH DISTURBED AREA:	56.1 ACRES

**2019 SPECIFICATIONS**

THE STANDARD SPECIFICATIONS OF THE STATE OF OHIO, DEPARTMENT OF TRANSPORTATION, INCLUDING SUPPLEMENTAL SPECIFICATIONS LISTED IN THE PLANS AND CHANGES LISTED IN THE PROPOSAL SHALL GOVERN THIS IMPROVEMENT.

I HEREBY APPROVE THESE PLANS AND DECLARE THAT THE MAKING OF THIS IMPROVEMENT WILL NOT REQUIRE THE CLOSING TO TRAFFIC OF THE HIGHWAY AND THAT PROVISIONS FOR THE MAINTENANCE AND SAFETY OF TRAFFIC WILL BE AS SET FORTH ON THE PLANS AND ESTIMATES.

DISTRICT DEPUTY DIRECTOR

*John Picuri, P.E., S.I.*  
12

DIRECTOR, DEPARTMENT OF TRANSPORTATION

*John M. ...*

STANDARD CONSTRUCTION DRAWINGS										SUPPLEMENTAL SPECIFICATIONS	SPECIAL PROVISIONS
BP-2.1	1-21-22	CB-1	7-16-21	DM-3.1	1-18-13	MT-101.75	1-17-20	TC-42.20	10-18-13	800 SEE PROPOSAL	WATERWAY PERMIT
BP-2.2	1-15-21	CB-2-2ABC	1-20-23	DM-4.3	1-15-16	MT-101.90	7-17-20	TC-51.11	1-15-16	809 1-20-23	4/10/2023
BP-3.1	1-21-22	CB-2-34	1-20-23	DM-4.4	1-15-16	MT-102.10	1-17-20	TC-52.10	10-18-13	815 4-16-21	
BP-4.1	7-19-13	CB-3	7-16-21			MT-102.20	4-19-19	TC-52.20	1-15-21	821 4-20-12	
BP-5.1	7-15-22	CB-3A	7-16-21	HW-2.1	7-20-18	MT-103.10	1-21-22	TC-65.10	1-17-14	832 7-15-22	
BP-7.1	1-21-22	CB-6	1-21-22	HW-2.2	7-20-18	MT-105.10	1-17-20	TC-65.11	7-15-22	870 10-21-22	
								TC-71.10	7-15-22	878 1-21-22	
MGS-1.1	7-16-21	I-2	7-16-21	HL-30.11	1-15-21	TC-12.31	4-15-22	TC-72.20	7-20-18	895 4-18-14	
MGS-2.1	1-19-18	I-2A	7-16-21	HL-30.22	1-15-21	TC-15.116	7-16-21	TC-74.10	1-20-23	906 10-15-10	
MGS-3.1	1-19-18			MT-095.31	7-19-19	TC-16.22	7-16-21	TC-81.22	7-15-22	909 10-21-22	
MGS-4.2	7-19-13	MH-1	7-15-22	MT-095.32	4-19-19	TC-21.11	7-16-21	TC-83.20	7-15-22	921 4-20-12	
		MH-2	7-16-21	MT-095.41	1-17-20	TC-21.21	1-20-23	TC-83.20	7-15-22	938 1-19-18	
RM-1.1	1-15-21	MH-3	7-16-21	MT-097.12	1-20-17	TC-22.10	4-17-20	TC-84.20	10-18-13	995 7-17-15	
RM-3.1	7-20-18			MT-099.20	4-19-19	TC-22.20	1-17-14	TC-85.10	4-17-20		
RM-4.2	4-17-20	DM-1.1	7-17-20	MT-101.60	1-17-20	TC-41.20	10-18-13	TC-85.20	7-20-18		
		DM-1.2	7-16-21	MT-101.70	1-17-20	TC-41.30	10-18-13				

ENGINEER'S SEAL



FEDERAL PROJECT NO. E191(584)

PID NO. 108665

CONSTRUCTION PROJECT NO.

RAILROAD INVOLVEMENT NONE

LAK-US-20-19.59 PART 1

1/1088

**MAINTENANCE OF TRAFFIC NARRATIVE**

THIS PROJECT HAS BEEN DIVIDED INTO TWO PARTS: PART 1 AND PART 2. PART 2 (LAK-US-20-24.99) IS A TWO YEAR PROJECT AND SHALL BE BUILT FIRST. PART 1 (LAK-US-20-19.59) IS A THREE YEAR PROJECT AND SHALL BE BUILT SECOND. WITHIN EACH OF THESE PARTS, PHASES SHALL BE CONSTRUCTED FROM EAST TO WEST PER THE CONSTRUCTION SEQUENCES. CONSTRUCTION OF TEMPORARY PAVEMENT SHALL ONLY OCCUR IN THE PHASE WHERE IT IS IMMEDIATELY NEEDED. NO CONSTRUCTION SHOULD BE SCHEDULED TO OCCUR DURING THE WINTER MONTHS, BETWEEN NOVEMBER 1 AND APRIL 1 (EXCEPT TREE CLEARING).

**SEQUENCE OF CONSTRUCTION**

**UTILITY RECONSTRUCTION**

UTILITY RECONSTRUCTION (BY OTHERS) SHALL BE COMPLETED BY DECEMBER 31, 2024

**TREE CLEARING**

ALL TREE CLEARING FOR THE LAK-20-19.59 PROJECT, PART 1 SHALL BE COMPLETED BY APRIL 1, 2024.

**PRE-PHASE 1A:**

1. CONSTRUCT THE TEMPORARY PAVEMENT BETWEEN STA. 250+00 TO STA. 257+00, RT. WORK SHALL BE COMPLETED USING DAILY LANE CLOSURES.

2. CONSTRUCT THE LEFT HALF OF THE CULVERT AT STA. 253+86.

3. CONSTRUCTION OF PRE-PHASE 1A SHALL OCCUR IN 2025.

**PRE-PHASE 1B:**

1. CONSTRUCT THE TEMPORARY PAVEMENT BETWEEN STA. 247+00 TO STA. 260+50, LT. WORK SHALL BE COMPLETED USING SHORT TERM LANE CLOSURES.

2. CONSTRUCT THE RIGHT HALF OF THE CULVERT AT STA. 253+86.

3. CONSTRUCTION OF PRE-PHASE 1B SHALL OCCUR IN 2025.

**PRE-PHASE 1C:**

CONSTRUCT THE TEMPORARY PAVEMENT FROM STA. 283+46.3 TO STA. 402+72.3, LT. WORK SHALL BE COMPLETED BY OCTOBER 15, 2025.

THE CONTRACTOR MAY UTILIZE A LONG TERM CLOSURE OF THE WESTBOUND OUTSIDE LANE FOR A DURATION OF FOURTEEN (14) CALENDAR DAYS IN ORDER TO INSTALL THE TEMPORARY PAVEMENT. A DISINCENTIVE SHALL BE ASSESSED IN THE AMOUNT OF \$1,500 FOR EACH CALENDAR DAY THAT THE WESTBOUND OUTSIDE LANE REMAINS CLOSED TO TRAFFIC BEYOND THIS SPECIFIED LIMIT.

**PHASE 1:**

THIS PHASE WILL INVOLVE THE RECONSTRUCTION OF THE SOUTH SIDE OF U.S. 20 FROM CENTER ROAD (STA. 286+00) TO TOWNLINE ROAD (STA. 399+90). ONE (1) LANE OF WESTBOUND TRAFFIC AND ONE (1) LANE OF EASTBOUND TRAFFIC WILL BE MAINTAINED AT ALL TIMES ALONG THIS SECTION OF U.S. 20.

THE CONTRACTOR SHALL BE ALLOWED TO CLOSE EACH SIDE STREET FOR FOURTEEN (14) CONSECUTIVE CALENDAR DAYS. A DISINCENTIVE SHALL BE ASSESSED IN THE AMOUNT OF \$300 FOR EACH CALENDAR DAY THAT THE SIDE STREET REMAINS CLOSED TO TRAFFIC BEYOND THIS SPECIFIED TIME LIMIT.

THE FOLLOWING IS A LIST OF SIDE STREETS TO BE CLOSED DURING THIS PHASE:

CALL ROAD STA. 332+79 RT SIDE STREET

THE CONTRACTOR SHALL NOT BE ALLOWED TO CLOSE TWO (2) ADJACENT SIDE STREETS AT THE SAME TIME. PEDESTRIAN TRAFFIC SHALL BE MAINTAINED.

CONSTRUCT THE TEMPORARY PAVEMENT AND TEMPORARY DRAINAGE BETWEEN STA. 283+46.3 AND STA. 402+72.3. PRIOR TO SHIFTING TRAFFIC.

**PHASE 2:**

THIS PHASE WILL INVOLVE THE RECONSTRUCTION OF THE NORTH SIDE OF U.S. 20 FROM CENTER ROAD (STA. 286+00) TO TOWNLINE ROAD (STA. 399+90). ONE (1) LANE OF WESTBOUND TRAFFIC AND ONE (1) LANE OF EASTBOUND TRAFFIC WILL BE MAINTAINED AT ALL TIMES ALONG THIS SECTION OF U.S. 20.

THE CONTRACTOR SHALL BE ALLOWED TO CLOSE EACH SIDE STREET FOR FOURTEEN (14) CONSECUTIVE CALENDAR DAYS. LIQUIDATED DAMAGES SHALL BE ASSESSED IN THE AMOUNT OF \$300 FOR EACH CALENDAR DAY THAT THE SIDE STREET REMAINS CLOSED TO TRAFFIC BEYOND THIS SPECIFIED TIME LIMIT.

THE FOLLOWING IS A LIST OF SIDE STREETS TO BE CLOSED DURING THIS PHASE:

PARMLY ROAD STA. 309+94 LT SIDE STREET  
RED MILL VALLEY ROAD STA. 318+50 LT SIDE STREET  
ANTIOCH ROAD STA. 357+71 LT SIDE STREET

THE CONTRACTOR SHALL NOT BE ALLOWED TO CLOSE TWO (2) ADJACENT SIDE STREETS AT THE SAME TIME.

PLACE TEMPORARY STRIPING AS PER THE STRIPING PLAN AFTER CONSTRUCTION IS COMPLETE.

PEDESTRIAN TRAFFIC SHALL BE MAINTAINED.

PHASE 2 SHALL BE COMPLETED BY OCTOBER 15, 2026.

**PRE-PHASE 3 (TO BE COMPLETED CONCURRENTLY WITH PHASE 2):**

CONSTRUCT THE CULVERT EXTENSION AT STA. 199+57.52, LT.

CONSTRUCT THE TEMPORARY PAVEMENT AND TEMPORARY DRAINAGE BETWEEN STA. 182+20 AND STA. 273+30. THE CONTRACTOR MAY UTILIZE A LONG TERM CLOSURE OF THE WESTBOUND OUTSIDE LANE FOR A DURATION OF FOURTEEN (14) CALENDAR DAYS IN ORDER TO INSTALL THE TEMPORARY PAVEMENT. A DISINCENTIVE SHALL BE ASSESSED IN THE AMOUNT OF \$1,500 FOR EACH CALENDAR DAY THAT THE WESTBOUND OUTSIDE LANE REMAINS CLOSED TO TRAFFIC BEYOND THIS SPECIFIED LIMIT.

PRE-PHASE 3 SHALL BE COMPLETED BY OCTOBER 15, 2026.

**PHASE 3:**

THIS PHASE WILL INVOLVE THE RECONSTRUCTION OF THE SOUTH SIDE OF U.S. 20 FROM LANE ROAD (STA. 182+20) TO CENTER ROAD (STA. 273+30). ONE (1) LANE OF WESTBOUND TRAFFIC AND ONE (1) LANE OF EASTBOUND TRAFFIC WILL BE MAINTAINED AT ALL TIMES ALONG THIS SECTION OF U.S. 20.

THE FOLLOWING IS A LIST OF SIDE STREETS TO BE CONSTRUCTED UTILIZING PART-WIDTH CONSTRUCTION:

OHIO STREET STA. 219+68 RT

PEDESTRIAN TRAFFIC SHALL BE MAINTAINED.

**PHASE 4:**

THIS PHASE WILL INVOLVE THE RECONSTRUCTION OF THE NORTH SIDE OF U.S. 20 FROM LANE ROAD (STA. 182+20) TO CENTER ROAD (STA. 273+30). ONE (1) LANE OF WESTBOUND TRAFFIC AND ONE (1) LANE OF EASTBOUND TRAFFIC WILL BE MAINTAINED AT ALL TIMES ALONG THIS SECTION OF U.S. 20.

THE CONTRACTOR SHALL BE ALLOWED TO CLOSE EACH SIDE STREET FOR FOURTEEN (14) CONSECUTIVE CALENDAR DAYS. LIQUIDATED DAMAGES SHALL BE ASSESSED IN THE AMOUNT OF \$300 FOR EACH CALENDAR DAY THAT THE SIDE STREET REMAINS CLOSED TO TRAFFIC BEYOND THIS SPECIFIED TIME LIMIT.

THE FOLLOWING IS A LIST OF SIDE STREETS TO BE CLOSED DURING THIS PHASE:

BLACKMORE ROAD STA. 188+06 LT SIDE STREET  
PERRY PARK ROAD STA. 229+21 LT SIDE STREET

THE CONTRACTOR SHALL NOT BE ALLOWED TO CLOSE TWO (2) ADJACENT SIDE STREETS AT THE SAME TIME.

AFTER CONSTRUCTION IS COMPLETE, PLACE TEMPORARY STRIPING AS PER THE STRIPING PLAN.

PEDESTRIAN TRAFFIC SHALL BE MAINTAINED.

PHASE 4 SHALL BE COMPLETED BY OCTOBER 15, 2027.

**PRE-PHASE 5 (TO BE COMPLETED CONCURRENTLY WITH PHASE 4)**

CONSTRUCT THE CULVERT EXTENSION AT STA. 149+38, LT.

CONSTRUCT THE TEMPORARY PAVEMENT AND TEMPORARY DRAINAGE BETWEEN STA. 101+50 AND STA. 170+88.8. THE CONTRACTOR MAY UTILIZE A LONG TERM CLOSURE OF THE WESTBOUND OUTSIDE LANE FOR A DURATION OF FOURTEEN (14) CALENDAR DAYS IN ORDER TO INSTALL THE TEMPORARY PAVEMENT. A DISINCENTIVE SHALL BE ASSESSED IN THE AMOUNT OF \$1,500 FOR EACH CALENDAR DAY THAT THE WESTBOUND OUTSIDE LANE REMAINS CLOSED TO TRAFFIC BEYOND THIS SPECIFIED LIMIT.

PRE-PHASE 5 SHALL BE COMPLETED BY OCTOBER 15, 2027.

**PHASE 5:**

THIS PHASE WILL INVOLVE THE RECONSTRUCTION OF THE SOUTH SIDE OF U.S. 20 FROM BRIDGE OVER S.R. 2 EASTBOUND (STA. 101+75) TO LANE ROAD (STA. 168+10). ONE (1) LANE OF WESTBOUND TRAFFIC AND ONE (1) LANE OF EASTBOUND TRAFFIC WILL BE MAINTAINED AT ALL TIMES ALONG THIS SECTION OF U.S. 20.

THE FOLLOWING IS A LIST OF RAMPS TO BE CONSTRUCTED UTILIZING PART-WIDTH CONSTRUCTION:

S.R. 2 (EASTBOUND) STA. 108+07 RT

THE CONTRACTOR SHALL BE ALLOWED TO CLOSE EACH SIDE STREET FOR FOURTEEN (14) CONSECUTIVE CALENDAR DAYS. A DISINCENTIVE SHALL BE ASSESSED IN THE AMOUNT OF \$300 FOR EACH CALENDAR DAY THAT THE SIDE STREET REMAINS CLOSED TO TRAFFIC BEYOND THIS SPECIFIED TIME LIMIT.

THE FOLLOWING IS A LIST OF SIDE STREETS TO BE CLOSED DURING THIS PHASE:

NARROWS RD. STA. 144+89 RT SIDE STREET

THE CONTRACTOR SHALL NOT BE ALLOWED TO CLOSE TWO (2) ADJACENT SIDE STREETS AT THE SAME TIME.

PEDESTRIAN TRAFFIC SHALL BE MAINTAINED.

**PHASE 6:**

THIS PHASE WILL INVOLVE THE RECONSTRUCTION OF THE NORTH SIDE OF U.S. 20 FROM BRIDGE OVER S.R. 2 EASTBOUND (STA. 101+75) TO LANE ROAD (STA. 168+10). ONE (1) LANE OF WESTBOUND TRAFFIC AND ONE (1) LANE OF EASTBOUND TRAFFIC WILL BE MAINTAINED AT ALL TIMES ALONG THIS SECTION OF U.S. 20.

THE FOLLOWING IS A LIST OF RAMPS TO BE CONSTRUCTED UTILIZING PART-WIDTH CONSTRUCTION:

S.R. 2 (WESTBOUND) STA. 105+16 LT

THE FOLLOWING IS A LIST OF SIDE STREETS TO BE CONSTRUCTED UTILIZING PART-WIDTH CONSTRUCTION:

BLASE NEMETH ROAD STA. 119+99 LT

AFTER CONSTRUCTION IS COMPLETE, PERFORM THE FOLLOWING WORK:

1. CONSTRUCT CONCRETE MEDIAN FROM STA. 109+50 TO STA. 119+00 PER THE PLANS.

2. PLACE TEMPORARY STRIPING AS PER THE STRIPING PLAN.

PEDESTRIAN TRAFFIC SHALL BE MAINTAINED.

PHASE 6 SHALL BE COMPLETED BY SEPTEMBER 15, 2028.

**PHASE 7:**

MILL OFF 1.5 INCHES OFF THE TOP COURSE OF PAVEMENT AND THEN FILL WITH ITEM 441 OR 442 ASPHALT CONCRETE SURFACE COURSE PER THE FINAL PAVEMENT BUILDUP SHOWN IN THE TYPICAL SECTIONS WHILE MAINTAINING TRAFFIC USING SCD MT-97.12 OVER THE ENTIRE PROJECT (NEWLY CONSTRUCTED PAVEMENT AND RESURFACING AREA). AFTER RESURFACING THE ENTIRE PROJECT SHALL BE RESTRIPEDED PER THE STRIPING PLAN.

PEDESTRIAN TRAFFIC SHALL BE MAINTAINED.

PHASE 7 SHALL BE PERFORMED IN CONJUNCTION WITH PART 2, PHASE 5.

DISINCENTIVE TABLE			
LOCATION OF CRITICAL WORK	COMPLETION DATE	TIME PERIOD	DISINCENTIVE \$ PER TIME PERIOD
PRE-PHASE 1C	FOURTEEN (14) CONSECUTIVE CALENDAR DAYS	DAY	\$1,500
CALL ROAD STA. 332+79 RT	FOURTEEN (14) CONSECUTIVE CALENDAR DAYS	DAY	\$300
PARMLY ROAD STA. 309+94 LT	FOURTEEN (14) CONSECUTIVE CALENDAR DAYS	DAY	\$300
RED MILL VALLEY ROAD STA. 318+50 LT	FOURTEEN (14) CONSECUTIVE CALENDAR DAYS	DAY	\$300
ANTIOCH ROAD STA. 357+71 LT	FOURTEEN (14) CONSECUTIVE CALENDAR DAYS	DAY	\$300
PHASE 2	OCTOBER 15, 2026	DAY	\$5,000
BLACKMORE ROAD STA. 188+06 LT	FOURTEEN (14) CONSECUTIVE CALENDAR DAYS	DAY	\$300
PERRY PARK ROAD STA. 229+21 LT	FOURTEEN (14) CONSECUTIVE CALENDAR DAYS	DAY	\$300
PRE-PHASE 3	FOURTEEN (14) CONSECUTIVE CALENDAR DAYS	DAY	\$1,500
PHASE 4	OCTOBER 15, 2027	DAY	\$5,000
NARROWS ROAD STA. 173+57 RT	FOURTEEN (14) CONSECUTIVE CALENDAR DAYS	DAY	\$300
PRE-PHASE 5	FOURTEEN (14) CONSECUTIVE CALENDAR DAYS	DAY	\$1,500
PHASE 6	SEPTEMBER 15, 2028	DAY	\$5,000

H:\2018\180743\0D0T\ProjectData\08665\_LAK\_20\_WEST\Design\MOT\Sheets\08665\_MN004.dgn Sheet 7/11/2023 11:19 AM somogyi

H:\2018\180743\0D0T\ProjectData\08665\_LAK\_20\_WEST\Design\MOT\Sheets\08665\_MY001.dgn MOT-01.ALT | 7/11/2023 8:26:00 AM somogyi

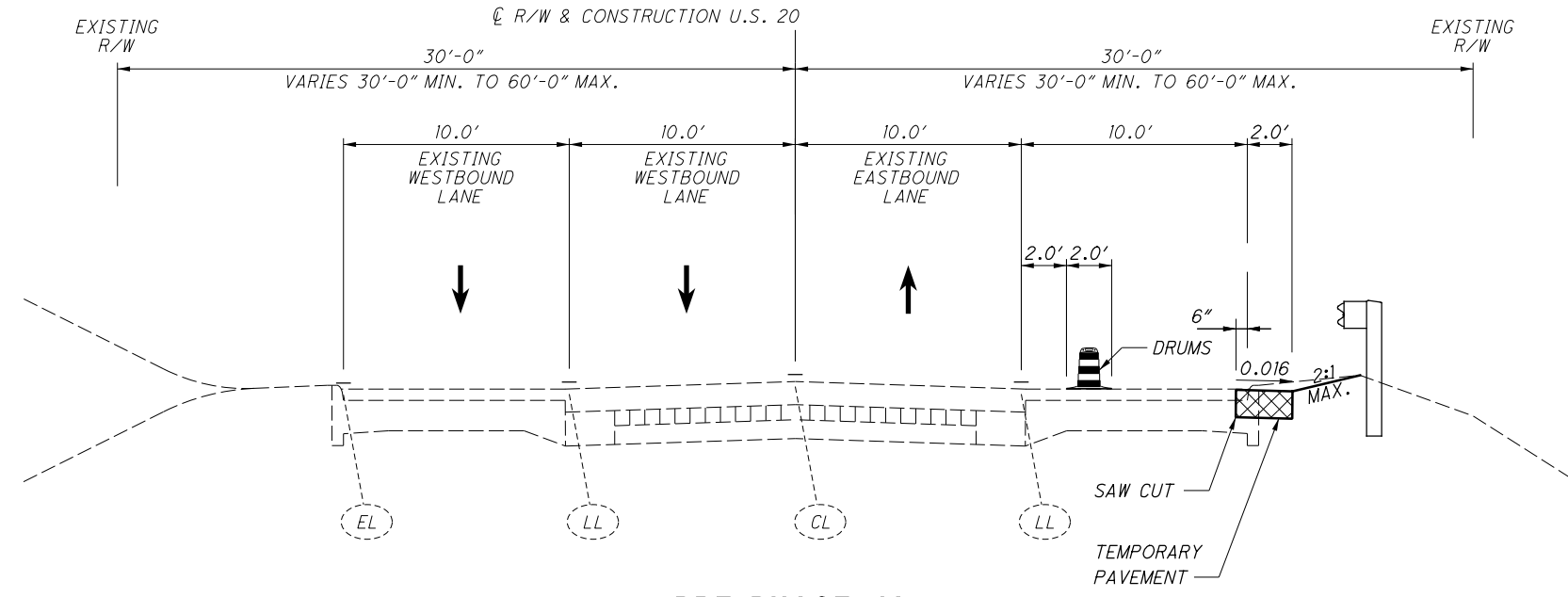

**PRE-PHASE 1A**  
TEMPORARY PAVEMENT  
STA. 250+00 TO STA. 257+00

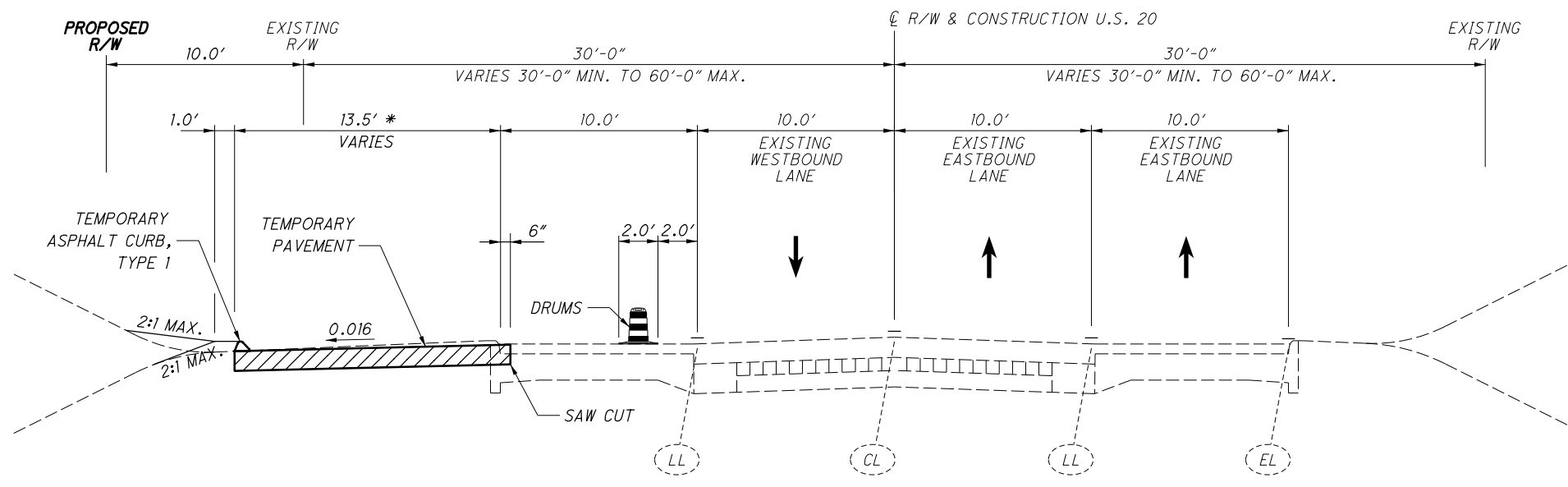

- PRE-PHASE 1C**  
\* TEMPORARY PAVEMENT:  
VARIES FROM 0.0' TO 13.5' FROM STA 283+46.3 TO STA 287+94  
VARIES FROM 13.5' TO 0.0' FROM STA 398+20 TO STA 402+72.3
- PRE-PHASE 3**  
\* TEMPORARY PAVEMENT:  
VARIES FROM 0.0' TO 13.5' FROM STA 179+42.6 TO STA 183+50  
VARIES FROM 13.5' TO 0.0' FROM STA 270+79 TO STA 275+22.6
- PRE-PHASE 5**  
\* TEMPORARY PAVEMENT:  
VARIES FROM 8.0' TO 13.5' FROM STA 114+45.6 TO STA 117+50  
VARIES FROM 13.5' TO 0.0' FROM STA 166+00 TO STA 170+88.8

- PRE-PHASE 1B**  
STA. 247+00.0 TO STA. 260+50.0
- PRE-PHASE 1C**  
STA. 283+46.3 TO STA. 402+72.3
- PRE-PHASE 3**  
STA. 179+42.6 TO STA. 275+22.6
- PRE-PHASE 5**  
STA. 114+45.6 TO STA. 170+88.8

**LEGEND**

- EXISTING CENTER LINE
- EXISTING EDGE LINE
- EXISTING CHANNELIZING LINE
- PROPOSED TEMPORARY PAVEMENT CONSTRUCTED THIS PHASE
- TRAFFIC FLOW

H:\2018\180743\000T\Projec+Data\08665\_LAK\_20\_WEST\Design\M01\Sheets\109270\_MY002.dgn M0T-06 ALI 17/11/2023 11:17:37 AM somogyi

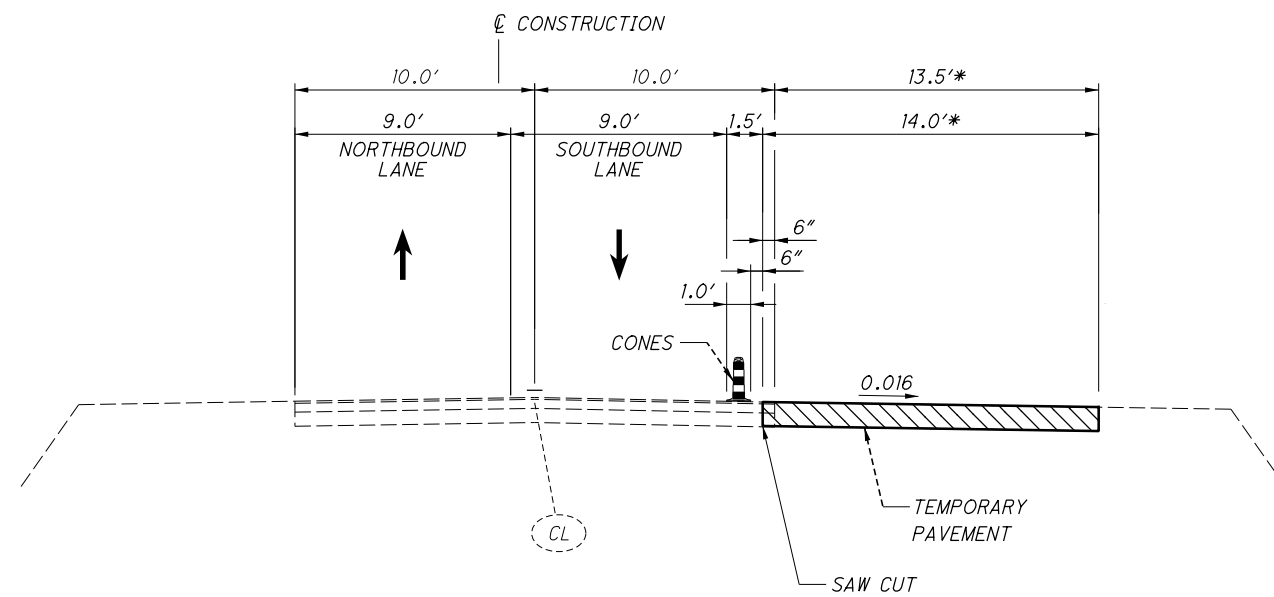

**PRE-PHASE 3, STEP 1**

STA. 6+87.00 TO STA. 9+90.6

\* TEMPORARY PAVEMENT  
FROM STA. 7+37.00 TO STA. 8+75.00  
VARIES FROM 13.0' RT. TO 25.0' RT.

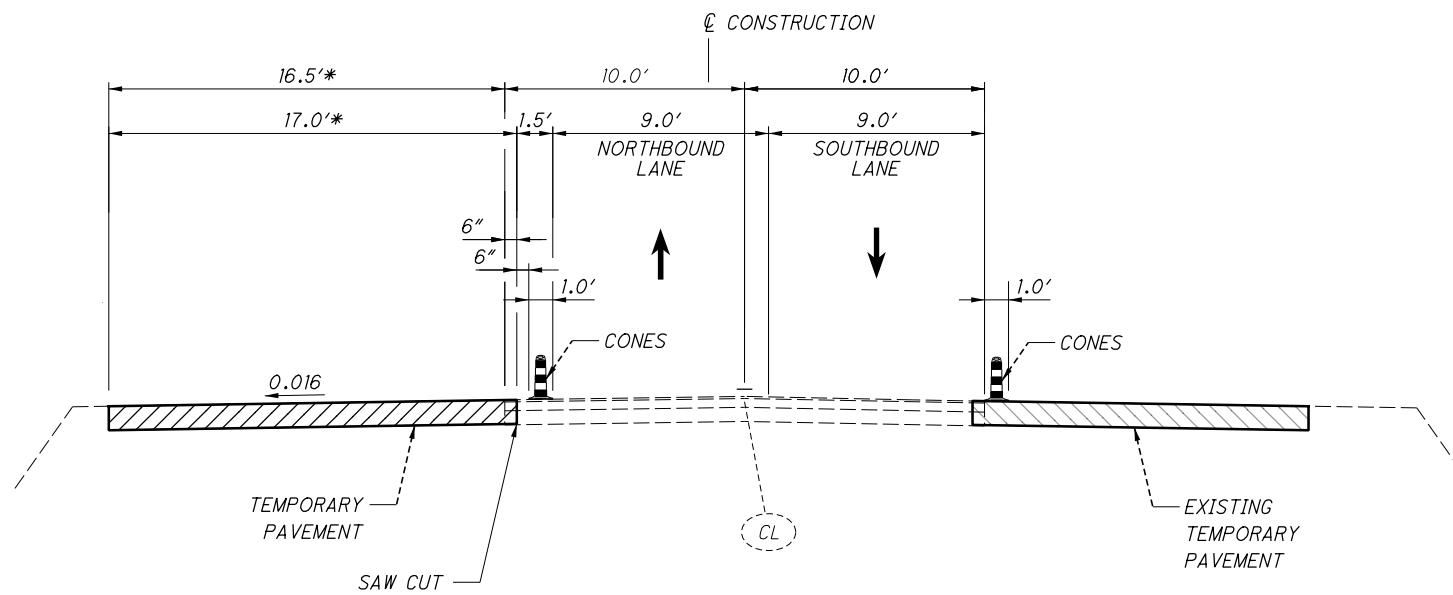





**PRE-PHASE 3, STEP 2**

STA. 6+54.00 TO STA. 9+29.5

\* TEMPORARY PAVEMENT  
FROM STA. 7+04.00 TO STA. 8+75.00  
VARIES FROM 10.0' LT. TO 25.0' LT.

**LEGEND**

-  EXISTING CENTER LINE
-  EXISTING EDGE LINE
-  EXISTING CHANNELIZING LINE
-  PROPOSED TEMPORARY PAVEMENT  
CONSTRUCTED THIS PHASE
-  TRAFFIC FLOW

**OHIO STREET**



H:\2018\180743\ProjectData\08665\_LAK\_20\_WEST\Design\M01\Sheets\08665\_MS022.dgn Sheet 7/11/2023 7:55:16 AM

REF NO.	SHEET NO.	STATION TO STATION	SIDE	606	606	606	611	611	611	611	611	614	614	614	614	614	614	614	614	615	614	614	622		
				GUARDRAIL, TYPE MGS, AS PER PLAN	ANCHOR ASSEMBLY, MGS TYPE E, AS PER PLAN (MASH 2016)	ANCHOR ASSEMBLY, MGS TYPE T, AS PER PLAN	12" CONDUIT, TYPE B, AS PER PLAN	15" CONDUIT, TYPE B, AS PER PLAN	CATCH BASIN, NO. 6, AS PER PLAN	CATCH BASIN RECONSTRUCTED TO GRADE, AS PER PLAN	INLET RECONSTRUCTED TO GRADE, AS PER PLAN	WORK ZONE LANE LINE, CLASS I, 4", 642 PAINT	WORK ZONE CENTER LINE, CLASS I, 642 PAINT	WORK ZONE EDGE LINE, CLASS I, 6", 642 PAINT	WORK ZONE CHANNELIZING LINE, CLASS I, 8", 642 PAINT	WORK ZONE DOTTED LINE, CLASS I, 4", 642 PAINT	WORK ZONE TRANSVERSE/DIAGONAL LINE, CLASS I, 642 PAINT	WORK ZONE STOP LINE, CLASS I, 642 PAINT	WORK ZONE CROSSWALK LINE, CLASS I, 12", 642 PAINT	WORK ZONE ARROW, CLASS I, 642 PAINT	WORK ZONE IMPACT ATTENUATOR, 24" WIDE HAZARDS, (BIDIRECTIONAL)	PAVEMENT FOR MAINTAINING TRAFFIC, CLASS A, AS PER PLAN	BARRIER REFLECTOR, TYPE 1 (BIDIRECTIONAL)	OBJECT MARKER, TWO WAY	PORTABLE BARRIER, UNANCHORED
				FT	EACH	EACH	FT	FT	EACH	EACH	MILE	MILE	MILE	FT	FT	FT	FT	FT	EACH	EACH	SY	EACH	EACH	FT	
<b>NARROWS ROAD</b>																									
CL-1	345	144+31					145+32	LT					0.019												
EL-1	345	144+46					145+47	LT						0.019											
PB-27	345	144+19					146+42	LT														2	2	223	
<b>WINTER PHASE</b>																									
		114+45.60					170+88.80	LT																	
		179+42.60					275+22.60	LT																	
		283+46.30					402+72.30	LT																	
SUBTOTAL SHEET 69													0.020	5.160									2	2	223
SUBTOTALS FROM SHEET 66												0.180	0.500	0.950	399						1	1773	9	9	847
SUBTOTALS FROM SHEET 67				588	3	1	148	39	7	5	2		0.690	1.340			13			21	5435	16	16	1389	
SUBTOTALS FROM SHEET 68												0.430	0.740	0.540	220	612	170	79	517	5		125			
TOTAL				588	3	1	148	39	7	5	2	0.610	1.950	7.990	619	612	170	92	517	5	22	7333	27	27	2459
TOTALS CARRIED TO GENERAL SUMMARY				588	3	1	148	39	7	5	2	0.61	1.95	7.99	619	612	170	92	517	5	22	7333	27	27	2459

MAINTENANCE OF TRAFFIC SUBSUMMARY  
 LAK-US-20-19.59  
 PART 1  
 CALCULATED  
 ARK  
 CHECKED  
 EJT

H:\2018\180743\000\ProjectData\08665\_LAK\_20\_WEST\Design\Roadway\Sheets\08665\_G0006.dgn\_Sheet 7/11/2023 7:57:42 AM somogyi

SHEET NUM.													PART.	ITEM	ITEM	GRAND	UNIT	DESCRIPTION	SEE SHEET NO.	CALCULATED	EJT	CHECKED	JMP
28	29	30	44	50	54	59	63	65	69	72	01/NHS/PV		EXT	TOTAL									
<b>MAINTENANCE OF TRAFFIC</b>																							
				1,013		613			588				2,214	606	15051	2,214	FT	GUARDRAIL, TYPE MGS, AS PER PLAN			30		
				1		1			3				5	606	26151	5	EACH	ANCHOR ASSEMBLY, MGS TYPE E, AS PER PLAN (MASH 2016)			30		
				3		5			1				9	606	26551	9	EACH	ANCHOR ASSEMBLY, MGS TYPE T, AS PER PLAN			30		
45,200													45,200	608	21201	45,200	SF	TEMPORARY ASPHALT CONCRETE WALK, AS PER PLAN			33		
				446		889		44	148				1,527	611	04401	1,527	FT	12" CONDUIT, TYPE B, AS PER PLAN			30, 32		
									39				39	611	05901	39	FT	15" CONDUIT, TYPE B, AS PER PLAN			30, 32		
				34									34	611	10401	34	FT	24" CONDUIT, TYPE B, AS PER PLAN			30, 32		
				36		25		1	7				69	611	98371	69	EACH	CATCH BASIN, NO. 6, AS PER PLAN			30, 32		
				35		25			5				65	611	98635	65	EACH	CATCH BASIN RECONSTRUCTED TO GRADE, AS PER PLAN			30, 32		
									2				2	611	99155	2	EACH	INLET RECONSTRUCTED TO GRADE, AS PER PLAN			30		
				1									1	611	99654	1	EACH	MANHOLE ADJUSTED TO GRADE					
	1,200												1,200	614	11110	1,200	HOUR	LAW ENFORCEMENT OFFICER WITH PATROL CAR FOR ASSISTANCE					
24													24	SPECIAL	61411300	24	EACH	WORK ZONE TRAFFIC SIGNAL			28		
			3	78	74	47	61	12	22	26			323	614	12384	323	EACH	WORK ZONE IMPACT ATTENUATOR, 24" WIDE HAZARDS, (BIDIRECTIONAL)					
		LS											LS	614	12420	LS		DETOUR SIGNING					
			15	95	90	75	67	41	27	74			484	614	13310	484	EACH	BARRIER REFLECTOR, TYPE 1 (BIDIRECTIONAL)					
			15	95	90	75	67	41	27	74			484	614	13360	484	EACH	OBJECT MARKER, TWO WAY					
180													180	614	18601	180	SNMT	PORTABLE CHANGEABLE MESSAGE SIGN, AS PER PLAN			28		
11.18				0.62	0.21	0.61	0.22	0.15	0.61	0.14			13.74	614	20100	13.74	MILE	WORK ZONE LANE LINE, CLASS I, 4", 642 PAINT					
21.26													21.26	614	20550	21.26	MILE	WORK ZONE LANE LINE, CLASS III, 4", 642 PAINT					
6.62			1.38	3.59	3.24	3.23	2.74		1.95	1.58			24.33	614	21100	24.33	MILE	WORK ZONE CENTER LINE, CLASS I, 642 PAINT					
12.78													12.78	614	21550	12.78	MILE	WORK ZONE CENTER LINE, CLASS III, 642 PAINT					
1.28			1.09	5.53	3.2	5.2	3.01	1.82	7.99	2.95			32.07	614	22110	32.07	MILE	WORK ZONE EDGE LINE, CLASS I, 6", 642 PAINT					
5.06													5.06	614	22360	5.06	MILE	WORK ZONE EDGE LINE, CLASS III, 6", 642 PAINT					
3,156				894	835	775	1,258	577	619	2,742			10,856	614	23200	10,856	FT	WORK ZONE CHANNELIZING LINE, CLASS I, 8", 642 PAINT					
8,926													8,926	614	23680	8,926	FT	WORK ZONE CHANNELIZING LINE, CLASS III, 8", 642 PAINT					
			1,800	990	540	1,040	50		612	1,440			6,472	614	24200	6,472	FT	WORK ZONE DOTTED LINE, CLASS I, 4", 642 PAINT					
1,600													1,600	614	24610	1,600	FT	WORK ZONE DOTTED LINE, CLASS III, 4", 642 PAINT					
742				288	304	329	379		170	216			2,428	614	25200	2,428	FT	WORK ZONE TRANSVERSE/DIAGONAL LINE, CLASS I, 642 PAINT					
1,142													1,142	614	25620	1,142	FT	WORK ZONE TRANSVERSE/DIAGONAL LINE, CLASS III, 642 PAINT					
693				310	203	258	150		92	73			1,779	614	26200	1,779	FT	WORK ZONE STOP LINE, CLASS I, 642 PAINT					
1,144													1,144	614	26610	1,144	FT	WORK ZONE STOP LINE, CLASS III, 642 PAINT					
2,665				623	45	1,135			517				4,985	614	27050	4,985	FT	WORK ZONE CROSSWALK LINE, CLASS I, 12", 642 PAINT					
4,068													4,068	614	27250	4,068	FT	WORK ZONE CROSSWALK LINE, CLASS III, 12", 642 PAINT					
72				18	17	19	24		5	14			169	614	30200	169	EACH	WORK ZONE ARROW, CLASS I, 642 PAINT					
120													120	614	30650	120	EACH	WORK ZONE ARROW, CLASS III, 642 PAINT					
74													74	614	32800	74	SF	WORK ZONE ISLAND MARKING, CLASS III, 642 PAINT					
	120												120	614	40051	120	EACH	BUSINESS ENTRANCE SIGN, AS PER PLAN			29		
		LS											LS	615	10000	LS		ROADS FOR MAINTAINING TRAFFIC					
			2,278	17,905		14,439			7,333				41,955	615	20001	41,955	SY	PAVEMENT FOR MAINTAINING TRAFFIC, CLASS A, AS PER PLAN			30		
			1,100										1,100	616	10000	1,100	MGAL	WATER					
				1,080	8,090	7,921	7,621	6,179	3,952	2,459	7,169		44,471	622	41100	44,471	FT	PORTABLE BARRIER, UNANCHORED					
			450										450	642	00720	450	FT	CHEVRON MARKING, TYPE 1					
			250,000										250,000	SPECIAL	69098000	250,000	EACH	REIMBURSEMENT FOR MOT ITEMS PERMANENTLY DAMAGED BY TRAFFIC			30		
<b>INCIDENTALS</b>																							
													97,500	100	51100	97,500	EACH	DEPARTMENT'S SHARE OF THE DISPUTE RESOLUTION BOARD					
													LS	108	10000	LS		CPM PROGRESS SCHEDULE					
		LS	LS	LS									LS	614	11000	LS		MAINTAINING TRAFFIC					
													36	619	16021	36	MNTH	FIELD OFFICE, TYPE C, AS PER PLAN			27A		
													LS	623	10000	LS		CONSTRUCTION LAYOUT STAKES AND SURVEYING					
													LS	624	10000	LS		MOBILIZATION					
													LS	SPECIAL	69098400	LS		PRECONSTRUCTION VIDEO DOCUMENTATION			23		

**GENERAL SUMMARY**  
**LAK-US-20-19.59**  
**PART 1**

388  
1088







**MAINTENANCE OF TRAFFIC NARRATIVE**

THIS PROJECT HAS BEEN DIVIDED INTO TWO PARTS: PART 1 AND PART 2. PART 2 (LAK-US-20-24.99) IS A TWO YEAR PROJECT AND SHALL BE BUILT FIRST. PART 1 (LAK-US-20-19.59) IS A THREE YEAR PROJECT AND SHALL BE BUILT SECOND. WITHIN EACH OF THESE PARTS, PHASES SHALL BE CONSTRUCTED FROM EAST TO WEST PER THE CONSTRUCTION SEQUENCES. CONSTRUCTION OF TEMPORARY PAVEMENT SHALL ONLY OCCUR IN THE PHASE WHERE IT IS IMMEDIATELY NEEDED. NO CONSTRUCTION SHOULD BE SCHEDULED TO OCCUR DURING THE WINTER MONTHS, BETWEEN NOVEMBER 1 AND APRIL 1 (EXCEPT TREE CLEARING).

**SEQUENCE OF CONSTRUCTION**

**UTILITY RELOCATION**

UTILITY RELOCATION (BY OTHERS) IS TO OCCUR IN 2023.

**PRE-PHASE 1:**

THE TEMPORARY PAVEMENT AND THE TEMPORARY DRAINAGE ARE TO BE CONSTRUCTED UNDER THIS PHASE. WORK SHALL BE COMPLETED USING DAILY LANE CLOSURES BY OCTOBER 15, 2023.

THE CONTRACTOR MAY UTILIZE A LONG TERM CLOSURE OF THE WESTBOUND OUTSIDE LANE FOR A DURATION OF FOURTEEN (14) CALENDAR DAYS IN ORDER TO INSTALL THE TEMPORARY PAVEMENT. A DISINCENTIVE SHALL BE ASSESSED IN THE AMOUNT OF \$1,500 FOR EACH CALENDAR DAY THAT THE WESTBOUND OUTSIDE LANE REMAINS CLOSED TO TRAFFIC BEYOND THIS SPECIFIED LIMIT.

**PHASE 1:**

THIS PHASE WILL INVOLVE FIRSTLY THE RECONSTRUCTION OF HUBBARD ROAD SOUTH OF U.S. 20 AND ITS DRAINAGE OUTLET; AND SECONDLY THE SOUTH SIDE OF U.S. 20 FROM STA. 500+40 TO STA. 572+50. ONE (1) LANE OF WESTBOUND TRAFFIC AND ONE (1) LANE OF EASTBOUND TRAFFIC WILL BE MAINTAINED AT ALL TIMES ALONG THIS SECTION OF U.S. 20. ONE (1) LANE OF NORTHBOUND TRAFFIC AND ONE (1) LANE OF SOUTHBOUND TRAFFIC WILL BE MAINTAINED AT ALL TIMES ALONG THIS SECTION OF HUBBARD ROAD. HUBBARD ROAD AND ITS DRAINAGE OUTLET SHALL BE CONSTRUCTED PRIOR TO THE WORK ON U.S. 20. CONSTRUCTION OF THE INTERSECTION OF HUBBARD ROAD AND U.S. 20 SHALL BE PERFORMED ON WEEKENDS.

THE SURFACE COURSE SHALL BE NON-PERFORMED AT THIS TIME AND THE INTERMEDIATE COURSE SHALL BE BUILT UP TO THE TOP OF PAVEMENT WITH A THICKNESS OF 3 INCHES.

THERE WILL BE NO RESURFACING DURING THIS PHASE.

THE CONTRACTOR SHALL BE ALLOWED TO CLOSE EACH SIDE STREET FOR FOURTEEN (14) CONSECUTIVE CALENDAR DAYS. A DISINCENTIVE SHALL BE ASSESSED IN THE AMOUNT OF \$800 FOR EACH CALENDAR DAY THAT THE SIDE STREET REMAINS CLOSED TO TRAFFIC BEYOND THIS SPECIFIED TIME LIMIT.

THE FOLLOWING IS A LIST OF SIDE STREETS TO BE CLOSED DURING THIS PHASE:

BURNS ROAD STA. 517+13 RT SIDE STREET

THE CONTRACTOR SHALL NOT BE ALLOWED TO CLOSE TWO (2) ADJACENT SIDE STREETS AT THE SAME TIME.

THE CONTRACTOR SHALL BE ALLOWED TO CLOSE EACH ACCESS DRIVEWAY FOR FOURTEEN (14) CONSECUTIVE CALENDAR DAYS. A DISINCENTIVE SHALL BE ASSESSED IN THE AMOUNT OF \$800 FOR EACH CALENDAR DAY THAT THE DRIVEWAY REMAINS CLOSED TO TRAFFIC BEYOND THIS SPECIFIED TIME LIMIT.

THE FOLLOWING IS A LIST OF ACCESS DRIVEWAYS TO BE CLOSED DURING THIS PHASE:

ACCESS DRIVE STA. 550+31 RT MAJOR DRIVE  
ACCESS DRIVE STA. 556+02 RT MAJOR DRIVE

THE CONTRACTOR SHALL NOT BE ALLOWED TO CLOSE TWO (2) ADJACENT MAJOR DRIVEWAYS AT THE SAME TIME.

THE FOLLOWING IS A LIST OF SIDE STREETS TO BE CONSTRUCTED UTILIZING PART-WIDTH CONSTRUCTION:

HUBBARD ROAD STA. 565+71 RT  
(INCLUDING THE DRAINAGE OUTLET)

PEDESTRIAN TRAFFIC SHALL BE MAINTAINED.

**PHASE 2:**

THIS PHASE WILL INVOLVE THE RECONSTRUCTION OF THE NORTH SIDE OF U.S. 20 FROM STA. 500+40 TO STA. 572+50 AND HUBBARD ROAD NORTH OF U.S. 20. ONE (1) LANE OF WESTBOUND TRAFFIC AND ONE (1) LANE OF EASTBOUND TRAFFIC WILL BE MAINTAINED AT ALL TIMES ALONG THIS SECTION OF U.S. 20. ONE (1) LANE OF NORTHBOUND TRAFFIC AND ONE (1) LANE OF SOUTHBOUND TRAFFIC WILL BE MAINTAINED AT ALL TIMES ALONG THIS SECTION OF HUBBARD ROAD. CONSTRUCTION OF THE INTERSECTION OF HUBBARD ROAD AND U.S. 20 SHALL BE PERFORMED ON WEEKENDS.

THE SURFACE COURSE SHALL BE NON-PERFORMED AT THIS TIME AND THE INTERMEDIATE COURSE SHALL BE BUILT UP TO THE TOP OF PAVEMENT WITH A THICKNESS OF 3 INCHES.

THERE WILL BE NO RESURFACING DURING THIS PHASE.

THE FOLLOWING ITEMS SHALL BE PERFORMED AT THE END OF PHASE 2 IN THE PHASE 1 / 2 WORK AREA:

- A. TRAFFIC SIGNAL AND FINAL CURB AND GUTTER WORK AT THE HUBBARD RD INTERSECTION.
- B. ALL OTHER TRAFFIC SIGNAL WORK.
- C. PERMANENT SIGNING.
- D. TEMPORARY STRIPING.

THE CONTRACTOR SHALL BE ALLOWED TO CLOSE EACH SIDE STREET FOR FOURTEEN (14) CONSECUTIVE CALENDAR DAYS. A DISINCENTIVE SHALL BE ASSESSED IN THE AMOUNT OF \$800 FOR EACH CALENDAR DAY THAT THE SIDE STREET REMAINS CLOSED TO TRAFFIC BEYOND THIS SPECIFIED TIME LIMIT.

THE FOLLOWING IS A LIST OF SIDE STREETS TO BE CLOSED DURING THIS PHASE:

WALMART DR. STA. 504+50 LT SIDE STREET  
STONEYRIDGE DR. STA. 532+95 LT SIDE STREET  
MORNINGSTAR DR. STA. 536+43 LT SIDE STREET

THE CONTRACTOR SHALL NOT BE ALLOWED TO CLOSE TWO (2) ADJACENT SIDE STREETS AT THE SAME TIME.

THE CONTRACTOR SHALL BE ALLOWED TO CLOSE EACH ACCESS DRIVEWAY FOR FOURTEEN (14) CONSECUTIVE CALENDAR DAYS. A DISINCENTIVE SHALL BE ASSESSED IN THE AMOUNT OF \$800 FOR EACH CALENDAR DAY THAT THE DRIVEWAY REMAINS CLOSED TO TRAFFIC BEYOND THIS SPECIFIED TIME LIMIT.

THE FOLLOWING IS A LIST OF ACCESS DRIVEWAYS TO BE CLOSED DURING THIS PHASE:

ACCESS DRIVE STA. 558+30 LT MAJOR DRIVE

THE CONTRACTOR SHALL NOT BE ALLOWED TO CLOSE TWO (2) ADJACENT MAJOR DRIVEWAYS AT THE SAME TIME.

THE FOLLOWING IS A LIST OF SIDE STREETS TO BE CONSTRUCTED UTILIZING PART-WIDTH CONSTRUCTION:

DERUBERTIS ROAD STA. 550+35 LT  
HUBBARD ROAD STA. 565+71 LT

PEDESTRIAN TRAFFIC SHALL BE MAINTAINED.

APPLY TEMPORARY STRIPING ON NEWLY CONSTRUCTED PAVEMENT AS PER THE STRIPING PLANS.

PHASE 2 SHALL BE COMPLETED BY OCTOBER 15, 2024.

**PRE-PHASE 3 (TO BE COMPLETED CONCURRENTLY WITH PHASE 2):**

THE TEMPORARY PAVEMENT AND TEMPORARY DRAINAGE TO BE CONSTRUCTED UNDER THIS PHASE.

THE CONTRACTOR MAY UTILIZE A LONG TERM CLOSURE OF THE WESTBOUND OUTSIDE LANE FOR A DURATION OF FOURTEEN (14) CALENDAR DAYS IN ORDER TO INSTALL THE TEMPORARY PAVEMENT. A DISINCENTIVE SHALL BE ASSESSED IN THE AMOUNT OF \$1,500 FOR EACH CALENDAR DAY THAT THE WESTBOUND OUTSIDE LANE REMAINS CLOSED TO TRAFFIC BEYOND THIS SPECIFIED LIMIT.

WORK SHALL BE COMPLETED BY OCTOBER 15, 2024.

**PHASE 3:**

THIS PHASE WILL INVOLVE THE RECONSTRUCTION OF THE SOUTH SIDE OF U.S. 20 FROM STA. 411+20 TO STA. 426+00 AND FROM STA. 440+15 TO STA. 486+40. ONE (1) LANE OF WESTBOUND TRAFFIC AND ONE (1) LANE OF EASTBOUND TRAFFIC WILL BE MAINTAINED AT ALL TIMES ALONG THIS SECTION OF U.S. 20.

THE SURFACE COURSE SHALL BE NON-PERFORMED AT THIS TIME AND THE INTERMEDIATE COURSE SHALL BE BUILT UP TO THE TOP OF PAVEMENT WITH A THICKNESS OF 3 INCHES. THERE WILL BE NO RESURFACING DURING THIS PHASE.

PEDESTRIAN TRAFFIC SHALL BE MAINTAINED.

**PHASE 4:**

THIS PHASE WILL INVOLVE THE RECONSTRUCTION OF THE NORTH SIDE OF U.S. 20 FROM STA. 411+20 TO STA. 426+00 AND FROM STA. 440+15 TO STA. 486+40. ONE (1) LANE OF WESTBOUND TRAFFIC AND ONE (1) LANE OF EASTBOUND TRAFFIC WILL BE MAINTAINED AT ALL TIMES ALONG THIS SECTION OF U.S. 20.

THE SURFACE COURSE SHALL BE NON-PERFORMED AT THIS TIME AND THE INTERMEDIATE COURSE SHALL BE BUILT UP TO THE TOP OF PAVEMENT WITH A THICKNESS OF 3 INCHES. THERE WILL BE NO RESURFACING DURING THIS PHASE.

THE FOLLOWING ITEMS SHALL BE PERFORMED AT THE END OF PHASE 4:

- A. TRAFFIC SIGNAL WORK.
- B. PERMANENT SIGNING.
- C. TEMPORARY STRIPING.

THE CONTRACTOR SHALL BE ALLOWED TO CLOSE EACH SIDE STREET FOR FOURTEEN (14) CONSECUTIVE CALENDAR DAYS. A DISINCENTIVE SHALL BE ASSESSED IN THE AMOUNT OF \$800 FOR EACH CALENDAR DAY THAT THE SIDE STREET REMAINS CLOSED TO TRAFFIC BEYOND THIS SPECIFIED TIME LIMIT.

THE FOLLOWING IS A LIST OF SIDE STREETS TO BE CLOSED DURING THIS PHASE:

HAINES ROAD STA. 463+33 LT SIDE STREET

THE CONTRACTOR SHALL NOT BE ALLOWED TO CLOSE TWO (2) ADJACENT SIDE STREETS AT THE SAME TIME.

PEDESTRIAN TRAFFIC SHALL BE MAINTAINED.

PHASE 4 SHALL BE COMPLETED BY OCTOBER 15, 2025.

**PHASE 5:**

MILL OFF 1.25 INCHES OFF THE TOP OF THE PAVEMENT AND THEN FILL WITH ITEM 441 SURFACE COURSE PER THE FINAL PAVEMENT BUILDUP SHOWN IN THE TYPICAL SECTIONS WHILE MAINTAINING TRAFFIC USING SCD MT-97.12 OVER THE ENTIRE PROJECT (NEWLY CONSTRUCTED PAVEMENT AND RESURFACING AREA ON U.S. 20 (BETWEEN STA. 411+20 TO STA. 552+50), HUBBARD ROAD, AND ALL OF THE SIDE ROADS. AFTER RESURFACING, THE ENTIRE PROJECT SHALL BE RESTRIPIED PER THE STRIPING PLAN. FIRST WITH CLASS 3 PRE-STRIPING AND THEN WITH THE FINAL STRIPING.

PEDESTRIAN TRAFFIC SHALL BE MAINTAINED.

PHASE 5 SHALL BE PERFORMED IN CONJUNCTION WITH PART 1, PHASE 7.

DISINCENTIVE TABLE			
LOCATION OF CRITICAL WORK	COMPLETION DATE	TIME PERIOD	DISINCENTIVE \$ PER TIME PERIOD
BURNS ROAD STA. 517+13 RT	FOURTEEN (14) CONSECUTIVE CALENDAR DAYS	DAY	\$800
ACCESS DRIVE STA. 550+31 RT	FOURTEEN (14) CONSECUTIVE CALENDAR DAYS	DAY	\$800
ACCESS DRIVE STA. 556+02 RT	FOURTEEN (14) CONSECUTIVE CALENDAR DAYS	DAY	\$800
WALMART DRIVE STA. 504+50 LT	FOURTEEN (14) CONSECUTIVE CALENDAR DAYS	DAY	\$800
STONY RIDGE DRIVE STA. 504+50 LT	FOURTEEN (14) CONSECUTIVE CALENDAR DAYS	DAY	\$800
MORNINGSTAR DRIVE STA. 504+50 LT	FOURTEEN (14) CONSECUTIVE CALENDAR DAYS	DAY	\$800
PHASE 2	OCTOBER 15, 2024	DAY	\$5,000
HAINES ROAD STA. 463+33	FOURTEEN (14) CONSECUTIVE CALENDAR DAYS	DAY	\$800
PRE-PHASE 3	FOURTEEN (14) CONSECUTIVE CALENDAR DAYS	DAY	\$1,500
PHASE 4	OCTOBER 15, 2025	DAY	\$5,000

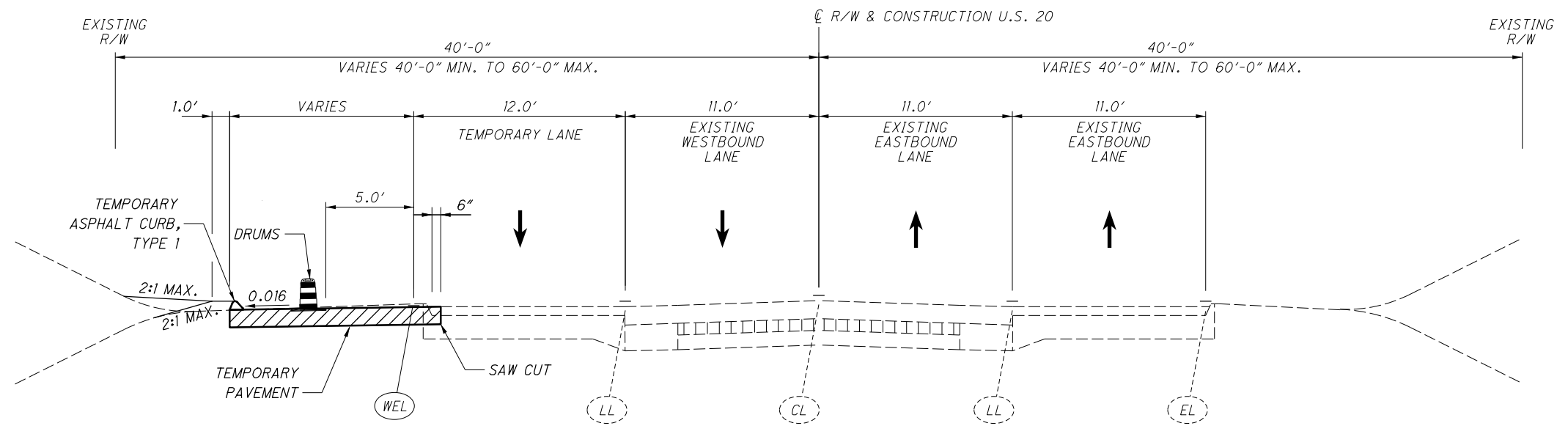

**WINTER PHASE**







**PRE-PHASE 1**

STA. 499+78.0 TO STA. 512+00

**PRE-PHASE 3**

STA. 409+04.9 TO STA. 430+24.8  
 STA. 436+55 TO STA. 488+88.6

**LEGEND**

-  CL EXISTING CENTER LINE
-  EL EXISTING EDGE LINE
-  LL EXISTING CHANNELIZING LINE
-  WEL WORKZONE EDGE LINE, CLASS 1
-  PROPOSED TEMPORARY PAVEMENT CONSTRUCTED THIS PHASE
-  TRAFFIC FLOW





H:\2018\180743\000\ProjectData\09270\_LAK\_20\_EAST\Design\Roadway\Sheets\09270\_G005.dgn\_Sheet 7/11/2023 8:15:33 AM somogyi

SHEET NUM.											PART.	ITEM	ITEM	GRAND	UNIT	DESCRIPTION	SEE SHEET NO.
21	22	23		37	41	46	50				02/NHS/ PV	EXT	TOTAL				
<b>MAINTENANCE OF TRAFFIC</b>																	
						325					325	606	15051	325	FT	GUARDRAIL, TYPE MGS, AS PER PLAN	23
						1					1	606	26151	1	EACH	ANCHOR ASSEMBLY, MGS TYPE E, AS PER PLAN (MASH 2016)	23
						1					1	606	26551	1	EACH	ANCHOR ASSEMBLY, MGS TYPE T, AS PER PLAN	23
86,000											86,000	608	21201	86,000	SF	TEMPORARY ASPHALT CONCRETE WALK, AS PER PLAN	26
				451		734					1,185	611	04401	1,185	FT	12" CONDUIT, TYPE B, AS PER PLAN	23, 25
				10		24					34	611	98371	34	EACH	CATCH BASIN, NO. 6, AS PER PLAN	23, 25
				10		25					35	611	98635	35	EACH	CATCH BASIN RECONSTRUCTED TO GRADE, AS PER PLAN	23, 25
						10					10	611	99654	10	EACH	MANHOLE ADJUSTED TO GRADE	
	1,000										1,000	614	11110	1,000	HOUR	LAW ENFORCEMENT OFFICER WITH PATROL CAR FOR ASSISTANCE	
20											20	SPECIAL	61411300	20	EACH	WORK ZONE TRAFFIC SIGNAL	21
				12	12	32	36				92	614	12384	92	EACH	WORK ZONE IMPACT ATTENUATOR, 24" WIDE HAZARDS, (BIDIRECTIONAL)	
			LS								LS	614	12420	LS		DETOUR SIGNING	
				15	15	83	63				176	614	13310	176	EACH	BARRIER REFLECTOR, TYPE 1 (BIDIRECTIONAL)	
						10					10	614	13312	10	EACH	BARRIER REFLECTOR, TYPE 2 (BIDIRECTIONAL)	
				15	15	88	63				181	614	13360	181	EACH	OBJECT MARKER, TWO WAY	
120											120	614	18601	120	SNMT	PORTABLE CHANGEABLE MESSAGE SIGN, AS PER PLAN	21
3.61				0.36	0.17	0.67	0.14				4.95	614	20100	4.95	MILE	WORK ZONE LANE LINE, CLASS I, 4", 642 PAINT	
12.38											12.38	614	20550	12.38	MILE	WORK ZONE LANE LINE, CLASS III, 4", 642 PAINT	
2.71				2.93	2.59	3.07	2.59				13.89	614	21100	13.89	MILE	WORK ZONE CENTER LINE, CLASS I, 642 PAINT	
8.66											8.66	614	21550	8.66	MILE	WORK ZONE CENTER LINE, CLASS III, 642 PAINT	
1.33				4.75	3.37	4.13	4.59				18.17	614	22110	18.17	MILE	WORK ZONE EDGE LINE, CLASS I, 6", 642 PAINT	
4.26											4.26	614	22360	4.26	MILE	WORK ZONE EDGE LINE, CLASS III, 6", 642 PAINT	
1,506				467	707	1,571	1,620				5,871	614	23200	5,871	FT	WORK ZONE CHANNELIZING LINE, CLASS I, 8", 642 PAINT	
4,032											4,032	614	23680	4,032	FT	WORK ZONE CHANNELIZING LINE, CLASS III, 8", 642 PAINT	
				1,168	500	990					2,658	614	24200	2,658	FT	WORK ZONE DOTTED LINE, CLASS I, 4", 642 PAINT	
648				171	81	501	471				1,872	614	25200	1,872	FT	WORK ZONE TRANSVERSE/DIAGONAL LINE, CLASS I, 642 PAINT	
1,676											1,676	614	25620	1,676	FT	WORK ZONE TRANSVERSE/DIAGONAL LINE, CLASS III, 642 PAINT	
566				459	357	278	190				1,850	614	26200	1,850	FT	WORK ZONE STOP LINE, CLASS I, 642 PAINT	
1,338											1,338	614	26610	1,338	FT	WORK ZONE STOP LINE, CLASS III, 642 PAINT	
				274		1,016					2,872	614	27050	2,872	FT	WORK ZONE CROSSWALK LINE, CLASS I, 12", 642 PAINT	
1,582											3,390	614	27250	3,390	FT	WORK ZONE CROSSWALK LINE, CLASS III, 12", 642 PAINT	
3,390											107	614	30200	107	EACH	WORK ZONE ARROW, CLASS I, 642 PAINT	
23				10	14	29	31				62	614	30650	62	EACH	WORK ZONE ARROW, CLASS III, 642 PAINT	
62																	
											51	614	32700	51	SF	WORK ZONE ISLAND MARKING, CLASS I	
51											102	614	32800	102	SF	WORK ZONE ISLAND MARKING, CLASS III, 642 PAINT	
102											65	614	40051	65	EACH	BUSINESS ENTRANCE SIGN, AS PER PLAN	22
			65														
			LS								LS	615	10000	LS		ROADS FOR MAINTAINING TRAFFIC	
				7,925	790	8,647					17,362	615	20001	17,362	SY	PAVEMENT FOR MAINTAINING TRAFFIC, CLASS A, AS PER PLAN	23
											550	616	10000	550	MGAL	WATER	
				1,060	1,530	6,179	4,713				13,482	622	41100	13,482	FT	PORTABLE BARRIER, UNANCHORED	
											250,000	SPECIAL	69098000	250,000	EACH	REIMBURSEMENT FOR MOT ITEMS PERMANENTLY DAMAGED BY TRAFFIC	23
			250,000														
<b>INCIDENTALS</b>																	
											97,500	100	51100	97,500	EACH	DEPARTMENT'S SHARE OF THE DISPUTE RESOLUTION BOARD	
											LS	108	10000	LS		CPM PROGRESS SCHEDULE	
											LS	614	11000	LS		MAINTAINING TRAFFIC	
											24	619	16021	24	MNTH	FIELD OFFICE, TYPE C, AS PER PLAN	20A
											LS	623	10000	LS		CONSTRUCTION LAYOUT STAKES AND SURVEYING	
											LS	624	10000	LS		MOBILIZATION	
											LS	SPECIAL	69098400	LS		PRECONSTRUCTION VIDEO DOCUMENTATION	16

**GENERAL SUMMARY**

**LAK-US-20-24.99 PART 2**



H:\2018\180743\000\ProjectData\09270\_LAK\_20\_EAST\_Design\Roadway\Sheets\09270\_CC005.dgn Sheet 7/10/2023 3:01:02 PM somogyi

STATION	SIDE	LENGTH	AVERAGE WIDTH	CALCULATED SURFACE AREA	CADD GENERATED SURFACE AREA	202	202	203.0	204	252	254	254	301	301	304	407	441	441	441		441		441	609	609	609	617	
						PAVEMENT REMOVED, AS PER PLAN	CURB REMOVED	EXCAVATION	SUBGRADE COMPACTION	FULL DEPTH PAVEMENT SAWING	1.25" PAVEMENT PLANING, ASPHALT CONCRETE	3" PAVEMENT PLANING, ASPHALT CONCRETE	6" ASPHALT CONCRETE BASE, PG64-22, (449)	6" ASPHALT CONCRETE BASE, (449), AS PER PLAN, PG64-22	6" AGGREGATE BASE	NON-TRACKING TACK COAT	1.25" ASPHALT CONCRETE SURFACE COURSE, TYPE 1, (446), AS PER PLAN, PG70-22M	1.25" ASPHALT CONCRETE SURFACE COURSE, TYPE 1, (449), PG64-22	1.75" ASPHALT CONCRETE INTERMEDIATE COURSE, TYPE 2, (446)	3.00" ASPHALT CONCRETE INTERMEDIATE COURSE, TYPE 2, (446)	1.75" ASPHALT CONCRETE INTERMEDIATE COURSE, TYPE 2, (449)	3.00" ASPHALT CONCRETE INTERMEDIATE COURSE, TYPE 2, (449)	ANTI-SEGREGATION EQUIPMENT	COMBINATION CURB AND GUTTER, TYPE 2	CURB, TYPE 6	CONCRETE TRAFFIC ISLAND	COMPACTED AGGREGATE	
FROM	TO					SY	FT	CY	SY	FT	SY	SY	CY	CY	CY	GAL	CY	CY	CY	CY	CY	CY	CY	FT	FT	SY	CY	
MCMACKIN																												
10+27.20	10+75.75	L/R	48.55		1766.8											23.6												
9+20.95	9+64.92	L/R	43.97		1531.4											20.4												
HAINES																												
10+26.62	10+92.79	L/R	66.17		2630.2	292.2			321.7		292.2		48.7		60.1	35.1												
10+92.79	11+50.00	L/R	57.21		1249.5	138.8			164.3	20	138.8		23.8		24.2	16.7											2.2	
GREEN																												
10+33.66	11+03.83	L/R	70.17		3659.4											48.8												96.0
WALMART																												
10+34.74	10+94.59	L/R	59.85		2800.6	311.2		69.5	337.8	24	311.2		51.9		64.8	37.3											40.0	
BURNS																												
8+24.93	9+33.02	L/R	108.09		2606.5	289.6			337.7	23	289.6		49.6		50.3	34.8												4.1
9+33.02	9+76.54	L/R	43.52		1734.1	192.7			212.0		192.7		32.1		40.3	23.1												
STONERIDGE																												
10+22.77	10+62.77	L/R	40.00		1646.6	183.0		40.9	200.7	24	183.0		30.5		38.6	22.0												
MORNINGSTAR																												
10+23.70	10+59.02	L/R	35.32		1225.5	136.2		30.4	151.9	26	136.2		22.7		29.0	16.3												
DERUBERTIS																												
10+23.30	11+00.00	L/R	76.7		2250.8	250.1			284.2		250.1		41.7		53.3	30.0												
11+00.00	11+50.00	L/R	50.0		1202.4	133.6			155.8		133.6		22.6		26.0	16.0												1.0
11+50.00	11+75.00	L/R	25.0		559.9	62.2			73.3	21	62.2		10.7		13.6	7.5												1.0
SOUTH DERUBERTIS																												
9+45.00	9+55.50	R	10.5		322.5	35.8		8.0	40.5	37	35.8		6.1		6.2	4.3												
9+55.50	9+77.00	R	21.5		730.68	81.2		18.1	90.7		81.2		13.5		17.8	9.7												
SHOP STA 556+02																												
10+23.29	10+79.97	L	56.68		3371.52	374.6		83.7	399.8	41	374.6		62.4		71.1	45.0												
9+08.00	9+77.00	R	69.00		3737.94	415.3		92.8	446.0	46	415.3		69.2		79.1	49.8												
SHOP 558+31																												
9+23.17	9+66.10	L	42.93		1892.28	210.3		47.0	229.3	30	210.3		35.0		41.5	25.2												
HUBBARD																												
90+00.00	91+80.90	L/R	180.90	44.00	7959.6							884.4			106.1	30.7		43.0										6.7
92+55.20	92+96.00	L/R	40.80	52.00	2121.6							235.7			28.3	8.2		11.5										1.6
92+96.00	96+00.00	L	304.0	14.50	4408.0					319	489.8			85.4	84.9	58.8	17.0	23.8										5.7
96+00.00	99+00.00	L	300.0	16.25	4875.0					300	541.7			94.0	93.5	65.0	18.8	26.3										5.6
92+96.00	97+20.00	R	424.0	26.00	11024.0							1224.9			147.0	42.5		59.5										7.9
97+20.00	99+00.00	R	180.0	18.00	3240.0							360.0			43.2	12.5		17.5										3.4
99+00.00	99+71.43	L/R	71.43		3559.2	395.5			427.2		395.5			65.9	78.2	47.5	13.7											
100+29.13	101+00.00	L/R	70.87		3684.7	409.4			440.9		409.4			68.2	80.7	49.1	14.2		33.0									
101+00.00	102+50.00	L/R	150.00	36.00	5400.0							600.0			72.0	20.8		29.2										5.6
102+50.00	104+50.00	L/R	200.00	30.00	6000.0							666.7			80.0	23.2		32.4										7.5
104+50.00	104+75.00	L/R	25.00	24.00	600.0							66.7			8.0	2.3		3.2										1.0
TOTALS THIS SHEET						3911.7		390.4	4313.8	911.0	4943.2	4811.5	520.5	313.5	953.2	1170.6	203.9	134.7	246.4	67.1	37.6	258.8	517.4	1811.0	96.0	69.4	53.3	
TOTALS FROM SHEET 234						33926	1681		41094	123	35177	8437		5863	6726	5234	1516		3342				4857	12603	1676			
TOTALS FROM SHEET 235						33815	137		40456	147	34538	9612		5757	6620	5298	1534		3346				4879	12966	95	16		
TOTALS CARRIED TO GENERAL SUMMARY						71653	1818	391	85864	1181	74659	22861	521	11934	14300	11703	3254	135	7002		297		10254	27380	1867	86	54	

**PAVEMENT CALCULATIONS**

**LAK-US-20-24.99 PART 2**

CALCULATED  
JMP  
CHECKED  
WDB

236  
599