

LEGEND

- ① ITEM 202 - CONCRETE WALK REMOVED
- ② ITEM 203 - EMBANKMENT
- ③ ITEM 204 - SUBGRADE COMPACTION
- ④ ITEM 301 - 7" ASPHALT CONCRETE BASE, PG64-22
- ⑤ ITEM 304 - 4" AGGREGATE BASE
- ⑥ ITEM 304 - 6" AGGREGATE BASE
- ⑦ ITEM 407 - TACK COAT
- ⑧ ITEM 441 - 3" ASPHALT CONCRETE SURFACE COURSE, TYPE 1, (448), PG64-22
- ⑨ ITEM 608 - 4" CONCRETE WALK
- ⑩ ITEM 659 - SEEDING AND MULCHING, CLASS 1
- ⑪ EXISTING PAVEMENT

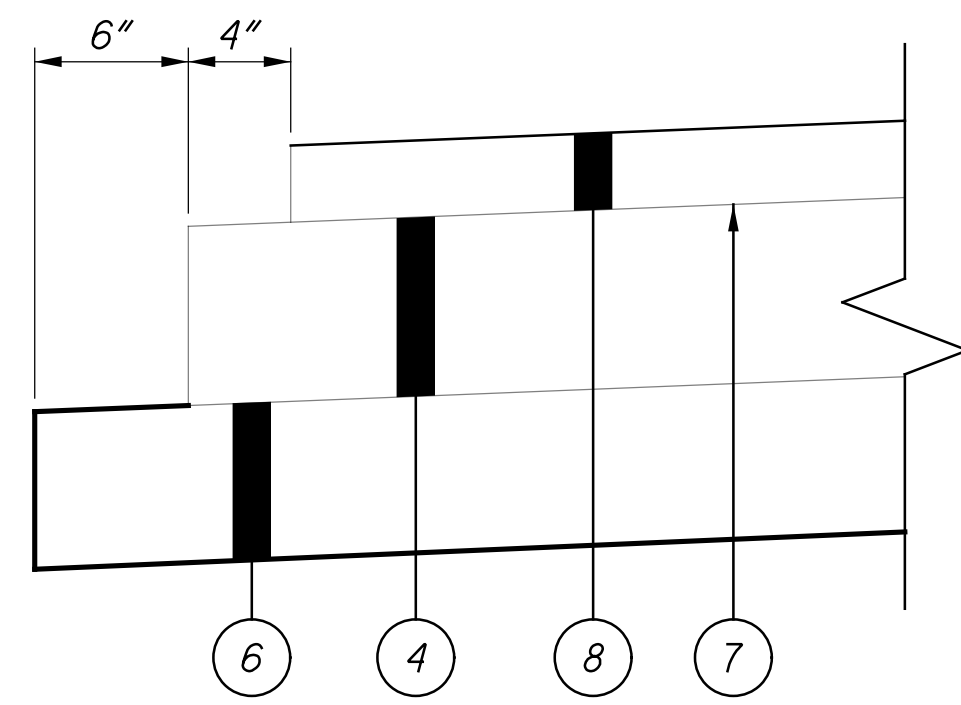

NOTES:

1. ALL EMBANKMENTS SHALL BE CONSTRUCTED PRIOR TO THE REMAINING PROPOSED WORK.
 2. ALL EMBANKMENTS SHALL BE CONSTRUCTED PER ODOT CMS 203.05.
 3. DRAINAGE AND UTILITY ITEMS SHALL BE CONSTRUCTED PRIOR TO THE CONSTRUCTION OF THE PROPOSED SIDEWALK.
 4. ASPHALT AND CONCRETE DRIVEWAYS SHALL BE REPLACED AS PER ODOT SCD BP-4.1 AND AS DESCRIBED BELOW.
 ASPHALT DRIVES SHALL CONSIST OF:
 3 1/2" ITEM 301 - ASPHALT CONCRETE BASE, PG64-22 5 CY
 ITEM 407 - TACK COAT 3 GAL
 1 1/4" ITEM 441 - ASPHALT CONCRETE SURFACE COURSE, TYPE 1, (448), PG64-22 2 CY
 CONCRETE DRIVES SHALL CONSIST OF:
 ITEM 452 - 6" NON-REINFORCED CONCRETE PAVEMENT, CLASS QC 1P 26 SY
- FOR REMOVING THE EXISTING DRIVES, AN AMOUNT OF 69 SY HAS BEEN INCLUDED IN THE ITEM 202 - PAVEMENT REMOVED
- ALL ITEMS ABOVE HAVE BEEN CARRIED TO THE GENERAL SUMMARY SHEET.

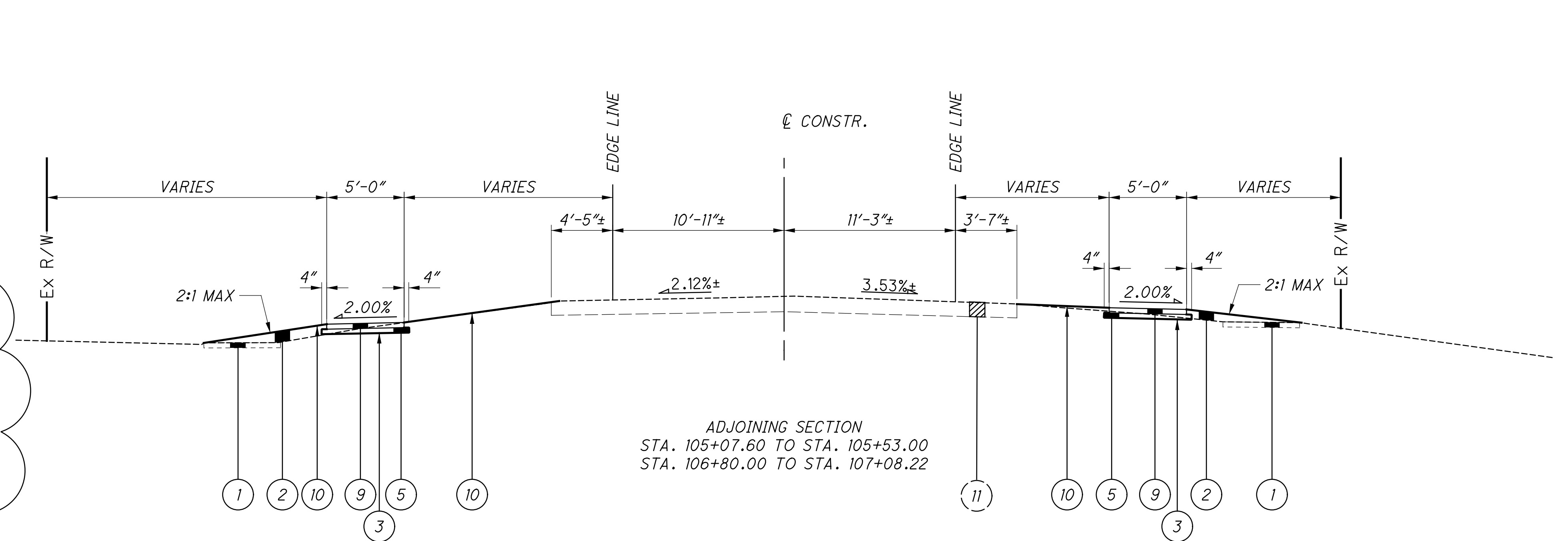
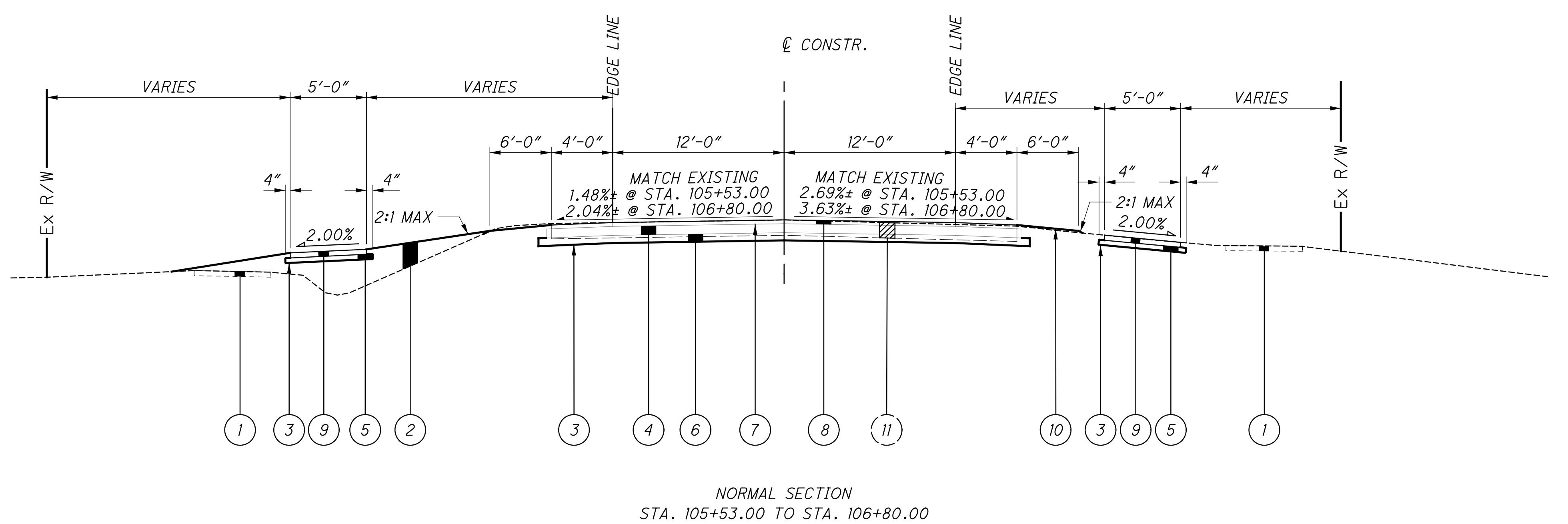
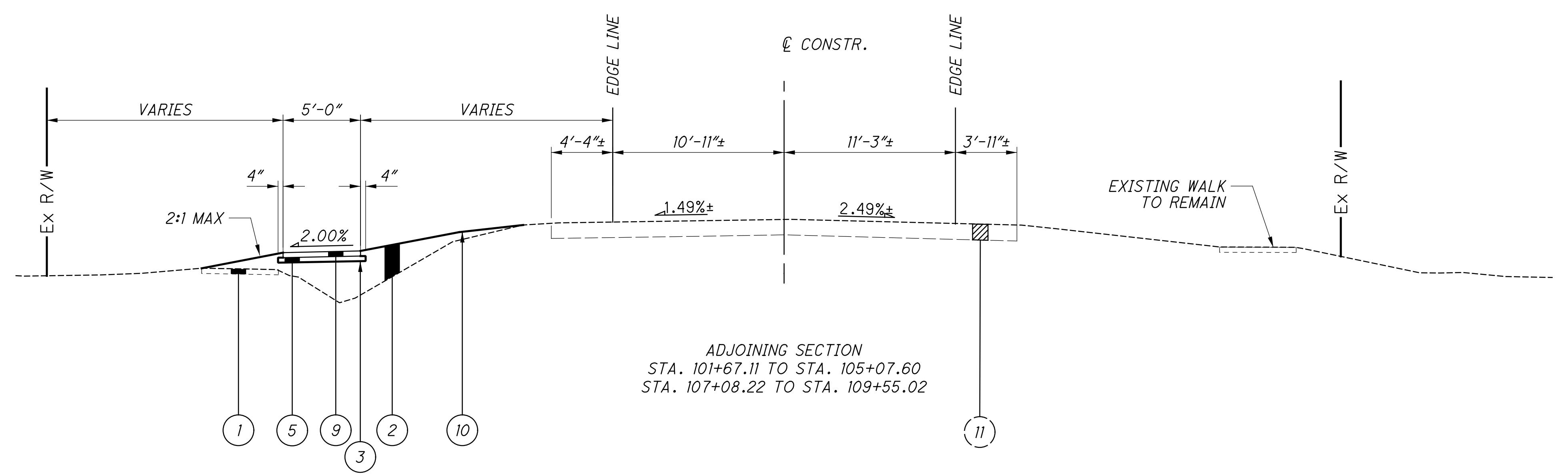

F:\Clients\Active\WHE\007\104780-HEBRON_CULVERT\Design\Roadway\Sheets\104780_GY00.dgn Sheet 1/12/2021 11:51:13 PM brusnell

