

State Job No. 478183

Project No.

PID No. 76665

FED. No. E08(0684)

PLAN PREPARED BY:



STATE OF OHIO
OHIO DEPARTMENT OF TRANSPORTATION
LOG-33-15.78

LOCATION MAP

MAINTENANCE
FOUR-LANE RESURFACING

Project Earth Disturbed Area = 0.43 Acres
Estimated Contractor Earth Disturbed Area = N/A
Notice of Intent Earth Disturbed Area = N/A

2008 SPECIFICATIONS

The Standard 2008 Specifications of the State of Ohio Department of Transportation, including changes and supplemental specifications listed in the plans and the proposal shall govern these improvements.

I hereby approve these plans and declare that the making of this improvement will not require the closing of the highway to traffic and that provisions for the maintenance and safety of traffic will be as set forth in the plans and estimates.

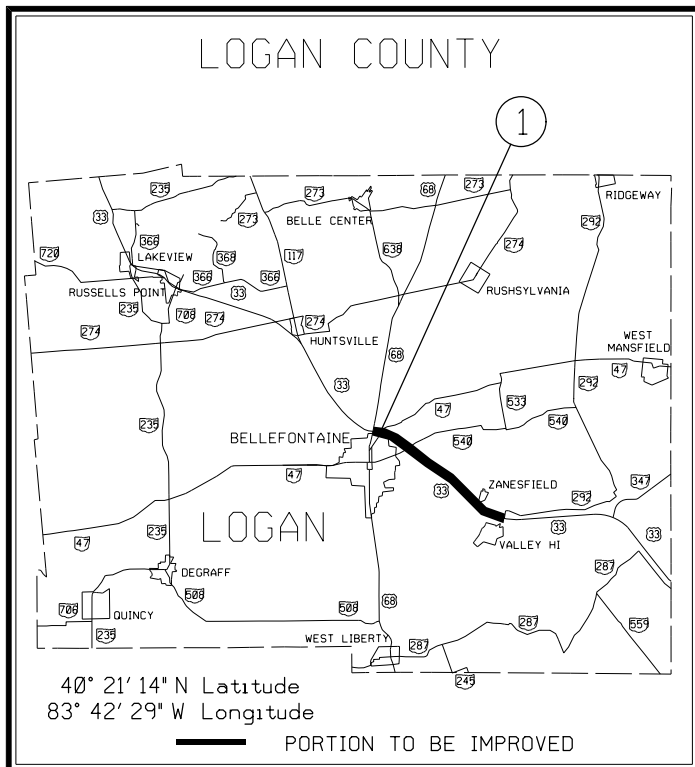

Date Approved

District Deputy Director

Date Approved

Director, Department of Transportation

PROJECT DESCRIPTION: The work proposed by this project consists of pavement planing and resurfacing the existing U. S. Route 33 roadway with Item 442 Asphalt Concrete as set forth in these plans.

① LOG-33-15.78 (U. S. Route 68 to State Route 292)

- 1 - Title Sheet
- 2 thru 4 - Pavement Data
- 5 - Berm Stabilization
- 6 - General Notes
- 7/8/9/10 - Maintenance of Traffic
- 11 & 12 - Bridge Sheets
- 13 - Raised Pavement Markers
- 14 & 15 - General Summary

UNDERGROUND UTILITIES

TWO WORKING DAYS
BEFORE YOU DIG

CALL 1-800-362-2764 (TOLL FREE)
OHIO UTILITIES PROTECTION SERVICE
NON-MEMBERS MUST BE CALLED DIRECTLY

ENGINEER'S SEAL



Signed _____

Date _____

STANDARD DRAWINGS						SUPPLEMENTAL SPECIFICATIONS	
BP-3.1	10-19-07	MT-98.22	10-19-07	TC-41.20	1-19-01		
BP-9.1	4-15-05	MT-98.20	10-19-07	TC-42.20	7-16-04	800	1-16-09
DM-4.3	7-19-02	MT-98.11	10-19-07	TC-52.10	1-19-07		
DM-4.4	7-19-02			TC-52.20	1-19-07	832	4-25-06
MT-35.10	4-20-01	MT-99.20	1-16-09	TC-65.10	1-21-05		
MT-95.30	9-5-06	MT-101.90	1-16-09	TC-65.11	1-21-05	842	1-19-07
MT-97.10	9-5-06	MT-105.10	1-16-09	TC-71.10	1-16-09		
MT-97.12	9-5-06			TC-72.20	1-21-05		