

US 20A AND SR 295 ROUNDABOUT - PROPOSED SECTION

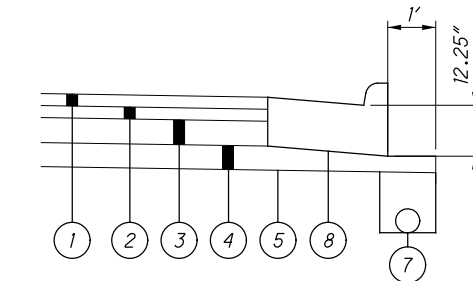

EDGE DETAIL

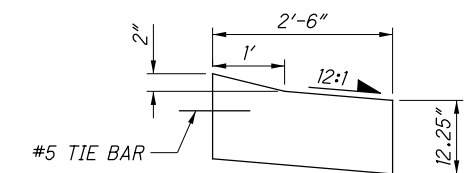

COMBINATION CURB AND GUTTER, TYPE 3, AS PER PLAN

NOTE: CONSTRUCTION MATERIALS AND METHODS SHALL BE IN ACCORDANCE WITH ODOT SECTION 609 AND BP-5.1. #5 TIE BAR SHALL BE USED TO CONNECT CURB AND GUTTER TO TRUCK APRON IN ACCORDANCE WITH BP-2.1.

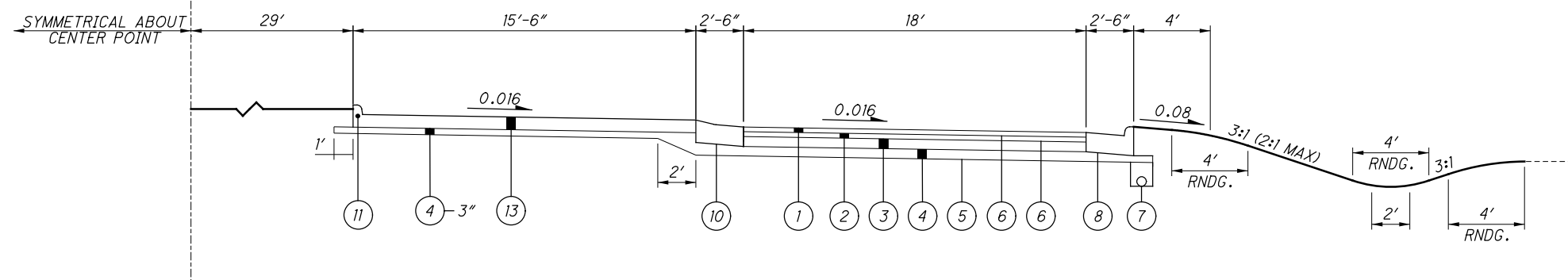

US 20A AND WHITEHOUSE-SPENCER ROUNDABOUT - PROPOSED SECTION

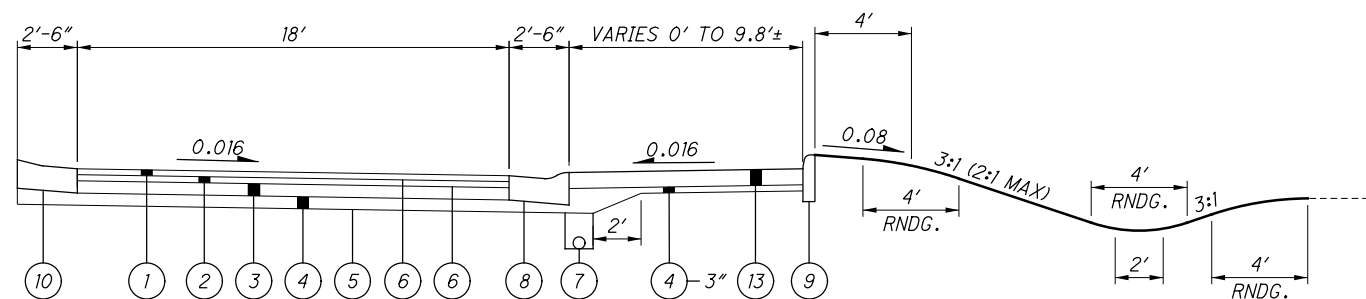

US 20A AND WHITEHOUSE-SPENCER ROUNDABOUT - PROPOSED TRUCK APRON SECTION

LEGEND

- ① ITEM 442 - 1 1/2" ASPHALT CONCRETE SURFACE COURSE, 12.5MM, TYPE A (446), AS PER PLAN, PG76-22M
- ② ITEM 442 - 1 3/4" ASPHALT CONCRETE INTERMEDIATE COURSE, 19MM, TYPE A (446), AS PER PLAN, PG76-22M
- ③ ITEM 301 - 9" ASPHALT CONCRETE BASE, PG64-22
- ④ ITEM 304 - 6" AGGREGATE BASE (UNLESS SHOWN OTHERWISE)
- ⑤ ITEM 204 - SUBGRADE COMPACTION
- ⑥ ITEM 407 - TACK COAT (0.055 GAL/SQ YD)
- ⑦ ITEM 605 - 6" BASE PIPE UNDERDRAINS
- ⑧ ITEM 609 - CURB AND GUTTER, TYPE 2, AS PER PLAN
- ⑨ ITEM 609 - CURB, TYPE 6
- ⑩ ITEM 609 - COMBINATION CURB AND GUTTER, TYPE 3, AS PER PLAN
- ⑪ ITEM 609 - CURB, TYPE 2A
- ⑫ ITEM 609 - 6" CONCRETE TRAFFIC ISLAND, AS PER PLAN, SPLITTER ISLAND
- ⑬ ITEM 609 - 8" CONCRETE TRAFFIC ISLAND, AS PER PLAN, TRUCK APRON
- ⑭ ITEM 452 - 11" NON-REINFORCED CONCRETE PAVEMENT, CLASS QC1

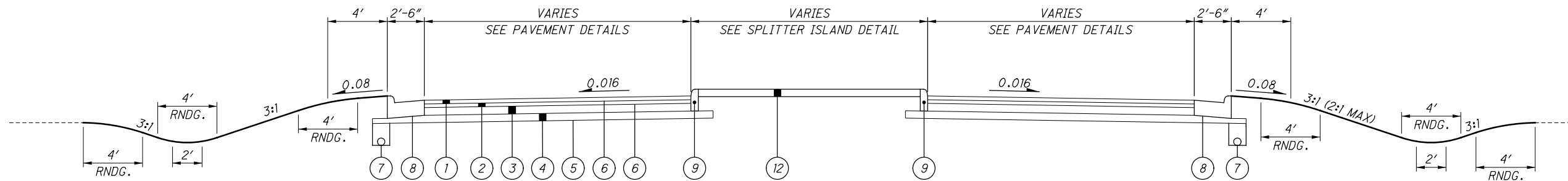

SPLITTER ISLAND - PROPOSED SECTION

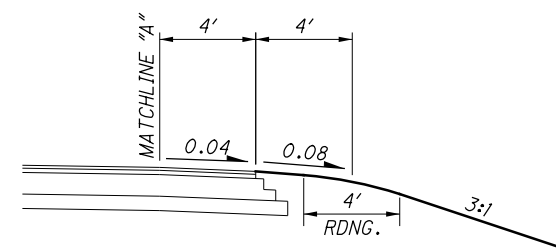

UNCURBED DETAIL

STA. 183+12.50 TO STA. 184+59.00
 STA. 188+90.00 TO STA. 194+60.79
 STA. 509+68.00 TO STA. 510+60.00
 STA. 235+91.04 TO STA. 237+25.00
 STA. 242+07.50 TO STA. 243+19.88
 STA. 28+00.00 TO STA. 29+03.00
 STA. 32+26.50 TO STA. 33+43.26

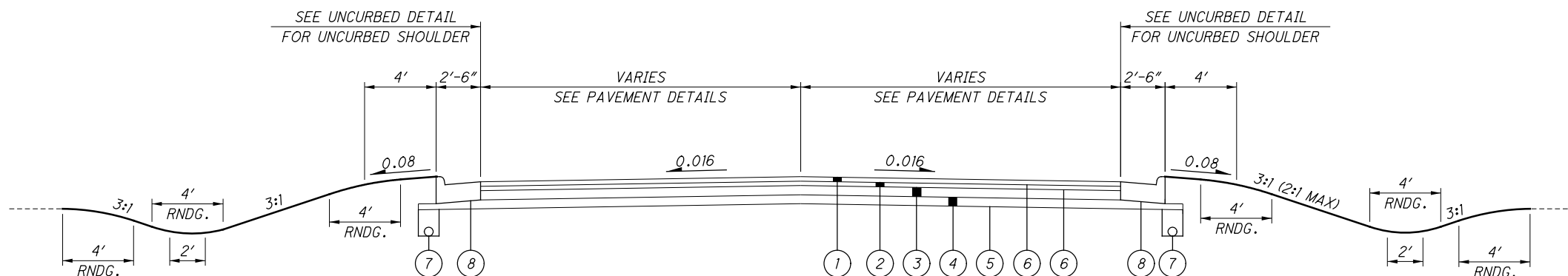

ROUNABOUT ENTRY & EXIT - PROPOSED SECTION

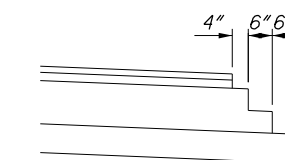

UNCURBED EDGE DETAIL

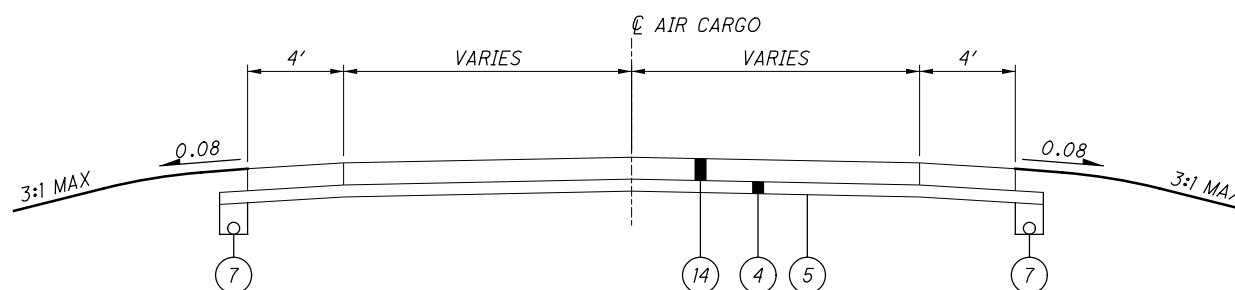

AIR CARGO - PROPOSED SECTION

SEE SHEET 8 FOR LEGEND

ROADWAY															
SHEET NUMBER	REFERENCE NUMBER	STATION		SIDE LT OR RT	202			606			609				
		FROM	TO		FENCE REMOVED	GUARDRAIL, TYPE MSG	ANCHOR ASSEMBLY, TYPE T	ANCHOR ASSEMBLY, TYPE E	CURB AND GUTTER TYPE 2, AS PER PLAN	CURB TYPE 6	CURB AND GUTTER TYPE 3, AS PER PLAN	CURB TYPE 2A	CURB, TYPE 3-A	6" CONCRETE TRAFFIC ISLAND, AS PER PLAN, SPLITTER ISLAND	8" CONCRETE TRAFFIC ISLAND, AS PER PLAN, TRUCK APRON
					FT	FT	EACH	EACH	FT	FT	FT	FT		SY	SY
23	C-1	184+52.52	186+82.86	LT					404.26						
23	C-2	184+59.38	186+82.59	RT					384.78						
23	F-1	184+71.55	186+47.06	LT	175										
24	F-1	512+55.78	515+23.23	LT	268										
24	C-1	185+80.33	186+42.17	LT						165.58					
24	C-2	185+80.33	186+42.17	LT									123.21		
24	C-3	186+77.32	187+55.67	LT								245			
24	C-4	186+59.32	187+73.67	LT							358				
24	C-5	186+61.82	187+71.17	LT											505.89
24	C-6	187+02.26	187+37.43	LT						157					
24	C-7	187+02.26	187+37.43	LT										119.44	
24	C-8	187+10.53	190+17.61	LT					491.54						
24	C-9	187+82.59	191+24.96	LT						718.45					
24	C-10	187+82.59	191+24.96	LT										515.97	
24	C-11	187+11.17	189+90.18	RT					261.70						
24	C-12	186+87.20	187+14.45	RT						113.45					
24	C-13	186+87.20	187+14.45	RT										64.08	
42	C-1	237+18.56	239+73.65	LT					361.58						
42	C-2	237+25.46	239+70.85	RT					323.95						
42	C-3	238+63.47	239+02.74	LT						105.96					
42	C-4	238+63.47	239+02.74	LT										56.00	
42	C-5	239+21.33	240+15.92	LT							295				
42	C-6	239+39.33	239+97.92	LT								182			
42	C-7	239+23.83	239+97.92	LT											397.67
42	C-8	239+72.78	239+97.76	LT						104.43					
42	C-9	239+72.78	239+97.76	LT										54.57	
42	C-10	240+08.84	242+70.27	LT					407.28						
42	C-11	240+29.97	240+64.07	LT						95.24					
42	C-12	240+29.97	240+64.07	LT										46.50	
42	C-13	239+95.06	242+07.46	RT					161.48		133				
42	C-14	239+63.17	239+82.29	RT						81.34					
42	C-15	239+63.17	239+82.29	RT										35.24	
42	C-16	29+40.00	240+84.40	RT						124.39					49.44
42	G-1	241+47.70	242+60.30	LT		112.50	1	1							
52	C-1	209+07.92	209+38.22	LT									82.56	40.22	
SR 295 & AIR CARGO (01/NHS/PV)					443	0	0	0	1542	1155	358	245	83	863	506
WHITEHOUSE-SPENCER (02/S>2/PV)					0	112.50	1	1	1254	511	429	182	0	192	447
TOTALS CARRIED TO GENERAL SUMMARY					443	112.50	1	1	2796	1666	787	427	83	1055	953

CALCULATED
ADC
CHECKED
ALZ

SUBSUMMARY

LUC-20A - 3.47 / 4.47

LOCATION	PAVEMENT																	
	AREA BY CAD					202	204	301	304	304	305	407	442	442	442	452	609	609
	SURFACE & INTERMEDIATE	AGGREGATE BASE	9" BASE	9" BASE 1ST LIFT (SHOULDER)	9" BASE 2ND LIFT (SHOULDER)	PAVEMENT REMOVED	SUBGRADE COMPACTION	9" ASPHALT CONCRETE BASE, PG64-22	3" AGGREGATE BASE	6" AGGREGATE BASE	8" AGGREGATE BASE	TACK COAT (0.055 gal/sqyd)	1 - 1/2" ASPHALT CONC SURFACE COURSE, TYPE 1, PG70-22	2" ASPHALT CONC SURFACE COURSE, TYPE 1, PG70-22	1-3/4" ASPHALT CONCRETE INTERMEDIATE COURSE, TYPE 2, PG64-22	11" NON-REINFORCED CONCRETE PAVEMENT, CLASS OCl	6" CONCRETE TRAFFIC ISLAND	8" CONCRETE TRAFFIC ISLAND
SF	SF	SF	SF	SF	SY	SY	CY	CY	CY	CY	GAL	CY	CY	CY	SY	SY	SY	
US20A and SR 295	61836	70186	55,746.15	7,439.46	6,656.79	5,637.11	7,798.44	1,744.29		1,299.74		755.78	286.28		333.99			
CENTER TRUCK APRON	4553	5671					630.11		52.51									505.89
SPLITTER ISLANDS	7402	7402					822.44										822.44	
AIRCARGO ROAD ISLAND	6489	7194				773.56	799.33			133.22					721.00			
	362	362					40.22										40.22	
DRIVE STA. 510+79.9	300	300					33.33			5.56				1.85				
DRIVE STA. 515+99.5	3125	3125					347.22				77.16							
DRIVE STA. 515+30.3	532	532					59.11				13.14							
US20A AND WHITEHOUSE SPENCER ROAD	40725	46887	37,418.02	4,072.15	3,609.02	4,087.67	5,278.67	1,146.07		868.28		497.76	188.54		219.97			
CENTER TRUCK APRON	3579	4477					497.44		41.45									397.67
SOUTHEAST TRUCK APRON	445	621					69.00		5.75									49.44
SPLITTER ISLANDS	1730	1730					192.22										192.22	
SR 295 & AIR CARGO (01/NHS/PV)						6,411	10,530	1,744	53	1,439	90	756	286	2	334	721	863	506
WHITEHOUSE-SPENCER (02/S>2/PV)						4,088	6,037	1,146	47	868	0	498	189	0	220	0	192	447
SUBTOTAL																		
TOTAL						10,499	16,567	2,890		2,497		1,254	477	554	721	1,055	953	

CALCULATED
ADC
CHECKED
ALZ

SUBSUMMARY