

MATCH LINE STA. 12+00

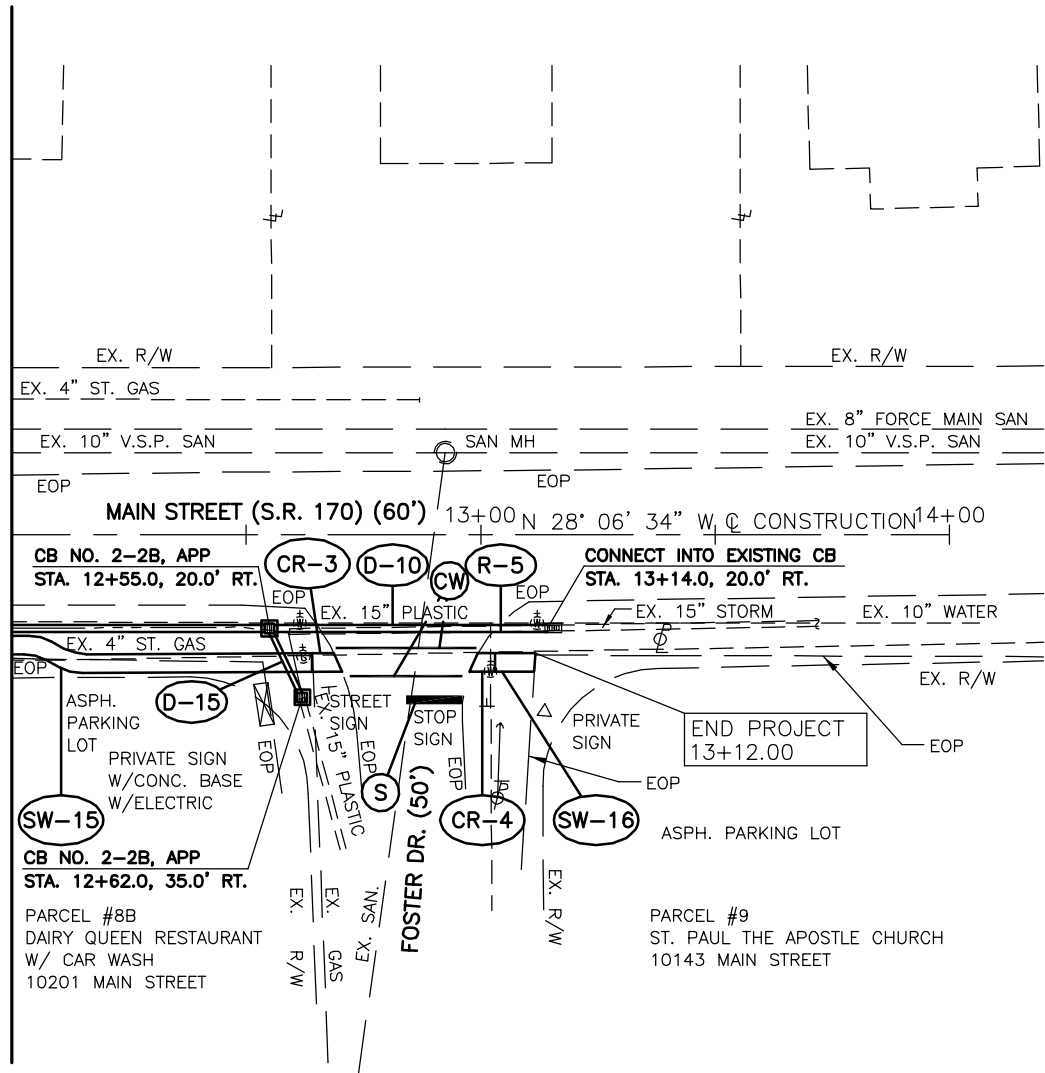

BM ELEV. 1203.61
ARROW ON FIRE HYDRANT,
NORTH SIDE OF FOSTER AVENUE
AT JEFFREY LANE

- (CW) ITEM 642 - CROSSWALK LINE, TYPE 1
- (S) ITEM 642 - STOP LINE, TYPE 1

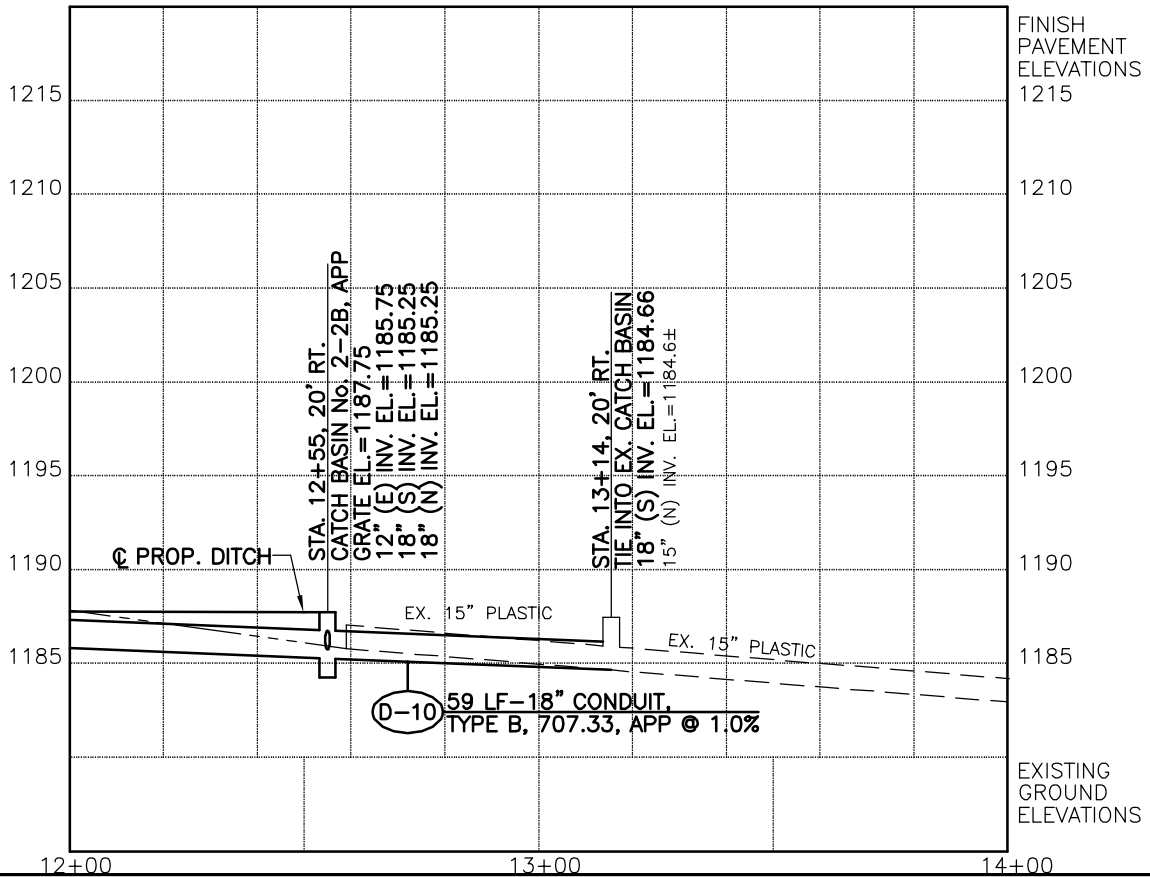

NOTE:
FOR ADDITIONAL QUANTITIES RELATING TO THE SIDEWALK
INSTALLATION SW-15, SEE SHEET No. 22.

REF NO.	STATION		SIDE	ITEM	UNIT	QUANTITY	CALCULATED	CHECKED
	FROM	TO						
SW-15	12+00	12+71	RT	202	PIPE REMOVED, 24" AND UNDER	FT		
SW-16	12+98	13+12	RT	603	12" CONDUIT, TYPE C, 707.33, A.P.P.	FT		
CR-3	12+64	12+70.5	RT	603	18" CONDUIT, TYPE B, 707.33, A.P.P.	FT		
CR-4	12+97.5	13+04	RT	603	18" CONDUIT, TYPE B, 707.33, A.P.P.	FT		
D-10	12+55	13+14	RT	604	CATCH BASIN, No. 2-2B, A.P.P.	EACH	1	
D-15	12+55	12+62	RT	604	CATCH BASIN, RECONSTRUCTED, AS PER PLAN	EACH	1	
R-5	12+55	13+14	RT	604	CATCH BASIN, RECONSTRUCTED, AS PER PLAN	EACH	1	
TOTALS CARRIED TO GENERAL SUMMARY				603		FT	59	
				603	12" CONDUIT, TYPE C, 707.33, A.P.P.	FT	16	
				604	CATCH BASIN, No. 2-2B, A.P.P.	EACH	2	
				604	CATCH BASIN, RECONSTRUCTED, AS PER PLAN	EACH	1	
				608	4" CONCRETE WALK	SQ FT	56	
				608	8" CONCRETE WALK, A.P.P.	SQ FT	284	
				608	CURB RAMP, DESIGN C, A.P.P.	EACH	2	
				642	CROSS-WALK LINE, TYPE 1	FT	54	
				642	STOP LINE, TYPE 1	FT	12	

PLAN AND PROFILE
STA. 12+00 TO STA. 14+00

MAH-170-5.22

