

S:\COO\3500--3599\3599\013\Micros\10156\roadway\sheets\101560_MN001.dgn 2/6/2020 6:17:42 AM jamesh

ITEM 614, MAINTAINING TRAFFIC, AS PER PLAN

TRAFFIC WILL BE MAINTAINED FOR THE DURATION OF THE PROJECT AS SHOWN IN THE PLAN DETAILS.

MAR-23-1150: US 23 OVER CSX RAILROAD AND CR 175
A MINIMUM OF 1 LANE OF TRAFFIC IN EACH DIRECTION SHALL BE MAINTAINED AT ALL TIMES ALONG US 23 BY USE OF THE EXISTING PAVEMENT.

MAR-23-1494: US 23 OVER NORFOLK SOUTHERN RAILROAD
A MINIMUM OF 1 LANE OF TRAFFIC IN EACH DIRECTION SHALL BE MAINTAINED AT ALL TIMES ALONG US 23 BY USE OF THE EXISTING PAVEMENT.

MAR-231-0342: SR 231 OVER US 23
A MINIMUM OF 1 LANE OF TRAFFIC SHALL BE MAINTAINED AT ALL TIMES ALONG SR 231 BY USE OF THE EXISTING PAVEMENT.

LENGTH AND DURATION OF LANE CLOSURES AND RESTRICTIONS SHALL BE AT THE APPROVAL OF THE ENGINEER. IT IS THE INTENT TO MINIMIZE THE IMPACT TO THE TRAVELING PUBLIC. LANE CLOSURES OR RESTRICTIONS OVER SEGMENTS OF THE PROJECT IN WHICH NO WORK IS ANTICIPATED WITHIN A REASONABLE TIME FRAME, AS DETERMINED BY THE ENGINEER, SHALL NOT BE PERMITTED. THE LEVEL OF UTILIZATION OF MAINTENANCE OF TRAFFIC DEVICES SHALL BE COMMENSURATE WITH THE WORK IN PROGRESS.

ALL WORK AND TRAFFIC CONTROL DEVICES SHALL BE IN ACCORDANCE WITH C&MS 614 AND OTHER APPLICABLE PORTIONS OF THE SPECIFICATIONS, AS WELL AS THE OHIO MANUAL OF UNIFORM TRAFFIC CONTROL DEVICES. PAYMENT FOR ALL LABOR, EQUIPMENT AND MATERIALS SHALL BE INCLUDED IN THE LUMP SUM CONTRACT PRICE FOR ITEM 614, MAINTAINING TRAFFIC, UNLESS SEPARATELY ITEMIZED IN THE PLAN.

HOLIDAYS

NO WORK SHALL BE PERFORMED AND ALL EXISTING LANES SHALL BE OPEN TO TRAFFIC DURING THE FOLLOWING DESIGNATED HOLIDAYS OR EVENTS:

CHRISTMAS	FOURTH OF JULY
NEW YEARS	LABOR DAY
MEMORIAL DAY	THANKSGIVING
	(OTHER HOLIDAY OR EVENT)

THE PERIOD OF TIME THAT THE LANES ARE TO BE OPEN DEPENDS UPON THE DAY OF THE WEEK ON WHICH THE HOLIDAY OR EVENT FALLS. THE FOLLOWING SCHEDULE SHALL BE USED TO DETERMINE THE PERIOD:

DAY OF THE WEEK - TIME ALL LANES MUST BE OPEN TO TRAFFIC

SUNDAY -	12:00N FRIDAY THROUGH 6:00 AM MONDAY
MONDAY -	12:00N FRIDAY THROUGH 6:00 AM TUESDAY
TUESDAY -	12:00N MONDAY THROUGH 6:00 AM WEDNESDAY
WEDNESDAY -	12:00N TUESDAY THROUGH 6:00 AM THURSDAY
THURSDAY -	12:00N WEDNESDAY THROUGH 6:00 AM FRIDAY
FRIDAY -	6:00 AM WEDNESDAY THROUGH 6:00 AM MONDAY
SATURDAY -	12:00N THURSDAY THROUGH 6:00 AM MONDAY

SHOULD THE CONTRACTOR FAIL TO MEET ANY OF THE REQUIREMENTS, THE CONTRACTOR SHALL BE ASSESSED A DISINCENTIVE IN THE AMOUNT OF \$50 FOR EACH MINUTE THE ABOVE DESCRIBED LANE CLOSURE RESTRICTIONS ARE VIOLATED.

FOR THE MAR-23-1494 L/R BRIDGES, THE REQUIREMENT WILL BE WAIVED TO HAVE ALL EXISTING LANES OPEN TO TRAFFIC DURING THE DESIGNATED HOLIDAYS AND SPECIAL EVENTS; HOWEVER, THE NO WORK REQUIREMENT WOULD STILL APPLY.

SPECIAL EVENTS

MARION POPCORN FESTIVAL - LANE OR SHOULDER CLOSURES ARE NOT PERMITTED ANY TIME DURING THE WEEK OF THE MARION POPCORN FESTIVAL

MARION COUNTY FAIR - LANE OR SHOULDER CLOSURES ARE NOT PERMITTED ANY TIME DURING THE WEEK OF THE MARION COUNTY FAIR

NOTIFICATION OF CONSTRUCTION INITIATION

AT LEAST FOURTEEN DAYS PRIOR TO STARTING INITIAL CONSTRUCTION ACTIVITIES, THE CONTRACTOR SHALL ADVISE THE DISTRICT OFFICE OF COMMUNICATIONS VIA EMAIL AT DO6.PIO@DOT.OHIO.GOV, THE DISTRICT WORK ZONE TRAFFIC MANAGER VIA EMAIL AT DO6.MOT@DOT.OHIO.GOV AND THE CENTRAL OFFICE SPECIAL HAUL PERMITS SECTION BY FAX AT (614)728-4099 OF THE ANTICIPATED START DATE OF ANY CONSTRUCTION ACTIVITIES INCLUDING BUT NOT LIMITED TO THE PLACING OF WORK ZONE SIGNS. THE NOTIFICATION SHALL ALSO INCLUDE THE PROJECT NUMBER, PID, NAME AND PHONE NUMBER OF THE CONTRACTOR, A POINT OF CONTACT AND THE ANTICIPATED IMPACT ON TRAFFIC. THE CONTRACTOR WILL IMMEDIATELY INFORM THE DISTRICT OFFICE OF COMMUNICATIONS AND THE DISTRICT WORK ZONE TRAFFIC MANAGER OF ANY AND ALL DELAYS AND/OR CHANGES REGARDING THE CONSTRUCTION INITIATION DATE.

NOTIFICATION OF TRAFFIC RESTRICTIONS

THROUGHOUT THE DURATION OF THE PROJECT, THE CONTRACTOR SHALL NOTIFY THE PROJECT ENGINEER IN WRITING OF ALL TRAFFIC RESTRICTIONS AND UPCOMING MAINTENANCE OF TRAFFIC CHANGES. THE CONTRACTOR SHALL ENSURE THE WRITTEN NOTIFICATION IS SUBMITTED IN A TIMELY MANNER TO ALLOW THE PROJECT ENGINEER TO MEET THE REQUIRED TIME FRAMES SET FORTH IN THE TABLE BELOW TO INFORM THE OFFICE OF COMMUNICATIONS. THIS NOTIFICATION SHALL BE RECEIVED BY THE PROJECT ENGINEER PRIOR TO THE PHYSICAL SETUP OF ANY APPLICABLE SIGNS OR MESSAGE BOARDS.

INFORMATION SHOULD INCLUDE BUT IS NOT LIMITED TO ALL CONSTRUCTION ACTIVITIES THAT IMPACT OR INTERFERE WITH TRAFFIC AND SHALL LIST THE SPECIFIC LOCATION, TYPE OF WORK, ROAD STATUS, DATE AND TIME OF RESTRICTION, DURATION OF RESTRICTION, NUMBER OF LANES MAINTAINED, NUMBER OF LANES CLOSED, DETOUR ROUTES IF APPLICABLE, AND ANY OTHER INFORMATION REQUESTED BY THE PROJECT ENGINEER.

NOTIFICATION TIME FRAME TABLE			
ITEM	DURATION OF CLOSURE	NOTIFICATION DUE TO DISTRICT 6 COMMUNICATIONS OFFICE	SIGN DISPLAYED TO PUBLIC
RAMP & ROAD CLOSURES	>= 2 WEEKS	21 CALENDAR DAYS PRIOR TO CLOSURE	14 CALENDAR DAYS PRIOR TO CLOSURE
	>12 HOURS & < 2 WEEKS	14 CALENDAR DAYS PRIOR TO CLOSURE	7 CALENDAR DAYS PRIOR TO CLOSURE
	< 12 HOURS	4 BUSINESS DAYS PRIOR TO CLOSURE	2 BUSINESS DAYS PRIOR TO CLOSURE
LANE CLOSURES & RESTRICTIONS	>= 2 WEEKS	14 CALENDAR DAYS PRIOR TO CLOSURE	
	< 2 WEEKS	2 BUSINESS DAYS PRIOR TO CLOSURE	
START OF CONSTRUCTION & TRAFFIC PATTERN CHANGES	N/A	14 CALENDAR DAYS PRIOR TO IMPLEMENTATION	

ANY UNFORESEEN CONDITIONS NOT SPECIFIED IN THE PLANS REQUIRING TRAFFIC RESTRICTIONS SHALL ALSO BE REPORTED TO THE PROJECT ENGINEER USING THE NOTIFICATION TIME FRAME TABLE.

SEQUENCE OF CONSTRUCTION

MAR-1150 STRUCTURE

PHASE 1
PHASE 1 CONSISTS OF MAINTAINING THE OUTSIDE LANES OF TRAFFIC WHILE THE INSIDE LANE CONCRETE PARAPETS ARE REMOVED AND REPLACED AT BOTH THE NORTHBOUND AND SOUTHBOUND 1150 STRUCTURE.

STEP (A)
REMOVE EXISTING PAVEMENT MARKINGS AND INSTALL WORK ZONE DOTTED LINES, TEMPORARY EDGE LINES, BARRELS, AND PORTABLE CONCRETE BARRIER AS SHOWN IN THE MAINTENANCE OF TRAFFIC PLAN AND APPLICABLE ODOT STANDARD CONSTRUCTION DRAWINGS.

STEP (B)
SHOULDER OVERLAYS AND FULL-DEPTH REPLACEMENTS WILL ALSO BE PERFORMED ON THE INSIDE SHOULDERS AT THE SPECIFIED LOCATIONS:

603+24 TO 605+42 (1150 L STRUCTURE)
608+26 TO 610+44 (1150 R STRUCTURE)
608+26 TO 610+44 (1150 L STRUCTURE)
603+24 TO 605+42 (1150 R STRUCTURE)

PHASE 2

PHASE 2 CONSISTS OF MAINTAINING THE INSIDE LANES OF TRAFFIC WHILE WORK IS PERFORMED ON THE OUTSIDE LANES OF U.S. 23 NORTHBOUND AND SOUTHBOUND AT STRUCTURE 1150.

STEP (A)
REMOVE PHASE 1 AND ADDITIONAL EXISTING PAVEMENT MARKINGS.

INSTALL PHASE 2 WORK ZONE DOTTED LINES, TEMPORARY EDGE LINES, BARRELS, AND PORTABLE CONCRETE BARRIER AS SHOWN IN THE MAINTENANCE OF TRAFFIC PLAN AND APPLICABLE ODOT STANDARD CONSTRUCTION DRAWINGS.

THE EXISTING 65 MPH SPEED ZONE ON U.S. 23 WILL BE REDUCED TO A VARIABLE SPEED LIMIT UPON THE START OF THIS PHASE. CONTRACTOR SHALL FURNISH, ERECT, REMOVE, AND MAINTAIN THE NECESSARY WORK ZONE SPEED LIMIT SIGNS.

STEP (B)
PERFORM SHOULDER OVERLAYS AND FULL-DEPTH REPLACEMENTS ON THE OUTSIDE SHOULDERS AT THE SPECIFIED LOCATIONS:

602+72 TO 605+17 (1150 L STRUCTURE)
608+51 TO 610+96 (1150 L STRUCTURE)
608+51 TO 610+96 (1150 R STRUCTURE)

STEP (C)
CONTINUE TO MAINTAIN TRAFFIC ON THE INSIDE LANES OF U.S. 23 NORTHBOUND AND SOUTHBOUND AND CONSTRUCT THE OUTSIDE LANES OF THE NEW STRUCTURE.

STEP (D)
REMOVE EXISTING GUARDRAIL AND GUARDRAIL END TREATMENTS AND INSTALL NEW GUARDRAIL AND GUARDRAIL END TREATMENTS PER THE PLANS.

PHASE 2 SHALL BE COMPLETED TO THE SATISFACTION OF THE ENGINEER PRIOR TO THE START OF ANY WORK ON PHASE 3.

PHASE 3

PHASE 3 CONSISTS OF MAINTAINING THE OUTSIDE LANES OF TRAFFIC ON THE NEWLY COMPLETED STRUCTURES AND PAVEMENT BUILD-UP WHILE WORK IS PERFORMED ON THE INSIDE LANES OF U.S. 23 NORTHBOUND AND SOUTHBOUND AT STRUCTURE 1150.

STEP (A)
REMOVE PHASE 2 WORK ZONE DOTTED LINES, TEMPORARY EDGE LINES, BARRELS, AND PORTABLE CONCRETE BARRIERS.

INSTALL PHASE 3 WORK ZONE DOTTED LINES, TEMPORARY EDGE LINES, BARRELS, AND PORTABLE CONCRETE BARRIER AS SHOWN IN THE MAINTENANCE OF TRAFFIC PLAN AND APPLICABLE ODOT STANDARD CONSTRUCTION DRAWINGS.

STEP (B)
CONTINUE TO MAINTAIN TRAFFIC ON THE OUTSIDE LANES OF U.S. 23 NORTHBOUND AND SOUTHBOUND AND CONSTRUCT THE INSIDE LANES OF THE NEW STRUCTURE.

STEP (C)
REMOVE EXISTING GUARDRAIL AND GUARDRAIL END TREATMENTS AND INSTALL NEW GUARDRAIL AND GUARDRAIL END TREATMENTS PER THE PLANS.

PHASE 3 SHALL BE COMPLETED TO THE SATISFACTION OF THE ENGINEER PRIOR TO RESTORING TRAFFIC TO ITS ORIGINAL PATTERN.

MAR-1494 STRUCTURE

PHASE 1A

PHASE 1A CONSISTS OF MAINTAINING THE OUTSIDE LANES OF TRAFFIC WHILE SHOULDER OVERLAYS AND FULL-DEPTH REPLACEMENTS ARE PERFORMED ON THE INSIDE (MEDIAN) SHOULDERS AT THE SPECIFIED LOCATIONS:

784+06 TO 785+75 (1494 L STRUCTURE)
784+48 TO 786+13 (1494 R STRUCTURE)
787+37 TO 789+02 (1494 L STRUCTURE)
787+77 TO 789+42 (1494 R STRUCTURE)

PHASE 1B

PHASE 1B CONSISTS OF MAINTAINING THE INSIDE LANES OF TRAFFIC WHILE WORK IS PERFORMED ON THE OUTSIDE LANES OF U.S. 23 NORTHBOUND AND SOUTHBOUND AT STRUCTURE 1494.

STEP (A)
REMOVE EXISTING PAVEMENT MARKINGS AND INSTALL WORK ZONE DOTTED LINES, TEMPORARY EDGE LINES, BARRELS, AND PORTABLE CONCRETE BARRIER AS SHOWN IN THE MAINTENANCE OF TRAFFIC PLAN AND APPLICABLE ODOT STANDARD CONSTRUCTION DRAWINGS.

STEP (B)
SHOULDER OVERLAYS AND FULL-DEPTH REPLACEMENTS WILL ALSO BE PERFORMED ON THE INSIDE SHOULDERS AT THE SPECIFIED LOCATIONS:

780+21 TO 785+46 (1494 L STRUCTURE)
780+63 TO 785+88 (1494 R STRUCTURE)
787+62 TO 792+87 (1494 L STRUCTURE)
788+02 TO 793+27 (1494 R STRUCTURE)

STEP (C)
CONTINUE TO MAINTAIN TRAFFIC ON THE INSIDE LANES OF U.S. 23 NORTHBOUND AND SOUTHBOUND AND CONSTRUCT THE OUTSIDE LANES OF THE NEW STRUCTURE.

STEP (D)
REMOVE EXISTING GUARDRAIL AND GUARDRAIL END TREATMENTS AND INSTALL NEW GUARDRAIL AND GUARDRAIL END TREATMENTS PER THE PLANS.

PHASE 1B SHALL BE COMPLETED TO THE SATISFACTION OF THE ENGINEER PRIOR TO THE START OF ANY WORK ON PHASE 2.

PHASE 2

PHASE 2 CONSISTS OF MAINTAINING TRAFFIC ON THE OUTSIDE LANES OF TRAFFIC WHILE WORK IS PERFORMED ON THE INSIDE LANES OF U.S. 23 NORTHBOUND AND SOUTHBOUND AT STRUCTURE 1494.

CALCULATED
KCS
CHECKED
JDH

MAINTENANCE OF TRAFFIC GENERAL NOTES

MAR-23-11.50

S:\COO\3500--3599\3599\013\Micros\10156\Roadway\sheets\10156_GG001.dgn 2/7/2020 12:56:49 PM jamesh





SHEET NUM.										PART.		ITEM	ITEM EXT	GRAND TOTAL	UNIT	DESCRIPTION	SEE SHEET NO.
31	36	57	62							01/NHS/ BR	02/NHS/ BR						
10										8	2	614	12336	10	EACH	WORK ZONE IMPACT ATTENUATOR (UNIDIRECTIONAL)	
4											4	614	12338	4	EACH	WORK ZONE IMPACT ATTENUATOR (BIDIRECTIONAL)	
											36	614	13310	36	EACH	BARRIER REFLECTOR, TYPE 1, ONE WAY	
										2	2	614	12500	4	EACH	REPLACEMENT SIGN	6
										8	7	614	12600	15	EACH	REPLACEMENT DRUM	6
158										107	51	614	13350	158	EACH	OBJECT MARKER, ONE WAY	
										9	9	614	18600	18	SNMT	PORTABLE CHANGEABLE MESSAGE SIGN	6
6.3										3.82	2.48	614	22000	6.3	MILE	WORK ZONE EDGE LINE, CLASS I, 4"	
8,362										5,330	3,032	614	24000	8,362	FT	WORK ZONE DOTTED LINE, CLASS I	
8,328										5,848	2,480	622	41000	8,328	FT	PORTABLE BARRIER, 32"	
24										24		644	00500	24	FT	STOP LINE, TEMPORARY	
											36	808	18700	36	SNMT	DIGITAL SPEED LIMIT (DSL) SIGN ASSEMBLY	
										1		SPECIAL	61411300	1	EACH	WORK ZONE TRAFFIC SIGNAL	6
			5,400							2,726	2,674	618	40100	5,400	FT	TRAFFIC CONTROL	
			103							59	44	621	00100	103	EACH	RUMBLE STRIPS, SHOULDER (ASPHALT CONCRETE)	
			103							59	44	621	54000	103	EACH	RPM	
			170							102	68	630	02100	170	FT	RAISED PAVEMENT MARKER REMOVED	
			30							18	12	630	81100	30	SF	GROUND MOUNTED SUPPORT, NO. 2 POST	
			10							6	4	630	84900	10	EACH	SIGN ERECTED, FLAT SHEET	
			10							6	4	630	86002	10	EACH	REMOVAL OF GROUND MOUNTED SIGN AND DISPOSAL	
			0.68							0.28	0.4	644	00104	0.68	MILE	REMOVAL OF GROUND MOUNTED POST SUPPORT AND DISPOSAL	
			0.38							0.26	0.12	644	00104	0.38	MILE	EDGE LINE, 6", (WHITE)	
			1.66							0.78	0.88	644	00200	1.66	MILE	EDGE LINE, 6", (YELLOW)	
			0.48							0.4	0.08	646	10010	0.48	MILE	LANE LINE, 4", (WHITE)	
			0.21							0.12	0.09	646	10010	0.21	MILE	EDGE LINE, 6", (WHITE)	
			0.22							0.14	0.08	646	10100	0.22	MILE	EDGE LINE, 6", (YELLOW)	
			0.14							0.14		646	10200	0.14	MILE	LANE LINE, 4", (WHITE)	
										LS	LS	108	10000	LS		INCIDENTALS	
										LS	LS	614	11001	LS		CPM PROGRESS SCHEDULE	
										6	6	619	16010	12	MNTH	MAINTAINING TRAFFIC, AS PER PLAN	5
										LS	LS	623	10000	LS		FIELD OFFICE, TYPE B	
										LS	LS	624	10000	LS		CONSTRUCTION LAYOUT STAKES AND SURVEYING	
																MOBILIZATION	

GENERAL SUMMARY

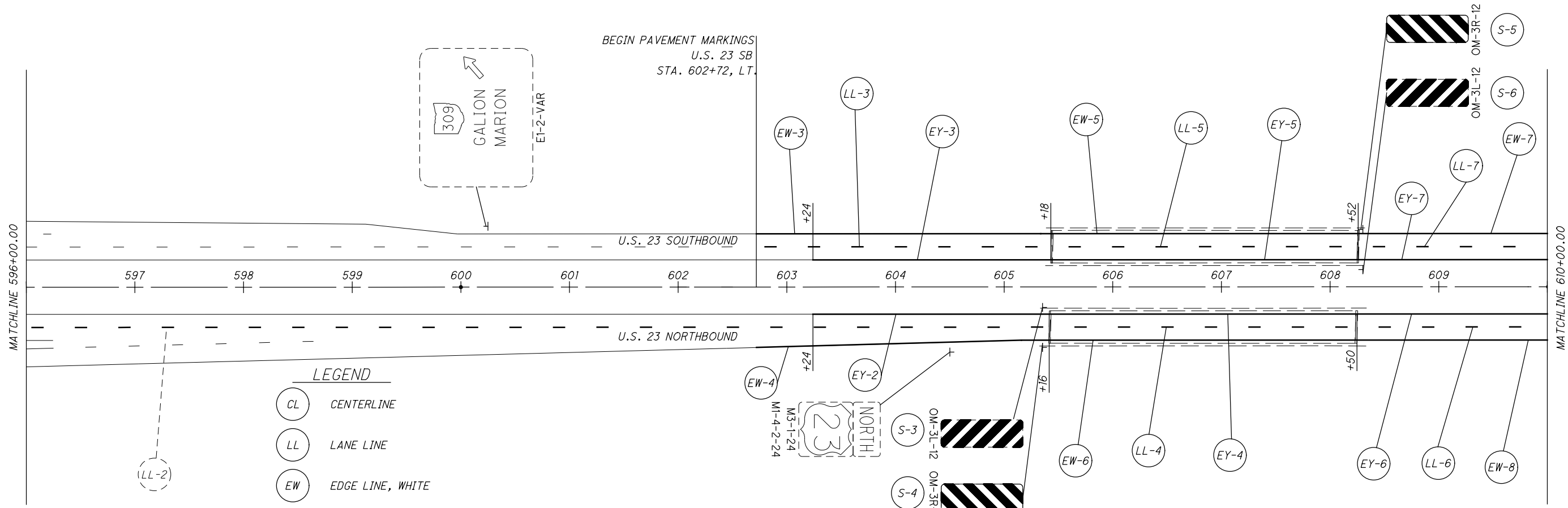
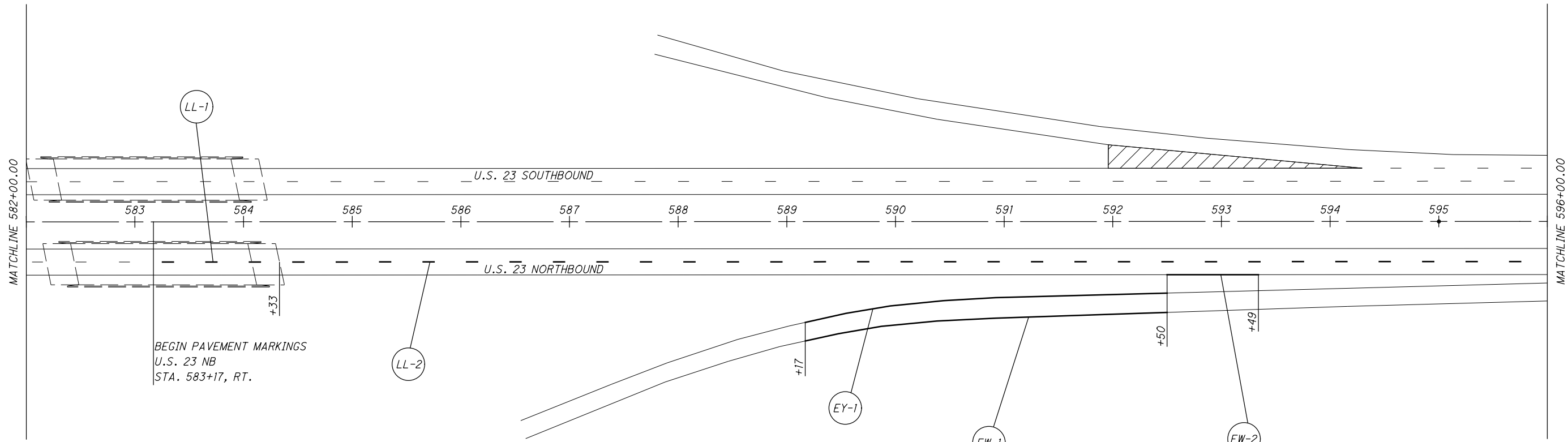
MAR-23-11.50

S:\COO\3500--3599\3599\013\Micros\10156\roadway\sheets\101560_PMO01.dgn 2/6/2020 5:56:04 AM jamesh



- LEGEND**
-  CENTERLINE
 -  LANE LINE
 -  EDGE LINE, WHITE
 -  EDGE LINE, YELLOW

CALCULATED KCS
CHECKED JDH

PAVEMENT MARKING AND SIGNING PLAN
STA. 582+00.00 TO STA. 610+00.00

MAR-23-11.50

S:\COO\3500--3599\3599\013\Roadway\Sheets\101560_PMO02.dgn 2/6/2020 5:54:04 AM jamesh

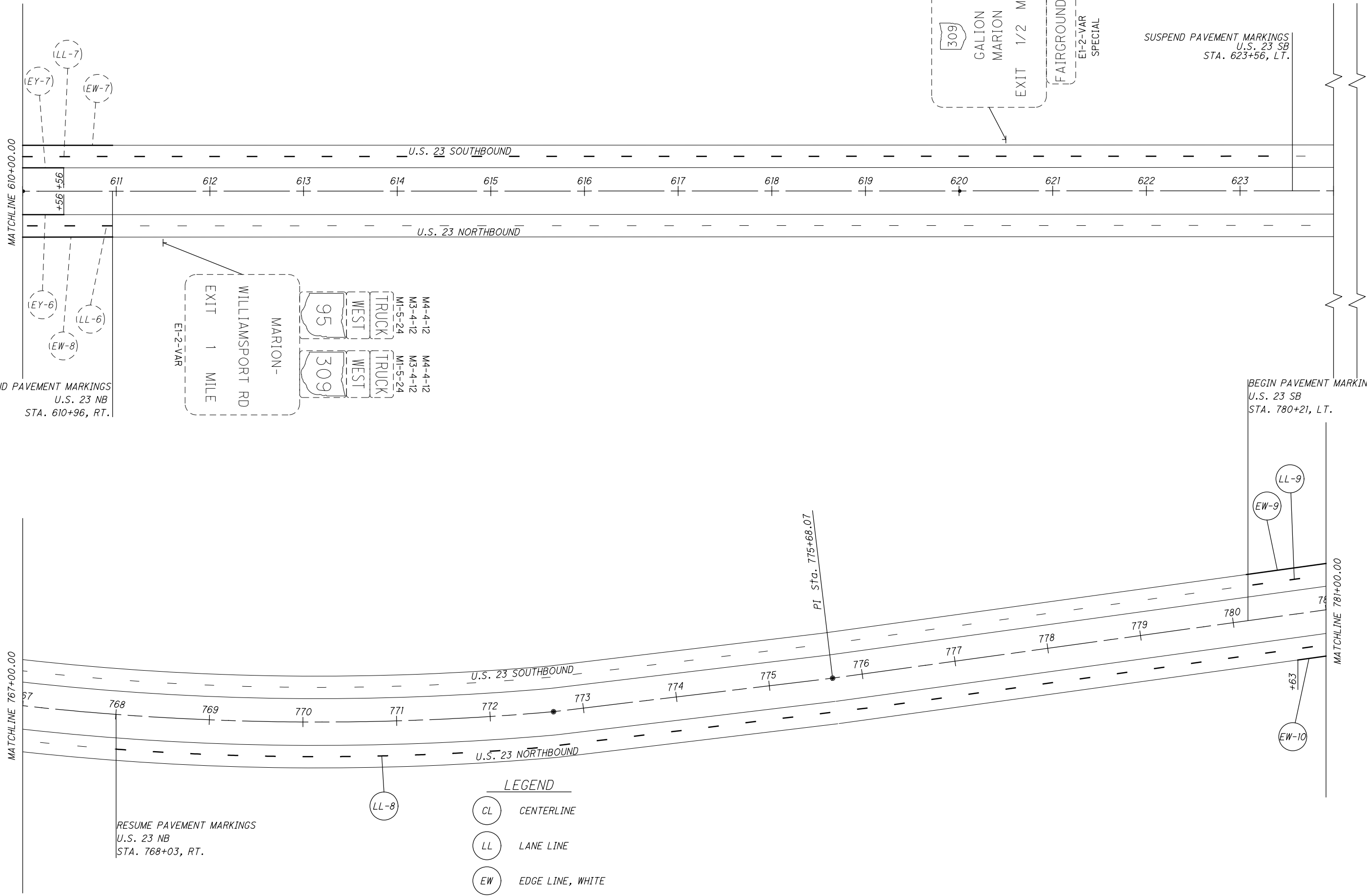

- LEGEND**
- (CL) CENTERLINE
 - (LL) LANE LINE
 - (EW) EDGE LINE, WHITE
 - (EY) EDGE LINE, YELLOW

RESUME PAVEMENT MARKINGS
 U.S. 23 NB
 STA. 768+03, RT.

SUSPEND PAVEMENT MARKINGS
 U.S. 23 NB
 STA. 610+96, RT.

BEGIN PAVEMENT MARKINGS
 U.S. 23 SB
 STA. 780+21, LT.

309
 GALION
 MARION
 EXIT 1/2 MILE
 FAIRGROUNDS
 E1-2-VAR
 SPECIAL

95
 WEST TRUCK
 M3-4-12
 M1-5-24
 M4-4-12
 MARION-
 WILLIAMSPORT RD
 EXIT 1 MILE
 E1-2-VAR

309
 WEST TRUCK
 M3-4-12
 M1-5-24
 M4-4-12

SUSPEND PAVEMENT MARKINGS
 U.S. 23 SB
 STA. 623+56, LT.

CALCULATED KCS
 CHECKED JDH

0 50 100
 HORIZONTAL SCALE IN FEET

PAVEMENT MARKING AND SIGNING PLAN
 STA. 610+00.00 TO STA. 781+00.00

MAR-23-11.50

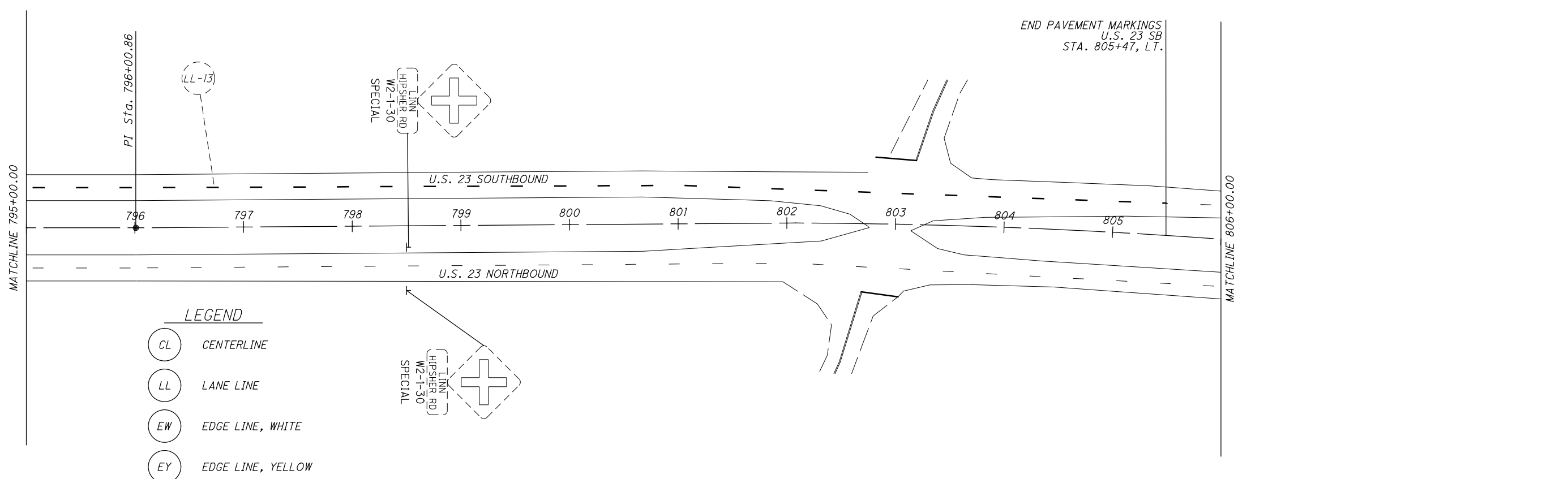
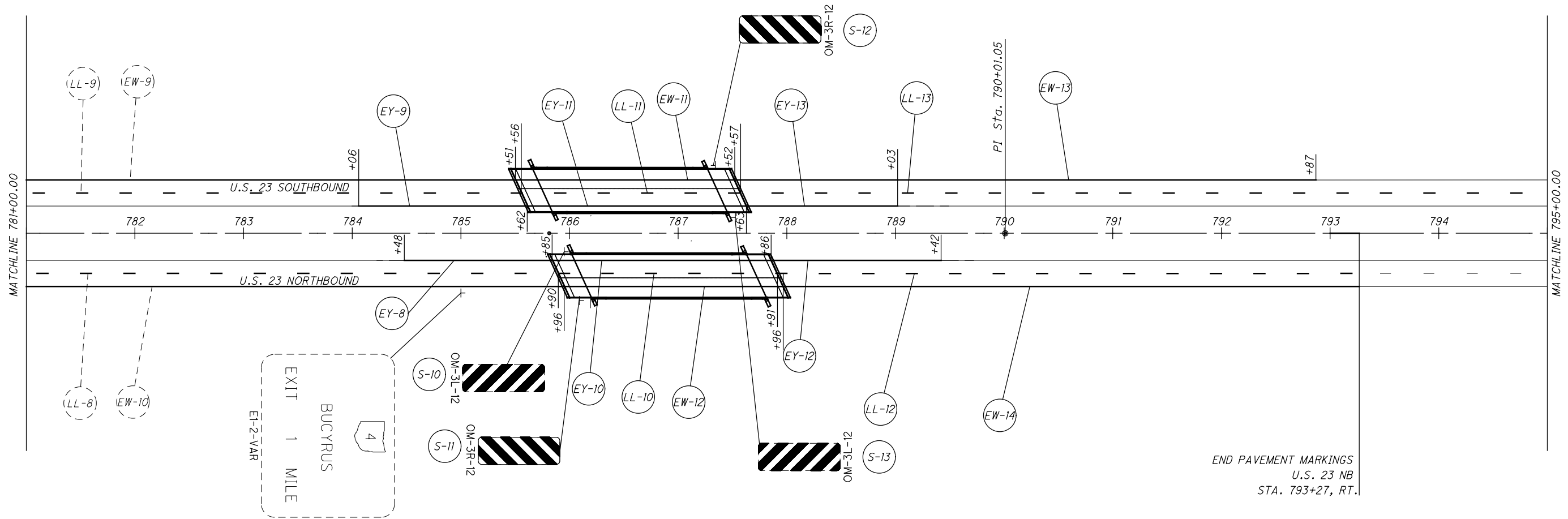

- LEGEND**
- CENTERLINE
 - LANE LINE
 - EDGE LINE, WHITE
 - EDGE LINE, YELLOW

END PAVEMENT MARKINGS
U.S. 23 NB
STA. 793+27, RT.

END PAVEMENT MARKINGS
U.S. 23 SB
STA. 805+47, LT.

CALCULATED KCS
CHECKED JDH

HORIZONTAL SCALE IN FEET

PAVEMENT MARKING AND SIGNING PLAN
STA. 781+00.00 TO STA. 806+00.00

MAR-23-11.50

S:\COO\3500--3599\3599\013\Roadway\Sheets\101560_TSO01.dgn 2/7/2020 11:10:35 AM jamesh

SHEET NO.	REFERENCE NO.	STATION TO STATION	SIDE	618	621		630				644			646			CENTER LINE			
				RUMBLE STRIPS ON SHOULDERS (ASPHALT CONCRETE)	RAISED PAVEMENT MARKER	RAISED PAVEMENT MARKER REMOVED	GROUND MOUNTED SUPPORT, NO. 2 POST			SIGN ERRECTED, FLAT SHEET		REMOVAL OF GROUND MOUNTED SIGN AND DISPOSAL	REMOVAL OF GROUND MOUNTED POST/BEAM SUPPORT AND DISPOSAL	EDGE LINE, 6 INCH (WHITE)	EDGE LINE, 6 INCH (YELLOW)	LANE LINE, 4 INCH (WHITE)			EDGE LINE, 6 INCH (WHITE)	EDGE LINE, 6 INCH (YELLOW)
				FT.	EACH	EACH	LF			SF		EACH	EACH	MILE	MILE	MILE	MILE	MILE	MILE	
58	LL-1	STA. 583+17 TO STA. 584+33	RT.		1	1	0.02	.	.
58	LL-2	STA. 584+33 TO STA. 605+16	RT.		17	17	0.39
58	LL-3	STA. 602+72 TO STA. 605+18	LT.		2	2	0.05
58	LL-4	STA. 605+16 TO STA. 608+50	RT.		3	3	0.06	.	.
58	LL-5	STA. 605+18 TO STA. 608+52	LT.		3	3	0.06	.	.
58,59	LL-6	STA. 608+50 TO STA. 610+96	RT.		2	2	0.05
58,59	LL-7	STA. 608+52 TO STA. 623+56	LT.		13	13	0.29
59,60	LL-8	STA. 768+03 TO STA. 785+90	RT.		15	15	0.34
59,60	LL-9	STA. 780+21 TO STA. 785+56	LT.		5	5	0.10
60	LL-10	STA. 785+90 TO STA. 787+91	RT.		2	2	0.04	.	.
60	LL-11	STA. 785+56 TO STA. 787+57	LT.		2	2	0.04	.	.
60	LL-12	STA. 787+91 TO STA. 793+27	RT.		5	5	0.10
60	LL-13	STA. 787+57 TO STA. 805+47	LT.		15	15	0.34
58	EY-1	STA. 589+17 TO STA. 592+50	RT.	333	0.06
58	EY-2	STA. 603+24 TO STA. 605+16	RT.	244	0.05
58	EY-3	STA. 603+24 TO STA. 605+18	LT.	246	0.05
58	EY-4	STA. 605+16 TO STA. 608+50	RT.	0.06	.	.	.
58	EY-5	STA. 605+18 TO STA. 608+52	LT.	0.06	.	.	.
58,59	EY-6	STA. 608+50 TO STA. 610+56	RT.	246	0.05
58,59	EY-7	STA. 608+52 TO STA. 610+56	LT.	244	0.05
60	EY-8	STA. 784+48 TO STA. 785+85	RT.	132	0.03
60	EY-9	STA. 784+06 TO STA. 785+62	LT.	150	0.03
60	EY-10	STA. 785+85 TO STA. 787+86	RT.	0.05	.	.	.
60	EY-11	STA. 785+62 TO STA. 787+63	LT.	0.04	.	.	.
60	EY-12	STA. 787+86 TO STA. 789+42	RT.	146	0.03
60	EY-13	STA. 787+63 TO STA. 789+03	LT.	141	0.03
58	EW-1	STA. 589+17 TO STA. 592+50	RT.	333	0.06
58	EW-2	STA. 592+50 TO STA. 593+49	RT.	99	0.02
58	EW-3	STA. 602+72 TO STA. 605+19	LT.	247	0.05
58	EW-4	STA. 602+72 TO STA. 605+16	RT.	244	0.05
58	EW-5	STA. 605+18 TO STA. 608+52	LT.	0.06
58,59	EW-6	STA. 605+16 TO STA. 608+50	RT.	0.06
58,59	EW-7	STA. 608+52 TO STA. 610+96	LT.	244	0.05
58,59	EW-8	STA. 608+50 TO STA. 610+96	RT.	246	0.05
59,60	EW-9	STA. 780+21 TO STA. 785+51	LT.	524	0.10
59,60	EW-10	STA. 780+63 TO STA. 785+96	RT.	526	0.10
60	EW-11	STA. 785+51 TO STA. 787+52	LT.	0.04
60	EW-12	STA. 785+96 TO STA. 787+96	RT.	0.04
60	EW-13	STA. 787+52 TO STA. 792+87	LT.	530	0.10
60	EW-14	STA. 787+96 TO STA. 793+27	RT.	525	0.10
61	CL-1	STA. 30+50 TO STA. 37+52	LT./RT.	.	18	18	0.14	.	.
61	EW-15	STA. 30+50 TO STA. 37+52	LT.	0.14
61	EW-16	STA. 30+50 TO STA. 37+52	RT.	0.14
58	S-3	STA. 605+35	RT.	.	.	.	17	.	.	3	.	1	1
58	S-4	STA. 605+35	RT.	.	.	.	17	.	.	3	.	1	1
58	S-5	STA. 608+30	LT.	.	.	.	17	.	.	3	.	1	1
58	S-6	STA. 608+30	LT.	.	.	.	17	.	.	3	.	1	1
60	S-10	STA. 785+95	RT.	.	.	.	17	.	.	3	.	1	1
60	S-11	STA. 786+10	RT.	.	.	.	17	.	.	3	.	1	1
60	S-12	STA. 787+34	LT.	.	.	.	17	.	.	3	.	1	1
60	S-13	STA. 787+53	LT.	.	.	.	17	.	.	3	.	1	1
61	S-16	STA. 32+55	RT.	.	.	.	17	.	.	3	.	1	1
61	S-17	STA. 35+37	LT.	.	.	.	17	.	.	3	.	1	1
TOTALS CARRIED TO GENERAL SUMMARY				5,400	103	103	170	.	.	30	.	10	10	0.68	0.38	1.66	0.48	0.21	0.22	0.14

CALCULATED	KCS
	CHECKED
JDH	
PAVEMENT MARKING AND SIGNING SUBSUMMARY	
MAR-23-11.50	
62 134	