

# STATE OF OHIO DEPARTMENT OF TRANSPORTATION

## MAR-98-6.22 (at SR-529)

RICHLAND TOWNSHIP  
MARION COUNTY

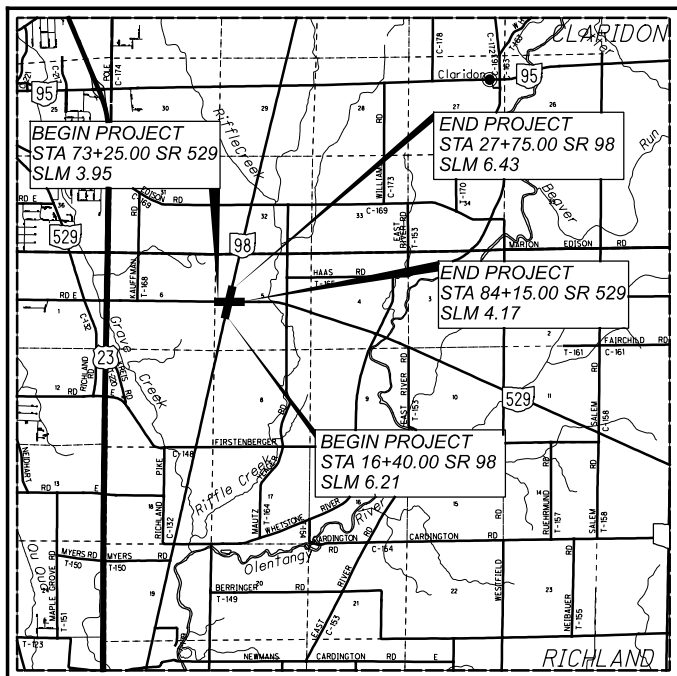

**LOCATION MAP**

LATITUDE: 40°32'58" LONGITUDE: 83°03'00"



PORTION TO BE IMPROVED	—————
INTERSTATE HIGHWAY	=====
FEDERAL ROUTES	—————
STATE ROUTES	—————
COUNTY & TOWNSHIP ROADS	—————
OTHER ROADS	—————

DESIGN DESIGNATION	SR 98	SR 529
CURRENT ADT (2018)	6150	6150
DESIGN YEAR ADT (2042)	7950	7950
DESIGN HOURLY VOLUME (2042)	636	411
DIRECTIONAL DISTRIBUTION	0.70	0.52
TRUCKS (24 HOUR B&C)	400	400
DESIGN SPEED	60 MPH	60 MPH
LEGAL SPEED	55 MPH	55 MPH
DESIGN FUNCTIONAL CLASSIFICATION:		
05 - MAJOR COLLECTOR (RURAL) - BOTH SR 98 AND SR 529		
NHS PROJECT	NO	NO

**DESIGN EXCEPTIONS**

NONE

**ADA DESIGN WAIVERS**

NONE

**UNDERGROUND UTILITIES**  
Contact Two Working Days  
Before You Dig

**OHIO811.org**  
Before You Dig

OHIO 811, 8-1-1, or 1-800-362-2764  
(Non members must be called directly)

PLAN PREPARED BY:

MEAD & HUNT  
4700 LAKEHURST CT, SUITE 110  
COLUMBUS OH, 43016

**INDEX OF SHEETS:**

TITLE SHEET	1
SCHEMATIC PLAN	2-3
TYPICAL SECTIONS	4-5
GENERAL NOTES	6-7
MAINTENANCE OF TRAFFIC	8-41
GENERAL SUMMARY	42-44
SUBSUMMARIES	45-48
PROJECT SITE PLAN	49-50
PLAN AND PROFILE - SR 98	51-55
PLAN AND PROFILE - SR 529	56-64
PLAN AND PROFILE - ROUNDABOUT	65
CROSS SECTIONS - SR 98	66-73
CROSS SECTIONS - SR 529	74-80
CROSS SECTIONS - ROUNDABOUT	81-84
SUPERELEVATION TABLES	85-86
INTERSECTION DETAIL	87-91
DRIVE DETAILS	92-96
STORM SEWER PROFILES	97-101
MISCELLANEOUS DETAILS	102-108
TRAFFIC CONTROL	109-122
LIGHTING	123-126
RIGHT OF WAY PLAN	127-156
SOIL PROFILE SHEETS	157-161

ENGINEER'S SEAL:

SIGNED: \_\_\_\_\_  
DATE: \_\_\_\_\_

ENGINEER'S SEAL:



SIGNED: *Daniel C. Barnhart*  
DATE: December 3, 2021

STANDARD CONSTRUCTION DRAWINGS								SUPPLEMENTAL SPECIFICATIONS		SPECIAL PROVISIONS	
BP-1.1	7/28/00	MH-3	7/16/21	HL-30.11	1/15/21	TC-52.10	10/18/13	800-2019	1/21/22		
BP-2.1	7/17/15			HL-30.21	4/17/20	TC-52.20	1/15/21	813	10/19/18		
BP-2.2	1/15/21	BP-4.1	7/19/13	HL-30.22	1/15/21	TC-65.10	1/17/14	818	1/19/18		
BP-3.1	1/17/20	BP-5.1	1/18/19	HL-40.10	7/17/20	TC-65.11	7/21/17	825	1/17/20		
		BP-7.1	7/17/20	HL-60.11	7/21/17	TC-71.10	7/16/21	832	10/19/18		
CB-2-2A, 2B, 2C	7/16/21			HL-60.31	1/17/20			878	4/16/21		
CB-2-3, 2-4	7/16/21	RM-1.1	1/15/21					913	4/24/17		
CB-8	7/16/21	RM-3.1	7/20/18	MT-101.60	1/17/20						
CB-4A, 5A, 8A	7/16/21			MT-101.90	7/17/20						
		HW-2.1	7/20/18								
DM-1.1	7/17/20	HW-2.2	7/20/18	TC-41.20	10/18/13						
DM-1.2	1/18/13			TC-41.30	10/18/13						
DM-4.1	7/17/20	HL-10.11	1/15/21	TC-41.40	10/18/13						
DM-4.2	7/20/12	HL-10.12	7/16/21	TC-41.50	10/18/13						
DM-4.3	1/15/16	HL-10.13	4/17/20	TC-42.10	10/18/13						
DM-4.4	1/15/16	HL-20.11	1/15/21	TC-42.20	10/18/13						

**FEDERAL PROJECT NUMBER**

E190 (545)

**RAILROAD INVOLVEMENT**

NONE

**PROJECT DESCRIPTION**

THIS PROJECT CONSISTS OF UPGRADING THE INTERSECTION OF SR 98 AND SR 529 TO A MODERN ROUNDABOUT. THIS PROJECT ALSO INCLUDES A NEW CLOSED STORM SEWER SYSTEM ALONG PORTIONS OF SR 98 AND APPROXIMATELY 2600' ALONG SR 529. ALSO INCLUDED ARE LIGHTING, MISC. DRAINAGE IMPROVEMENTS, SIGNING AND STRIPING WORK.

**EARTH DISTURBED AREAS**

PROJECT EARTH DISTURBED AREA:	5.52 ACRES
ESTIMATED CONTRACTOR EARTH DISTURBED AREA:	0.95 ACRES
NOTICE OF INTENT EARTH DISTURBED AREA:	6.47 ACRES

**2019 SPECIFICATIONS**

THE STANDARD SPECIFICATIONS OF THE STATE OF OHIO, DEPARTMENT OF TRANSPORTATION, INCLUDING SUPPLEMENTAL SPECIFICATIONS LISTED IN THE PLANS AND CHANGES LISTED IN THE PROPOSAL SHALL GOVERN THIS IMPROVEMENT.

I HEREBY APPROVE THESE PLANS AND DECLARE THAT THE MAKING OF THIS IMPROVEMENT WILL REQUIRE THE PART TIME CLOSING OF THE HIGHWAY TO TRAFFIC, AS NOTED ON SHEETS 11-14. DURING WHICH TIME DETOURS WILL BE PROVIDED AS SHOWN HEREIN. PROVISIONS FOR THE MAINTENANCE AND SAFETY OF TRAFFIC WILL BE AS SET FORTH ON THE PLANS AND ESTIMATES.

APPROVED: *by C. Row*  
DATE: 1/20/22 DISTRICT DEPUTY DIRECTOR

APPROVED: \_\_\_\_\_  
DATE: \_\_\_\_\_ DIRECTOR, DEPARTMENT OF TRANSPORTATION

TITLE SHEET

DESIGN AGENCY  
**Mead & Hunt**  
CLIENT



DESIGNER  
ANM

REVIEWER  
DCB 10/09/20

PROJECT ID  
109550

SHEET TOTAL  
P.01 | 161

MAR-98-6.22

MODEL: Sheet PAPER SIZE: 17x11 (in.) DATE: 1/19/2022 TIME: 3:16:05 PM USER: 16366cbb X:\40370001\90724.011\09550\_MAR-98-6.22\400-Engineering\Roadway\Sheets\109550\_GT001.dgn



MAR-98-6.22

MODEL: Sheet PAPER SIZE: 17x11 (in.) DATE: 5/6/2022 TIME: 10:56:06 AM USER: 1426egd X:\4037000\190724\01109550\_MAR-98-6.22\400-Engineering\Roadway\Sheets\109550\_GY001.dgn

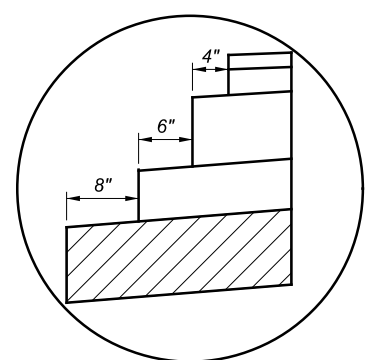

PAVEMENT STEP DETAIL

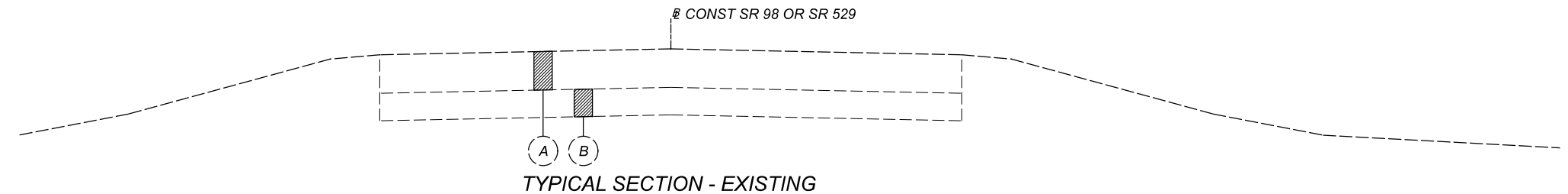

TYPICAL SECTION - EXISTING

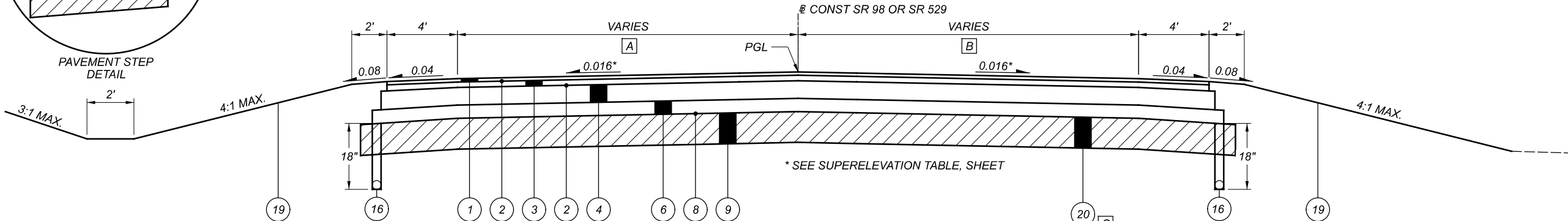

TYPICAL SECTION - PAVED SHOULDERS

STA 16+40.00 TO STA 17+27.51 - SR 98  
STA 22+75.94 TO STA 27+75.00 - SR 98  
STA 73+25.00 TO STA 77+72.43 - SR 529  
STA 82+86.21 TO STA 84+15.00 - SR 529

\* SEE SUPERELEVATION TABLE, SHEET

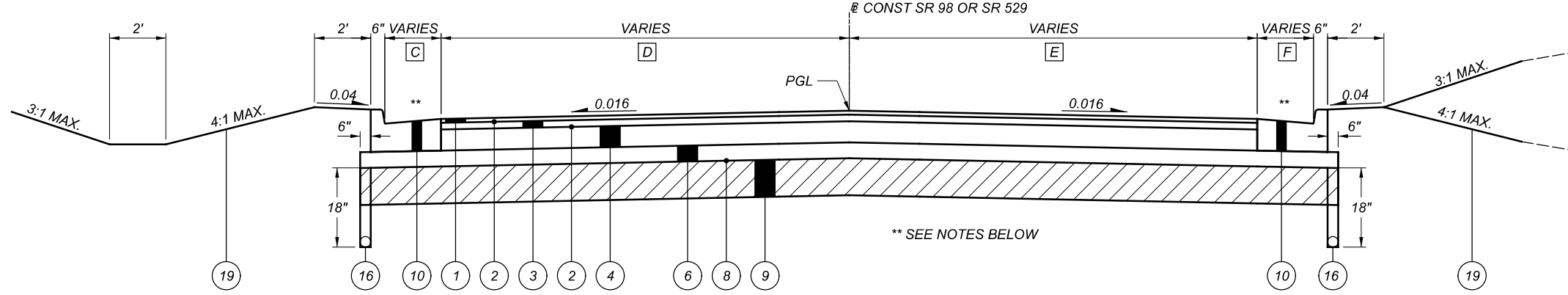

TYPICAL SECTION - CURB AND GUTTER

STA 17+27.51 TO STA 17+35.29 - SR 98  
STA 22+68.88 TO STA 22+75.94 - SR 98  
STA 77+72.43 TO STA 77+78.80 - SR 529  
STA 82+78.03 TO STA 82+86.21 - SR 529

\*\* SEE NOTES BELOW

LEGEND

- 1 ITEM 442 - 1 1/2" ASPHALT CONCRETE SURFACE COURSE, 12.5 MM, TYPE A, (446)
- 2 ITEM 407 - NON-TRACKING TACK COAT (REFERENCE THE CMS TABLE 406.06-1 FOR APPLICATION RATES)
- 3 ITEM 442 - 1 3/4" ASPHALT CONCRETE INTERMEDIATE COURSE, 12.5 MM, TYPE A, (446)
- 4 ITEM 301 - 5" ASPHALT CONCRETE BASE PG 64.22, (449)
- 5 ITEM 605 - 6" BASE PIPE UNDERDRAINS
- 6 ITEM 304 - 6" AGGREGATE BASE
- 7 ITEM 304 - 14" AGGREGATE BASE
- 8 ITEM 204 - PROOF ROLLING
- 9 ITEM 206 - LIME STABILIZED SUBGRADE, 14 INCHES DEEP
- 10 ITEM 609 - COMBINATION CURB & GUTTER, TYPE 2
- 11 NOT USED
- 12 ITEM 609 - CURB, TYPE 6
- 13 ITEM 451 - 7" REINFORCED CONCRETE PAVEMENT
- 14 ITEM 609 - COMBINATION CURB & GUTTER, TYPE 9
- 15 ITEM 609 - COMBINATION CURB & GUTTER, TYPE 9, AS PER PLAN (SEE NEXT SHEET)
- 16 ITEM 605 - 6" BASE PIPE UNDERDRAINS (OR 6" UNCLASSIFIED UNDERDRAIN WHEN CALLED FOR IN PROFILE)
- 17 ITEM 609 - 4" CONCRETE MEDIAN
- 18 ITEM 304 - 4" AGGREGATE BASE
- 19 ITEM 659 - SEEDING AND MULCHING
- 20 ITEM 204 - EXCAVATION OF SUBGRADE
- 21 ITEM 203 - EMBANKMENT
- A EXISTING 12" ASPHALT CONCRETE
- B EXISTING 6"-8" AGGREGATE BASE

NOTES: ALL COMBINATION CURB AND GUTTER, TYPE 2 TRANSITIONS FROM A 4' WIDE GUTTER PAN TO THE STANDARD 2' WIDTH OVER THE FIRST 8' OF THE RUN.

ALL COMBINATION CURB AND GUTTER, TYPE 2 TRANSITIONS FROM -0.04 GUTTER PAN CROSS SLOPE TO -0.0833 GUTTER PAN CROSS SLOPE OVER THE 8' GUTTER PAN WIDTH TRANSITION.

ALL COMBINATION CURB AND GUTTER, TYPE 2 TRANSITIONS FROM 0" TO 6" CURB HEIGHT OVER THE FIRST 10'.

ALL SHOULDERS TRANSITION FROM THE EXISTING CROSS SLOPE TO -0.04 OVER THE FIRST 50' OF PROPOSED WORK.

ALL CURB, TYPE 6 ALONG DRIVES TAPER DOWN FROM 6" TO 0" OVER THE LAST 10' OF THE RUN.

- A VARIES FROM 12' AT STA 16+40.00 TO 16.71' AT STA 17+27.51  
VARIES FROM 15.25' AT STA 22+75.94 TO 12' AT STA 27+75.00  
VARIES FROM 12' AT STA 73+25.00 TO 14.89' AT STA 77+72.43  
VARIES FROM 15.75' AT STA 82+85.73 TO 12' AT STA 84+15.00
- B VARIES FROM 12' AT STA 16+40.00 TO 13.65' AT STA 17+27.51  
VARIES FROM 16.02' AT STA 22+75.94 TO 12' AT STA 27+75.00  
VARIES FROM 12' AT STA 73+25.00 TO 16.58' AT STA 77+72.43  
VARIES FROM 14.54' AT STA 82+85.73 TO 12' AT STA 84+15.00
- C VARIES FROM 4' AT STA 17+27.51 TO 2' AT STA 17+36.02  
VARIES FROM 2' AT STA 22+67.84 TO 4' AT STA 22+75.94  
VARIES FROM 2' AT STA 77+72.43 TO 4' AT STA 77+80.47  
VARIES FROM 2' AT STA 82+78.23 TO 4' AT STA 82+85.73
- D VARIES FROM 16.71' AT STA 17+27.51 TO 17.33' AT STA 17+36.02  
VARIES FROM 15.68' AT STA 22+67.84 TO 15.25' AT STA 22+75.94  
VARIES FROM 14.89' AT STA 77+72.43 TO 15.05' AT STA 77+80.47  
VARIES FROM 15.75' AT STA 82+78.23 TO 14.54' AT STA 82+85.73
- E VARIES FROM 13.65' AT STA 17+27.51 TO 14.51' AT STA 17+36.02  
VARIES FROM 16.24' AT STA 22+67.43 TO 16.03' AT STA 22+75.49  
VARIES FROM 16.58' AT STA 77+72.43 TO 16.87' AT STA 77+79.98  
VARIES FROM 14.54' AT STA 82+76.90 TO 14.59' AT STA 82+85.20
- F VARIES FROM 4' AT STA 17+27.60 TO 2' AT STA 17+35.54  
VARIES FROM 2' AT STA 22+67.43 TO 4' AT STA 22+75.49  
VARIES FROM 2' AT STA 77+71.90 TO 4' AT STA 77+79.98  
VARIES FROM 2' AT STA 82+76.90 TO 4' AT STA 82+85.20
- G EXCAVATE 36" OF UNSUITABLE SOIL REPLACE WITH SUITABLE SOIL STA 25+00 TO STA 27+75 - SR 98

TYPICAL SECTIONS

DESIGN AGENCY  
**Mead & Hunt**  
CLIENT

DESIGNER  
ANM

REVIEWER  
DCB 9/21/21

PROJECT ID  
109550

SHEET TOTAL  
P.04 161



MAR-98-6.22

MODEL: Sheet PAPER SIZE: 17x11 (in.) DATE: 5/6/2022 TIME: 11:16:51 AM USER: 1426egpd X:\4037000\190724\01109550\_MAR-98-6.22\400-Engineering\MOT\Sheets\109550\_MC001.dgn

REF NO.	SHEET NO.	STATION TO STATION	614	614	614	614	614	614	614	301	304	407	410	410	441	614	614	614	614	616	617	642
			SNMT	MI	MI	FT	FT	EACH	FT	MI	CY	CY	GAL	CY	CY	CY	CY	LS	HR	LS	MGAL	CY
			PHASE 1																			
CL1	18 - 21, 23	12+00.00 TO 29+50.00	0.32																			
ELW1	18 - 21, 23	12+00.00 TO 29+50.00		0.33																		
ELW2	18 - 20, 23 - 25	12+00.00 TO 90+00.00		0.34																		
CL2	20, 24 - 25	81+11.00 TO 90+00.00	0.17																			
ELW3	20 - 21, 23 - 25	29+50.00 TO 90+00.00		0.35																		
SL1	20 & 24	81+11.00				10																
			PHASE 3																			
CL3	35 - 37	16+47.00 TO 27+75.00	0.17																			
ELW4	35 - 37	16+47.00 TO 27+75.00		0.12																		
ELW5	35 - 37	16+47.00 TO 27+75.00		0.12																		
CL4	38 - 39	73+00.00 TO 77+80.00	0.13																			
ELW5	38 - 39	73+00.00 TO 77+80.00		0.10																		
ELW6	38 - 39	73+00.00 TO 77+80.00		0.10																		
YL1	36 & 39	19+24.00					12															
YL2	36 & 39	20+66.00					13															
YL3	36 & 39	79+43.00					14															
AR1	36 & 39	79+89.00				1																
AR2	36 & 39	20+09.00				1																
AR3	36 & 39	80+11.00				1																
AR4	36 & 39	19+92.00				1																
MOT NOTES			7	0.33	0.52	109		48		300	300	100	100	100	300	300	1	96	1	150	1000	2
TOTALS CARRIED TO GENERAL SUMMARY			7	1.12	1.98	109	10	4	87	300	300	100	100	100	300	300	1	96	1	150	1000	2

ASPHALT CONCRETE BASE, PG64-22, (449)

Maintenance of Traffic Estimated Quantities

DESIGN AGENCY  
  
 CLIENT  
  
 DESIGNER  
 RO  
 REVIEWER  
 EGD 08-18-21  
 PROJECT ID  
 109550  
 SHEET TOTAL  
 P. 08 | 161

MAR-98-6.22

MODEL: Sheet PAPER SIZE: 34x22 (in.) DATE: 5/4/2022 TIME: 9:58:34 AM USER: 1426egd X:\4037000\190724.01109550\_MAR-98-6.22\40C-Eng\Sheet\109550\_MN001.dgn

**ITEM 614, MAINTAINING TRAFFIC**

ALL TRAFFIC CONTROL DEVICES SHALL BE FURNISHED, ERECTED, MAINTAINED, AND REMOVED BY THE CONTRACTOR IN ACCORDANCE WITH THE OHIO MANUAL OF UNIFORM TRAFFIC CONTROL DEVICES (CURRENT EDITION). COPIES ARE AVAILABLE FROM,

THE OHIO DEPARTMENT OF TRANSPORTATION  
BUREAU OF TRAFFIC,  
1980 WEST BROAD STREET  
COLUMBUS, OHIO 43223

THE CONTRACTOR SHALL NOT ORDER MATERIALS OR PERFORM WORK LISTED IN THE GENERAL SUMMARY FOR ITEMS DESIGNATED BY PLAN NOTE TO BE USED "AS DIRECTED BY THE ENGINEER" UNLESS AUTHORIZED BY THE ENGINEER.

LENGTH AND DURATION OF LANE CLOSURES AND RESTRICTIONS SHALL BE AT THE APPROVAL OF THE ENGINEER. IT IS THE INTENT TO MINIMIZE THE IMPACT TO THE TRAVELING PUBLIC. LANE CLOSURES OR RESTRICTIONS OVER SEGMENTS OF THE PROJECT IN WHICH NO WORK IS ANTICIPATED WITHIN A REASONABLE TIME FRAME, AS DETERMINED BY THE ENGINEER, SHALL NOT BE PERMITTED. THE LEVEL OF UTILIZATION OF MAINTENANCE OF TRAFFIC DEVICES SHALL BE COMMENSURATE WITH THE WORK IN PROGRESS.

CONSTRUCTION OPERATIONS SHALL NOT BEGIN UNTIL ALL TRAFFIC CONTROL IS IN PLACE AND APPROVED BY ODOT PERSONNEL. THE CONSTRUCTION INSPECTOR SHALL APPROVE ALL TEMPORARY TRAFFIC CONTROL DEVICES FOR CONDITION AND LOCATION BEFORE THE CONTRACTOR WILL BE ALLOWED TO BEGIN WORK. IF THE CONTRACTOR DOES NOT COMPLY WITH THE STANDARDS, HIS PERMIT SHALL BE REVOKED AND ALL WORK SHALL BE TERMINATED.

A MINIMUM OF ONE LANE OF TRAFFIC IN EACH DIRECTION SHALL BE MAINTAINED AT ALL TIMES, EXCEPT FOR A PERIOD NOT TO EXCEED 45 CONSECUTIVE CALENDAR DAYS FOR PHASE 1, 30 CONSECUTIVE CALENDAR DAYS FOR PHASE 2, AND 15 CONSECUTIVE CALENDAR DAYS FOR PHASE 3, WHEN THROUGH TRAFFIC MAY BE DETOURED AS SHOWN ON SHEETS 11 - 14. A DISINCENTIVE SHALL BE ASSESSED IN THE AMOUNT OF \$3500 FOR PHASE 1, \$10,000 FOR PHASE 2 AND \$5000 FOR PHASE 3 PER DAY FOR EACH CALENDAR DAY THE ROADWAY REMAINS CLOSED TO TRAFFIC BEYOND THE SPECIFIED LIMIT.

**WINDOW CONTRACT TABLE**

DESCRIPTION OF CRITICAL WORK	CALENDAR DAYS TO COMPLETE	DISINCENTIVE \$ PER DAY	WORK WINDOW	
			START	END
PHASE 1	45	\$3500 PER DAY	CONTRACT EXECUTION DATE	PRIOR TO STARTING PHASE 2
PHASE 2	30	\$10,000 PER DAY	COMPLETION OF PHASE 1	PRIOR TO STARTING PHASE 3
PHASE 3	15	\$5000 PER DAY	COMPLETION OF PHASE 2	PROJECT COMPLETION DATE

NO WORK SHALL BE PERFORMED AND ALL EXISTING LANES SHALL BE OPEN TO TRAFFIC DURING THE FOLLOWING DESIGNATED HOLIDAYS OR EVENTS:

CHRISTMAS	MEMORIAL DAY	LABOR DAY
NEW YEAR'S	FOURTH OF JULY	THANKSGIVING

THE PERIOD OF TIME THAT THE LANES ARE TO BE OPEN DEPENDS ON THE DAY OF THE WEEK ON WHICH THE HOLIDAY OR EVENT FALLS. THE FOLLOWING SCHEDULE SHALL BE USED TO DETERMINE THIS PERIOD:

DAY OF HOLIDAY / TIME ALL LANES MUST BE OPEN TO TRAFFIC:

- SUNDAY / 12:00N FRIDAY THROUGH 6:00AM MONDAY
- MONDAY / 12:00N FRIDAY THROUGH 6:00AM TUESDAY
- TUESDAY / 12:00N MONDAY THROUGH 6:00AM WEDNESDAY
- WEDNESDAY / 12:00N TUESDAY THROUGH 6:00AM THURSDAY
- THURSDAY / 12:00N WEDNESDAY THROUGH 6:00AM FRIDAY

**ITEM 614, MAINTAINING TRAFFIC (CONT.)**

THANKSGIVING / 6:00AM WEDNESDAY THROUGH 6:00AM MONDAY  
FRIDAY / 12:00N THURSDAY THROUGH 6:00AM MONDAY  
SATURDAY / 12:00N FRIDAY THROUGH 6:00AM MONDAY

IRON OHIO 70.3 - LANE OR SHOULDER CLOSURES ARE NOT PERMITTED DURING THE IRON MAN OHIO DURING THE EVENT OR THE WEEK PRECEDING IT ON THE FOLLOWING ROUTES:

- US 23 BETWEEN WILLEY RD AND SR 98
- SR 98 BETWEEN US 23 AND SR 309
- SR 309 BETWEEN SR 98 AND SR 746
- SR 746 BETWEEN SR 309 AND US 42
- US 42 BETWEEN SR 746 AND KELLEY MCMASTER RD
- US 42 BETWEEN HORSESHOE RD AND E CENTRAL AVE (CITY OF DELAWARE LIMITS)

THE CONTRACTOR SHALL PROVIDE, ERECT, AND MAINTAIN STANDARD 48 x 30 INCH ROAD CLOSED SIGNS, SIGN SUPPORTS, BARRICADES AND LIGHTS, AS DETAILED IN SCD MT-101.60 AT THE FOLLOWING LOCATIONS DURING PERIODS WHICH THE AFFECTED ROADS ARE CLOSED TO TRAFFIC.

- PHASE 1 SR 529 (1,100 FT WEST OF INTERSECTION)
- PHASE 2 SR 529 AND SR 98 (ALL FOUR APPROACHES)
- PHASE 3 SR 529 (1,500 FT EAST OF INTERSECTION)

NOTICE OF CLOSURE SIGNS, W20-H13, SHALL BE ERECTED BY THE CONTRACTOR PRIOR TO THE SCHEDULED ROAD CLOSURE IN ACCORDANCE WITH THE NOTICE OF CLOSURE TIME TABLE BELOW. [AT THE APPROVAL OF THE ENGINEER, PORTABLE CHANGEABLE MESSAGE SIGNS MAY BE USED IN LIEU OF THE STANDARD FLATSHEET SIGN FOR CLOSURE DURATIONS OF LESS THAN 1 WEEK.]

THE SIGNS SHALL BE ERECTED ON THE RIGHT-HAND SIDE OF THE ROAD FACING TRAFFIC. THEY SHALL BE PLACED SO AS NOT TO INTERFERE WITH THE VISIBILITY OF ANY OTHER TRAFFIC CONTROL SIGNS. ON ROADWAYS, THEY SHOULD BE ERECTED AT OR NEAR THE POINT OF CLOSURE.

**NOTICE OF CLOSURE SIGN TIME TABLE**

ITEM	DURATION OF CLOSURE	SIGN DISPLAYED TO PUBLIC	NOTIFICATION DUE TO DISTRICT 6 COMMUNICATION OFFICE
ROAD CLOSURES	>=2 WEEKS	14 CALENDAR DAYS PRIOR TO CLOSURE	21 CALENDAR DAYS PRIOR TO CLOSURE
	> 12 HOURS & < 2 WEEKS	7 CALENDAR DAYS PRIOR TO CLOSURE	14 CALENDAR DAYS PRIOR TO CLOSURE
	<= 12 HOURS	2 BUSINESS DAYS PRIOR TO CLOSURE	4 BUSINESS DAYS PRIOR TO CLOSURE

THE SIGN SHALL DISPLAY THE DATE OF THE CLOSURE IN MMM-DD FORMAT AND THE NUMBER OF DAYS OF THE CLOSURE. THE LAST LINE OF THE W20-H13 SIGN SHALL DISPLAY THE PHONE NUMBER OF THR DISTRICT 6 PUBLIC INFORMATION CONSTRUCTION LINE, (740)833-8268, WHICH A MOTORIST MAY CALL FOR ADDITIONAL INFORMATION.

THE FOLLOWING ESTIMATED QUANTITIES HAVE BEEN INCLUDED IN THE GENERAL SUMMARY FOR USE AS DETERMINED BY THE ENGINEER FOR THE MAINTENANCE OF TRAFFIC.

- ITEM 410, TRAFFIC COMPACTED SURFACE, TYPE A OR B 100 CU. YD.
- ITEM 410, TRAFFIC COMPACTED SURFACE, TYPE C 100 CU. YD.
- ITEM 614, ASPHALT CONCRETE FOR MAINTAINING TRAFFIC 100 CU. YD.
- ITEM 616, WATER 50 M. GAL.

ALL WORK AND TRAFFIC CONTROL DEVICES SHALL BE IN ACCORDANCE WITH C&MS 614 AND OTHER APPLICABLE PORTIONS OF THE SPECIFICATIONS, AS WELL AS THE OHIO MANUAL OF UNIFORM TRAFFIC CONTROL DEVICES. PAYMENT FOR ALL LABOR, EQUIPMENT AND MATERIALS SHALL BE INCLUDED IN THE LUMP SUM

**ITEM 614, MAINTAINING TRAFFIC (CONT.)**

CONTRACT PRICE FOR ITEM 614, MAINTAINING TRAFFIC, UNLESS SEPARATELY ITEMIZED IN THE PLAN.

**DUST CONTROL**

THE CONTRACTOR SHALL FURNISH AND APPLY WATER FOR DUST CONTROL AS DIRECTED BY THE ENGINEER. THE FOLLOWING ESTIMATED QUANTITIES HAVE BEEN INCLUDED FOR DUST CONTROL PURPOSES:

- ITEM 616, WATER 50 M. GAL.

**DESIGNATED LOCAL DETOUR ROUTE**

IN ADDITION TO THE OFFICIAL, SIGNED DETOUR ROUTE, A LOCAL ROUTE HAS BEEN DETERMINED TO BE THE SECONDARY, UNSIGNED DETOUR ROUTE OR "DESIGNATED LOCAL DETOUR ROUTE." THIS ROUTE IS SHOWN ON SHEETS NO. 11-14. DURING THE TIME THAT TRAFFIC IS DETOURED, THE CONTRACTOR SHALL MAINTAIN THIS ROUTE IN A CONDITION WHICH IS REASONABLY SMOOTH AND FREE FROM HOLES, RUTS, RIDGES, BUMPS, DUST AND STANDING WATER. ONCE THE DETOUR IS REMOVED AND TRAFFIC RETURNED TO ITS NORMAL PATTERN, THE DESIGNATED LOCAL DETOUR ROUTE SHALL BE RESTORED TO A CONDITION THAT IS EQUIVALENT TO THAT WHICH EXISTED PRIOR TO ITS USE FOR THIS PURPOSE. ALL SUCH WORK SHALL BE PERFORMED WHEN AND AS DETERMINED BY THE ENGINEER.

THE FOLLOWING ESTIMATED QUANTITIES ARE PROVIDED FOR USE AS DETERMINED BY THE ENGINEER TO MAINTAIN AND SUBSEQUENTLY RESTORE THE DESIGNATED LOCAL DETOUR ROUTE

- ITEM 301, ASPHALT CONCRETE BASE, PG 64-22, (449) 300 CU. YD.
- ITEM 304, AGGREGATE BASE 300 CU. YD.
- ITEM 441, ASPHALT CONCRETE SURFACE COURSE, TYPE 1, (448), PG 64-22 300 CU. YD.
- ITEM 407, NON-TRACKING TACK COAT 100 GAL.
- ITEM 614, ASPHALT CONCRETE FOR MAINTAINING TRAFFIC 200 CU. YD.
- ITEM 616, WATER 50 M. GAL.
- ITEM 617, COMPACTED AGGREGATE, TYPE A 1,000 CU. YD.
- ITEM 642, CENTER LINE 2 MILE

**DROP-OFFS IN WORK ZONES**

THE DROP-OFF ADJACENT TO THE TRAVEL LANE SHALL MEET THE CRITERIA OUTLINED IN STANDARD DRAWING MT-101.90. NO ADDITIONAL COMPENSATION SHALL BE MADE FOR MATERIALS, LABOR, OR EQUIPMENT NECESSARY TO MEET THE REQUIREMENTS OF MT-101.90.

**WORK ZONE MARKINGS AND SIGNS**

SEE THE MAINTENANCE OF TRAFFIC SUBSUMMARY FOR ESTIMATED QUANTITIES TO BE USED AT LOCATIONS IDENTIFIED BY THE ENGINEER FOR WORK ZONE PAVEMENT MARKINGS AND SIGNS PER THE REQUIREMENTS OF C&MS 614.04 AND 614.11.

**ADVANCE WORK ZONE INFORMATION**

ADVANCE WORK ZONE INFORMATION SIGNS, AS USED IN THIS NOTE, ARE FIXED MESSAGE TYPES. THE SIGNS ARE TO BE LOCATED AT EXTREME DISTANCE FROM THE WORK AREA AS SHOWN IN THE PLANS.

THE SIGNS SHALL BE BLACK ON ORANGE (INCLUDING BLACK BORDER). THE LAYOUT SHALL BE IN CONFORMANCE WITH TEM CHAPTER 211.

WHEN REGULATORY INFORMATION IS PROVIDED, IT SHALL BE DISPLAYED SEPARATELY AS A STANDARD BLACK-ON-WHITE SIGN. MIXING OF BLACK-ON-WHITE REGULATORY INFORMATION ON BLACK-ON-ORANGE INFORMATION SIGN IS PROHIBITED.

IF THE MOTORIST IS BEING DETOURED OR IF AN ALTERNATE ROUTE IS PROVIDED, THE ROUTE SHOULD BE SIGNED WITH ASSEMBLIES CONSISTING OF THE APPROPRIATE BLACK-ON-ORANGE DETOUR OR ALT MARKER WITH A STANDARD ROUTE MARKER OR ARROW PLATE. IF MORE TARGET VALUE IS DESIRED, THIS TRAIL BLAZER INFORMATION MAY BE SHOWN ON AN ORANGE PANEL (OMUTCD SECTION 2D.32).

**ADVANCE WORK ZONE INFORMATION (CONTINUED)**

ROUTE SIGN ASSEMBLIES SHALL BE SIZED ACCORDING TO THE TYPE OF ROAD ON WHICH THEY ARE LOCATED IN ACCORDANCE WITH THE OMUTCD.

SUPPORTS FOR SIGN INSTALLATIONS SHALL CONFORM TO ALL EXISTING STANDARDS FOR PERMANENT SIGNS. THESE SIGNS SHOULD NOT BE ATTACHED TO EXISTING SUPPORTS.

ALL ADVANCE WORK ZONE INFORMATION SIGN INSTALLATIONS LOCATED OUTSIDE OF THE PROJECT WORK LIMITS SHALL BE PAID FOR UNDER APPROPRIATE 630 ITEMS.

**NOTIFICATION OF TRAFFIC RESTRICTIONS**

THROUGHOUT THE DURATION OF THE PROJECT, THE CONTRACTOR SHALL NOTIFY THE PROJECT ENGINEER IN WRITING OF ALL TRAFFIC RESTRICTIONS AND UPCOMING MAINTENANCE OF TRAFFIC CHANGES. THE CONTRACTOR SHALL ENSURE THE WRITTEN NOTIFICATION IS SUBMITTED IN A TIMELY MANNER TO ALLOW THE PROJECT ENGINEER TO MEET THE REQUIRED TIME FRAMES SET FORTH IN THE TABLE BELOW TO INFORM THE SPECIAL HAULING PERMITS SECTION (HAULING.PERMITS@DOT.OHIO.GOV) AND THE DISTRICT PUBLIC INFORMATION OFFICE (PIO). THIS NOTIFICATION SHALL BE RECEIVED BY THE PROJECT ENGINEER PRIOR TO THE PHYSICAL SETUP OF ANY APPLICABLE SIGNS OR MESSAGE BOARDS.

INFORMATION SHOULD INCLUDE, BUT IS NOT LIMITED TO, ALL CONSTRUCTION ACTIVITIES THAT IMPACT OR INTERFERE WITH TRAFFIC AND SHALL LIST THE SPECIFIC LOCATION, TYPE OF WORK, ROAD STATUS, DATE AND TIME OF RESTRICTION, DURATION OF RESTRICTION, NUMBER OF LANES MAINTAINED, NUMBER OF LANES CLOSED, MINIMUM VERTICAL CLEARANCE, MINIMUM WIDTH OF DRIVABLE PAVEMENT, DETOUR ROUTES, IF APPLICABLE, AND ANY OTHER INFORMATION REQUIRED BY THE PROJECT ENGINEER.

**NOTIFICATION OF TRAFFIC RESTRICTIONS TIME TABLE**

ITEM	DURATION OF CLOSURE	NOTICE DUE TO PERMITS & PIO
ROAD CLOSURES	>= 2 WEEKS	21 CALENDAR DAYS PRIOR TO CLOSURE
	>12 HOURS & <2 WEEKS	14 CALENDAR DAYS PRIOR TO CLOSURE
	<=12 HOURS	4 CALENDAR DAYS PRIOR TO CLOSURE
LANE CLOSURES & RESTRICTIONS	>= 2 WEEKS	21 CALENDAR DAYS PRIOR TO CLOSURE
	< 2 WEEKS	5 CALENDAR DAYS PRIOR TO CLOSURE
START OF CONSTRUCTION & TRAFFIC PATTERN CHANGES	N/A	14 CALENDAR DAYS PRIOR TO CLOSURE

**WORK ZONE PAVEMENT MARKINGS**

THE FOLLOWING QUANTITIES ARE PROVIDED FOR THE PLACEMENT OF WORK ZONE PAVEMENT MARKINGS ON THE NEWLY PLACED ASPHALT CONCRETE SURFACE COURSE PRIOR TO THE PLACEMENT OF THE PERMANENT PAVEMENT MARKINGS.

THE FOLLOWING QUANTITIES HAVE BEEN CARRIED TO THE MOT SUB-SUMMARY FOR USE AS DIRECTED BY THE ENGINEER.

- ITEM 614 - WORK ZONE CENTER LINE, CLASS III, 642 PAINT 0.33 MILE
- ITEM 614 - WORK ZONE EDGE LINE, CLASS III, 6", 642 PAINT 0.52 MILE
- ITEM 614 - WORK ZONE DOTTED LINE, CLASS III, 12" 642 PAINT 109 FT
- ITEM 614 - WORK ZONE PAVEMENT MARKINGS, MISC.: YIELD LINE CLASS III, 642 PAINT 48 FT

MAINTENANCE OF TRAFFIC NOTES

DESIGN AGENCY  
**SINGH**  
SINGH + ASSOCIATES, INC.  
CONSULTING ENGINEERS  
CLIENT

DESIGNER  
RO

REVIEWER  
EGD 08-18-21

PROJECT ID  
109550

SHEET TOTAL  
P. 09 | 161

**ITEM 614, PORTABLE CHANGEABLE MESSAGE SIGNS, AS PER PLAN**

THE CONTRACTOR SHALL FURNISH, INSTALL, MAINTAIN AND REMOVE, WHEN NO LONGER NEEDED, A CHANGEABLE MESSAGE SIGN. THE SIGN SHALL BE OF A TYPE SHOWN ON A LIST OF APPROVED PCMS UNITS AVAILABLE ON THE OFFICE OF MATERIALS MANAGEMENT WEB PAGE. THE LIST CONTAINS CLASS A AND B UNITS WITH MINIMUM LEGIBILITY DISTANCES OF 800 FEET AND 650 FEET, RESPECTIVELY.

EACH SIGN SHALL BE TRAILER-MOUNTED AND EQUIPPED WITH A FUNCTIONAL DIMMING MECHANISM, TO DIM THE SIGN DURING DARKNESS, AND A TAMPER AND VANDAL PROOF ENCLOSURE. EACH SIGN SHALL BE PROVIDED WITH APPROPRIATE TRAINING AND OPERATION INSTRUCTIONS TO ENABLE ON-SITE PERSONNEL TO OPERATE AND TROUBLESHOOT THE UNIT. THE SIGN SHALL ALSO BE CAPABLE OF BEING POWERED BY AN ELECTRICAL SERVICE DROP FROM A LOCAL UTILITY COMPANY. THE PCMS SHALL BE DELINEATED IN ACCORDANCE WITH C&MS 614.03.

PLACEMENT, OPERATION, MAINTENANCE AND ALL ACTIVATION OF THE SIGNS BY THE CONTRACTOR SHALL BE AS DIRECTED BY THE ENGINEER. THE PCMS SHALL BE LOCATED IN A HIGHLY VISIBLE POSITION YET PROTECTED FROM TRAFFIC. THE CONTRACTOR SHALL, AT THE DIRECTION OF THE ENGINEER, RELOCATE THE PCMS TO IMPROVE VISIBILITY OR ACCOMMODATE CHANGED CONDITIONS. WHEN NOT IN USE, THE PCMS SHALL BE TURNED OFF. ADDITIONALLY, WHEN NOT IN USE FOR EXTENDED PERIODS OF TIME, THE PCMS SHALL BE TURNED AWAY FROM ALL TRAFFIC.

THE ENGINEER SHALL BE PROVIDED ACCESS TO EACH SIGN UNIT AND SHALL BE PROVIDED WITH APPROPRIATE TRAINING AND OPERATION INSTRUCTIONS TO ENABLE ODOT PERSONNEL TO OPERATE AND TROUBLESHOOT THE UNIT, AND TO REVISE SIGN MESSAGES, IF NECESSARY.

THE CONTRACTOR SHALL IMPLEMENT A SYSTEM WHEREBY CHANGEABLE MESSAGES WILL BE IMPLEMENTED WITHIN 4 HOURS FOLLOWING TELEPHONE NOTIFICATION FROM THE PROJECT ENGINEER TO A DESIGNATED PHONE.

ALL MESSAGES TO BE DISPLAYED ON THE SIGN WILL BE PROVIDED BY THE ENGINEER. A LIST OF ALL REQUIRED PRE-PROGRAMMED MESSAGES WILL BE GIVEN TO THE CONTRACTOR AT THE PROJECT PRECONSTRUCTION CONFERENCE. THE SIGN SHALL HAVE THE CAPABILITY TO STORE UP TO 99 MESSAGES. MESSAGE MEMORY OR PRE-PROGRAMMED DISPLAYS SHALL NOT BE LOST AS A RESULT OF POWER FAILURES TO THE ON-BOARD COMPUTER. THE SIGN LEGEND SHALL BE CAPABLE OF BEING CHANGED IN THE FIELD. THREE-LINE PRESENTATION FORMATS WITH UP TO SIX MESSAGE PHASES SHALL BE SUPPORTED. PCMS FORMAT SHALL PERMIT THE COMPLETE MESSAGE FOR EACH PHASE TO BE READ AT LEAST TWICE.

THE PCMS SHALL CONTAIN AN ACCURATE CLOCK AND PROGRAMMING LOGIC WHICH WILL ALLOW THE SIGN TO BE ACTIVATED, DEACTIVATED OR MESSAGES CHANGED AUTOMATICALLY AT DIFFERENT TIMES OF THE DAY FOR DIFFERENT DAYS OF THE WEEK.

**ITEM 614, PORTABLE CHANGEABLE MESSAGE SIGNS, AS PER PLAN (CONT.)**

THE PCMS SHALL CONTAIN A CELLULAR TELEPHONE DATA LINK WHICH WILL (IN ACTIVE CELLULAR PHONE AREAS) ALLOW REMOTE SIGN ACTIVATION, MESSAGE CHANGES, MESSAGE ADDITIONS AND REVISIONS TO TIME OF DAY PROGRAMS. THE SYSTEM SHALL ALSO PERMIT VERIFICATION OF CURRENT AND PROGRAMMED MESSAGES. ONE REMOTE DATA INPUT DEVICE (LAPTOP COMPUTER PLUS MODEM OR EQUIVALENT) SHALL BE FURNISHED FOR USE BY THE DISTRICT TRAFFIC ENGINEER, OR EQUIVALENT, AND SHALL BE INSURED AGAINST THEFT. THE PCMS UNIT SHALL BE MAINTAINED IN GOOD WORKING ORDER BY THE CONTRACTOR IN ACCORDANCE WITH THE PROVISIONS OF C&MS 614.07. THE CONTRACTOR SHALL, PRIOR TO ACTIVATING THE UNIT, MAKE ARRANGEMENTS, WITH AN AUTHORIZED SERVICE AGENT FOR THE PCMS, TO ASSURE PROMPT SERVICE IN THE EVENT OF FAILURE. ANY FAILURE SHALL NOT RESULT IN THE SIGN BEING OUT OF SERVICE FOR MORE THAN 12 HOURS, INCLUDING WEEKENDS. FAILURE TO COMPLY MAY RESULT IN AN ORDER TO STOP WORK AND OPEN ALL TRAFFIC LANES AND/OR IN THE DEPARTMENT TAKING APPROPRIATE ACTION TO SAFELY CONTROL TRAFFIC. THE ENTIRE COST TO CONTROL TRAFFIC, ACCRUED BY THE DEPARTMENT DUE TO THE CONTRACTOR'S NONCOMPLIANCE, WILL BE DEDUCTED FROM MONEYS DUE, OR TO BECOME DUE THE CONTRACTOR ON HIS CONTRACT.

THE CONTRACTOR SHALL BE RESPONSIBLE FOR 24-HOUR-PER-DAY OPERATION AND MAINTENANCE OF THESE SIGNS ON THE PROJECT FOR THE DURATION OF THE PHASES WHEN THE PLAN REQUIRES THEIR USE.

PAYMENT FOR THE ABOVE DESCRIBED ITEM SHALL BE AT THE CONTRACT UNIT PRICE. PAYMENT SHALL INCLUDE ALL LABOR, MATERIALS, EQUIPMENT, FUELS, LUBRICATING OILS, SOFTWARE, HARDWARE AND INCIDENTALS TO PERFORM THE ABOVE DESCRIBED WORK.

ITEM 614, PORTABLE CHANGEABLE MESSAGE SIGN, AS PER PLAN  
3.5 SIGN MONTHS ASSUMING 2 PCMS SIGNS FOR 7 MONTHS



DESIGN AGENCY	EGD
CLIENT	EGD
DESIGNER	EGD
REVIEWER	MJV 05/02/22
PROJECT ID	109550
SHEET	TOTAL
P. 09A	161

**SR 529 DETOUR  
PHASE 1**

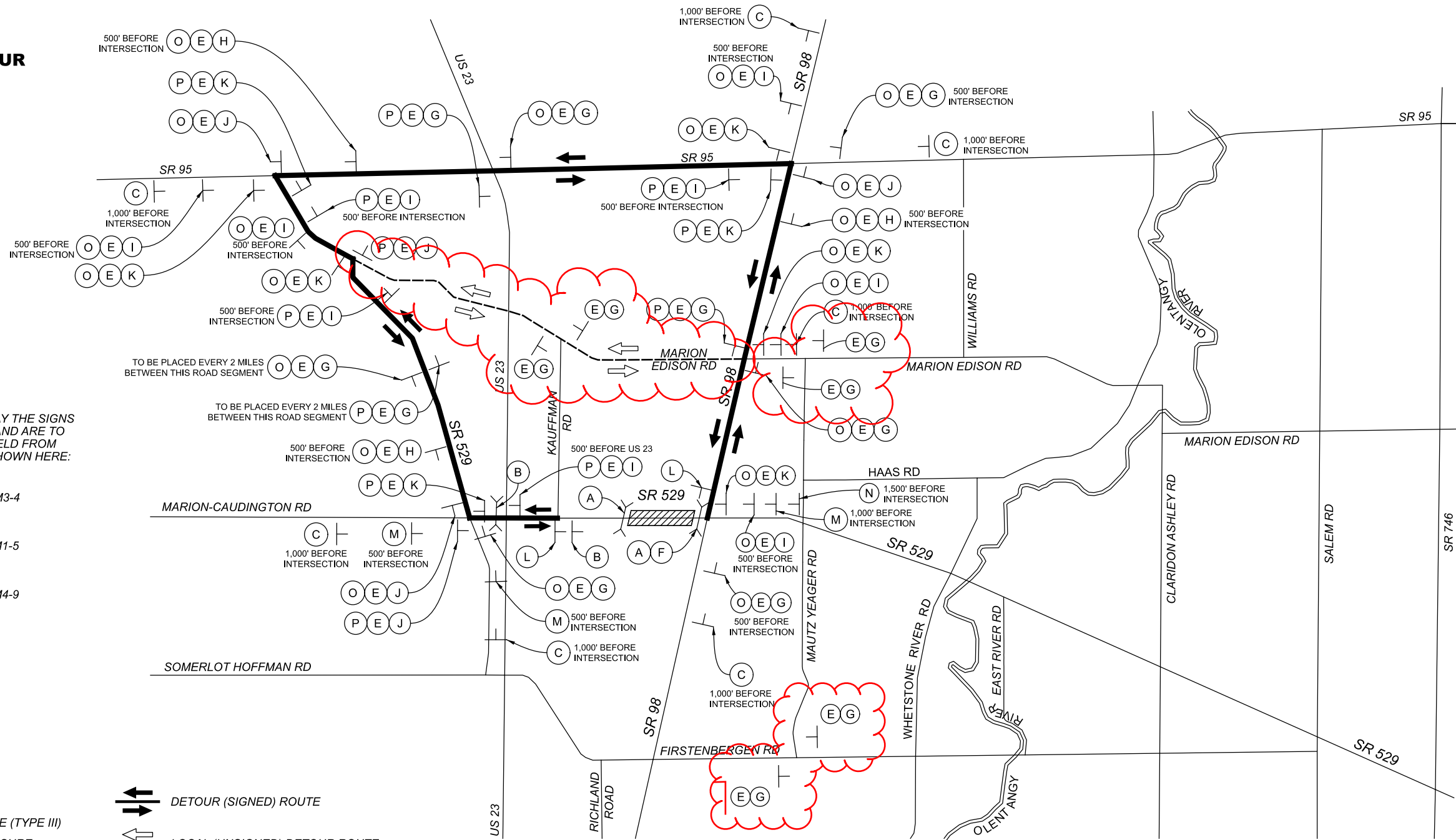

**NOTE**  
1. DETOUR PLANS DISPLAY THE SIGNS FROM LEFT TO RIGHT AND ARE TO BE ERECTED IN THE FIELD FROM TOP TO BOTTOM. AS SHOWN HERE:

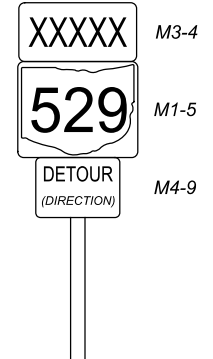

**LEGEND**

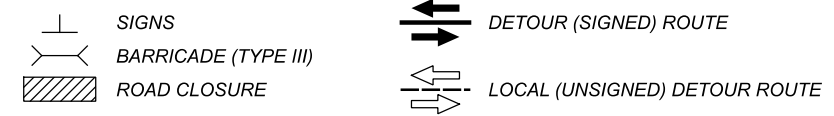

**SIGNING LEGEND**

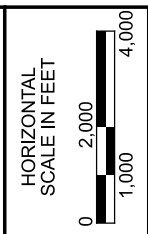
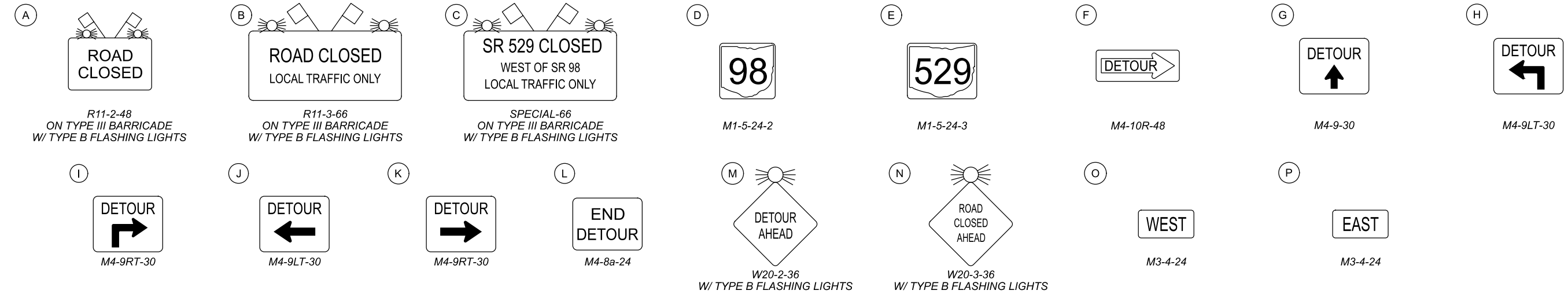

**MAINTENANCE OF TRAFFIC  
SR 529: DETOUR PLAN - PHASE 1**

MAR-98-6.22

MODEL: Sheet PAPER: 34x22 (in.) DATE: 4/27/2022 TIME: 4:03 PM USER: i426eegd  
X:\4037000\190724\01\09550\MAR-98-6.22\400-Engineer\mg\01\Sheets\09550\_MD001.dgn

DESIGN AGENCY	<b>SINGH</b>
DESIGNER	RO
REVIEWER	EGD 08-18-21
PROJECT ID	109550
SHEET	TOTAL
P. 11	156

**SR 98 DETOUR  
PHASE 2**

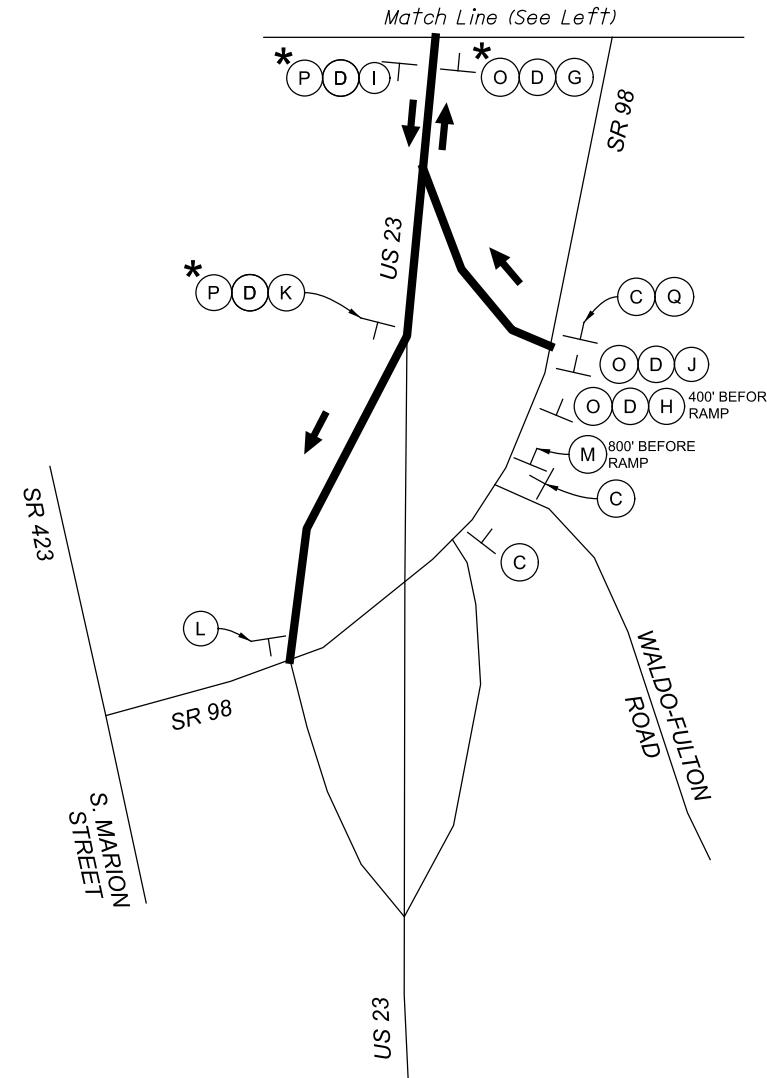
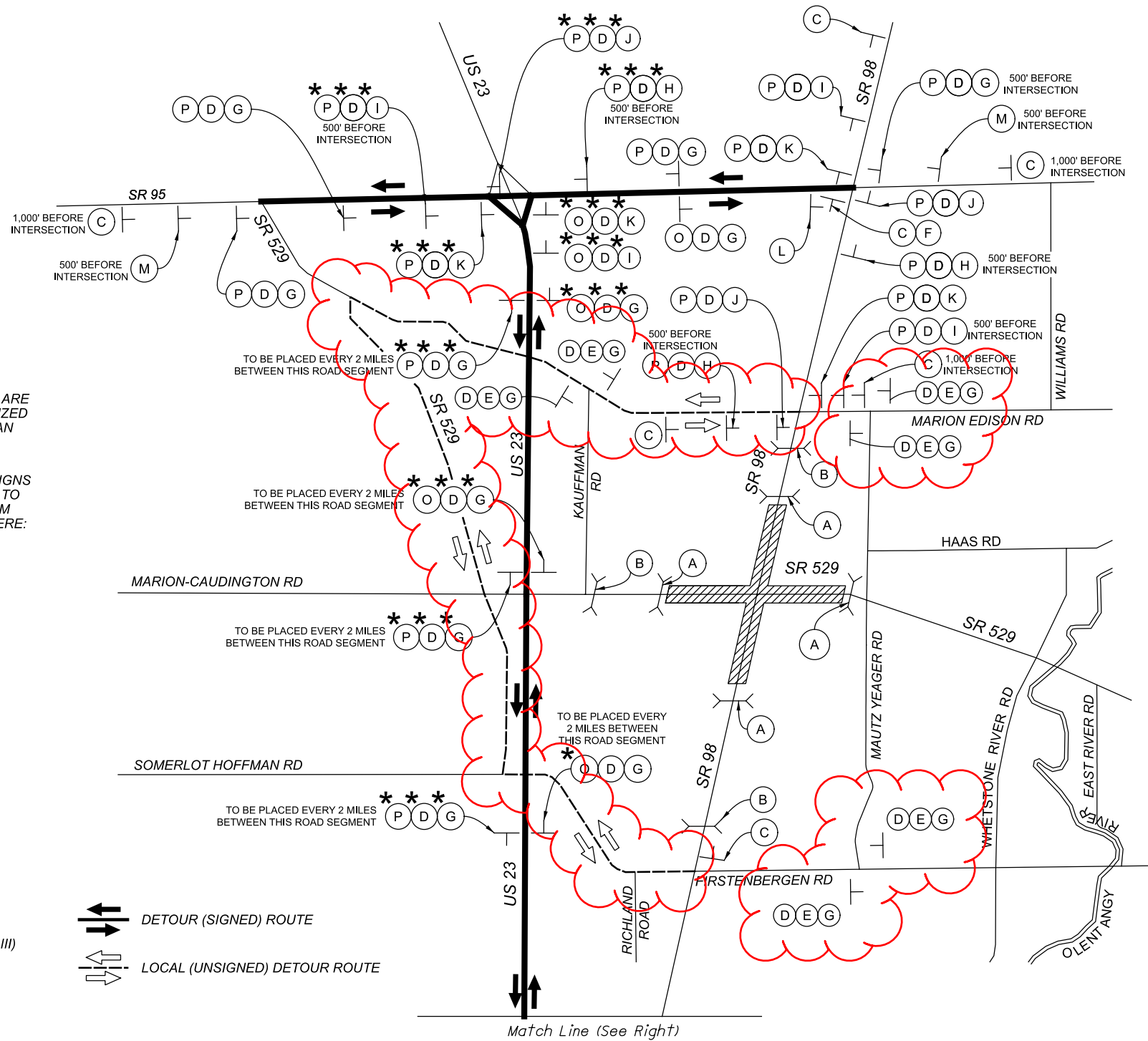

**NOTES**

- SIGNS WITH AN ASTERISK (\*) ARE TO BE PLACED USING THE UPSIZED DIMENSIONS. SEE SIZES WITH AN ASTERISK IN SIGNING LEGEND BELOW FOR DIMENSIONS.
- DETOUR PLANS DISPLAY THE SIGNS FROM LEFT TO RIGHT AND ARE TO BE ERECTED IN THE FIELD FROM TOP TO BOTTOM. AS SHOWN HERE:

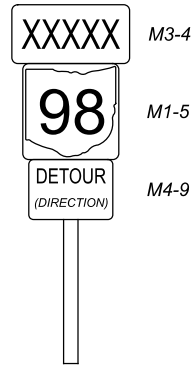

**LEGEND**

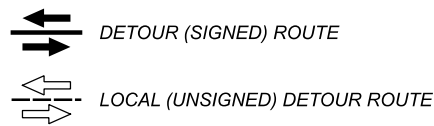
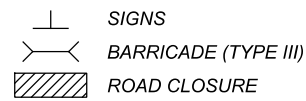

**SIGNING LEGEND**

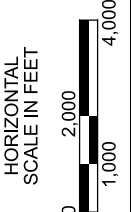
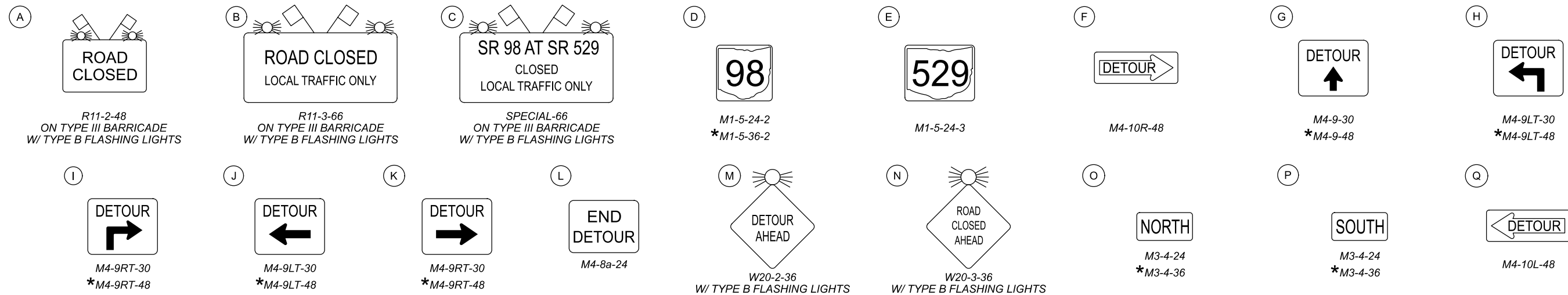

**MAINTENANCE OF TRAFFIC  
SR 98: DETOUR PLAN - PHASE 2**

DESIGN AGENCY  
**SINGH**  
SINGH + ASSOCIATES, INC.  
CONSULTING ENGINEERS

CLIENT

DESIGNER  
RO

REVIEWER  
EGD 08-18-21

PROJECT ID  
109550

SHEET TOTAL  
P. 12 | 161

MAR-98-6.22

MODEL: Sheet PAPER SIZE: 34x22 (in.) DATE: 4/27/2022 TIME: 12:25 PM USER: h26eggd X:\4037000\190724\01\09550\MAR-98-6.22\400-Engineer\ng\MOT\Sheets\09550\_MD002A.dgn

**SR 529 DETOUR  
PHASE 2**

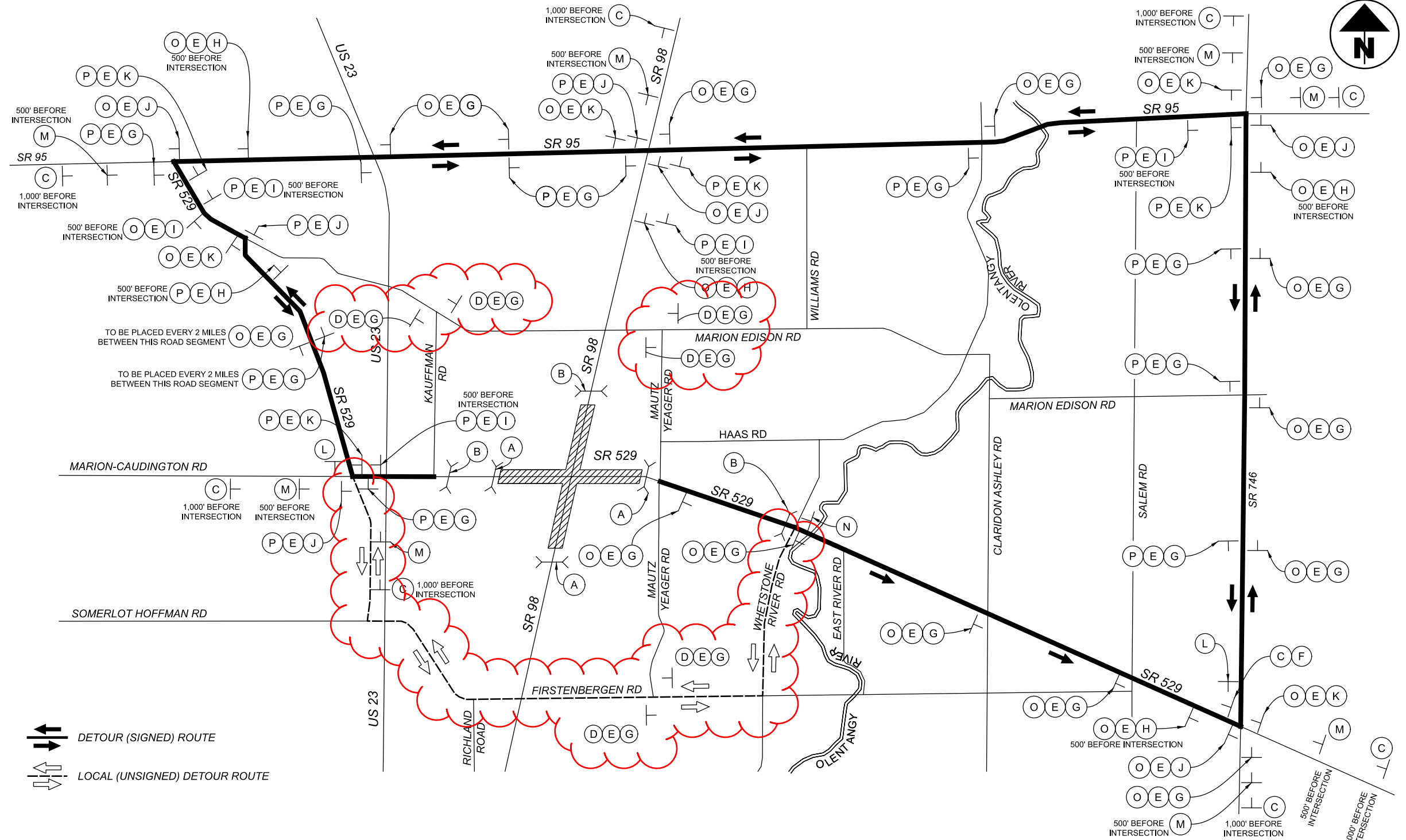

**NOTE**  
1. DETOUR PLANS DISPLAY THE SIGNS FROM LEFT TO RIGHT AND ARE TO BE ERECTED IN THE FIELD FROM TOP TO BOTTOM. AS SHOWN HERE:

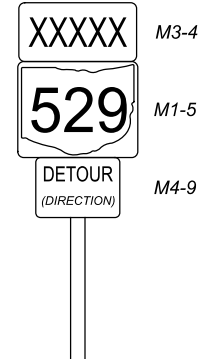

**LEGEND**

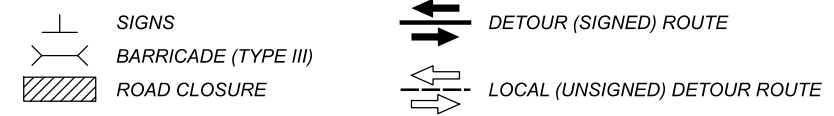

**SIGNING LEGEND**

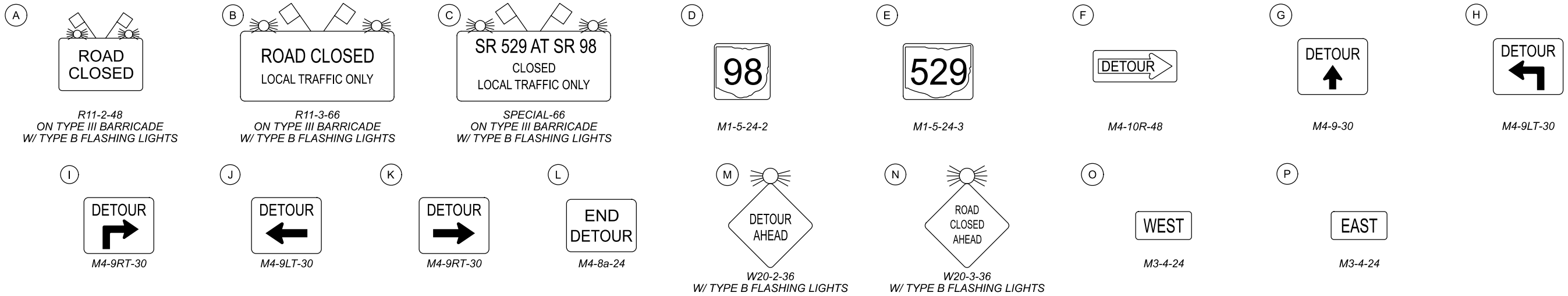

MAR-98-6.22

MODEL: Sheet PAPER: 34x22 (in.) DATE: 4/27/2022 TIME: 11:32 PM USER: i426eod  
 X:\4037000\190724\01\09550\MAR-98-6.22\400-Engineer\ng\01\Sheets\09550\_MD002B.dgn



**MAINTENANCE OF TRAFFIC  
SR 529: DETOUR PLAN - PHASE 2**

DESIGN AGENCY	<b>SINGH</b>
DESIGNER	RO
REVIEWER	EGD 08-18-21
PROJECT ID	109550
SHEET	TOTAL
P. 13	156



**SR 529 DETOUR  
PHASE 3**

**NOTE**

1. DETOUR PLANS DISPLAY THE SIGNS FROM LEFT TO RIGHT AND ARE TO BE ERECTED IN THE FIELD FROM TOP TO BOTTOM. AS SHOWN HERE:

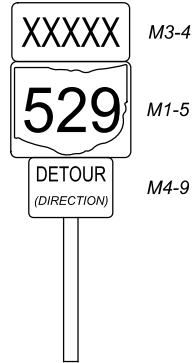

**LEGEND**

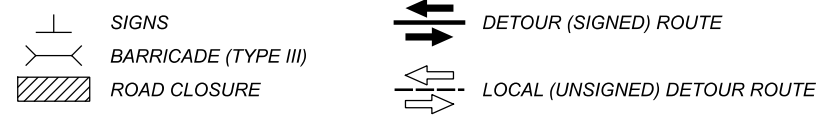

**SIGNING LEGEND**

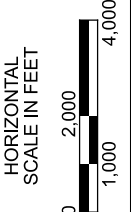
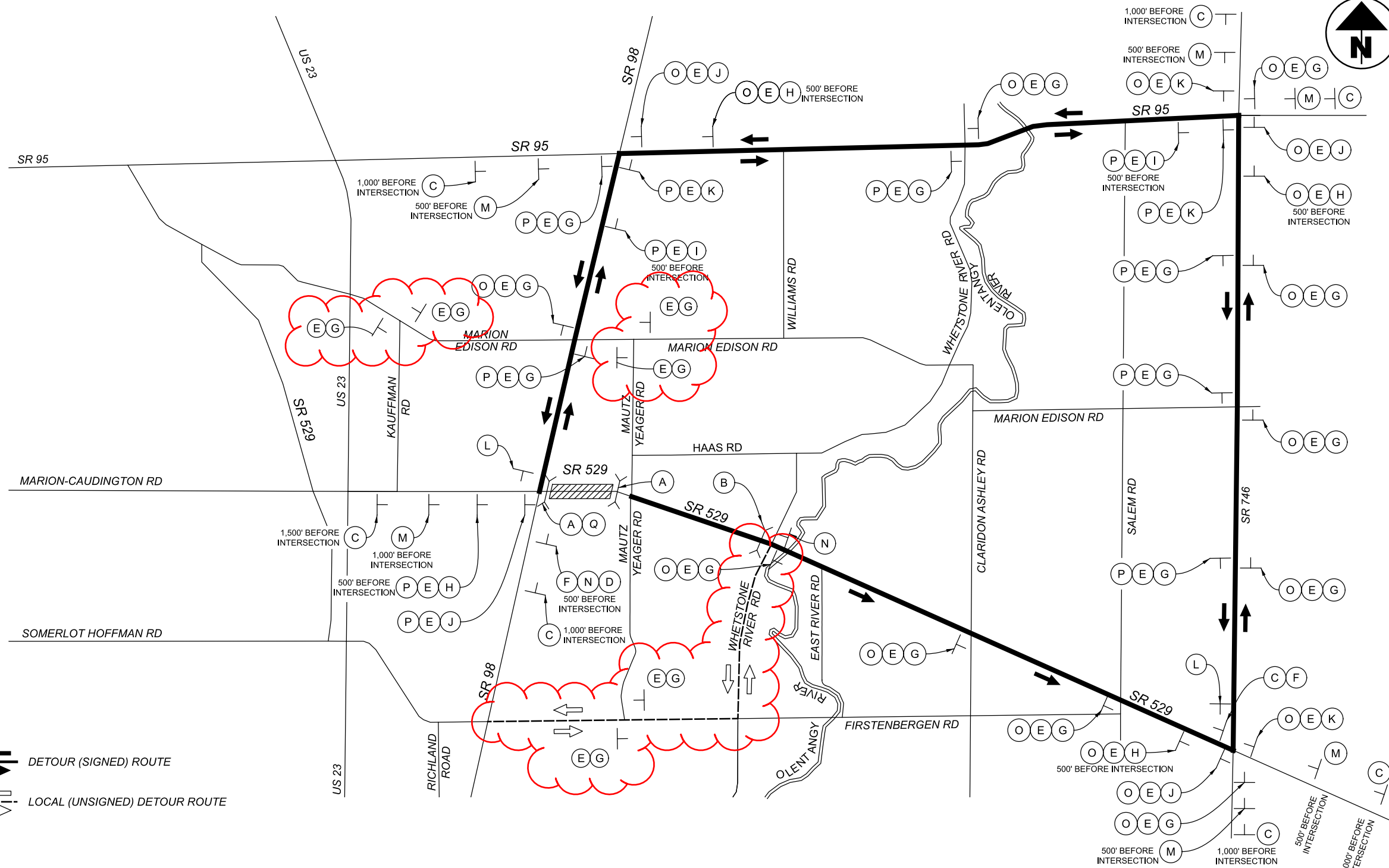
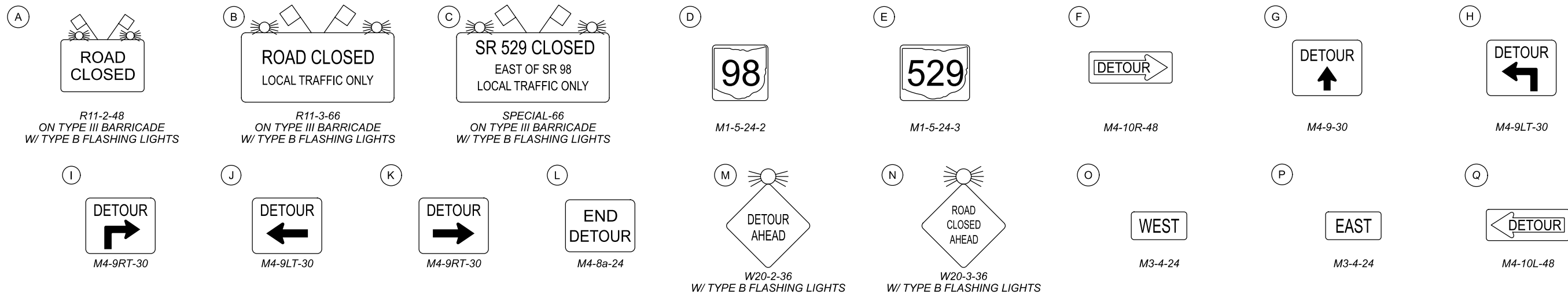

**MAINTENANCE OF TRAFFIC  
SR 529: DETOUR PLAN - PHASE 3**

DESIGN AGENCY  
**SINGH**  
SINGH & ASSOCIATES, INC.  
CONSULTING ENGINEERS  
CLIENT

DESIGNER  
RO

REVIEWER  
EGD 08-18-21

PROJECT ID  
109550

SHEET TOTAL  
P. 14 | 156

MAR-98-6.22

MODEL: Sheet PAPER SIZE: 34x22 (in.) DATE: 4/27/2022 TIME: 11:40 PM USER: l426egd X:\4037000\190724\01\09550\MAR-98-6.22\400-Engineer\ng\m01\Sheets\09550\_MD003.dgn

MAR-98-6-22

MODEL: Sheet PAPER: 34x22 (in.) DATE: 5/4/2022 TIME: 10:18:01 AM USER: 1426egrd X:\4037000\190724.01\109550\_MAR-98-6-22\400-Engineering\Roadway\Sheets\109550\_GG002.dgn

SHEET NUM.											PART.		ITEM	ITEM EXT	GRAND TOTAL	UNIT	DESCRIPTION	SEE SHEET NO.
8	45	46	47	48	49	92	PAVT CALCS	01/SAF/PV	02/STR/CV									
		1.4	1.1							1.4	1.1	602	20000	2.5	CY	<b>DRAINAGE</b> CONCRETE MASONRY		
				941						941		605	13300	941	FT	6" UNCLASSIFIED PIPE UNDERDRAINS		
				2,681						2,681		605	14000	2,681	FT	6" BASE PIPE UNDERDRAINS		
				319						319		611	00510	319	FT	6" CONDUIT, TYPE F FOR UNDERDRAIN OUTLETS		
		100								100		611	01500	100	FT	6" CONDUIT, TYPE F		
			200							200		611	02500	200	FT	8" CONDUIT, TYPE E		
		165	100							265		611	04400	265	FT	12" CONDUIT, TYPE B		
			232								232	611	04600	232	FT	12" CONDUIT, TYPE C		
		20								20		611	04601	20	FT	12" CONDUIT, TYPE C, AS PER PLAN	7	
		177								177		611	06100	177	FT	15" CONDUIT, TYPE C, 706.02		
		45								45		611	06400	45	FT	15" CONDUIT, TYPE D, 706.02		
			96								96	611	07400	96	FT	18" CONDUIT, TYPE B		
		233								233		611	10400	233	FT	24" CONDUIT, TYPE B		
		77								77		611	16400	77	FT	36" CONDUIT, TYPE B		
		67								67		611	19400	67	FT	42" CONDUIT, TYPE B		
		196								196		611	19600	196	FT	42" CONDUIT, TYPE C		
		382								382		611	20900	382	FT	48" CONDUIT, TYPE B		
			1,754								1,754	611	21100	1,754	FT	48" CONDUIT, TYPE C		
			265								265	611	21100	265	FT	48" CONDUIT, TYPE C, 706.02		
			20							20		611	97400	20	FT	CONDUIT, MISC.:TYPE B FOR DRAINAGE DISCHARGE CONTINUANCE	7	
			20							20		611	97400	20	FT	CONDUIT, MISC.:TYPE C FOR DRAINAGE DISCHARGE CONTINUANCE	7	
			20							20		611	97400	20	FT	CONDUIT, MISC.:TYPE E FOR DRAINAGE DISCHARGE CONTINUANCE	7	
			20							20		611	97400	20	FT	CONDUIT, MISC.:TYPE F FOR DRAINAGE DISCHARGE CONTINUANCE	7	
		2	1							2	1	611	98410	3	EACH	CATCH BASIN, NO. 8		
			7								7	611	98434	7	EACH	CATCH BASIN, NO. 8A		
		2	4							2	4	611	98470	6	EACH	CATCH BASIN, NO. 2-2B		
		2								2		611	98540	2	EACH	CATCH BASIN, NO. 2-4		
		1								1		611	99574	1	EACH	MANHOLE, NO. 3		
				4						4		611	99710	4	EACH	PRECAST REINFORCED CONCRETE OUTLET		
			4							4		611	99720	4	EACH	INSPECTION WELL		
																<b>PAVEMENT</b>		
300	16					14	1,124			1,454		301	56000	1,454	CY	ASPHALT CONCRETE BASE, PG64-22, (449)		
300	105					8	1,765			2,170		304	20000	2,170	CY	AGGREGATE BASE		
						8				8		407	10000	8	GAL	TACK COAT		
										4,415		407	20000	4,415	GAL	NON-TRACKING TACK COAT		
		100				5	1,315			311		441	50000	311	CY	ASPHALT CONCRETE SURFACE COURSE, TYPE 1, (448), PG64-22		
		300	6							330		442	10000	380	CY	ASPHALT CONCRETE SURFACE COURSE, 12.5 MM, TYPE A (446)		
							330			386		442	10080	386	CY	ASPHALT CONCRETE INTERMEDIATE COURSE, 12.5 MM, TYPE A (446)		
							743			743		451	11010	743	SY	7" REINFORCED CONCRETE PAVEMENT, CLASS QC 1P		
						155	743			155		452	10010	155	SY	6" NON-REINFORCED CONCRETE PAVEMENT, CLASS QC 1P		
										1,785		609	12000	1,785	FT	COMBINATION CURB AND GUTTER, TYPE 2		
										1,942		609	26000	1,942	FT	CURB, TYPE 6		
						46				283		609	31000	283	FT	COMBINATION CURB AND GUTTER, TYPE 9		
										688		609	31001	688	FT	COMBINATION CURB AND GUTTER, TYPE 9, AS PER PLAN	5	
										942		609	70000	942	SY	4" CONCRETE MEDIAN		
										1,000		617	10100	1,000	CY	COMPACTED AGGREGATE, TYPE A		

GENERAL SUMMARY

DESIGN AGENCY  
**Mead & Hunt**  
CLIENT

DESIGNER  
ANM  
REVIEWER  
DCB 09/14/21  
PROJECT ID  
109550  
SHEET TOTAL  
P.43 | 161

MAR-98-6.22

MODEL: Sheet PAPER: 17x11 (in.) DATE: 5/6/2022 TIME: 11:28:31 AM USER: 1426egpd X:\4037000\190724\01109550\_MAR-98-6.22\400-Engineering\Roadway\Sheets\109550\_GG003.dwg

SHEET NUM.											PART.		ITEM	ITEM EXT	GRAND TOTAL	UNIT	DESCRIPTION	SEE SHEET NO.
8	45	109	110	111	112	124					01/SAF/PV	02/STR/CV						
<b>LIGHTING</b>																		
											8		625	00450	8	EACH	CONNECTION, FUSED PULL APART	
											8		625	00460	8	EACH	CONNECTION, UNFUSED PULL APART	
											6		625	00480	6	EACH	CONNECTION, UNFUSED PERMANENT	
											8		625	10490	8	EACH	LIGHT POLE, CONVENTIONAL, AT12B40	
											8		625	14100	8	EACH	LIGHT POLE FOUNDATION, 24" X 8' DEEP	
											3,315		3,315	23200	3,315	FT	NO. 4 AWG 2400 VOLT DISTRIBUTION CABLE	
											1,248		1,248	23400	1,248	FT	NO. 10 AWG POLE AND BRACKET CABLE	
											860		860	25500	860	FT	CONDUIT, 3", 725.04	
											80		625	25902	80	FT	CONDUIT, JACKED OR DRILLED, 725.04, 3"	
											8		625	26252	8	EACH	LUMINAIRE, CONVENTIONAL, SOLID STATE (LED), 14000 - 15300 LUMENS	123
											860		860	29002	860	FT	TRENCH, 24" DEEP	
											4		625	30700	4	EACH	PULL BOX, 725.08, 18"	
											1		625	30706	1	EACH	PULL BOX, 725.08, 24"	
											8		625	32000	8	EACH	GROUND ROD	
											1		625	34001	1	EACH	POWER SERVICE, AS PER PLAN	123
											860		860	36010	860	FT	UNDERGROUND WARNING/MARKING TAPE	
											1		625	76000	1	EACH	ARC FLASH CALCULATIONS AND LABEL LIGHTING CENTER	123
<b>TRAFFIC CONTROL</b>																		
					42						50		621	00300	50	EACH	RPM REFLECTOR, 1-WAY, WHITE	
					29						35		621	00300	35	EACH	RPM REFLECTOR, 1-WAY, YELLOW	
											204		630	02100	204	FT	GROUND MOUNTED SUPPORT, NO. 2 POST	
											416.6		630	03100	416.6	FT	GROUND MOUNTED SUPPORT, NO. 3 POST	
											8		630	08600	8	EACH	SIGN POST REFLECTOR	
											295.8		630	80100	295.8	SF	SIGN, FLAT SHEET	
											45		630	85000	45	EACH	REMOVAL OF GROUND MOUNTED SIGN AND STORAGE	
											27		630	86002	27	EACH	REMOVAL OF GROUND MOUNTED POST SUPPORT AND DISPOSAL	
											2		642	00300	2	MILE	CENTER LINE, TYPE 1	
											0.52		644	00104	0.52	MILE	EDGE LINE, 6", "WHITE"	
											0.3		644	00104	0.3	MILE	EDGE LINE, 6", "YELLOW"	
											0.34		644	00300	0.34	MILE	CENTER LINE "DOUBLE SOLID"	
											96		644	00620	96	FT	CROSSWALK LINE, 12"	
											109		644	01520	109	FT	DOTTED LINE, 12"	
											48		644	20800	48	FT	YIELD LINE	
<b>MAINTENANCE OF TRAFFIC</b>																		
											100		410	10000	100	CY	TRAFFIC COMPACTED SURFACE, TYPE A OR B	
											100		410	13000	100	CY	TRAFFIC COMPACTED SURFACE, TYPE C	
											96		614	11110	96	HOUR	LAW ENFORCEMENT OFFICER WITH PATROL CAR FOR ASSISTANCE	10
											LS		614	12420	LS		DETOUR SIGNING	10
											300		614	13000	300	CY	ASPHALT CONCRETE FOR MAINTAINING TRAFFIC	
											7		614	18601	7	SNMT	PORTABLE CHANGEABLE MESSAGE SIGN, AS PER PLAN	
											1.12		614	21550	1.12	MILE	WORK ZONE CENTER LINE, CLASS III, 642 PAINT	
											1.98		614	22360	1.98	MILE	WORK ZONE EDGE LINE, CLASS III, 6", 642 PAINT	
											109		614	24618	109	FT	WORK ZONE DOTTED LINE, CLASS III, 12", 642 PAINT	
											10		614	26610	10	FT	WORK ZONE STOP LINE, CLASS III, 642 PAINT	
											4		614	30650	4	EACH	WORK ZONE ARROW, CLASS III, 642 PAINT	
											87		614	98100	87	FT	WORK ZONE PAVEMENT MARKING, MISC.: YIELD LINE, CLASS III, 642 PAINT	8
											150		616	10000	150	MGAL	WATER	
											LS		108	10000	LS		INCIDENTALS	
											LS		614	11000	LS		CPM PROGRESS SCHEDULE	7
											6		619	16010	6	MNTH	MAINTAINING TRAFFIC	9
											LS		623	10000	LS		FIELD OFFICE, TYPE B	
											LS		624	10000	LS		CONSTRUCTION LAYOUT STAKES AND SURVEYING	
											LS		624	10000	LS		MOBILIZATION	

GENERAL SUMMARY

DESIGN AGENCY  
**Mead & Hunt**

CLIENT

DESIGNER  
ANM

REVIEWER  
DCB 09/14/21

PROJECT ID  
109550

SHEET TOTAL  
P.44 | 161

REFERENCE	SHEET NO	STATION RANGE	SIDE	TYPE	DISTANCE (D)	APRON AREA	DRIVE AREA	202	204	301	407	441	452	609
					FT	SQ FT	SQ FT	PAVEMENT REMOVED	SUBGRADE COMPACTION	ASPHALT CONCRETE BASE, PG64-22, (449)	TACK COAT	ASPHALT CONCRETE SURFACE COURSE, TYPE 1, (448), PG64-22	6" NON-REINFORCED CONCRETE PAVEMENT, CLASS QC 1P	CURB, TYPE 6
SUBTOTALS								239.05	295.94	13.79	7.80	4.92	154.11	45.16
TOTALS CARRIED TO GENERAL SUMMARY								240	296	14	8	5	155	46
DW1	93	23+60.69	RT	RES ASPH		704.00	118.00	40.84	91.33	8.88	5.02	3.17		
DW2	94	25+68.44	RT	RES CONC		345.00	570.00	101.22	101.67				101.67	
DW3	95	27+10.79	RT	RES ASPH		305.64	148.84	70.12	50.50	4.91	2.78	1.75		
DW4	96	82+02.91	LT	RES CONC		381.00	91.00	26.86	52.44				52.44	45.16

DRIVE DETAILS

RESIDENTIAL ASPHALT (ALONG SR 98)

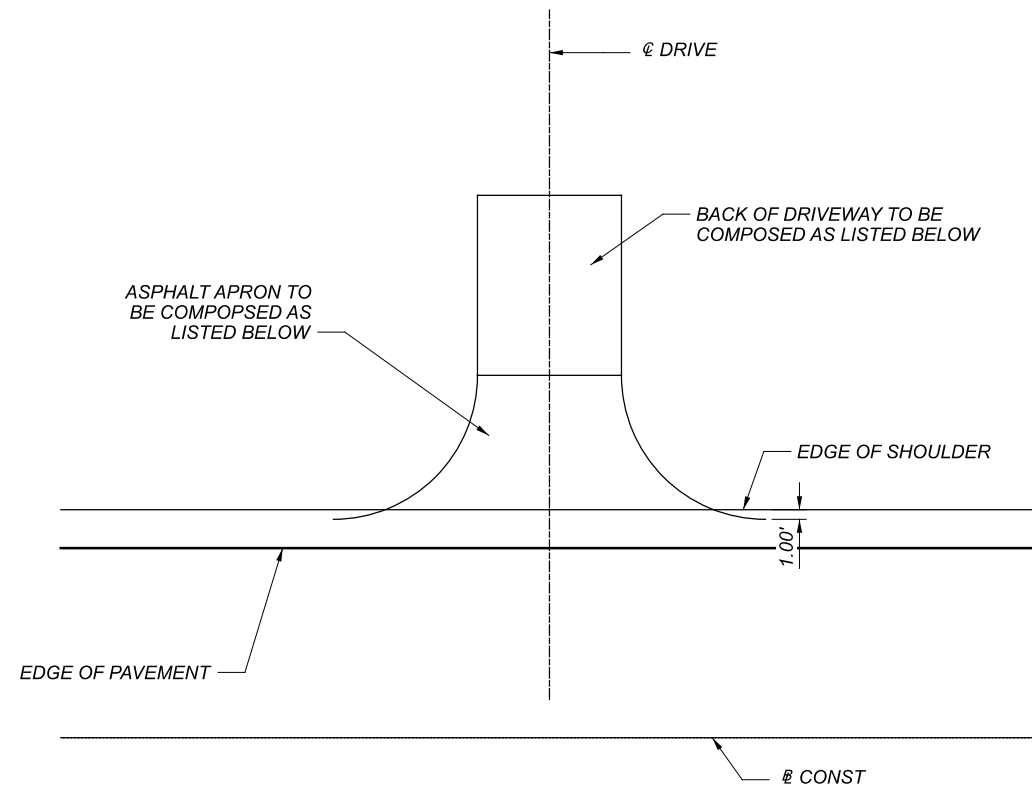

RESIDENTIAL ASPHALT DRIVES

- ITEM 441 - 1.25" ASPHALT CONCRETE SURFACE COURSE, TYPE 1, (448), PG64-22
- ITEM 407 - TACK COAT
- ITEM 301 - 3.5" ASPALT CONCRETE BASE

RESIDENTIAL CONCRETE (ALONG SR 529)

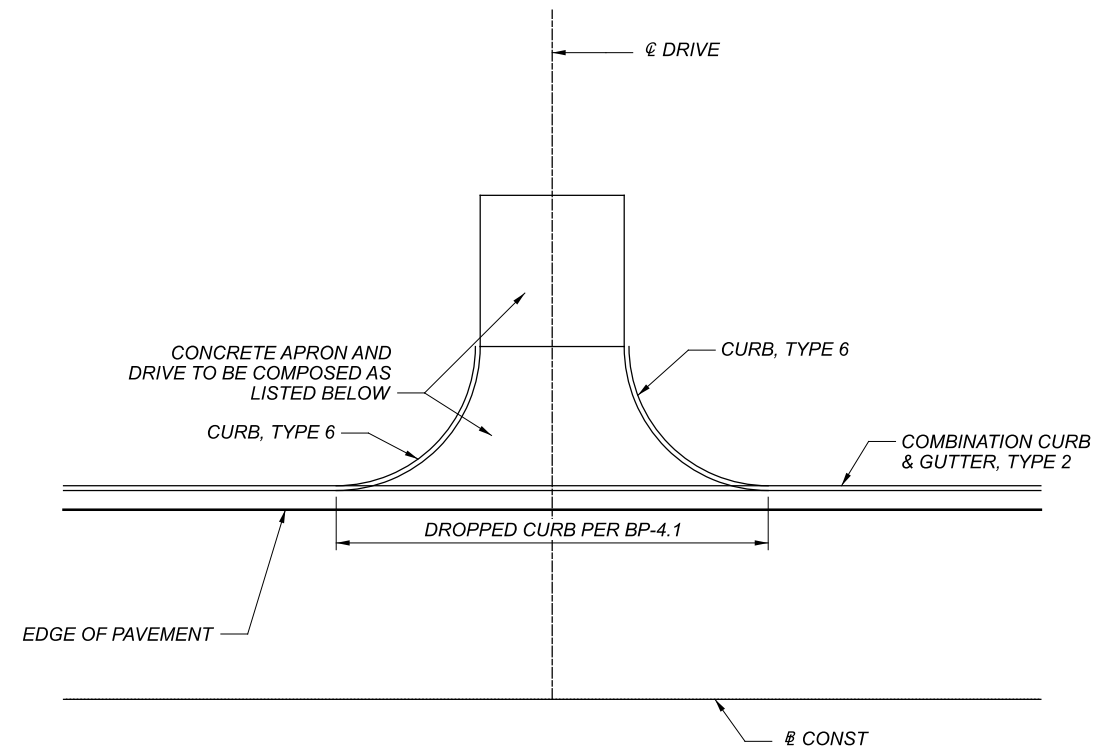

RESIDENTIAL CONCRETE DRIVES (APRON & DRIVE)

ITEM 454 - 6" NON-REINFORCED CONCRETE PAVEMENT

DESIGN AGENCY  
**Mead & Hunt**  
CLIENT



DESIGNER  
C.JL

REVIEWER  
SJS 10/09/20

PROJECT ID  
110876

SHEET TOTAL  
P.92 | 161

MAR-98-6.22

MODEL: Sheet PAPER SIZE: 34x22 (in.) DATE: 4/27/2022 TIME: 1:45:50 PM USER: jk@mead  
X:\4037000\190724\011\09550\_MAR-98-6.22\400-Engineering\Traffic\Sheets\09550\_1\_002.dgn

SHEET NO.	REFERENCE NO.	LOCATION	STATION	SIDE	CODE	SIZE (INCHES)	630	630	630	630	630	630																	
							GROUND MOUNTED SUPPORT, NO. 2 POST	GROUND MOUNTED SUPPORT, NO. 3 POST	SIGN POST REFLECTOR	SIGN, FLAT SHEET	REMOVAL OF GROUND MOUNTED SIGN AND STORAGE	REMOVAL OF GROUND MOUNTED POST SUPPORT AND DISPOSAL	FT	FT	EACH	SF	EACH	EACH											
119	S16	SR 529	79+10.00	RT	R1-2-36	36x36	7.0	10.0	1	9.0																			
119	S17	SR 529	79+30.00	RT	R1-2-36	36x36	5.0	10.0	1	9.0																			
119	S18	SR 529	79+32.00	LT	M3-4-24	24x12	8.0	10.0		2.0																			
					M1-5-3-30	30x24				5.0																			
					M6-2R-21	21x15				2.2																			
119	S19	SR 529	80+69.00	RT	M3-2-24	24x12	8.0	10.0		2.0																			
					M1-5-3-30	30x24				5.0																			
					M6-2R-21	21x15				2.2																			
119	S20	SR 529	80+71.00	LT	R1-2-36	36x36	5.0	10.0	1	9.0																			
119	S21	SR 529	80+97.00	LT	R1-2-36	36x36	7.0	10.0	1	9.0																			
120	S22	SR 98	24+00.00	LT	W2-6-30	30x30	7.0	10.0		6.3																			
					W16-17P-24	24x12				2.0																			
120	S23	SR 98	24+75.00	RT	M3-1-24	24x12	7.0	10.0		2.0																			
					M1-5-2-24	24x24				4.0																			
120	S24	SR 98	32+29.00	LT	M2-1-21	21x15	7.0	10.0		2.2																			
					M1-5-3-30	30x24				5.0																			
121	S25	SR 529	74+00.00	LT	M3-4-24	24x12	7.0	10.0		2.0																			
					M1-5-3-30	30x24				5.0																			
121	S26	SR 529	74+00.00	RT	M2-1-21	21x15	7.0	10.0		2.2																			
					M1-5-2-24	24x24				4.0																			
121	S27	SR 529	76+00.00	RT	W2-6-30	30x30	7.0	10.0		6.3																			
					W16-17P-24	24x12				2.0																			
121	S28	SR 529	77+90.00	RT	R4-7-24	24x30	5.0	10.0		5.0																			
122	S29	SR 529	82+65.00	LT	R4-7-24	24x30	5.0	10.0		5.0																			
122	S30	SR 529	84+75.00	LT	W2-6-30	30x30	7.0	10.0		6.3																			
					W16-17P-24	24x12				2.0																			
122	S31	SR 529	85+50.00	RT	M3-2-24	24x12	7.0	10.0		2.0																			
					M1-5-3-30	30x24				5.0																			
122	S32	SR 529	92+75.00	LT	M2-1-21	21x15	7.0	10.0		2.2																			
					M1-5-2-24	24x24				4.0																			
112A	S33	KAUFMAN RD			SPECIAL	36x36		13.8		9.0																			
112A	S34	KAUFMAN RD			SPECIAL	36x36		13.8		9.0																			
112A	S35	MAUTZ YEAGER RD			SPECIAL	36x36		13.8		9.0																			
112A	S36	MAUTZ YEAGER RD			SPECIAL	36x36		13.8		9.0																			
112A	S37	MAUTZ YEAGER RD			SPECIAL	36x36		13.8		9.0																			
112A	S39	MAUTZ YEAGER RD			SPECIAL	36x36		13.8		9.0																			
112A	S39	EAST RIVER RD			SPECIAL	36x36		13.8		9.0																			
TOTALS CARRIED TO GENERAL SUMMARY							113.0	266.6	4	191.9																			

SIGNING SUBSUMMARY

DESIGN AGENCY	<b>Mead &amp; Hunt</b>
CLIENT	
DESIGNER	EGD
REVIEWER	SJS 08/20/21
PROJECT ID	109550
SHEET TOTAL	P.110   161

**LEGEND**

┃ SINGLE POST SIGN

**SIGNING LEGEND**

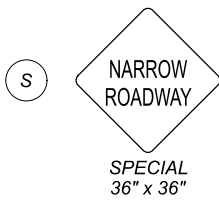

NOTE: SIGNS S33 THROUGH S39 SHALL BE INSTALLED PRIOR TO THE BEGINNING OF CONSTRUCTION AND SHALL REMAIN IN PLACE AT THE COMPLETION OF THIS PROJECT.

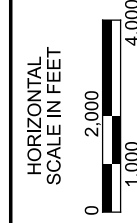
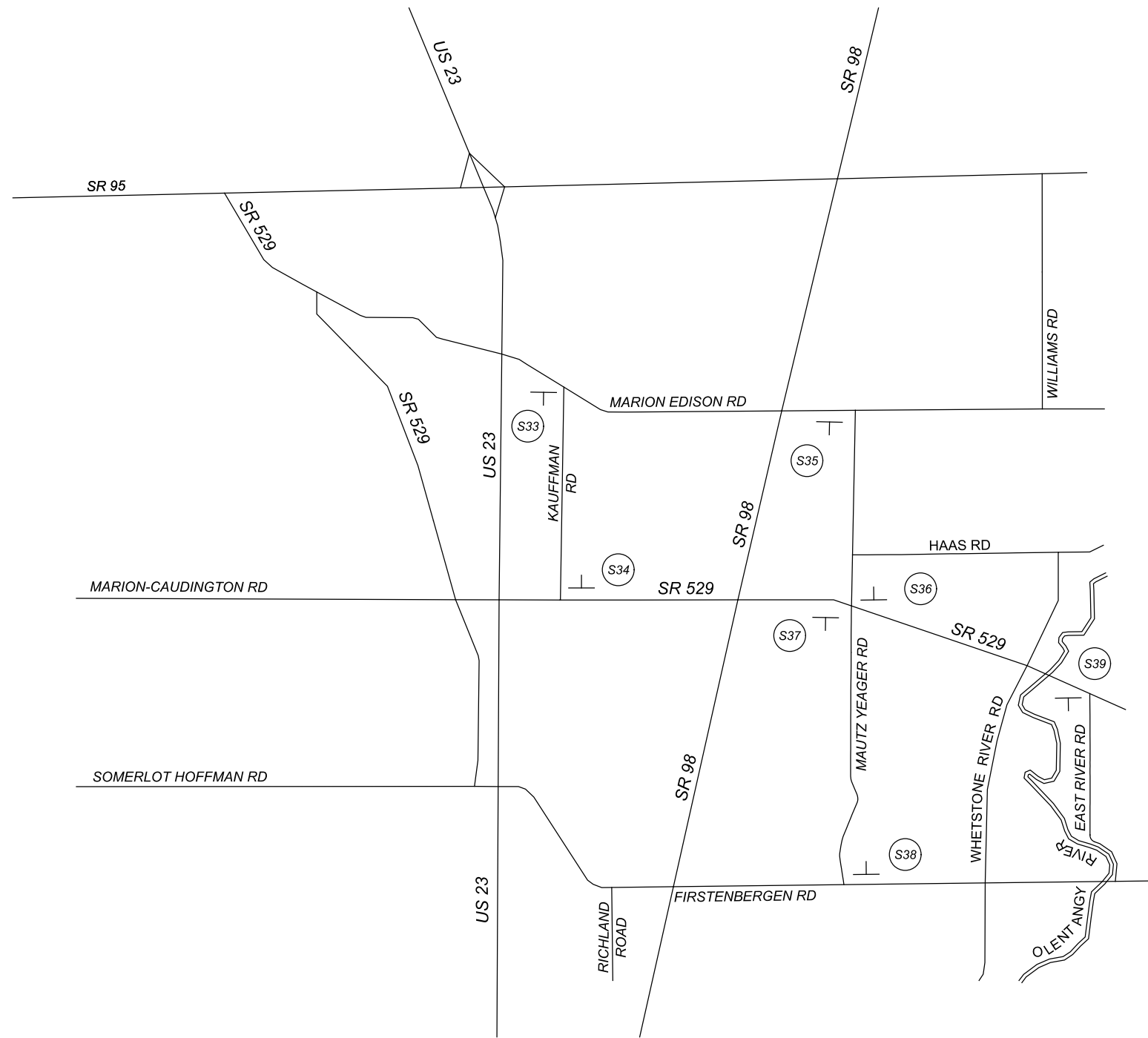

**TRAFFIC CONTROL SCHEMATIC PLAN**

DESIGN AGENCY



CLIENT



DESIGNER

EGD

REVIEWER

MJV 05/02/22

PROJECT ID

109550

SHEET TOTAL

P. 112A 161