

ENVIRONMENTAL COMMITMENTS

1. ODOT SHALL SELF-PERMIT BY OBTAINING THE FLOODPLAIN PERMIT OR DOCUMENTATION OF EXEMPTION PRIOR TO CONSTRUCTION. THE CONTRACTOR SHALL NOT WORK BELOW THE ORDINARY HIGH WATER MARK OF CLEAR CREEK, OR INSTALL, MODIFY, OR REMOVE ANY EXISTING INSTREAM FILLS UNTIL ODOT HAS RECEIVED THE FLOODPLAIN PERMIT OR DOCUMENT OF EXEMPTION.
 2. ODOT SHALL OBTAIN AND ADHERE TO ALL APPROPRIATE WATERWAY PERMITS PRIOR TO ANY WORK BELOW THE ORDINARY HIGH WATER MARK OF ANY WATERWAY AND ALL SPECIAL PROVISIONS FOR WATERWAY PERMITS WILL BE INCLUDED IN THE PLANS. THE CONTRACTOR SHALL NOT PERFORM ANY WORK WITHIN THE BOUNDARIES OF ANY WETLAND OR BELOW THE ORDINARY HIGH WATER MARK (OHWM) OF ANY STREAM UNTIL ODOT OBTAINS THE NECESSARY WATERWAY PERMIT(S). THIS INCLUDES THE PLACEMENT OF ANY TEMPORARY OR PERMANENT FILLS BELOW THE OHWM.
 3. FOR THIS STRUCTURE, A COPY OF THE OHIO ENVIRONMENTAL PROTECTION AGENCY (OHIO EPA) NOTIFICATION OF DEMOLITION AND RENOVATION FORM WITH SECTIONS I-VII, XVII, XVIII COMPLETED BY ODOT WILL BE PROVIDED TO THE CONTRACTOR. THE CONTRACTOR WILL COMPLETE THE OEPA ONLINE NOTIFICATION OF DEMOLITION AND RENOVATION FORM AND PAY THE CALCULATED APPLICABLE FEES TO THE OHIO EPA, AT LEAST 10 BUSINESS DAYS PRIOR TO DEMOLITION/RENOVATION ACTIVITIES. ALL ASSOCIATED FEES MUST BE PAID VIA CREDIT CARD OR BY ELECTRONIC CHECK TO THE OHIO EPA. ALL WORK TO COMPLY WITH THESE REQUIREMENTS AND THE FEES REQUIRED BY THE OHIO EPA SHALL BE INCLUDED IN ITEM 202 - STRUCTURE REMOVED, OVER 20 FOOT SPAN, AS PER PLAN.
- DURING DEMOLITION OF THE STRUCTURE, SHOULD ASBESTOS CONTAINING MATERIAL (ACM) BE FOUND, THE CONTRACTOR SHALL TAKE WHATEVER PRECAUTIONS ARE NECESSARY TO ENSURE THE ACM DOES NOT BECOME FRIABLE. TO ASSURE THE NON-FRIABLE ASBESTOS MATERIAL DOES NOT BECOME FRIABLE OR IN THE EVENT THAT THE NON-FRIABLE MATERIAL BECOMES FRIABLE, THE CONTRACTOR SHALL PROVIDE AN INDIVIDUAL TRAINED IN THE PROVISIONS OF NESHAP THAT WILL BE ON-SITE DURING THE DEMOLITION AND/OR REMOVAL OF THE ACM. ALL ACMS SHALL BE PROPERLY CONTAINERIZED, TRANSPORTED, AND DISPOSED OF IN ACCORDANCE WITH THE STATE AND FEDERAL REGULATIONS. COST TO CONTAIN, TRANSPORT AND DISPOSE OF ACM FOUND UPON DEMOLITION OF THE STRUCTURE WILL BE PAID BY CHANGE ORDER.

CALCULATED
ATS
CHECKED
VAG

GENERAL NOTES

MED - 42 - 2.47

F:\36\36923\3692300\04_CAD\TRNS\94437\Design\Roadway\Sheets\94437_GS001.dgn Sheet 11/10/2020 9:43:23 AM ATStumbo

PAVEMENT CALCULATIONS

STATION TO STATION	SIDE	LENGTH (L)	AVERAGE WIDTH (W)	SURFACE AREA (A) A=LxW	CADD GENERATED AREA	202	254	204	204	204	204	301	304	407	441	441					
						PAVEMENT REMOVED	PAVEMENT PLANING, ASPHALT CONCRETE, 1-1/4"	SUBGRADE COMPACTION	EXCAVATION OF SUBGRADE	GRANULAR MATERIAL, TYPE B, 14"	GEOTEXTILE FABRIC	ASPHALT CONCRETE BASE, PG64-22, 9"	AGGREGATE BASE, 6"	TACK COAT	ASPHALT CONCRETE SURFACE COURSE, TYPE 1, (448), PG64-22, 1-1/4"	ASPHALT CONCRETE SURFACE COURSE, TYPE 1, (448), PG64-22, 1-3/4"					
129+94.45	130+45.75	LT.			880	98															
129+94.45	130+45.75	RT.			868	96															
130+45.75	130+59.57	LT.			134	15															
130+45.75	130+59.57	RT.			120	13															
131+41.58	131+61.76	LT.			148	16															
131+41.58	131+61.76	RT.			171	19															
131+61.76	132+07.16	LT.			766	85															
131+61.76	132+07.16	RT.			782	87															
129+69.45	129+94.45	LT.	25.00	16.38	410																
129+69.45	129+94.45	RT.	25.00	17.22	431																
129+94.45	130+44.45	LT.			883																
129+94.45	130+44.45	RT.			852																
130+44.45	130+64.45	LT.	20.00	22.00	440																
130+44.45	130+64.45	RT.	20.00	22.00	440																
131+37.16	131+57.16	LT.	20.00	22.00	440																
131+37.16	131+57.16	RT.	20.00	22.00	440																
131+57.16	132+07.16	LT.			840																
131+57.16	132+07.16	RT.			914																
132+07.16	132+32.16	LT.	25.00	16.68	417																
132+07.16	132+32.16	RT.	25.00	17.55	439																
SUBTOTALS						429	189	624	237	237	609	99	102	81	21	20					
TOTALS CARRIED TO GENERAL SUMMARY						429	189	624	237	237	609	99	102	81		41					

CALCULATED
ATS
CHECKED
VAG

SUBSUMMARIES

MED - 42 - 2.47

17
43

ROADWAY QUANTITIES TABLE

REF NO.	SHEET NO.	STATION TO STATION		SIDE	202	202	606	606	606	607
					GUARDRAIL REMOVED	FENCE REMOVED	GUARDRAIL, TYPE MGS	ANCHOR ASSEMBLY, MGS TYPE E, MASH 2016	MGS BRIDGE TERMINAL ASSEMBLY, TYPE 1	FENCE, TYPE 47
		FROM	TO	FT	FT	FT	EACH	EACH	FT	
R-1	18	128+86.30	130+55.89	RT.	170					
R-2	18	129+06.36	130+63.68	LT.	157					
R-3	18	131+37.78	132+94.19	RT.	156					
R-4	18	131+45.42	133+14.62	LT.	169					
R-5	18	130+53.04	130+57.07	RT.		24				
R-6	18	130+65.23	130+70.50	LT.		26				
R-7	18	131+32.61	131+36.06	RT.		26				
R-8	18	131+44.42	131+49.15	LT.		24				
GR-1	18	128+84.51	130+61.53	RT.			100	1	1	
GR-2	18	128+92.48	130+69.50	LT.			100	1	1	
GR-3	18	131+32.11	133+09.13	RT.			100	1	1	
GR-4	18	131+40.08	133+17.10	LT.			100	1	1	
F-1	18	130+53.04	130+59.27	RT.						16
F-2	18	130+70.50	130+70.92	LT.						16
F-3	18	131+30.69	131+32.61	RT.						16
F-4	18	131+42.34	131+49.15	LT.						16
TOTALS CARRIED TO GENERAL SUMMARY					652	100	400	4	4	64

EARTHWORK QUANTITIES TABLE

SHEET NO.	STATION TO STATION		203	203
			EXCAVATION	EMBANKMENT
	FROM	TO	CY	CY
19	128+75.00	129+00.00	0	3
20	129+00.00	129+94.45	9	11
21	129+94.45	130+64.45	98	0
22	131+37.16	132+07.16	88	6
23	132+07.16	133+25.00	10	10
TOTALS CARRIED TO GENERAL SUMMARY			205	30

2020-11-10: ADDENDUM 3 - QUANTITIES UPDATED

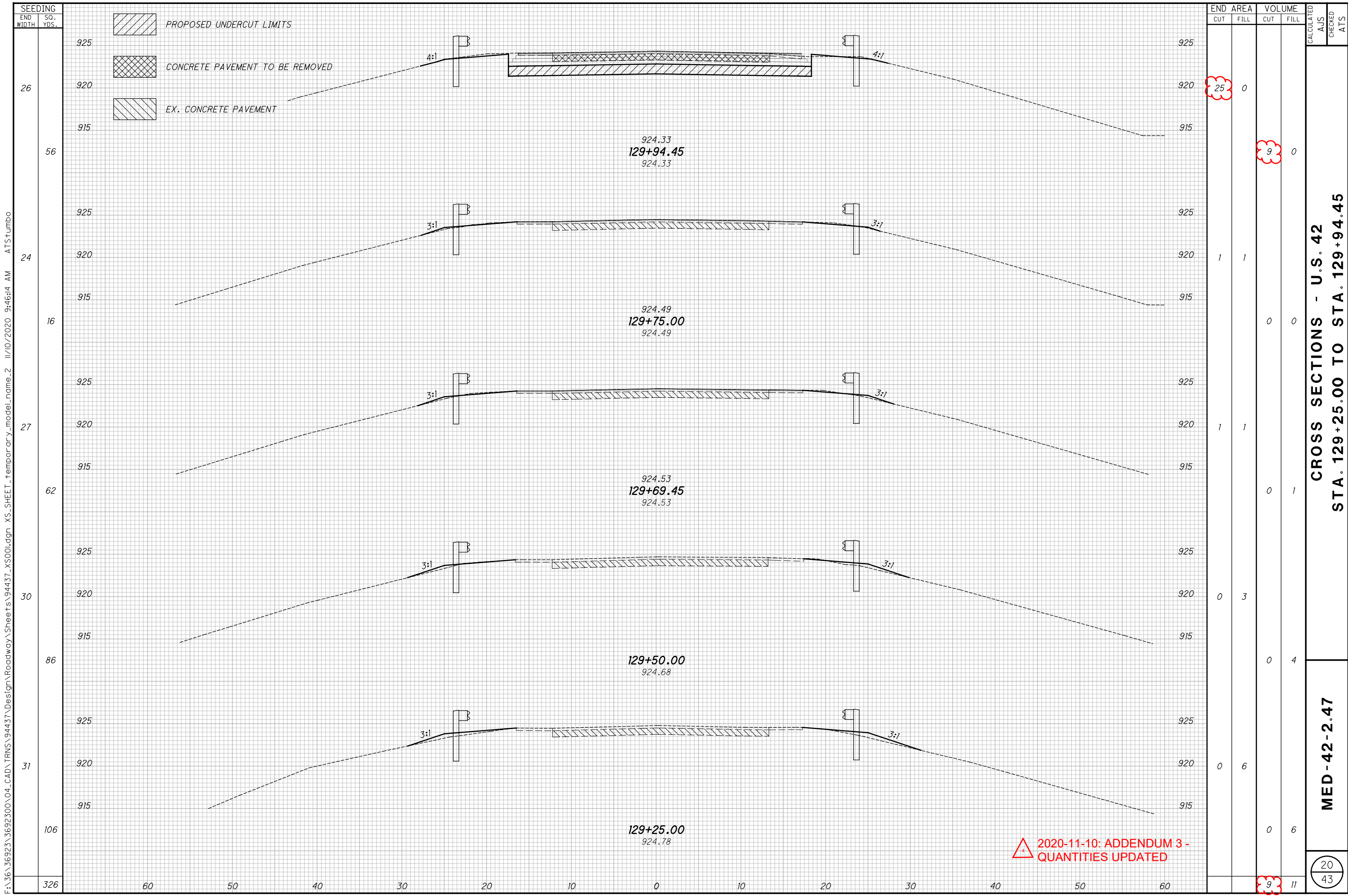

END AREA	VOLUME		CALCULATED AJS	CHECKED ATS
	CUT	FILL		
25	0	0	9	0
1	1	0	0	0
1	1	0	0	1
0	3	0	0	4
0	6	0	0	6
9	11	0	20	43

CROSS SECTIONS - U.S. 42
STA. 129+25.00 TO STA. 129+94.45



MED - 42 - 2.47

2020-11-10: ADDENDUM 3 - QUANTITIES UPDATED

F:\36\36923\3692300\04_CAD\TRNS\94437\Design\Roadway\Sheets\94437_XS001.dgn XS_SHEET_Temporary_model_name_2 11/10/2020 9:46:14 AM ATStumbo

F:\36\36923\3692300\04_CAD\TRANS\94437\Design\Roadway\Sheets\94437_XS001.dgn XS_SHEET_Temporary_model_name_3 11/10/2020 9:46:17 AM ATStumbo

SEEDING	
END WIDTH	SO. YDS.
14	14
34	34
15	15
46	46
25	25
69	69
25	25
16	16
165	165

 PROPOSED UNDERCUT LIMITS
 CONCRETE PAVEMENT TO BE REMOVED

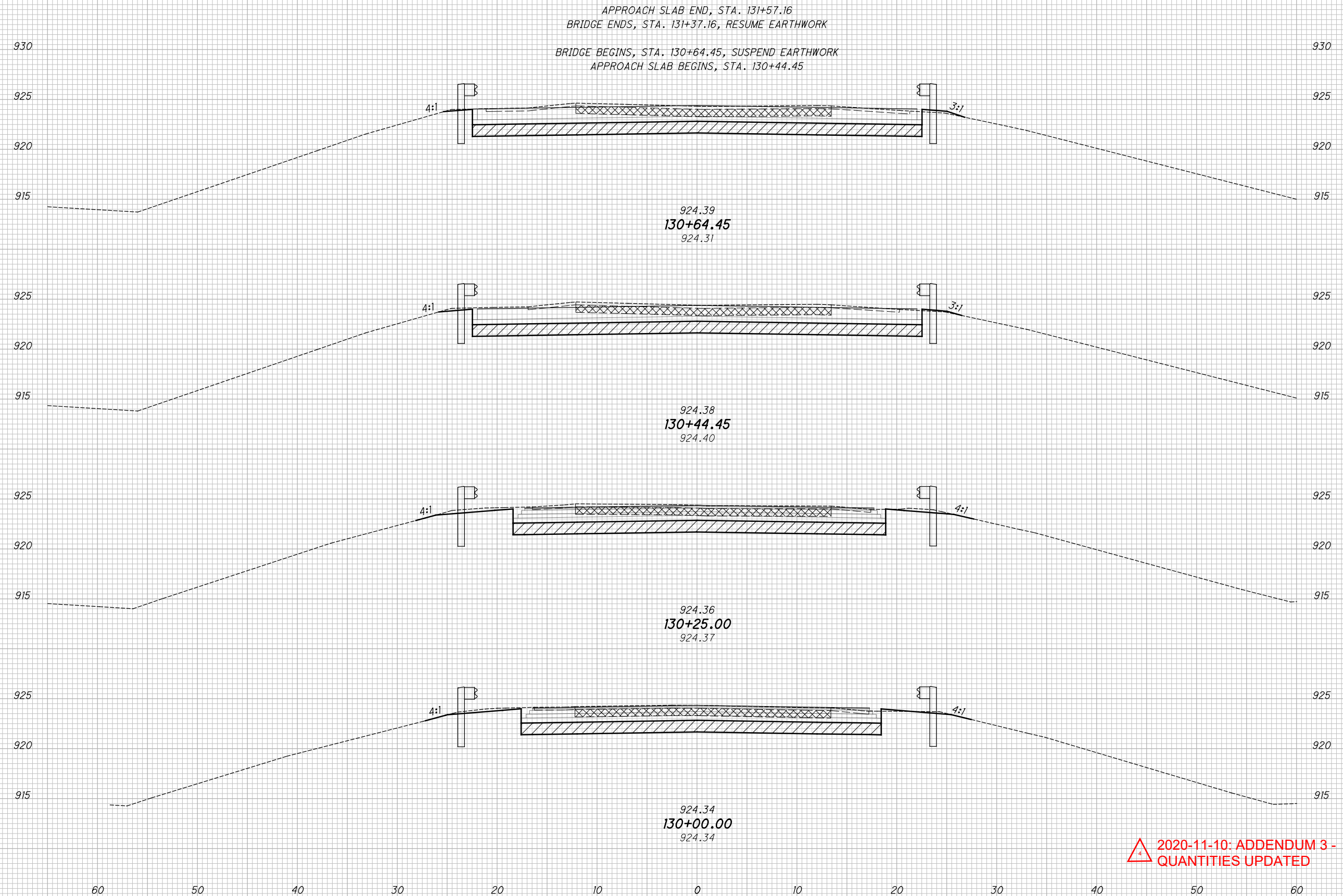

END AREA		VOLUME		CALCULATED AJS	CHECKED ATS
CUT	FILL	CUT	FILL		
44	1	35	0		
50	0	30	0		
34	0	28	0		
26	0	5	0		
98	0				

**CROSS SECTIONS - U.S. 42
 STA. 130+00.00 TO STA. 130+64.45**

MED - 42 - 2.47

 2020-11-10: ADDENDUM 3 - QUANTITIES UPDATED

21
43

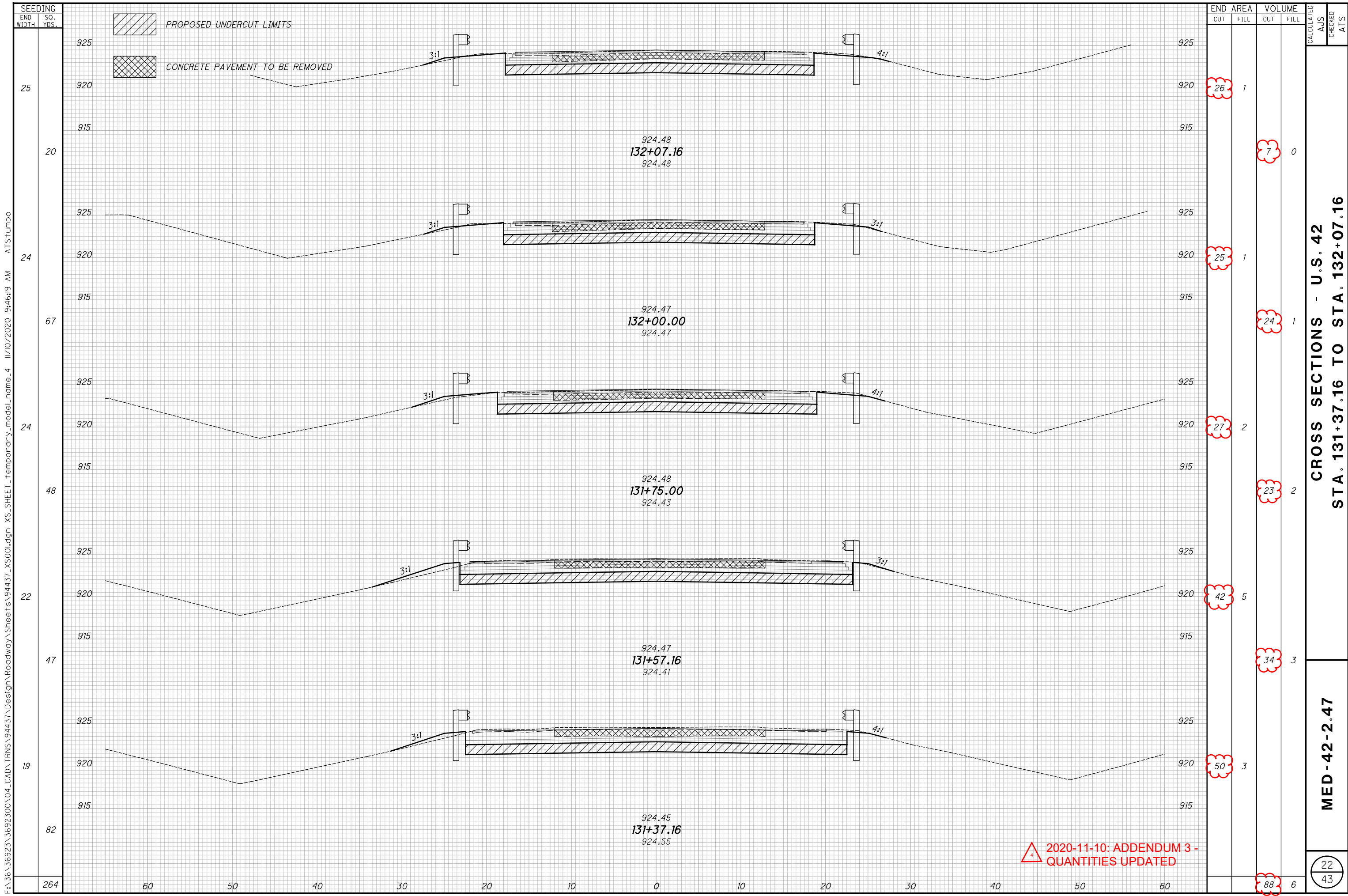

F:\36\36923\3692300\04_CAD\TRNS\94437\Design\Roadway\Sheets\94437_XS001.dgn XS_SHEET_Temporary_model_name_4 11/10/2020 9:46:19 AM ATStumbo

CROSS SECTIONS - U.S. 42
STA. 131+37.16 TO STA. 132+07.16

MED - 42 - 2.47

▲ 2020-11-10: ADDENDUM 3 - QUANTITIES UPDATED

22
43

F:\36\36923\3692300\04_CAD\TRNS\94437\Design\Roadway\Sheets\94437_XS001.dgn XS_SHEET_Temporary_model_name.5 11/10/2020 9:46:22 AM ATStumbo

SEEDING	
END WIDTH	SO. YDS.
60	258
50	77
40	22
30	64
20	24
10	50
0	24
10	19
20	22
30	48
40	
50	
60	

 EX. CONCRETE PAVEMENT

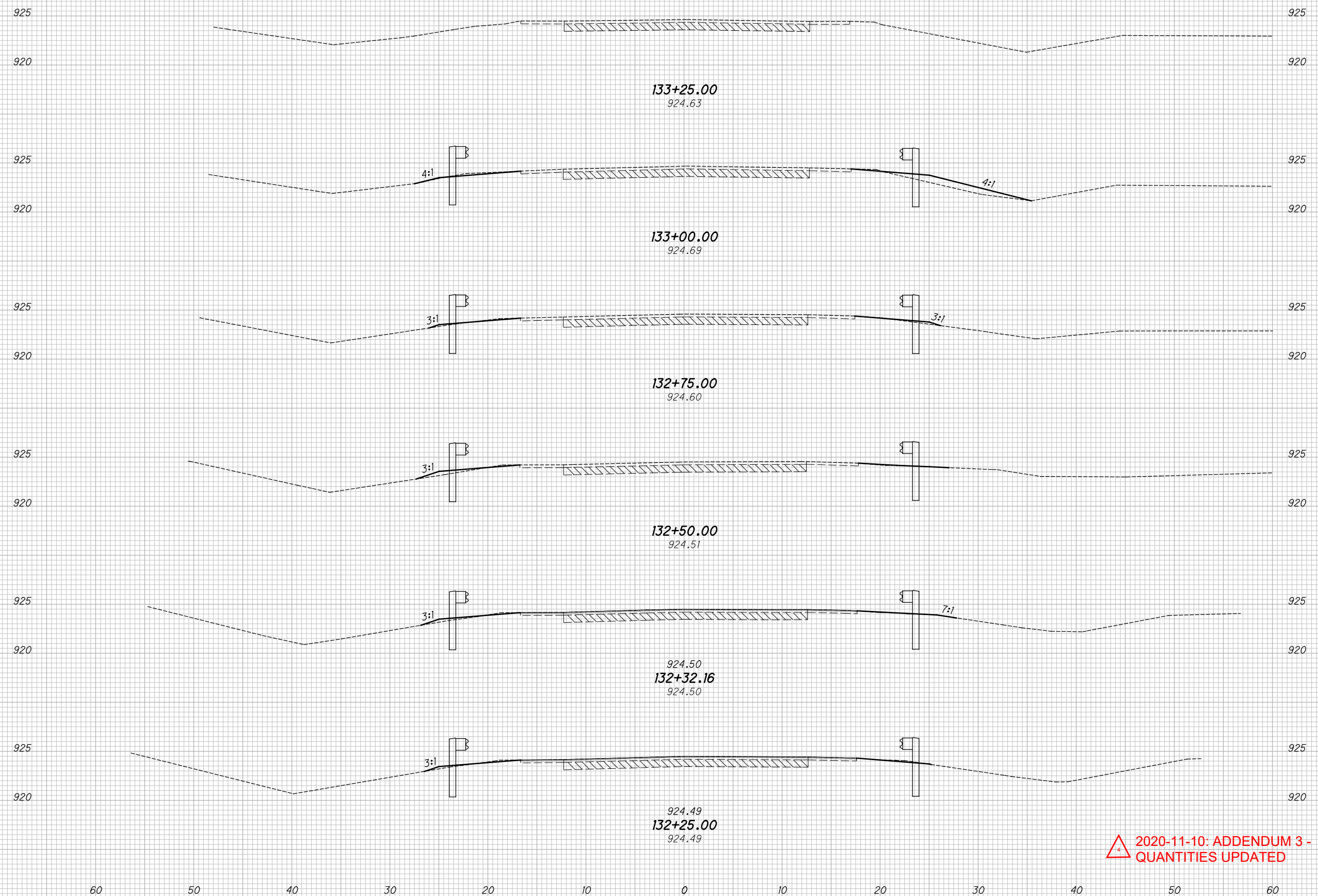

END	AREA		VOLUME		CALCULATED	CHECKED	ATS
	CUT	FILL	CUT	FILL			
925	0	0					
920			1	3			
925	1	7					
920			0	4			
925	0	1					
920			0	1			
925	0	2					
920			0	1			
925	0	1					
920			0	0			
925	1	1					
920			9	1			
925			10	10			

**CROSS SECTIONS - U.S. 42
STA. 132+25.00 TO STA. 133+25.00**

MED - 42 - 2.47

 2020-11-10: ADDENDUM 3 - QUANTITIES UPDATED

23
43