

STATE OF OHIO  
DEPARTMENT OF TRANSPORTATION

**MIA-75-3.95**

CITY OF TIPP CITY  
MIAMI COUNTY

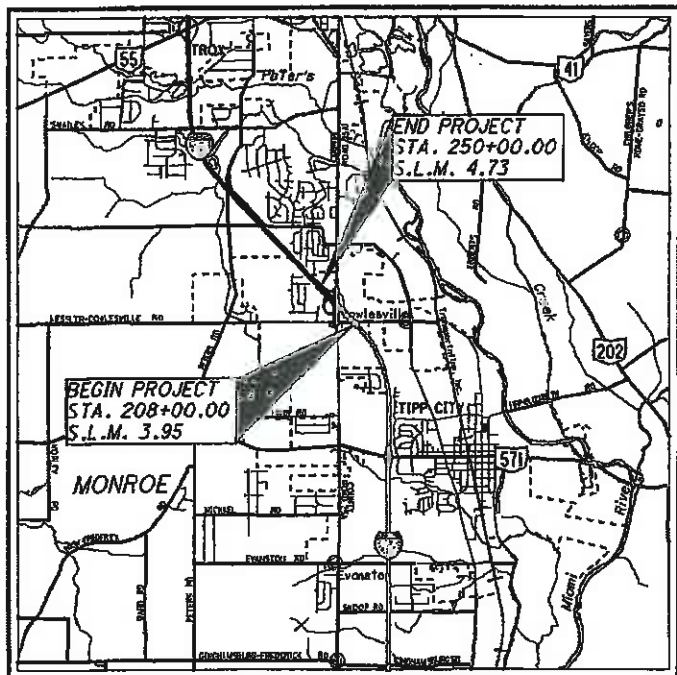

LOCATION MAP

LATITUDE: N 39°59'01" LONGITUDE: W 84°12'01"

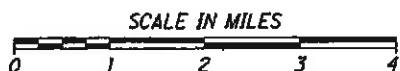

PORTION TO BE IMPROVED	-----
INTERSTATE HIGHWAY	=====
STATE & FEDERAL ROUTES	===== =====
COUNTY & TOWNSHIP ROADS	----- -----
OTHER ROADS	-----

DESIGN DESIGNATION I.R. 75

CURRENT ADT (2015)	68,410
DESIGN YEAR ADT (2035)	84,960
DESIGN HOURLY VOLUME (2035)	8,040
DIRECTIONAL DISTRIBUTION	0.50
TRUCKS (24 HOUR B&C)	0.31
DESIGN SPEED	70 MPH
LEGAL SPEED	65 MPH
DESIGN FUNCTIONAL CLASSIFICATION:	
URBAN INTERSTATE	
NHS PROJECT	YES

DESIGN DESIGNATION Co. Rd. 25A

CURRENT ADT (2015)	15,800
DESIGN YEAR ADT (2035)	18,900
DESIGN HOURLY VOLUME (2035)	8,040
DIRECTIONAL DISTRIBUTION	0.49
TRUCKS (24 HOUR B&C)	0.09
DESIGN SPEED	45 MPH
LEGAL SPEED	45 MPH
DESIGN FUNCTIONAL CLASSIFICATION:	
MINOR ARTERIAL	

DESIGN EXCEPTIONS

GRADED SHOULDER WIDTH - APPROVED 02/16/12

UNDERGROUND UTILITIES

CONTACT BOTH SERVICES  
CALL TWO WORKING DAYS  
BEFORE YOU DIG

CALL  
**1-800-362-2764**  
(TOLL FREE)

OHIO UTILITIES PROTECTION SERVICE  
NON-MEMBERS  
MUST BE CALLED DIRECTLY

OIL & GAS PRODUCERS PROTECTIVE  
SERVICE CALL: **1-800-925-0988**

PLAN PREPARED BY:  
OHIO DEPARTMENT OF TRANSPORTATION  
DISTRICT 7 - SIDNEY, OH  
PLANNING & ENGINEERING

INDEX OF SHEETS:

TITLE SHEET	1	7-9, 9A, 10-22
SCHEMATIC PLAN	2	
TYPICAL SECTIONS	3-5	
GENERAL NOTES	6, 6A	
MAINTENANCE OF TRAFFIC	7-9, 9A, 10-22	
GENERAL SUMMARY	23,24	
ESTIMATED QUANTITIES	25-28	
PROJECT SITE PLAN	29	
PLAN & PROFILE (I.R. 75)	30-39	
CROSS SECTIONS (I.R. 75)	40-62	
PLAN & PROFILE (C.R. 25A)	63-66	
CROSS SECTIONS (C.R. 25A)	67-70	
PLAN & PROFILE (RAMP A)	71,72	
CROSS SECTIONS (RAMP A)	73-77	
PLAN & PROFILE (RAMP B)	78,79	
CROSS SECTIONS (RAMP B)	80-82	
PLAN & PROFILE (RAMP C)	83-85	
CROSS SECTIONS (RAMP C)	86-92	
SUPER ELEVATION TABLES	93,94	
INTERSECTION DETAILS	95,96	
PAVEMENT DETAILS	97,98	
PLAN (INTERCHANGE)	99	
GRADING PLAN	100	
EXISTING RAMP LAYOUT	101	
CROSS SECTIONS EX. RAMPS B&C	102-110	
DRAINAGE DETAIL	111	
TRAFFIC CONTROL GENERAL SUMMARY	112,113	
TRAFFIC SUB-SUMMARY	114-118	
TRAFFIC CONTROL PLANS	119-138	
TRAFFIC SIGNAL PLANS	139, 140, 140A, 141-147	
HIGHWAY LIGHTING PLANS	148-154	
RIGHT-OF-WAY PLANS	155-159	

8009-12

COPY

PROJECT DESCRIPTION

THE PROJECT WILL INCLUDE THE RECONSTRUCTION OF THE SOUTHBOUND EXIT AND ENTRANCE RAMPS TO RECONFIGURE THE INTERCHANGE INTO A DIAMOND INTERCHANGE. ADDITIONAL WORK WILL INCLUDE THE ADDITION OF A TURN LANE ON THE NORTHBOUND EXIT RAMP, AND OTHER MINOR WORK ON CO. RD. 25A.

PROJECT EARTH DISTURBED AREA: 21.3 ACRES  
ESTIMATED CONTRACTOR EARTH DISTURBED AREA: 0.25 ACRES  
NOTICE OF INTENT EARTH DISTURBED AREA: 21.55 ACRES

LIMITED ACCESS

THIS IMPROVEMENT IS ESPECIALLY DESIGNED FOR THROUGH TRAFFIC AND HAS BEEN DECLARED A LIMITED ACCESS HIGHWAY OR FREEWAY BY ACTION OF THE DIRECTOR IN ACCORDANCE WITH THE PROVISIONS OF SECTION 5511.02 OF THE OHIO REVISED CODE.

2010 SPECIFICATIONS

THE STANDARD SPECIFICATIONS OF THE STATE OF OHIO, DEPARTMENT OF TRANSPORTATION, INCLUDING CHANGES AND SUPPLEMENTAL SPECIFICATIONS LISTED IN THE PROPOSAL SHALL GOVERN THIS IMPROVEMENT.

I HEREBY APPROVED THESE PLANS AND DECLARE THAT THE MAKING OF THIS IMPROVEMENT WILL NOT REQUIRE THE CLOSING TO TRAFFIC OF THE HIGHWAY AND THAT PROVISIONS FOR THE MAINTENANCE AND SAFETY OF TRAFFIC WILL BE AS SET FORTH ON THE PLANS AND ESTIMATES.

EXIT 69  
I-75 & Co Rd 25A  
REC'D  
7/6/12  
RW

STANDARD CONSTRUCTION DRAWINGS										SUPPLEMENTAL SPECIFICATIONS	
BP-1.1	7/28/00	GR-1.1	7/16/04	MT-95.32	7/17/09	MT-102.30	4/17/09	TC-51.12	10/21/11	800	1/20/12
BP-2.1	7/18/08	GR-2.1	1/16/04	MT-95.40	7/17/09	MT-105.30	1/16/09	TC-52.10	1/19/07		
BP-2.2	7/18/08	GR-3.1	10/16/09	MT-95.41	4/17/09	MT-120.00	1/16/09	TC-52.20	1/19/07	816	1/20/12
BP-3.1	1/20/12	GR-4.2	1/20/12	MT-98.10	7/17/09			TC-61.10	10/21/11	832	5/5/09
BP-6.1	1/21/11	GR-5.1	4/16/10	MT-98.11	7/17/09	TC-12.30	1/21/11	TC-61.30	7/15/11	806	10/15/10
BP-9.1	4/15/05	GR-5.2	4/16/10	MT-98.20	7/17/09	TC-21.10	1/19/07	TC-65.10	1/21/05	907	1/20/12
HW-2.2	7/30/07	GR-5.3	4/16/10	MT-98.21	7/17/09	TC-21.20	4/15/11	TC-65.11	1/21/05		
DM-1.1	1/21/11			MT-98.22	7/17/09	TC-22.20	1/21/11	TC-71.10	1/21/11		
DM-1.2	10/21/05	HL-20.11	1/19/07	MT-98.28	7/17/09	TC-41.10	10/19/07	TC-72.20	10/16/09		
DM-1.4	7/15/11	HL-30.11	10/16/09	MT-98.29	7/17/09	TC-41.20	1/19/07	TC-73.10	10/21/11		
DM-4.3	4/17/09	HL-30.21	10/21/11	MT-99.20	1/16/09	TC-41.30	1/19/07	TC-81.21	10/21/11		
DM-4.4	4/17/09	HL-30.22	4/17/09	MT-99.30	4/15/11	TC-41.41	1/21/11	TC-82.10	1/21/11		
				MT-101.60	4/17/09	TC-41.50	1/19/07	TC-83.20	1/21/11		
F-1.1	4/16/10			MT-101.70	4/15/11	TC-42.10	1/19/07	TC-84.20	1/21/11		
F-3.3	7/28/00	MT-35.10	4/20/01	MT-101.90	10/21/11	TC-42.20	1/21/11	TC-84.21	1/19/07		
F-3.4	7/28/00	MT-95.30	7/17/09	MT-102.10	7/17/09	TC-51.11	1/21/11	TC-85.20	7/15/11		

ENGINEERS SEAL:



SIGNED: Sherry Susan Wampler-Ley  
DATE: 2/27/12

APPROVED: Randy Chevalley, P.E., P.E./PRV  
DATE: 2-27-12 DISTRICT DEPUTY DIRECTOR

APPROVED: \_\_\_\_\_  
DATE: \_\_\_\_\_ DIRECTOR, DEPARTMENT OF TRANSPORTATION

FEDERAL PROJECT NO.  
E071(179)

PID NO.  
83372

CONSTRUCTION PROJECT NO.

RAILROAD INVOLVEMENT  
NONE

MIA-75-3.95

1  
159

I:\PROJECTS\MIA\075\0430\B3372\Design\B3372-12.dwg 27-FEB-2012 10:56AM jberlike

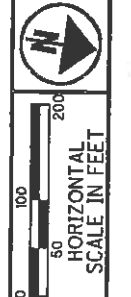

**SCHEMATIC PLAN**

**MIA-75-3.95**

**EXISTING C.R. 25A CURVE DATA**

P.I. = Sta. 9+81.57  
 $\Delta = 3^\circ 40' 13''$  (RT)  
 $Dc = 1^\circ 00' 00''$   
 $R = 5,729.58'$   
 $T = 183.57'$   
 $L = 367.02'$   
 $E = 2.94'$   
 $P.C. = 7+98.00$   
 $P.T. = 11+65.02$

**PROPOSED RAMP B CURVE DATA**

P.I. = STA. 10+83.78 ST = 66.71'  
 $\Delta = 29^\circ 34' 28''$  LT.  
 $Dc = 4^\circ 30' 00''$   
 $R = 1,273.24'$   
 $Ls = 200'$   
 $Os = 4^\circ 30' 00''$   
 $LT = 133.38'$   
 $x = 199.88'$   
 $y = 5.23'$   
 $k = 99.98'$   
 $p = 1.31'$   
 $\Delta c = 25^\circ 4' 28''$  LT.  
 $Lc = 557.21'$   
 $e_{max} = 0.049$

**PROPOSED RAMP C CURVE DATA**

P.I. = STA. 13+95.81  
 $\Delta = 58^\circ 43' 20''$  (RT)  
 $Dc = 16^\circ 30' 00''$   
 $R = 347.25'$   
 $T = 195.35'$   
 $L = 355.89'$   
 $E = 51.18'$   
 $e_{max} = 0.060$   
 $P.C. = STA. 12+00.46$   
 $P.T. = STA. 15+56.35$

P.I. = STA. 20+00.00  
 $\Delta = 26^\circ 00' 00''$  (LT)  
 $Dc = 6^\circ 30' 00''$   
 $R = 881.47'$   
 $T = 203.50'$   
 $L = 400.00'$   
 $E = 23.19'$   
 $e_{max} = 0.060$   
 $P.C. = STA. 17+96.49$   
 $P.T. = STA. 21+96.49$

P.I. = STA. 24+30.12  
 $\Delta = 7^\circ 00' 00''$  (LT)  
 $Dc = 1^\circ 30' 00''$   
 $R = 3,819.72'$   
 $T = 233.62'$   
 $L = 466.67'$   
 $E = 7.14'$   
 $e_{max} = 0.037$   
 $P.C. = STA. 21+96.49$   
 $P.T. = STA. 26+63.16$

**EXISTING S.B. LANES I.R. 75 CURVE DATA**

P.I. = Sta. 237+16.67  
 $\Delta = 1^\circ 04' 00''$  (LT)  
 $Dc = 0^\circ 12' 00''$   
 $R = 28,647.90'$   
 $T = 266.67'$   
 $L = 533.32'$   
 $E = 1.24'$   
 $P.C. = STA. 234+50.00$   
 $P.T. = STA. 239+83.32$

P.I. = Sta. 242+53.84  
 $\Delta = 1^\circ 04' 00''$  (RT)  
 $Dc = 0^\circ 12' 00''$   
 $R = 28,647.90'$   
 $T = 266.67'$   
 $L = 533.32'$   
 $E = 1.24'$   
 $P.C. = STA. 239+87.17$   
 $P.T. = STA. 245+20.49$

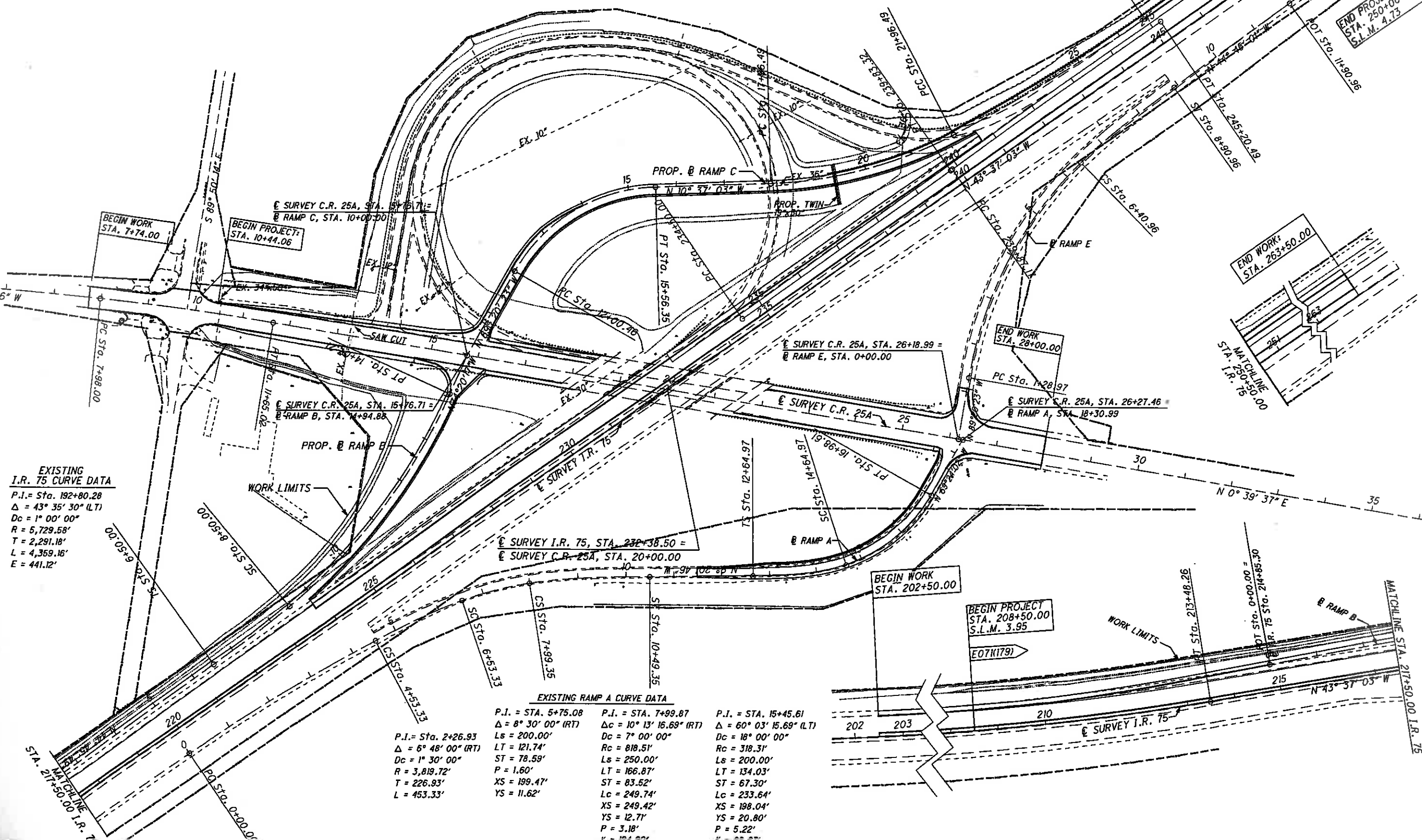

**EXISTING I.R. 75 CURVE DATA**

P.I. = Sta. 192+80.28  
 $\Delta = 43^\circ 35' 30''$  (LT)  
 $Dc = 1^\circ 00' 00''$   
 $R = 5,729.58'$   
 $T = 2,291.18'$   
 $L = 4,359.16'$   
 $E = 441.12'$

**EXISTING RAMP A CURVE DATA**

P.I. = STA. 5+75.08 $\Delta = 8^\circ 30' 00''$ (RT) $Ls = 200.00'$ $ST = 78.59'$ $R = 3,819.72'$ $T = 226.93'$ $L = 453.33'$	P.I. = STA. 7+99.87 $\Delta c = 10^\circ 13' 16.69''$ (RT) $Dc = 7^\circ 00' 00''$ $Rc = 818.51'$ $Ls = 250.00'$ $LT = 166.87'$ $ST = 83.52'$ $Lc = 249.74'$ $Xs = 249.42'$ $Ys = 12.71'$ $P = 3.18'$ $K = 184.80'$	P.I. = STA. 15+45.61 $\Delta = 60^\circ 03' 15.69''$ (LT) $Dc = 18^\circ 00' 00''$ $Rc = 318.31'$ $Ls = 200.00'$ $LT = 134.03'$ $ST = 67.30'$ $Lc = 233.64'$ $Xs = 198.04'$ $Ys = 20.80'$ $P = 5.22'$ $K = 83.87'$
---	--	---

jberntke 27-FEB-2012 3:25PM C:\URV\06\08\3572\Design\83372\p01.dgn

F:\PROJECTS\Mia\075\0430\83372\Design\83372mp103.dgn 27-FEB-2012 3:25PM jberlike

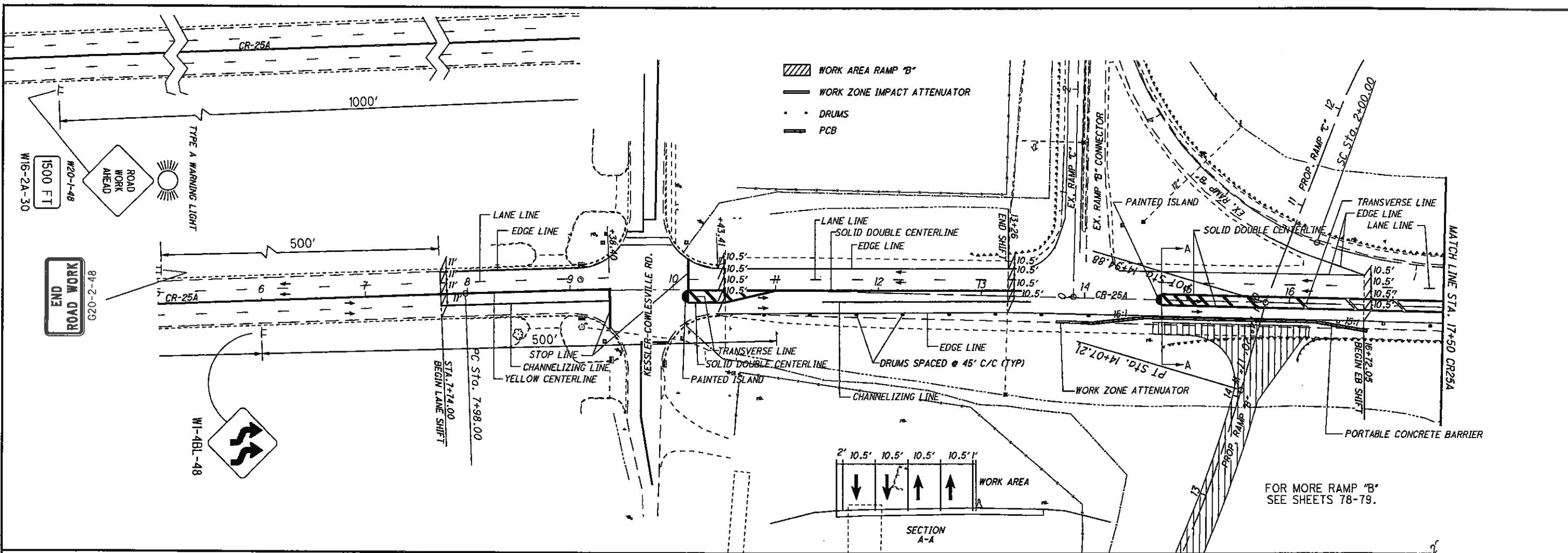

NOTE:  
 ALL WORK ZONE MARKINGS ACROSS STR. No. MIA-75-0440 SHALL BE OF CLASS 1, 740.06, TYPE 1 (REMOVABLE TAPE)

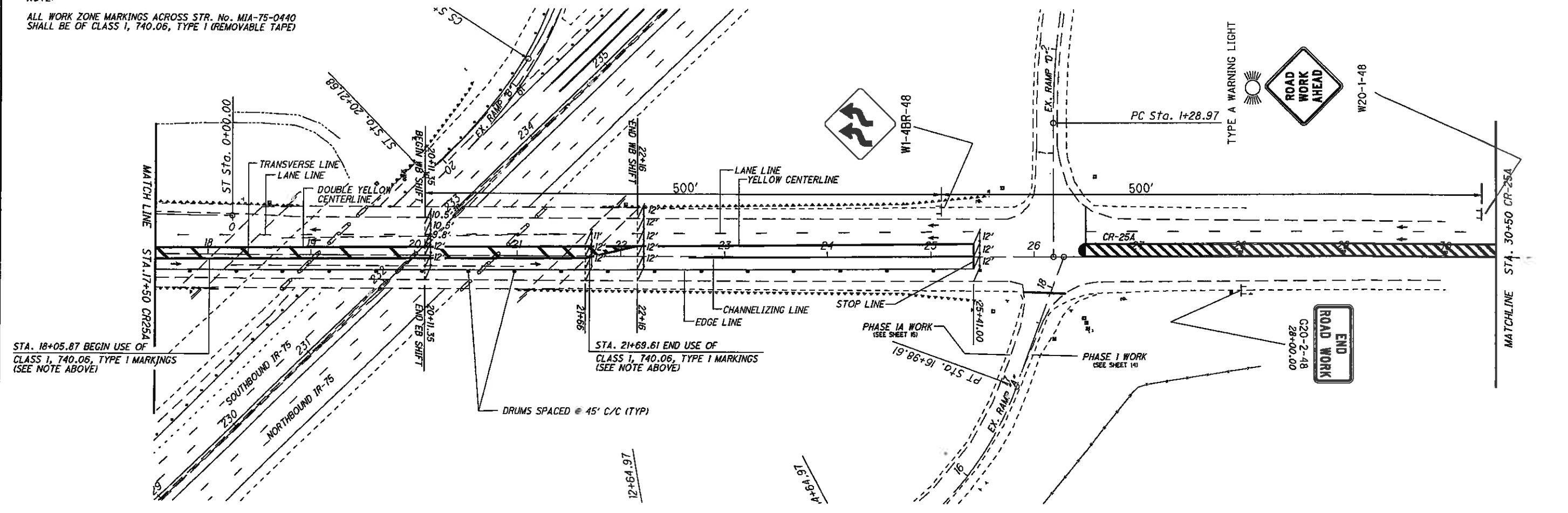

0 50 100  
 HORIZONTAL SCALE IN FEET

MAINTENANCE OF TRAFFIC - PHASE 1  
 STA. 7+00.00 TO STA. 27+50.00 (CR25A)

MIA-75-3.95

13  
 159

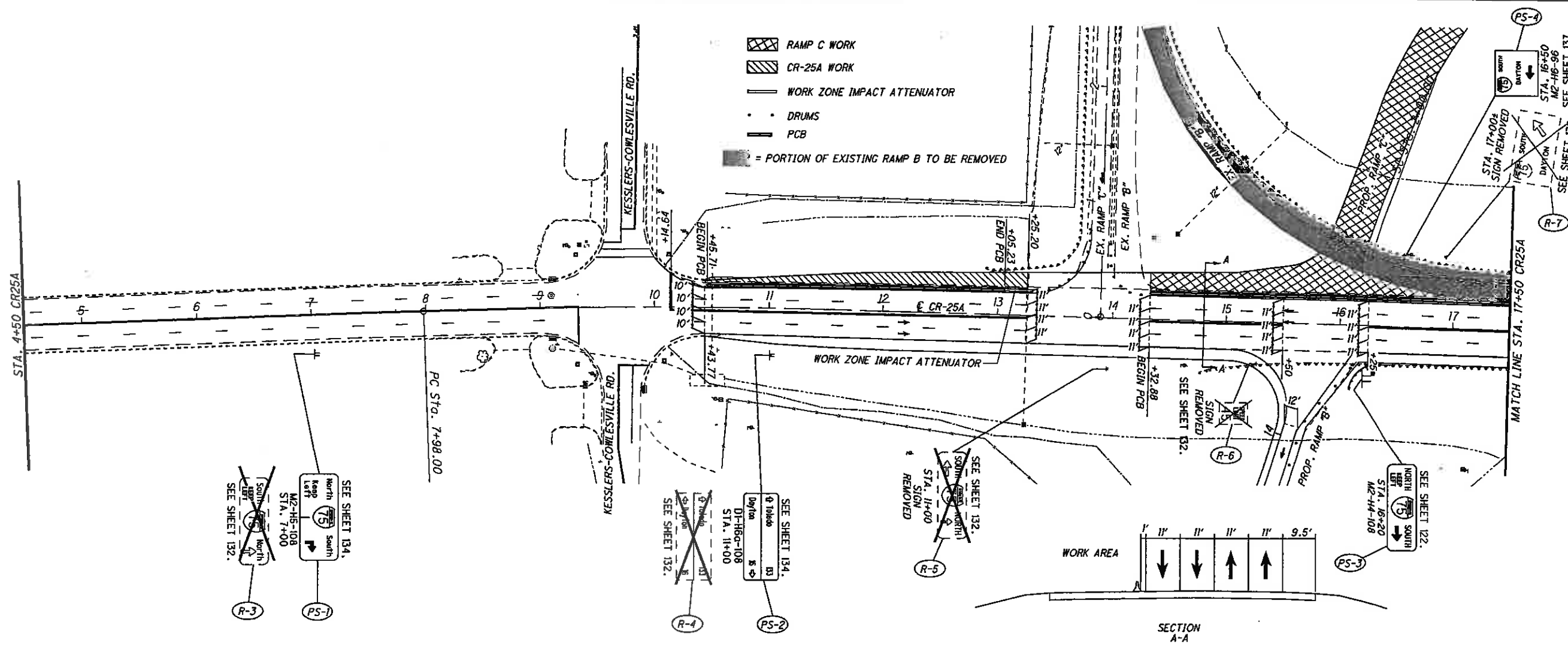
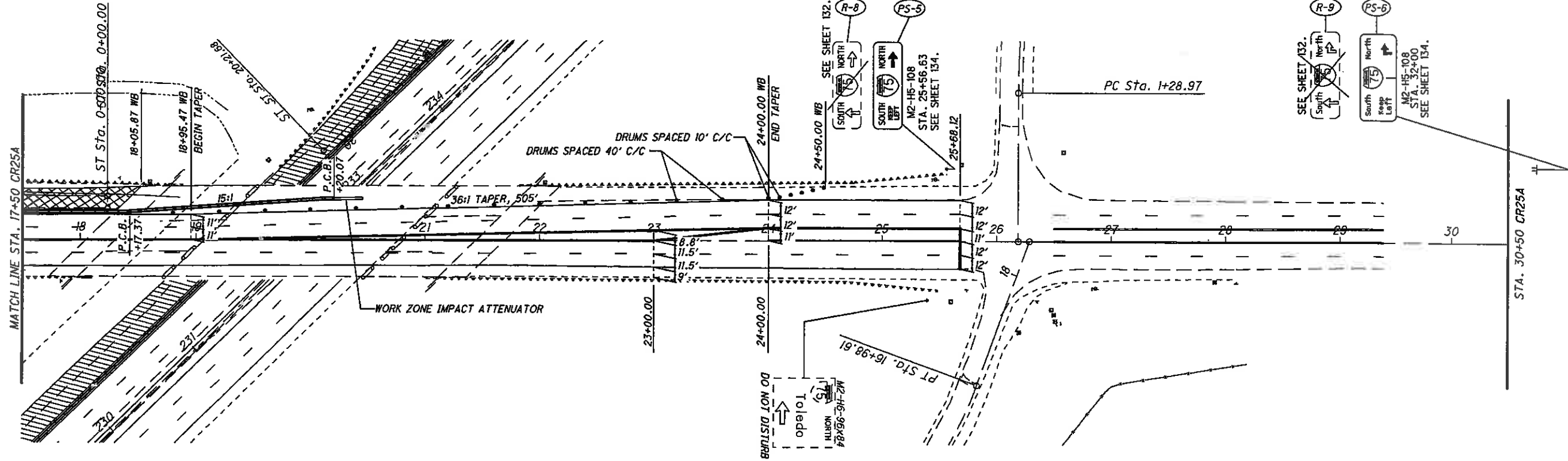

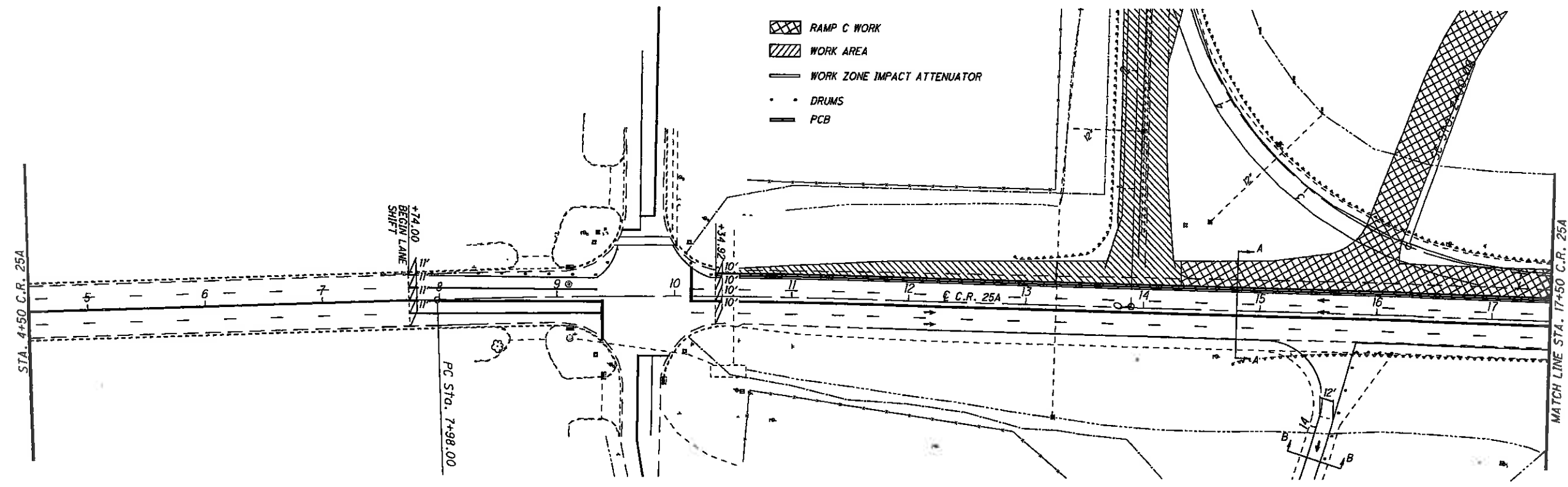
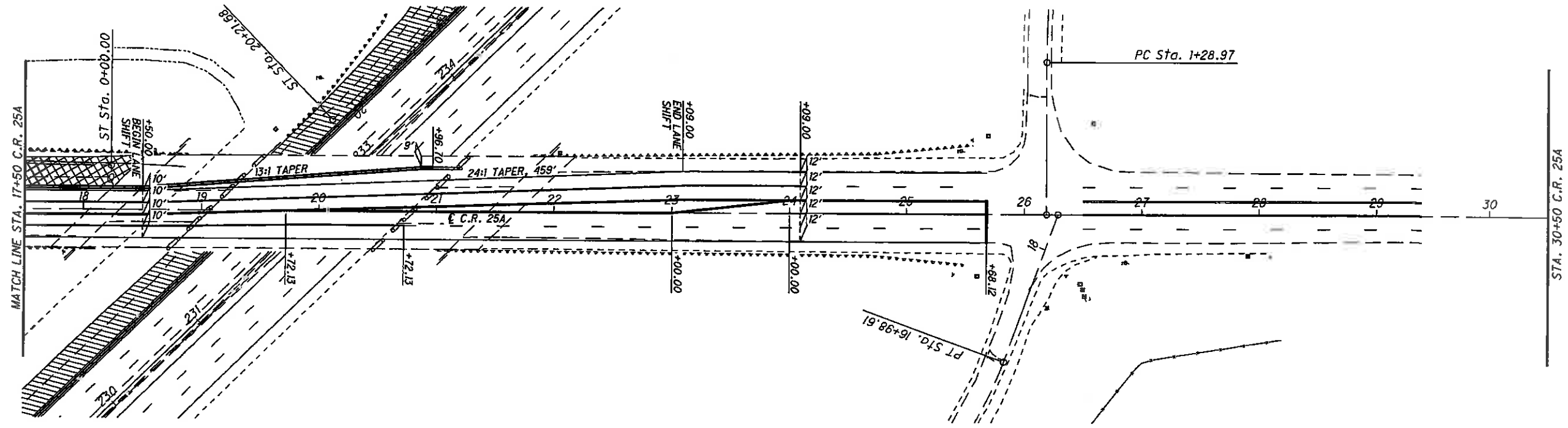

- RAMP C WORK
- WORK AREA
- WORK ZONE IMPACT ATTENUATOR
- DRUMS
- PCB

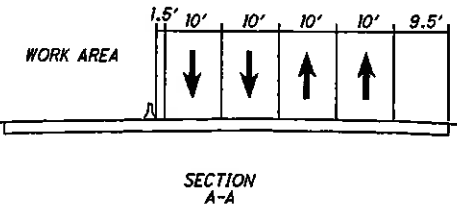

HORIZONTAL SCALE IN FEET

CALCULATED BCW CHECKED  
**MAINTENANCE OF TRAFFIC - PHASE 2A**  
**STA. 4+50.00 TO STA. 30+50.00**

**MIA-75-3.95**

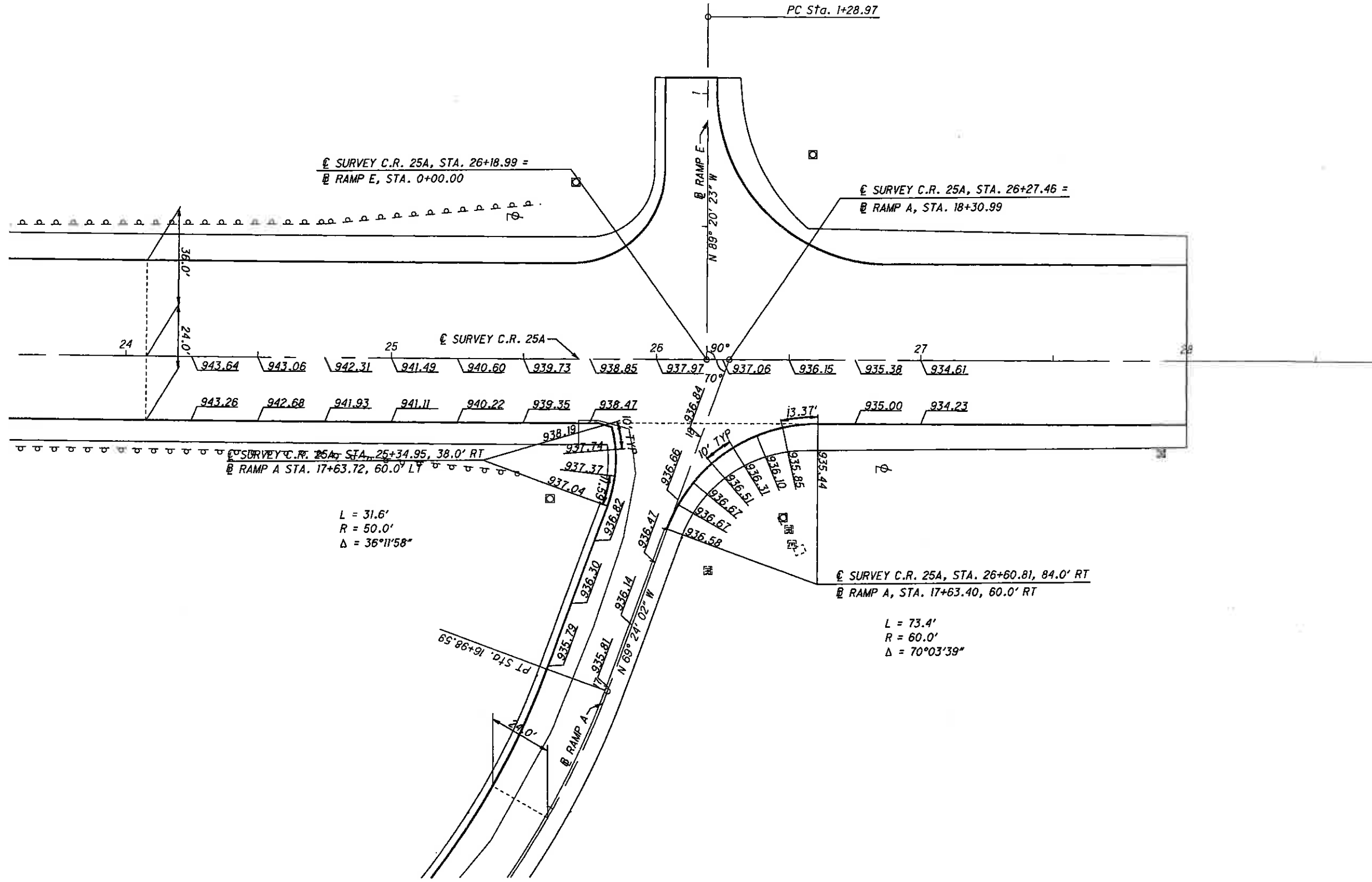

CALCULATED BCW CHECKED

0 10 20 30 40  
HORIZONTAL SCALE IN FEET

INTERSECTION DETAIL  
Co. Rd. 25A & RAMP A

MIA-75-3.95

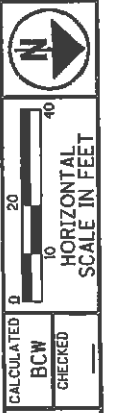
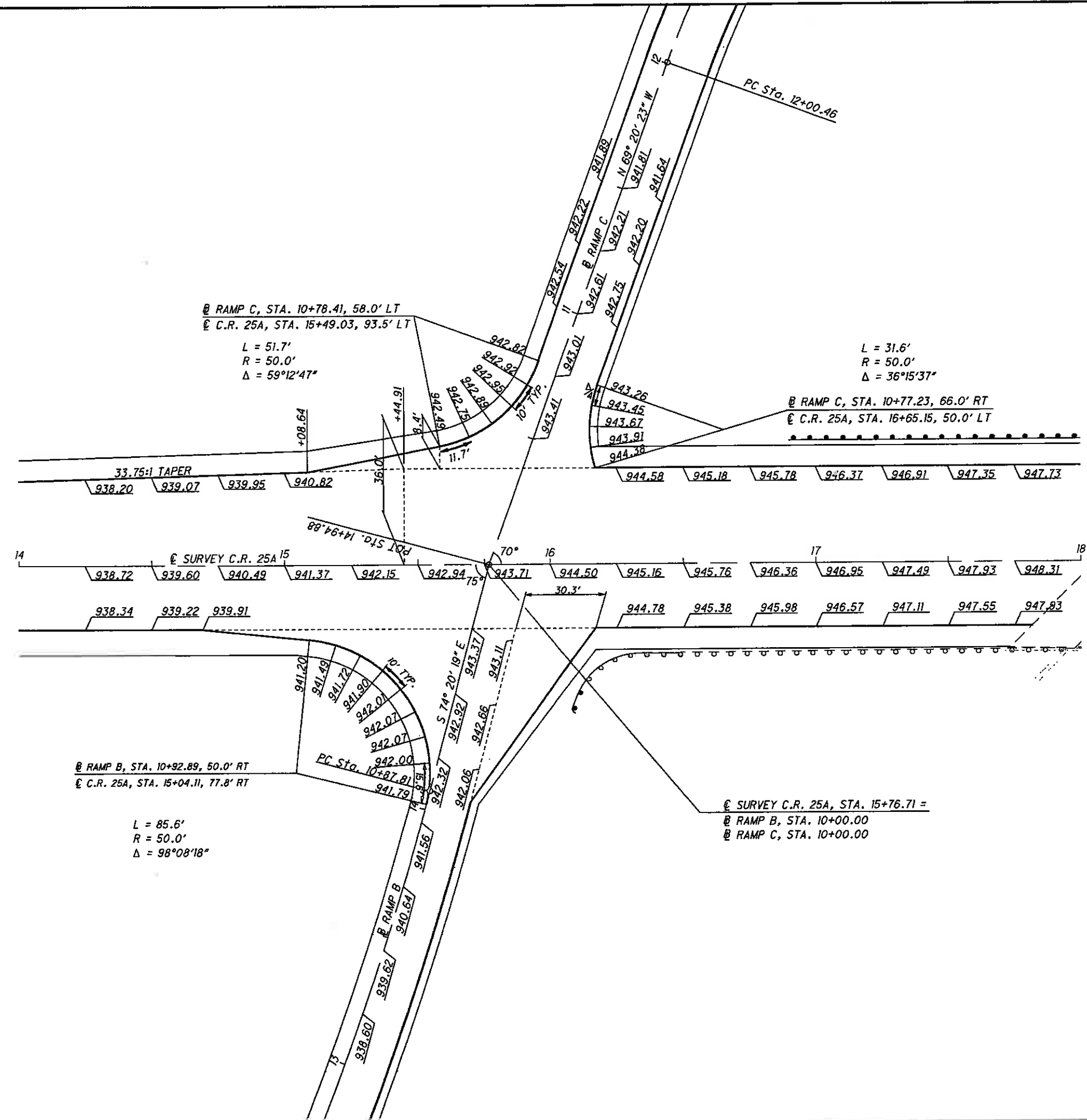

CALCULATED BY BCW  
 CHECKED BY \_\_\_\_\_

**INTERSECTION DETAIL**  
**C.R. 25A & RAMP B & RAMP C**