

STATE OF OHIO
DEPARTMENT OF HIGHWAYS AND PUBLIC WORKS
DIVISION OF HIGHWAYS
BUREAU OF CONSTRUCTION

SR-13

NEWARK-NEW LEXINGTON-ROAD
I.C.H. NO. 356 SEC. SOMERSET. PET. NO.
PERRY COUNTY
READING TOWNSHIP JUNE 1924.

INDEX.

Title Page	P-1
Typical Cross Section	P-2
Plans and Profile	P-3
Cross Sections	P-4
Structural Plans	P-5

The Standard Specifications of the State of Ohio, Division of Highways, in force on date of contract, will govern this improvement.

I hereby approve this plan and declare that the making of this improvement will require the closing to traffic of the highway and that the detours will be provided as shown on the plans and estimates.

Approved Walker W. Dief
Date 6/23/24 Resident Engineer.

Approved _____
Date _____ County Surveyor.

Approved Walker G. Smith
Date 7-3-24 Division Engineer.

Approved G. F. Pillsinger
Date 7-16-24 State Highway Engineer.

Approved LaBoulay
Date 7-16-24 Director of Highways and Public Works.

CONVENTIONAL SIGNS.

Section Line	-----
Corporation Line	-----
Property Line	-----
Center Line	-----
Fence	-----
Hedge	-----
Telephone or Telegraph	TTTTTTTT
Railroad	-----
Trees	o o o o o o o o

We, the City Council of Somerset hereby approve these plans and certify that the right-of-way 66 feet wide is available for the construction, maintenance and repair of the above highway

A. B. Bourne
Date 6/23/24 City Council.

Approved A. M. Skinner
J. W. Taylor
A. B. Bourne
Date 6/23/24 County Commissioners.

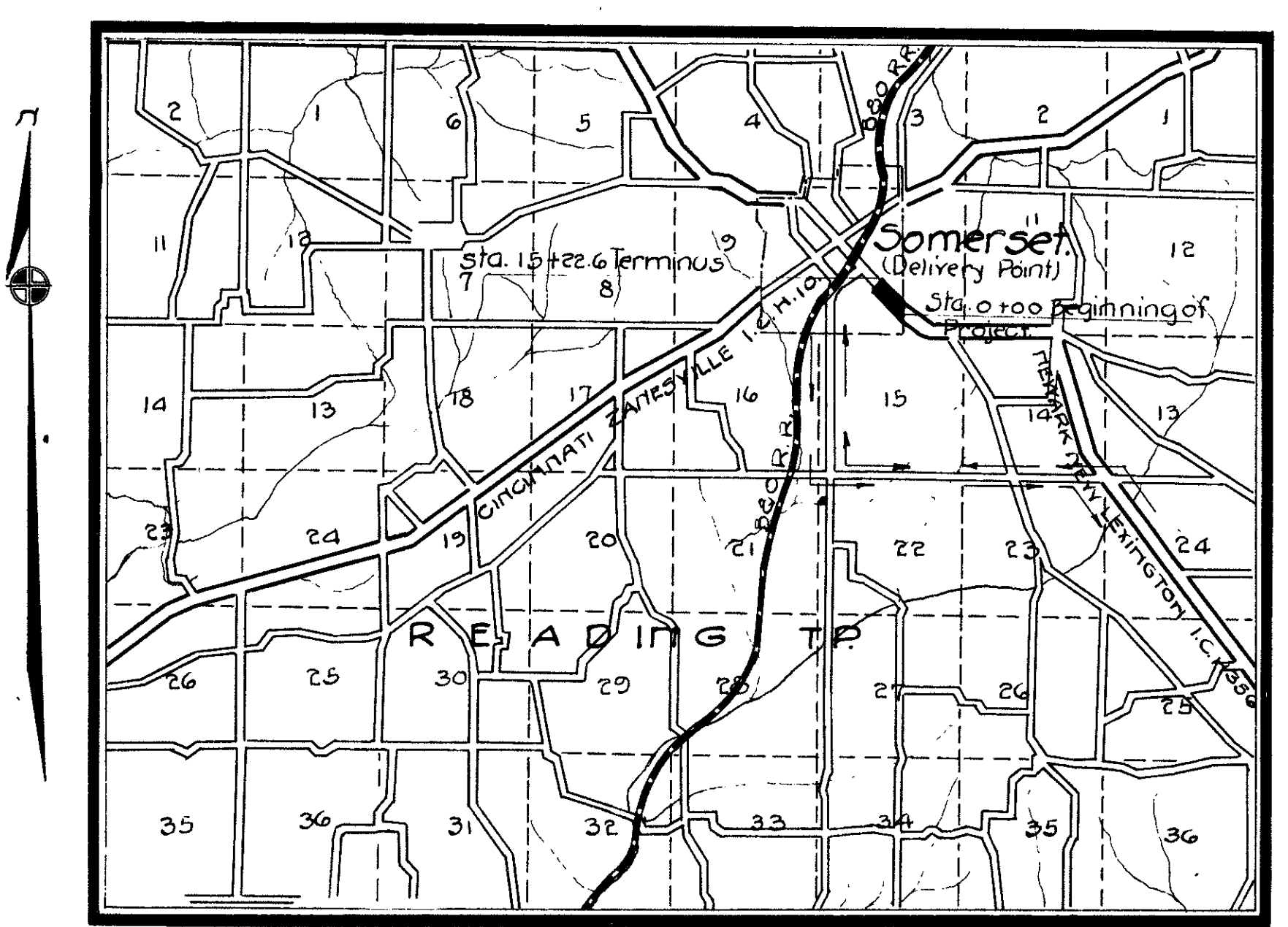

LOCATION PLAN

SCALE OF MILES.
0 1/4 1/2 1 2 3

Portion to be Improved
Detours shown thus

SCALES
Plan 1 inch = 100 feet.
Profile (Hor.) 1 " = 100 "
Profile (Ver.) 1 " = 10 "
Cross Sections 1 " = 5 "

