

NOTIFICATION OF CONSTRUCTION INITIATION:

AT LEAST 21 DAYS PRIOR TO STARTING INITIAL CONSTRUCTION ACTIVITIES, THE CONTRACTOR SHALL ADVISE THE DISTRICT OFFICE OF COMMUNICATIONS VIA EMAIL AT D06.PIO@DOT.OHIO.GOV, THE DISTRICT WORK ZONE TRAFFIC MANAGER VIA EMAIL AT D06.MOT@DOT.OHIO.GOV AND THE CENTRAL OFFICE SPECIAL HAUL PERMITS SECTION BY FAX AT (614)728-4099 OF THE ANTICIPATED START DATE OF ANY CONSTRUCTION ACTIVITIES INCLUDING BUT NOT LIMITED TO THE PLACING OF WORK ZONE SIGNS. THE NOTIFICATION SHALL ALSO INCLUDE THE PROJECT NUMBER, PID, NAME AND PHONE NUMBER OF THE CONTRACTOR, A POINT OF CONTACT AND THE ANTICIPATED IMPACT ON TRAFFIC. THE CONTRACTOR WILL IMMEDIATELY INFORM THE DISTRICT OFFICE OF COMMUNICATIONS AND THE DISTRICT WORK ZONE TRAFFIC MANAGER OF ANY AND ALL DELAYS AND/OR CHANGES REGARDING THE CONSTRUCTION INITIATION DATE.

GENERAL:

THE CONTRACTOR SHALL SUBMIT IN WRITING A SCHEDULE OF OPERATIONS TO THE ENGINEER AND RECEIVE APPROVAL IN WRITING BEFORE WORK IS STARTED ON THIS PROJECT. ALL TRAFFIC CONTROL DEVICES SHALL BE FURNISHED, ERECTED, MAINTAINED, AND REMOVED BY THE CONTRACTOR IN ACCORDANCE WITH THE OHIO MANUAL OF UNIFORM TRAFFIC CONTROL DEVICES.

CLEARING AND GRUBBING, AS PER PLAN:

ALTHOUGH THERE ARE NO TREES OR STUMPS SPECIFICALLY MARKED FOR REMOVAL WITHIN THE LIMITS OF THE PROJECT, A LUMP SUM QUANTITY HAS BEEN INCLUDED IN THE GENERAL SUMMARY FOR ITEM 201 CLEARING AND GRUBBING TO INCLUDE CONSTRUCTION DEBRIS THAT HAS BEEN DUMPED ALONGSIDE OF SR 674.

ADDITIONALLY, ALL TREES DEEMED TO INTERFERE WITH ACCESS TO THE SITE HAVE BEEN CUT AND LEFT ONSITE. THE CONTRACTOR WILL BE RESPONSIBLE FOR DISPOSING THE DOWNED TREES AND REMOVING THE STUMPS IN ACCORDANCE WITH ITEM 201. ALL PROVISIONS AS SET FORTH IN THE SPECIFICATIONS UNDER THIS ITEM SHALL BE INCLUDED IN THE LUMP SUM BID PRICE FOR ITEM 201 CLEARING AND GRUBBING, AS PER PLAN.

WORK LIMITS:

THE CONTRACTOR'S EQUIPMENT SHALL BE OPERATED IN THE DIRECTION OF TRAFFIC WHERE PRACTICAL. EQUIPMENT SHALL HAVE AT LEAST ONE AMBER FLASHING LIGHT. WHEN PARKED ALONG THE HIGHWAY, THE EQUIPMENT SHALL BE LOCATED EITHER A MINIMUM THIRTY FEET FROM THE EDGE OF PAVEMENT OR SIX FEET BEHIND GUARDRAIL PRECEDING THE EQUIPMENT. ALL OTHER EQUIPMENT, INCLUDING PRIVATE VEHICLES, SHALL BE STORED AT AN APPROVED CONTRACTOR'S STORAGE AREA.

CONSTRUCTION NOISE:

ACTIVITIES AND LAND USE ADJACENT TO THIS PROJECT MAY BE AFFECTED BY CONSTRUCTION NOISE. IN ORDER TO MINIMIZE ADVERSE CONSTRUCTION NOISE IMPACTS, DO NOT OPERATE POWER-OPERATED CONSTRUCTION-TYPE DEVICES BETWEEN THE HOURS OF 8PM AND 8AM. IN ADDITION, DO NOT OPERATE AT ANY TIME ANY DEVICE IN SUCH A MANNER THAT THE NOISE CREATED SUBSTANTIALLY EXCEEDS THE NOISE CUSTOMARILY AND NECESSARILY ATTENDANT TO THE REASONABLE AND EFFICIENT PERFORMANCE OF SUCH EQUIPMENT.

REMOVAL ITEMS:

GUARDRAIL, POSTS, ASPHALT AND MISCELLANEOUS HARDWARE DESIGNATED FOR REMOVAL BECOME PROPERTY OF THE CONTRACTOR AND SHALL BE DISPOSED OF. PAYMENT FOR THE ABOVE SHALL BE INCLUDED IN THE UNIT PRICE BID FOR THE REMOVED ITEM.

UNDERGROUND UTILITIES:

THE ODOT CONTRACTOR IS REQUIRED TO CONTACT OUPS A MINIMUM OF 48 HOURS EXCLUDING WEEKENDS AND HOLIDAYS TO PERMIT ALL UNDERGROUND UTILITIES AN OPPORTUNITY TO MARK THEIR LINES. IT IS ALSO THE ODOT CONTRACTOR'S RESPONSIBILITY TO CONTACT ALL NON-MEMBERS OF OUPS DIRECTLY A MINIMUM OF 48 HOURS NOTICE EXCLUDING WEEKENDS AND HOLIDAYS TO PROVIDE THEM WITH THE SAME OPPORTUNITY.

IT IS ODOT'S EXPECTATION THAT ALL GUARDRAIL POSTS WILL BE INSTALLED SO THERE WILL BE NO DISRUPTION TO UNDERGROUND UTILITIES. IF THERE IS A UTILITY MARKING WITHIN THE TOLERANCE ZONE OF A UTILITY LOCATE FROM THE PROPOSED GUARDRAIL PLACEMENT, IT IS THE ODOT CONTRACTORS RESPONSIBILITY TO DIRECTLY CONTACT THE IMPACTED UTILITY AND WORK WITH THEM TO FIND A SOLUTION THAT DOES NOT CHANGE THE GUARDRAIL PLACEMENT OR DAMAGE THE EXISTING UTILITY. NO UTILITY RELOCATION WILL BE REIMBURSED NOR WILL DELAY CLAIMS BE PERMISSIBLE BASED ON LACK OF COORDINATION BETWEEN THE ODOT CONTRACTOR AND THE IMPACTED UTILITY.

BELOW IS A LIST OF UTILITIES LOCATED WITHIN THE PROJECT AREA TOGETHER WITH THEIR RESPECTIVE OWNERS.

AT&T - OHIO
111 NORTH FOURTH STREET
COLUMBUS, OH 43215
GUY SPIDEL
O. 614.223.7162
M. 937.296.3699
GS1878@ATT.COM

SPECTRUM
3760 INTERCHANGE DRIVE
COLUMBUS, OH 43204
SAM LUTZ
O. 614.481.5047
M. 614.348.2966
SAMUEL.LUTZ@CHARTER.COM

SOUTH CENTRAL POWER
2780 COONPATH ROAD
LANCASTER, OH 43130
LARRY MAO
O. 740.689.6119
M. 740.689.6236
MAO@SCP.UTILITIES.COM

PICKAWAY COUNTY ENGINEERS
207 SOUTH COURT STREET
CIRCLEVILLE, OH 43113
O. 740.474.3360

WATER QUALITY PROTECTION:

NO TOXIC OR HAZARDOUS MATERIALS SUCH AS SEALANTS, PAINT, SOLVENTS, CLEANING AGENTS, EARTHEN MATERIALS, WASTE-WATER FUELS OR DEBRIS OF ANY KIND SHALL BE DISCHARGED TO ANY STREAMS, DRAINAGE COURSES OR BODIES OF WATER. ALL ASPHALT OR CONCRETE GRINDINGS, EXCESS ASPHALT OR CONCRETE MATERIALS OR ANY OTHER DEBRIS GENERATED DURING RESURFACING OR OTHER SIMILAR ACTIVITIES SHALL BE REMOVED IMMEDIATELY FROM WITHIN 1,000 FEET OF A FLOODPLAIN BELOW THE 100-YEAR FLOOD ELEVATION. THE CONTRACTOR SHALL TAKE ALL PRECAUTIONS NECESSARY TO PREVENT LIQUIDS USED TO REPAIR, CLEAN, SEAL, OR TREAT ANY STRUCTURE (E.G. PAINT, SEALER, SOLVENT) FROM ENTERING STREAMS, WETLANDS OR OTHER "WATERS OF THE UNITED STATES" AND TAKE THE APPROPRIATE ACTIONS IN THE EVENT OF A RELEASE.

SURVEYING PARAMETERS:

PRIMARY PROJECT CONTROL MONUMENTS GOVERN ALL POSITIONING ON ODOT PROJECTS.

USE THE FOLLOWING PROJECT CONTROL, VERTICAL POSITIONING AND HORIZONTAL PARAMETERS FOR ALL SURVEYING:

VERTICAL POSITIONING:
ORTHOMETRIC HEIGHT DATUM: NAVD 1988
GEOID: GEOID12A

HORIZONTAL POSITIONING:
REFERENCE FRAME: NAD 83 (CORS)
ELLIPSOID: WGS84
MAP PROJECTION: LAMBERT CONFORMAL CONIC
COORDINATE SYSTEM: OHIO STATE PLAN SOUTH.
COORDINATES GIVEN ARE IN GRID ONLY.

UNITS ARE IN U.S. SURVEY FEET. USE THE FOLLOWING CONVERSION FACTOR: 1 METER = 3.280833333 U.S. SURVEY FEET.

SEE SCHEMATIC PLAN ON SHEET 2 FOR MONUMENTATION OF PROJECT CONTROL.

CONNECTION BETWEEN EXISTING AND PROPOSED GUARDRAIL:

WHEN IT IS NECESSARY TO SPLICE PROPOSED GUARDRAIL TO EXISTING GUARDRAIL, ONLY THE EXISTING GUARDRAIL SHALL BE CUT, DRILLED, OR PUNCHED. THE CONNECTION SHALL BE MADE USING A W-BEAM, BEAM SPLICE AS SHOWN IN AASHTO M 180-12, EXCEPT THE BEAM WASHERS ARE NOT TO BE USED. PAYMENT SHALL BE INCLUDED IN THE CONTRACT PRICE FOR THE RESPECTIVE GUARDRAIL ITEMS.

REFER TO ODOT STD. DWG. MGS-4.3 FOR TRANSITION DETAILS BETWEEN EXISTING (TYPE 5) GUARDRAIL TO PROPOSED (MGS) GUARDRAIL SYSTEMS.

ITEM 209 - PREPARING SUBGRADE FOR SHOULDER PAVING, AS PER PLAN:

PREPARE THE SHOULDER FOR PAVING A CONSISTENT SAFETY EDGE IN BOTH THICKNESS AND WIDTH. PRIOR TO PAVING THE SAFETY EDGE AND PLACING THE COMPACTED AGGREGATE, GRADE AN AREA 12 INCHES WIDE, BEGINNING AT THE EDGE OF THE PAVED ROADWAY, TO PROVIDE A LEVEL SURFACE FREE OF VEGETATION FOR CONSTRUCTION OF THE SAFETY EDGE AND AGGREGATE SHOULDER. SEE SHEET 4 FOR DETAILS. IF NECESSARY, EXCAVATE THE GRADED AREA TO THE DEPTH NECESSARY TO CONSTRUCT THE SAFETY EDGE. COMPACT THE GRADED SHOULDER ACCORDING TO 617.05, OR AS DIRECTED BY THE ENGINEER.

ENVIRONMENTAL COMMITMENTS

- 1. THIS PROJECT IS LOCATED WITHIN THE KNOWN HABITAT RANGES OF THE FEDERALLY LISTED AND PROTECTED INDIANA BAT AND NORTHERN LONG-EARED BAT. NO TREES SHALL BE REMOVED UNDER THIS PROJECT FROM APRIL 1 THROUGH SEPTEMBER 30. ALL NECESSARY TREE REMOVAL SHALL OCCUR FROM OCTOBER 1 THROUGH MARCH 31. THIS REQUIREMENT IS NECESSARY TO AVOID AND MINIMIZE IMPACTS TO THESE SPECIES AS REQUIRED BY THE ENDANGERED SPECIES ACT. FOR THE PURPOSE OF THIS NOTE, A TREE IS DEFINED AS A LIVE, DYING, OR DEAD WOODY PLANT WITH A TRUNK THREE INCHES OR GREATER IN DIAMETER AT A HEIGHT OF 4.5 FEET ABOVE THE GROUND SURFACE AND WITH A MINIMUM HEIGHT OF 13 FEET.
- 2. THE CONTRACTOR IS RESPONSIBLE FOR NOTIFYING, BY LETTER WITH COMPANY LETTERHEAD, RESIDENTS AND BUSINESSES WHERE DRIVEWAYS WILL BE IMPACTED DURING THE DETOUR PHASE. ADVANCED NOTICE SHALL BE TWO WEEKS PRIOR TO THE FIRST DAY OF WORK AT THAT LOCATION. A COPY OF THE LETTER SHALL BE PRESENTED AT THE PRE-CONSTRUCTION MEETING. THE CONTRACTOR IS TO NOTIFY THE PROJECT ENGINEER OF THE DATES WHEN THIS NOTIFICATION IS DISTRIBUTED.

- 3. THE CONTRACTOR IS RESPONSIBLE FOR CONTACTING THE DISTRICT 6 PUBLIC INFORMATION OFFICE VIA EMAIL AT D06.PIO@DOT.OHIO.GOV TO COORDINATE EFFORTS TO NOTIFY ALL COUNTY, STATE AND FEDERAL EMERGENCY SERVICES, SCHOOL DISTRICTS AND ADJACENT RESIDENTS AND BUSINESSES OF THE UPCOMING CLOSURE NO LATER THAN 21 DAYS PRIOR TO THE CLOSING OF THE ROAD.
- 4. A WATERWAY PERMIT SHALL BE OBTAINED PRIOR TO CONSTRUCTION FOR THE CULVERT WORK. ALL SPECIAL PROVISIONS SHALL BE ATTACHED TO THE FINAL PLAN SET AND FOLLOWED THROUGHOUT CONSTRUCTION. THERE MUST BE NO IMPACTS TO ANY RIVERS, STREAMS, AND DITCHES OUTSIDE OF THE PERMITTED AREA FOR THIS PROJECT.
- 5. THE CONTRACTOR MUST CONTAIN ALL MATERIAL AND DEBRIS WITHIN THE PROPOSED CONSTRUCTION LIMITS. BMPS MUST BEING IN PLACE TO PREVENT INCIDENTAL IMPACTS TO STREAMS DUE TO CONSTRUCTION ACTIVITIES. ANY IMPACTS BEYOND THE CONSTRUCTION LIMITS MUST BE REPORTED TO THE DISTRICT ENVIRONMENTAL COORDINATOR IMMEDIATELY. THE CONTRACTOR IS RESPONSIBLE FOR ALL COSTS ASSOCIATED WITH VIOLATING ANY ENVIRONMENTAL COMMITMENTS. ANY QUESTIONS OR CONCERNS, CONTACT THE ODOT DISTRICT 6 ENVIRONMENTAL COORDINATOR, MARCI LININGER, AT MARCI.LININGER@DOT.OHIO.GOV 740.833.8065.

I:\Project\Dot\05025_PIC-674-10.19\Design\Roadway\Sheets\05025_GN001.dgn GENERAL NOTES - SHEET 1 2/27/2020 4:05:34 PM k.fiant

CALCULATED
MJR
CHECKED
JPH

GENERAL NOTES

PIC-674-10.19 / 10.35

ITEM 606 - ITEM 606 - ANCHOR ASSEMBLY, (MGS) TYPE E, AS PER PLAN (NCHRP350):

THIS ITEM SHALL CONSIST OF FURNISHING AND INSTALLING ANY OF THE GUARDRAIL END TERMINALS FOR TYPE MGS GUARDRAIL AS LISTED ON ROADWAY ENGINEERING'S WEB PAGE UNDER ROADSIDE SAFETY DEVICES FOR APPROVED GUARDRAIL END TREATMENTS. INSTALLATION SHALL BE AT THE LOCATIONS SPECIFIED IN THE PLANS, IN ACCORDANCE WITH THE MANUFACTURER'S SPECIFICATIONS.

WHEN THE FACE OF THE ADJACENT (ATTACHED) GUARDRAIL IS LESS THAN 4' OFFSET FROM THE PROPOSED EDGE LINE, THE PROPOSED TYPE E ANCHOR ASSEMBLY SHALL BE INSTALLED USING A 25:1 FLARE RATE (24" OFFSET DESIGN) AS DETAILED IN THE SHOP DRAWINGS AND AS DIRECTED BY THE ENGINEER.

THE FACE OF THE TYPE E IMPACT HEAD SHALL BE COVERED WITH A SHEET OF TYPE G REFLECTIVE SHEETING, PER CMS 730.19.

REFER TO THE MANUFACTURER'S INSTRUCTIONS REGARDING THE INSTALLATION OF, AND THE GRADING AROUND THE FOUNDATION TUBES AND GROUND STRUT. THE TOP OF ANY FOUNDATION TUBE SHOULD BE LESS THAN 4 INCHES ABOVE THE GROUND. THE PLACEMENT OF THE FOUNDATION TUBES SHOULD BE AN APPROPRIATE DEPTH BELOW THE LEVEL LINE IN ORDER TO MAINTAIN THE FINISHED GUARDRAIL HEIGHT OF 31 INCHES FROM THE EDGE OF THE SHOULDER.

ON-SITE GRADING IS REQUIRED IF THE TOP OF THE FOUNDATION TUBES OR TOP OF THE GROUND STRUT DOES PROJECT MORE THAN 4 INCHES ABOVE THE GROUND LINE.

THE PAYMENT LIMIT (LENGTH) FOR THE PROPOSED ANCHOR ASSEMBLY, (MGS) TYPE E, AS PER PLAN SHALL BE 53'-1 1/2" (TO THE STANDARD MGS CONNECTION) AS DETAILED BELOW.

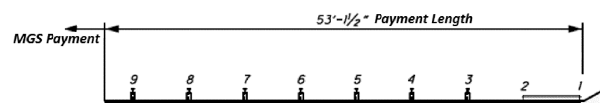

PAYMENT FOR THE ABOVE WORK SHALL BE MADE AT THE UNIT PRICE BID FOR ITEM 606, ANCHOR ASSEMBLY, MGS TYPE E, EACH, AND SHALL INCLUDE ALL LABOR, TOOLS, EQUIPMENT AND MATERIALS NECESSARY TO CONSTRUCT A COMPLETE AND FUNCTIONAL ANCHOR ASSEMBLY SYSTEM, INCLUDING ALL RELATED TRANSITIONS, REFLECTIVE SHEETING, HARDWARE, GRADING, EMBANKMENT AND EXCAVATION NOT SEPARATELY SPECIFIED, AS REQUIRED BY THE MANUFACTURER.

ITEM 623 - CONSTRUCTION LAYOUT STAKES, AND SURVEYING, AS PER PLAN:

THIS ITEM SHALL CONSIST OF STATIONING USING 3 FOOT LATH STAKES OR PAINT MARKINGS. THE STAKES OR PAINT MARKINGS SHALL BE PLACED AT 50 FOOT INTERVALS AND EXTEND THROUGHOUT THE LENGTH OF THE PROJECT. PLACEMENT OF THE STAKES OR PAINT MARKINGS SHALL BE AS DIRECTED BY THE ENGINEER. THE CONTRACTOR IS RESPONSIBLE FOR REPLACING ANY DAMAGED, MISSING STAKES, OR PAINT MARKINGS. PAINT MARKINGS SHALL BE PLACED ON CURBS OR AT THE EDGE OF PAVEMENT, AND USED IN AREAS WHERE THE PLACEMENT OF LATH STAKES IS NOT POSSIBLE AND BE APPROVED BY THE PROJECT ENGINEER.

ALL LABOR, MATERIALS, SERVICES, EQUIPMENT, TOOLS AND INCIDENTALS, INCLUDING THE REMOVAL LAYOUT STAKES SHALL BE PAID AT THE CONTRACT LUMP SUM BID PRICE FOR ITEM 623 - CONSTRUCTION LAYOUT STAKES, AND SURVEYING, AS PER PLAN.

ITEM 659 - SEEDING AND MULCHING:

SEEDING AND MULCHING SHALL BE APPLIED TO ALL AREAS OF EXPOSED SOIL BETWEEN THE RIGHT-OF-WAY LIMITS, AND WITHIN THE CONSTRUCTION LIMITS, FOR AREAS OUTSIDE THE RIGHT-OF-WAY LIMITS THAT ARE COVERED BY WORK AGREEMENT OR SLOPE EASEMENT. THE FOLLOWING QUANTITIES ARE PROVIDED TO PROMOTE GROWTH AND CARE OF PERMANENT SEEDED AREAS:

ITEM 659 - SEEDING AND MULCHING, CLASS 2 = 484 SY

ITEM 659 - COMERCIAL FERTILIZER
(RATE: 1 TON PER 7,410 SY OF PERMANENT SEEDED AREA)
484 SY / 7,410 = 0.07 TON

ITEM 659 - LIME
(RATE: 1 ACRE PER EVERY 4,840 SY OF PERMANENT SEEDED AREA)
484 SY X 1 ACRE / 4,840 SY = 0.10 ACRE

ITEM 659 WATER
(RATE: 0.0054 M GAL PER SY OF PERMANENT SEEDED AREA)
484 SY OF PERMANENT SEEDED AREA X 0.0054 M GAL / SY = 2.61 M GAL

ITEM SPECIAL 690 - TEMPORARY ACCESS DRIVE WITH NON-ERODIBLE FILL:

THIS ITEM INCLUDES THE CONSTRUCTION, UPKEEP AND MAINTENANCE, AND REMOVAL OF THE TEMPORARY ACCESS DRIVE AS DETAILED ON SHEET 20 OF 25 OF THE PLANS. THE DRIVE SHALL BE CONSTRUCTED OF NON-ERODIBLE MATERIAL AND SHALL BE REMOVED UPON COMPLETION OF THE PROJECT. THE AREA WILL BE REGRADED TO MATCH PRE-EXISTING SLOPE.

I:\Project+Data\05025_PIC-674-10.19\Design\Roadway\Sheets\05025_GN001.dgn GENERAL NOTES - SHEET 2 2/27/2020 4:16:32 PM k-flant

CALCULATED
MJR
CHECKED
JPH

GENERAL NOTES

PIC-674-10.19 / 10.35

5
25

I:\Project+Data\05025_PIC-674-10.19\Design\Roadway\Sheets\05025_GG001.dgn GENERAL SUMMARY 2/27/2020 4:52:37 PM kflant

SHEET NUM.											PART.		ITEM	ITEM EXT	GRAND TOTAL	UNIT	DESCRIPTION	SEE SHEET NO.
5	6	7	10	16	17	20	01/S>2/OT	02/S>2/BR										
											LS	LS	201	11001	LS		ROADWAY	4
			393.75			250	393.75	250					202	38000	643.75	FT	CLEARING AND GRUBBING, AS PER PLAN	
						90		90					SPECIAL	20270130	90	FT	GUARDRAIL REMOVED PIPE CLEANOUT OVER 48"	20
				4							4		203	10000	4	CY	EXCAVATION	
				17							17		203	20000	17	CY	EMBANKMENT	
			0.16								0.16		209	72050	0.16	MILE	PREPARING SUBGRADE FOR SHOULDER PAVING	
			0.16								0.16		209	60500	0.16	MILE	LINEAR GRADING	
				250								250	606	13000	250	FT	GUARDRAIL, TYPE 5	
				343.75			343.75						606	15050	343.75	FT	GUARDRAIL, TYPE MGS	
				1			1						606	26150	1	EACH	ANCHOR ASSEMBLY, MGS TYPE E, NCHRP350	
57												57	SPECIAL	69098300	57	SY	TEMPORARY ACCESS DRIVE WITH NON-ERODIBLE FILL	5
																	EROSION CONTROL	
484							484						659	00510	484	SY	SEEDING AND MULCHING, CLASS 2	
0.07							0.07						659	20000	0.07	TON	COMMERCIAL FERTILIZER	
0.1							0.1						659	31000	0.1	ACRE	LIME	
3							3						659	35000	3	MGAL	WATER	
							2,000	3,000					832	30000	5,000	EACH	EROSION CONTROL	
																	DRAINAGE	
						LS					LS		503	11100	LS		COFFERDAMS AND EXCAVATION BRACING	
						165							165	34401	165	CY	ROCK CHANNEL PROTECTION, WITH GROUT, AS PER PLAN, TYPE B	20
						90							90	96550	90	FT	FIELD PAVING OF EXISTING PIPE, TYPE A, 108" DIAMETER	
																	PAVEMENT	
			1,067				1,067						254	01000	1,067	SY	PAVEMENT PLANING, ASPHALT CONCRETE, 1.5" THICKNESS	
			91				91						407	20000	91	GAL	NON-TRACKING TACK COAT	
			52				52						441	50000	52	CY	ASPHALT CONCRETE SURFACE COURSE, TYPE 1, (448), PG64-22	
			47				47						617	10100	47	CY	COMPACTED AGGREGATE, 8" THICKNESS	
																	TRAFFIC CONTROL	
						15	15				15		621	00100	15	EACH	RPM	
						15							621	54000	15	EACH	RAISED PAVEMENT MARKER REMOVED	
			15			3	15	3					626	00110	18	EACH	BARRIER REFLECTOR, TYPE 2, BIDIRECTIONAL	
			0.16				0.16						642	00104	0.16	MILE	EDGE LINE, 6", TYPE 1	
			0.08				0.08						642	00300	0.08	MILE	CENTER LINE, TYPE 1	
																	RETAINING WALLS (TANGENT DRILLED SHAFT)	
					2		2						503	21100	2	CY	UNCLASSIFIED EXCAVATION	
					1,755		1,755						507	00400	1,755	FT	STEEL PILES, MISC.:W21X50 STEEL BEAM, FURNISHED	17
					1,800		1,800						524	94603	1,800	FT	DRILLED SHAFTS, 30" DIAMETER, ABOVE BEDROCK, AS PER PLAN	17
					645		645						524	95000	645	FT	DRILLED SHAFTS, MISC.:PLUG PILE, 30" DIAMETER (UNREINFORCED)	17
					1		1						602	20000	1	CY	CONCRETE MASONRY	
																	MAINTENANCE OF TRAFFIC	
							LS				LS		614	12420	LS		DETOUR SIGNING	
							2						614	18601	2	SNMT	PORTABLE CHANGEABLE MESSAGE SIGN, AS PER PLAN, TYPE B	7
	500						500						254	01000	500	SY	PAVEMENT PLANING, ASPHALT CONCRETE, 1.5" THICKNESS	
	43						43						441	50000	43	CY	ASPHALT CONCRETE SURFACE COURSE, TYPE 1, (448), PG64-22	
	20						20						407	20000	20	GAL	NON-TRACKING TACK COAT	
																	INCIDENTALS	
							LS				LS		614	11000	LS		MAINTAINING TRAFFIC	
							LS				LS		623	10000	LS		CONSTRUCTION LAYOUT STAKES AND SURVEYING	
							LS				LS		624	10000	LS		MOBILIZATION	

GENERAL SUMMARY

PIC-674-10.19 / 10.35

- ESTIMATED TEMPORARY FILL

TOTAL ESTIMATED PLAN AREA OF TEMPORARY FILL = 0.01 ACRES
 TOTAL ESTIMATED VOLUME OF TEMPORARY FILL MATERIAL = 29 CUBIC YARDS
 AREA 1 = 157.1 SQ FT
 DEPTH OF FILL TO OHWM = 1.25 FT, VOLUME = 7.3 CU YD
 ADDITIONAL FILL ABOVE OHWM = 1.0 FT, VOLUME = 5.8 CU YD
 AREA 2 = 396.7 SQ FT
 DEPTH OF FILL TO OHWM = 2.60 FT
 VOLUME = 38.2 CU YD
 ADDITIONAL FILL ABOVE OHWM = 1.0 FT
 VOLUME = 14.7 CU YD
 TOTAL VOLUME OF TEMP FILL = 66 CU YD

ITEM 202 SPECIAL - PIPE CLEANOUT OVER 48"
 THIS WORK CONSISTS OF REMOVING SEDIMENT AND DEBRIS FROM THE EXISTING CONDUIT. ALL MATERIAL REMOVED MUST BE DISPOSED OF AS PER 105.16 AND 105.17. THE CONDUIT MUST BE CLEANED OUT TO THE SATISFACTION OF THE ENGINEER.
 CLEAN OUT OF THE CONDUIT WILL BE PAID FOR AT THE UNIT PRICE BID FOR ITEM SPECIAL - PIPE CLEANOUT OVER 48". THIS PRICE INCLUDES THE COST OF EQUIPMENT, LABOR, AND INCIDENTALS NECESSARY TO COMPLETE THIS WORK.

ITEM 601 ROCK CHANNEL PROTECTION, WITH GROUT AS PER PLAN, TYPE B
 THE CONTRACTOR MUST PLACE AND GROUT THE PROPOSED ROCK CHANNEL PROTECTION IN LIFTS. INSTALL FILTER FABRIC 712.09 UNDER THE FIRST LIFT. THE FIRST LIFT MUST BE INSTALLED TO THE BOTTOM OF THE CULVERT FOOTING AND THE CONTRACTOR MUST VERIFY THAT GROUT AND STONE HAS FILLED THE VOID UNDER THE WALL. THE SECOND LIFT MAY BE BROUGHT TO THE FINISHED LEVEL.

ESTIMATED QUANTITIES				
ITEM	ITEM EXT	GRAND TOTAL	UNIT	DESCRIPTION
202	38000	250	FT	GUARDRAIL REMOVED FOR REUSE, AS PER PLAN
202	70130	90	FT	SPECIAL-PIPE CLEANOUT OVER 48"
503	11100		LS	COFFERDAMS AND EXCAVATION BRACING
601	34401	165	CY	ROCK CHANNEL PROTECTION, WITH GROUT, AS PER PLAN TYPE B
606	13000	250	FT	GUARDRAIL, TYPE 5
611	96550	90	FT	FIELD PAVING OF EXISTING PIPE, TYPE A, 108"
624	00110	3	EACH	BARRIER REFLECTOR, TYPE 2, BIDIRECTIONAL

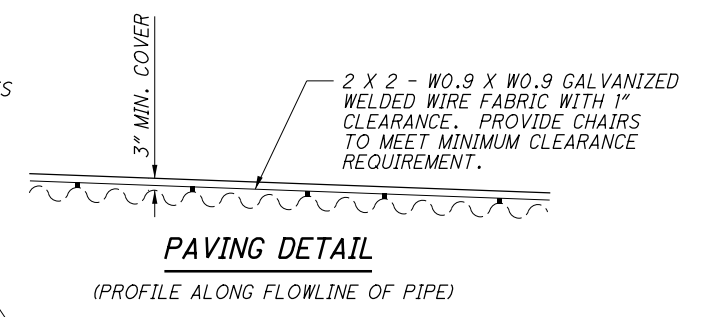
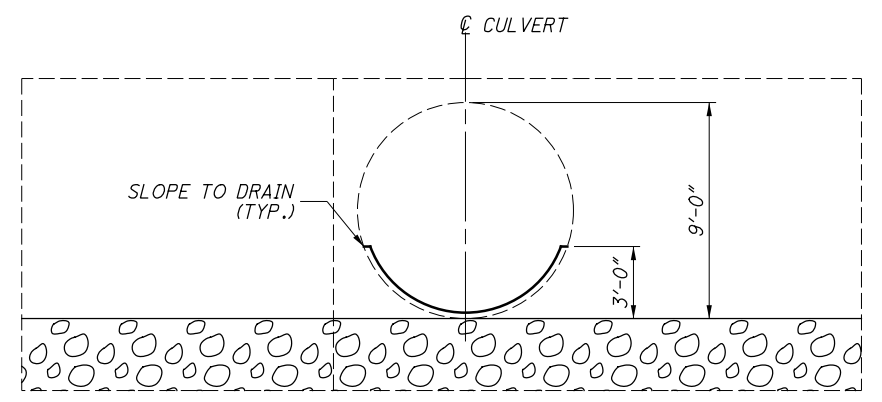
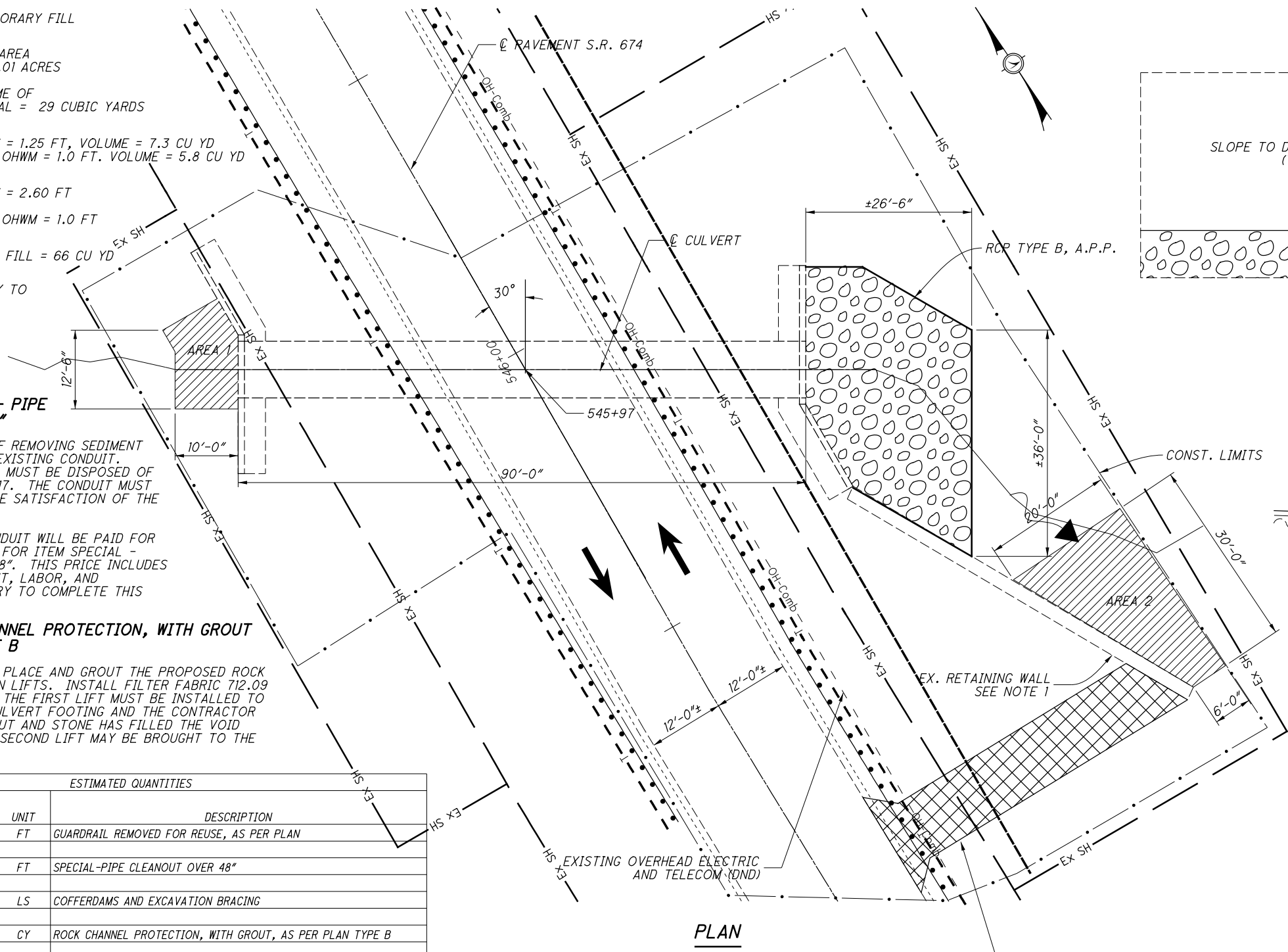

- LEGEND**
- ITEM 601 ROCK CHANNEL PROTECTION, WITH GROUT, AS PER PLAN, TYPE B
 - TEMPORARY ACCESS DRIVE WITH NON-ERODIBLE FILL

- NOTES:**
- TEMPORARY FILL MAY BE PLACED ON SIDE OF RETAINING WALL TO ALLOW ACCESS TO STREAM. TEMPORARY FILL MUST BE REMOVED ONCE PROJECT IS COMPLETE. WALL IS MODULAR CONCRETE WALL. ANY DAMAGE TO THE WALL IS TO BE REPAIRED BY CONTRACTOR.

HYDRAULIC DATA
 Q (25) = 103 CFS V (25) = 7.46 FT/S
 Q (100) = 146 CFS V (100) = 8.24 FT/S

EXISTING STRUCTURE
 TYPE: CORRUGATED METAL PIPE
 LENGTH: 90'-0" ALONG ϕ PIPE
 SPAN: 10'-4 5/8" \pm ALONG ϕ ROADWAY
 SIZE/DIAMETER: 9'-0" (108")
 SKEW: 30° L.F.
 STRUCTURAL (CULVERT) FILE NUMBER: CFN 1974911
 DATE BUILT: 1984
 DISPOSITION: INVERT PAVING AND EROSION PROTECTION AT OUTLET

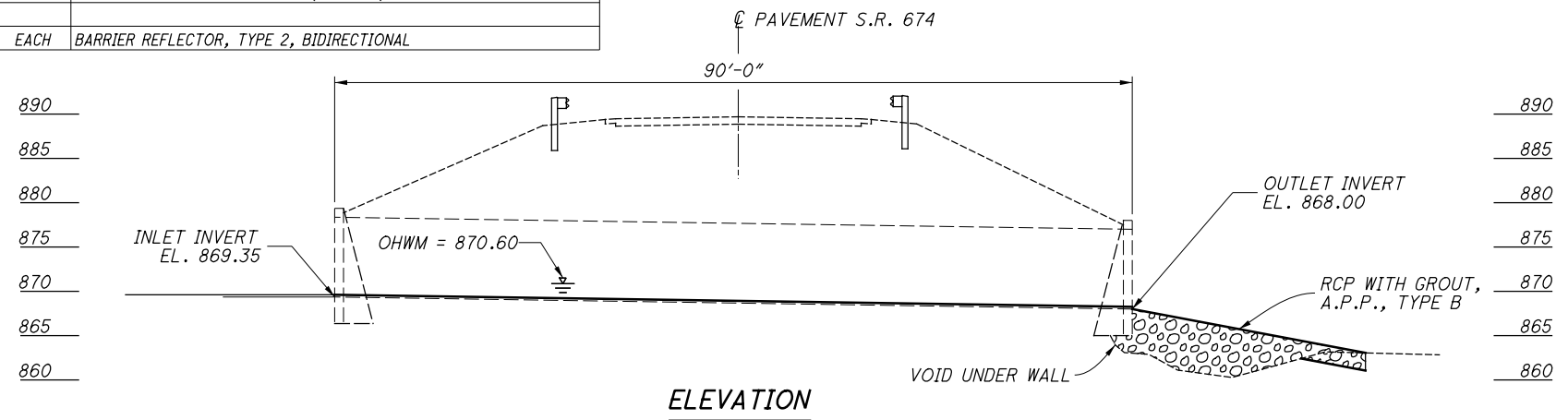

I:\ProjectData\05025_PIC-674-10.19\Design\Roadway\Basesmaps\05025_DC002.dgn CULVERT DETAIL SHEET 2/27/2020 3:56:13 PM kflant