

TYPICAL SECTION 1				
ROUTE	SLM		AVG. PW (FEET)	LENGTH (MILES)
	FROM	TO		
SR 59	7.21	7.58	42	0.37
SR 59	7.58	7.73	47	0.15
SR 59	7.99	8.08	69	0.09
SR 59	8.08	8.16	40	0.08
SR 59	8.16	8.61	29	0.45

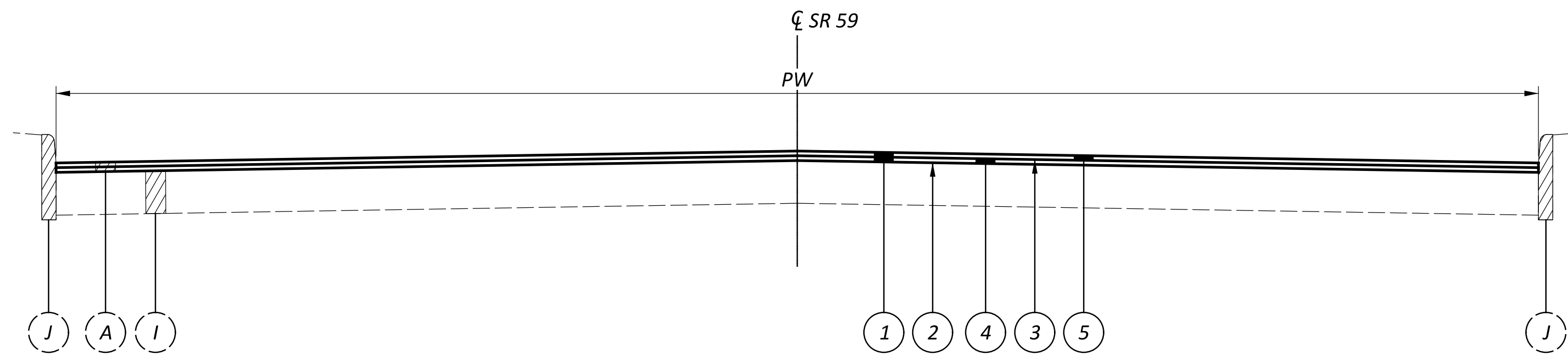

TYPICAL SECTION 2				
ROUTE	SLM		AVG. PW (FEET)	LENGTH (MILES)
	FROM	TO		
SR 59	8.61	9.05	55	0.42

LEGEND

- (A) EXISTING ASPHALT CONCRETE (T = 2"±)
- (B) EXISTING ASPHALT CONCRETE (T = 3"±)
- (C) EXISTING ASPHALT CONCRETE (T = 4"±)
- (D) EXISTING RIGID BRICK BASE (T = 4"±)
- (E) EXISTING SAND CUSHION (T = 1"±)
- (F) EXISTING GRANULATED SLAG SUBBASE (T = 8"±)
- (G) EXISTING PLAIN CONCRETE BASE (T = 3"±)
- (H) EXISTING PLAIN CONCRETE BASE (T = 6"±)
- (I) EXISTING PLAIN CONCRETE BASE (T = 9"±)
- (J) EXISTING CURB
- (K) EXISTING CURB AND GUTTER
- (1) ITEM 254, PAVEMENT PLANING, ASPHALT CONCRETE, AS PER PLAN (T = 2")
- (2) ITEM 407, TACK COAT, 702.13 @ 0.09 GAL/SY
- (3) ITEM 407, NON-TRACKING TACK COAT @ 0.06 GAL/SY
- (4) ITEM 441, ASPHALT CONCRETE INTERMEDIATE COURSE, TYPE 1, (448) (T = 1.25")
- (5) ITEM 424, FINE GRADED POLYMER ASPHALT CONCRETE, TYPE A, (449), AS PER PLAN* (T = 0.75") *ADTT < 1,500

DESIGN AGENCY



DESIGNER	CMS
REVIEWER	MJP 04/27/23
PROJECT ID	102732
SHEET	TOTAL
P.2	35

SHEET NUM.										PART.			ITEM	ITEM EXT	GRAND TOTAL	UNIT	DESCRIPTION	SEE SHEET NO.	
5	6	7	8	17	18	19	26	27	29	01/NHS/05/RA	02/NHS/05/RA	03/NHS/13							
ROADWAY																			
					6,104	4,178							10,282	202	30000	10,282	SF	WALK REMOVED	
					107	300							407	202	32000	407	FT	CURB REMOVED	
					159	5							164	202	32500	164	FT	CURB AND GUTTER REMOVED	
125													125	203	10000	125	CY	EXCAVATION (FOR PAVEMENT REPAIR)	
						1							1	203	10000	1	CY	EXCAVATION (FOR WALK OR CURB RAMP INSTALLATION)	
					1,330	1,525							2,855	608	10000	2,855	SF	4" CONCRETE WALK	
					4,195	2,746							6,941	608	52000	6,941	SF	CURB RAMP	
10													10	623	39501	10	EACH	MONUMENT BOX ADJUSTED TO GRADE, AS PER PLAN	
	LUMP												LUMP	SPECIAL	69091000	LS		AS-BUILT CONSTRUCTION PLANS	
EROSION CONTROL																			
													3,000	832	30000	3,000	EACH	EROSION CONTROL	
DRAINAGE																			
25													25	611	98630	25	EACH	CATCH BASIN ADJUSTED TO GRADE	
5													5	611	98634	5	EACH	CATCH BASIN RECONSTRUCTED TO GRADE	
20													20	611	99655	20	EACH	MANHOLE ADJUSTED TO GRADE, AS PER PLAN	
1,250													1,250	SPECIAL	61199820	1,250	LB	MISCELLANEOUS METAL	
PAVEMENT																			
4,600													4,600	252	01500	4,600	FT	FULL DEPTH PAVEMENT SAWING	
750													750	253	01001	750	SY	PAVEMENT REPAIR, AS PER PLAN	
				66,413									66,413	254	01001	66,413	SY	PAVEMENT PLANING, ASPHALT CONCRETE, AS PER PLAN (T = 2.0")	
													6,641	254	01600	6,641	SY	PATCHING PLANED SURFACE	
125													125	304	20000	125	CY	AGGREGATE BASE (FOR PAVEMENT REPAIR)	
				5,978									5,978	407	13900	5,978	GAL	TACK COAT, 702.13 @ 0.08 GAL/SY	
				3,985									3,985	407	20000	3,985	GAL	NON-TRACKING TACK COAT @ 0.06 GAL/SY	
				1,384									1,384	424	13101	1,384	CY	FINE GRADED POLYMER ASPHALT CONCRETE, TYPE A, (449), AS PER PLAN	
				2,306									2,306	441	50200	2,306	CY	ASPHALT CONCRETE INTERMEDIATE COURSE, TYPE 1, (448)	
					199	7							206	609	12000	206	FT	COMBINATION CURB AND GUTTER, TYPE 2	
					134	375							509	609	26000	509	FT	CURB, TYPE 6	
WATER WORK																			
15						1							15	1	638	10801	16	EACH	VALVE BOX ADJUSTED TO GRADE, AS PER PLAN
TRAFFIC CONTROL																			
	42												42	630	02100	42	FT	GROUND MOUNTED SUPPORT, NO. 2 POST	
	12												12	630	80100	12	SF	SIGN, FLAT SHEET	
	2												2	630	80100	2	SF	SIGN, FLAT SHEET, 730.20	
	6												6	630	84900	6	EACH	REMOVAL OF GROUND MOUNTED SIGN AND DISPOSAL	
	4												4	630	86002	4	EACH	REMOVAL OF GROUND MOUNTED POST SUPPORT AND DISPOSAL	
							2.73						2.73	646	10110	2.73	MILE	LANE LINE, 6"	
							2.33						2.33	646	10200	2.33	MILE	CENTER LINE	
							218	1,969					2,187	646	10310	2,187	FT	CHANNELIZING LINE, 12"	
							301	493					794	646	10400	794	FT	STOP LINE	
							1,897	3,658					5,555	646	10520	5,555	FT	CROSSWALK LINE, 24"	
								763					763	646	10600	763	FT	TRANSVERSE/DIAGONAL LINE, WHITE	
								258					258	646	20370	258	EACH	TWO WAY LEFT TURN ARROW	
								317					317	646	10800	317	SF	ISLAND MARKING	
								12					12	646	10900	12	EACH	HANDICAP SYMBOL MARKING	
							3						3	646	20110	3	EACH	SCHOOL SYMBOL MARKING, 96"	
								2,621					2,621	646	20200	2,621	FT	PARKING LOT STALL MARKING	
							6	41					47	646	20300	47	EACH	LANE ARROW	
							2						2	646	20350	2	EACH	LANE REDUCTION ARROW	
								3					3	646	20300	3	EACH	LANE ARROW	
STRUCTURE REPAIRS																			
																		FOR POR-59-0605 ESTIMATED QUANTITIES	
MAINTENANCE OF TRAFFIC																			
													100	614	11110	100	HOUR	LAW ENFORCEMENT OFFICER WITH PATROL CAR FOR ASSISTANCE	
			4										4	614	12460	4	EACH	WORK ZONE MARKING SIGN	
			20										20	614	13000	20	CY	ASPHALT CONCRETE FOR MAINTAINING TRAFFIC	
			14										14	614	18601	14	SNMT	PORTABLE CHANGEABLE MESSAGE SIGN, AS PER PLAN	
			5.14										5.14	614	20010	5.14	MILE	WORK ZONE LANE LINE, CLASS 1, 6"	

GENERAL SUMMARY

DESIGN AGENCY	
	
DESIGNER	CMS
REVIEWER	MJP 04/27/23
PROJECT ID	102732
SHEET	P.15
TOTAL	35

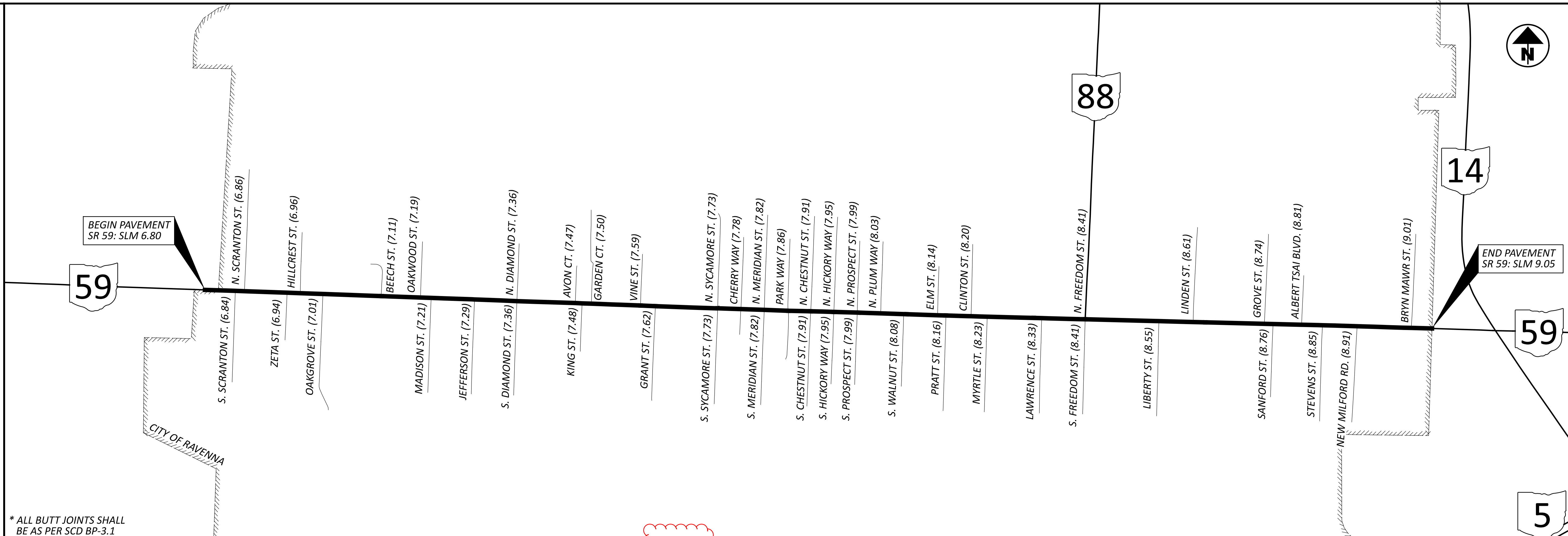

* ALL BUTT JOINTS SHALL BE AS PER SCD BP-3.1

SLM RANGE			TYPICAL SECTION	SIDE	DISTANCE (D)	AVERAGE WIDTH (W)	SURFACE AREA (A) A=DxW/9	CADD GENERATED AREA	PAVEMENT PLANING, ASPHALT CONCRETE, AS PER PLAN (T = 2.0")	TACK COAT, 702.13 @ 0.09 GAL/SY	NON-TRACKING TACK COAT @ 0.06 GAL/SY	FINE GRADED POLYMER ASPHALT CONCRETE, TYPE A, (449), AS PER PLAN (T = 0.75")	ASPHALT CONCRETE INTERMEDIATE COURSE, TYPE 1, (448) (T = 1.25")						
					FT	FT	SQ YD	SQ YD	SY	GAL	GAL	CY	CY						
MAINLINE SR 59																			
6.80	TO	7.21	3	L/R	2164.80	50.00	12026.67		12026.67	1082.40	721.60	250.56	417.59						
7.21	TO	7.58	1	L/R	1953.60	42.00	9116.80		9116.80	820.51	547.01	189.93	316.56						
7.58	TO	7.73	1	L/R	792.00	47.00	4136.00		4136.00	372.24	248.16	86.17	143.61						
7.73	TO	7.86	4	L/R	686.40	71.00	5414.93		5414.93	487.34	324.90	112.81	188.02						
7.86	TO	7.91	5	L/R	264.00	71.00	2082.67		2082.67	187.44	124.96	43.39	72.31						
7.91	TO	7.95	6	L/R	211.20	86.00	2018.13		2018.13	181.63	121.09	42.04	70.07						
7.95	TO	7.99	7	L/R	211.20	69.00	1619.20		1619.20	145.73	97.15	33.73	56.22						
7.99	TO	8.08	1	L/R	475.20	69.00	3643.20		3643.20	327.89	218.59	75.90	126.50						
8.08	TO	8.16	1	L/R	422.40	40.00	1877.33		1877.33	168.96	112.64	39.11	65.19						
8.16	TO	8.61	1	L/R	2376.00	29.00	7656.00		7656.00	689.04	459.36	159.50	265.83						
8.61	TO	9.05	2	L/R	2323.20	55.00	14197.33		14197.33	1277.76	851.84	295.78	492.96						
INTERSECTIONS																			
6.80	TO	9.05			VARIES	VARIES		2624.03	2624.03	236.16	157.44	54.67	91.11						
SUBTOTALS									66412.30	5977.11	3984.74	1383.59	2305.98						
TOTALS CARRIED TO GENERAL SUMMARY									66413	5978	3985	1384	2306						

PAVEMENT CALCULATIONS

DESIGN AGENCY

DESIGNER **CMS**

REVIEWER **MJP 04/27/23**

PROJECT ID **102732**

SHEET **P.17** TOTAL **35**