

STATE OF OHIO DEPARTMENT OF TRANSPORTATION

SAN-6/20I-14.87/0.00

FOR PART 2, SEE SAN-CR20W-0.00

SANDUSKY TOWNSHIP
SANDUSKY COUNTY

FEDERAL PROJECT NUMBER

E200611

RAILROAD INVOLVEMENT

NONE

PROJECT DESCRIPTION

RECONFIGURE C.R. 20 ACCESS TO U.S. 6 WITH A HIGH SPEED ENTRANCE RAMP. REMOVE ACCESS T.R. 138 TO U.S. 20. RECONFIGURE OVERHEAD SIGNS AND MARKINGS FOR NEW LANE UTILIZATION ON WESTBOUND U.S. 20 AND EASTBOUND IN ADVANCE OF THE INTERCHANGE.

EARTH DISTURBED AREAS

PROJECT EARTH DISTURBED AREA: 4.24 ACRES
ESTIMATED CONTRACTOR EARTH DISTURBED AREA: 0.40 ACRES
NOTICE OF INTENT EARTH DISTURBED AREA: 4.64 ACRES

LIMITED ACCESS

THIS IMPROVEMENT IS ESPECIALLY DESIGNED FOR THROUGH TRAFFIC AND HAS BEEN DECLARED A LIMITED ACCESS HIGHWAY OR FREEWAY BY ACTION OF THE DIRECTOR IN ACCORDANCE WITH THE PROVISIONS OF SECTION 5511.02 OF THE OHIO REVISED CODE.

2019 SPECIFICATIONS

THE STANDARD SPECIFICATIONS OF THE STATE OF OHIO, DEPARTMENT OF TRANSPORTATION, INCLUDING SUPPLEMENTAL SPECIFICATIONS LISTED IN THE PLANS AND CHANGES LISTED IN THE PROPOSAL SHALL GOVERN THIS IMPROVEMENT.

I HEREBY APPROVE THESE PLANS AND DECLARE THAT THE MAKING OF THIS IMPROVEMENT WILL REQUIRE THE PART TIME CLOSING OF THE HIGHWAY TO TRAFFIC, AS NOTED ON SHEET 21. DURING WHICH TIME DETOURS WILL BE PROVIDED AS SHOWN HEREIN. PROVISIONS FOR THE MAINTENANCE AND SAFETY OF TRAFFIC WILL BE AS SET FORTH ON THE PLANS AND ESTIMATES.

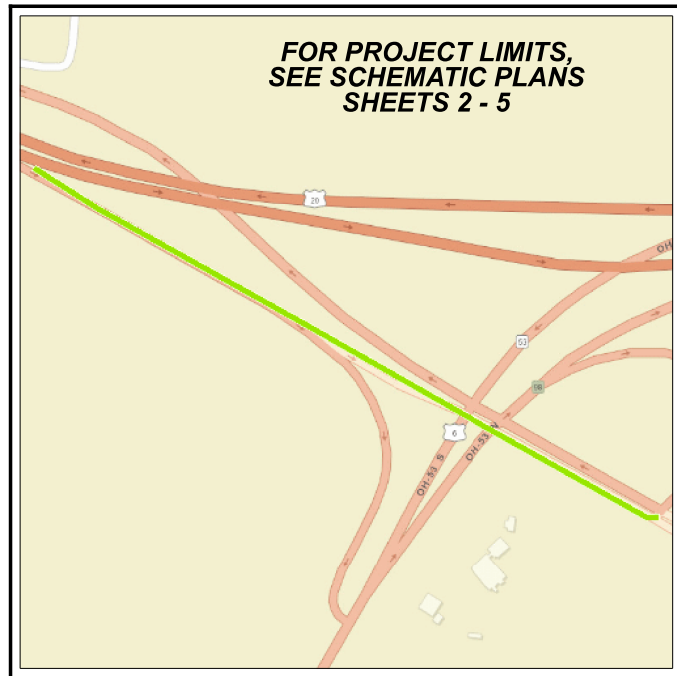

LOCATION MAP

LATITUDE: 41°22'04" N LONGITUDE: 83°09'42" W



PORTION TO BE IMPROVED	_____
INTERSTATE HIGHWAY	=====
FEDERAL ROUTES	-----
STATE ROUTES	-----
COUNTY & TOWNSHIP ROADS	-----
OTHER ROADS	-----

**DESIGN DESIGNATION - (A) U.S. 6
- (B) C.R. 20 (W. STATE ST.)
- (C) U.S. 20 WEST OF INTERCHANGE**

OPENING YEAR ADT (2022)	(A) 10500, (B) 7500, (C) 14000
DESIGN YEAR ADT (2042)	(A) 11500, (B) 10100, (C) 17000
DESIGN HOURLY VOLUME (2042)	(A) 1000, (B) 1000, (C) 1500
DIRECTIONAL DISTRIBUTION	(A) 50%, (B) 57%, (C) 53%
TRUCKS (24 HOUR B&C)	(A) 23%, (B) 9%, (C) 17%
DESIGN SPEED	(A) 60, (B) VARIES, (C) 65
LEGAL SPEED	(A) 55, (B) VARIES, (C) 60
DESIGN FUNCTIONAL CLASSIFICATION:	
RURAL PRINCIPAL ARTERIAL	_____
NHS PROJECT	_____ YES

DESIGN EXCEPTIONS

NONE REQUIRED

ADA DESIGN WAIVERS

NONE REQUIRED

UNDERGROUND UTILITIES
Contact Two Working Days
Before You Dig

Before You Dig

OHIO811. 8-1-1. or 1-800-362-2764
(Non members must be called directly)

PLAN PREPARED BY:



©2021 LJB Inc. All rights reserved. No part of this drawing may be used, reproduced, or modified in any manner without the prior written authorization of LJB Inc. Any such unauthorized use or reproduction of or modification to this drawing is done at the user's own risk and the user agrees to indemnify, defend and hold harmless LJB Inc. from and against any and all claims, liability, and expense, including, but not limited to, reasonable attorney's fees, arising from such use, reproduction or modification.

DESIGN DESIGNATION - U.S. 6/20 EAST OF INTERCHANGE

OPENING YEAR ADT (2022)	15000
DESIGN YEAR ADT (2042)	16000
DESIGN HOURLY VOLUME (2042)	1300
DIRECTIONAL DISTRIBUTION	52%
TRUCKS (24 HOUR B&C)	17%
DESIGN SPEED	70
LEGAL SPEED	65
DESIGN FUNCTIONAL CLASSIFICATION:	
RURAL EXPRESSWAY	_____
NHS PROJECT	_____ YES

**DESIGN DESIGNATION - EB C.R. 20 (W. STATE ST.)
TO U.S. 6 RAMP**

OPENING YEAR ADT (2022)	1100
DESIGN YEAR ADT (2042)	1400
DESIGN HOURLY VOLUME (2042)	160
DIRECTIONAL DISTRIBUTION	100%
TRUCKS (24 HOUR B&C)	22%
DESIGN SPEED	45
DESIGN FUNCTIONAL CLASSIFICATION:	
RURAL LOCAL	_____
NHS PROJECT	_____ NO

INDEX OF SHEETS:

TITLE SHEET	1
SCHEMATIC PLAN	2 - 6
TYPICAL SECTION	7 - 11
GENERAL NOTES	12 - 14
MAINTENANCE OF TRAFFIC	15 - 27, 15A, 27A-27D
GENERAL SUMMARY	28 - 30
PAVEMENT SUBSUMMARY	31-31A
ROADWAY SUBSUMMARY	32
DRAINAGE SUBSUMMARY	33
PROJECT SITE PLAN	34
PLAN - RESURFACING	35 - 55
PLAN AND PROFILE - U.S. 6 & RAMP G	56 - 60
CROSS SECTIONS - U.S. 6 & RAMP G	61 - 80
PAVEMENT ELEVATION TABLE - U.S. 6	81
SUPERELEVATION TABLE - RAMP G	82
GRADING PLAN - EXISTING RAMP G	83
GORE GRADING - U.S. 6 & RAMP G	84 - 85
PAVEMENT JOINT DETAILS	86 - 89
INTERSECTION & MEDIAN DETAILS	90 - 93
DRIVE DETAILS	94
DITCH AND STORM SEWER	95
PLAN AND PROFILE	
TRAFFIC CONTROL	96 - 150
SOIL PROFILES	151 - 157

ENGINEER'S SEAL:
FOR SHEETS 96 - 150

SIGNED: *Laurence A. Sack*
DATE: 09/29/2021

ENGINEER'S SEAL:
FOR SHEETS 1 - 95

SIGNED: *Joseph R. Espelage*
DATE: 09/29/2021

STANDARD CONSTRUCTION DRAWINGS								SUPPLEMENTAL SPECIFICATIONS	SPECIAL PROVISIONS
BP-2.1	7/17/15	MGS-4.2	7/19/13	TC-21.11	7/16/21	TC-61.30	7/19/19	800-2019	7/17/20
BP-2.2	1/15/21	MGS-4.3	1/18/13	TC-21.21	7/16/21	TC-65.10	1/17/14	832	10/19/18
BP-2.5	7/19/13	MGS-5.2	7/15/16	TC-22.10	4/17/20	TC-65.11	7/21/17	861	1/15/21
BP-3.1	1/17/20	MGS-5.3	7/15/16	TC-22.20	1/17/14	TC-71.10	7/16/21	874	4/17/20
BP-4.1	7/19/13			TC-41.10	7/19/13	TC-72.20	7/20/18	1120	7/16/21
BP-6.1	7/19/13	RM-1.1	1/15/21	TC-41.20	10/18/13	TC-73.20	1/17/20		
		RM-4.1	7/21/17	TC-41.30	10/18/13				
DM-1.1	7/17/20			TC-41.40	10/18/13				
DM-1.2	7/16/21	MT-95.30	7/19/19	TC-41.50	10/18/13				
		MT-97.10	4/19/19	TC-42.10	10/18/13				
F-2.1	7/20/18	MT-97.12	1/20/17	TC-42.20	10/18/13				
		MT-99.20	4/19/19	TC-51.11	1/15/16				
MGS-1.1	7/16/21			TC-51.12	1/15/16				
MGS-2.1	1/19/18	TC-12.31	1/21/22	TC-52.10	10/18/13				
MGS-3.1	1/19/18	TC-15.116	7/16/21	TC-52.20	1/15/21				
MGS-3.2	1/18/13	TC-16.22	7/16/21	TC-61.10	1/17/20				

APPROVED _____
DATE _____ DISTRICT DEPUTY DIRECTOR

APPROVED _____
DATE _____ DIRECTOR, DEPARTMENT OF TRANSPORTATION

TITLE SHEET

DESIGN AGENCY

DESIGNER
BMG

REVIEWER
JRE 07/19/21

PROJECT ID
111020

SHEET TOTAL
1 | 157

SAN-6/20I-14.87/0.00

MODEL: Sheet PAPER SIZE: 17x11 (in.) DATE: 4/11/2022 TIME: 8:59:07 AM USER: jespelage C:\ODOT_D2\0118257A\00 - SAN-6_20I-1487_000\111020400-Engineering\Roadway\Sheets\111020_GT0001.dgn

PHASE 1--CONSTRUCT PROPOSED C.R. 20 MEDIAN PAVEMENT AT RAMP G AND PROPOSED COUNTY ROAD 20 DRIVE ACCESS MEDIAN CROSSOVER.

1. CLOSE LEFT LANE OF EASTBOUND AND WESTBOUND C.R. 20 (WEST STATE STREET) USING A DESIGN SPEED OF 45 MPH WESTBOUND AND 45 MPH EASTBOUND AND MT-95.30 (CLOSING RIGHT OR LEFT LANE OF A MULTI-LANE DIVIDED HIGHWAY WITH DRUMS).
2. CONSTRUCT DRIVE CROSSOVER EAST OF THE U.S. 6 OVERPASS NEAR STA. 258+50. TO REMAIN CLOSED UNTIL NEW RAMP G IS COMPLETED. MAINTAIN ACCESS TO MADISON MOTORS AT ALL TIMES.
3. CONSTRUCT CROSSOVER FOR PROPOSED RAMP G AND LEAVE CLOSED OFF USING MT-98.30 (INTERSECTION ENTRANCE RAMP AND TURN BAY CLOSURE).
4. DRUM OFF THE EXISTING T.R. 138 CROSSOVER ALONG SOUTH (LEFT-HAND) EDGE LINE OF WESTBOUND C.R. 20 (WEST STATE STREET).
5. DRUM OFF THE EXISTING T.R. 138 CROSSOVER ALONG NORTH (RIGHT-HAND) EDGE LINE OF WESTBOUND U.S. 20.
6. CLOSE THE LEFT-HAND LANE OF WESTBOUND U.S. 20 USING A DESIGN SPEED OF 60 MPH, MT-95.30 (CLOSING RIGHT OR LEFT LANE OF A MULTI-LANE DIVIDED HIGHWAY WITH DRUMS).
7. CLOSE THE NORTH (LEFT-HAND) LANE OF EASTBOUND C.R. 20 (WEST STATE STREET) USING A DESIGN SPEED OF 60 MPH AND MT-95.30 (CLOSING RIGHT OR LEFT LANE OF A MULTI-LANE DIVIDED HIGHWAY WITH DRUMS).

PHASE 2--CONSTRUCT PROPOSED RAMP G (C.R. 20 (WEST STATE STREET TO WESTBOUND U.S. 6)) AND WIDENING OF U. S. 6 SOUTH OF C.R. 20.

1. SWITCH EB W STATE STREET LEFT LANE CLOSURE (FROM PHASE 1) TO RIGHT LANE CLOSURE.
2. DETOUR RAMP G AS SHOWN IN THESE PLANS. CLOSURE TO BE LIMITED TO 70 CALENDAR DAYS.
3. CONSTRUCT PAVEMENT FOR MAINTAINING TRAFFIC ALONG EASTERN SHOULDER OF US 6 SOUTH OF C.R. 20
 - A. CLOSURE OF WB/SB U.S. 6 LIMITED TO 4 DAYS FOR INSTALLATION OF THE PAVEMENT FOR MAINTAINING TRAFFIC/CONCRETE BARRIER WALL AND REALIGNMENT OF TRAFFIC LANES ON US 6 SOUTH OF C.R. 20
 - I. CLOSE WB/SB US 6 AT RAMP TO WB 20 (STATION 805+00+/-)
 - II. DETOUR OF WB/SB US 6: WB 20 TO SB 590 TO US 6.
 - III. SHIFT EB/NB US 6 OVER TO WB/SB LANES OF US 6 BETWEEN STATIONS 500+75 AND 516+27
 - IV. INSTALL PAVEMENT FOR MAINTAINING TRAFFIC.
 - V. INSTALL TEMPORARY PAVEMENT MARKINGS
 - VI. SHIFT EB/NB US 6 ONTO NEWLY INSTALLED PAVEMENT FOR MAINTAINING TRAFFIC.
 - VII. INSTALL CONCRETE BARRIER WALL ALONG WB/SB US 6
 - VIII. REOPEN WB/SB US 6
4. CONSTRUCT WIDENING OF U. S. 6 AND RAMP G ALONG WEST SIDE OF THE ROADWAY
5. CLOSE WB/SB US 6 AT WB 20 (STATION 805+00+/-) FOR UP TO 4 DAYS. EB/NB US 6 TO REMAIN OPEN.
 - A. REMOVE CONCRETE BARRIER WALL.
 - B. COMPLETE MILL/FILL, PAVEMENT MARKINGS FROM SOUTH END OF PROJECT UP TO C.R. 20 BY SHIFTING THE EB/NB TRAFFIC TO THE WB/SB LANES WHEN NECESSARY.

6. OPEN RAMP G. REMOVE/RESTORE THE EXISTING RAMP G PER THE GRADING PLAN.

PHASE 3A--REMOVE T.R. 138 CROSSOVER (NORTH)

1. REMOVE PAVEMENT BETWEEN WESTBOUND C.R. 20 (WEST STATE STREET) AND WESTBOUND U.S. 20.

PHASE 3B--REMOVE T.R. 138 CROSSOVER (SOUTH)

1. REMOVE THE EXISTING PAVEMENT.
2. RESURFACE T.R. 138, MODIFY SIGNING AND PAVEMENT MARKINGS TO RIGHT-IN/RIGHT-OUT.

PHASE 4--EASTBOUND AND WESTBOUND C.R. 20 (WEST STATE STREET) FROM U.S. 20 EXIT GORE TO PROJECT END

1. INSTALL OVERHEAD SIGN SUPPORTS ON EASTBOUND U.S. 20 NORTHWEST OF GORE USING A DESIGN SPEED OF 65 MPH AND MT-95.45 (CLOSING SHOULDER OF A MULTI-LANE DIVIDED HIGHWAY). IF PROPOSED OVERHEAD SIGN SUPPORTS ARE NOT AVAILABLE, INSTALL TEMPORARY SIGNS AS DIRECTED IN THESE NOTES.

2. INSTALL LANE DROP SIGNING AND MARKING ON THE SOUTH (RIGHT-HAND) LANE OF EASTBOUND U.S. 20 NORTHWEST OF GORE USING A DESIGN SPEED OF 65 MPH AND MT-99.20 (TRAFFIC CONTROL FOR LINE PAVEMENT MARKING OPERATIONS).

3. CLOSE THE RIGHT LANE OF EASTBOUND U.S. 20 AND CLOSE THE LEFT LANE OF EASTBOUND C.R. 20 (WEST STATE STREET) USING A MAINLINE DESIGN SPEED OF 65 MPH AND MT-98.20 (LANE CLOSURE AT EXIT RAMP USING DRUMS).

4. RESURFACE WESTBOUND C.R. 20.

PHASE 5A--RESURFACE EASTBOUND U.S. 20 (E.B. LANES B AND F) AND EASTBOUND U.S. 6.

1. RESURFACE EASTBOUND U.S. 20 AND EASTBOUND U.S. 6 USING A DESIGN SPEED OF 65 MPH AND MT-95.30 (CLOSING RIGHT OR LEFT LANE OF A MULTI-LANE DIVIDED HIGHWAY WITH DRUMS).
2. STRIPE/SIGN COMPLETED PAVEMENT USING MT-99.20 (TRAFFIC CONTROL FOR LONG LINE PAVEMENT MARKING OPERATIONS).

PHASE 5B--RESURFACE RAMP H.

1. DETOUR TRAFFIC FROM RAMP H. CLOSURE TO BE LIMITED TO 4 CALENDAR DAYS.
2. RESURFACE RAMP H USING A MAINLINE DESIGN SPEED OF 65 MPH AND MT-98.20 (LANE CLOSURE AT EXIT RAMP USING DRUMS).
3. STRIPE/SIGN COMPLETED PAVEMENT USING MT-99.20 (TRAFFIC CONTROL FOR LONG LINE PAVEMENT MARKING OPERATIONS).

PHASE 6--RESURFACE WESTBOUND U.S. 20 (W.B. LANES A AND E), WESTBOUND U.S. 6

1. INSTALL ADVANCE OVERHEAD SIGN SUPPORTS ON WESTBOUND U.S. 6/U.S. 20 EAST OF GORE USING A DESIGN SPEED OF 65 MPH AND MT-95.45 (CLOSING SHOULDER OF A MULTI-LANE DIVIDED HIGHWAY). IF PROPOSED OVERHEAD SIGN SUPPORTS ARE NOT AVAILABLE, INSTALL TEMPORARY SIGNS AS DIRECTED IN THESE NOTES.

2. INSTALL LANE DROP SIGNING AND MARKING ON WESTBOUND U.S. 6/U.S. 20 EAST OF GORE USING MT-99.20 (TRAFFIC CONTROL FOR LONG LINE PAVEMENT MARKING OPERATIONS).

3. CLOSE THE SOUTH (LEFT-HAND) LANE OF WESTBOUND U.S. 20 USING A DESIGN SPEED OF 65 MPH, MT-95.30 (CLOSING RIGHT OR LEFT LANE OF A MULTI-LANE DIVIDED HIGHWAY WITH DRUMS) AND MT-95.30 (SUPPLEMENTAL ADVANCED SIGNS USED WITH LANE CLOSURES FROM THE GORE TO JUST WEST OF THE INTERSECTION WITH T.R. 138).

4. RESURFACE THE SOUTH (LEFT-HAND) HALF OF THE PAVEMENT FROM THE GORE TO JUST WEST OF THE INTERSECTION WITH T.R. 138.

5. CLOSE THE NORTH (RIGHT-HAND) LANE OF WESTBOUND U.S. 20 USING A DESIGN SPEED OF 65 MPH, MT-95.30 (CLOSING RIGHT OR LEFT LANE OF A MULTI-LANE DIVIDED HIGHWAY WITH DRUMS) AND MT-95.30 (SUPPLEMENTAL ADVANCED SIGNS USED WITH LANE CLOSURES) FROM THE GORE TO JUST WEST OF THE INTERSECTION WITH T.R. 138.

DESIGNATED LOCAL DETOUR ROUTE

IN ADDITION TO THE OFFICIAL, SIGNED DETOUR ROUTE, A LOCAL ROUTE HAS BEEN DETERMINED TO BE THE SECONDARY, UNSIGNED DETOUR ROUTE OR "DESIGNATED LOCAL DETOUR ROUTE." THIS ROUTE IS SHOWN ON SHEET NO. 21. DURING THE TIME THAT TRAFFIC IS DETOURED, THE CONTRACTOR SHALL MAINTAIN THIS ROUTE IN A CONDITION WHICH IS REASONABLY SMOOTH AND FREE FROM HOLES, RUTS, RIDGES, BUMPS, DUST AND STANDING WATER. ONCE THE DETOUR IS REMOVED AND TRAFFIC RETURNED TO ITS NORMAL PATTERN, THE DESIGNATED LOCAL DETOUR ROUTE SHALL BE RESTORED TO A CONDITION THAT IS EQUIVALENT TO THAT WHICH EXISTED PRIOR TO ITS USE FOR THIS PURPOSE. ALL SUCH WORK SHALL BE PERFORMED WHEN AND AS DETERMINED BY THE ENGINEER.

THE REPLACEMENT PAVEMENT FOR ITEM 253, PAVEMENT REPAIR SHALL CONSIST OF 1.25" ITEM 441, ASPHALT CONCRETE SURFACE COURSE, TYPE 1, PG64-22, ITEM 407, TACK COAT PLACED ON 5" OF ITEM 301, ASPHALT CONCRETE BASE, PG64-22.

THE FOLLOWING ESTIMATED QUANTITIES ARE PROVIDED FOR USE AS DETERMINED BY THE ENGINEER TO MAINTAIN AND SUBSEQUENTLY RESTORE THE DESIGNATED LOCAL DETOUR ROUTE.

ITEM 253, PAVEMENT REPAIR	20 CU. YD.
ITEM 441, ASPHALT CONCRETE SURFACE COURSE, TYPE 1, PG 64-22	20 CU. YD.
ITEM 407, TACK COAT	20 GAL.
ITEM 617, COMPACTED AGGREGATE	50 CU. YD.
ITEM 642, CENTER LINE	1.0 MILE

OVERHEAD SIGN WORK SCHEDULING

THIS NOTE HAS BEEN REMOVED.

COMPLETION DATE:

ALL WORK SHALL BE COMPLETED BY THE INTERIM COMPLETION DATE OF 9/1/2022 WITH THE EXCEPTION OF ANY OVERHEAD SIGN SUPPORTS THAT CANNOT BE COMPLETED DUE TO LONG LEAD TIMES. THESE OVERHEAD SIGN SUPPORTS SHALL BE INSTALLED AND COMPLETED BY 3/31/2023. SHOULD THE CONTRACTOR FAIL TO MEET THE INTERIM COMPLETION DATE OF 9/1/2022, DAMAGES SHALL BE ASSESSED IN THE AMOUNT OF \$2500 PER CALENDAR DAY. FAILURE TO MEET THE CONTRACT COMPLETION DATE OF 3/31/2023 WILL LEAD TO ASSESSMENT OF DAMAGES PER CMS TABLE 108.07-1.

ITEM 614-MAINTAINING TRAFFIC, MISC., 6"x8" SOLID WOOD POST, AS PER PLAN

THIS ITEM SHALL CONSIST OF INSTALLING AND REMOVING GROUND MOUNTED 6"x8" SOLID WOOD POSTS. FIGURE 298-26 OF THE TRAFFIC ENGINEERING MANUAL (P. 2-219) SHOULD BE USED AS A GUIDE FOR INSTALLATION OF THE 6"x8" POSTS.

GRADE 2 SOUTHERN YELLOW PINE SHALL BE USED AND SHALL BE PRESSURE TREATED WITH CCA PRESERVATIVE.

PAYMENT WILL BE MADE PER UNIT PRICE BID PER EACH ITEM 614 MAINTAINING TRAFFIC, MISC.: 6" X 8" SOLID WOOD POST, AS PER PLAN.

T1 ONE POST, MEDIAN	1
T2 ONE POST, RIGHT SIDE	1
T3 ONE POST, MEDIAN	1
T4 ONE POST, RIGHT SIDE	1
T5 ONE POST, MEDIAN	1
T6 ONE POST, RIGHT SIDE	1
T7 ONE POST, RIGHT SIDE	1
T8 ONE POST, NORTH SIDE	1
T9 ONE POST, SOUTH SIDE	1
T10 ONE POST, NORTH SIDE	1
T11 ONE POST, MEDIAN	1
T12 ONE POST, NORTH SIDE	1
T13 ONE POST, MEDIAN	1
	13

THE FOLLOWING QUANTITIES ARE FORWARDED TO THE GENERAL SUMMARY FOR TEMPORARY SIGNS T1 THROUGH T13:

ITEM 614 MAINTAINING TRAFFIC, MISC., 6"x8" SOLID WOOD POST, AS PER PLAN 13 EACH

ITEM 614-MAINTAINING TRAFFIC, MISC., SIGN (FLAT SHEET, 4'X8', PLYWOOD), AS PER PLAN

THIS ITEM CONSISTS OF INSTALLING AND REMOVING A FLAT SHEET SIGN USING A 4'X8' SHEET OF PLYWOOD. THE PLYWOOD SHALL BE A MINIMUM OF 3/4" THICK AND OF A MATERIAL APPROPRIATE FOR OUTDOOR USE, SUCH AS MARINE DENSITY OVERLAY, SIGNBOARD, OVERLAID PLYWOOD, OR HIGH DENSITY OVERLAY PLYWOOD. ATTACHMENT AND MOUNTING MATERIALS SHALL BE IN CONFORMANCE WITH NCHRP REPORT 350. SEE SHEETS 27A-27D FOR LOCATION AND DESIGN OF THE TEMPORARY SIGNAGE. THIS SIGNAGE IS TO BE REMOVED ONCE THE PERMANENT SIGNS HAVE BEEN PLACED ON THE OVERHEAD SIGN SUPPORTS.

PAYMENT WILL BE MADE PER UNIT PRICE BID PER SQUARE FOOT OF ITEM 614 MAINTAINING TRAFFIC, MISC.: SIGN (FLAT SHEET, 4' X 8', PLYWOOD), AS PER PLAN.

THE FOLLOWING QUANTITIES ARE FORWARDED TO THE GENERAL SUMMARY FOR TEMPORARY SIGNS T1 THROUGH T13:

ITEM 614-MAINTAINING TRAFFIC, MISC., SIGN (FLAT SHEET, 4'X8', PLYWOOD), AS PER PLAN 416 SF



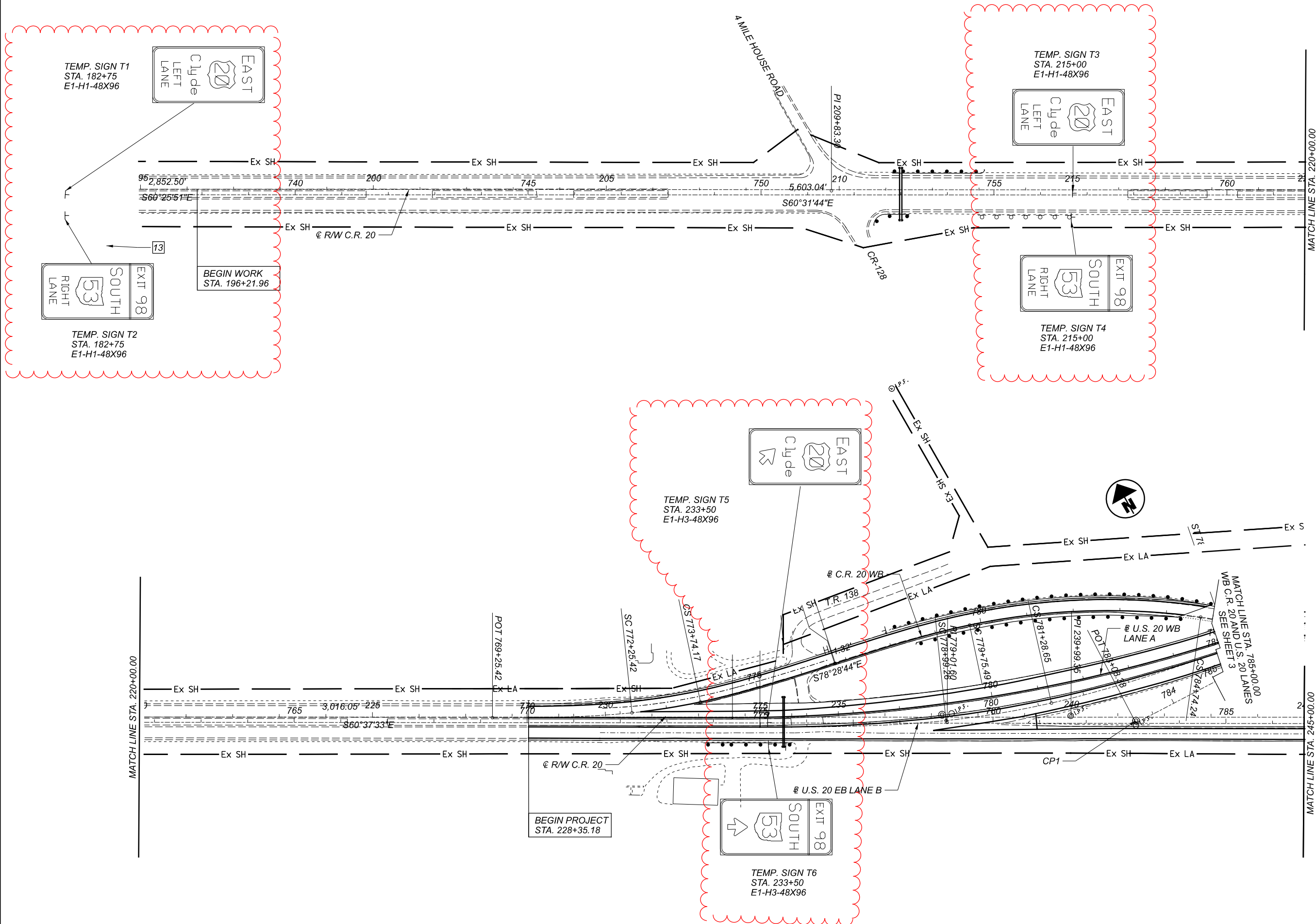

TEMP. SIGN T1
STA. 182+75
E1-H1-48X96



BEGIN WORK
STA. 196+21.96



TEMP. SIGN T2
STA. 182+75
E1-H1-48X96

TEMP. SIGN T3
STA. 215+00
E1-H1-48X96

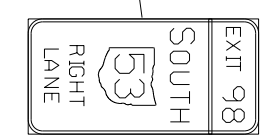

TEMP. SIGN T4
STA. 215+00
E1-H1-48X96

TEMP. SIGN T5
STA. 233+50
E1-H3-48X96

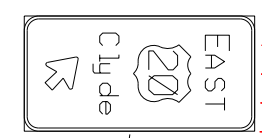

BEGIN PROJECT
STA. 228+35.18

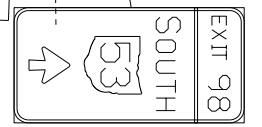

TEMP. SIGN T6
STA. 233+50
E1-H3-48X96

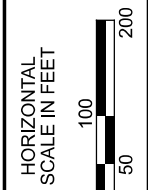

MAINTENANCE OF TRAFFIC TEMPORARY SIGNING PLAN

DESIGN AGENCY



DESIGNER
ODOT D2

REVIEWER
D2 03/30/22

PROJECT ID
111020

SHEET TOTAL
27A 157

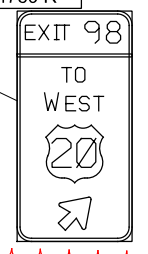
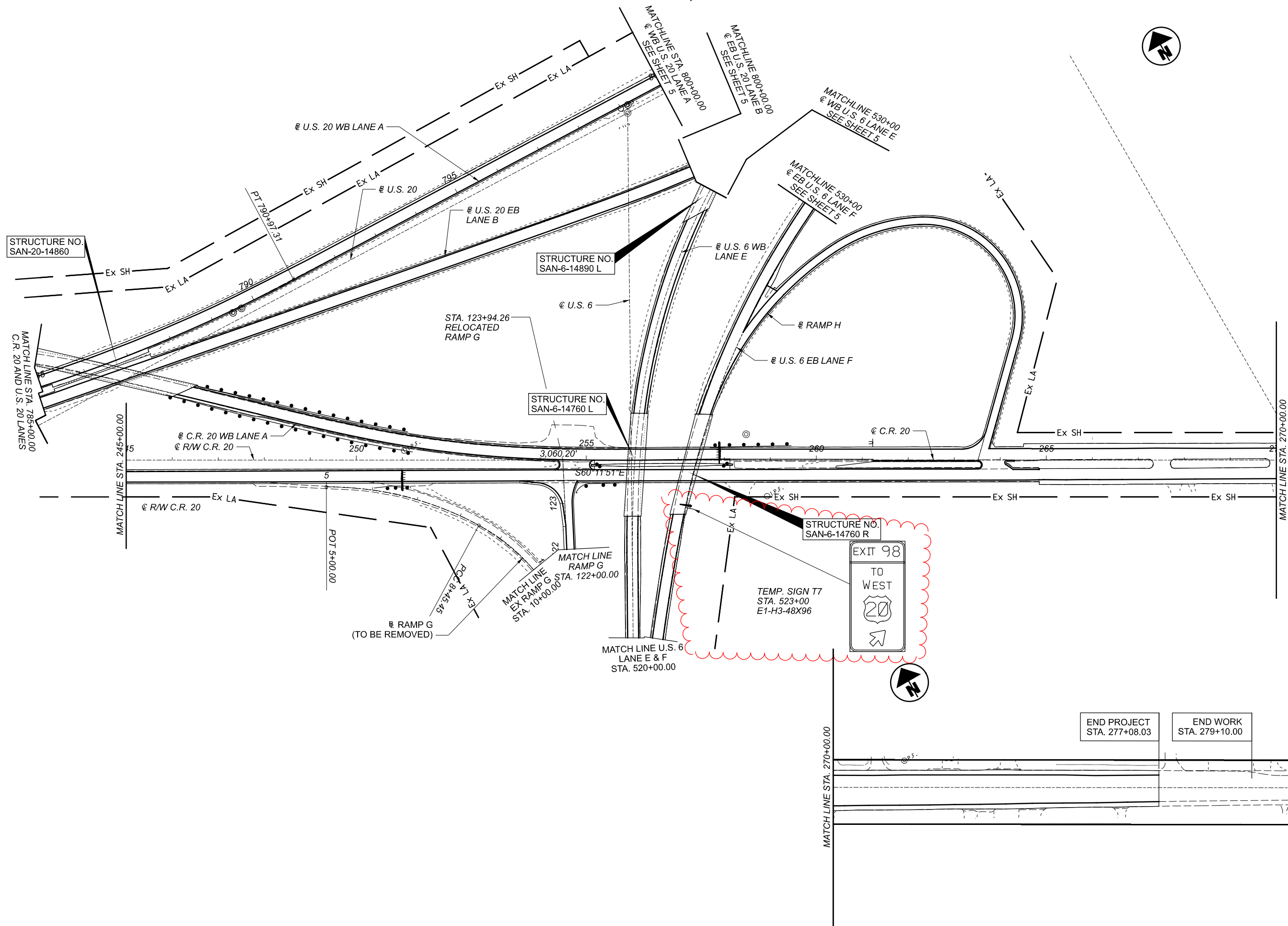

END PROJECT STA. 277+08.03
END WORK STA. 279+10.00

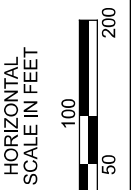

MAINTENANCE OF TRAFFIC TEMPORARY SIGNING PLAN

DESIGN AGENCY



DESIGNER	ODOT D2
REVIEWER	D2 03/30/22
PROJECT ID	111020
SHEET TOTAL	27B 157

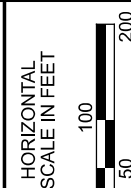
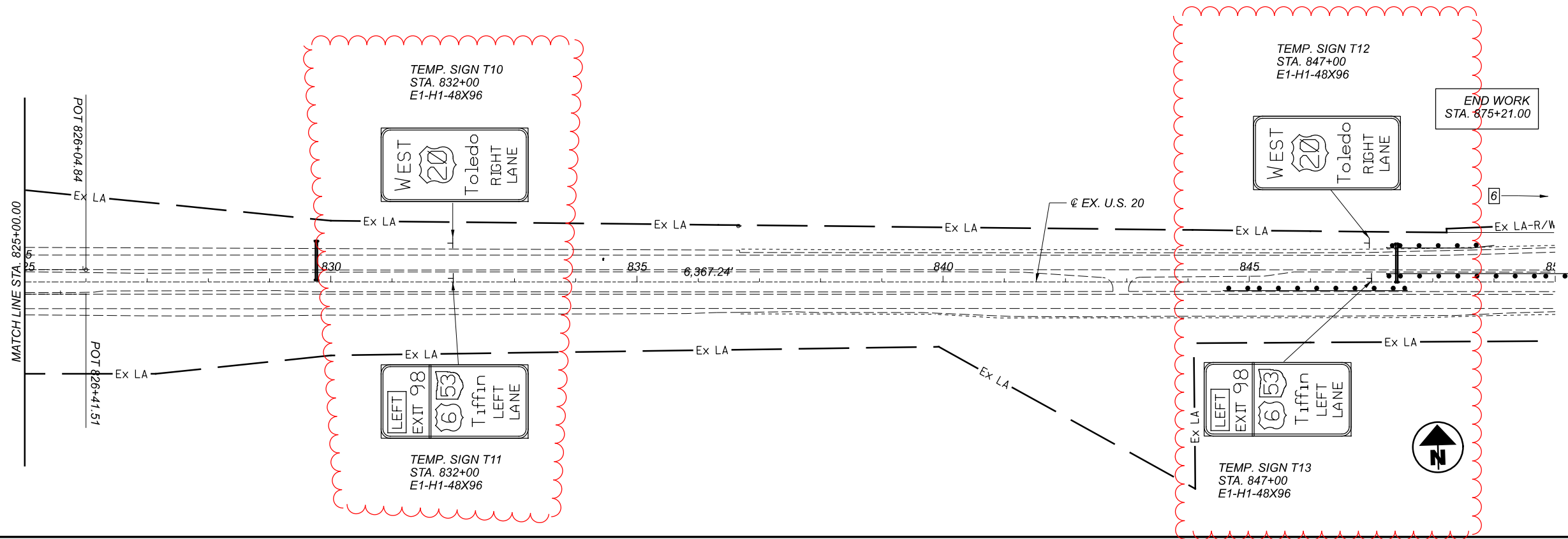
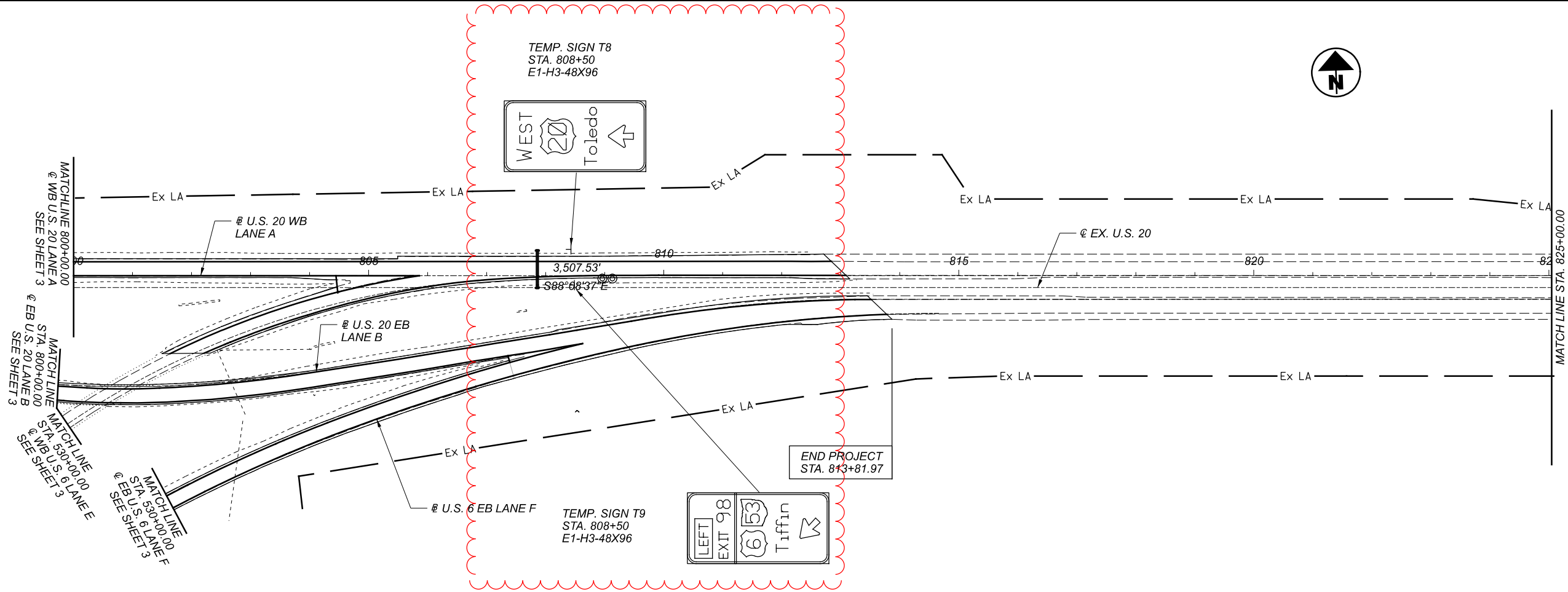

MAINTENANCE OF TRAFFIC TEMPORARY SIGNING PLAN

DESIGN AGENCY



DESIGNER	ODOT D2
REVIEWER	D2 03/30/22
PROJECT ID	111020
SHEET TOTAL	27C 157

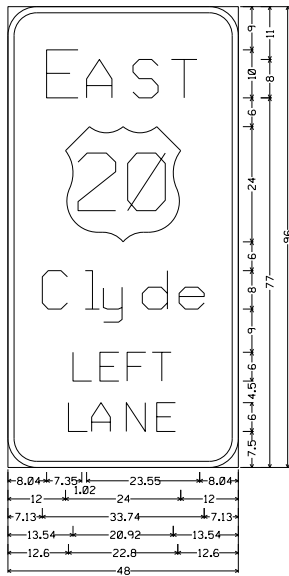

6.00' Radius, 1.25' Border, Black on Orange;
 'E', E; 'AST', E; US 20 MI-4;
 'Clyde', E Mod; 'LEFT', E; 'LANE', E;

T1
182+75
E1-H1-48X96

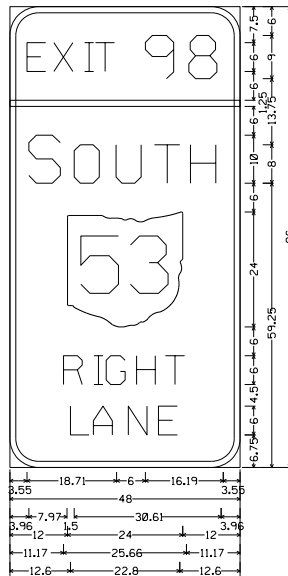

6.00' Radius, 1.25' Border, Black on Orange;
 'EXIT 98', E; 'S', E; 'OUTH', E;
 State Highway 53 MI-H5-24-2; 'RIGHT', E;
 'LANE', E;

T2
182+75
E1-H1-48X96

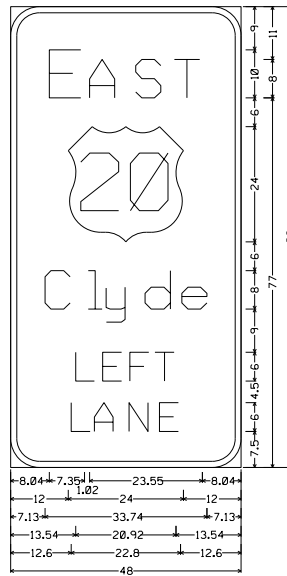

6.00' Radius, 1.25' Border, Black on Orange;
 'E', E; 'AST', E; US 20 MI-4;
 'Clyde', E Mod; 'LEFT', E; 'LANE', E;

T3
215+00
E1-H1-48X96

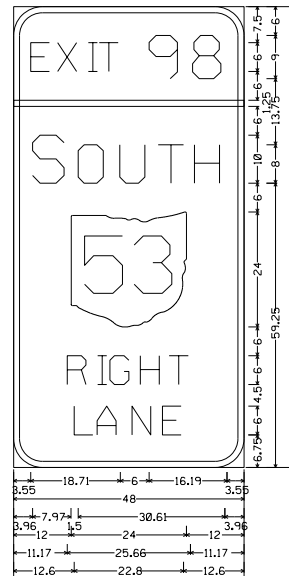

6.00' Radius, 1.25' Border, Black on Orange;
 'EXIT 98', E; 'S', E; 'OUTH', E;
 State Highway 53 MI-H5-24-2; 'RIGHT', E;
 'LANE', E;

T4
215+00
E1-H1-48X96

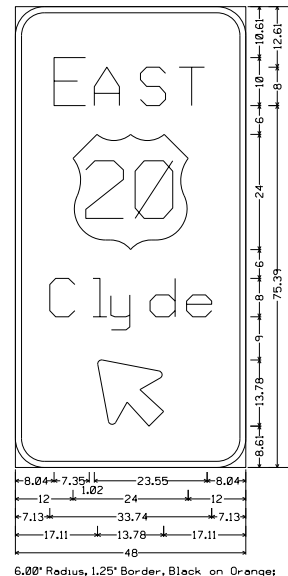

6.00' Radius, 1.25' Border, Black on Orange;
 'E', E; 'AST', E; US 20 MI-4;
 'Clyde', E Mod; Arrow B-4 - 17.00' 135% α ;

T5
233+50
E1-H3-48X96

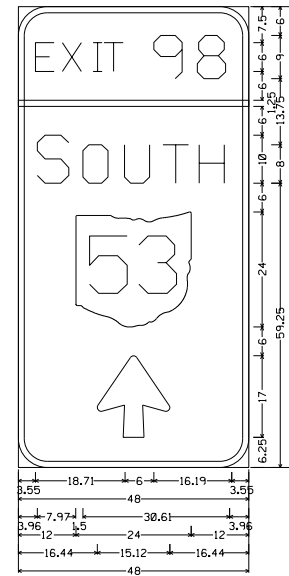

6.00' Radius, 1.25' Border, Black on Orange;
 'EXIT 98', E; 'S', E; 'OUTH', E;
 State Highway 53 MI-H5-24-2;
 Arrow B-4 - 17.00' 90% α ;

T6
233+50
E1-H3-48X96

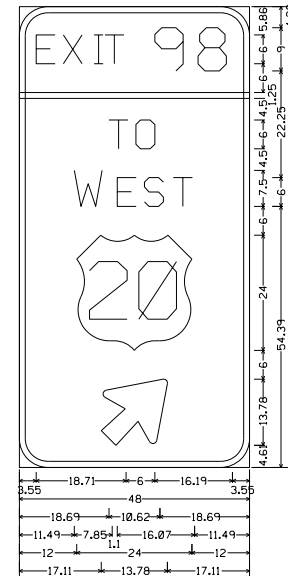

6.00' Radius, 1.25' Border, Black on Orange;
 'EXIT 98', E; 'TO', E; 'W', E; 'EST', E;
 US 20 MI-4; Arrow B-4 - 17.00' 45% α ;

T7
523+00
E1-H3-48X96

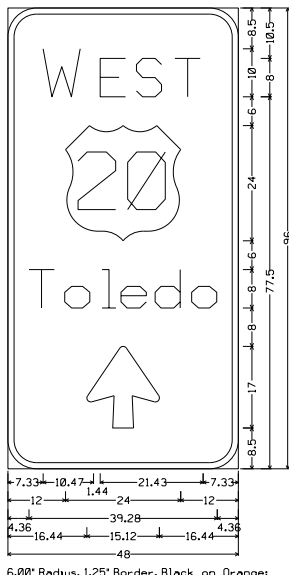

6.00' Radius, 1.25' Border, Black on Orange;
 'W', E; 'EST', E; US 20 MI-4;
 'Toledo', E Mod; Arrow B-4 - 17.00' 90% α ;

T8
808+50
E1-H3-48X96

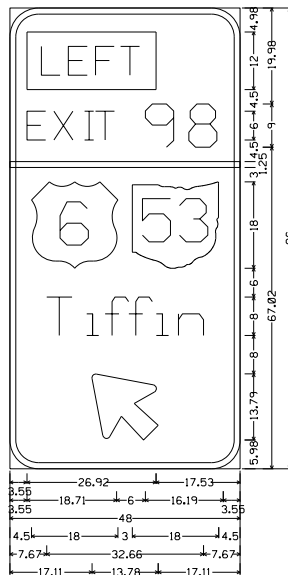

6.00' Radius, 1.25' Border, Black on Orange;
 Exit Plaque LEFT 6' Text: 'EXIT 98', E;
 US 6 MI-4; State Highway 53 MI-H5-18-2;
 'Tiffin', E Mod; Arrow B-4 - 17.00' 135% α ;

T9
808+50
E1-H3-48X96

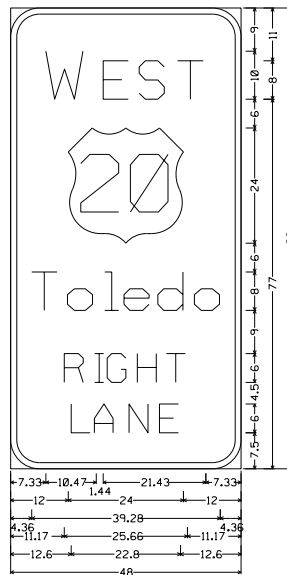

6.00' Radius, 1.25' Border, Black on Orange;
 'W', E; 'EST', E; US 20 MI-4;
 'Toledo', E Mod; 'RIGHT', E; 'LANE', E;

T10
832+00
E1-H1-48X96

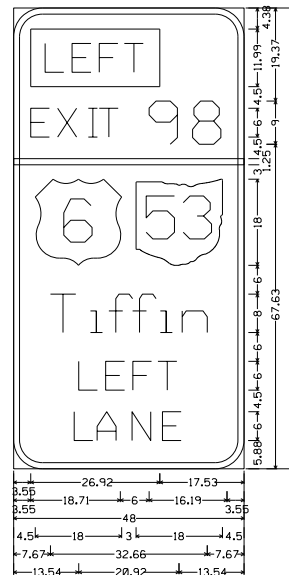

6.00' Radius, 1.25' Border, Black on Orange;
 Exit Plaque LEFT 6' Text: 'EXIT 98', E;
 US 6 MI-4; State Highway 53 MI-H5-18-2;
 'Tiffin', E Mod; 'LEFT', E; 'LANE', E;

T11
832+00
E1-H1-48X96

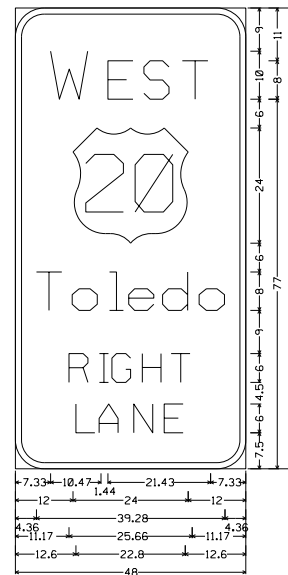

6.00' Radius, 1.25' Border, Black on Orange;
 'W', E; 'EST', E; US 20 MI-4;
 'Toledo', E Mod; 'RIGHT', E; 'LANE', E;

T12
847+00
E1-H1-48X96

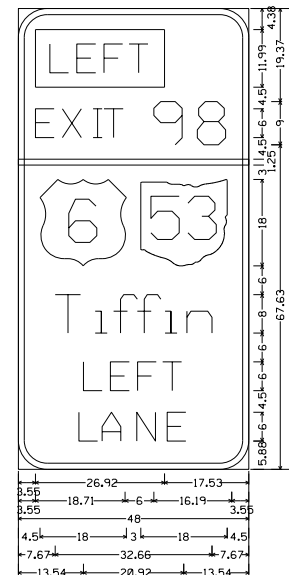

6.00' Radius, 1.25' Border, Black on Orange;
 Exit Plaque LEFT 6' Text: 'EXIT 98', E;
 US 6 MI-4; State Highway 53 MI-H5-18-2;
 'Tiffin', E Mod; 'LEFT', E; 'LANE', E;

T13
847+00
E1-H1-48X96



SHEET NUM.												PART.	ITEM	ITEM	GRAND	UNIT	DESCRIPTION	SEE SHEET NO.
15	15A	16	32		96	97	98		104	105		01/SAF/PV	EXT	TOTAL				
TRAFFIC CONTROL CONT.																		
					6	3	1					10	642	00104	10	MILE	EDGE LINE, 6", TYPE 1	
					1		1					2	642	00204	2	MILE	LANE LINE, 6", TYPE 1	
		1			1		1					3	642	00300	3	MILE	CENTER LINE, TYPE 1	
					7,529	1,660						9,189	642	00414	9,189	FT	CHANNELIZING LINE, 12", TYPE 1A	
					3,915		202					4,117	642	30000	4,117	FT	REMOVAL OF PAVEMENT MARKING	
					253	120	156					529	646	10310	529	FT	CHANNELIZING LINE, 12"	
							18					18	646	10400	18	FT	STOP LINE	
					4,343	1,836	218					6,397	646	10600	6,397	FT	TRANSVERSE/DIAGONAL LINE	
					718	402						1,120	646	10620	1,120	FT	CHEVRON MARKING	
					3	8	8					19	646	20300	19	EACH	LANE ARROW	
						2						2	646	20320	2	EACH	WRONG WAY ARROW	
							3					3	646	20350	3	EACH	LANE REDUCTION ARROW	
					4,779	983	1,426					7,188	646	20510	7,188	FT	DOTTED LINE, 12"	
									543	102		645	621	00101	645	EACH	RPM, AS PER PLAN	
									501	87		588	621	54000	588	EACH	RAISED PAVEMENT MARKER REMOVED	
												82	626	00116	82	EACH	BARRIER REFLECTOR, TYPE 5 (BI-DIRECTIONAL)	
			82									27	626	00116	27	EACH	BARRIER REFLECTOR, TYPE 5 (ONE-WAY)	
			27															
MAINTENANCE OF TRAFFIC																		
100												100	614	11110	100	HOUR	LAW ENFORCEMENT OFFICER WITH PATROL CAR FOR ASSISTANCE	
2												2	614	12380	2	EACH	WORK ZONE IMPACT ATTENUATOR, 24" WIDE HAZARDS, (UNIDIRECTIONAL)	
	30											30	614	13310	30	EACH	BARRIER REFLECTOR, TYPE 1 (1 WAY)	
	30											30	614	13350	30	EACH	OBJECT MARKER, ONE WAY	
												13	614	18000	13	EACH	MAINTAINING TRAFFIC, MISC.:6"x8" SOLID WOOD POST, AS PER PLAN	
			13									416	614	18010	416	SF	MAINTAINING TRAFFIC, MISC.:SIGN (FLAT SHEET, 4'X8", PLYWOOD), AS PER PLAN	
			416									30	614	18601	30	SNMT	PORTABLE CHANGEABLE MESSAGE SIGN, AS PER PLAN	
	30																	
												6	614	20110	6	MILE	WORK ZONE LANE LINE, CLASS I, 6", 642 PAINT	
												9	614	21000	9	MILE	WORK ZONE CENTER LINE, CLASS I	
												31	614	22010	31	MILE	WORK ZONE EDGE LINE, CLASS I, 6"	
29,000												29,000	614	23210	29,000	FT	WORK ZONE CHANNELIZING LINE, CLASS I, 12", 642 PAINT	
57												57	614	30000	57	EACH	WORK ZONE ARROW, CLASS I	
690												690	615	20000	690	SY	PAVEMENT FOR MAINTAINING TRAFFIC, CLASS A	
INCIDENTALS																		
												LS	108	30000	LS		CPM PROGRESS SCHEDULE SHORT DURATION PROJECTS	
												LS	614	11000	LS		MAINTAINING TRAFFIC	
												LS	614	12420	LS		DETOUR SIGNING	
												LS	623	10000	LS		CONSTRUCTION LAYOUT STAKES AND SURVEYING	
												LS	624	10000	LS		MOBILIZATION	

GENERAL SUMMARY

DESIGN AGENCY



DESIGNER

BMG

REVIEWER

JRE 07/20/21

PROJECT ID

111020

SHEET

TOTAL

30 | 157