

STATE OF OHIO DEPARTMENT OF TRANSPORTATION

SCI SHAWNEE SF LODGE

NILE TOWNSHIP
SCIOTO COUNTY

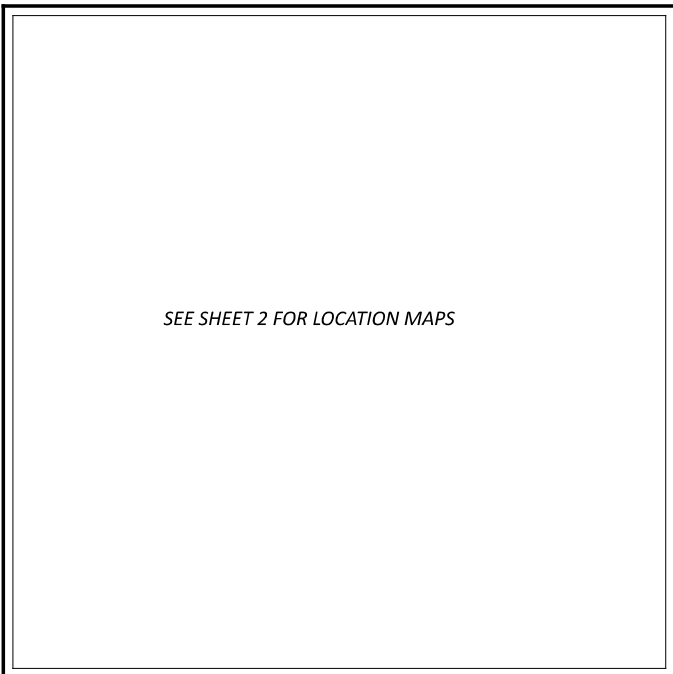

LOCATION MAP

LATITUDE: 38°44'26" LONGITUDE: 83°12'17"



PORTION TO BE IMPROVED	---
INTERSTATE HIGHWAY	====
FEDERAL ROUTES	====
STATE ROUTES	====
COUNTY & TOWNSHIP ROADS	====
OTHER ROADS	-----

DESIGN DESIGNATION

CURRENT ADT (2023)	N/A
DESIGN HOURLY VOLUME (2023)	N/A
DIRECTIONAL DISTRIBUTION	N/A
TRUCKS (24 HOUR B&C)	N/A
DESIGN SPEED	N/A
LEGAL SPEED	N/A
DESIGN FUNCTIONAL CLASSIFICATION:	
NONE (ODNR PROJECT)	
NHS PROJECT	NO

DESIGN EXCEPTIONS

NONE (ODNR PROJECT)

ADA DESIGN WAIVERS

NONE

UNDERGROUND UTILITIES
Contact Two Working Days
Before You Dig

OHIO811.org
Before You Dig

OHIO811, 8-1-1, or 1-800-362-2764
(Non members must be called directly)



PLAN PREPARED BY:
**Ohio Department
of Transportation**
District Nine

ENGINEER'S SEAL

DAVID M. BEEKMAN
E-69687
REGISTERED PROFESSIONAL ENGINEER

INDEX OF SHEETS:

TITLE SHEET	1
LOCATION MAP	2
TYPICAL SECTIONS	3
GENERAL NOTES	4
MAINTENANCE OF TRAFFIC	5
GENERAL SUMMARY	6
PAVEMENT CALCULATIONS	7
PAVEMENT MARKINGS	8
SITE MAPS	9-10

STANDARD CONSTRUCTION DRAWINGS							SUPPLEMENTAL SPECIFICATIONS		SPECIAL PROVISIONS	
BP-2.1	1/21/22	MT-97.10	4/19/19	TC-41.20	10/18/13		800	10/20/23		
BP-3.1	1/21/22	MT-97.12	1/20/17	TC-41.50	10/18/13		832	7/21/23		
		MT-101.60	4/26/23	TC-42.20	10/18/13					
		MT-105.10	1/17/20	TC-52.10	10/18/13					
RM-6.1	7/18/14									

FEDERAL PROJECT NUMBER

NON FEDERAL

RAILROAD INVOLVEMENT

NONE

PROJECT DESCRIPTION

THE RESURFACING OF SHAWNEE STATE PARK LODGE
PARKING LOT AND SHAWNEE STATE PARK CAMPGROUND.
TREATMENT SHALL BE 1.5" MILL & FILL WITH
PAVEMENT REPAIRS.

EARTH DISTURBED AREAS

PROJECT EARTH DISTURBED AREA:	N/A (MAINTENANCE PROJECT)
ESTIMATED CONTRACTOR EARTH DISTURBED AREA:	N/A (MAINTENANCE PROJECT)
NOTICE OF INTENT EARTH DISTURBED AREA:	N/A (MAINTENANCE PROJECT)

2023 SPECIFICATIONS

THE STANDARD SPECIFICATIONS OF THE STATE OF OHIO, DEPARTMENT OF TRANSPORTATION, INCLUDING SUPPLEMENTAL SPECIFICATIONS LISTED IN THE PLANS, CHANGES LISTED IN THE PROPOSAL, AND THE SUPPLEMENTAL SPECIFICATION 800 VERSION INDICATED ON THE PROPOSAL SHALL GOVERN THIS IMPROVEMENT.

I HEREBY APPROVE THESE PLANS AND DECLARE THAT THE MAKING OF THIS IMPROVEMENT WILL NOT REQUIRE THE CLOSING TO TRAFFIC OF THE HIGHWAY AND THAT PROVISIONS FOR THE MAINTENANCE AND SAFETY OF TRAFFIC WILL BE AS SET FORTH ON THE PLANS AND ESTIMATES.

Michael G. Dombrowski
Michael G. Dombrowski
District 09 Deputy Director

Jack Marchbanks
Jack Marchbanks, PhD
Director, Department of Transportation

SCI SHAWNEE STATE PARK

DESIGN AGENCY



DESIGNER

ZDR

REVIEWER

DMB MM-DD-YY

PROJECT ID

111272

SHEET

TOTAL

P.1

10

SCI-SHAWNEE SF LODGE

MODEL: Sheet: PAPER: 34x22 (in.) DATE: 3/19/2024 TIME: 8:50:47 AM USER: zrockwell
p:\ohio\dot-pw-bentley.com\shado-pw-02\Documents\01 Active Projects\District 09\Scioto\111272400-Engineering\Roadway\Sheets\111272_GT001.dgn

UTILITIES

THERE ARE NO EXISTING UNDERGROUND UTILITY FACILITIES SHOWN ON THE PLANS, NOR WILL ANY EXISTING UNDERGROUND UTILITY FACILITIES BE RELOCATED FOR THE PROJECT. THE NATURE OF THE WORK REQUIRED BY THIS PROJECT WILL NOT AFFECT ANY UTILITIES THAT MAY EXIST WITHIN THE WORK AREA. IT IS THE RESPONSIBILITY OF THE CONTRACTOR TO IDENTIFY POTENTIAL UTILITY CONFLICTS, BY VISUAL INSPECTION AND BY CONTACTING THE OHIO UTILITIES PROTECTION SERVICE (OHIO 811) FOR FIELD MARKINGS OF THE UNDERGROUND UTILITIES. THE CONTRACTOR SHALL CONTACT AND COORDINATE WITH THE OWNERS TO RESOLVE ALL UTILITY CONFLICTS PRIOR TO CONSTRUCTION OR, WITH THE APPROVAL OF THE PROJECT ENGINEER, THE CONTRACTOR SHALL ADJUST THE PROJECT CONSTRUCTION ACCORDINGLY, SO AS TO AVOID DAMAGE TO THE EXISTING UTILITY FACILITIES.

THE UTILITY CONTACT INFORMATION FOR THE PROJECT CAN BE OBTAINED THROUGH THE ODOT DISTRICT 9 UTILITY COORDINATOR AT 740-774-9075.

GENERAL

QUANTITIES IN THESE PLANS ARE APPROXIMATE FROM FIELD AND AERIAL CADD MEASUREMENTS, BUT FINAL WORK AND QUANTITIES WILL BE AS DIRECTED BY THE ENGINEER AND/OR ODNR PERSONNEL.

WORK LIMITS

THE WORK LIMITS SHOWN ON THESE PLANS ARE FOR PHYSICAL CONSTRUCTION ONLY. PROVIDE THE INSTALLATION AND OPERATION OF ALL WORK ZONE TRAFFIC CONTROL AND WORK ZONE TRAFFIC CONTROL DEVICES REQUIRED BY THESE PLANS WHETHER INSIDE OR OUTSIDE THESE WORK LIMITS.

WINDOW CONTRACT TABLE

DESCRIPTION OF CRITICAL WORK	CALENDAR DAYS TO COMPLETE
ALL WORK ON PROJECT	90

NOTIFICATION

ERIC EVANOO
 OHIO DEPARTMENT OF NATURAL RESOURCES
 DIVISION OF ENGINEERING
 2045 MORSE RD., BLD E-3
 COLUMBUS, OH 43229
 614-265-6957
 eric.evanoo@dnr.state.oh.us

RYAN BARTLEY
 OHIO DIVISION OF PARKS & WATERCRAFT
 SHAWNEE STATE PARK
 4404 STATE ROUTE 125
 WEST PORTSMOUTH, OH 45663
 740-858-6652
 ryan.bartley@dnr.ohio.gov

ITEM 251 - PARTIAL DEPTH PAVEMENT REPAIR (441), AS PER PLAN

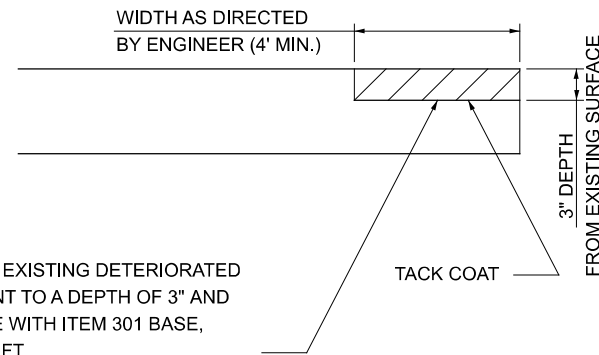

REMOVE EXISTING DETERIORATED PAVEMENT TO A DEPTH OF 3" AND REPLACE WITH ITEM 301 BASE, IN ONE LIFT.

THE FOLLOWING ESTIMATED QUANTITIES HAVE BEEN INCLUDED AND CARRIED TO THE GENERAL SUMMARY FOR USE AS DIRECTED BY THE ENGINEER:

ITEM 251 PARTIAL DEPTH PAVEMENT REPAIR (441),AS PER PLAN	
01/NFA/05 TOTALS:	2892 SY
TOTALS:	2892 SY

PROFILE AND ALIGNMENT

PLACE THE PROPOSED PAVEMENT TO FOLLOW THE ALIGNMENT AND PROFILE OF THE EXISTING PAVEMENT. PLACE THE PROPOSED ASPHALT CONCRETE SURFACE COURSE, TYPE 1, PG64-22 AS SHOWN ON THE TYPICAL SECTIONS.

DISPOSAL OF ASPHALT GRINDINGS

ASPHALT GRINDINGS ARE TO BECOME THE PROPERTY OF THE CONTRACTOR.

ITEM SPECIAL - CONCRETE PARKING BLOCKS

PARKING BLOCKS SHALL BE REMOVED, STORED, AND RESET AS NECESSARY TO PERFORM ALL RESURFACING ACTIVITIES. CARE SHALL BE TAKEN TO NOT DAMAGE OR DESTROY EXISTING PARKING BLOCKS AS BEST PRACTICAL. A QUANTITY HAS BEEN PROVIDED TO REMOVE AND REPLACE THOSE BLOCKS THAT ARE NOT IN CONDITION TO BE RESET.

PARKINGS BLOCKS SHALL BE AS PER ODOT STANDARD DRAWING RM-6.1. PAYMENT FOR ALL PARKING BLOCKS SHALL BE MADE AT THE UNIT PRICE FOR EACH, AND SHALL INCLUDE ALL LABOR, TOOLS, EQUIPMENT, MATERIALS AND INCIDENTALS NECESSARY TO PERFORM THE WORK.

THE FOLLOWING QUANTITIES HAVE BEEN CARRIED TO THE GENERAL SUMMARY TO BE USED AS DIRECTED BY THE ENGINEER.

ITEM SPECIAL - PARKING BLOCK REMOVED	50 EACH
ITEM SPECIAL - PARKING BLOCK REMOVED AND RESET	454 EACH
ITEM SPECIAL - CONCRETE PARKING BLOCK	50 EACH

DESIGN AGENCY



DESIGNER
ZDR

REVIEWER

DMB MM-DD-YY

PROJECT ID

111272

SHEET TOTAL

P.4 | 10

SHEET NUM.				PART.	ITEM	ITEM	GRAND	UNIT	DESCRIPTION	SEE SHEET NO.
4	5	7	8	01/NEA/05	EXT	TOTAL				
ROADWAY										
50						50	EACH	PARKING BLOCK REMOVED		4
454						454	EACH	PARKING BLOCK REMOVED AND RESET		4
50						50	EACH	CONCRETE PARKING BLOCK		4
PAVEMENT										
2,892						2,892	SY	PARTIAL DEPTH PAVEMENT REPAIR (441), AS PER PLAN		4
		51,473				51,473	SY	PAVEMENT PLANING, ASPHALT CONCRETE, 1.5"		
		4,117				4,117	GAL	NON-TRACKING TACK COAT		
		2,145				2,145	CY	ASPHALT CONCRETE SURFACE COURSE, TYPE 1, (449), PG64-22, 1.5"		
TRAFFIC CONTROL										
			1.25			1.25	MILE	EDGE LINE, 6", TYPE 1		
			0.66			0.66	MILE	CENTER LINE, TYPE 1		
			11,591			11,591	FT	PARKING LOT STALL MARKING, TYPE 1		
			22			22	EACH	HANDICAP SYMBOL MARKING, TYPE 1		
			14			14	EACH	LANE ARROW, TYPE 1		
			111			111	FT	STOP LINE, TYPE 1		
			164			164	FT	CHANNELIZING LINE, 12", TYPE 1		
			102			102	FT	TRANSVERSE/DIAGONAL LINE, TYPE 1		
			86			86	EACH	PAVEMENT MARKING, MISC.: CAMP SITE NUMBERS, 1' STENCILS		8
MAINTENANCE OF TRAFFIC										
	5					5	EACH	WORK ZONE MARKING SIGN		
INCIDENTALS										
						100	LS	MAINTAINING TRAFFIC		
						100	LS	CONSTRUCTION LAYOUT STAKES AND SURVEYING		
						100	LS	MOBILIZATION		

GENERAL SUMMARY

DESIGN AGENCY	
DESIGNER	ZDR
REVIEWER	
PROJECT ID	DMB MM-DD-YY
	111272
SHEET	TOTAL
P.6	10

PAVING AT SHAWNEE STATE PARK CAMPGROUND WILL BEGIN AT THE INTERSECTION OF THE CAMPGROUND AND S.R. 125. THE PAVING WILL INCLUDE ALL CAMPGROUND ROADS, PARKING AREAS AND CAMPSITES.

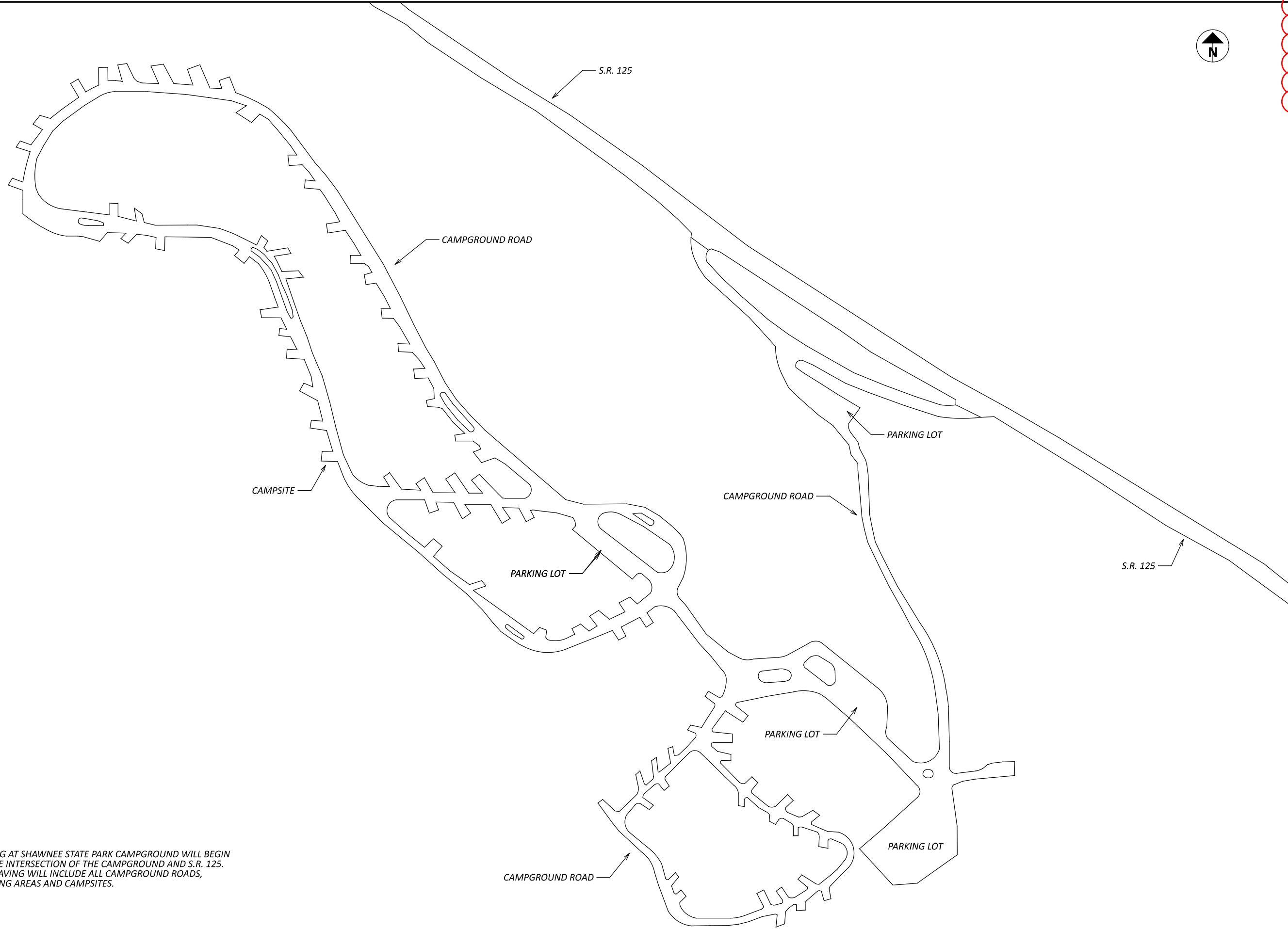

NOT TO SCALE

SITE MAP
SHAWNEE STATE PARK

DESIGN AGENCY



DESIGNER
ZDR

REVIEWER

DMB MM-DD-YY

PROJECT ID
111272

SHEET	TOTAL
P.9	10

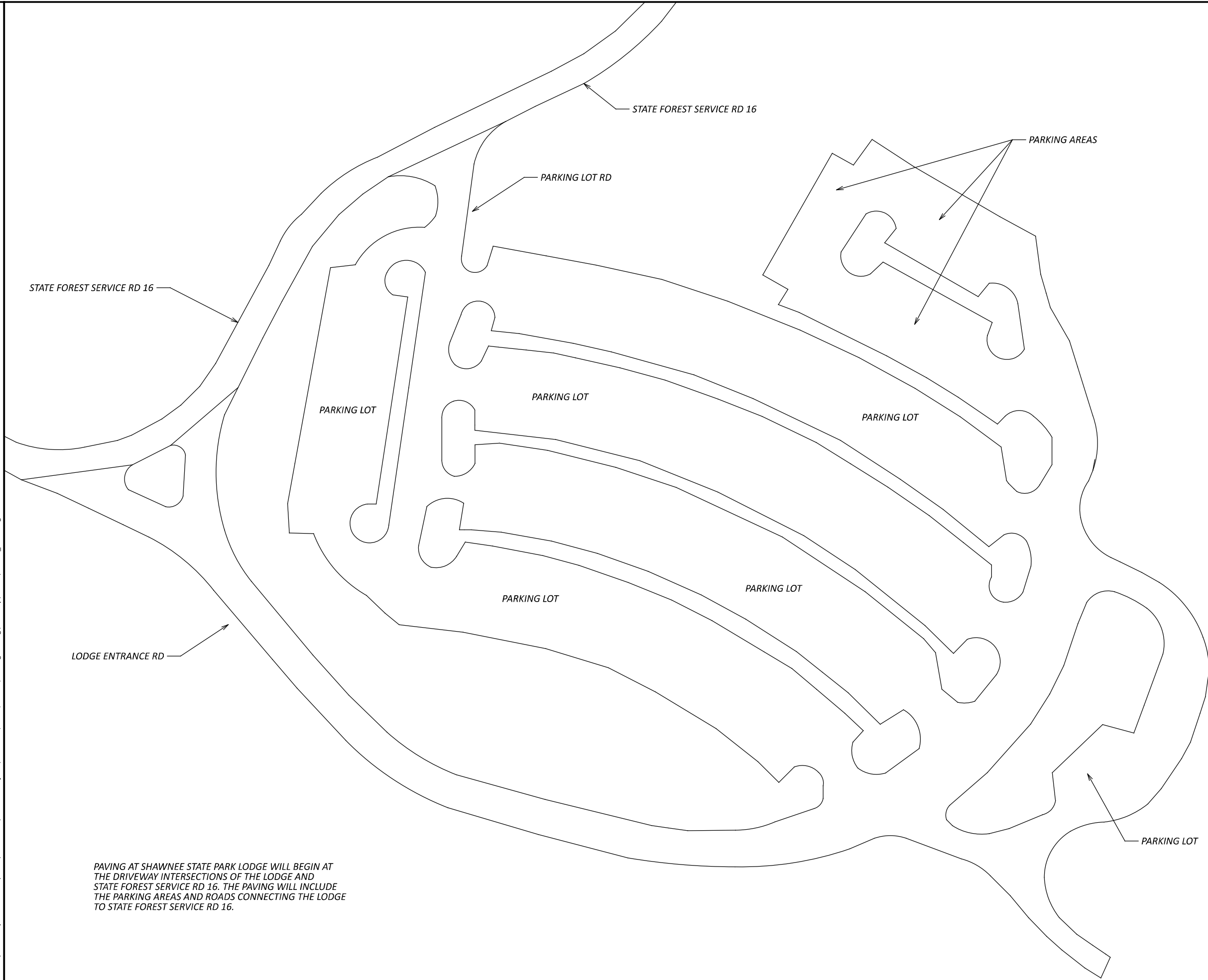

NOT TO SCALE

PAVING AT SHAWNEE STATE PARK LODGE WILL BEGIN AT THE DRIVEWAY INTERSECTIONS OF THE LODGE AND STATE FOREST SERVICE RD 16. THE PAVING WILL INCLUDE THE PARKING AREAS AND ROADS CONNECTING THE LODGE TO STATE FOREST SERVICE RD 16.

SITE MAP
SHAWNEE STATE PARK LODGE PARKING LOT

DESIGN AGENCY



DESIGNER
ZDR

REVIEWER
DMB MM-DD-YY

PROJECT ID
111272

SHEET TOTAL
P.10 10