

U:\Account\OH\DOT\19002...-STA-21-21-30\DESIGN\CT\ProjectData\06135\Design\Structures\STA021-2130\SS001.dgn 1/8/2020 12:12:03 PM JSchar

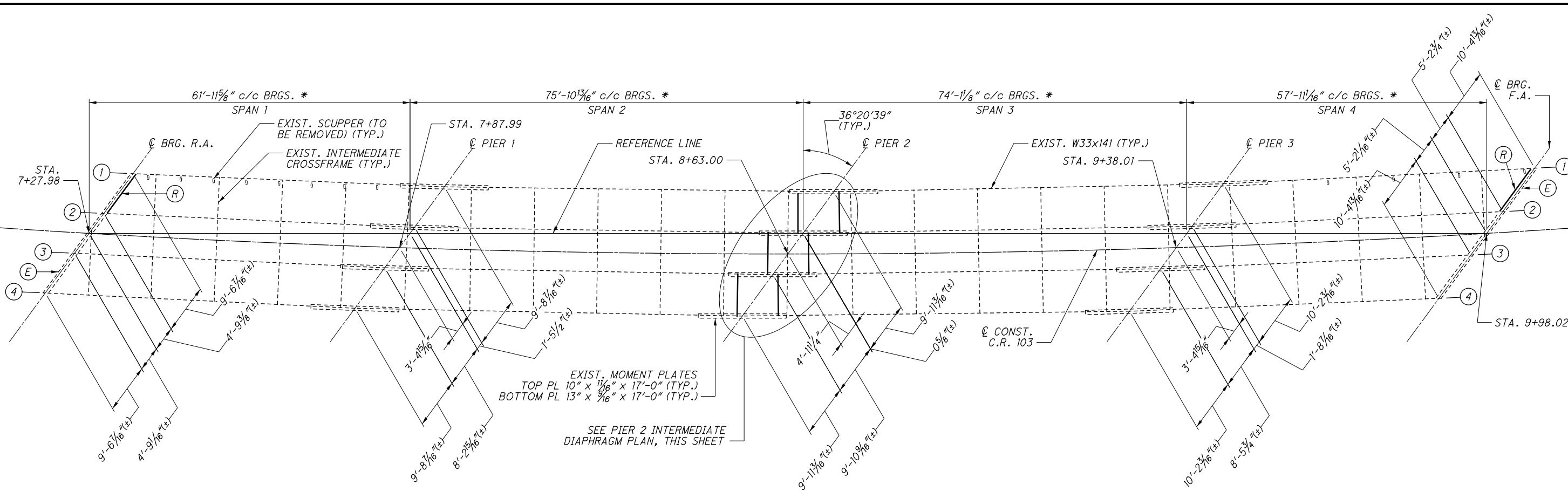

FRAMING PLAN



LEGEND

- ⊕ EXIST. BEAM LINE DESIGNATION
- Ⓔ PROPOSED EXPANSION JOINT ARMOR PER STANDARD DRAWING EXJ-4-87 (TYP. AT BOTH ABUTMENTS)
- Ⓟ PROPOSED INTERMEDIATE CROSSFRAME PER SHEET 2/4 OF ODOT STANDARD DRAWING GSD-1-19, SEE NOTES 1 & 2 (6 LOCATIONS, AS SPECIFICALLY SHOWN)
- Ⓡ REPLACE EXISTING END CROSSFRAME IN ACCORDANCE WITH ITEM 513 - STRUCTURAL STEEL, MISC.: REPLACEMENT OF DAMAGED CROSSFRAMES, SEE NOTE 2 & 7 (2 LOCATIONS, AS SPECIFICALLY SHOWN)
- ⓧ EXISTING INTERMEDIATE CROSSFRAME TO BE REMOVED, SEE NOTE 1 (3 LOCATIONS, AS SPECIFICALLY SHOWN)
- * SPAN LENGTH MEASURED ALONG REFERENCE LINE

NOTES

1. FOR INFORMATIONAL PURPOSES: LOCATIONS OF THE EXISTING INTERMEDIATE CROSSFRAMES TO BE REMOVED AND REPLACED WITH THE PROPOSED INTERMEDIATE CROSSFRAMES AS SHOWN IN THE PLANS ARE REQUIRED TO MEET AASHTO SEISMIC REQUIREMENTS BY CREATING A DIRECT LOAD PATH FROM THE DECK TO THE FIXED BEARINGS.
2. PAINT ALL PROPOSED CROSSFRAMES IN ACCORDANCE WITH ITEM 514.
3. CLEAN AND PAINT AREAS OF EXISTING BEAMS DAMAGED BY CROSSFRAME REMOVAL IN ACCORDANCE WITH ITEM 514 AND AT THE DIRECTION OF THE ENGINEER. CLEANING AND PAINTING WILL BE PAID FOR AS PART OF ITEM 514 - FIELD PAINTING STRUCTURAL STEEL, FINISH COAT, AS PER PLAN.
4. EXISTING BEAM WELDED FIELD SPLICES ARE LOCATED AT PIER BEARING CENTERLINES.
5. ALL EXISTING FRAMING IS TO REMAIN UNLESS OTHERWISE NOTED.
6. THIS SHEET IS INTENDED TO PROVIDE A SCHEMATIC OVERVIEW OF THE EXISTING FRAMING AND SHOW THE LOCATION OF VARIOUS WORK ITEMS. SELECTED DIMENSIONS HAVE BEEN PROVIDED FOR THE CONTRACTORS INFORMATION. (ADDITIONAL DATA, IF REQUIRED, MAY BE OBTAINED FROM THE RECORD PLANS ON FILE WITH ODOT DISTRICT 4.)
7. FOR GENERAL STEEL DETAILS NOT SHOWN, REFER TO ODOT STANDARD DRAWING GSD-1-19.
8. FOR TRANSVERSE SECTION, SEE SHEET 21/32.
9. FOR DECK SLAB PLAN, SEE SHEET 22/32.
10. FOR EXISTING BEAM ELEVATIONS, SEE SHEETS 19/32 AND 20/32.

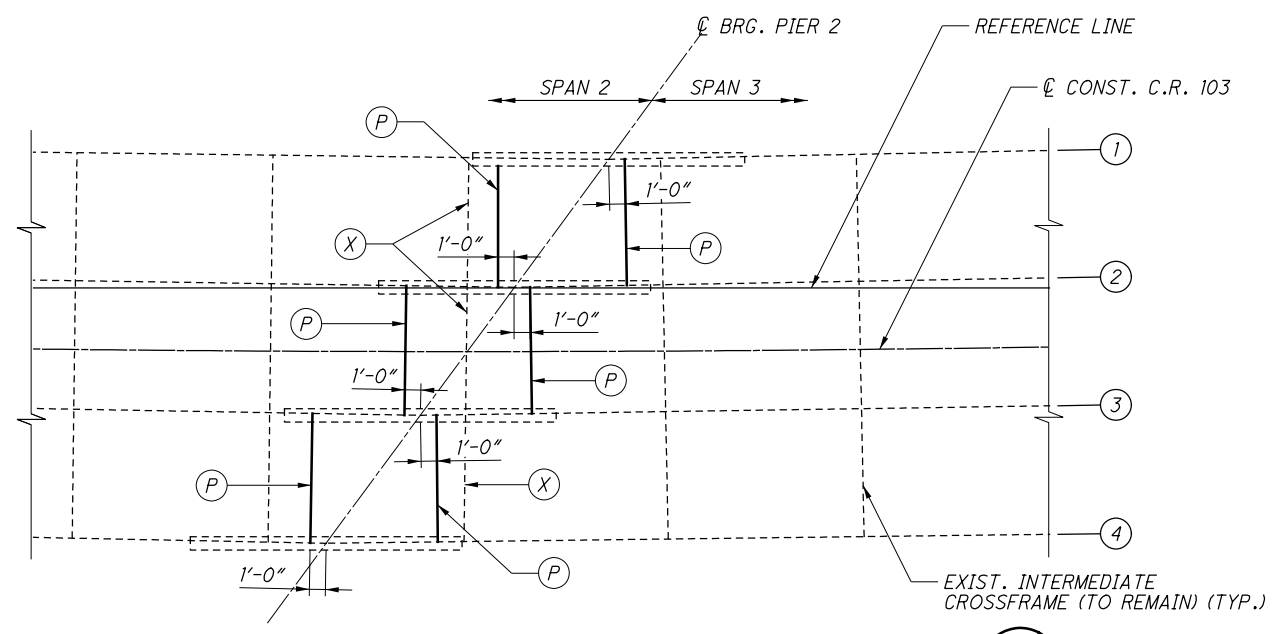

PIER 2 INTERMEDIATE DIAPHRAGM PLAN



DESIGN AGENCY
DATE 11/25/19
REVIEWED DWJ STRUCTURE FILE NUMBER T600666
DRAWN CJK CHECKED ARA
FRAMING PLAN BRIDGE NO. STA-21-2130 C.R. 103 (DEERFIELD AVE. N.W.) OVER S.R. 21
STA-21-21-30 PID No. 106135
18 / 32 <div style="border: 1px solid black; border-radius: 50%; width: 30px; height: 30px; display: flex; align-items: center; justify-content: center; margin: 0 auto;"> 46 60 </div>