

**INSTALL "TO" (M4-5-30), "EAST" (M3-2-30), "US 62" (M1-4-3) WITH ADVANCED RIGHT TURN ARROW (M5-1R-30) ON KIRBY AVE SB, NORTH OF PROGRESS STREET.
 **INSTALL "TO" (M4-5-30), "WEST" (M3-4-30), "US 62" (M1-4-3) WITH ADVANCED RIGHT TURN ARROW (M5-1R-30) ON KIRBY AVE SB, SOUTH OF PROGRESS STREET AND NORTH OF US 62.

PAVEMENT MARKING LEGEND

NOTE: MARKINGS LISTED BELOW MAY NOT BE USED ON THIS PARTICULAR SHEET.

- (A) ODOT ITEM 644 - EDGE LINE, 6", WHITE
- (B) ODOT ITEM 644 - CHANNELIZING LINE, 12", WHITE
- (C) ODOT ITEM 644 - LANE ARROW, WHITE
- (D) ODOT ITEM 644 - CENTER LINE, 4", YELLOW, SOLID, DOUBLE
- (E) ODOT ITEM 644 - TRANSVERSE/DIAGONAL LINE, 24", YELLOW (SPACING PER ODOT T.E.M. 301-14.1)
- (F) ODOT ITEM 644 - LANE LINE, 6", WHITE
- (G) ODOT ITEM 644 - STOP LINE, 24", WHITE
- (H) ODOT ITEM 644 - DOTTED LINE, 6", WHITE
- (I) ODOT ITEM 644 - EDGE LINE, 6", YELLOW
- (J) ODOT ITEM 644 - CHEVRON MARKING, 24", WHITE (SPACING PER TC 72.20)
- (K) ODOT ITEM 644 - DOTTED LINE, 6", YELLOW

DATE	07/20/2022
CHECKED BY	BTP
DRAWN BY	MYP
SCALE:	1"=30'

SIGNING & PAVEMENT MARKING PLAN

PROJECT FOR ROADWAY IMPROVEMENTS

CITY OF CANTON STARK COUNTY

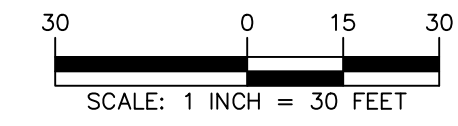
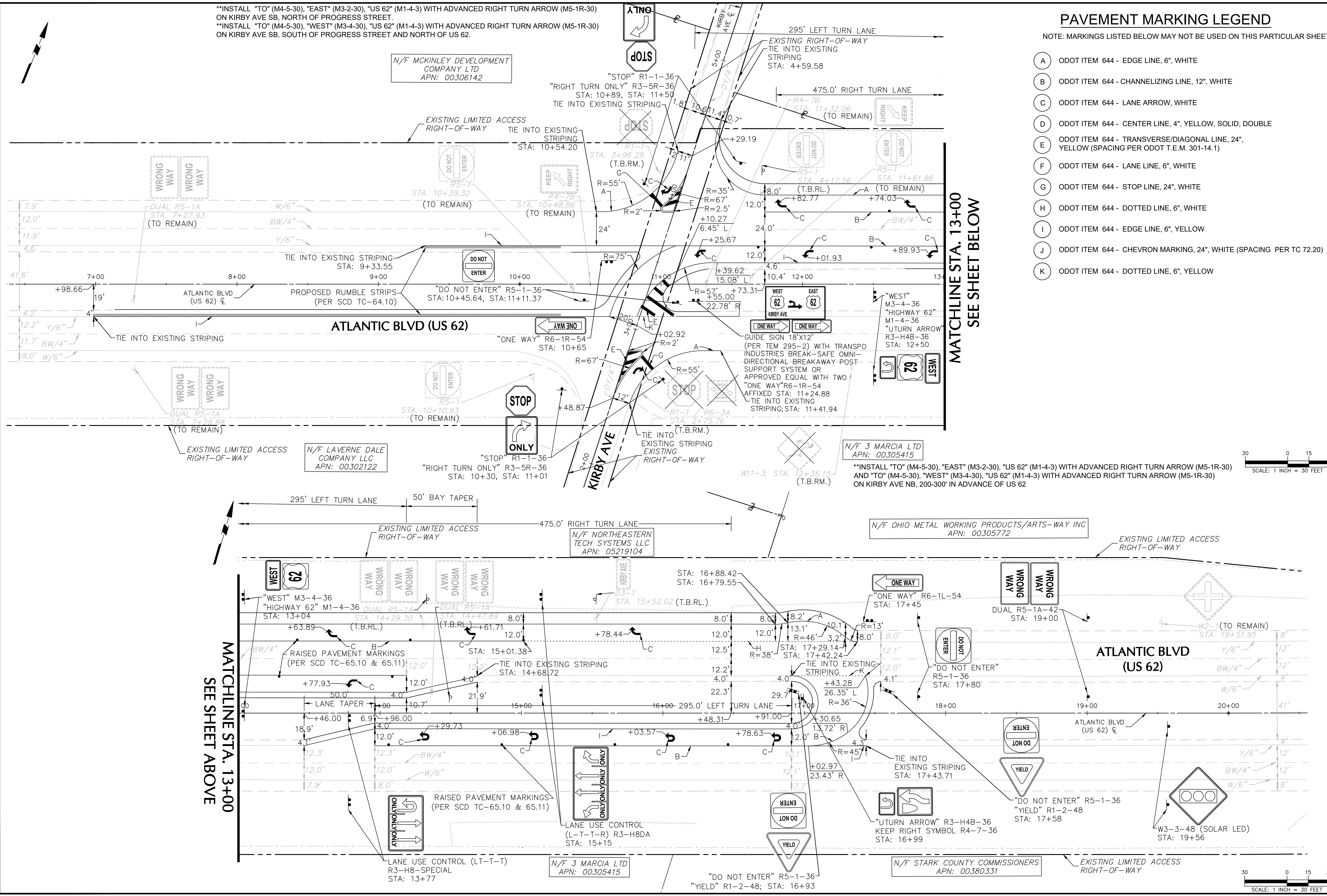

ATLANTIC BLVD (US 62)

MATCHLINE STA. 13+00
SEE SHEET ABOVE

MATCHLINE STA. 13+00
SEE SHEET BELOW