

ODOT Dist 4 - Stark County - FINAL
No Passing Zone Log (STA)

Route: **0172R (SSTASR00172**C)**

From: **16.580 LEAVE CANTON**

Length: **13.664** Direction: **East**

To: **30.244 ENTER COL CO**

| Length | Left | C/L | Right | Length | Control Points | Scale: 1.00 mile/page |
|--------|--------|-----|--------|--------|-----------------------|-----------------------|
| | 26.000 | | 26.000 | 25.987 | C0044 PARIS | |
| | | | | 25.900 | Mile Post = 026 | |
| | | | | 25.592 | C0119 ROBERTSVILLE RT | |
| 1.000 | | | | 25.487 | BRIDGE | |
| | | | | 25.380 | C0119 AUTUMN LT | |
| | 25.000 | | 25.000 | | | |

Sheet total equivalent length of solid line: 2.000

Accum. total: 13.997

ODOT Dist 4 - Stark County - FINAL
No Passing Zone Log (STA)

Route: **0172R (SSTASR00172**C)**

From: **16.580 LEAVE CANTON**

Length: **13.664** Direction: **East**

To: **30.244 ENTER COL CO**

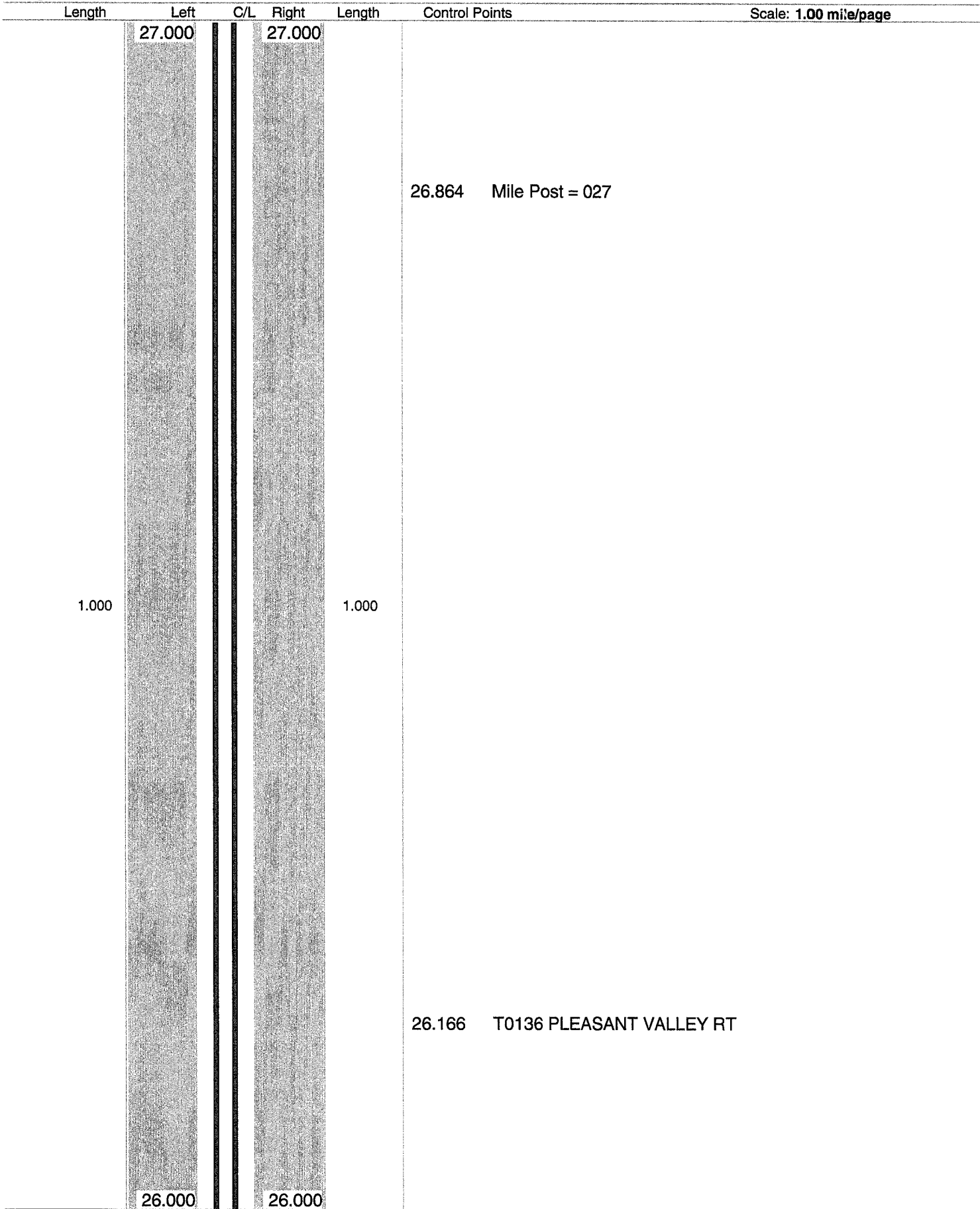

ODOT Dist 4 - Stark County - FINAL
No Passing Zone Log (STA)

Route: **0172R (SSTASR00172**C)**

From: **16.580 LEAVE CANTON**

Length: **13.664** Direction: **East**

To: **30.244 ENTER COL CO**

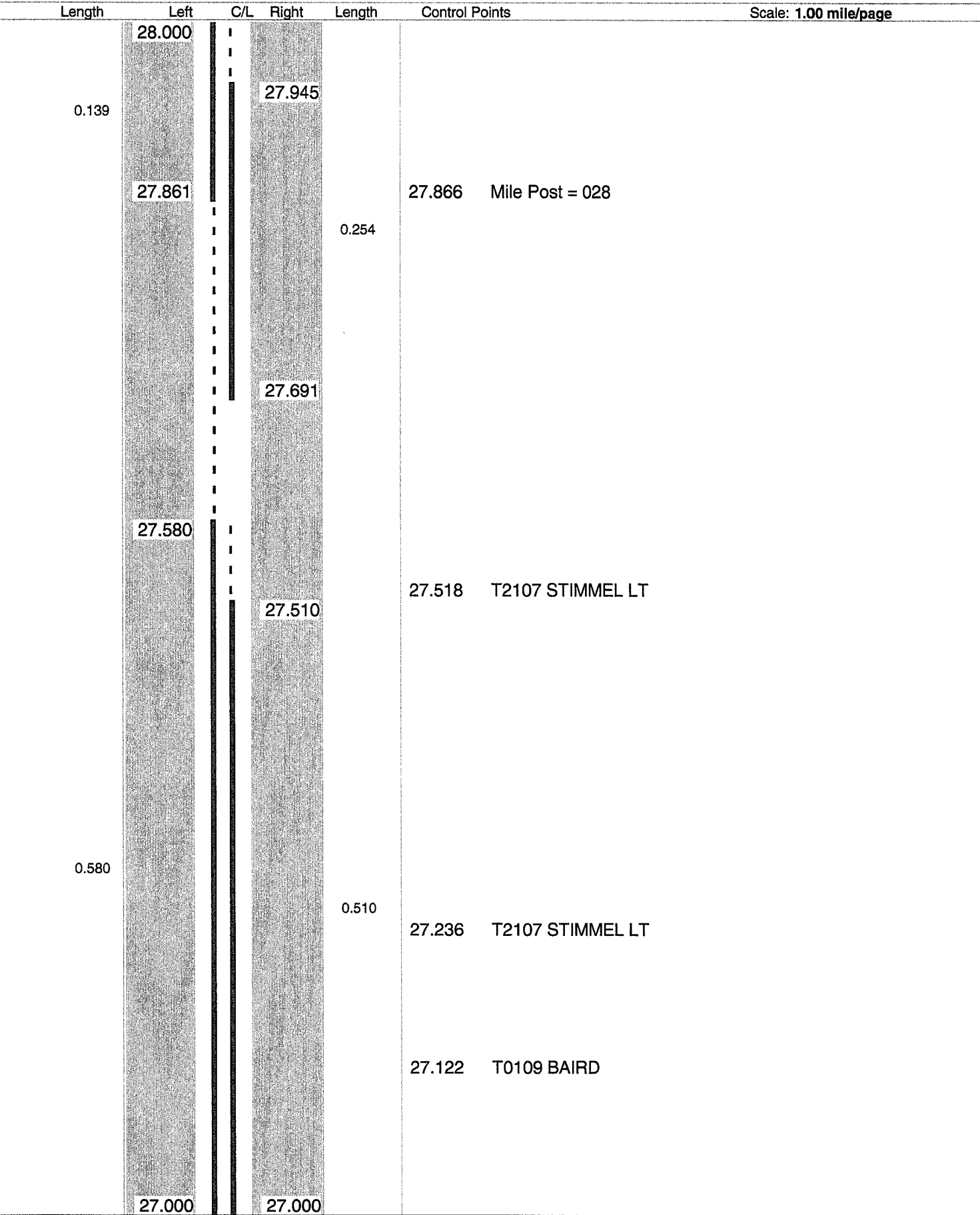

Sheet total equivalent length of solid line: 1.585

Accum. total: 17.582

ODOT Dist 4 - Stark County - FINAL
 No Passing Zone Log (STA)

Route: 0172R (SSTASR00172**C)

From: 16.580 LEAVE CANTON

Length: 13.664

Direction: East

To: 30.244 ENTER COL CO

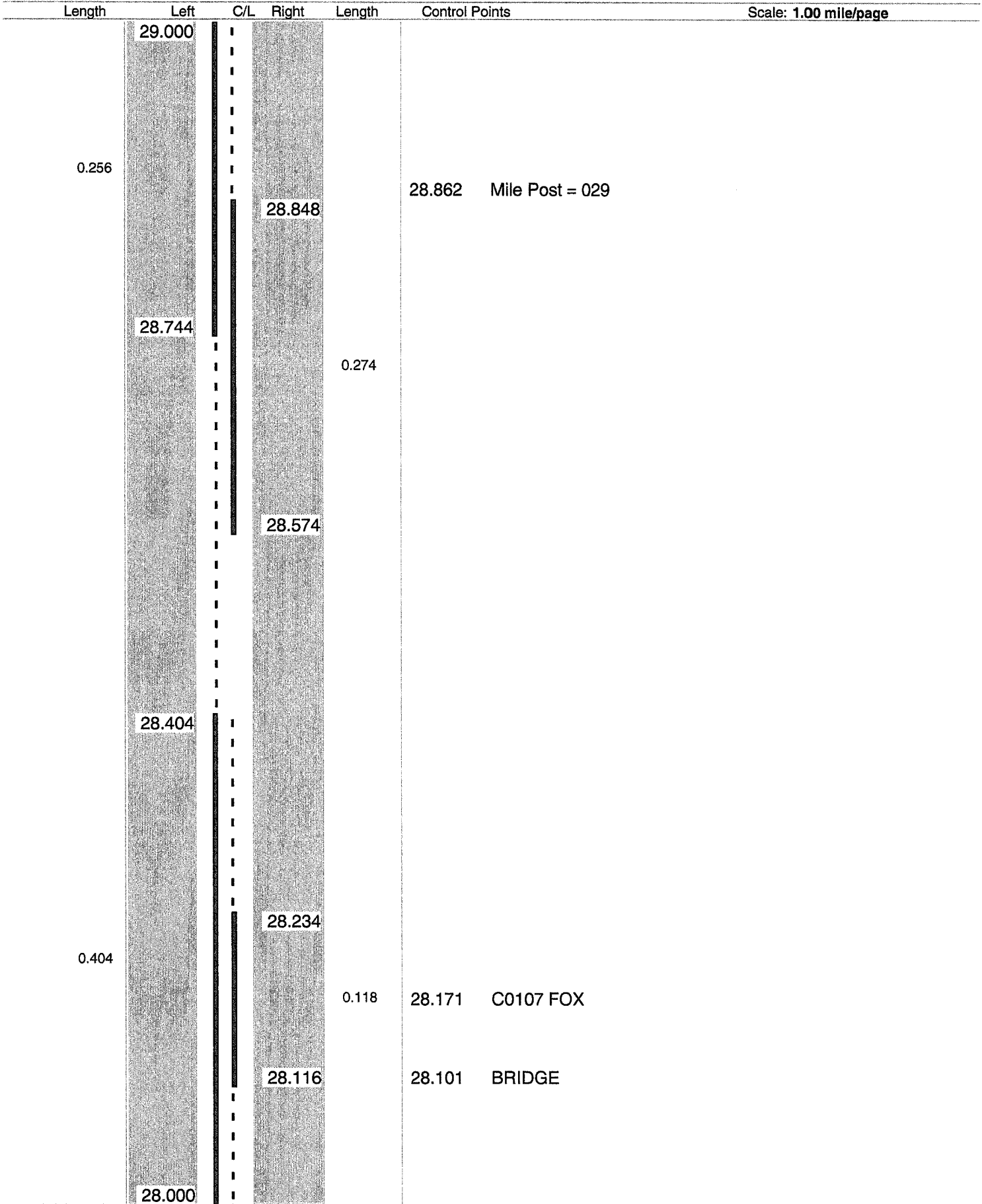

Sheet total equivalent length of solid line: 1.247

Accum. total: 18.829

ODOT Dist 4 - Stark County - FINAL
No Passing Zone Log (STA)

Route: **0172R (SSTASR00172**C)**

From: **16.580 LEAVE CANTON**

Length: **13.664** Direction: **East**

To: **30.244 ENTER COL CO**

| Length | Left | C/L | Right | Length | Control Points | Scale: 1.00 mile/page |
|--------|------------------|-----|------------------|--------|------------------------|-----------------------|
| 0.011 | 30.000 29.973 | | 30.000 29.973 | 0.011 | 29.981 S0183R | |
| | | | | | 29.874 Mile Post = 030 | |
| | | | | | 29.763 T2526 CALWAY RT | |
| 0.812 | | | | 0.874 | | |
| | 29.161 | | | | 29.161 T0114 WHITACRE | |
| | | | 29.099 | | | |
| 0.018 | 29.018 29.000 | | | | | |

Sheet total equivalent length of solid line: 1.766

Accum. total: 20.595

ODOT Dist 4 - Stark County - FINAL
No Passing Zone Log (STA)

Route: **0172R (SSTASR00172**C)**

From: **16.580 LEAVE CANTON**

Length: **13.664**

Direction: **East**

To: **30.244 ENTER COL CO**

