

STATE OF OHIO

DEPARTMENT OF TRANSPORTATION

**SUM-76 / VAR-6.90 / VAR SIGNS**

**BATH, BOSTON, NORTHFIELD CENTER  
AND RICHFIELD TOWNSHIPS  
CITIES OF GREEN, AKRON,  
BARBERTON, AND RICHFIELD  
SUMMIT COUNTY**

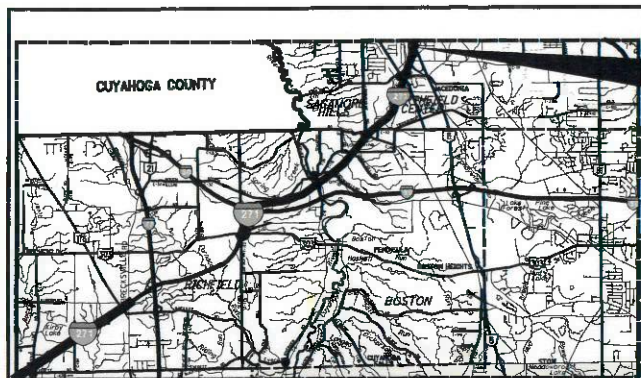

END PROJECT  
SLM 11.45  
SUM-IR-271



BEGIN PROJECT  
SLM 0.00  
SUM-IR-271

END PROJECT  
SLM 8.24  
SUM-IR-76

BEGIN PROJECT  
SLM 6.90  
SUM-IR-76

LOCATION MAP

LATITUDE: 41°07'54" LONGITUDE: 81°35'28"

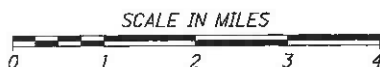

INDEX OF SHEETS:

TITLE SHEET	1	
GENERAL NOTES	2	
MAINTENANCE OF TRAFFIC NOTES	3-6	
GENERAL SUMMARY	7	
I-271 SIGNING SUBSUMMARY	8-10	
I-76 SIGNING SUBSUMMARY	11-12	
I-77 SIGNING SUBSUMMARY	13	
SR-8 SIGNING SUBSUMMARY	13A	ADDED SHEETS
I-271 SIGNING PLAN	14-20	
I-76 SIGNING PLAN	21-22, 22A	
I-77 SIGNING PLAN	23-24, 24A, 24B	
SR-8 SIGNING PLAN	24C	
CROSS SECTIONS	25-30	

PROJECT DESCRIPTION

FREWAY SYSTEMATIC SIGN REPLACEMENTS ON SUM 76 FROM W. WILBETH RD TO MORSE ST. AND SUM-IR 271 FROM MEDINA COUNTY LINE TO BRECKSVILLE ROAD AND SR 303 TO SR 8. INCLUDES LEAD-IN SIGNS AND 2 OVERHEAD SIGNS ON I-77 AT SLM 23.92 & 24.15

EARTH DISTURBED AREAS

PROJECT EARTH DISTURBED AREA: N/A  
ESTIMATED CONTRACTOR EARTH DISTURBED AREA: N/A  
NOTICE OF INTENT EARTH DISTURBED AREA: N/A

LIMITED ACCESS

THIS IMPROVEMENT IS ESPECIALLY DESIGNED FOR THROUGH TRAFFIC AND HAS BEEN DECLARED A LIMITED ACCESS HIGHWAY OR FREEWAY BY ACTION OF THE DIRECTOR IN ACCORDANCE WITH THE PROVISIONS OF SECTION 5511.02 OF THE OHIO REVISED CODE.

2019 SPECIFICATIONS

THE STANDARD SPECIFICATIONS OF THE STATE OF OHIO, DEPARTMENT OF TRANSPORTATION, INCLUDING SUPPLEMENTAL SPECIFICATIONS LISTED IN THE PLANS AND CHANGES LISTED IN THE PROPOSAL SHALL GOVERN THIS IMPROVEMENT.

I HEREBY APPROVED THESE PLANS AND DECLARE THAT THE MAKING OF THIS IMPROVEMENT WILL NOT REQUIRE THE CLOSING TO TRAFFIC OF THE HIGHWAY EXCEPT AS NOTED ON SHEETS 5-6 FOR THE MAINTENANCE AND SAFETY OF TRAFFIC WILL BE AS SET FORTH ON THE PLANS AND ESTIMATES.

DESIGN DESIGNATION

CURRENT ADT (2018)	27000
DESIGN YEAR ADT (20 )	
DESIGN HOURLY VOLUME (20 )	
DIRECTIONAL DISTRIBUTION	
TRUCKS (24 HOUR B&C)	5500
DESIGN SPEED	70
LEGAL SPEED	65
DESIGN FUNCTIONAL CLASSIFICATION:	
FREEWAYS AND INTERSTATES	
NHS PROJECT	YES

DESIGN EXCEPTIONS

NONE



PLAN PREPARED BY:  
ODOT DISTRICT 4, PLANNING & ENGINEERING  
2088 S. ARLINGTON ROAD  
AKRON, OH 44306

ENGINEERS SEAL:  
  
SIGNED: *Rebecca M. MocarSKI*  
DATE: 11-27-19

STANDARD CONSTRUCTION DRAWINGS				SUPPLEMENTAL SPECIFICATIONS	SPECIAL PROVISIONS
DM-4.3	1/15/16	TC-42.20	10/18/13	800-2019	10/18/19
DM-4.4	1/15/16	TC-51.11	1/15/16	821	4/20/12
		TC-52.10	10/18/13	832	10/19/18
TC-7.65	7/20/18	TC-52.20	7/20/18	921	4/20/12
TC-9.30	1/19/18			992	4/18/14
TC-12.30	1/19/18	MT-95.30	7/19/19		
TC-18.24	1/17/14	MT-95.31	7/19/19		
TC-21.10	7/19/19	MT-95.45	4/19/19		
TC-21.20	7/20/18	MT-97.10	4/19/19		
TC-22.20	1/17/14	MT-98.10	1/20/17		
TC-41.10	7/19/13	MT-98.22	1/20/17		
TC-41.20	10/18/13	MT-98.28	1/20/17		
TC-41.30	10/18/13	MT-98.29	7/19/19		
TC-41.40	10/18/13	MT-105.10	7/19/13		
TC-41.50	10/18/13				
TC-42.10	10/18/13				

APPROVED: *Alan Wood*  
DATE: 11/27/19 DISTRICT DEPUTY DIRECTOR

APPROVED: \_\_\_\_\_  
DATE: \_\_\_\_\_ DIRECTOR, DEPARTMENT OF TRANSPORTATION

FEDERAL PROJECT NO. NON-FEDERAL  
PID NO. 105080  
CONSTRUCTION PROJECT NO.  
RAILROAD INVOLVEMENT NONE  
SUM-76 / VAR-6.90 / VAR SIGNS  
1/30

I:\ProjectData\SUM105080\_SIGNS\Design\Roadway\Sheet\S105080\_G1001.dgn Sheet 11/27/2019 12:43:57 PM crees

**UTILITIES**

THE CONTRACTOR SHALL USE THE FOLLOWING PROCEDURE AT EACH LOCATION WHERE WORK IS PERFORMED, IN ACCORDANCE WITH SECTIONS 105.07 AND 107.16 IN THE CONSTRUCTION AND MATERIALS SPECIFICATIONS:

THE CONTRACTOR SHALL NOTIFY THE PROJECT ENGINEER, THE OHIO UTILITIES PROTECTION SERVICE (OUPS), THE OHIO & GAS PROCEDURES UNDERGROUND PROTECTION SERVICE (OGPUPS), THE OHIO DEPARTMENT OF TRANSPORTATION DISTRICT 4 HEAD-QUARTERS AND ALL NON REGISTERED UTILITY OWNERS AT LEAST TWO (2) WORKING DAYS PRIOR TO COMMENCING CONSTRUCTION OPERATIONS IN ALL AREAS.

OUPS 1-800-362-2764 (CONTACT LIMITED BASIS PARTICIPANTS DIRECTLY)  
OGPUPS 1-800-925-0988  
ODOT 330-786-2267 MICHELLE CHANEY

ODOT ITS LAB  
1606 WEST BROAD STREET  
COLUMBUS, OHIO 43223  
614-487-4113  
GEN.ITS.LAB@dot.ohio.gov

LOCATE REQUESTS SHALL BE EMAILED TO THE ODOT ITS LAB.

THE LOCATIONS OF EXISTING UNDERGROUND UTILITIES ARE NOT SHOWN ON THE PLANS, BUT CAN BE OBTAINED FROM THE OWNERS OF THE UTILITIES. THE CONTRACTOR IS RESPONSIBLE FOR ANY DAMAGE TO UTILITIES.

**WORK LIMITS**

THE WORK LIMITS SHOWN ON THESE PLANS ARE FOR PHYSICAL CONSTRUCTION ONLY. PROVIDE THE INSTALLATION AND OPERATION OF ALL WORK ZONE TRAFFIC CONTROL AND WORK ZONE TRAFFIC CONTROL DEVICES REQUIRED BY THESE PLANS WHETHER INSIDE OR OUTSIDE THESE WORK LIMITS.

**CLEARING AND GRUBBING, AS PER PLAN**

ALTHOUGH THERE ARE NO TREES OR STUMPS SPECIFICALLY MARKED FOR REMOVAL WITHIN THE LIMITS OF THE PROJECT, A LUMP SUM QUANTITY IS INCLUDED IN THE GENERAL SUMMARY FOR ITEM 201, CLEARING AND GRUBBING, AS PER PLAN.

THE CONTRACTOR SHALL TRIM SHRUBS OR TREES PARTIALLY COVERING ANY SIGNS.

ALL PROVISIONS AS SET FORTH IN THE SPECIFICATIONS UNDER THIS ITEM ARE INCLUDED IN THE LUMP SUM PRICE BID FOR ITEM 201, CLEARING AND GRUBBING, AS PER PLAN.

**CROSS SECTIONS**

CROSS SECTIONS HAVE BEEN PROVIDED FOR OVERHEAD SIGNS. THE CONTRACTOR SHALL PLACE OVERHEAD SIGNS OVER LANES ACCORDING TO THESE SIGNS.

**GROUND AND OVERHEAD MOUNTED SIGNS**

GROUND AND OVERHEAD MOUNTED SIGNS ON EXISTING BEAMS/TRUSSES/CANTILEVERS SHALL BE INSTALLED AT THE SAME HEIGHT AS EXISTING SIGNS.

**SIGN ATTACHMENT ASSEMBLY, AS PER PLAN**

REFER TO STANDARD CONSTRUCTION DRAWING TC-9.30 FOR CENTER MOUNT OVERHEAD SIGN SUPPORTS ASSEMBLIES FOR S-27 AND S-30 ON SHEET 20.

**ITEM 630 SIGN SUPPORT ASSEMBLY, BARRIER MOUNTED, AS PER PLAN**

THE CONTRACTOR SHALL USE CONCRETE BARRIER MOUNTED SIGN SUPPORTS, AS PER DETAIL A BELOW.

THE ABOVE WORK SHALL BE PAID FOR UNDER ITEM 630 SIGN SUPPORT ASSEMBLY, BARRIER MOUNTED, AS PER PLAN AND SHALL INCLUDE ALL LABOR, BRACKETS AND MATERIALS REQUIRED TO COMPLETE THE WORK.

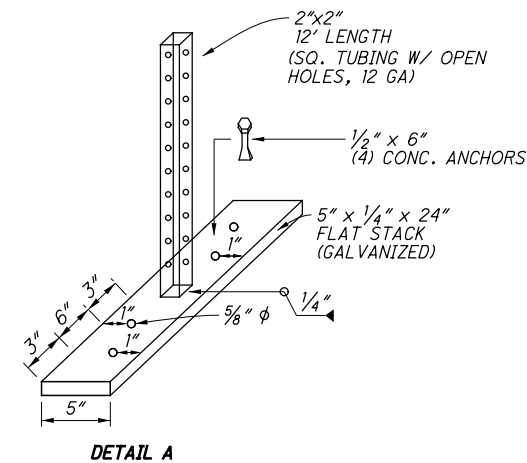

**INTERIM COMPLETION DATE FOR HOSPITAL SIGNS**  
THE CONTRACTOR SHALL HAVE THE HOSPITAL SIGNS ON SHEETS 21, 22A & 24A-C INSTALLED BY JUNE 30, 2020.  
**ADDED PLAN NOTE**

I:\Project+Data\SUM\05080\_SIGNS\Design\Roadway\Sheets\05080\_GN001.dgn Sheet 2/5/2020 2:00:59 PM rblsesi

I:\Project+Data\SUM\05080...SIGNS\Roadway\Design\Roadway\Sheets\05080\_MN001.dgn Sheet2 2/11/2020 3:03:40 PM rbsesi

**ITEM 614, PORTABLE CHANGEABLE MESSAGE SIGNS, AS PER PLAN**

THE CONTRACTOR SHALL FURNISH, INSTALL, MAINTAIN AND REMOVE, WHEN NO LONGER NEEDED, A CHANGEABLE MESSAGE SIGN. THE SIGN SHALL BE OF A TYPE SHOWN ON A LIST OF APPROVED PCMS UNITS AVAILABLE ON THE OFFICE OF MATERIALS MANAGEMENT WEB PAGE. THE LIST CONTAINS CLASS A AND B UNITS WITH MINIMUM LEGIBILITY DISTANCES OF 800 FEET AND 650 FEET, RESPECTIVELY.

EACH SIGN SHALL BE TRAILER-MOUNTED AND EQUIPPED WITH A FUNCTIONAL DIMMING MECHANISM, TO DIM THE SIGN DURING DARKNESS, AND A TAMPER AND VANDAL PROOF ENCLOSURE. EACH SIGN SHALL BE PROVIDED WITH APPROPRIATE TRAINING AND OPERATION INSTRUCTIONS TO ENABLE ON-SITE PERSONNEL TO OPERATE AND TROUBLESHOOT THE UNIT. THE SIGN SHALL ALSO BE CAPABLE OF BEING POWERED BY AN ELECTRICAL SERVICE DROP FROM A LOCAL UTILITY COMPANY. THE PCMS SHALL BE DELINEATED IN ACCORDANCE WITH C&MS 614.03.

THE PROBABLE PCMS LOCATIONS AND WORK LIMITS FOR THOSE LOCATIONS ARE SHOWN ON SHEET(S) 5 & 6 OF THE PLAN. PLACEMENT, OPERATION, MAINTENANCE AND ALL ACTIVATION OF THE SIGNS BY THE CONTRACTOR SHALL BE AS DIRECTED BY THE ENGINEER. THE PCMS SHALL BE LOCATED IN A HIGHLY VISIBLE POSITION YET PROTECTED FROM TRAFFIC. THE CONTRACTOR SHALL, AT THE DIRECTION OF THE ENGINEER, RELOCATE THE PCMS TO IMPROVE VISIBILITY OR ACCOMMODATE CHANGED CONDITIONS. WHEN NOT IN USE, THE PCMS SHALL BE TURNED OFF. ADDITIONALLY, WHEN NOT IN USE FOR EXTENDED PERIODS OF TIME, THE PCMS SHALL BE TURNED AWAY FROM ALL TRAFFIC.

THE ENGINEER SHALL BE PROVIDED ACCESS TO EACH SIGN UNIT AND SHALL BE PROVIDED WITH APPROPRIATE TRAINING AND OPERATION INSTRUCTIONS TO ENABLE ODOT PERSONNEL TO OPERATE AND TROUBLESHOOT THE UNIT, AND TO REVISE SIGN MESSAGES, IF NECESSARY.

**DELETED "CONTRACTOR SHALL IMPLEMENT MESSG**  
ALL MESSAGES TO BE DISPLAYED ON THE SIGN WILL BE PROVIDED BY THE ENGINEER. A LIST OF ALL REQUIRED PRE-PROGRAMMED MESSAGES WILL BE GIVEN TO THE CONTRACTOR AT THE PROJECT PRECONSTRUCTION CONFERENCE. THE SIGN SHALL HAVE THE CAPABILITY TO STORE UP TO 99 MESSAGES. MESSAGE MEMORY OR PRE-PROGRAMMED DISPLAYS SHALL NOT BE LOST AS A RESULT OF POWER FAILURES TO THE ON-BOARD COMPUTER. THE SIGN LEGEND SHALL BE CAPABLE OF BEING CHANGED IN THE FIELD. THREE-LINE PRESENTATION FORMATS WITH UP TO SIX MESSAGE PHASES SHALL BE SUPPORTED. PCMS FORMAT SHALL PERMIT THE COMPLETE MESSAGE FOR EACH PHASE TO BE READ AT LEAST TWICE.

THE PCMS SHALL CONTAIN AN ACCURATE CLOCK AND PROGRAMMING LOGIC WHICH WILL ALLOW THE SIGN TO BE ACTIVATED, DEACTIVATED OR MESSAGES CHANGED AUTOMATICALLY AT DIFFERENT TIMES OF THE DAY FOR DIFFERENT DAYS OF THE WEEK.

(THE PCMS SHALL CONTAIN A CELLULAR TELEPHONE DATA LINK WHICH WILL (IN ACTIVE CELLULAR PHONE AREAS) ALLOW REMOTE SIGN ACTIVATION, MESSAGE CHANGES, MESSAGE ADDITIONS AND REVISIONS TO TIME OF DAY PROGRAMS. THE SYSTEM SHALL ALSO PERMIT VERIFICATION OF CURRENT AND PROGRAMMED MESSAGES. ONE REMOTE DATA INPUT DEVICE (LAPTOP COMPUTER PLUS MODEM OR EQUIVALENT) SHALL BE FURNISHED FOR USE BY THE DISTRICT TRAFFIC ENGINEER, OR EQUIVALENT, AND SHALL BE INSURED AGAINST THEFT.) THE PCMS UNIT SHALL BE MAINTAINED IN GOOD WORKING ORDER BY THE CONTRACTOR IN ACCORDANCE WITH THE PROVISIONS OF C&MS 614.07. THE CONTRACTOR SHALL, PRIOR TO ACTIVATING THE UNIT, MAKE ARRANGEMENTS, WITH AN AUTHORIZED SERVICE AGENT FOR THE PCMS, TO ASSURE PROMPT SERVICE IN THE EVENT OF FAILURE. ANY FAILURE SHALL NOT RESULT IN THE SIGN BEING OUT OF SERVICE FOR MORE THAN 12 HOURS, INCLUDING WEEKENDS. FAILURE TO COMPLY MAY RESULT IN AN ORDER TO STOP WORK AND OPEN ALL TRAFFIC LANES AND/OR IN THE DEPARTMENT TAKING APPROPRIATE ACTION TO SAFELY CONTROL TRAFFIC. THE ENTIRE COST TO CONTROL TRAFFIC, ACCRUED BY THE DEPARTMENT DUE TO THE CONTRACTOR'S NONCOMPLIANCE, WILL BE DEDUCTED FROM MONEYS DUE, OR TO BECOME DUE THE CONTRACTOR ON HIS CONTRACT.

THE CONTRACTOR SHALL BE RESPONSIBLE FOR 24-HOUR-PER-DAY OPERATION AND MAINTENANCE OF THESE SIGNS ON THE PROJECT FOR THE DURATION OF THE PHASES WHEN THE PLAN REQUIRES THEIR USE.

PAYMENT FOR THE ABOVE DESCRIBED ITEM SHALL BE AT THE CONTRACT UNIT PRICE. PAYMENT SHALL INCLUDE ALL LABOR, MATERIALS, EQUIPMENT, FUELS, LUBRICATING OILS, SOFTWARE, HARDWARE, AND INCIDENTALS TO PERFORM THE ABOVE DESCRIBED WORK.

614 PORTABLE CHANGEABLE MESSAGE SIGN,  
AS PER PLAN, 7 SIGN MONTH

**ITEM 614 - LAW ENFORCEMENT OFFICER (WITH PATROL CAR) FOR ASSISTANCE DURING CONSTRUCTION OPERATIONS**

USE OF LAW ENFORCEMENT OFFICERS (LEOS) BY CONTRACTORS OTHER THAN THE USES SPECIFIED BELOW WILL NOT BE PERMITTED AT PROJECT COST. LEOS SHOULD NOT BE USED WHERE THE ODOT INTENDS THAT FLAGGERS BE USED.

IN ADDITION TO THE REQUIREMENTS OF CMS 614 AND THE ODOT, A UNIFORMED LEO WITH AN OFFICIAL PATROL CAR (CAR WITH TOP-MOUNTED EMERGENCY FLASHING LIGHTS AND COMPLETE MARKINGS OF THE APPROPRIATE LAW ENFORCEMENT AGENCY) SHALL BE PROVIDED FOR THE FOLLOWING TRAFFIC CONTROL TASKS:

DURING THE ENTIRE ADVANCE PREPARATION AND CLOSURE SEQUENCE WHERE COMPLETE BLOCKAGE OF TRAFFIC IS REQUIRED.

FOR LANE CLOSURES: DURING INITIAL SET-UP PERIODS, TEAR DOWN PERIODS, SUBSTANTIAL SHIFTS OF A CLOSURE POINT OR WHEN NEW LANE CLOSURE ARRANGEMENTS ARE INITIATED FOR LONG-TERM LANE CLOSURES/SHIFTS (FOR THE FIRST AND LAST DAY OF MAJOR CHANGES IN TRAFFIC CONTROL SETUP).

LEOS SHOULD NOT FORGO THEIR TRAFFIC CONTROL RESPONSIBILITIES TO APPREHEND MOTORISTS FOR ROUTINE TRAFFIC VIOLATIONS. HOWEVER, IF A MOTORIST'S ACTIONS ARE CONSIDERED TO BE RECKLESS, THEN PURSUIT OF THE MOTORIST IS APPROPRIATE.

IN GENERAL LEOS SHOULD BE POSITIONED IN ADVANCE OF AND ON THE SAME SIDE AS THE LANE RESTRICTION OR AT THE POINT OF ROAD CLOSURE, AND TO MANUALLY CONTROL TRAFFIC MOVEMENTS THROUGH SIGNALIZED INTERSECTIONS IN WORK ZONE.

THE LEOS WORK AT THE DIRECTION OF THE ENGINEER. THE CONTRACTOR IS RESPONSIBLE FOR SECURING THE SERVICES OF THE LEOS WITH THE APPROPRIATE AGENCIES AND COMMUNICATING THE INTENTIONS OF THE PLANS WITH RESPECT TO DUTIES OF THE LEOS. THE ENGINEER SHALL HAVE FINAL CONTROL OVER THE LEOS' DUTIES AND PLACEMENT, AND WILL RESOLVE ANY ISSUES THAT MAY ARISE BETWEEN THE TWO PARTIES.

THE LEO SHALL REPORT IN TO THE CONTRACTOR PRIOR TO THE START OF THE SHIFT, IN ORDER TO RECEIVE INSTRUCTIONS REGARDING SPECIFIC WORK ASSIGNMENTS DURING HIS/HER SHIFT. THE LEO IS EXPECTED TO STAY AT THE PROJECT SITE FOR THE ENTIRE DURATION OF HIS/HER SHIFT. THE LEO SHALL REPORT TO THE CONTRACTOR AT THE END OF HIS/HER SHIFT. ONCE THE LEO HAS COMPLETED THE DUTIES DESCRIBED ABOVE AND STILL HAS TIME REMAINING ON HIS/HER SHIFT, THE LEO MAY BE ASKED TO PATROL THROUGH THE WORK ZONE (WITH FLASHING LIGHTS OFF) OR BE PLACED AT A LOCATION TO DETER MOTORISTS FROM SPEEDING. SHOULD IT BE NECESSARY TO LEAVE THE PROJECT SITE, THE LEO SHALL NOTIFY THE ENGINEER. THE CONTRACTOR SHALL PROVIDE THE LEO WITH A TWO-WAY COMMUNICATION DEVICE WHICH SHALL BE RETURNED TO THE CONTRACTOR AT THE END OF HIS/HER SHIFT.

LEOS (WITH PATROL CAR) REQUIRED BY THE TRAFFIC MAINTENANCE TASKS ABOVE SHALL BE PAID FOR ON A UNIT PRICE (HOURLY) BASIS UNDER ITEM 614, LAW ENFORCEMENT OFFICER (WITH PATROL CAR) FOR ASSISTANCE. THE FOLLOWING ESTIMATED QUANTITIES HAVE BEEN CARRIED TO THE GENERAL SUMMARY.

ITEM 614, LAW ENFORCEMENT OFFICER WITH PATROL CAR FOR ASSISTANCE 100 HOURS

THE HOURS PAID SHALL INCLUDE ANY MINIMUM SHOW-UP TIME REQUIRED BY THE LAW ENFORCEMENT AGENCY INVOLVED.

ANY ADDITIONAL COSTS (ADMINISTRATIVE OR OTHERWISE) INCURRED BY THE CONTRACTOR TO OBTAIN THE SERVICES OF AN LEO ARE INCLUDED WITH THE BID UNIT PRICE FOR ITEM 614, LAW ENFORCEMENT OFFICER WITH PATROL CAR FOR ASSISTANCE.

POPULATED THIS FIELD

WITHIN XX HOURS FOLLOWING PHONE NOTIFIC..."









\\004F5006\drive\Project\04\Sign\Design\Sigs\Roadway\Sheets\05090\_Tc016.dgn Sheet 02 2/4/2020 2:38:47 PM jf1zslm

REF NO.	SHEET NO.	SLM	SIDE	CODE *PLYWOOD # YELLOWGREEN ## WHITE OR BROWN	SIZE (INCHES)	630	630	630	630	630	630	630	630	630	630	630	625	630	630	630	630	630			
						EACH	EACH	SF	SF	EACH	EACH	EACH	EACH	EACH	EACH	EACH	FT	EACH	EACH	EACH	SF	EACH	EACH		
S-25	21	8.27	RT	SPECIAL E5-H1a	72x60					1					2							30		2	
S-26	KENMORE		LT	M4-5	24x12			2		7															
	22			M3-2	24x12			2																	
	22			M1-1	24x24			4																	
	22			M6-1	21x15			2.19																	
	22			M4-5	24x12			2																	
	22			M1-1	24x24			4																	
	22			M6-1	21x15			2.19																	
S-27	KENMORE		LT	E1-2	84x96		2		56				2												
	22			E1-2	84x96		2		56																
S-28	KENMORE		LT	E1-2	120x72	3			60					1		1	1					1			
	22																								
S-29	KENMORE		RT	E1-2	120x72	3			60					1		1		1				1			
	22																								
S-30	KENMORE		RT	E1-2	84x84		2		49			2													
	22			E1-2	84x84		2		49																
S-31	KENMORE		LT	E1-2	108x72	3			54		1														
	22			M1-4	30x24			5						1											
	22			M4-5	24x12			2																	
	22			M5-1	21x15			2.19																	
S-32	BATTLES		LT	M4-5	24x12			2				5		1											
	22			M1-1	24x24			4						1											
	22			M3-2	24x12			2						1											
	22			M1-1	24x24			4						1											
	22			M6-3	21x15			2.19						1											
S-33	21	7.75	RT	D9-H2a	60x30				12.5					1											
S-34	21	8.10	RT	D9-H2a	60x30				12.5					1											
S-35	21	8.20	RT	D9-H2a	60x30				12.5					1											
S-36	22A	11.03	RT	D9-H2a	60x30				12.5					1											
S-37	22A	11.48	RT	D9-H2a	60x30				12.5					1											
S-38	22A	11.63	RT	D9-H2a	60x30				12.5					1											
S-39	22A	11.78	LT	D9-H2a	60x30				12.5					1											
S-40	22A	11.89	LT	D9-H2a	60x30				12.5					1											
S-41	22A	12.03	LT	D9-H2a	60x30				12.5					1											
TOTALS CARRIED TO GENERAL SUMMARY						9.0	8.0	41.8	497	8	1	4	5	2	5	10	2	2	32	2	1	1	30	2	2

ADDED QUANTITIES

IR-76 SIGNING SUBSUMMARY

SUM-76 / VAR-6.90 / VAR  
SIGNS

CALCULATED  
JFF  
CREATED  
RMB







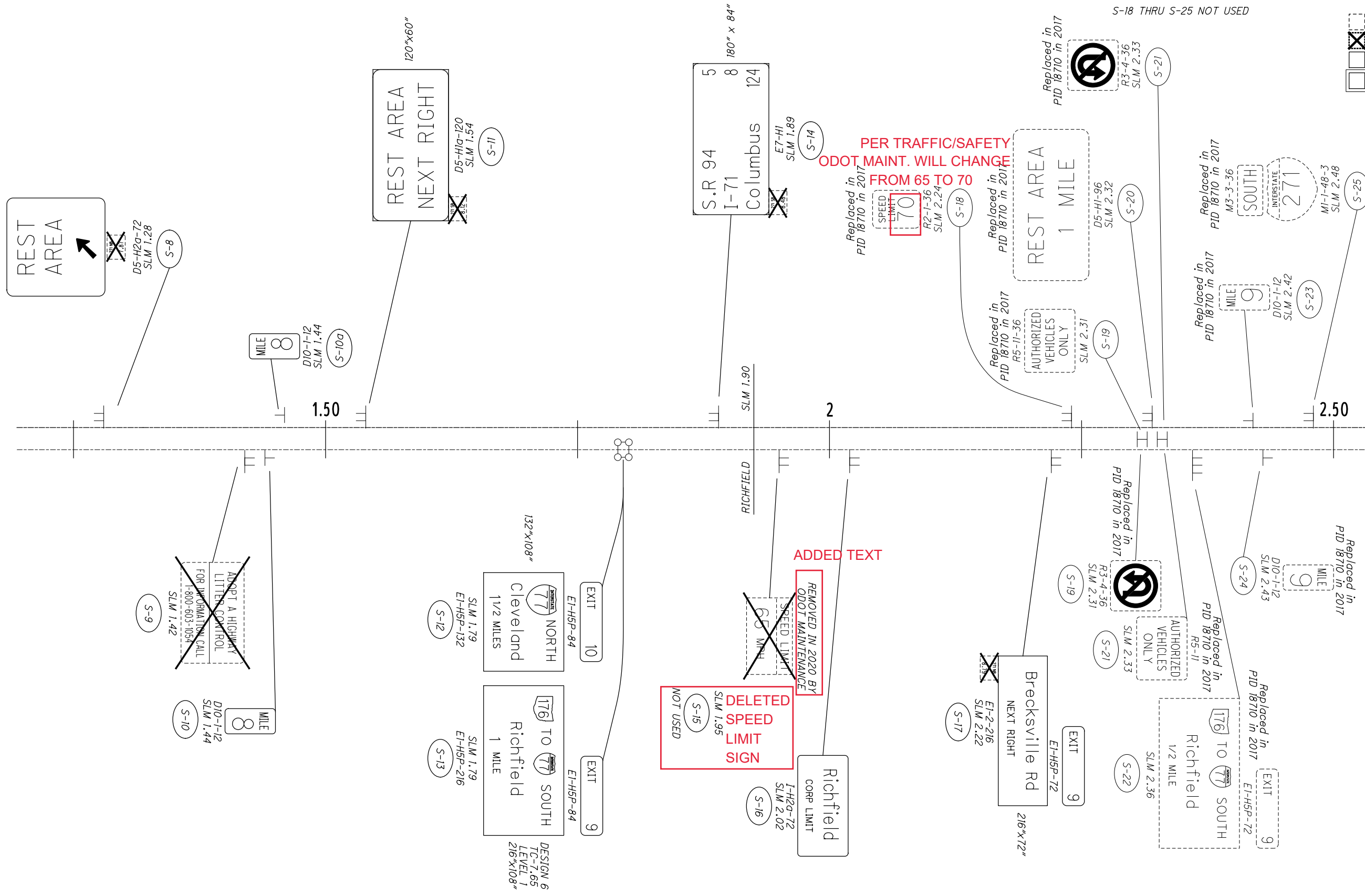

LEGEND

- EX-NO WORK
- EX-REMOVE
- EX-REPLACE
- NEW/ADD

CALCULATED 0  
NAR 0  
CHECKED 0  
RMB 0

HORIZONTAL SCALE IN FEET

**SIGNING PLAN**  
**SUM-IR 271 (SLM 1.25 TO 2.50)**

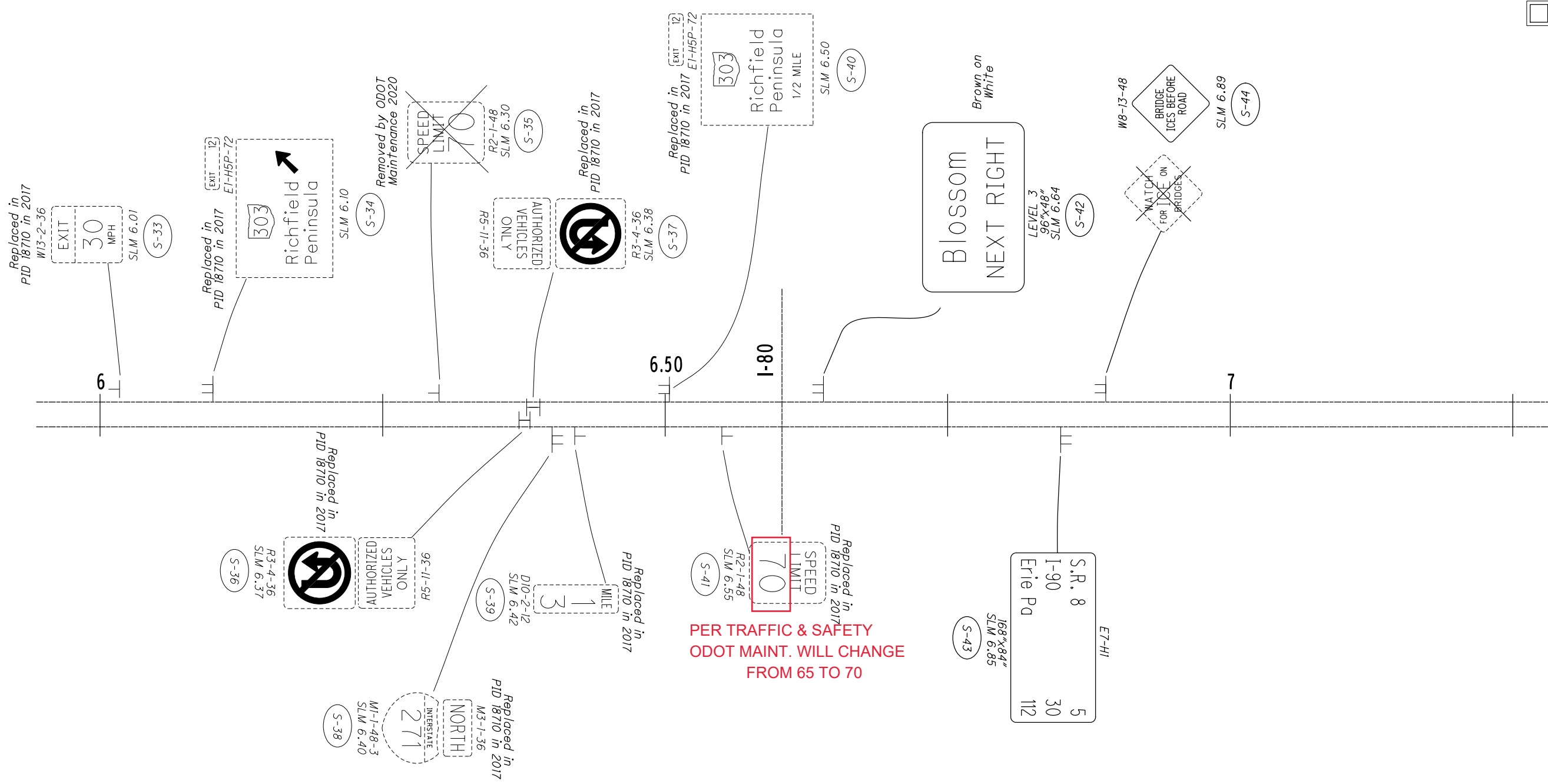

S-33 THRU S-41 NOT USED

**LEGEND**

- EX-NO WORK
- EX-REMOVE
- EX-REPLACE
- NEW/ADD

CALCULATED  
NAR

CHECKED  
RMB

0 0 0  
HORIZONTAL  
SCALE IN FEET

**SIGNING PLAN**

**SUM-IR 271 (SLM 6.03 TO 7.25)**

**SUM-76 VAR-6.90/VAR**

**SIGNS**

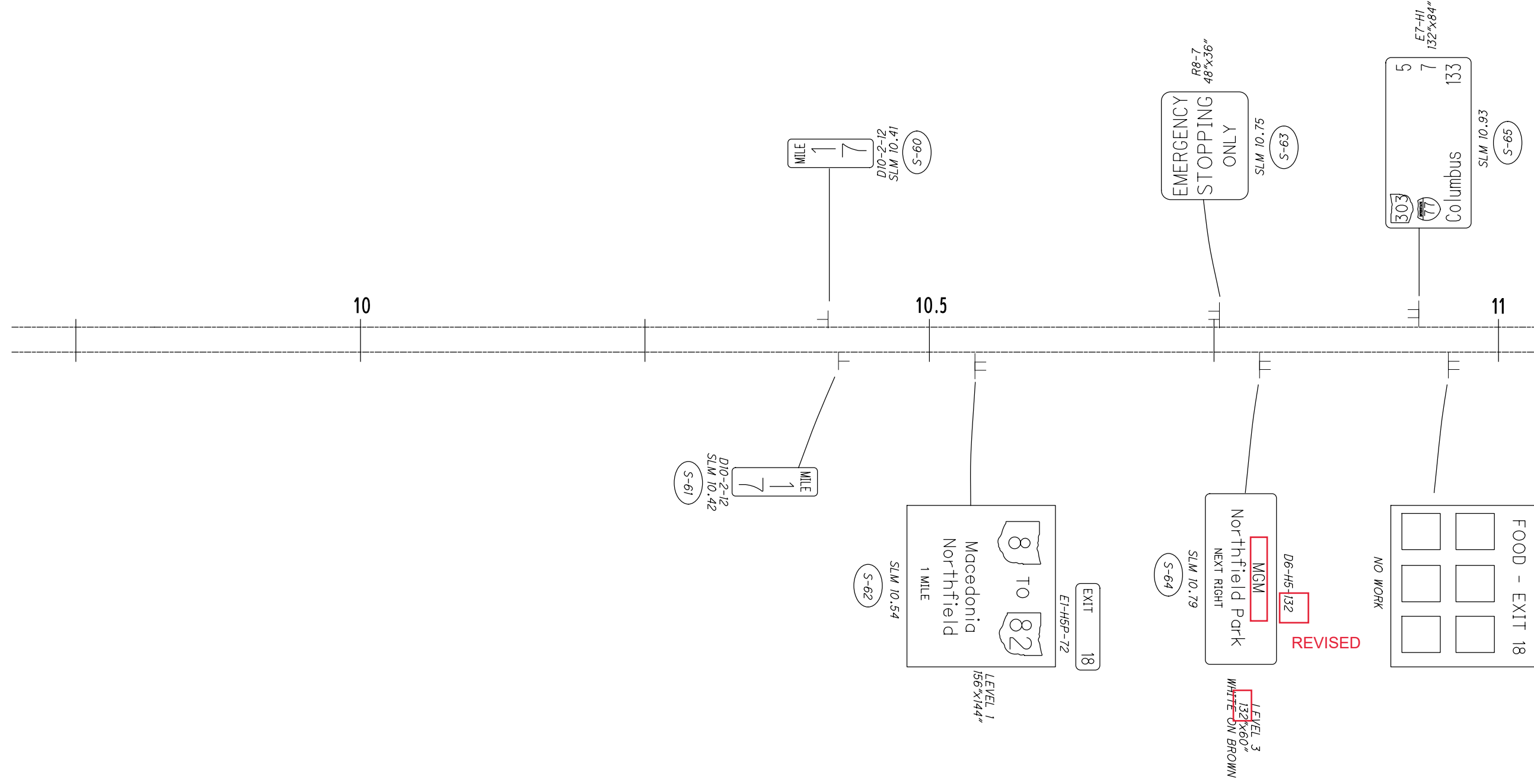

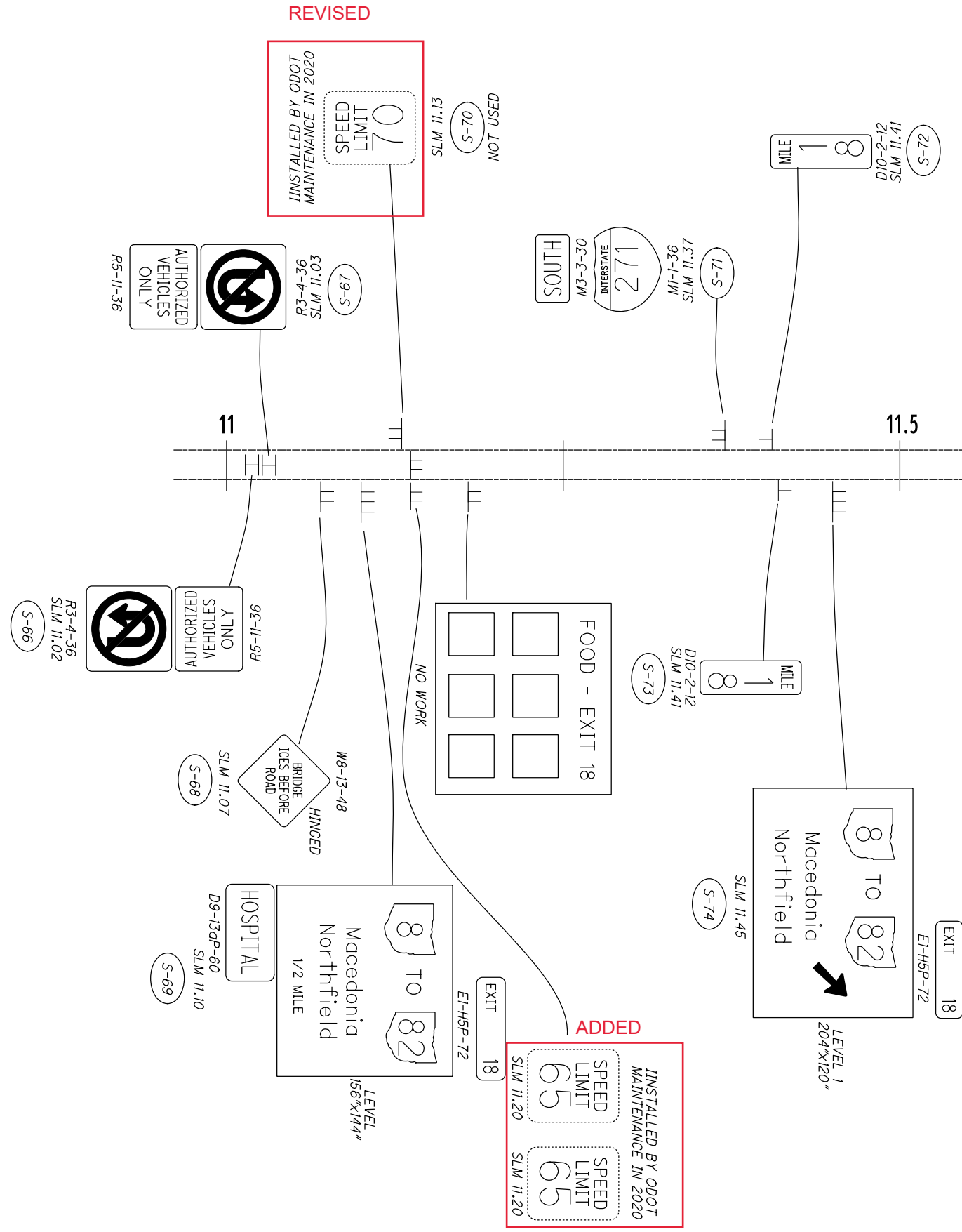

**LEGEND**

- EX-NO WORK
- EX-REMOVE
- EX-REPLACE
- NEW/ADD

CALCULATED  
JRF

CHECKED  
RMB

0  
0  
0  
HORIZONTAL  
SCALE IN FEET

**SIGNING PLAN**  
**SUM-IR 271 (SLM 11.00 TO 11.55)**

**SUM-76 VAR-6.90 / VAR**  
**SIGNS**

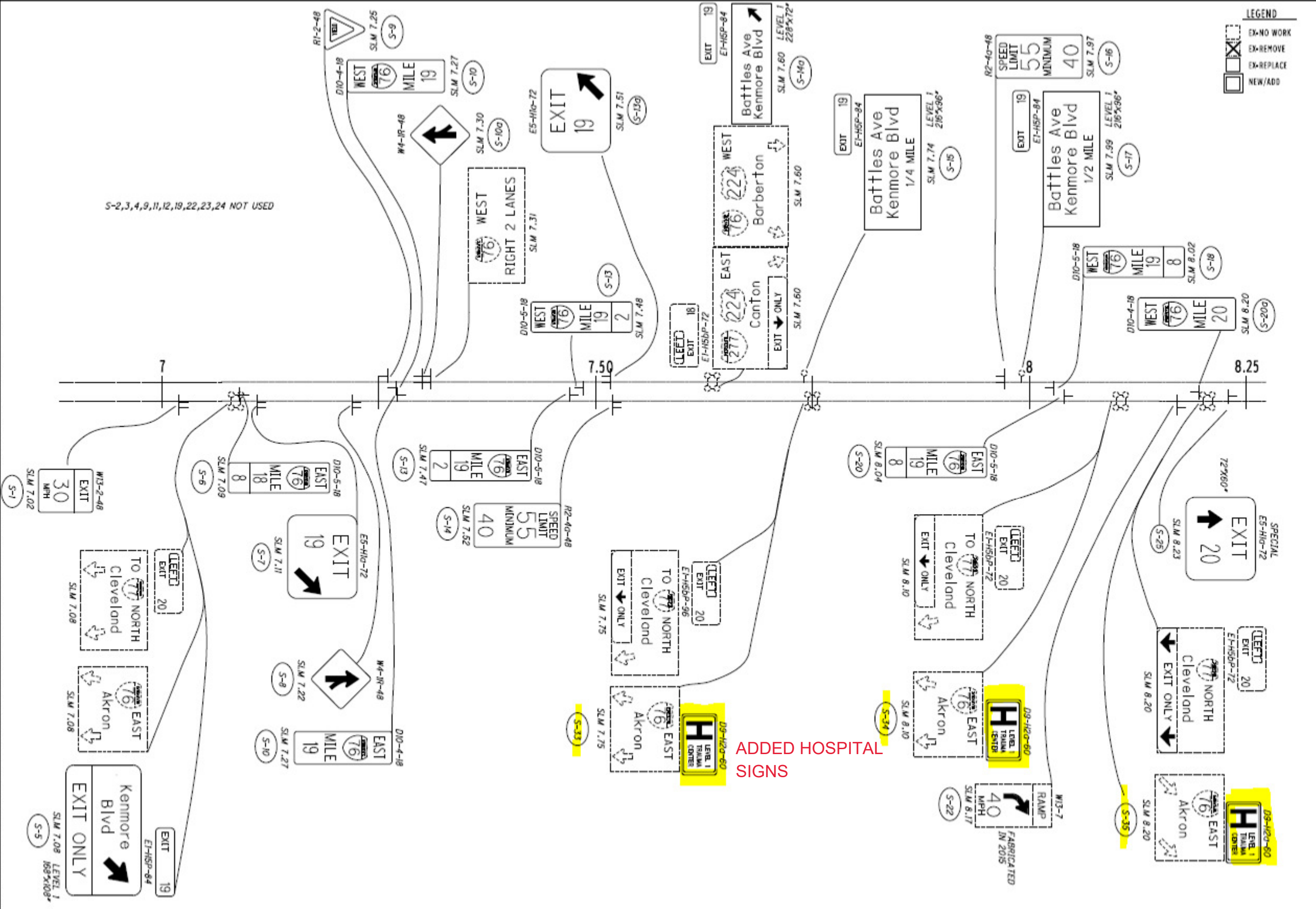

S-2,3,4,9,11,12,19,22,23,24 NOT USED

ADDED HOSPITAL SIGNS

**LEGEND**

- EX-NO WORK
- EX-REMOVE
- EX-REPLACE
- NEW/ADD

**SIGNING PLAN**

**SUM-IR 76 (SLM 6.90 TO 8.25)**

**SUM-76 VAR-6.90 VAR / 96 VAR - 6.90 VAR / 96 VAR**

**SIGNS**

Horizontal Scale: 1" = 60'

Vertical Scale: 1" = 10'

Calculated: JRF, Checked: RMB

21/30

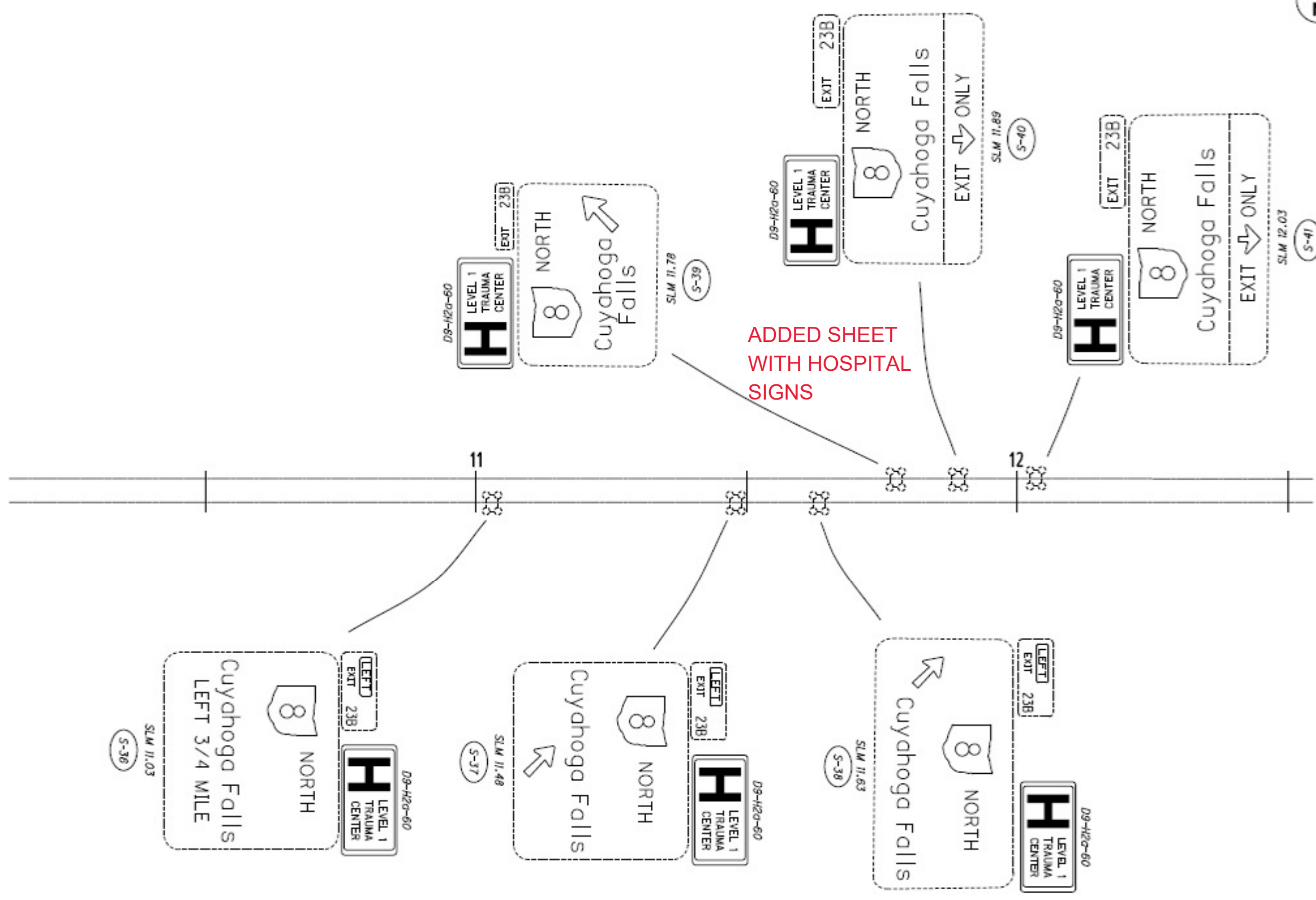

**LEGEND**

	EX-NO WORK
	EX-REMOVE
	EX-REPLACE
	NEW/ADD



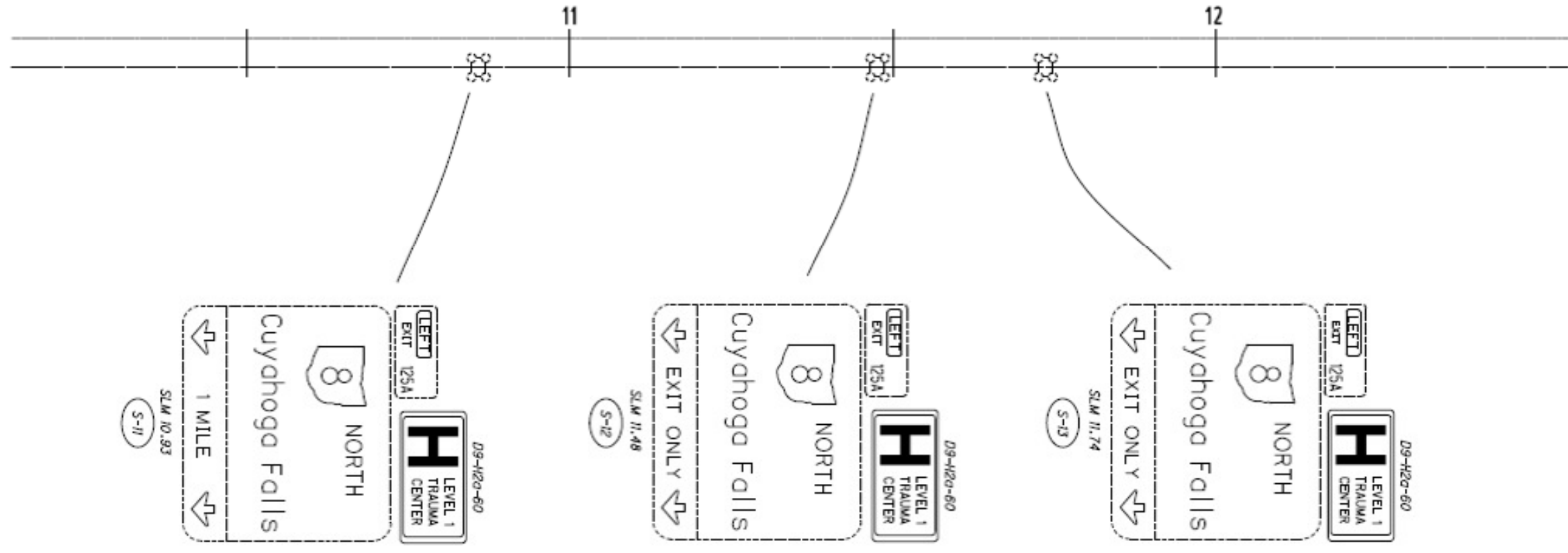

ADDED SHEET  
WITH HOSPITAL  
SIGNS



LEGEND

	EX-NO WORK
	EX-REMOVE
	EX-REPLACE
	NEW/ADD

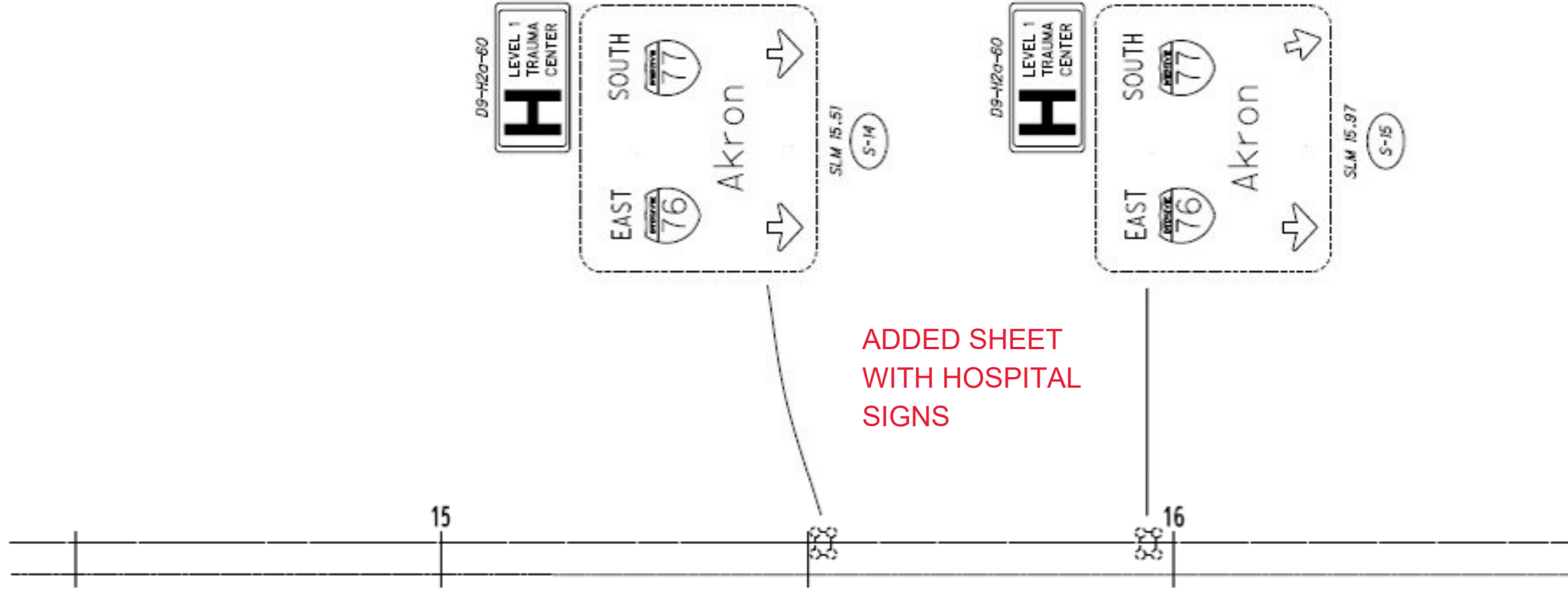

LEGEND

	EX-NO WORK
	EX-REMOVE
	EX-REPLACE
	NEW/ADD

24B 30	SUM-76 / VAR-6.90 / VAR SIGNS	PROPOSED SIGN UPGRADE - IR 77		
		CALCULATED	JRF CHECKED	AC

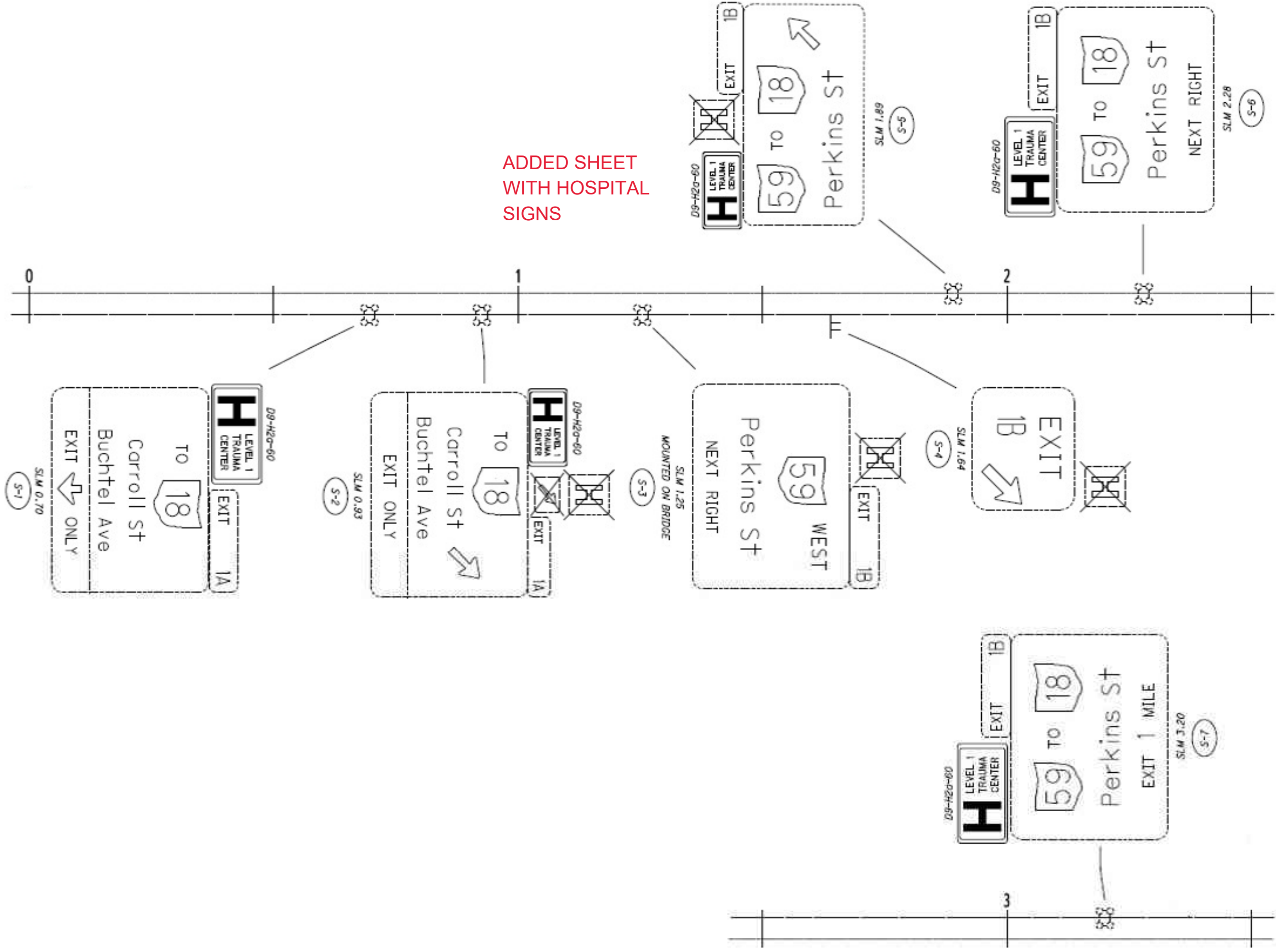

ADDED SHEET WITH HOSPITAL SIGNS

**LEGEND**

- EX-NO WORK
- EX-REMOVE
- EX-REPLACE
- NEW/ADD