

PAVEMENT MARKING LEGEND

- (EW) EDGE LINE, (WHITE)
- (L) LANE LINE
- (CS) CENTER LINE, DOUBLE, SOLID
- (C) CENTER LINE, DOUBLE, BROKEN AND SOLID
- (CH) CHANNELIZING LINE
- (S) STOP LINE
- (CW) CROSSWALK LINE
- (TY) TRANSVERSE LINE, (YELLOW)
- (IM) ISLAND MARKING, (YELLOW)
- (A) LANE ARROW
- (W) WORD ON PAVEMENT, 180mm [7.2in]
- (D) DOTTED LINE, 100mm [4.0in]

DESIGNED BY: T.K.L. DATE: 11/28/94
 DRAWN BY: T.K.L. DATE: 11/28/94
 CHECKED BY: BSK DATE: 2/21/01
 CAD FILE NAME: 7006500-PROSIGN2

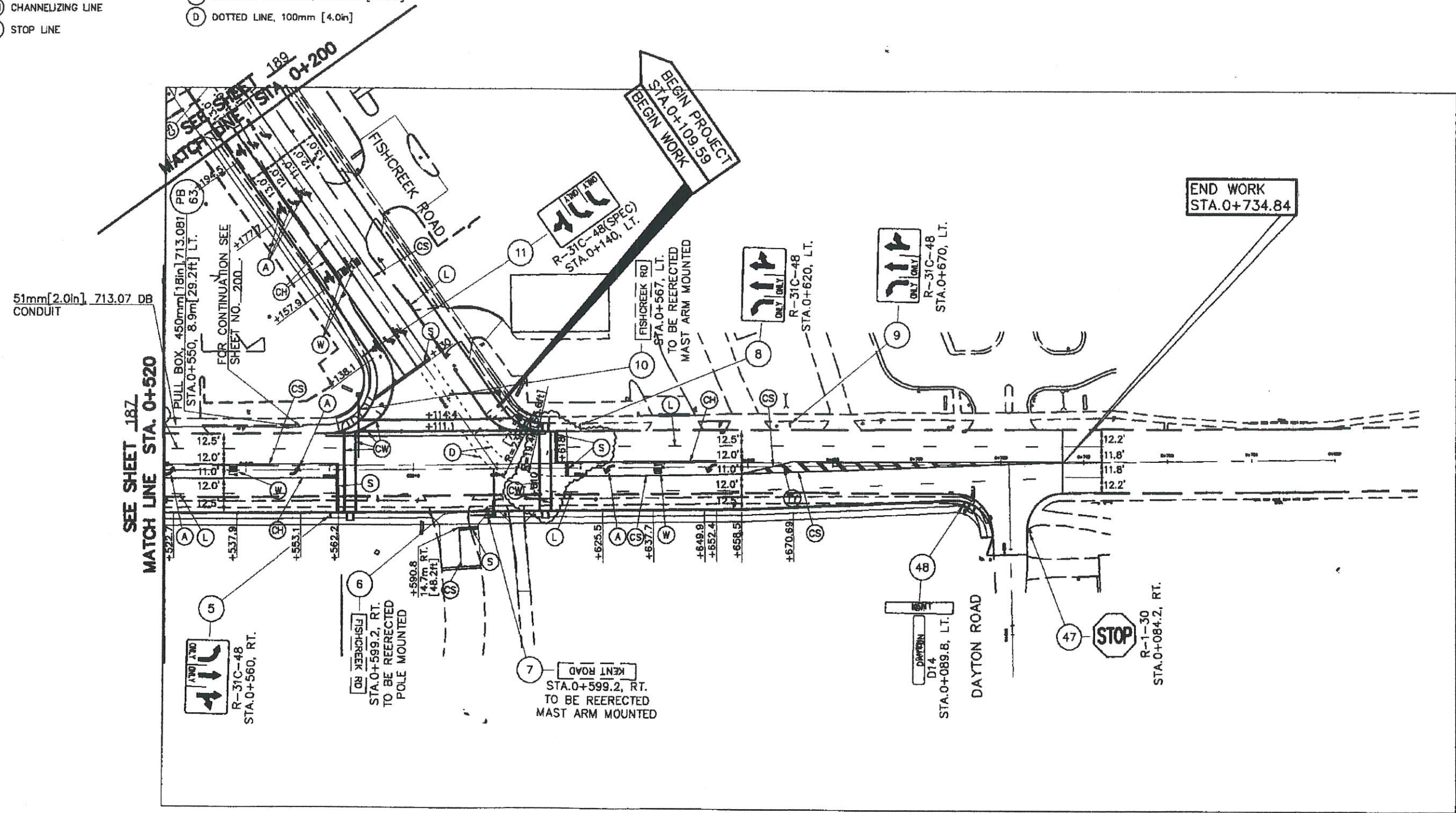

FOR SIGN LEGEND
 SEE SHEET NO. 177

FOR QUANTITIES
 SEE SHEET NO. 195-198

FOR SIGNAL PLAN
 SEE SHEET NO. 200

SUM-FISHCREEK ROAD

SIGNING AND PAVEMENT MARKING PLAN-KENT ROAD(SR59)

STA. 0+520 TO STA. 0+800

SCALE IN METERS

0 5 10 20

CALCULATED

CHECKED

188

274

BENCHMARK :
 CHISELED "□" TOP OF N.W. CORNER
 OF CONCRETE LIGHT POLE BASE
 STA. 0+126 ± 14.2m [46.6ft.] RT. @ FISHCREEK RD.
 ELEVATION: 319.10m [1046.90ft.]

KENT RD. (SR 59)
 @ SURVEY CURVE DATA
 Δ = 01°53'00"
 R = 6987.37m [22924.2ft.]
 T = 114.85m [376.8ft.]
 L = 229.68m [753.53ft.]
 P.I. STA. = 0+486.15
 E = 0.94m [3.08ft.]

KENT RD. (SR 59)
 @ CONSTRUCTION CURVE DATA
 Δ = 01°37'33"
 R = 6986.31m [22923.9ft.]
 T = 99.13m [325.23ft.]
 L = 198.25m [650.42ft.]
 P.I. STA. = 0+501.84
 E = 0.70m [2.30ft.]
 e = NC

LEGEND

- (S) SIDEWALK
- (CR) CURB RAMP
- (D) DRIVEWAY
- (W) WATER WORK
- (R) REMOVE
- (P) PROPOSED DRAINAGE
- (ADJ) ADJUST TO GRADE
- (M) MONUMENT
- (C) CURB



CALCULATED
 CHECKED

ROADWAY PLAN - FISHCREEK ROAD
 STA. 0+100 TO STA. 0+200

SUM-FISHCREEK ROAD

50
 274

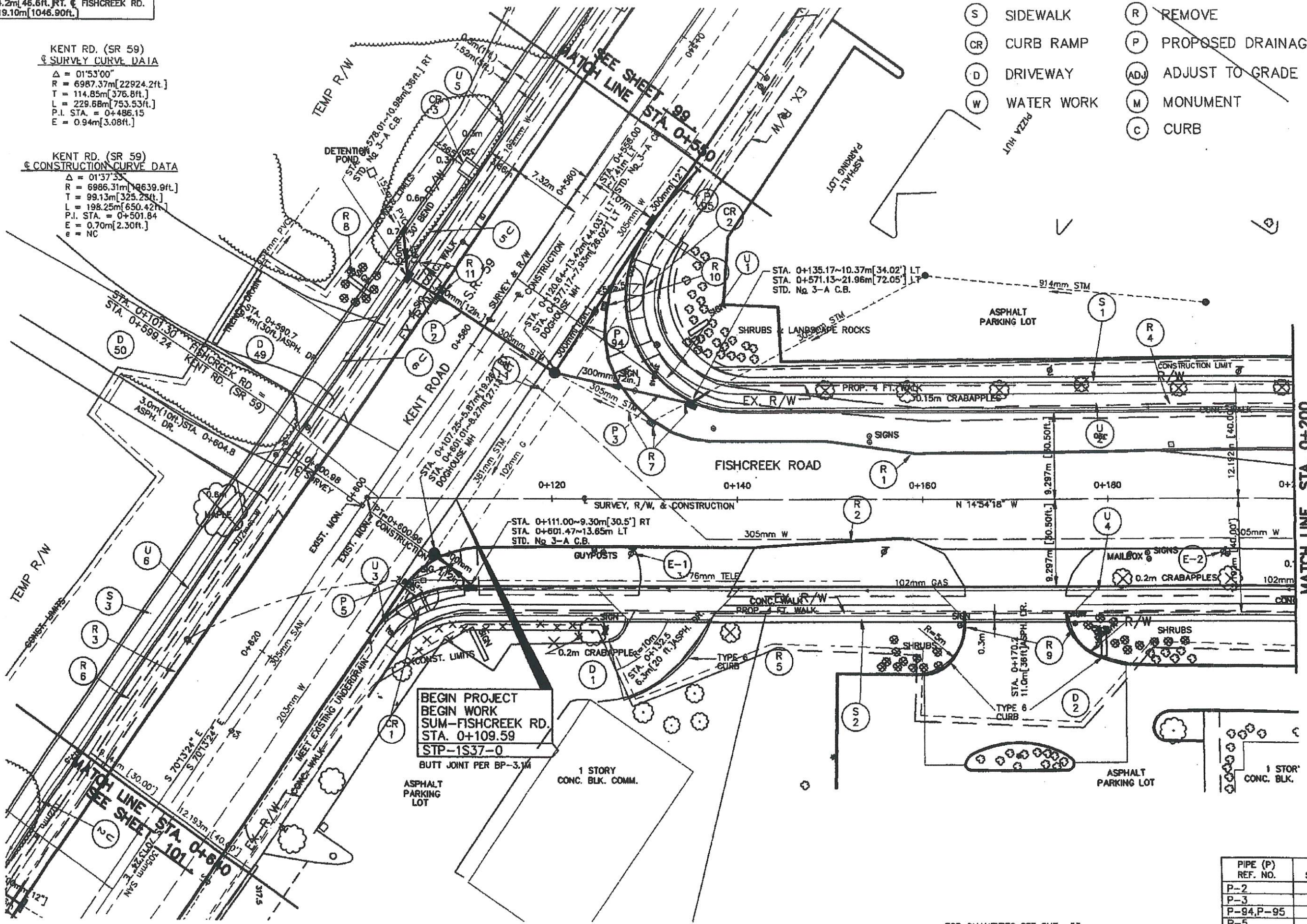

**BEGIN PROJECT
 BEGIN WORK
 SUM-FISHCREEK RD.
 STA. 0+109.59
 STP-1S37-0
 BUTT JOINT PER BP-3.14**

| PIPE (P) REF. NO. | PROFILE SHEET NO. |
|----------------------|----------------------|
| P-2 | 133 |
| P-3 | 162 |
| P-94, P-95 | 102 |
| P-5 | 133 |

FOR QUANTITIES SEE SHT. 53.
 FOR INTERSECTION DETAIL SEE SHT. 154.
 FOR DRIVE DETAILS AND QUANTITIES SEE SHT. 151-153.

DESIGNED BY: XXX CHECKED
 DATE: X/X/XX
 DRAWN BY: CHA REVISIONS BY: CHF
 DATE: 10-28-94 DATE: 5/17/00
 CAD FILE NAME: 7006500-DRSRT1