

ALL PROPOSED TRAFFIC EQUIPMENT WEST OF THE EXISTING ADOLPH STREET RIGHT-OF-WAY ARE WITHIN THE ROUTE 8 RIGHT-OF-WAY LIMITS.

\* SEE SHEET 783 FOR SIGN DETAILS

PULL BOX NO. 1, 24"  
STA. 345+90, 17' LT.

CONTROLLER W/ CONCRETE  
WORK PAD  
STA. 345+93, 26' LT.

SIGNAL SUPPORT NO. 1  
8' FLANGE MOUNT PEDESTAL  
STA. 345+95, 20' LT.

POWER SOURCE  
STA. 346+03, 25' LT.  
TO BE RELOCATED BY OTHERS

PULL BOX NO. 2, 24"  
STA. 346+15, 40' LT.

REMOVE EXISTING  
SIGNAL INSTALLATION

INTERCONNECT  
SEE SHEET 827

PULL BOX NO. 3, 24"  
STA. 93+13, @ RAMP J, 44' LT.

SIGNAL SUPPORT NO. 2 \*  
COMBINATION SIGNAL SUPPORT,  
TYPE TC-12.30 DESIGN 2, 36'  
ARM AND SIGN SUPPORT, TYPE  
TC-12.30, DESIGN 2, 19' ARM  
AND SIGNAL SUPPORT, TYPE  
TC-81.20 DESIGN 11, 39' ARM  
STA. 93+23, @ RAMP J, 26' LT.

@ CONST.

FOUNTAIN ST.

STA. 346+49.44 =  
STA. 51+21.21

STA. 92+73.21 =  
STA. 51+42.81

@ CONST.

RAMP J

L/A R/W  
3.00'  
DEPTH

COMB. SIGNAL SUPPORT NO. 4  
TC-81.20, DESIGN 3, 36' ARM  
STA. 346+11, 47' RT.

PULL BOX NO. 6, 24"  
STA. 346+15, 45' RT.

SIGNAL SUPPORT NO. 3  
8' FLANGE MOUNT PEDESTAL  
STA. 93+09, @ RAMP J, 48' RT.

PULL BOX NO. 4, 24"  
STA. 93+10, @ RAMP J, 31' RT.

PULL BOX NO. 5, 18"  
STA. 93+13, @ RAMP J, 76' RT.

QTY.=2  
TO CROSS  
FOUNTAIN ST  
PUSH BUTTON  
WAIT FOR  
WALK SIGNAL  
R-73A-9  
(9X12)

QTY.=2  
TO CROSS  
PERKINS ST  
PUSH BUTTON  
WAIT FOR  
WALK SIGNAL  
R-73A-9  
(9X12)

PUSHBUTTON SIGNS  
(FOR MOUNTING, SEE TC-85.10)

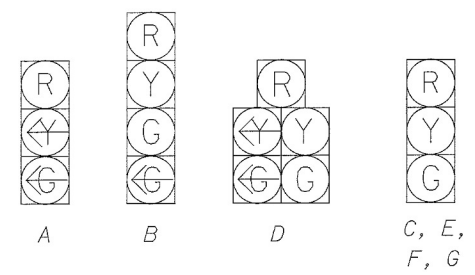

12" LENSES  
SIGNAL HEADS

STYLE D2  
X-X, Z-Z

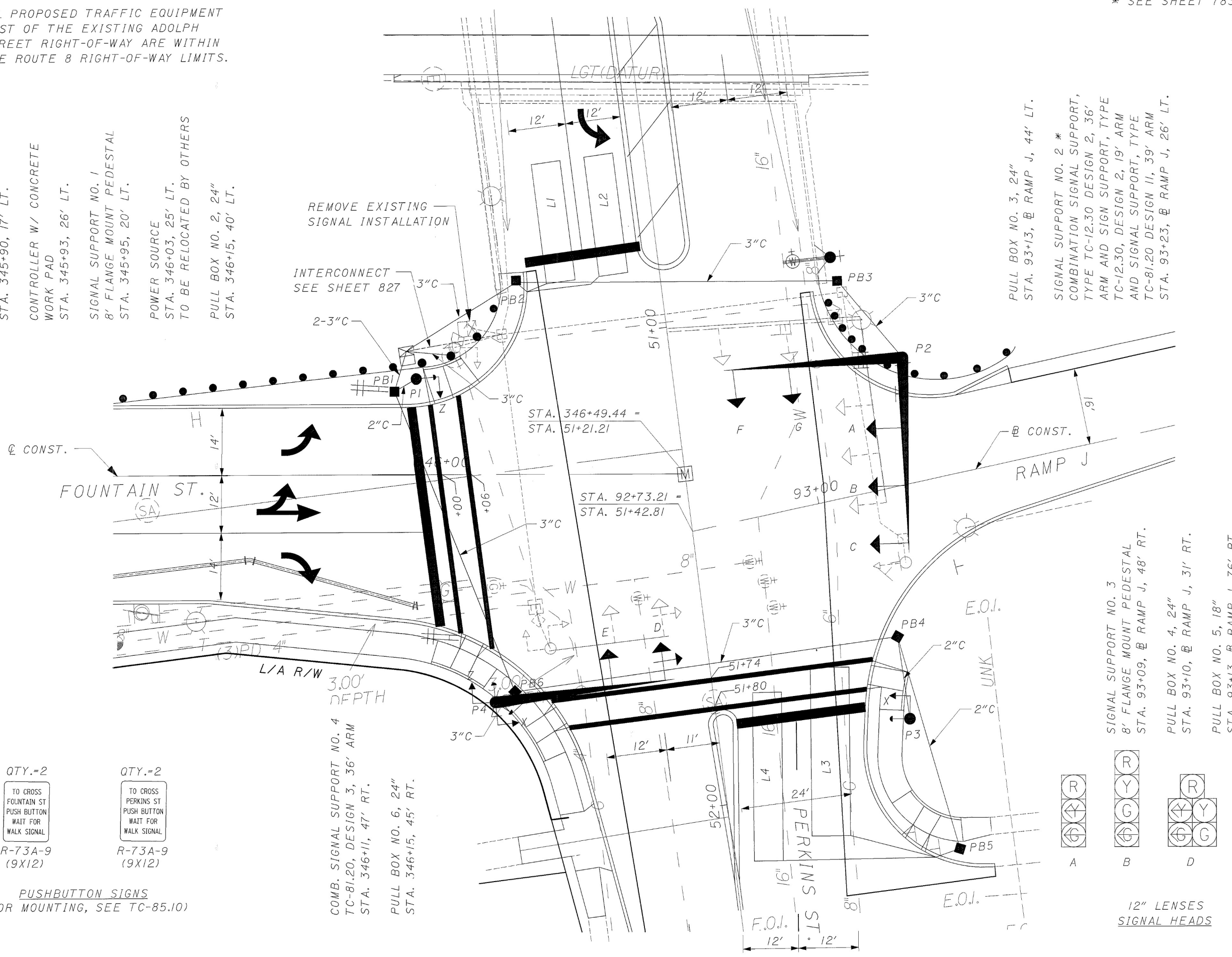

### SIGNAL DISPLAY CHART

SIGNAL HEAD	Ø2			Ø4&Ø7			Ø4&Ø8			FLASH
	R/W	CLEAR	FLASH	R/W	CLEAR	FLASH	R/W	CLEAR	FLASH	
A	⬅	➡	⚡	R	R	R	R	R	R	R
B	⬅	➡	⚡	R	R	R	R	R	R	R
C	G	G	Y	R	R	R	R	R	R	R
D	R	R	R	R	R	R	R	R	R	R
E	R	R	R	G	G	G	G	G	G	Y
F	R	R	R	R	R	R	R	R	R	Y
G	R	R	R	R	R	R	R	R	R	Y
X-X	W	FDW	DW	DW	DW	DW	DW	DW	DW	OUT
Z-Z	DW	DW	DW	DW	DW	DW	DW	DW	DW	OUT

### COORDINATION TIMING

CYCLE/OFFSET	PHASE			DESCRIPTION
	Ø2	Ø4&Ø7	Ø4&Ø8	
80/22	29	26	25	M-F, 9 AM-4 PM & 6 PM-6 AM, SAT. & SUN.
100/76	31	32	19	M-F, 6 AM-9 AM & 4 PM-6 PM

### TRAFFIC CONTROL QUANTITIES

ITEM	EXT.	QTY.	UNITS	DESCRIPTION
625	25402	69	LF	CONDUIT, 2", 713.07
625	25502	80	LF	CONDUIT, 3", 713.07
625	25802	213	LF	CONDUIT, CONCRETE ENCASED, 3"
625	29002	255	LF	TRENCH, 24" DEEP
625	29600	109	LF	TRENCH IN PAVED AREA, TYPE B
625	30700	1	EACH	PULL BOX, 713.08, 18" AS PER PLAN
625	30707	5	EACH	PULL BOX, 713.08, 24" AS PER PLAN
625	32000	10	EACH	GROUND ROD
625	32001	1	EACH	GROUND ROD, AS PER PLAN
SPECIAL	36000	364	LF	PLASTIC CAUTION TAPE
630	79100	1	EACH	SIGN HANGER ASSEMBLY, MAST ARM
630	80102	7	SF	SIGN, FLAT SHEET, TYPE G
632	00302	5	EACH	VEHICULAR SIGNAL HEAD, 3 SECTION 12" LENS, I-WAY, POLYCARBONATE
632	00402	1	EACH	VEHICULAR SIGNAL HEAD, 4 SECTION, 12" LENS, I-WAY, POLYCARBONATE
632	00502	1	EACH	VEHICULAR SIGNAL HEAD, 5-SECTION, 12" LENS, I-WAY, POLYCARBONATE
632	20601	4	EACH	PEDESTRIAN SIGNAL HEAD, TYPE D2, AS PER PLAN
632	25000	7	EACH	COVERING OF VEHICULAR SIGNAL HEAD
632	25010	4	EACH	COVERING OF PEDESTRIAN SIGNAL HEAD
632	26000	4	EACH	PEDESTRIAN PUSHBUTTON
632	26500	4	EACH	DETECTOR LOOP
632	27008	4	EACH	LOOP DETECTOR UNIT, DELAY AND EXTENSION TYPE
632	40700	1304	LF	SIGNAL CABLE, 7 CONDUCTOR, NO. 14 AWG
632	64010	2	EACH	SIGNAL SUPPORT FOUNDATION
632	64020	2	EACH	PEDESTAL FOUNDATION
632	65200	1081	LF	LOOP DETECTOR LEAD-IN CABLE
632	68200	24	LF	POWER CABLE, 2 CONDUCTOR, 6 AWG
632	70001	1	EACH	POWER SERVICE, AS PER PLAN
632	81300	1	EACH	COMBINATION SIGNAL SUPPORT, TYPE TC-81.20, DESIGN 3
632	81700	1	EACH	COMBINATION SIGNAL SUPPORT, MISC.: TYPE TC-12.30, DESIGN 2 AND SIGN SUPPORT, TYPE TC-12.30, DESIGN 2 AND SIGNAL SUPPORT, TYPE TC-81.20, DESIGN II
632	89600	2	EACH	PEDESTAL, 8"
632	90101	1	EACH	REMOVAL OF TRAFFIC SIGNAL INSTALLATION, AS PER PLAN
633	38000	1	EACH	CONTROLLER, ACTUATED, 8 PHASE, SOLID STATE DIGITAL MICROPROCESSOR
633	70001	1.15	CY	CONCRETE FOR CABINET FOUNDATION, AS PER PLAN
633	70500	9	SF	CONTROLLER WORK PAD
633	99000	1	EACH	ALTERNATE BID: CONTROLLER MISC.; ECONOLITE CONTROLLER

### CONTROLLER TIMING DATA

CYCLE LENGTH	80			100		
	Ø2	Ø4&Ø7	Ø4&Ø8	Ø2	Ø4&Ø7	Ø4&Ø8
MOVEMENT	NB	EB/EBL	EB/WB	NB	EB/EBL	EB/WB
GREEN TIME	23	20	19	31	32	19
YELLOW TIME	3.0	3.0	3.0	3.0	3.0	3.0
ALL RED	3.0	3.0	3.0	3.0	3.0	3.0
MINIMUM INITIAL	10	10	7	10	10	7
VEHICULAR EXTENSION	-	3.0	3.0	-	3	3
WALK	7	-	7	7	-	7
FLASH DON'T WALK	15	-	12	15	-	12
MEMORY	OFF	OFF	OFF	OFF	OFF	OFF
RECALL	MIN	NONE	NONE	MIN	NONE	NONE

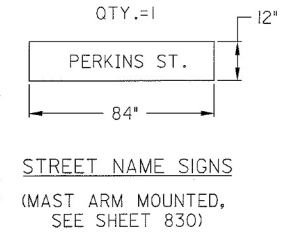
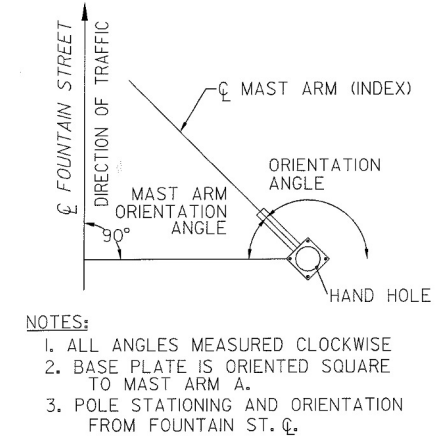
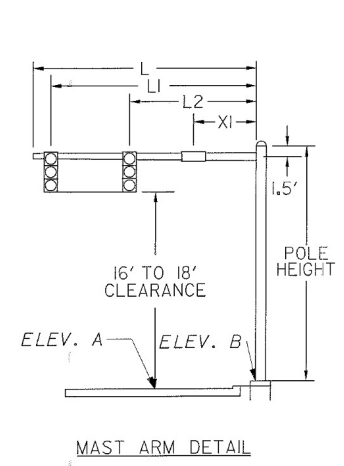
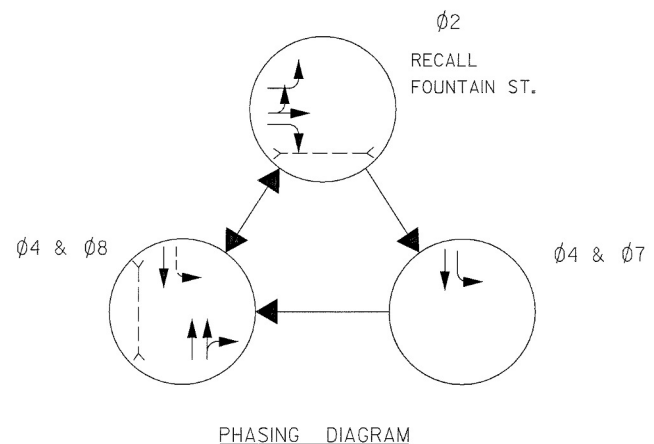

POLE NO.	DESIGN NO.	POLE HEIGHT (FT)	SIGNAL SUPPORT		FOUNDATION							ELEVATION		MAST ARM ANGLE (A)	MAST ARM ANGLE (B)	ORIENTATION ANGLES FROM MAST ARM		
			STATION	OFFSET	L	LI	L2	L3	L4	XI	A	B	PEDESTRIAN SIGNALS			PEDESTRIAN PUSH BUTTONS	HANDHOLE	
			FT.	FT.	FT.	FT.	FT.	FT.	FT.	FT.	FT.	FT.						
1	PED	8	345+95	20' LT.	36	34	23									270	270	180
2	4	24	+93+23	26' LT.	39	37	25	13				1053.5	1052.6	10	90			
3	PED	8	+93+09	48' RT.	36	34	23									0	270	180
4	2	25	346+11	47' RT.	36	34	23					1052.6	1052.5	80	90/270	0/270	180	

+ B RAMP J

### LOOP DETECTORS

DESIGNATION	SIZE	# OF TURNS	PULSE OR PRESENCE	DELAY	ASSOCIATED CONTROLLER PHASE	STATION 1st FRONT CORNER	STATION 2nd FRONT CORNER
L-1	6 x 25	2	PRESENCE	0	4	346+22, 40' LT.	346+28, 40' LT.
L-2	6 x 25	2	PRESENCE	0	7	346+33, 41' LT.	346+39, 42' LT.
L-3	8 x 35	2	PRESENCE	7	8	+ 92+78, 35' RT.	+ 92+99, 35' RT.
L-4	6 x 35	2	PRESENCE	0	8	+ 92+91, 33' RT.	+ 92+84, 37' RT.
SL-32*	6 x 6	3	PRESENCE	0	-	343+48, 14' LT	343+56, 14' LT
SL-33*	6 x 10	3	PRESENCE	0	-	343+51, 0' RT	343+51, 10' RT
SL-34*	6 x 10	3	PRESENCE	0	-	+ 93+64, 0' LT	+ 93+64, 10' LT

+ B RAMP J

\*SL DENOTES A SYSTEM LOOP DETECTOR. ALL SYSTEM LOOP DETECTOR QUANTITIES ARE SHOWN ON SHEET 827.

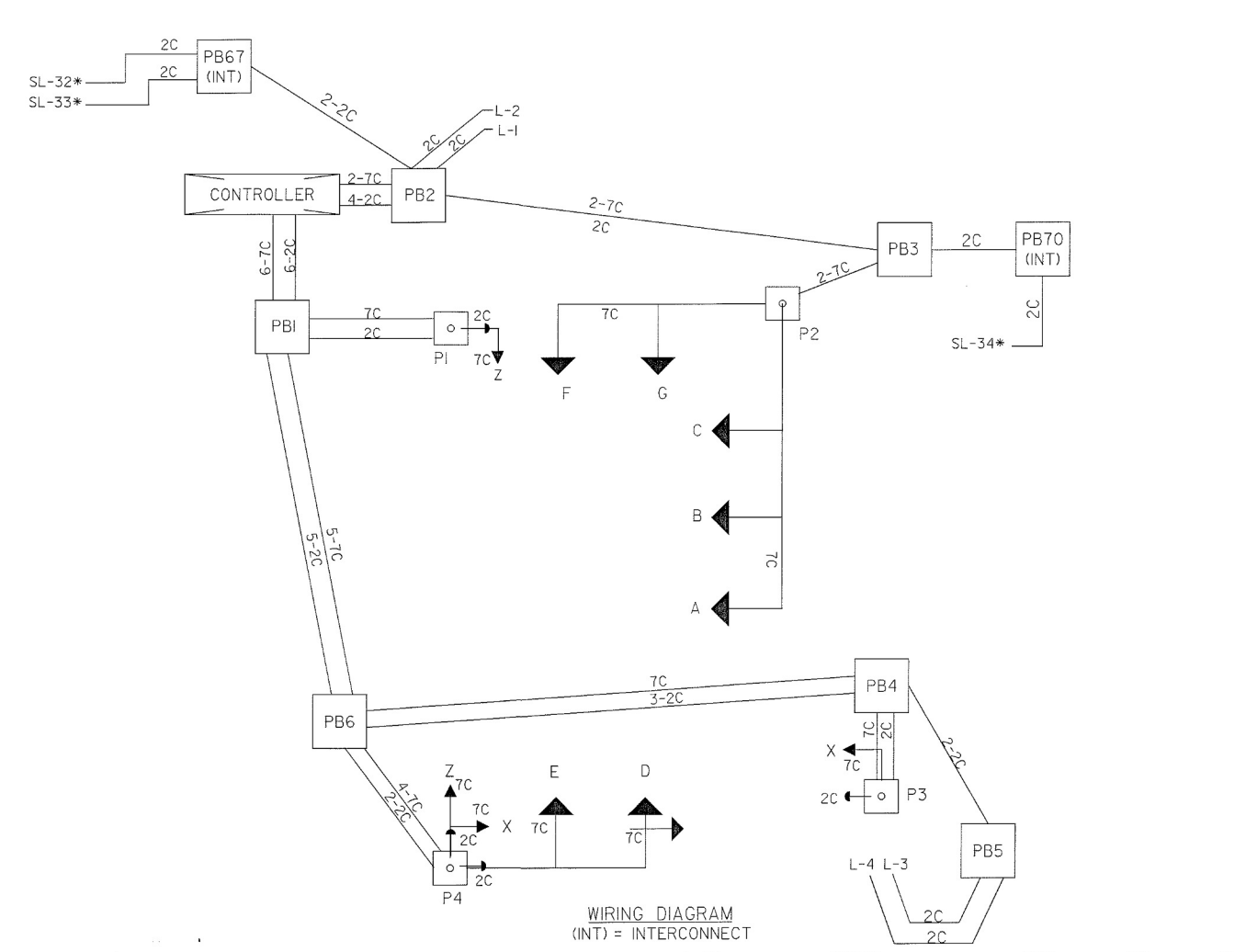

CALCULATED  
CRP

CHECKED  
TS

TRAFFIC SIGNAL PLAN DETAILS  
FOUNTAIN ST. AND PERKINS ST.

SUM - 8 - 0.63

809  
1088

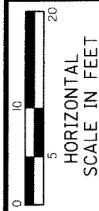

**TRAFFIC SIGNAL PLAN  
 GOODKIRK ST. AND PERKINS ST.**

**SUM - 8 - 0.63**

ALL PROPOSED TRAFFIC EQUIPMENT EAST OF THE EXISTING GOODKIRK STREET RIGHT-OF-WAY ARE WITHIN THE ROUTE 8 RIGHT-OF-WAY LIMITS.

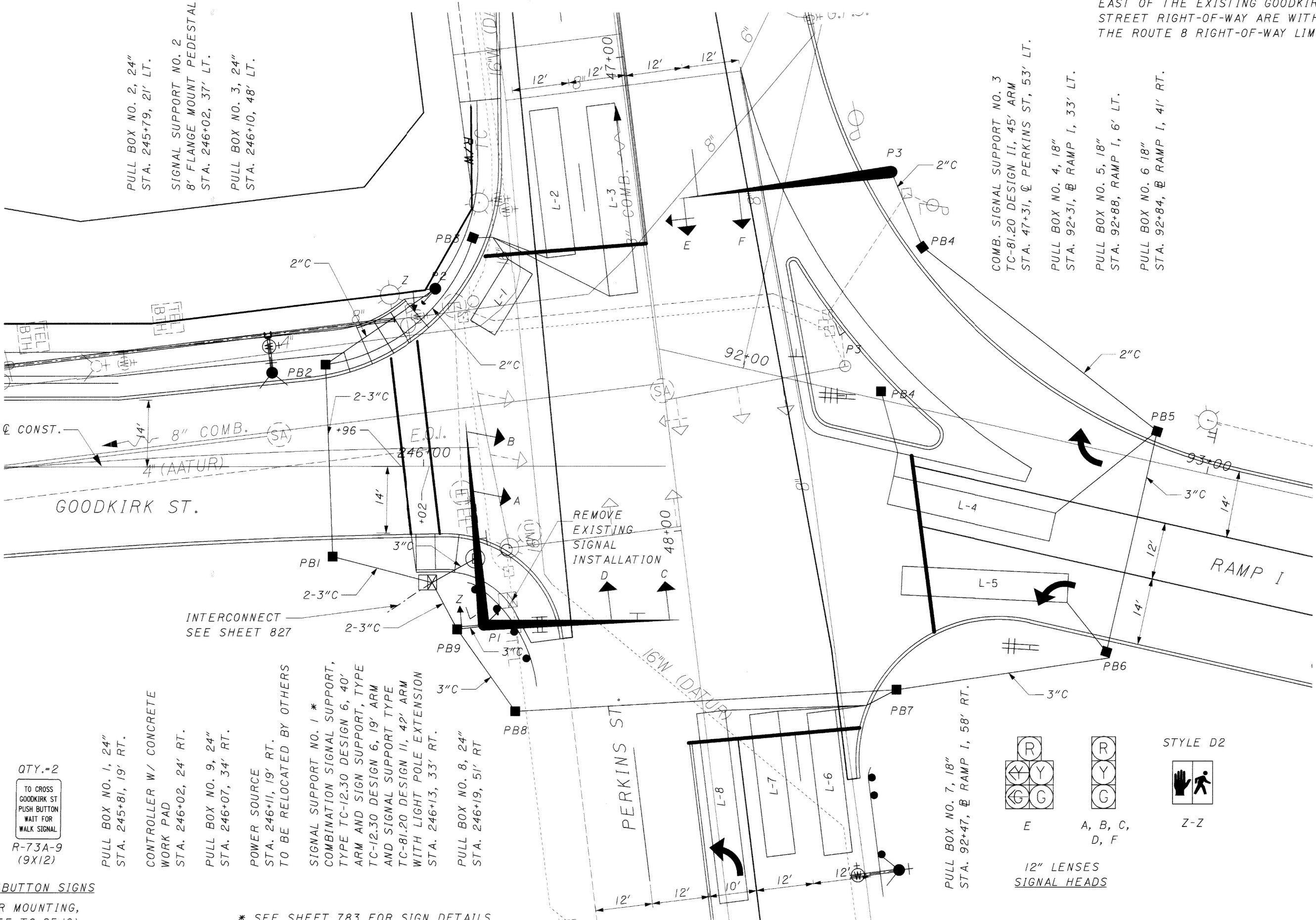

PULL BOX NO. 2, 24"  
 STA. 245+79, 21' LT.  
 SIGNAL SUPPORT NO. 2  
 8' FLANGE MOUNT PEDESTAL  
 STA. 246+02, 37' LT.  
 PULL BOX NO. 3, 24"  
 STA. 246+10, 48' LT.

COMB. SIGNAL SUPPORT NO. 3  
 TC-81.20 DESIGN II, 45' ARM  
 STA. 47+31, @ PERKINS ST, 53' LT.  
 PULL BOX NO. 4, 18"  
 STA. 92+31, @ RAMP I, 33' LT.  
 PULL BOX NO. 5, 18"  
 STA. 92+88, RAMP I, 6' LT.  
 PULL BOX NO. 6 18"  
 STA. 92+84, @ RAMP I, 41' RT.

QTY.=2  
 TO CROSS  
 GOODKIRK ST  
 PUSH BUTTON  
 WAIT FOR  
 WALK SIGNAL  
 R-73A-9  
 (9X12)

PULL BOX NO. 1, 24"  
 STA. 245+81, 19' RT.  
 CONTROLLER W/ CONCRETE  
 WORK PAD  
 STA. 246+02, 24' RT.  
 PULL BOX NO. 9, 24"  
 STA. 246+07, 34' RT.

POWER SOURCE  
 STA. 246+11, 19' RT.  
 TO BE RELOCATED BY OTHERS  
 SIGNAL SUPPORT NO. 1 \*  
 COMBINATION SIGNAL SUPPORT,  
 TYPE TC-12.30 DESIGN 6, 40'  
 ARM AND SIGN SUPPORT, TYPE  
 TC-12.30 DESIGN 6, 19' ARM  
 AND SIGNAL SUPPORT TYPE  
 TC-81.20 DESIGN II, 42' ARM  
 WITH LIGHT POLE EXTENSION  
 STA. 246+13, 33' RT.

PULL BOX NO. 8, 24"  
 STA. 246+19, 51' RT

**PUSHBUTTON SIGNS**  
 (FOR MOUNTING,  
 SEE TC-85.10)

\* SEE SHEET 783 FOR SIGN DETAILS

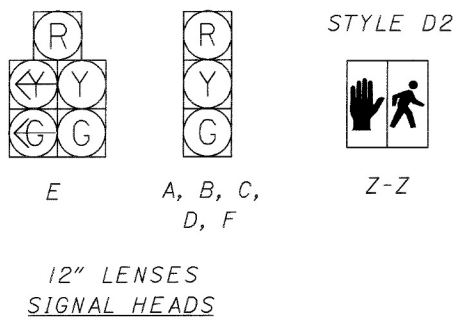

SIGNAL DISPLAY CHART															
SIGNAL HEAD	Ø3 & Ø8				Ø4 & Ø8				Ø6				FLASH	DWELL	
	R/W	CLEAR	R/W	CLEAR	R/W	CLEAR	R/W	CLEAR	R/W	CLEAR	R/W	CLEAR			
A	R	R	R	R	R	R	R	R	G	G	Y	R	R	-	-
B	R	R	R	R	R	R	R	R	G	G	Y	R	R	-	-
C	R	R	R	R	G	G	Y	R	R	R	R	R	Y	-	-
D	R	R	R	R	G	G	Y	R	R	R	R	R	Y	-	-
E	G/Y	G/Y	G/Y	G/Y	G	G	Y	R	R	R	R	R	Y	-	-
F	G	G	G	G	G	G	Y	R	R	R	R	R	Y	-	-
Z-Z	DW	DW	DW	DW	W	FDW	DW	DW	DW	DW	DW	DW	OUT	-	-

CONTROLLER TIMING DATA							
CYCLE LENGTH	80				100		
	Ø3&Ø8	Ø4&Ø8	Ø6	Ø3&Ø8	Ø4&Ø8	Ø6	
MOVEMENT	WB	EB/WB	SB	WB	EB/WB	SB	
GREEN TIME	5	46	11	7	64	11	
YELLOW TIME	3.0	3.0	3.0	3.0	3.0	3.0	
ALL RED	3.0	3.0	3.0	3.0	3.0	3.0	
MINIMUM INITIAL	5.0	10.0	10.0	5.0	10.0	10.0	
VEHICULAR EXTENSION	3.0	3.0	3.0	X.X	X.X	X.X	
WALK	-	7	-	-	7	-	
FLASH DON'T WALK	-	9	-	-	9	-	
MEMORY	OFF	OFF	OFF	OFF	OFF	OFF	
RECALL	NONE	NONE	MIN	NONE	NONE	MIN	

COORDINATION TIMING				
CYCLE/OFFSET	PHASE			DESCRIPTION
	Ø3&Ø8	Ø4&Ø8	Ø6	
80/19	11	52	17	M-F, 9 AM-4 PM & 6 PM-6 AM, SAT. & SUN.
100/59	13	70	17	M-F, 6 AM-9 AM & 4 PM-6 PM

TRAFFIC CONTROL QUANTITIES				
ITEM	EXT.	QTY.	UNITS	DESCRIPTION
625	25402	85	LF	CONDUIT, 2", 713.07
625	25502	103	LF	CONDUIT, 3", 713.07
625	25802	223	LF	CONDUIT, CONCRETE ENCASED, 3"
625	29002	313	LF	TRENCH, 24" DEEP
625	29500	0	LF	TRENCH IN PAVED AREA, TYPE A
625	29600	57	LF	TRENCH IN PAVED AREA, TYPE B
625	30700	2	EACH	PULL BOX, 713.08, 18" AS PER PLAN
625	30707	5	EACH	PULL BOX, 713.08, 24" AS PER PLAN
625	32000	10	EACH	GROUND ROD
625	32001	1	EACH	GROUND ROD, AS PER PLAN
SPECIAL	36000	338	LF	PLASTIC CAUTION TAPE
630	79100	3	EACH	SIGN HANGER ASSEMBLY, MAST ARM
630	80102	22	SF	SIGN, FLAT SHEET, TYPE G
632	00302	5	EACH	VEHICULAR SIGNAL HEAD, 3 SECTION 12" LENS, 1-WAY, POLYCARBONATE
632	00502	1	EACH	VEHICULAR SIGNAL HEAD, 5-SECTION, 12" LENS, 1-WAY, POLYCARBONATE
632	20601	2	EACH	PEDESTRIAN SIGNAL HEAD, TYPE D2, AS PER PLAN
632	25000	6	EACH	COVERING OF VEHICULAR SIGNAL HEAD
632	25010	2	EACH	COVERING OF PEDESTRIAN SIGNAL HEAD
632	26000	2	EACH	PEDESTRIAN PUSHBUTTON
632	26500	8	EACH	DETECTOR LOOP
632	27008	8	EACH	LOOP DETECTOR UNIT, DELAY AND EXTENSION TYPE
632	40700	992	LF	SIGNAL CABLE, 7 CONDUCTOR, NO. 14 AWG
632	64010	2	EACH	SIGNAL SUPPORT FOUNDATION
632	64020	1	EACH	PEDESTAL FOUNDATION
632	65200	1397	LF	LOOP DETECTOR LEAD-IN CABLE
632	68200	25	LF	POWER CABLE, 2 CONDUCTOR, 6 AWG
632	70001	1	EACH	POWER SERVICE, AS PER PLAN
632	81300	1	EACH	COMBINATION SIGNAL SUPPORT, TYPE TC-81.20, DESIGN 3
632	81700	1	EACH	COMBINATION SIGNAL SUPPORT, MISC.: TYPE TC-12.30, DESIGN 6 AND SIGN SUPPORT, TYPE TC-12.30, DESIGN 6 AND SIGNAL SUPPORT, TYPE TC-81.20, DESIGN 11, WITH LIGHT POLE EXTENSION
632	89600	1	EACH	PEDESTAL, 8'
632	90101	1	EACH	REMOVAL OF TRAFFIC SIGNAL INSTALLATION, AS PER PLAN
633	38000	1	EACH	CONTROLLER, ACTUATED, 8 PHASE, SOLID STATE DIGITAL MICROPROCESSOR
633	70001	1.15	CY	CONCRETE FOR CABINET FOUNDATION, AS PER PLAN
633	70500	9	SF	CONTROLLER WORK PAD
633	99000	1	EACH	ALTERNATE BID: CONTROLLER MISC.: ECONOLITE CONTROLLER

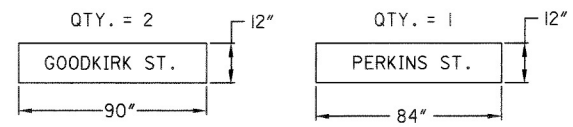
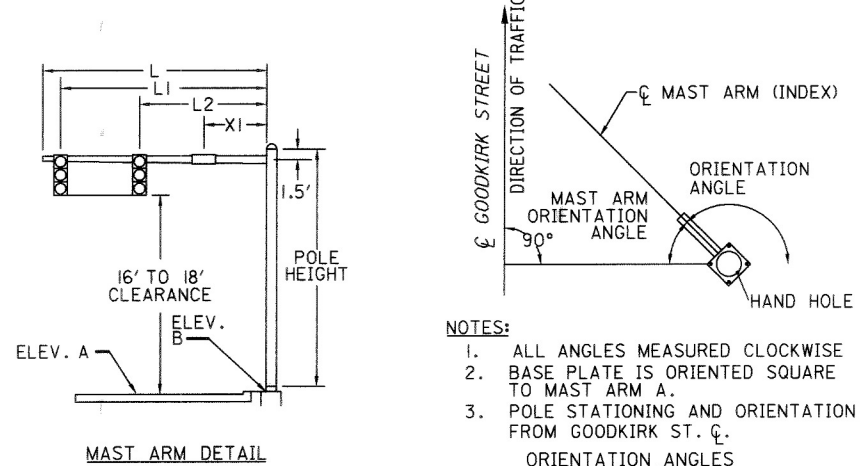
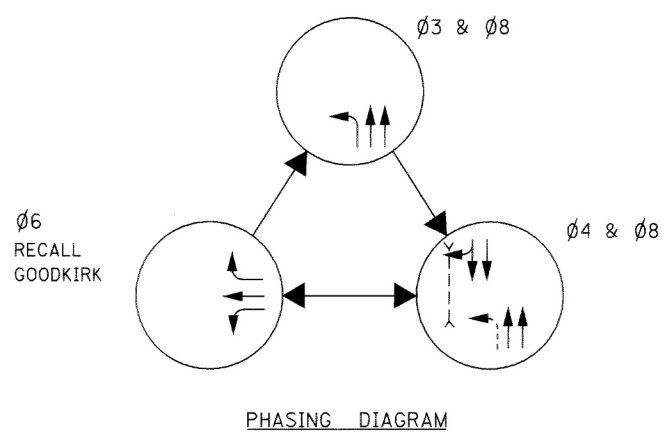

POLE NO.	DESIGN NO.	POLE HEIGHT (FT)	SIGNAL SUPPORT							ELEVATION		MAST ARM ANGLE (A)	MAST ARM ANGLE (B)	ORIENTATION ANGLES FROM MAST ARM			
			FOUNDATION		L	L1	L2	L3	L4	X1	A			B	PEDESTRIAN SIGNALS	PEDESTRIAN PUSH BUTTONS	HANDHOLE
			STATION	OFFSET													
1	7	25	246+13	33' RT.	42	40	27			17	1050.8	1051.3	355	94	270	45	180
2	PED	8	246+02	37' LT.	40	38	26			31	1052.3	1051.3			85	42	
3	3	25	+92+18	9' LT.	30	28	16			8	1051.0	1050.2	76				180

LOOP DETECTORS							
DESIGNATION	SIZE	# OF TURNS	PULSE OR PRESENCE	DELAY	ASSOCIATED CONTROLLER PHASE	STATION 1st FRONT CORNER	STATION 2nd FRONT CORNER
L-1	6 x 15	2	PRESENCE	7	4	246+10, 31' LT.	246+15, 27' LT.
L-2	6 x 31	2	PRESENCE	7	4	246+26, 44' LT.	246+32, 44' LT.
L-3	6 x 40	2	PRESENCE	0	4	246+39, 36' LT.	246+45, 36' LT.
L-4	6 x 35	2	PRESENCE	0	6	+92+36, 15' RT.	+92+36, 21' RT.
L-5	6 x 35	2	PRESENCE	0	6	+92+42, 33' RT.	+92+43, 39' RT.
L-6	6 x 30	2	PRESENCE	0	8	+92+29, 67' RT.	+92+35, 65' RT.
L-7	6 x 30	2	PRESENCE	0	8	+92+18, 70' RT.	+92+23, 68' RT.
L-8	6 x 40	2	PRESENCE	0	3	+92+07, 73' RT.	+92+12, 71' RT.
SL-23*	6 x 6	3	PRESENCE	0	-	244+72, 7' LT.	244+80, 7' LT.
SL-24*	6 x 6	3	PRESENCE	0	-	244+72, 8' RT.	244+80, 6' RT.
SL-25*	6 x 6	3	PRESENCE	0	-	Δ 46+59, 18' RT.	Δ 46+67, 18' RT.
SL-26*	6 x 6	3	PRESENCE	0	-	Δ 46+59, 6' RT.	Δ 46+67, 6' RT.
SL-27*	6 x 6	3	PRESENCE	0	-	Δ 46+59, 7' LT.	Δ 46+67, 7' LT.
SL-28*	6 x 6	3	PRESENCE	0	-	Δ 46+59, 19' LT.	Δ 46+67, 19' LT.
SL-29*	6 x 6	3	PRESENCE	0	-	+93+69, 4' RT.	+93+78, 4' RT.
SL-30*	6 x 6	3	PRESENCE	0	-	+93+69, 18' RT.	+93+78, 18' RT.
SL-31*	6 x 6	3	PRESENCE	0	-	+93+69, 31' RT.	+93+78, 31' RT.

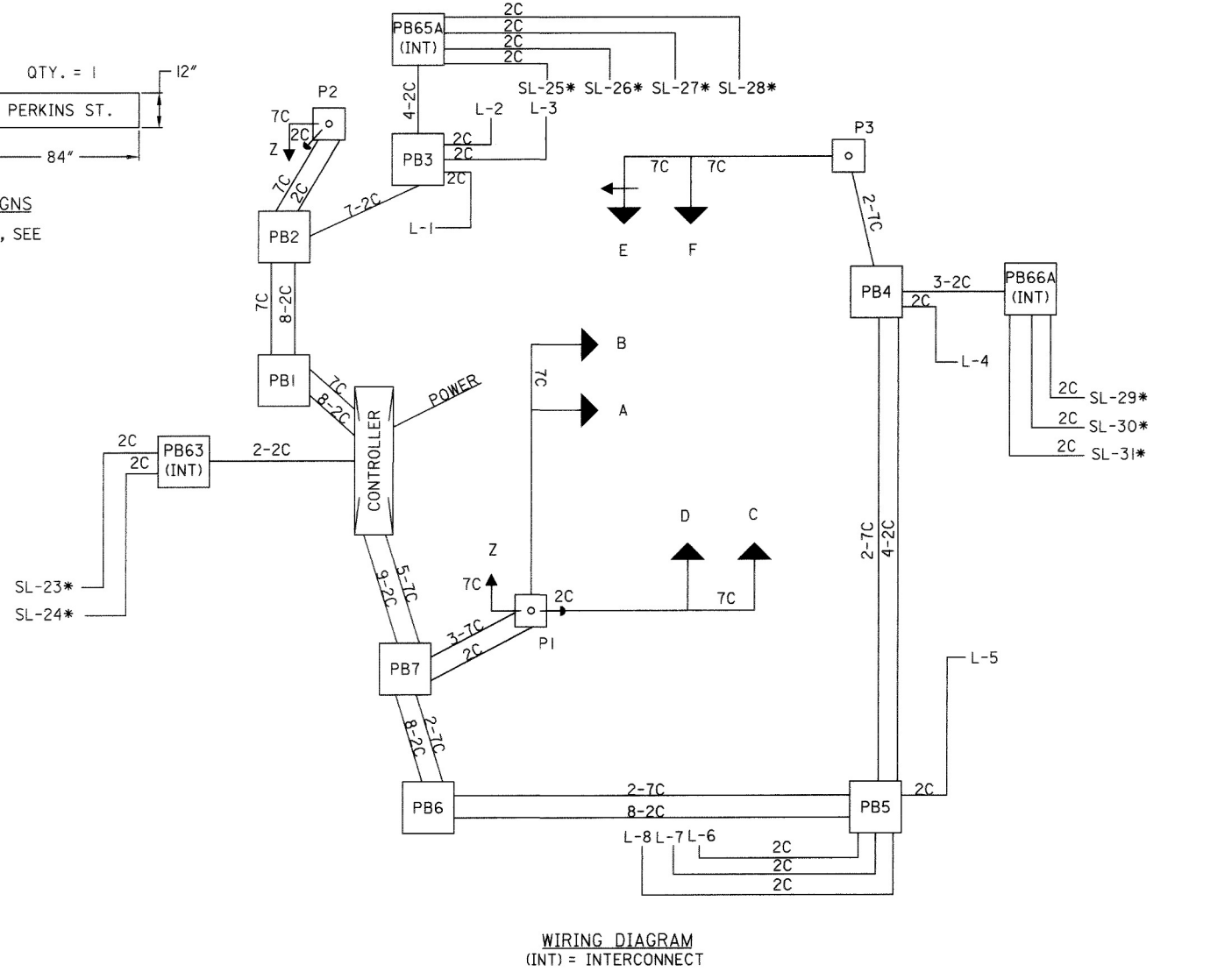

CALCULATED CRP  
 CHECKED TS  
**TRAFFIC SIGNAL PLAN DETAILS**  
**GOODKIRK ST. AND PERKINS ST.**  
**SUM - 8 - 0.63**  
 821  
 1088

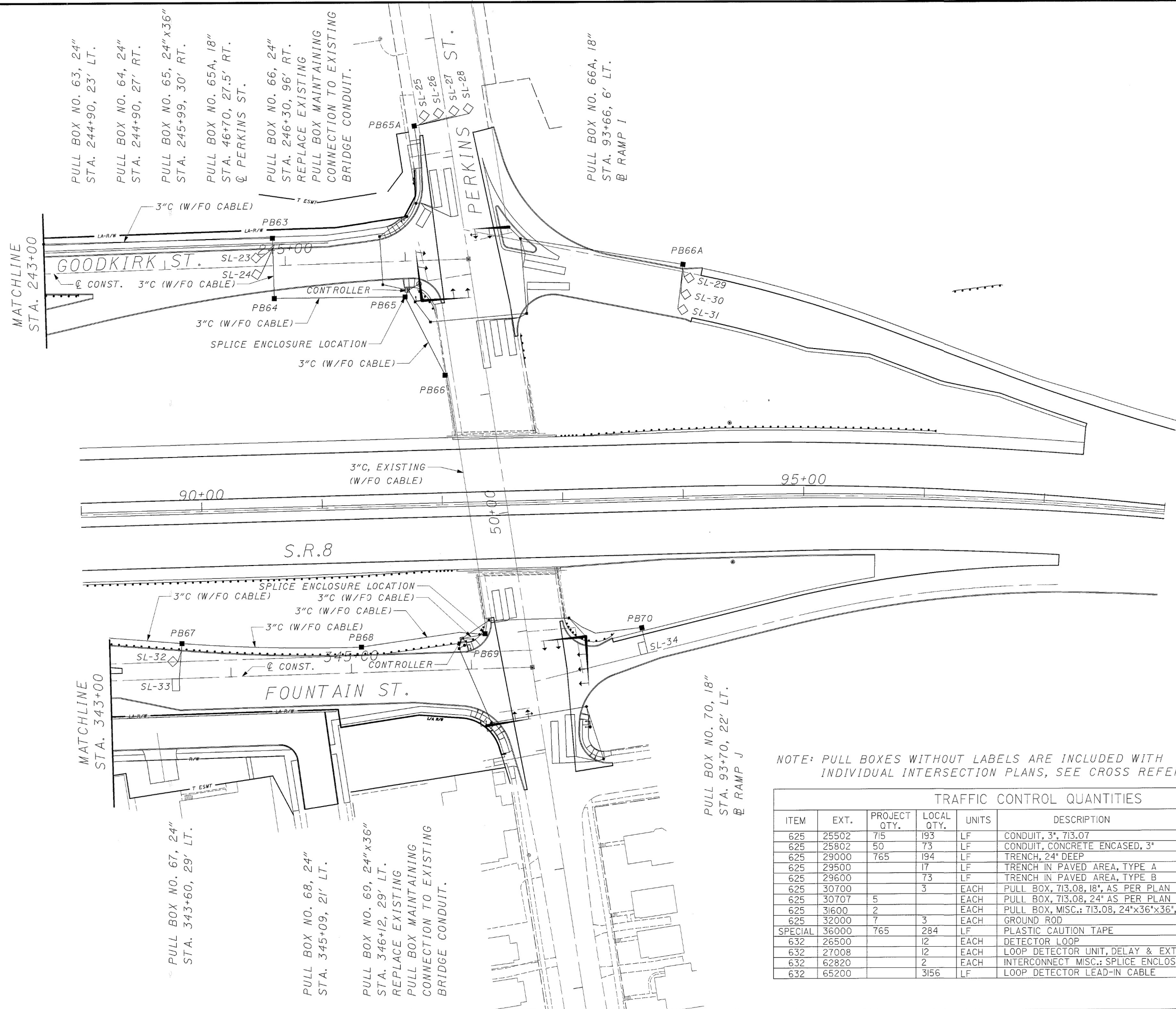

PULL BOX NO. 63, 24"  
STA. 244+90, 23' LT.

PULL BOX NO. 64, 24"  
STA. 244+90, 27' RT.

PULL BOX NO. 65, 24"x36"  
STA. 245+99, 30' RT.

PULL BOX NO. 65A, 18"  
STA. 46+70, 27.5' RT.  
PERKINS ST.

PULL BOX NO. 66, 24"  
STA. 246+30, 96' RT.  
REPLACE EXISTING  
PULL BOX MAINTAINING  
CONNECTION TO EXISTING  
BRIDGE CONDUIT.

PULL BOX NO. 66A, 18"  
STA. 93+66, 6' LT.  
RAMP I

PULL BOX NO. 67, 24"  
STA. 343+60, 29' LT.

PULL BOX NO. 68, 24"  
STA. 345+09, 21' LT.

PULL BOX NO. 69, 24"x36"  
STA. 346+12, 29' LT.  
REPLACE EXISTING  
PULL BOX MAINTAINING  
CONNECTION TO EXISTING  
BRIDGE CONDUIT.

PULL BOX NO. 70, 18"  
STA. 93+70, 22' LT.  
RAMP J

CROSS REFERENCES	
SHEET NO.	DESCRIPTION
808-809, 820-821	TRAFFIC SIGNAL PLANS
827A	INTERCONNECT PLAN

NOTE: PULL BOXES WITHOUT LABELS ARE INCLUDED WITH INDIVIDUAL INTERSECTION PLANS, SEE CROSS REFERENCES.

TRAFFIC CONTROL QUANTITIES					
ITEM	EXT.	PROJECT QTY.	LOCAL QTY.	UNITS	DESCRIPTION
625	25502	715	193	LF	CONDUIT, 3", 713.07
625	25802	50	73	LF	CONDUIT, CONCRETE ENCASED, 3"
625	29000	765	194	LF	TRENCH, 24" DEEP
625	29500		17	LF	TRENCH IN PAVED AREA, TYPE A
625	29600		73	LF	TRENCH IN PAVED AREA, TYPE B
625	30700		3	EACH	PULL BOX, 713.08, 18", AS PER PLAN
625	30707	5		EACH	PULL BOX, 713.08, 24" AS PER PLAN
625	31600	2		EACH	PULL BOX, MISC.: 713.08, 24"x36"x36", AS PER PLAN
625	32000	7	3	EACH	GROUND ROD
SPECIAL	36000	765	284	LF	PLASTIC CAUTION TAPE
632	26500		12	EACH	DETECTOR LOOP
632	27008		12	EACH	LOOP DETECTOR UNIT, DELAY & EXTENSION TYPE
632	62820		2	EACH	INTERCONNECT MISC.: SPLICE ENCLOSURE, AS PER PLAN
632	65200		3156	LF	LOOP DETECTOR LEAD-IN CABLE



CALCULATED  
CRP  
CHECKED  
HJC

**TRAFFIC SIGNAL  
INTERCONNECT PLAN**

**SUM - 8 - 0.63**

# FIBER CABLE ROUTING

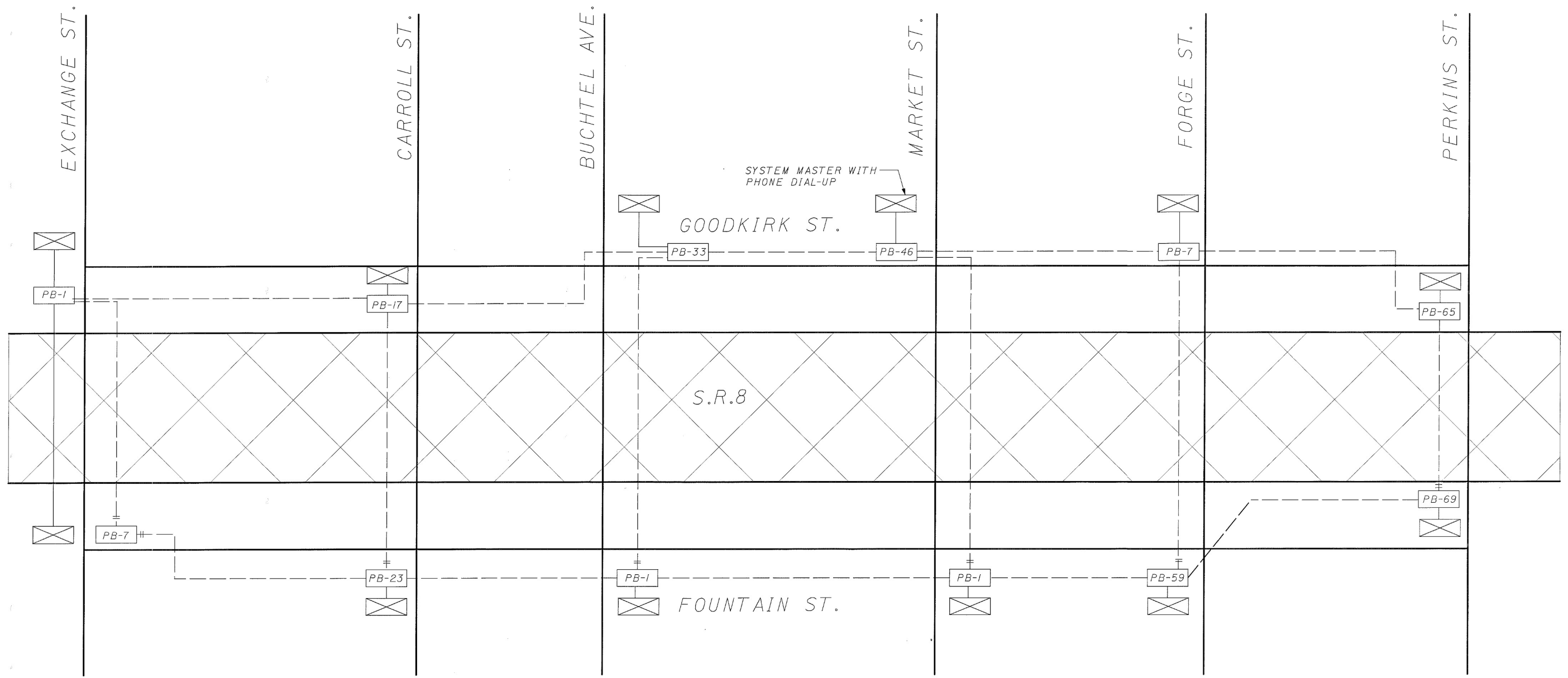

**LEGEND**

- = CONTROLLER CABINET
- PB-# = PULL BOX W/SPLICE ENCLOSURE AND 50 FT. OF COILED FIBER CABLE.
- = FIBER CABLE INTO PULL BOX AND PROPERLY TERMINATED FOR FUTURE USE/EMERGENCY
- = FIBER OPTIC TRUNK CABLE
- = FIBER OPTIC DROP CABLE

**TRAFFIC CONTROL QUANTITIES**

ITEM	EXT.	LOCAL QTY.	UNITS	DESCRIPTION
632	62810	1108	LF	INTERCONNECT CABLE, MISC.: DROP CABLE, 6 FIBER-6 SM, AS PER PLAN
632	62810	13723	LF	INTERCONNECT CABLE, MISC.: FIBER OPTIC TRUNK CABLE, 48 FIBER-48 SM, AS PER PLAN
632	62820	48	EACH	INTERCONNECT MISC.: OPTICAL SPLICING, AS PER PLAN
632	62820	12	EACH	INTERCONNECT MISC.: FIBER OPTIC MODEM, SM, AS PER PLAN
632	62820	12	EACH	INTERCONNECT MISC.: FIBER OPTIC DROP KIT, AS PER PLAN
632	62820	12	EACH	INTERCONNECT MISC.: FIBER OPTIC FAN-OUT KIT, 6 FIBER, AS PER PLAN
632	62820	48	EACH	INTERCONNECT MISC.: FIBER OPTIC SPLICE EQUIPMENT, FIBER OPTIC CONNECTOR, SM, AS PER PLAN
632	62820	12	EACH	INTERCONNECT MISC.: SPLICE TRAY, AS PER PLAN
632	62820	12	EACH	INTERCONNECT MISC.: WALL MOUNT INTERCONNECT CENTER, AS PER PLAN
632	62830	LUMP	LUMP	INTERCONNECT MISC.: FIBER OPTIC CABLE TESTING, OTDR, AS PER PLAN

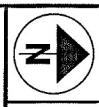

NOT TO SCALE

CALCULATED  
CRP  
CHECKED  
SJ

**TRAFFIC SIGNAL  
INTERCONNECT PLAN**

**SUM-8-0.63**

827A  
1088