

# Specification Sheet

**lumenbeam**

**LBX**  
WHITE & STATIC COLORS

Project Name \_\_\_\_\_ Qty \_\_\_\_\_

Type \_\_\_\_\_ Catalog / Part Number \_\_\_\_\_

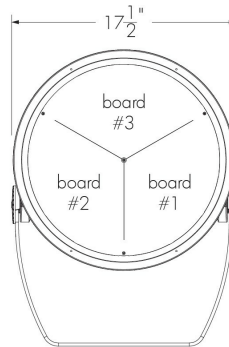

Front view

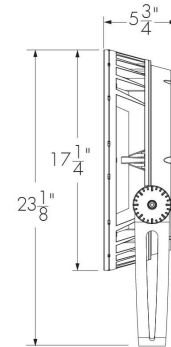

Side view

## Photometric Summary

4000K, HO	Delivered output (lm)	Intensity (peak cd)
XN	14,193	1,169,800
VN	10,447	656,461
NS	10,251*	353,555*
NF	10,592*	63,959*
FL	10,689*	27,663*
WFL	9,997*	9,456*

Photometric performance is measured in compliance with IESNA LM-79-08.  
\*Estimated. Consult website for the latest IES and LDT files.

## Optics

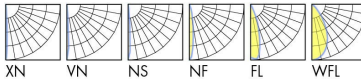

## Control

ON/OFF    0-10V    DALI



## Rating



## Description

The Lumenbeam LBX is a high-performance, 140W or 205W luminaire for lighting multi-story facades and tall structures. Noted for its slim form factor and long L70 lifetime, the luminaire can be configured with numerous options including two outputs RO (140W) and HO (205W); optics for flood or accent lighting; a choice of color temperatures and colors; various mounting options, accessories, spread lenses and controls.

## Features

<b>Color and Color Temperature</b>	2200K, 2700K, 3000K, 3500K, 4000K, 5700K, Red, Green, Blue
<b>Optics (nominal distribution)</b>	4°, 6°, 10°, 20°, 40°, 60°
<b>Optical Option</b>	Linear spread lens horizontal distribution, Linear spread lens vertical distribution
<b>Options</b>	Short Yoke, 3G ANSI C136.31 Vibration Rating for bridge applications, Corrosion-resistant coating for hostile environments
<b>Power Consumption</b>	140 W (RO version), 205 W (HO version)
<b>Warranty</b>	5-year limited warranty

**lumenpulse™**

1220 Marie-Victorin Blvd., Longueuil, QC J4G 2H9 CA T 1.877.937.3003 | 514.937.3003 F 514.937.6289  
info@lumenpulse.com www.lumenpulsegroup.com

Lumenpulse Group Inc. reserves the right to make changes to this product at any time without prior notice and such modification shall be effective immediately  
2017.11.28 copyright © 2017 Lumenpulse Group Inc.  
MG - R38

Project: ODOT SUM-8-1.75

Date: 10/07/2022

Type: F1A,B,C,D,F

HLB Project #:18173

Submittal: 100% Package

APPENDIX: LUMINAIRE CATALOGUE CUTS Note: This document is for information only. Refer to specifications for all catalog numbers, etc.

Horton Lees Brogden Lighting Design | 38 E 32nd St 11th Floor New York NY 10016 | P: 212 674 5580 | F: 212 254 2712 | www.HLBlighting.com

**Performance**

<b>Delivered Output</b>	10,361 lm (4000K, XN optic, RO version), 14,193 lm (4000K, XN optic, HO version)
<b>Delivered Intensity</b>	853,954 cd at nadir (4000K, XN optic, RO version), 1,169,800 cd at nadir (4000K, XN optic, HO version)
<b>Illuminance at Distance</b>	Minimum 1 fc at 924 ft distance (4000K, XN optic, RO version), Minimum 1 fc at 1082 ft distance (4000K, XN optic, HO version)
<b>Color Consistency</b>	2 SDCM
<b>Color Rendering</b>	CRI 80+
<b>Lumen Maintenance</b>	L70 120,000 hrs (Ta 25 °C)

**Physical**

<b>Housing Material</b>	Low copper content high pressure die-cast aluminum
<b>Yoke Material</b>	Steel (standard yoke included)
<b>Lens Material</b>	Clear tempered glass
<b>Hardware Material</b>	Stainless steel
<b>Gasket Material</b>	Silicone
<b>Surface Finish</b>	Electrostatically applied polyester powder coat
<b>Weight</b>	38 lbs
<b>EPA</b>	Front = 2.75 sq ft, Side = 1.17 sq ft

**Electrical and control**

<b>Voltage</b>	100 to 277 volts
<b>Fixture Cable</b>	Power and data in 1 cable, 3 ft cord standard (#16-5), other lengths available
<b>Resolution (DMX/RDM)</b>	Per fixture, 8-bit or 16-bit
<b>Control</b>	On/Off control, Lumentalk, 0-10V dimming, DALI dimming, Lutron® EcoSystem® Enabled dimming, DMX/RDM enabled

**Environmental**

<b>Operating Temperature</b>	-13 °F to 122 °F
<b>IP Rating</b>	IP66
<b>IK Rating</b>	IK09

**Accessories (order separately)**

<b>Control Boxes</b>	Power and control box - daisy chain configuration, Power and control box - star configuration
<b>Control Systems</b>	Lumentouch 2.0™, Lumencue, Lumentone
<b>Diagnostic and Addressing Tools</b>	LumenID, LumentalkID

**Mounting options**

SY - Short yoke

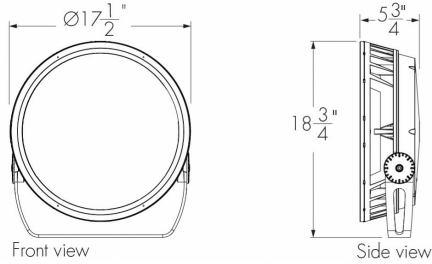

**Mounting details**

Mounting hole pattern - standard and short yoke

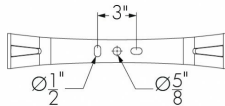

Adjustable pivot limits (adjustable in 6 degree increments)

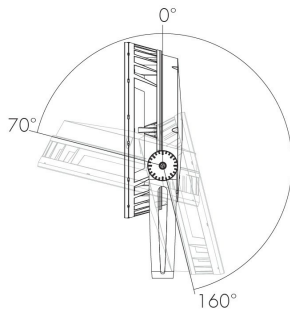

Standard yoke

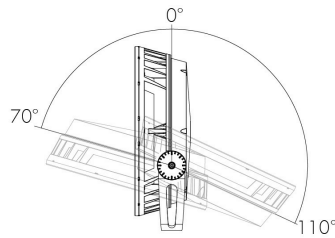

Short yoke

**Optical options**

LSLH - Linear spread lens horizontal distribution

LSLV - Linear spread lens vertical distribution

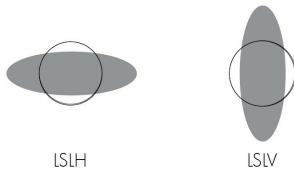

	Beam angle with LSLH/LSLV
<b>XN</b>	5° x 57°
<b>VN</b>	8° x 60°
<b>NS</b>	9° x 60°
<b>NF</b>	18° x 65°
<b>FL</b>	32° x 72°

Factory installed, not adjustable on site. Not available for WFL optic.  
See 'Optical Accessories' section for field adjustable spread lens (LSLA).

**Mounting accessories (order separately)**

**Round pole mounting accessory**

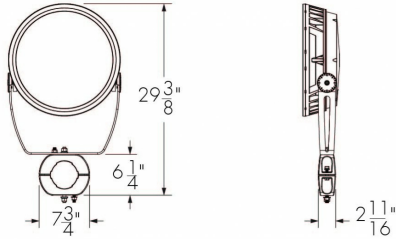

PM4 model shown.  
Consult factory for square pole section.



**PM4-1, PM4.5-1, PM5-1** - Round pole mounting accessory - single fixture



**PM4-2, PM4.5-2, PM5-2** - Round pole mounting accessory - twin fixtures  
\*One bracket assembly is supplied per 2 fixtures unless otherwise specified.

	PM4	PM4.5	PM5
For pole Ø	4" ± 1/16	4.5" ± 1/16	5" ± 1/16

Consult factory for other pole diameters.

**Tenon adapter**

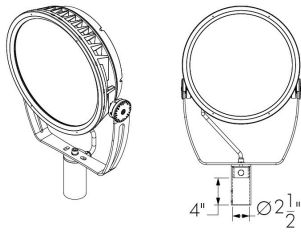

**TN2** - Tenon adapter to fit on 2 3/8 in O.D. tenon

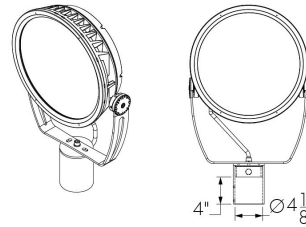
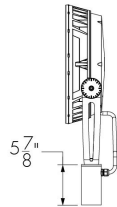

**TN4** - Tenon adapter to fit on 4 in O.D. tenon

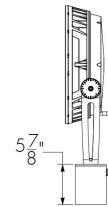

**Optical accessories (order separately)**

Installed optical accessories will affect the maximum pivot limits for each mounting option, consult factory for details.

**SN - Snoot**

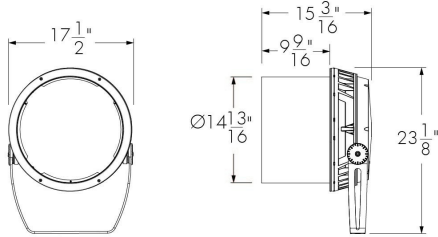

**LBXSN-FINISH-BK**  
Interior surface painted black. Please specify desired exterior FINISH from list of available finishes.

**SNW - Snoot wide**

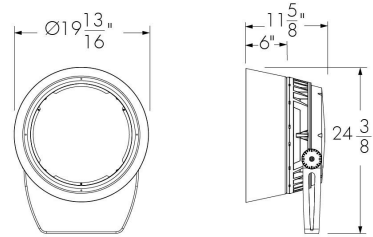

**LBXSNW-FINISH-BK**  
Interior surface painted black. Please specify desired exterior FINISH from list of available finishes.

**VS - Visor**

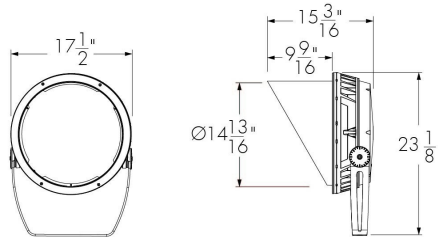

**LBXVS-FINISH-BK**  
Interior surface painted black. Please specify desired exterior FINISH from list of available finishes.

**LSLA - Linear spread lens adjustable**

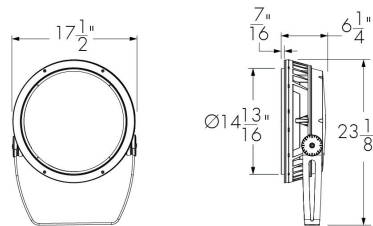

**LBXLSLA-FINISH**  
Please specify desired exterior FINISH from list of available finishes.

**WG - Wire guard**

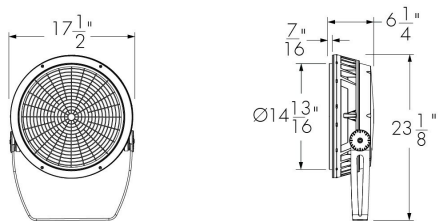

**LBXWG-FINISH**  
Please specify desired exterior FINISH from list of available finishes.

**Accessory combinations**

	+	Snoot	Snoot wide	Visor
<b>Linear spread lens adjustable</b>		YES	NO*	YES
<b>Wire guard</b>		YES	NO	YES

Accessory combinations must be ordered together on a single line  
Ex: A snoot + wire guard combination order code is LBXSNWG-BK-BK.  
\*Consult factory for a linear spread lens adjustable + snoot wide combination.

# Specification Sheet

### Available exterior finishes for optical accessories

- BK** - Black Sandtex®
- BRZ** - Bronze Sandtex®
- SI** - Silver Sandtex®
- WH** - Smooth white
- BKTX** - Textured black
- BRZTX** - Textured bronze, non-metallic
- GRATX** - Textured medium gray
- GRNTX** - Textured green
- WHTX** - Textured white
- CC** - Custom color and finish (please specify RAL color)\*

\*Lumenpulse offers a wide selection of RAL CLASSIC (K7) colors with a smooth texture and high-gloss finish. Please consult factory for a list of available K7 colors, other RAL textures and glosses, or to match alternate color charts. Final color matching results may vary.

### Typical wiring diagrams

#### Wiring color code

UL Color Code	USE
Green	Ground
Black	Live 100-277V
White	Neutral
Red/Purple	0-10V / Data +
Orange	0-10V / Data -

#### On/Off control (NO)

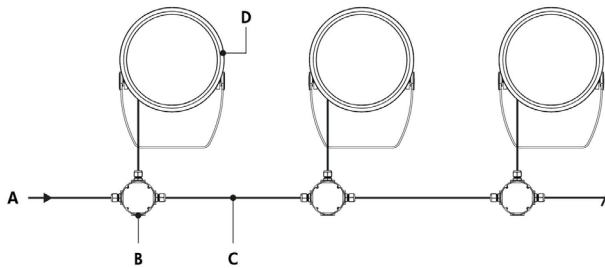

- A** - Power input (100-277V)
- B** - Junction box (by others)
- C** - Power wiring (by others)
- D** - Lumenbeam LBX

#### On/Off control (NO) - wiring detail

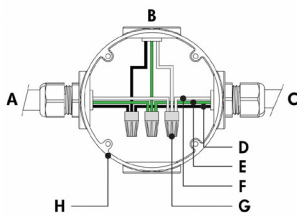

- A** - Power input or from previous fixture
- B** - To fixture
- C** - To next fixture
- D** - Live
- E** - Ground
- F** - Neutral
- G** - Wire-nuts (by others)
- H** - Junction box (by others)

- Consult factory for specific applications and maximum fixture count/cable length recommendations.
- Regular Output version: 140 watts per fixture, High Output version: 205 watts per fixture.

**lumenpulse™**

1220 Marie-Victorin Blvd., Longueuil, QC J4G 2H9 CA T 1.877.937.3003 | 514.937.3003 F 514.937.6289  
info@lumenpulse.com www.lumenpulsegroup.com

Lumenpulse Group Inc. reserves the right to make changes to this product at any time without prior notice and such modification shall be effective immediately  
2017.11.28 copyright © 2017 Lumenpulse Group Inc.  
MG - R38

Project: ODOT SUM-8-1.75

Date: 10/07/2022

Type: F1A,B,C,D,F

HLB Project #:18173

Submittal: 100% Package

APPENDIX: LUMINAIRE CATALOGUE CUTS Note: This document is for information only. Refer to specifications for all catalog numbers, etc.

Horton Lees Brogden Lighting Design | 38 E 32nd St 11th Floor New York NY 10016 | P: 212 674 5580 | F: 212 254 2712 | www.HLBlighting.com

# Specification Sheet

**lumenbeam**

**LBX**  
WHITE & STATIC COLORS

## Lumentalk (LT)

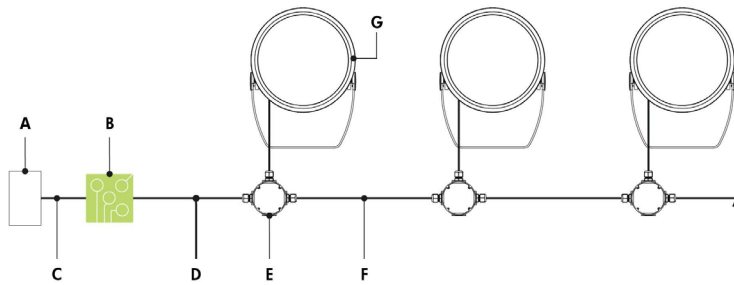

- A - Third party dimmer/controller
- B - Lumentranslator (LTL-010, -DMX, -TRIAC, -DALI)
- C - Data wiring (by others)
- D - Power line (120-277V AC)
- E - Junction box (by others)
- F - Power wiring (by others)
- G - Lumenbeam LBX

## Lumentalk (LT) - wiring detail

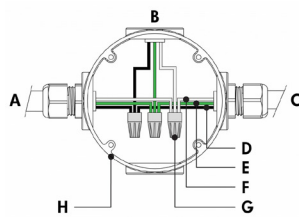

- A - Power input (control over power line via Lumentalk system) or from previous fixture
- B - To fixture
- C - To next fixture
- D - Live
- E - Ground
- F - Neutral
- G - Wire-nuts (by others)
- H - Junction box (by others)

- Consult factory for specific applications and maximum fixture count/cable length recommendations.
- Lumentalk enabled fixtures must be commissioned using LumentalkID software and a LID-LT. Consult factory for details.
- Maximum of 1 transmitter (Lumentranslator or Lumenlink) per system.
- No third party fixtures allowed on the same circuit.
- For DMX applications: 1 DMX controller per Lumentalk network, maximum of 48 DMX channels per Lumentalk network (minimum step transition update rate is 1 second, minimum fade time between two colors is 1 minute). Consult factory for applications that require additional capabilities.
- Consult factory for DALI Lumentalk applications.
- 1% minimum dimming value.
- Regular Output version: 140 watts per fixture, High Output version: 205 watts per fixture.

**lumenpulse™**

1220 Marie-Victorin Blvd., Longueuil, QC J4G 2H9 CA T 1.877.937.3003 | 514.937.3003 F 514.937.6289  
info@lumenpulse.com [www.lumenpulsegroup.com](http://www.lumenpulsegroup.com)

Lumenpulse Group Inc. reserves the right to make changes to this product at any time without prior notice and such modification shall be effective immediately  
2017.11.28 copyright © 2017 Lumenpulse Group Inc.  
MG - R38

7 / 15

Project: ODOT SUM-8-1.75

Date: 10/07/2022

Type: F1A,B,C,D,F

HLB Project #:18173

Submittal: 100% Package

APPENDIX: LUMINAIRE CATALOGUE CUTS Note: This document is for information only. Refer to specifications for all catalog numbers, etc.

Horton Lees Brogden Lighting Design | 38 E 32nd St 11th Floor New York NY 10016 | P: 212 674 5580 | F: 212 254 2712 | [www.HLBlighting.com](http://www.HLBlighting.com)

# Specification Sheet

**lumenbeam**

**LBX**  
WHITE & STATIC COLORS

## 0-10V dimming (DIM)

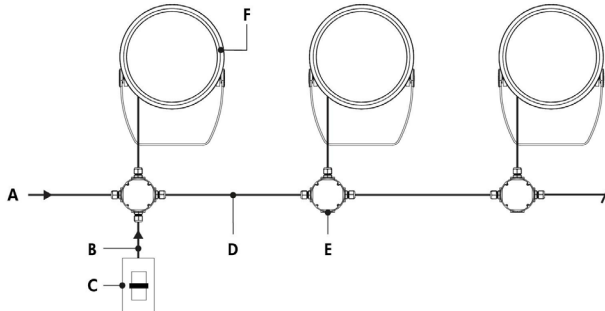

- A - Power input (100-277V)
- B - Data wiring (by others)
- C - Third party dimmer
- D - Power and data wiring (by others)
- E - Junction box (by others)
- F - Lumenbeam LBX

## 0-10V dimming (DIM) - wiring detail

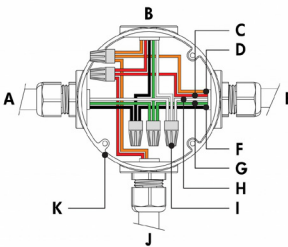

- A - Power input or from previous fixture
- B - To fixture
- C - 0-10 V +
- D - 0-10 V -
- E - To next fixture
- F - Live
- G - Ground
- H - Neutral
- I - Wire-nuts (by others)
- J - From third party dimmer
- K - Junction box (by others)

- Consult factory for specific applications and maximum fixture count/cable length recommendations.
- 0-10V mA ratings: passive dimmer (Current Sink): 3mA per fixture, active dimmer (Current Source): 0.5mA per fixture.
- 10% minimum dimming value.
- Regular Output version: 140 watts per fixture, High Output version: 205 watts per fixture.

**lumenpulse™**

1220 Marie-Victorin Blvd., Longueuil, QC J4G 2H9 CA T 1.877.937.3003 | 514.937.3003 F 514.937.6289  
info@lumenpulse.com [www.lumenpulsegroup.com](http://www.lumenpulsegroup.com)

Lumenpulse Group Inc. reserves the right to make changes to this product at any time without prior notice and such modification shall be effective immediately  
2017.11.28 copyright © 2017 Lumenpulse Group Inc.  
MG - R38

8 / 15

Project: ODOT SUM-8-1.75

Date: 10/07/2022

Type: F1A,B,C,D,F

HLB Project #:18173

Submittal: 100% Package

APPENDIX: LUMINAIRE CATALOGUE CUTS Note: This document is for information only. Refer to specifications for all catalog numbers, etc.

Horton Lees Brogden Lighting Design | 38 E 32nd St 11th Floor New York NY 10016 | P: 212 674 5580 | F: 212 254 2712 | [www.HLBlighting.com](http://www.HLBlighting.com)



# Specification Sheet

**lumenbeam**

**LBX**  
WHITE & STATIC COLORS

## DALI dimming (DALI)

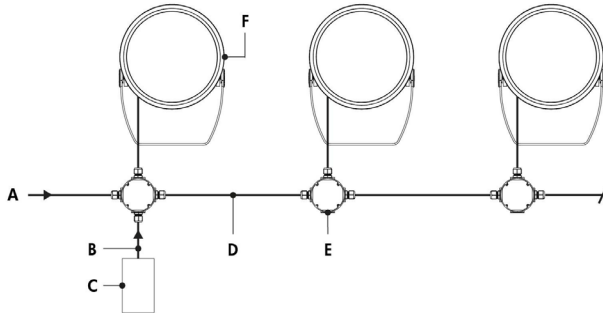

- A - Power input (100-277V)
- B - Data wiring (by others)
- C - Third party DALI controller
- D - Power and data wiring (by others)
- E - Junction box (by others)
- F - Lumenbeam LBX

## DALI dimming (DALI) - wiring detail

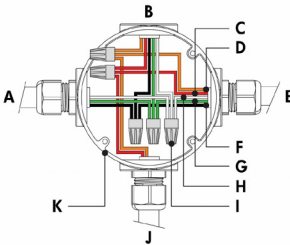

- A - Power input or from previous fixture
- B - To fixture
- C - Data +
- D - Data -
- E - To next fixture
- F - Live
- G - Ground
- H - Neutral
- I - Wire-nuts (by others)
- J - From third party DALI controller
- K - Junction box (by others)

- Consult factory for specific applications and maximum fixture count/cable length recommendations.
- Maximum of 64 DALI fixtures per DALI loop.
- 1% minimum dimming value.
- Regular Output version: 140 watts per fixture, High Output version: 205 watts per fixture.

**lumenpulse™**

1220 Marie-Victorin Blvd., Longueuil, QC J4G 2H9 CA T 1.877.937.3003 | 514.937.3003 F 514.937.6289  
info@lumenpulse.com [www.lumenpulsegroup.com](http://www.lumenpulsegroup.com)

Lumenpulse Group Inc. reserves the right to make changes to this product at any time without prior notice and such modification shall be effective immediately  
2017.11.28 copyright © 2017 Lumenpulse Group Inc.  
MG - R38

Project: ODOT SUM-8-1.75

Date: 10/07/2022

Type: F1A,B,C,D,F

HLB Project #:18173

Submittal: 100% Package

APPENDIX: LUMINAIRE CATALOGUE CUTS Note: This document is for information only. Refer to specifications for all catalog numbers, etc.

Horton Lees Brogden Lighting Design | 38 E 32nd St 11th Floor New York NY 10016 | P: 212 674 5580 | F: 212 254 2712 | [www.HLBlighting.com](http://www.HLBlighting.com)

# Specification Sheet

**lumenbeam**

**LBX**  
WHITE & STATIC COLORS

## Lutron® EcoSystem® Enabled dimming (ES)

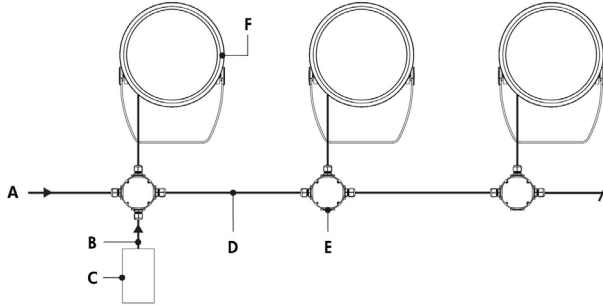

- A - Power input (100-277V)
- B - Data wiring (by others)
- C - Lutron® EcoSystem® controller
- D - Power and data wiring (by others)
- E - Junction box (by others)
- F - Lumenbeam LBX

## Lutron® EcoSystem® Enabled dimming (ES) - wiring detail

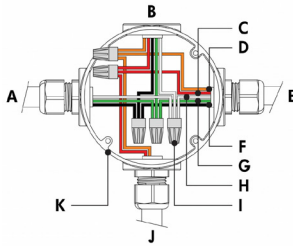

- A - Power input or from previous fixture
- B - To fixture
- C - Data +
- D - Data -
- E - To next fixture
- F - Live
- G - Ground
- H - Neutral
- I - Wire-nuts (by others)
- J - From Lutron® EcoSystem® controller
- K - Junction box (by others)

- Consult factory for specific applications and maximum fixture count/cable length recommendations.
- Each Lutron® EcoSystem® enabled fixture has its own address; for the example shown, there are a total of 3 EcoSystem® addresses.
- 1% minimum dimming value.
- Regular Output version: 140 watts per fixture, High Output version: 205 watts per fixture.

**lumenpulse™**

1220 Marie-Victorin Blvd., Longueuil, QC J4G 2H9 CA T 1.877.937.3003 | 514.937.3003 F 514.937.6289  
info@lumenpulse.com [www.lumenpulsegroup.com](http://www.lumenpulsegroup.com)

Lumenpulse Group Inc. reserves the right to make changes to this product at any time without prior notice and such modification shall be effective immediately  
2017.11.28 copyright © 2017 Lumenpulse Group Inc.  
MG - R38

10 / 15

Project: ODOT SUM-8-1.75

Date: 10/07/2022

Type: F1A,B,C,D,F

HLB Project #:18173

Submittal: 100% Package

APPENDIX: LUMINAIRE CATALOGUE CUTS Note: This document is for information only. Refer to specifications for all catalog numbers, etc.

Horton Lees Brogden Lighting Design | 38 E 32nd St 11th Floor New York NY 10016 | P: 212 674 5580 | F: 212 254 2712 | [www.HLBlighting.com](http://www.HLBlighting.com)

# Specification Sheet

**lumenbeam**

**LBX**  
WHITE & STATIC COLORS

## Star Layout (DMX/RDM)

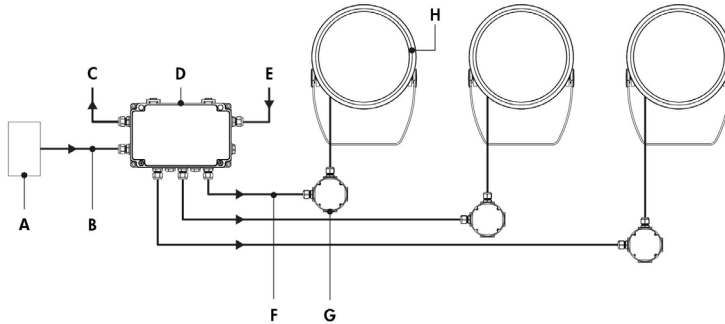

- A - Third party DMX/RDM controller
- B - Data input (Belden 9841 or equivalent, by others)
- C - Data output to next CBX (optional, not isolated/not boosted)
- D - CBX-ST
- E - Power input (100-277V)
- F - Power and data output to fixture (wiring by others)
- G - Junction box (by others)
- H - Lumenbeam LBX

## Star Layout (DMX/RDM) - wiring detail

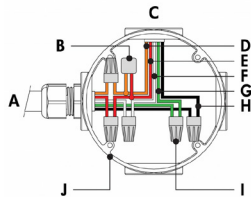

- A - From CBX or previous fixture
- B - Lumenterminator\*
- C - To fixture
- D - Data -
- E - Data +
- F - Neutral
- G - Ground
- H - Live
- I - Wire nuts (by others)
- J - Junction box (by others)

Maximum number of fixtures per run (Based on 15A maximum, 16AWG cable, fixtures spaced 10ft on center, first fixture 50ft from CBX)				
Configuration/Voltage	120V	208V	240V	277V
LBX RO	8	12	14	16
LBX HO	5	9	10	11

- Consult factory for specific applications and maximum fixture count/cable length recommendations.
- The DMX/RDM protocol states a maximum of 32 DMX/RDM enabled fixtures on any single run.
- Maximum of 4 DMX/RDM repeaters/CBX cascading in line.
- Maximum of 6 outputs per CBX-ST.
- Each fixture requires 1 DMX address.
- 1% minimum dimming value.
- Regular Output version: 140 watts per fixture, High Output version: 205 watts per fixture.

\* DMX terminator is required at the end of each run to maintain data integrity. (6x) DMX lumenterminators included per CBX-ST. See installation instructions for details.

**lumenpulse™**

1220 Marie-Victorin Blvd., Longueuil, QC J4G 2H9 CA T 1.877.937.3003 | 514.937.3003 F 514.937.6289  
info@lumenpulse.com [www.lumenpulsegroup.com](http://www.lumenpulsegroup.com)

Lumenpulse Group Inc. reserves the right to make changes to this product at any time without prior notice and such modification shall be effective immediately  
2017.11.28 copyright © 2017 Lumenpulse Group Inc.  
MG - R38

11 / 15

Project: ODOT SUM-8-1.75

Date: 10/07/2022

Type: F1A,B,C,D,F

HLB Project #:18173

Submittal: 100% Package

APPENDIX: LUMINAIRE CATALOGUE CUTS Note: This document is for information only. Refer to specifications for all catalog numbers, etc.

Horton Lees Brogden Lighting Design | 38 E 32nd St 11th Floor New York NY 10016 | P: 212 674 5580 | F: 212 254 2712 | [www.HLBlighting.com](http://www.HLBlighting.com)

# Specification Sheet

**lumenbeam**

**LBX**  
WHITE & STATIC COLORS

## Daisy Chain Layout (DMX/RDM)

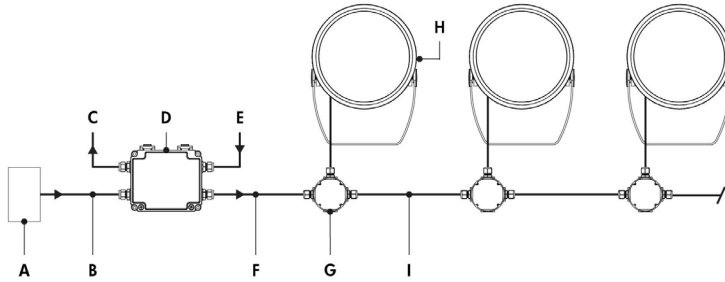

- A - Third party DMX/RDM controller
- B - Data input (Belden 9841 or equivalent, by others)
- C - Data output to next CBX (optional, not isolated/not boosted)
- D - CBX-DS
- E - Power input (100-277V)
- F - Power and data output to fixture (wiring by others)
- G - Junction box (by others)
- H - Lumenbeam LBX
- I - Power and data wiring (by others)

## Daisy Chain Layout (DMX/RDM) - wiring detail (first or middle of run)

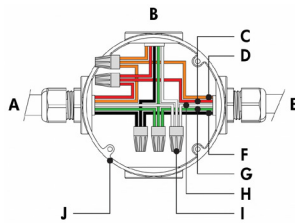

- A - From CBX or previous fixture
- B - To fixture
- C - Data +
- D - Data -
- E - To next/from previous fixture
- F - Live
- G - Ground
- H - Neutral
- I - Wire-nuts (by others)
- J - Junction box (by others)

## Daisy Chain Layout (DMX/RDM) - wiring detail (end of run)

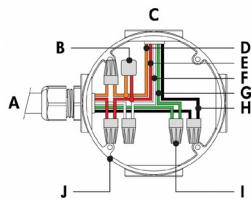

- A - From CBX or previous fixture
- B - Lumenterminator\*
- C - To fixture
- D - Data -
- E - Data +
- F - Neutral
- G - Ground
- H - Live
- I - Wire-nuts (by others)
- J - Junction box (by others)

Maximum number of fixtures per run (Based on 15A maximum, 16AWG cable, fixtures spaced 10ft on center, first fixture 50ft from CBX)				
Configuration/Voltage	120V	208V	240V	277V
<b>LBX RO</b>	8	12	14	16
<b>LBX HO</b>	5	9	10	11

- Consult factory for specific applications and maximum fixture count/cable length recommendations.
- The DMX/RDM protocol states a maximum of 32 DMX/RDM enabled fixtures on any single run.
- Maximum of 4 DMX/RDM repeaters/CBX cascading in line.
- Maximum of 1 output per CBX-DS.
- Maximum of 3 ft cable length between fixture and next junction box for daisy chain layout.
- Each fixture requires 1 DMX address.
- 1% minimum dimming value.
- Regular Output version: 140 watts per fixture, High Output version: 205 watts per fixture.

\* DMX terminator is required at the end of each run to maintain data integrity. (2x) DMX lumenterminators included per CBX-DS. See installation instructions for details.

**lumenpulse™**

1220 Marie-Victorin Blvd., Longueuil, QC J4G 2H9 CA T 1.877.937.3003 | 514.937.3003 F 514.937.6289  
info@lumenpulse.com [www.lumenpulsegroup.com](http://www.lumenpulsegroup.com)

Lumenpulse Group Inc. reserves the right to make changes to this product at any time without prior notice and such modification shall be effective immediately  
2017.11.28 copyright © 2017 Lumenpulse Group Inc.  
MG - R38

12 / 15

Project: ODOT SUM-8-1.75

Date: 10/07/2022

Type: F1A,B,C,D,F

HLB Project #:18173

Submittal: 100% Package

APPENDIX: LUMINAIRE CATALOGUE CUTS Note: This document is for information only. Refer to specifications for all catalog numbers, etc.

Horton Lees Brogden Lighting Design | 38 E 32nd St 11th Floor New York NY 10016 | P: 212 674 5580 | F: 212 254 2712 | [www.HLBlighting.com](http://www.HLBlighting.com)

**Accessories (order separately)**

**Control Boxes**

---

**CBX-DS-Power and control box - daisy chain configuration**

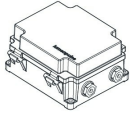

DMX/RDM control box. One power and data output to fixture or fixture run. Ethernet enabled option. Refer to CBX specification sheet for details.

**CBX-ST-Power and control box - star configuration**

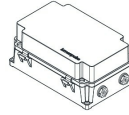

DMX/RDM control box. Up to six power and data outputs to fixtures or fixture runs. Ethernet enabled option. Refer to CBX specification sheet for details.

**Control Systems**

---

**LTO2-Lumentouch 2.0™**



Lumentouch is a wall mount DMX 512 controller keypad.

**LCU-Lumencie**



Lumencie is a USB / mini SD DMX 512 controller.

**LTN-Lumentone**



Lumentone is a simple pre-programmed DMX 512 controller with a push button rotary dial and live feedback.

**Diagnostic and Addressing Tools**

---

**LID-LumenID**



LumenID is a diagnostic and addressing DMX/RDM tool. It must be specified on all DMX applications. Refer to LID specification sheet for details.

**LID-LT-LumentalkID**



LumentalkID is a diagnostic and addressing tool. It must be specified for all Lumentalk (LT) applications. Refer to LID-LT specification sheet for details.

How to order							
1	2	3	4	5	6	7	8
9	10	11	12				

**1 . Housing**

<b>LBX RO</b>	Lumenbeam™ XLarge, Regular Output, 140W
<b>LBX HO</b>	Lumenbeam™ XLarge, High Output, 205W

**2 . Voltage**

<b>100</b>	100 volts
<b>120</b>	120 volts
<b>208</b>	208 volts
<b>220</b>	220 volts
<b>240</b>	240 volts
<b>277</b>	277 volts

**3 . Color and Color Temperature <sup>(1)</sup>**

<b>22K</b>	2200K
<b>27K</b>	2700K
<b>30K</b>	3000K
<b>35K</b>	3500K
<b>40K</b>	4000K
<b>57K</b>	5700K
<b>RD</b>	Red
<b>GR</b>	Green
<b>BL</b>	Blue

**4 . Optic1**

<b>XN</b>	Extra Narrow 4°
<b>VN</b>	Very Narrow 6°
<b>NS</b>	Narrow Spot 10°
<b>NF</b>	Narrow Flood 20°
<b>FL</b>	Flood 40°
<b>WFL</b>	Wide Flood 60° <sup>(2)</sup>

**5 . Optic2**

<b>XN</b>	Extra Narrow 4°
<b>VN</b>	Very Narrow 6°
<b>NS</b>	Narrow Spot 10°
<b>NF</b>	Narrow Flood 20°
<b>FL</b>	Flood 40°
<b>WFL</b>	Wide Flood 60° <sup>(2)</sup>

**6 . Optic3**

<b>XN</b>	Extra Narrow 4°
<b>VN</b>	Very Narrow 6°
<b>NS</b>	Narrow Spot 10°
<b>NF</b>	Narrow Flood 20°
<b>FL</b>	Flood 40°
<b>WFL</b>	Wide Flood 60° <sup>(2)</sup>

**7 . Optical Option**

<b>LSH</b>	Linear spread lens horizontal distribution <sup>(3)</sup>
<b>LSV</b>	Linear spread lens vertical distribution <sup>(3)</sup>

**8 . Finish**

<b>BK</b>	Black Sandtex®
<b>BRZ</b>	Bronze Sandtex®
<b>SI</b>	Silver Sandtex®
<b>WH</b>	Smooth white
<b>BKTX</b>	Textured black
<b>BRZTX</b>	Textured bronze non-metallic
<b>GRATX</b>	Textured medium gray
<b>GRNTX</b>	Textured green
<b>WHTX</b>	Textured white
<b>CC</b>	Custom color and finish (please specify RAL color) <sup>(4)</sup>

**9 . Control**

<b>NO</b>	On/Off control
<b>LT</b>	Lumentalk <sup>(5)</sup>
<b>DIM</b>	0-10V dimming
<b>DALI</b>	DALI dimming
<b>ES</b>	Lutron® EcoSystem® Enabled dimming
<b>DMX/RDM</b>	DMX/RDM enabled

**10 . Options**

<b>SY</b>	Short Yoke
<b>3GV</b>	3G ANSI C136.31 Vibration Rating for bridge applications
<b>CRC</b>	Corrosion-resistant coating for hostile environments <sup>(6)</sup>

**11 . Certification**

<b>UL</b>	UL compliant
<b>CE</b>	CE compliant

**12 . Cable Length <sup>(7)</sup>**

<b>3FT</b>	3 ft <sup>(7)</sup> <sup>(8)</sup>
<b>10FT</b>	10 ft
<b>20FT</b>	20 ft
<b>30FT</b>	30 ft
<b>50FT</b>	50 ft
<b>70FT</b>	70 ft
<b>100FT</b>	100 ft

**Notes:**

- <sup>(1)</sup> Consult factory for availability of static Royal Blue, 6500K and 90+ CRI.
- <sup>(2)</sup> Cannot be combined with other optics.
- <sup>(3)</sup> Factory installed, not available for 60° optic. Field adjustable spread lens optical accessory available, order separately.
- <sup>(4)</sup> Lumenpulse offers a wide selection of RAL CLASSIC (K7) colors with a smooth texture and high-gloss finish. Please consult factory for a list of available K7 colors, other RAL textures and glosses, or to match alternate color charts. Final color matching results may vary.
- <sup>(5)</sup> A Lumentranslator and LumentalkID (LIDL) must be specified for Lumentalk applications. Consult Lumentranslator and Lumentalk pages and specification sheets for details.
- <sup>(6)</sup> Use only when exposed to salt spray and harsh chemicals. This option is not required for normal outdoor exposure.
- <sup>(7)</sup> 3 ft cable length is standard unless otherwise specified.
- <sup>(8)</sup> Maximum of 3 ft cable length for daisy chain DMX applications with CBX-DS.

# Specification Sheet

**lumenbeam**

**Grande**  
WHITE AND STATIC COLORS

Project Name \_\_\_\_\_ Qty \_\_\_\_\_

Type \_\_\_\_\_ Catalog / Part Number \_\_\_\_\_

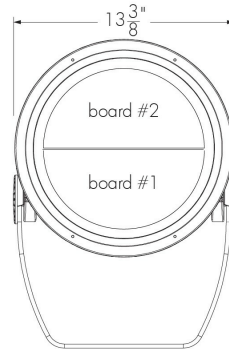

Front view

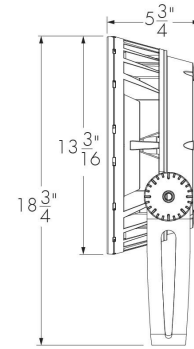

Side view

## Photometric Summary

4000K	Delivered output (lm)	Intensity (peak cd)
XN	8,425	593,570
VN	6,313	361,807
NS	6,667	222,046
NF	6,437	44,962
FL	6,286	16,798
WFL	5,635	5,469

Photometric performance is measured in compliance with IESNA LM-79-08.

## Optics

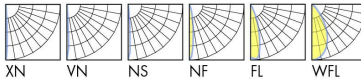

## Control

ON/OFF    0-10V    DMX/RDM

lumen talk    EcoSystem Enabled    DALI

## Rating



## Description

The Lumenbeam Grande is a high-performance, 100W luminaire for lighting architectural exteriors and facades. It has numerous options including optics for flood or accent lighting; a choice of color temperatures and colors; various mounting options, accessories, spread lenses and controls.

## Features

**Color and Color Temperature**    2200K, 2700K, 3000K, 3500K, 4000K, 5700K, Red, Green, Blue

**Optics (nominal distribution)**    4°, 6°, 10°, 20°, 40°, 60°

**Optical Option**    Linear spread lens horizontal distribution, Linear spread lens vertical distribution

**Options**    Short Yoke, 3G ANSI C136.31 Vibration Rating for bridge applications, Corrosion-resistant coating for hostile environments

**Power Consumption**    100 W

**Warranty**    5-year limited warranty

## Performance

**Delivered Output**    8,425 lm (4000K, XN optic)

**Delivered Intensity**    593,570 cd at nadir (4000K, XN optic)

**Illuminance at Distance**    Minimum 1 fc at 770 ft distance (4000K, XN optic)

**Color Consistency**    2 SDCM

**Color Rendering**    CRI 80+

**Lumen Maintenance**    L70 120,000 hrs (Ta 25 °C)

**lumenpulse™**

1220 Marie-Victorin Blvd., Longueuil, QC J4G 2H9 CA T 1.877.937.3003 | 514.937.3003 F 514.937.6289  
info@lumenpulse.com    www.lumenpulsegroup.com

Lumenpulse Group Inc. reserves the right to make changes to this product at any time without prior notice and such modification shall be effective immediately  
2017.11.28 copyright © 2017 Lumenpulse Group Inc.  
MG - R14

Project: ODOT SUM-8-1.75

Date: 10/07/2022

Type: F1E

HLB Project #:18173

Submittal: 100% Package

APPENDIX: LUMINAIRE CATALOGUE CUTS Note: This document is for information only. Refer to specifications for all catalog numbers, etc.

Horton Lees Brogden Lighting Design | 38 E 32nd St 11th Floor New York NY 10016 | P: 212 674 5580 | F: 212 254 2712 | www.HLBlighting.com



**Physical**

<b>Housing Material</b>	Low copper content high pressure die-cast aluminum
<b>Yoke Material</b>	Heavy aluminum (standard yoke included)
<b>Lens Material</b>	Clear tempered glass
<b>Hardware Material</b>	Stainless steel
<b>Surface Finish</b>	Electrostatically applied polyester powder coat
<b>Weight</b>	24 lbs
<b>EPA</b>	Front = 1.6 sq ft, Side = 0.97 sq ft

**Electrical and control**

<b>Voltage</b>	100 to 277 volts
<b>Fixture Cable</b>	Power and data in 1 cable, 3 ft cord standard (#16-5), other lengths available
<b>Resolution (DMX/RDM)</b>	Per fixture, 8-bit or 16-bit
<b>Control</b>	On/Off control, Lumentalk, 0-10V dimming, DALI dimming, Lutron® EcoSystem® Enabled dimming, DMX/RDM enabled

**Environmental**

<b>Operating Temperature</b>	-13 °F to 122 °F
<b>IP Rating</b>	IP66
<b>IK Rating</b>	IK09

**Accessories (order separately)**

<b>Control Boxes</b>	Power and control box - daisy chain configuration, Power and control box - star configuration
<b>Control Systems</b>	Lumentouch 2.0™, Lumencue, Lumentone
<b>Diagnostic and Addressing Tools</b>	LumenID, LumentalkID



1220 Marie-Victorin Blvd., Longueuil, QC J4G 2H9 CA T 1.877.937.3003 | 514.937.3003 F 514.937.6289  
 info@lumenpulse.com www.lumenpulsegroup.com

Lumenpulse Group Inc. reserves the right to make changes to this product at any time without prior notice and such modification shall be effective immediately  
 2017.11.28 copyright © 2017 Lumenpulse Group Inc.  
 MG - R14

Project: ODOT SUM-8-1.75

Date: 10/07/2022

Type: F1E

HLB Project #:18173

Submittal: 100% Package

APPENDIX: LUMINAIRE CATALOGUE CUTS Note: This document is for information only. Refer to specifications for all catalog numbers, etc.

Horton Lees Brogden Lighting Design | 38 E 32nd St 11th Floor New York NY 10016 | P: 212 674 5580 | F: 212 254 2712 | www.HLBlighting.com

**Mounting options**

SY - Short yoke

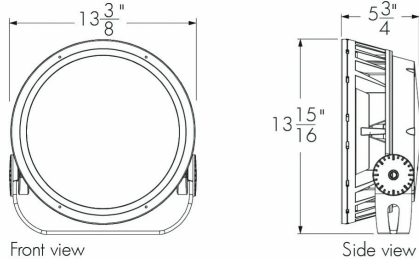

**Mounting details**

Mounting hole pattern - standard and short yoke

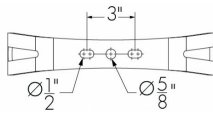

Adjustable pivot limits

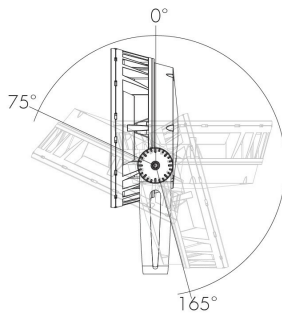

Standard yoke

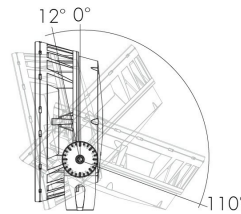

Short yoke

**Optical options**

LSLH - Linear spread lens horizontal distribution  
 LSLV - Linear spread lens vertical distribution

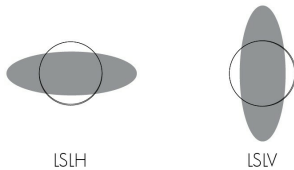

	Beam angle with LSLH/LSLV
<b>XN</b>	5° x 57°
<b>VN</b>	8° x 60°
<b>NS</b>	9° x 60°
<b>NF</b>	18° x 65°
<b>FL</b>	32° x 72°

Factory installed, not adjustable on site. Not available for WFL optic.  
 See 'Optical Accessories' section for field adjustable spread lens (LSLA).

**Mounting accessories (order separately)**

**Round pole mounting accessory**

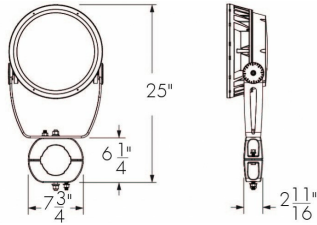

PM4 model shown.  
Consult factory for square pole section.

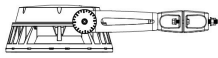

**PM4-1, PM4.5-1, PM5-1** - Round pole mounting accessory - single fixture

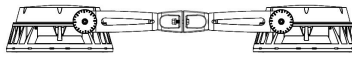

**PM4-5, PM4.5-2, PM5-2** - Round pole mounting accessory - twin fixtures  
\*One bracket assembly is supplied per 2 fixtures unless otherwise specified.

	PM4	PM4.5	PM5
<b>For pole Ø</b>	4" ± 1/16	4.5" ± 1/16	5" ± 1/16

Consult factory for other pole diameters.

**Tenon adapter**

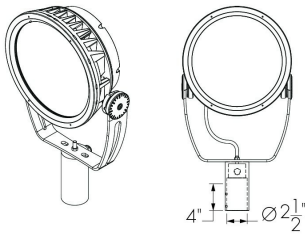

**TN2** - Tenon adapter to fit on 2 3/8 in O.D. tenon



**TN4** - Tenon adapter to fit on 4 in O.D. tenon

**Optical accessories (order separately)**

Installed optical accessories will affect the maximum pivot limits for each mounting option, consult factory for details.

**SN - Snoot**

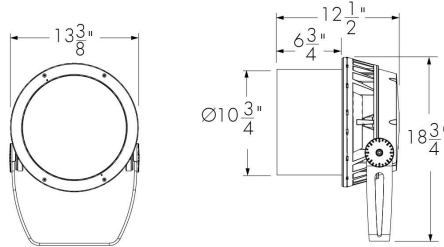

**LBGSN-FINISH-BK**  
Interior surface painted black. Please specify desired exterior FINISH from list of available finishes.

**SNW - Snoot wide**

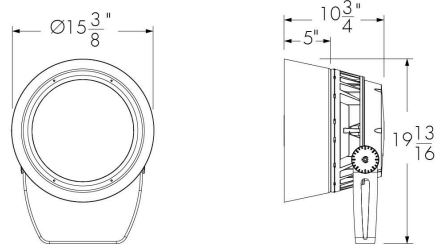

**LBGSNW-FINISH-BK**  
Interior surface painted black. Please specify desired exterior FINISH from list of available finishes.

**VS - Visor**

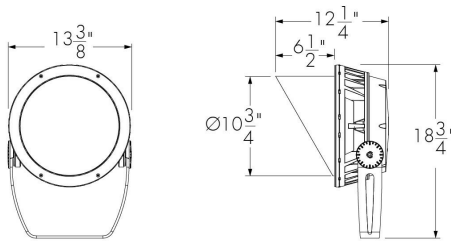

**LBGVS-FINISH-BK**  
Interior surface painted black. Please specify desired exterior FINISH from list of available finishes.

**LSLA - Linear spread lens adjustable**

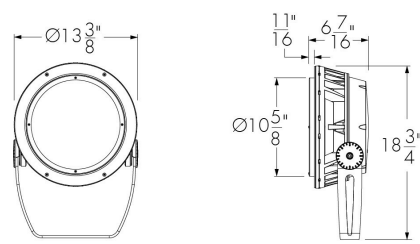

**LBGLSLA-FINISH**  
Please specify desired exterior FINISH from list of available finishes.

**WG - Wire guard**

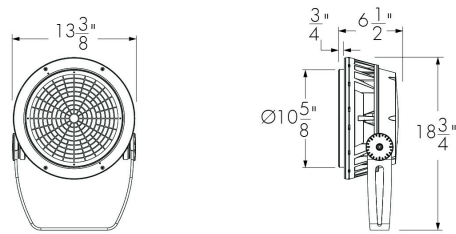

**LBGWG-FINISH**  
Please specify desired exterior FINISH from list of available finishes.

**Accessory combinations**

	+	Snoot	Snoot wide	Visor
<b>Linear spread lens adjustable</b>	YES	NO*	YES	
<b>Wire guard</b>	YES	NO	YES	

Accessory combinations must be ordered together on a single line  
Ex: A snoot + wire guard combination order code is LBGSNWG-BK-BK.  
\*Consult factory for a linear spread lens adjustable + snoot wide combination.

# Specification Sheet

**lumenbeam**  
**Grande**  
 WHITE AND STATIC COLORS

## Available exterior finishes for optical accessories

- BK** - Black Sandtex®
- BRZ** - Bronze Sandtex®
- SI** - Silver Sandtex®
- WH** - Smooth white
- BKTX** - Textured black
- BRZTX** - Textured bronze, non-metallic
- GRATX** - Textured medium gray
- GRNTX** - Textured green
- WHTX** - Textured white
- CC** - Custom color and finish (please specify RAL color)\*

\*Lumenpulse offers a wide selection of RAL CLASSIC (K7) colors with a smooth texture and high-gloss finish. Please consult factory for a list of available K7 colors, other RAL textures and glosses, or to match alternate color charts. Final color matching results may vary.

## Typical wiring diagrams

### Wiring color code

UL Color Code	USE
Green	Ground
Black	Live 100-277V
White	Neutral
Red/Purple	0-10V / Data +
Orange	0-10V / Data -

### On/Off control (NO)

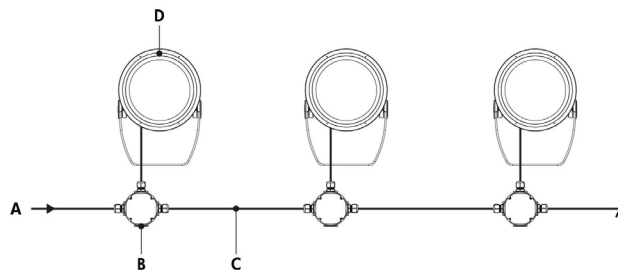

- A** - Power input (100-277V)
- B** - Junction box (by others)
- C** - Power wiring (by others)
- D** - Lumenbeam Grande

### On/Off control (NO) - wiring detail

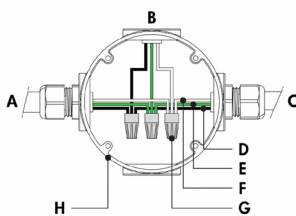

- A** - Power input or from previous fixture
- B** - To fixture
- C** - To next fixture
- D** - Live
- E** - Ground
- F** - Neutral
- G** - Wire-nuts (by others)
- H** - Junction box (by others)

- Consult factory for specific applications and maximum fixture count/cable length recommendations.
- 100 watts per fixture.

**lumenpulse™**

1220 Marie-Victorin Blvd., Longueuil, QC J4G 2H9 CA T 1.877.937.3003 | 514.937.3003 F 514.937.6289  
 info@lumenpulse.com www.lumenpulsegroup.com

Lumenpulse Group Inc. reserves the right to make changes to this product at any time without prior notice and such modification shall be effective immediately  
 2017.11.28 copyright © 2017 Lumenpulse Group Inc.  
 MG - R14

Project: ODOT SUM-8-1.75

Date: 10/07/2022

Type: F1E

HLB Project #:18173

Submittal: 100% Package

APPENDIX: LUMINAIRE CATALOGUE CUTS Note: This document is for information only. Refer to specifications for all catalog numbers, etc.

Horton Lees Brogden Lighting Design | 38 E 32nd St 11th Floor New York NY 10016 | P: 212 674 5580 | F: 212 254 2712 | www.HLBlighting.com

# Specification Sheet

**lumenbeam**  
**Grande**  
 WHITE AND STATIC COLORS

## Lumentalk (LT)

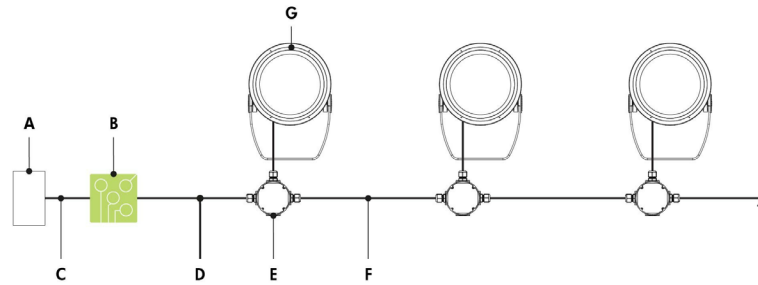

- A - Third party dimmer/controller
- B - Lumentranslator (LTL-010, -DMX, -TRIAC, -DALI)
- C - Data wiring (by others)
- D - Power line (120-277V AC)
- E - Junction box (by others)
- F - Power wiring (by others)
- G - Lumenbeam Grande

## Lumentalk (LT) - wiring detail

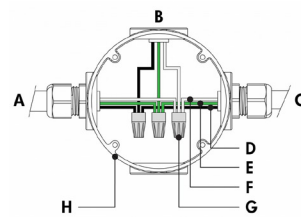

- A - Power input (control over power line via Lumentalk system) or from previous fixture
- B - To fixture
- C - To next fixture
- D - Live
- E - Ground
- F - Neutral
- G - Wire-nuts (by others)
- H - Junction box (by others)

- Consult factory for specific applications and maximum fixture count/cable length recommendations.
- Lumentalk enabled fixtures must be commissioned using LumentalkID software and a LID-LT. Consult factory for details.
- Maximum of 1 transmitter (Lumentranslator or Lumenlink) per system.
- No third party fixtures allowed on the same circuit.
- For DMX applications: 1 DMX controller per Lumentalk network, maximum of 48 DMX channels per Lumentalk network (minimum step transition update rate is 1 second, minimum fade time between two colors is 1 minute). Consult factory for applications that require additional capabilities.
- Consult factory for DALI Lumentalk applications.
- 1% minimum dimming value.
- 100 watts per fixture.

**lumenpulse™**

1220 Marie-Victorin Blvd., Longueuil, QC J4G 2H9 CA T 1.877.937.3003 | 514.937.3003 F 514.937.6289  
 info@lumenpulse.com [www.lumenpulsegroup.com](http://www.lumenpulsegroup.com)

Lumenpulse Group Inc. reserves the right to make changes to this product at any time without prior notice and such modification shall be effective immediately  
 2017.11.28 copyright © 2017 Lumenpulse Group Inc.  
 MG - R14

Project: ODOT SUM-8-1.75

Date: 10/07/2022

Type: F1E

HLB Project #:18173

Submittal: 100% Package

APPENDIX: LUMINAIRE CATALOGUE CUTS Note: This document is for information only. Refer to specifications for all catalog numbers, etc.

Horton Lees Brogden Lighting Design | 38 E 32nd St 11th Floor New York NY 10016 | P: 212 674 5580 | F: 212 254 2712 | [www.HLBlighting.com](http://www.HLBlighting.com)

# Specification Sheet

**lumenbeam**  
**Grande**  
 WHITE AND STATIC COLORS

## 0-10V dimming (DIM)

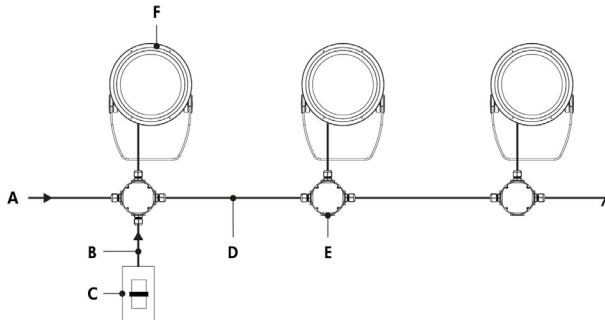

- A - Power input (100-277V)
- B - Data wiring (by others)
- C - Third party dimmer
- D - Power and data wiring (by others)
- E - Junction box (by others)
- F - Lumenbeam Grande

## 0-10V dimming (DIM) - wiring detail

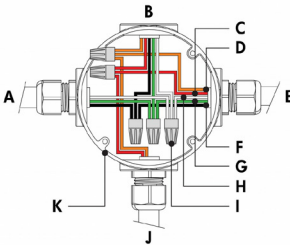

- A - Power input or from previous fixture
- B - To fixture
- C - 0-10 V +
- D - 0-10 V -
- E - To next fixture
- F - Live
- G - Ground
- H - Neutral
- I - Wire-nuts (by others)
- J - From third party dimmer
- K - Junction box (by others)

- Consult factory for specific applications and maximum fixture count/cable length recommendations.
- 0-10V mA ratings: passive dimmer (Current Sink): 3mA per fixture, active dimmer (Current Source): 0.5mA per fixture.
- 10% minimum dimming value.
- 100 watts per fixture.

**lumenpulse™**

1220 Marie-Victorin Blvd., Longueuil, QC J4G 2H9 CA T 1.877.937.3003 | 514.937.3003 F 514.937.6289  
 info@lumenpulse.com [www.lumenpulsegroup.com](http://www.lumenpulsegroup.com)

Lumenpulse Group Inc. reserves the right to make changes to this product at any time without prior notice and such modification shall be effective immediately  
 2017.11.28 copyright © 2017 Lumenpulse Group Inc.  
 MG - R14

Project: ODOT SUM-8-1.75

Date: 10/07/2022

Type: F1E

HLB Project #:18173

Submittal: 100% Package

APPENDIX: LUMINAIRE CATALOGUE CUTS Note: This document is for information only. Refer to specifications for all catalog numbers, etc.

Horton Lees Brogden Lighting Design | 38 E 32nd St 11th Floor New York NY 10016 | P: 212 674 5580 | F: 212 254 2712 | [www.HLBlighting.com](http://www.HLBlighting.com)

# Specification Sheet

**lumenbeam**  
**Grande**  
 WHITE AND STATIC COLORS

## DALI dimming (DALI)

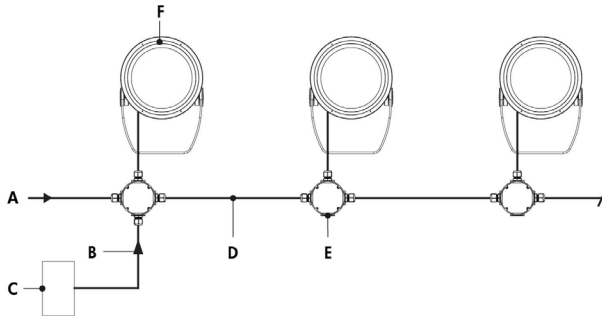

- A - Power input (100-277V)
- B - Data wiring (by others)
- C - Third party DALI controller
- D - Power and data wiring (by others)
- E - Junction box (by others)
- F - Lumenbeam Grande

## DALI dimming (DALI) - wiring detail

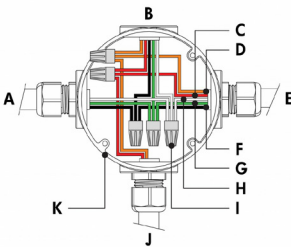

- A - Power input or from previous fixture
- B - To fixture
- C - Data +
- D - Data -
- E - To next fixture
- F - Live
- G - Ground
- H - Neutral
- I - Wire-nuts (by others)
- J - From third party DALI controller
- K - Junction box (by others)

- Consult factory for specific applications and maximum fixture count/cable length recommendations.
- Maximum of 64 DALI fixtures per DALI loop.
- 1% minimum dimming value.
- 100 watts per fixture.

**lumenpulse™**

1220 Marie-Victorin Blvd., Longueuil, QC J4G 2H9 CA T 1.877.937.3003 | 514.937.3003 F 514.937.6289  
 info@lumenpulse.com [www.lumenpulsegroup.com](http://www.lumenpulsegroup.com)

Lumenpulse Group Inc. reserves the right to make changes to this product at any time without prior notice and such modification shall be effective immediately  
 2017.11.28 copyright © 2017 Lumenpulse Group Inc.  
 MG - R14

Project: ODOT SUM-8-1.75

Date: 10/07/2022

Type: F1E

HLB Project #:18173

Submittal: 100% Package

APPENDIX: LUMINAIRE CATALOGUE CUTS Note: This document is for information only. Refer to specifications for all catalog numbers, etc.

Horton Lees Brogden Lighting Design | 38 E 32nd St 11th Floor New York NY 10016 | P: 212 674 5580 | F: 212 254 2712 | [www.HLBlighting.com](http://www.HLBlighting.com)



# Specification Sheet

**lumenbeam**  
**Grande**  
 WHITE AND STATIC COLORS

## Lutron® EcoSystem® Enabled dimming (ES)

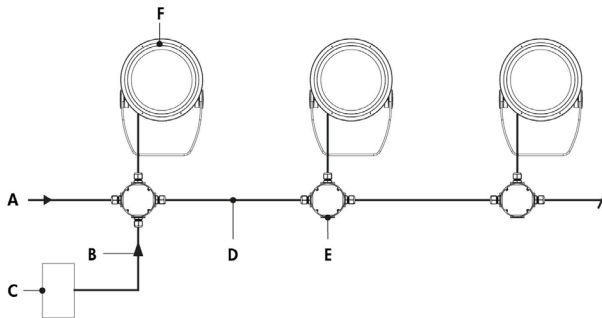

- A - Power input (100-277V)
- B - Data wiring (by others)
- C - Lutron® EcoSystem® controller
- D - Power and data wiring (by others)
- E - Junction box (by others)
- F - Lumenbeam Grande

## Lutron® EcoSystem® Enabled dimming (ES) - wiring detail

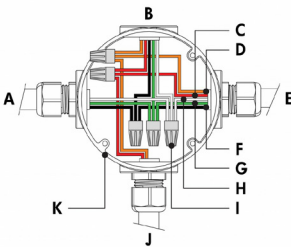

- A - Power input or from previous fixture
- B - To fixture
- C - Data +
- D - Data -
- E - To next fixture
- F - Live
- G - Ground
- H - Neutral
- I - Wire-nuts (by others)
- J - From Lutron® EcoSystem® controller
- K - Junction box (by others)

- Consult factory for specific applications and maximum fixture count/cable length recommendations.
- Each Lutron® EcoSystem® enabled fixture has its own address; for the example shown, there are a total of 3 EcoSystem® addresses.
- 1% minimum dimming value.
- 100 watts per fixture.

**lumenpulse™**

1220 Marie-Victorin Blvd., Longueuil, QC J4G 2H9 CA T 1.877.937.3003 | 514.937.3003 F 514.937.6289  
 info@lumenpulse.com www.lumenpulsegroup.com

Lumenpulse Group Inc. reserves the right to make changes to this product at any time without prior notice and such modification shall be effective immediately  
 2017.11.28 copyright © 2017 Lumenpulse Group Inc.  
 MG - R14

Project: ODOT SUM-8-1.75

Date: 10/07/2022

Type: F1E

HLB Project #:18173

Submittal: 100% Package

APPENDIX: LUMINAIRE CATALOGUE CUTS Note: This document is for information only. Refer to specifications for all catalog numbers, etc.

Horton Lees Brogden Lighting Design | 38 E 32nd St 11th Floor New York NY 10016 | P: 212 674 5580 | F: 212 254 2712 | www.HLBlighting.com

# Specification Sheet

**lumenbeam**  
**Grande**  
 WHITE AND STATIC COLORS

## Star Layout (DMX/RDM)

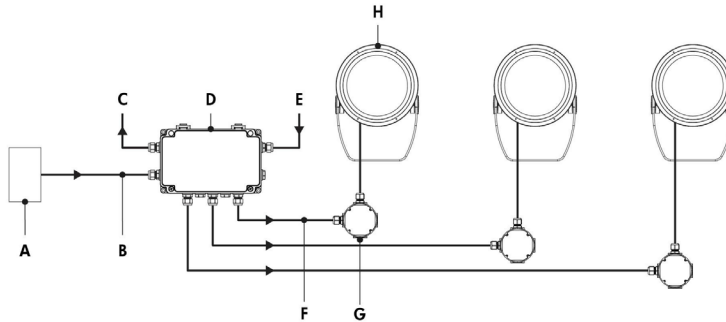

- A - Third party DMX/RDM controller
- B - Data input (Belden 9841 or equivalent, by others)
- C - Data output to next CBX (optional, not isolated/not boosted)
- D - CBX-ST
- E - Power input (100-277V)
- F - Power and data output to fixture (wiring by others)
- G - Junction box (by others)
- H - Lumenbeam Grande

## Star Layout (DMX/RDM) - wiring detail

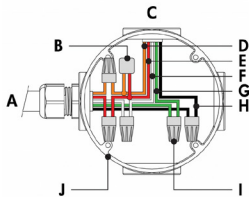

- A - From CBX or previous fixture
- B - Lumenterminator\*
- C - To fixture
- D - Data -
- E - Data +
- F - Neutral
- G - Ground
- H - Live
- I - Wire nuts (by others)
- J - Junction box (by others)

Maximum number of fixtures per run (Based on 1.5A maximum, 16AWG cable, fixtures spaced 10ft on center, first fixture 50ft from CBX)				
Configuration/Voltage	<b>120V</b>	<b>208V</b>	<b>240V</b>	<b>277V</b>
<b>LBG</b>	10	16	18	21

- Consult factory for specific applications and maximum fixture count/cable length recommendations.
- The DMX/RDM protocol states a maximum of 32 DMX/RDM enabled fixtures on any single run.
- Maximum of 4 DMX/RDM repeaters/CBX cascading in line.
- Maximum of 6 outputs per CBX-ST.
- Each fixture requires 1 DMX address.
- 1% minimum dimming value.
- 100 watts per fixture.

\*DMX terminator is required at the end of each run to maintain data integrity. (6x) DMX lumenterminators included per CBX-ST. See installation instructions for details.

**lumenpulse™**

1220 Marie-Victorin Blvd., Longueuil, QC J4G 2H9 CA T 1.877.937.3003 | 514.937.3003 F 514.937.6289  
 info@lumenpulse.com [www.lumenpulsegroup.com](http://www.lumenpulsegroup.com)

Lumenpulse Group Inc. reserves the right to make changes to this product at any time without prior notice and such modification shall be effective immediately  
 2017.11.28 copyright © 2017 Lumenpulse Group Inc.  
 MG - R14

Project: ODOT SUM-8-1.75

Date: 10/07/2022

Type: F1E

HLB Project #:18173

Submittal: 100% Package

APPENDIX: LUMINAIRE CATALOGUE CUTS Note: This document is for information only. Refer to specifications for all catalog numbers, etc.

Horton Lees Brogden Lighting Design | 38 E 32nd St 11th Floor New York NY 10016 | P: 212 674 5580 | F: 212 254 2712 | [www.HLBlighting.com](http://www.HLBlighting.com)

# Specification Sheet

## Daisy Chain Layout (DMX/RDM)

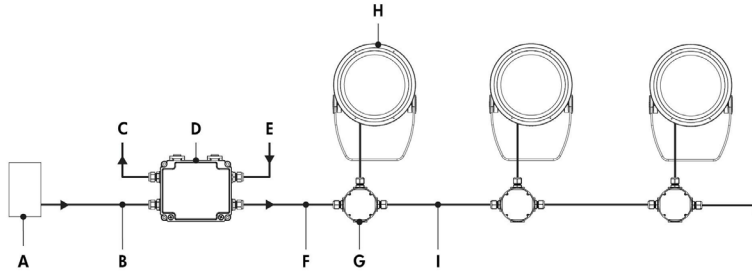

- A - Third party DMX/RDM controller
- B - Data input (Belden 9841 or equivalent, by others)
- C - Data output to next CBX (optional, not isolated/not boosted)
- D - CBX-DS
- E - Power input (100-277V)
- F - Power and data output to fixture (wiring by others)
- G - Junction box (by others)
- H - Lumenbeam Grande
- I - Power and data wiring (by others)

## Daisy Chain Layout (DMX/RDM) - wiring detail (first or middle of run)

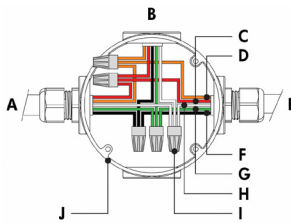

- A - From CBX or previous fixture
- B - To fixture
- C - Data +
- D - Data -
- E - To next/from previous fixture
- F - Live
- G - Ground
- H - Neutral
- I - Wire-nuts (by others)
- J - Junction box (by others)

## Daisy Chain Layout (DMX/RDM) - wiring detail (end of run)

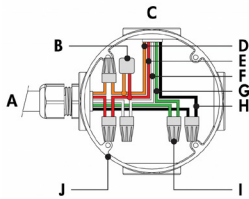

- A - From CBX or previous fixture
- B - Lumenterminator\*
- C - To fixture
- D - Data -
- E - Data +
- F - Neutral
- G - Ground
- H - Live
- I - Wire-nuts (by others)
- J - Junction box (by others)

Maximum number of fixtures per run (Based on 1.5A maximum, 16AWG cable, fixtures spaced 10ft on center, first fixture 50ft from CBX)				
Configuration/Voltage	120V	208V	240V	277V
<b>LBG</b>	10	16	18	21

- Consult factory for specific applications and maximum fixture count/cable length recommendations.
- The DMX/RDM protocol states a maximum of 32 DMX/RDM enabled fixtures on any single run.
- Maximum of 4 DMX/RDM repeaters/CBX cascading in line.
- Maximum of 1 output per CBX-DS.
- Maximum of 3 ft cable length between fixture and next junction box for daisy chain layout.
- Each fixture requires 1 DMX address.
- 1% minimum dimming value.
- 100 watts per fixture.

\* DMX terminator is required at the end of each run to maintain data integrity. (2x) DMX lumenterminators included per CBX-DS. See installation instructions for details.

Accessories (order separately)

**Control Boxes**

---

**CBX-DS-Power and control box - daisy chain configuration**

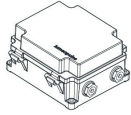

DMX/RDM control box. One power and data output to fixture or fixture run. Ethernet enabled option. Refer to CBX specification sheet for details.

**CBX-ST-Power and control box - star configuration**

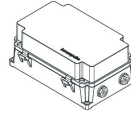

DMX/RDM control box. Up to six power and data outputs to fixtures or fixture runs. Ethernet enabled option. Refer to CBX specification sheet for details.

**Control Systems**

---

**LTO2-Lumentouch 2.0™**



Lumentouch is a wall mount DMX 512 controller keypad.

**LCU-Lumencie**



Lumencie is a USB / mini SD DMX 512 controller.

**LTN-Lumentone**



Lumentone is a simple pre-programmed DMX 512 controller with a push button rotary dial and live feedback.

**Diagnostic and Addressing Tools**

---

**LID-LumenID**



LumenID is a diagnostic and addressing DMX/RDM tool. It must be specified on all DMX applications. Refer to LID specification sheet for details.

**LID-LT-LumentalkID**



LumentalkID is a diagnostic and addressing tool. It must be specified for all Lumentalk (LT) applications. Refer to LID-LT specification sheet for details.

How to order							
1	2	3	4	5	6	7	8
LBG							
9	10	11					

**1 . Housing**

<b>LBG</b>	Lumenbeam™ Grande
------------	-------------------

**2 . Voltage**

<b>100</b>	100 volts
<b>120</b>	120 volts
<b>208</b>	208 volts
<b>220</b>	220 volts
<b>240</b>	240 volts
<b>277</b>	277 volts

**3 . Color and Color Temperature <sup>(1)</sup>**

<b>22K</b>	2200K
<b>27K</b>	2700K
<b>30K</b>	3000K
<b>35K</b>	3500K
<b>40K</b>	4000K
<b>57K</b>	5700K
<b>RD</b>	Red
<b>GR</b>	Green
<b>BL</b>	Blue

**4 . Optic1**

<b>XN</b>	Extra Narrow 4°
<b>VN</b>	Very Narrow 6°
<b>NS</b>	Narrow Spot 10°
<b>NF</b>	Narrow Flood 20°
<b>FL</b>	Flood 40°
<b>WFL</b>	Wide Flood 60° <sup>(2)</sup>

**5 . Optic2**

<b>XN</b>	Extra Narrow 4°
<b>VN</b>	Very Narrow 6°
<b>NS</b>	Narrow Spot 10°
<b>NF</b>	Narrow Flood 20°
<b>FL</b>	Flood 40°
<b>WFL</b>	Wide Flood 60° <sup>(2)</sup>

**6 . Optical Option**

<b>LSLH</b>	Linear spread lens horizontal distribution <sup>(3)</sup>
<b>LSLV</b>	Linear spread lens vertical distribution <sup>(3)</sup>

**7 . Finish**

<b>BK</b>	Black Sandtex®
<b>BRZ</b>	Bronze Sandtex®
<b>SI</b>	Silver Sandtex®
<b>WH</b>	Smooth white
<b>BKTX</b>	Textured black
<b>BRZTX</b>	Textured bronze non-metallic
<b>GRATX</b>	Textured medium gray
<b>GRNTX</b>	Textured green
<b>WHTX</b>	Textured white
<b>CC</b>	Custom color and finish (please specify RAL color) <sup>(4)</sup>

**lumenpulse™** 1220 Marie-Victorin Blvd., Longueuil, QC J4G 2H9 CA T 1.877.937.3003 | 514.937.3003 F 514.937.6289  
 info@lumenpulse.com www.lumenpulsegroup.com

Lumenpulse Group Inc. reserves the right to make changes to this product at any time without prior notice and such modification shall be effective immediately  
 2017.11.28 copyright © 2017 Lumenpulse Group Inc.  
 MG - R14

Project: ODOT SUM-8-1.75

Date: 10/07/2022

Type: F1E

HLB Project #:18173

Submittal: 100% Package

APPENDIX: LUMINAIRE CATALOGUE CUTS Note: This document is for information only. Refer to specifications for all catalog numbers, etc.

Horton Lees Brogden Lighting Design | 38 E 32nd St 11th Floor New York NY 10016 | P: 212 674 5580 | F: 212 254 2712 | www.HLBlighting.com

**8 . Control**

<b>NO</b>	On/Off control
<b>LT</b>	Lumentalk <sup>(5)</sup>
<b>DIM</b>	0-10V dimming
<b>DALI</b>	DALI dimming
<b>ES</b>	Lutron® EcoSystem® Enabled dimming
<b>DMX/RDM</b>	DMX/RDM enabled

**11 . Cable Length <sup>(7)</sup>**

<b>3FT</b>	3 ft <sup>(7)</sup> <sup>(8)</sup>
<b>10FT</b>	10 ft
<b>20FT</b>	20 ft
<b>30FT</b>	30 ft
<b>50FT</b>	50 ft
<b>70FT</b>	70 ft
<b>100FT</b>	100 ft

**9 . Options**

<b>SY</b>	Short Yoke
<b>3GV</b>	3G ANSI C136.31 Vibration Rating for bridge applications
<b>CRC</b>	Corrosion-resistant coating for hostile environments <sup>(6)</sup>

**10 . Certification**

<b>UL</b>	UL compliant
<b>CE</b>	CE compliant

**Notes:**

- <sup>(1)</sup> Consult factory for availability of static Royal Blue, 6500K and 90+ CRI.
- <sup>(2)</sup> Cannot be combined with other optics.
- <sup>(3)</sup> Factory installed, not available for 60° optic. Field adjustable spread lens optical accessory available, order separately.
- <sup>(4)</sup> Lumenpulse offers a wide selection of RAL CLASSIC (K7) colors with a smooth texture and high-gloss finish. Please consult factory for a list of available K7 colors, other RAL textures and glosses, or to match alternate color charts. Final color matching results may vary.
- <sup>(5)</sup> A Lumentranslator and LumentalkID (LIDL) must be specified for Lumentalk applications. Consult Lumentranslator and Lumentalk pages and specification sheets for details.
- <sup>(6)</sup> Use only when exposed to salt spray and harsh chemicals. This option is not required for normal outdoor exposure.
- <sup>(7)</sup> 3 ft cable length is standard unless otherwise specified.
- <sup>(8)</sup> Maximum of 3 ft cable length for daisy chain DMX applications with CBX-DS.

Project Name \_\_\_\_\_ Qty \_\_\_\_\_

Type \_\_\_\_\_ Catalog / Part Number \_\_\_\_\_

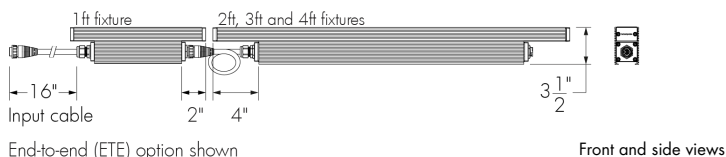
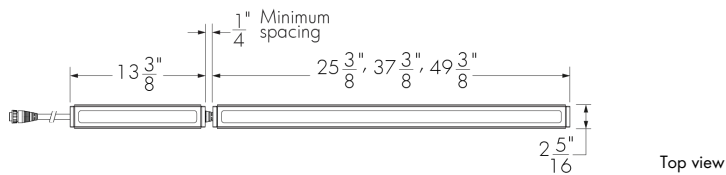

**Photometric Summary**

	Delivered output (lm)	Intensity (peak cd)
<b>WW</b>	3,592	5,159
<b>8°x8°</b>	4,045	77,896
<b>10°x10°</b>	3,768*	38,346*
<b>10°x30°</b>	3,830	30,056
<b>10°x60°</b>	3,692	19,654
<b>10°x90°</b>	3,576	7,897
<b>30°x30°</b>	3,765	14,726
<b>30°x60°</b>	3,862*	5,119*
<b>60°x60°</b>	3,447*	3,015*
<b>90°x90°</b>	3,592	1,886

Based on HO 4000K, 4ft [1219mm] configuration.  
Photometric performance is measured in compliance with IESNA LM-79-08.  
\*Estimated. Consult website for the latest photometric files.

**Optics**

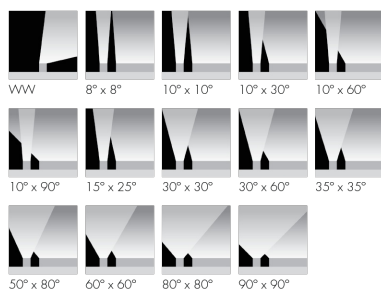

**Description**

The Lumenfacade is a high-performance linear LED luminaire for grazing or floodlighting exterior walls and facades. Featuring second generation LED technology, the luminaire is available in 12 in, 24 in, 36 in or 48 in sections, and can be configured with a wide number of options, including: optics for grazing or flood lighting; a choice of outputs (ASHRAE 5 W/ft, RO 8.5 W/ft or HO 15.25 W/ft); various color temperatures or static colors; various mounting options, finishes, accessories and controls. The Lumenfacade is also available with a unique asymmetric wallwash distribution, providing exceptional uniformity and brightness for walls and signage.

**Features**

<b>Color and Color Temperature</b>	2200K, 2700K, 3000K, 3500K, 4000K, Red, Green, Blue
<b>Length (nominal)</b>	12 in, 24 in, 36 in, 48 in
<b>Optics</b>	Asymmetric Wallwash, 8° x 8°, 10° x 10°, 10° x 30°, 10° x 60°, 10° x 90°, 15° x 25°, 30° x 30°, 30° x 60°, 35° x 35°, 50° x 80°, 60° x 60°, 80° x 80°, 90° x 90°
<b>Options</b>	End-to-end configuration (factory installed 16 in black input cable included), Corrosion-resistant coating for hostile environments, 3G ANSI C136.31 Vibration Rating for bridge applications, CE (certification covers European Economic Area)
<b>Power Consumption</b>	5 W/ft (meets ASHRAE standards for linear lighting on building facades - not available for 12 in fixture lengths), 8.5 W/ft (RO version), 15.25 W/ft (HO version), Typically 20% higher for 12 in fixture lengths
<b>Warranty</b>	5-year limited warranty



1220 Marie-Victorin Blvd., Longueuil, QC J4G 2H9 CA T United States 617.307.5700 | Canada 1.877.937.3003 | 514.937.3003 F 514.937.6289  
info@lumenpulse.com www.lumenpulse.com www.lumenpulse.com/products/1046/lumenfacade

Lumenpulse Group Inc. reserves the right to make changes to this product at any time without prior notice and such modification shall be effective immediately  
2019.01.10 copyright © 2019 Lumenpulse Group Inc.  
MG - R66

Project: ODOT SUM-8-1.75

Date: 10/07/2022

Type: F2A & F2B

HLB Project #:18173

Submittal: 100% Package

APPENDIX: LUMINAIRE CATALOGUE CUTS Note: This document is for information only. Refer to specifications for all catalog numbers, etc.

Horton Lees Brogden Lighting Design | 38 E 32nd St 11th Floor New York NY 10016 | P: 212 674 5580 | F: 212 254 2712 | www.HLBlighting.com

# Specification Sheet

**lumenfacade**  
LOG

WHITE AND STATIC COLORS

## Colors and Color Temperatures



## Controls

ON/OFF    0-10V    DALI



## Ratings

IP66    IK07\*  
\*asymmetric wallwash lens is IK06 rated

## Certifications



## Performance

<b>Illuminance at Distance</b>	Minimum 1 fc at 140 ft (HO 4000K, 48 in fixture, 10° x 60°, DMX/RDM)
<b>Color Consistency</b>	2 SDCM, 3 SDCM (2200K)
<b>Color Rendering</b>	Minimum CRI 80
<b>Lumen Maintenance</b>	L70 280,000 hrs, L95 35,000 hrs

## Physical

<b>Housing Material</b>	Low copper content extruded aluminum
<b>Lens Material</b>	Clear tempered glass
<b>Hardware Material</b>	Stainless steel
<b>End Cap Material</b>	Machined aluminum
<b>Gasket Material</b>	Silicone
<b>Surface Finish</b>	Electrostatically applied polyester powder coat
<b>Weight</b>	12 in: 4.5 lbs, 24 in: 7 lbs, 36 in: 10.5 lbs, 48 in: 14 lbs

## Electrical and control

<b>Voltage</b>	100 to 277 volts
<b>Fixture Cable</b>	Power and data in one cable, End-to-end option (ETE): 16 in black input cable (no jumper cable needed for minimum spacing between two fixtures)
<b>Leader Cable Conductors</b>	5C #16-5
<b>Maximum Cable and Fixture Run Length</b>	252 ft (On/Off, 277V, RO version), 164 ft (On/Off, 277V, HO version)
<b>Control</b>	On/Off control, Lumentalk, 0-10V dimming, DALI dimming, Lutron® EcoSystem® Enabled dimming, DMX/RDM enabled
<b>Resolution (DMX/RDM)</b>	Per foot or per fixture (configured with LumenID V3 software), 8-bit or 16-bit

## Environmental

<b>Storage Temperature</b>	-40 °F to 185 °F (device must reach start-up temperature value before operating)
<b>Start-up Temperature</b>	-13 °F to 122 °F
<b>Operating Temperature</b>	-40 °F to 122 °F
<b>Ingress Protection Rating</b>	IP66
<b>Impact Resistance Rating</b>	IK07 (asymmetric wallwash lens is IK06 rated)

**lumenpulse™**

1220 Marie-Victorin Blvd., Longueuil, QC J4G 2H9 CA    T United States 617.307.5700 | Canada 1.877.937.3003 | 514.937.3003    F 514.937.6289  
info@lumenpulse.com    www.lumenpulse.com    www.lumenpulse.com/products/1046/lumenfacade

Lumenpulse Group Inc. reserves the right to make changes to this product at any time without prior notice and such modification shall be effective immediately  
2019.01.10 copyright © 2019 Lumenpulse Group Inc.  
MG - R66

2 / 16

Project: ODOT SUM-8-1.75

Date: 10/07/2022

Type: F2A & F2B

HLB Project #:18173

Submittal: 100% Package

APPENDIX: LUMINAIRE CATALOGUE CUTS Note: This document is for information only. Refer to specifications for all catalog numbers, etc.

Horton Lees Brogden Lighting Design | 38 E 32nd St 11th Floor New York NY 10016 | P: 212 674 5580 | F: 212 254 2712 | www.HLBlighting.com



**Accessories (order separately)**

---

<b>Optical Accessories</b>	Lumenfacade Radial Louver
<b>Cables</b>	Leader cable (standard), Jumper cable (standard), Leader cable (ETE), Jumper cable (ETE)
<b>Control Boxes</b>	DMX/RDM enabled (daisy chain or star configuration), Ethernet enabled (daisy chain or star configuration), Lumentalk Data Bridge
<b>Control Systems</b>	Lumentone™ 2, Pharos® kit
<b>Diagnostic and Addressing Tools</b>	LumenID, LumentalkID

---

Project: ODOT SUM-8-1.75

Date: 10/07/2022

Type: F2A & F2B

HLB Project #:18173

Submittal: 100% Package

APPENDIX: LUMINAIRE CATALOGUE CUTS Note: This document is for information only. Refer to specifications for all catalog numbers, etc.

---

Horton Lees Brogden Lighting Design | 38 E 32nd St 11th Floor New York NY 10016 | P: 212 674 5580 | F: 212 254 2712 | [www.HLBlighting.com](http://www.HLBlighting.com)

**Asymmetric wallwash optic details**

**WWLF - Asymmetric wallwash optic, left feed**

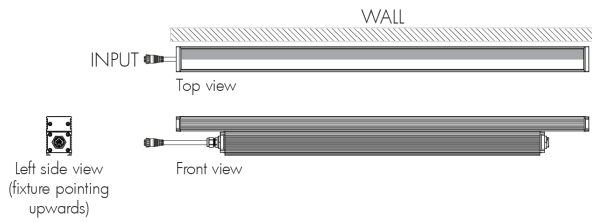

**WWRF - Asymmetric wallwash optic, right feed**

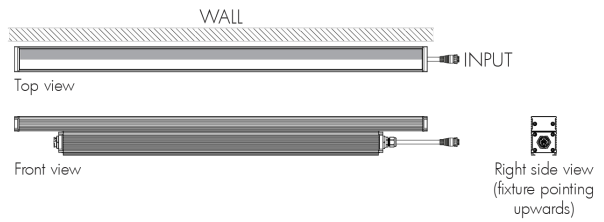

- Always position frosted side toward the wall.
- Fixture's feeding side is based on uplight installations. Feeding sides are reversed when fixture is used in a downlight application.
- Recommended setback from wall is 1/10 of the wall height. Example: 2 ft setback for a 20 ft wall.

**Mounting options**

**Surface Mount**

**SAM - Slim Adjustable Mounting**

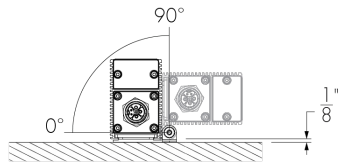

**SAM - Mounting hole pattern**

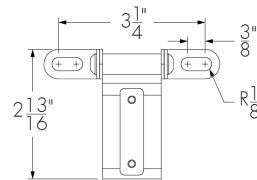

**UMP - Fixed Mounting**

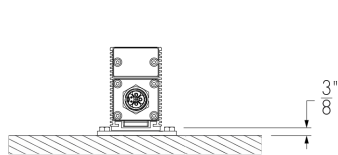

**UMP - Mounting hole pattern**

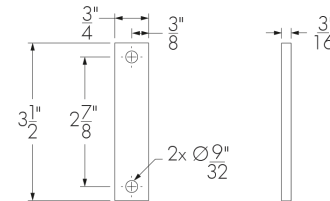

**Wall Mount**

**UMAS - Universal Adjustable Mounting**

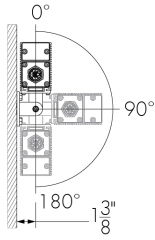

**UMAS - Mounting hole pattern**

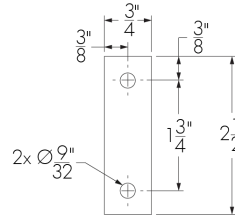

**WAM2 - Adjustable Wall Mounting 2 in**

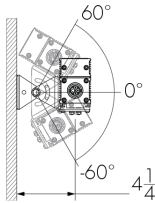

**WAM2 - Mounting hole pattern**

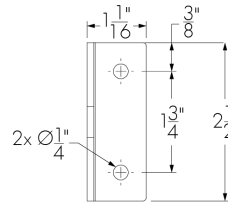

**WAM6 - Adjustable Extended Arm Mounting 6 in**

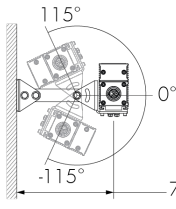

**WAM6 - Mounting hole pattern**

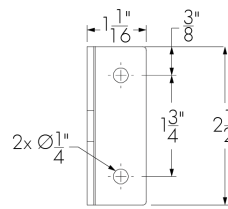

**WAM12 - Adjustable Extended Arm Mounting 12 in**

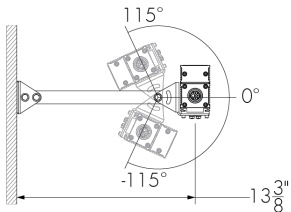

**WAM12 - Mounting hole pattern**

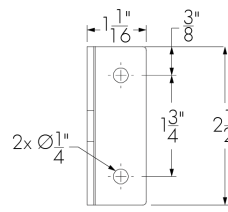

**WAM18 - Adjustable Extended Arm Mounting 18 in**

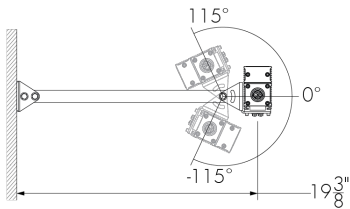

**WAM18 - Mounting hole pattern**

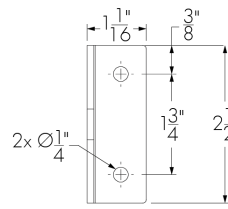

1220 Marie-Victorin Blvd., Longueuil, QC J4G 2H9 CA T United States 617.307.5700 | Canada 1.877.937.3003 | 514.937.3003 F 514.937.6289  
info@lumenpulse.com www.lumenpulse.com www.lumenpulse.com/products/1046/lumenfacade

Lumenpulse Group Inc. reserves the right to make changes to this product at any time without prior notice and such modification shall be effective immediately  
2019.01.10 copyright © 2019 Lumenpulse Group Inc.  
MG - R66

Project: ODOT SUM-8-1.75

Date: 10/07/2022

Type: F2A & F2B

HLB Project #:18173

Submittal: 100% Package

APPENDIX: LUMINAIRE CATALOGUE CUTS Note: This document is for information only. Refer to specifications for all catalog numbers, etc.

Horton Lees Brogden Lighting Design | 38 E 32nd St 11th Floor New York NY 10016 | P: 212 674 5580 | F: 212 254 2712 | www.HLBlighting.com

**End-to-end configuration option (ETE)**

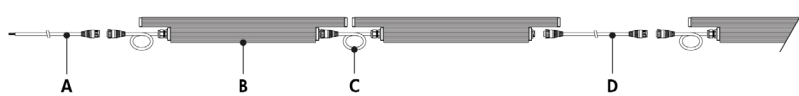

- A - ETE leader cable (order separately)
- B - Lumenpulse with ETE option
- C - ETE 16 in black input cable
- D - ETE jumper cable (order separately)

Includes a factory installed 16 in black input cable. A jumper cable is not required for minimum spacing between two end-to-end (ETE) fixtures. An ETE jumper cable is required only if a longer distance between two adjacent ETE fixtures is needed, or to connect two continuous runs of ETE fixtures together.

**Optical accessories (order separately)**

**LOGRD - Radial louver for Lumenpulse**

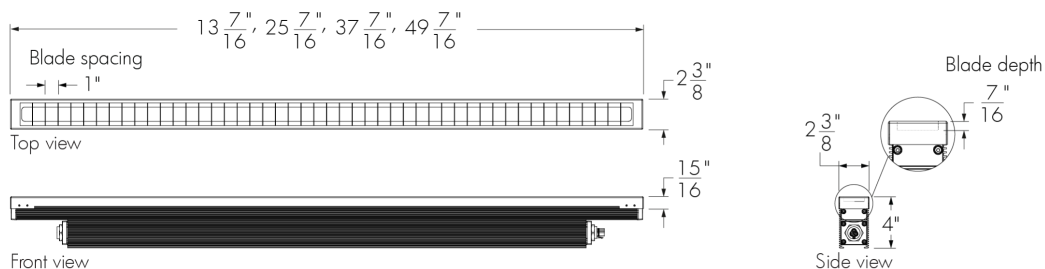

**LOGRD-LENGTH-FINISH-OPTIONS**

Please specify:

**LENGTH:** 12 in, 24 in, 36 in or 48 in; **FINISH:** BK - Black Sandtex®, BRZ - Bronze Sandtex®, SI - Silver Sandtex®, WH - Smooth white or CC - custom color and finish (please specify RAL color); **OPTIONS:** CRC - Corrosion-resistant coating for hostile environments

- The addition of a louver will affect beam distribution. Consult factory for application support.
- Not suitable for asymmetric wallwash optic.

**Cables (order separately)**

**LOGLC - Leader cable for Lumenfacade**



Standard construction

LOGLC-CERTIFICATION-STD-LENGTH-CABLE COLOR



End-to-end (ETE) option

LOGLC-CERTIFICATION-ETE-LENGTH-CABLE COLOR

Please specify:

**CERTIFICATION:** UL or CE; **LENGTH:** 10 ft, 25 ft, 50 ft, 100 ft, 150 ft or 200 ft; **CABLE COLOR:** black or white (connectors are black as standard; ETE fixture input cables are black as standard)

- Suitable for dimming/data and non-dimming applications.
- Sealing end cap is mandatory for any unused connector. One (1) included with every leader cable.
- Consult Lumenfacade leader cable specification sheet for details.

**LOGJC - Jumper cable for Lumenfacade**



Standard construction

LOGJC-CERTIFICATION-STD-LENGTH-CABLE COLOR



End-to-end (ETE) option

LOGJC-CERTIFICATION-ETE-LENGTH-CABLE COLOR

Please specify:

**CERTIFICATION:** UL or CE; **LENGTH:** 1 ft (available for ETE option only), 2 ft to 30 ft (available in 1 ft increments) or 50 ft; **CABLE COLOR:** black or white (connectors are black as standard; ETE fixture input cables are black as standard)

- Suitable for dimming/data and non-dimming applications.
- Consult Lumenfacade jumper cable specification sheet for details.

**Control boxes (order separately)**

**CBX-DMX/RDM - DMX/RDM enabled (daisy chain or star configuration)**

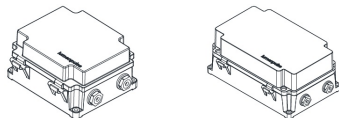

DMX/RDM control box. Up to six power and data outputs to fixtures or fixture runs. Consult CBX specification sheet and installation instructions for details. Lumeterminators provided with CBX (2x for daisy chain configuration, 6x for star configuration), consult factory to order spares.

**CBX-ENET - Ethernet enabled (daisy chain or star configuration)**

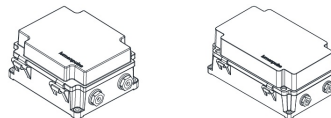

Ethernet control box. Up to four power and data outputs to fixture or fixture runs. Consult Ethernet CBX specification sheet and installation instructions for details.

**LDB - Lumentalk Data Bridge**

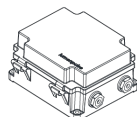

Lumentalk Data Bridge, 0-10V or DMX output. Consult LDB specification sheet for details.

**Control systems (order separately)**

**LITN2 - Lumentone™ 2**



Lumentone 2 is a simple pre-programmed DMX 512 controller with a push button rotary dial and live feedback.

**PHAROS - Pharos® kit**



The Pharos kit, available for 1 or 2 DMX universes, allows for complete control of large lighting installations. 2 DMX universes kit shown.

**Diagnostic and addressing tools (order separately)**

**LID - LumenID**



LumenID is a diagnostic and addressing DMX/RDM tool. It must be specified on all DMX applications. Consult LID specification sheet for details.

**LID-LT - LumentalkID**



LumentalkID is a diagnostic and addressing tool. It must be specified for all Lumentalk (LT) applications. Consult LID-LT specification sheet for details.

**Resolution details**

Resolution per foot: each 12 in section is addressed independently  
DMX addresses:

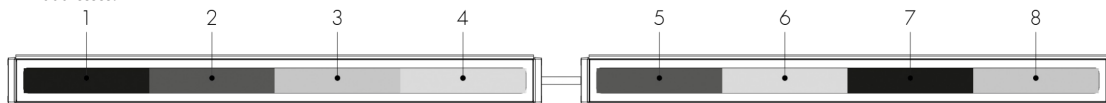

Resolution per fixture: each fixture is addressed independently  
DMX addresses:



- 48 in fixtures shown.
- Applicable for DMX/RDM control option only. Fixture resolution can be configured on-site within the LumenID V3 software. A DMX/RDM enabled CBX is required.

**Typical wiring diagrams**

**Wiring color code**

UL Color Code	USE
Green	Ground
Black	Line
White	Line/Neutral
Red or Purple	0-10V / Data +
Orange	0-10V / Data -

**On/Off control (NO)**

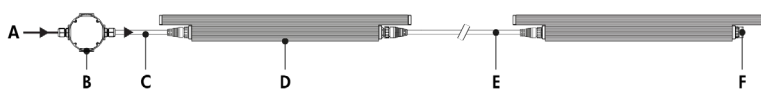

- A - Power input (100-277V, wiring by others)
- B - Junction box (by others)
- C - Leader cable (LOGLC)
- D - Lumenfacade
- E - Jumper cable (LOGJC)
- F - Sealing end cap

**On/Off control (NO) - wiring detail**

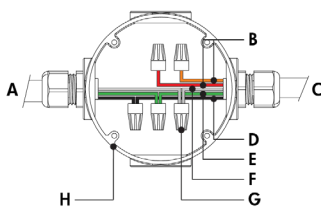

- A - Power input
- B - Not required
- C - To fixture
- D - Line
- E - Ground
- F - Line/Neutral
- G - Wire-nuts (by others)
- H - Junction box (by others)

- Consult factory for specific applications and maximum fixture count/cable length recommendations.
- ASHRAE version (not available for 12 in fixture lengths): 5 W/ft; Regular Output version: 8.5 W/ft; High Output version: 15.25 W/ft.

**Lumentalk (LT)**

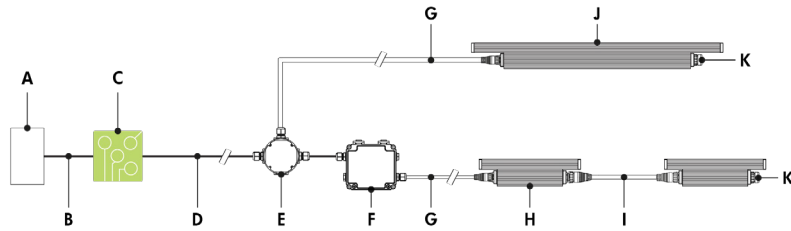

- A** - Dimmer/controller (order separately from Lumenpulse, or by others)
- B** - Data wiring (by others)
- C** - Lumentranslator (LTL-010, -DMX, -TRIAC, -DALI)
- D** - Power line (120-277V AC, wiring by others)
- E** - Junction box (by others)
- F** - Lumentalk Data Bridge (LDB-DIM or LDB-DMX)
- G** - Leader cable (LOGLC)
- H** - Lumenfacade 12 in
- I** - Jumper cable (LOGJC)
- J** - Lumenfacade (24 in, 36 in or 48 in fixture lengths)
- K** - Sealing end cap

**Lumentalk (LT) - wiring detail**

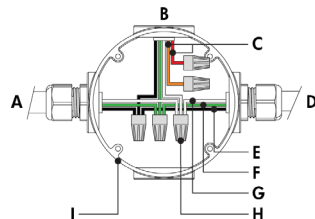

- A** - Power input (control over power line via Lumentalk system)
- B** - To fixture
- C** - Not required
- D** - To Lumentalk Data Bridge (for run lengths with 12 in fixtures)
- E** - Line
- F** - Ground
- G** - Line/Neutral
- H** - Wire-nuts (by others)
- I** - Junction box (by others)

- Consult factory for specific applications and maximum fixture count/cable length recommendations.
- Lumentalk Data Bridge required for 12 in fixture lengths, see LDB installation instructions for details.
- For applications with all fixtures controlled as 1 zone: fixtures and Lumentalk Data Bridge must be specified as DIM. Maximum of 10 fixtures per LDB-DIM, consult factory for applications that require additional capabilities.
- For applications with fixtures controlled individually: fixtures and Lumentalk Data Bridge must be specified as DMX, 2-step commissioning process: 1 - DMX/RDM system using LumenD software and a LID, 2 - Lumentalk system using LumentalkID software and a LID-LT. Maximum of 32 fixtures per LDB-DMX. Consult factory for details.
- For DMX applications: 1 DMX controller per Lumentalk network, maximum of 48 DMX channels per Lumentalk network (minimum step transition update rate is 1 second, minimum fade time between two colors is 1 minute). Consult factory for applications that require additional capabilities.
- Maximum of 1 transmitter (Lumentranslator or Lumenlink) per system.
- No third party fixtures allowed on the same circuit.
- Consult factory for DALI Lumentalk applications.
- 1% minimum dimming value.
- ASHRAE version (not available for 12 in fixture lengths): 5 W/ft; Regular Output version: 8.5 W/ft; High Output version: 15.25 W/ft.



**0-10V dimming (DIM)**

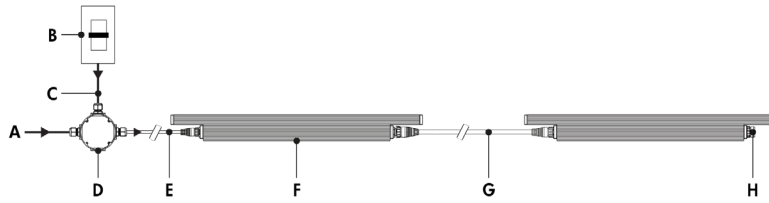

- A** - Power input (100-277V, wiring by others)
- B** - Dimmer (by others)
- C** - Data wiring (by others)
- D** - Junction box (by others)
- E** - Leader cable (LOGLC)
- F** - Lumenfacade
- G** - Jumper cable (LOGJC)
- H** - Sealing end cap

**0-10V dimming (DIM) - wiring detail**

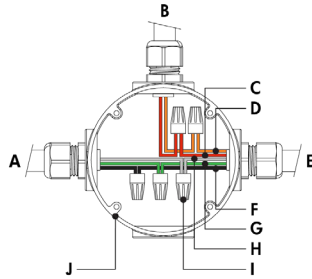

- A** - Power input
- B** - From dimmer (by others)
- C** - 0-10 V +
- D** - 0-10 V -
- E** - To fixture
- F** - Line
- G** - Ground
- H** - Neutral
- I** - Wire-nuts (by others)
- J** - Junction box (by others)

- Consult factory for specific applications and maximum fixture count/cable length recommendations.
- 0-10V mA ratings: passive dimmer (Current Sink): 3 mA per fixture, active dimmer (Current Source): 0.5 mA per fixture.
- 10% minimum dimming value.
- ASHRAE version (not available for 12 in fixture lengths): 5 W/ft; Regular Output version: 8.5 W/ft; High Output version: 15.25 W/ft.

**DALI dimming (DALI)**

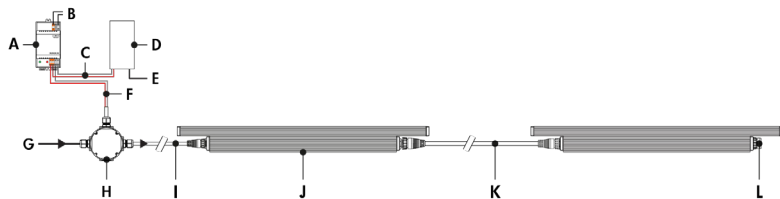

- A - DALI bus power supply (by others)
- B - Power input for DALI bus power supply (wiring by others)
- C - Data output to DALI controller (wiring by others)
- D - DALI controller (by others)
- E - Power input for DALI controller (wiring by others)
- F - Data output to fixture (wiring by others)
- G - Power input (100-277V, wiring by others)
- H - Junction box (by others)
- I - Leader cable (LOGLC)
- J - Lumenfacade
- K - Jumper cable (LOGJC)
- L - Sealing end cap

**DALI dimming (DALI) - wiring detail**

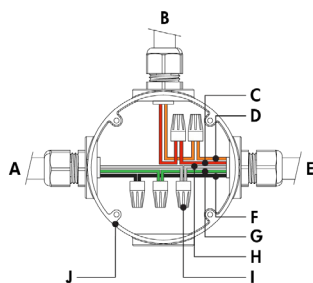

- A - Power input
- B - From DALI controller (by others)
- C - Data +
- D - Data -
- E - To fixture
- F - Line
- G - Ground
- H - Neutral
- I - Wire-nuts (by others)
- J - Junction box (by others)

- Consult factory for specific applications and maximum fixture count/cable length recommendations.
- Maximum of 64 DALI fixtures per DALI loop.
- 1% minimum dimming value.
- ASHRAE version (not available for 12 in fixture lengths): 5 W/ft; Regular Output version: 8.5 W/ft; High Output version: 15.25 W/ft.

**Lutron® EcoSystem® Enabled dimming (ES)**

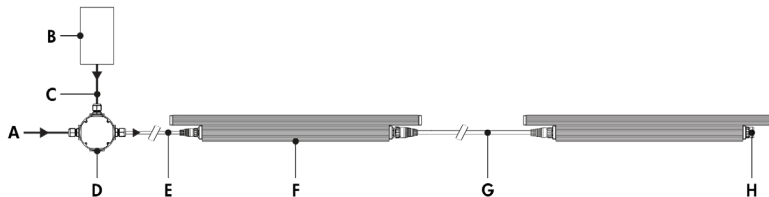

- A** - Power input (100-277V, wiring by others)
- B** - Lutron® EcoSystem® controller (by others)
- C** - Data wiring (by others)
- D** - Junction box (by others)
- E** - Leader cable (LOGLC)
- F** - Lumenfacade (24 in, 36 in or 48 in fixture lengths)
- G** - Jumper cable (LOGJC)
- H** - Sealing end cap

**Lutron® EcoSystem® Enabled dimming (ES) - wiring detail**

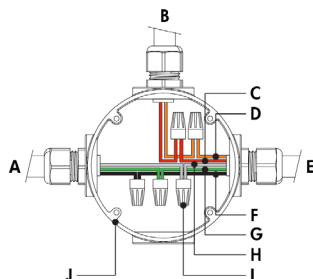

- A** - Power input
- B** - From Lutron® EcoSystem® controller (by others)
- C** - Data +
- D** - Data -
- E** - To fixture
- F** - Line
- G** - Ground
- H** - Neutral
- I** - Wire-nuts (by others)
- J** - Junction box (by others)

- Consult factory for specific applications and maximum fixture count/cable length recommendations.
- Each Lutron® EcoSystem® enabled fixture has its own address; for the example shown, there are a total of 2 EcoSystem® addresses.
- 1% minimum dimming value.
- ASHRAE version (not available for 12 in fixture lengths): 5 W/ft; Regular Output version: 8.5 W/ft; High Output version: 15.25 W/ft.

**Star Layout (DMX/RDM)**

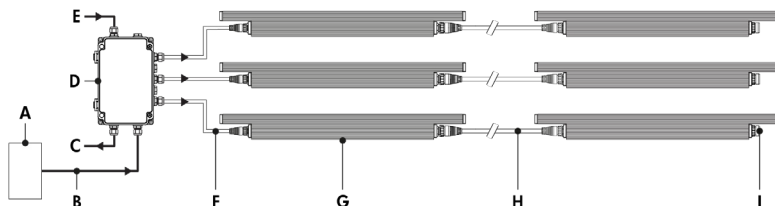

- A** - DMX/RDM controller (order separately from Lumenpulse, or by others)
- B** - Data input (Belden 9841 or equivalent, by others)
- C** - Data output to next CBX (optional, not isolated/not boosted)
- D** - CBX-ST
- E** - Power input (100-277V, wiring by others)
- F** - Leader cable (LOGLC)
- G** - Lumenfacade
- H** - Jumper cable (LOGJC)
- I** - Sealing end cap

**Daisy Chain Layout (DMX/RDM)**



- A** - DMX/RDM controller (order separately from Lumenpulse, or by others)
- B** - Data input (Belden 9841 or equivalent, by others)
- C** - Data output to next CBX (optional, not isolated/not boosted)
- D** - CBX-DS
- E** - Power input (100-277V, wiring by others)
- F** - Leader cable (LOGLC)
- G** - Lumenfacade
- H** - Jumper cable (LOGJC)
- I** - Sealing end cap

**Maximum run length**

Configuration/Voltage	120V	240V	277V
<b>LOG HO</b>	68ft	76ft	84ft
<b>LOG RO</b>	120ft	128ft	128ft
<b>LOG ASHRAE</b>	128ft	128ft	128ft

Based on 1.5A maximum, 50 ft leader cable.

- Consult CBX installation instructions for additional wiring details.
- Consult factory for specific applications and maximum fixture count/cable length recommendations. Maximum run length calculations are typically based on 48 in fixtures.
- The DMX/RDM protocol states a maximum of 32 DMX/RDM enabled fixtures on any single run.
- Maximum of 4 DMX/RDM repeaters/CBX cascading in line.
- Maximum of 6 outputs per CBX-ST; maximum of 1 output per CBX-DS.
- Each fixture requires 1 DMX address.
- 1% minimum dimming value.
- ASHRAE version (not available for 12 in fixture lengths): 5 W/ft; Regular Output version: 8.5 W/ft; High Output version: 15.25 W/ft.

**How to order**

1	2	3	4	5	6	7	8
9							

**1 . Housing <sup>(1)</sup>**

<b>LOG ASHRAE</b>	Lumenfacade™, 5 W/ft ASHRAE compliant <sup>(2)</sup>
<b>LOG RO</b>	Lumenfacade™ Regular Output, 8.5 W/ft
<b>LOG HO</b>	Lumenfacade™ High Output, 15.25 W/ft

<sup>(1)</sup> Power consumption is typically 20% higher for 12 in fixture lengths.  
<sup>(2)</sup> ASHRAE version not available for 12 in fixture lengths.

**2 . Voltage**

<b>100</b>	100 volts
<b>120</b>	120 volts
<b>208</b>	208 volts
<b>220</b>	220 volts
<b>240</b>	240 volts
<b>277</b>	277 volts

**3 . Length**

<b>12</b>	13 3/8 in (4.5 lbs) <sup>(1)</sup> <sup>(2)</sup>
<b>24</b>	25 3/8 in (7 lbs)
<b>36</b>	37 3/8 in (10.5 lbs)
<b>48</b>	49 3/8 in (14 lbs)

<sup>(1)</sup> Power consumption is typically 20% higher for 12 in fixture lengths.  
<sup>(2)</sup> To connect 12 in fixture lengths to the Lumentalk system, DIM or DMX/RDM must be specified as the control option, and a Lumentalk Data Bridge (LDB) is required. See the typical wiring diagrams in the specification sheet for details.

**4 . Color and Color Temperature <sup>(1)</sup>**

<b>22K</b>	2200K
<b>27K</b>	2700K
<b>30K</b>	3000K
<b>35K</b>	3500K
<b>40K</b>	4000K
<b>RD</b>	Red <sup>(2)</sup>
<b>GR</b>	Green <sup>(2)</sup>
<b>BL</b>	Blue <sup>(2)</sup>

<sup>(1)</sup> Consult factory for availability of static Royal Blue, 6500K and 90+ CRI.  
<sup>(2)</sup> Static colors made to order 8-10 weeks.

**5 . Optics**

<b>WWLF</b>	Asymmetric Wallwash, left feed
<b>WWRF</b>	Asymmetric Wallwash, right feed
<b>8x8</b>	8° x 8° <sup>(1)</sup>
<b>10x10</b>	10° x 10° <sup>(1)</sup>
<b>10x30</b>	10° x 30°
<b>10x60</b>	10° x 60°
<b>10x90</b>	10° x 90°
<b>15x25</b>	15° x 25°
<b>30x30</b>	30° x 30°
<b>30x60</b>	30° x 60°
<b>35x35</b>	35° x 35°
<b>50x80</b>	50° x 80°
<b>60x60</b>	60° x 60°
<b>80x80</b>	80° x 80°
<b>90x90</b>	90° x 90°

<sup>(1)</sup> For best results use with HO fixtures at a 6 in setback from surface. Contact factory for application support.

**6 . Mounting Options**

<b>SAM</b>	Slim Adjustable Mounting
<b>UMP</b>	Fixed Mounting <sup>(1)</sup>
<b>UMAS</b>	Universal Adjustable Mounting <sup>(1)</sup>
<b>WAM2</b>	Adjustable Wall Mounting 2 in
<b>WAM6</b>	Adjustable Extended Arm Mounting 6 in
<b>WAM12</b>	Adjustable Extended Arm Mounting 12 in
<b>WAM18</b>	Adjustable Extended Arm Mounting 18 in

<sup>(1)</sup> Suitable to use when 3GV option is specified.

**7 . Finish**

<b>BK</b>	Black Sandtex®
<b>BRZ</b>	Bronze Sandtex®
<b>SI</b>	Silver Sandtex®
<b>WH</b>	Smooth white
<b>CC</b>	Custom color and finish (please specify RAL color) <sup>(1)</sup>

<sup>(1)</sup> Lumenpulse offers a wide selection of RAL CLASSIC (K7) colors with a smooth texture and high-gloss finish. Please consult factory for a list of available K7 colors, other RAL textures and glosses, or to match alternate color charts. Final color matching results may vary.

**8 . Control**

<b>NO</b>	On/Off control
<b>LT</b>	Lumentalk <sup>(1)</sup> <sup>(2)</sup>
<b>DIM</b>	0-10V dimming
<b>DALI</b>	DALI dimming
<b>ES</b>	Lutron® EcoSystem® Enabled dimming <sup>(3)</sup>
<b>DMX/RDM</b>	DMX/RDM enabled <sup>(4)</sup>

<sup>(1)</sup> To connect 12 in fixture lengths to the Lumentalk system, DIM or DMX/RDM must be specified as the control option, and a Lumentalk Data Bridge (LDB) is required. See the typical wiring diagrams in the specification sheet for details.

<sup>(2)</sup> A Lumentranslator and LumentalkID (LIDLT) must be specified for Lumentalk applications. Consult Lumentranslator and Lumentalk pages and specification sheets for details.

<sup>(3)</sup> Available for 24 in (ASHRAE and RO only), 36 in and 48 in fixture lengths only.

<sup>(4)</sup> A control box (CBX) and LumenID (LID) must be specified.

**9 . Options**

<b>ETE</b>	End-to-end configuration (factory installed 16 in black input cable included)
<b>CRC</b>	Corrosion-resistant coating for hostile environments <sup>(1)</sup>
<b>3GV</b>	3G ANSI C136.31 Vibration Rating for bridge applications <sup>(2)</sup>
<b>CE</b>	CE (certification covers European Economic Area) <sup>(3)</sup>

<sup>(1)</sup> Use only when exposed to salt spray and harsh chemicals. This option is not required for normal outdoor exposure.

<sup>(2)</sup> Available with UMP and UMAS mounting options only.

<sup>(3)</sup> Consult European specification sheet and installation instructions for CE wiring information.

PROJECT: \_\_\_\_\_ TYPE: \_\_\_\_\_ CAT. #: MIM-HO-\_\_\_\_\_-\_\_\_\_\_-\_\_\_\_\_-\_\_\_\_\_-\_\_\_\_\_-\_\_\_\_\_- UNV-\_\_\_\_\_-AS-\_\_\_\_\_

**PROFILE**

LIGHT SOURCE	HIGH OUTPUT (17.0 W/FT)
OPTICS	10°X10° TO 100°X100°, ASY
CCT	RGBW, RGBA, RGBL, AWH (KELVIN TUNABLE (KELVIN TUNABLE 27K-65K)
PERFORMANCE	UP TO 28814 PEAK CANDELA
VOLTAGE	UNIVERSAL 120-277 V
POWER	INTEGRATED POWER SUPPLY
CONTROL	DMX FIXTURE, SYSTEM, OR FT BY FT RESOLUTION
HOUSING	EXTRUDED ALUMINIUM
LENS	CLEAR TEMPERED GLASS (8 MM)
FINISH	SILVER ANODIZED POWDER COAT FINISH
WARRANTY	5-YEAR LIMITED
PATENTS	PAT.: US D836,815
OPERATING TEMP	-20° C to 50° C
LUMEN MAINTENANCE	75,000 HRS L70
CERTIFICATION	ETL AND cETL FOR WET LOCATION IP68 (FOR IMMERSION UP TO 42" FOR 30 MINS) IK10 (WALK/DRIVE OVER COMPLIANT UP TO 5000 LBS)



**OPTICS**

Not all available options shown

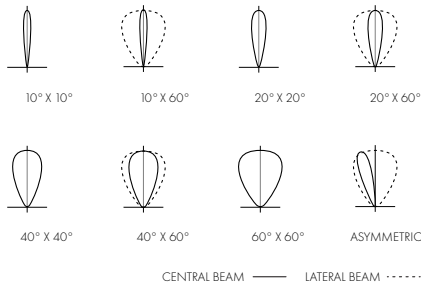

**DIMENSIONS**

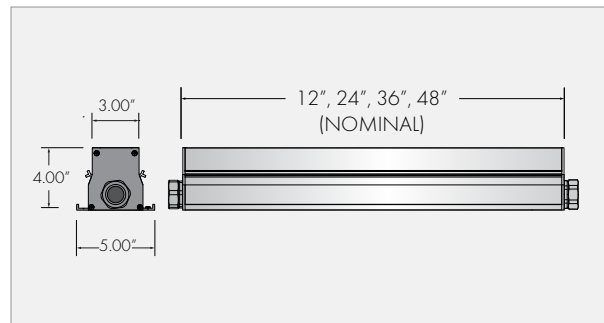

**PERFORMANCE SUMMARY**

RGBWq, HO, 48.00"	LUMENS	PEAK CANDELA
10° X 10°	2831	28814
10° X 60°	2545	8024
20° X 20°	3027	16233
20° X 60°	2734	6147
40° X 40°	3004	4282
40° X 60°	2693	2645
60° X 60°	2678	2172

**ACCESSORIES / OPTIONS**

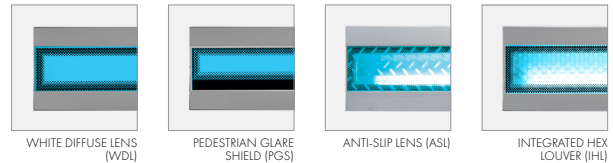

Revised 10/7/2021  
Specifications subject to change without notice

Project: ODOT SUM-8-1.75

Date: 10/07/2022

Type: F2C

HLB Project #:18173

Submittal: 100% Package

APPENDIX: LUMINAIRE CATALOGUE CUTS Note: This document is for information only. Refer to specifications for all catalog numbers, etc.

Horton Lees Brogden Lighting Design | 38 E 32nd St 11th Floor New York NY 10016 | P: 212 674 5580 | F: 212 254 2712 | [www.HLBlighting.com](http://www.HLBlighting.com)

PROJECT: \_\_\_\_\_ TYPE: \_\_\_\_\_ CAT. #: MIM - HO - \_\_\_\_\_ - \_\_\_\_\_ - \_\_\_\_\_ - UNV - \_\_\_\_\_ - AS - \_\_\_\_\_

**SPECIFICATION**

Separate options with dashes

MIM | HO | \_\_\_\_\_ | \_\_\_\_\_ | \_\_\_\_\_ | UNV | \_\_\_\_\_ | AS | \_\_\_\_\_

1 | 2 | 3 | 4 | 5 | 6 | 7 | 8 | 9

**1 FIXTURE**  
MEDLEY INGRADE MIM

**2 WATTAGE**  
HIGH OUTPUT HO  
170 W/FT

**3 CCT**  
RED, GREEN, BLUE, 40K RGBWq  
RED, GREEN, BLUE, AMBER RGBAg  
RED, GREEN, BLUE, LIME RGBLq  
RED, GREEN, BLUE, LIME RGBLq  
ACTIVE WHITE AWHq  
kelvin tunable 27K-65K

**4 OPTICS**  
10° X 10° 1010  
10° X 10° optic is intended for a 6.00" fixture setback from the source  
10° X 60° 1060  
20° X 20° 2020  
20° X 60° 2060  
40° X 40° 4040  
40° X 60° 4060  
60° X 60° 6060  
80° X 80° 8080  
100° X 100° 100100  
ASYMMETRIC ASYD  
ASYMMETRIC is intended for a wall height of 10.0 - 12.0 FT  
For best results a 24.00" setback is recommended

**5 FIXTURE LENGTH**  
12" 12  
24" 24  
36" 36  
48" 48

**6 VOLTAGE**  
UNIVERSAL UNV  
110-208V, 277V  
Contact factory for 347V (black cable/flying lead only)

**7 CONTROL OPTIONS**  
DMX FT BY FT RESOLUTION DMXFT  
DMX FIXTURE RESOLUTION DMXFX  
DMX SYSTEM RESOLUTION DMXSY  
DMX controls are required and must be ordered separately  
Requires a **DMX Programming Kit** see below  
Default factory programming setting is system resolution  
All fixtures are shipped from the factory with default channels 1-4  
Please contact factory for factory pre-addressing and labeling of fixtures

**8 FINISH**  
ANODIZED SILVER AS

**9 OPTIONS**  
WHITE DIFFUSE LENS WWS  
For direct view applications  
Available with 100° optics only  
Not available with Honeycomb Louver  
PEDESTRIAN GLARE SHIELD PGS  
ANTI-SLIP LENS ASL  
INTERNAL HONEYCOMB LOUVER IHL  
Internal Honeycomb Louver is not available with Asymmetric optics  
2.5 DEGREE TILT T2.5  
0° aiming is standard  
Tilt options must be done at the factory  
Tilt is not recommended with Asymmetric Optics  
5 DEGREE TILT T5  
0° aiming is standard  
Tilt options must be done at the factory  
Tilt is not recommended with Asymmetric Optics  
PLUG AND PLAY CONNECTION PNP  
PNP option allows for continuous fixture connection and carry power & data from fixture to fixture  
A T-Connector is provided (see page 5)  
May require jumper cables  
See below for details  
Contact factory for plug and play option for 347V or 480V

**CONTROL & WIRING ORDER OPTIONS**

[Go to DMX Guide >](#)

**DMX DISTRIBUTION & PROGRAMMING KIT - REQUIRED FOR DMX DIMMING**  
DMX/RDM Distribution Kit (4 OUTPUTS) - IP67 CDS-RDM  
DMX/RDM DISTRIBUTION KIT consists four outputs  
Each output is limited to (1) run per output - up to 32 fixtures max  
Three terminators are included for end of line termination.

**J-BOX STARTER KIT - OPTIONAL**  
IN68 INGRADE J-BOX STARTER KIT SK  
Converts line voltage and data to Insight's cabling system within the concrete pour box  
One STARLET KIT per circuit or run  
Not available with 12.00" fixture  
See page 3 for details

**EXTERIOR LEADER CABLES** [Go to Cable Guide >](#)  
25.0 FT BLACK LEADER CABLE LC-25-B  
Converts line voltage and data to Insight's cabling system outside of the concrete pour box (i-box by others)  
One leader cable is required for stand alone fixtures and for the first fixture in a plug and play continuous run (32 fixtures maximum per run, circuit limitations my apply)  
A leader cable is not required if a J-box starter kit is ordered  
See **J-box Starter Kit** below  
leaders and cables are not available with 347V or 480V

**EXTERIOR BLACK JUMPER CABLES**  
1.0 FT BLACK BLACK JUMPER CABLE JC-1-B  
2.0 FT BLACK JUMPER CABLE JC-2-B  
5.0 FT BLACK JUMPER CABLE JC-5-B  
10.0 FT BLACK JUMPER CABLE JC-10-B  
25.0 FT BLACK JUMPER CABLE JC-25-B  
Required if fixtures are not mounted in an end-to-end continuous manner and for line voltage only  
Leaders and cables are not available with 347V or 480V

Project: ODOT SUM-8-1.75

Date: 10/07/2022

Type: F2C

HLB Project #:18173

Submittal: 100% Package

APPENDIX: LUMINAIRE CATALOGUE CUTS Note: This document is for information only. Refer to specifications for all catalog numbers, etc.

Horton Lees Brogden Lighting Design | 38 E 32nd St 11th Floor New York NY 10016 | P: 212 674 5580 | F: 212 254 2712 | www.HLBlighting.com



PROJECT: \_\_\_\_\_ TYPE: \_\_\_\_\_ CAT. #: MIM-HO- \_\_\_\_\_ - \_\_\_\_\_ - UNV- \_\_\_\_\_ - AS- \_\_\_\_\_

**PERFORMANCE**

48.00" LENGTH				
LED CHIP	OPTIC	DELIVERED LUMENS	LUMINAIRE EFFICACY	PEAK CANDELA
RGBWq	10 X 10	2831 LM	33.0 LM/W	28814
	10 X 60	2545 LM	37.0 LM/W	8024
	20 X 20	3027 LM	42.0 LM/W	16233
	20 X 60	2734 LM	38.0 LM/W	6147
	40 X 40	3004 LM	44.0 LM/W	4282
	40 X 60	2693 LM	39.0 LM/W	2645
	60 X 60	2678 LM	36.0 LM/W	2172

**QUAD CHIP**

The quad array integrates multiple colors (i.e. red, green, blue, white) into a single location for immediate and superior color saturation. This is ideal for direct line of sight applications where the face of the fixture is visible, creating color consistency between the luminaire and the illuminated surface. LED color combinations may be customized to suit any application (i.e. royal blue, cyan, lime, white, etc.). Please contact the factory for special branding requirements.



Project: ODOT SUM-8-1.75

Date: 10/07/2022

Type: F2C

HLB Project #:18173

Submittal: 100% Package

APPENDIX: LUMINAIRE CATALOGUE CUTS Note: This document is for information only. Refer to specifications for all catalog numbers, etc.

PROJECT: \_\_\_\_\_ TYPE: \_\_\_\_\_ CAT. #: MIM-HO- \_\_\_\_\_ - \_\_\_\_\_ - UNV- \_\_\_\_\_ - AS- \_\_\_\_\_

**DIMENSIONS**

LENGTH	4"	12"	24"	36"	48"
DIM A	6.38"	14.38"	26.38"	38.38"	50.38"

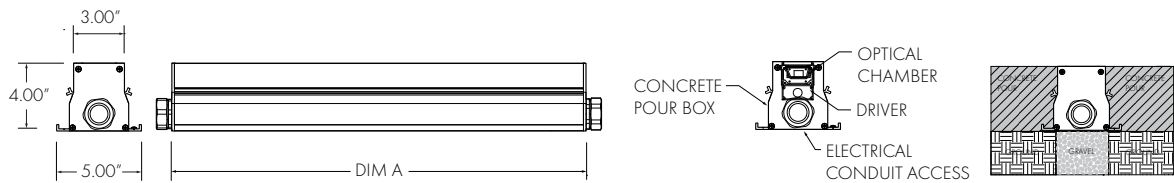

**PLUG AND PLAY CONTINUOUS RUN CONFIGURATION WITH SPACING** Jumper cable NOT required

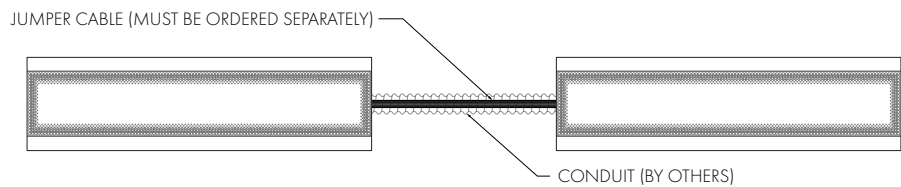

**PLUG AND PLAY CONTINUOUS END-TO-END RUN CONFIGURATION** Jumper cable required

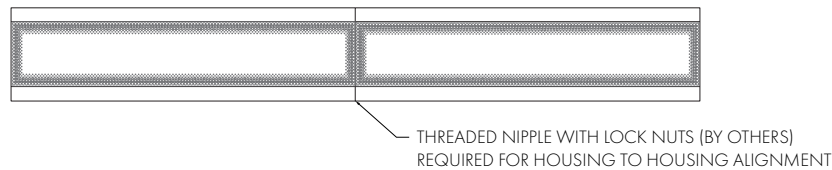

**WIRING GUIDE WITH J-BOX STARTER KIT**

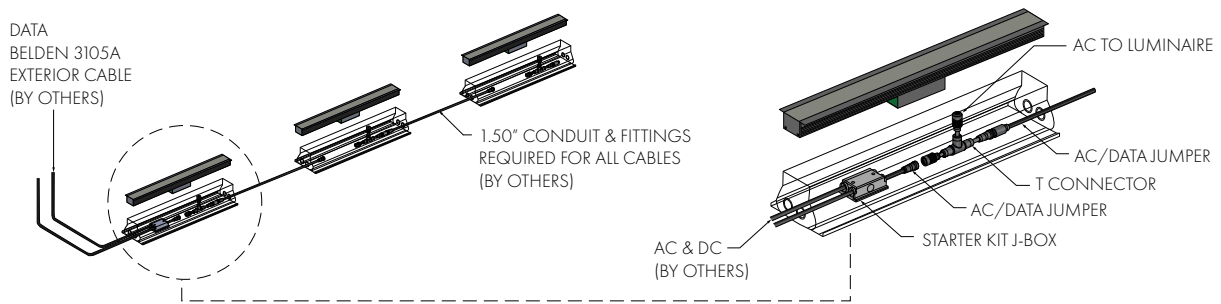

Project: ODOT SUM-8-1.75

Date: 10/07/2022

Type: F2C

HLB Project #:18173

Submittal: 100% Package

PROJECT: \_\_\_\_\_ TYPE: \_\_\_\_\_ CAT. #: MIM-HO- \_\_\_\_\_ - \_\_\_\_\_ - UNV- \_\_\_\_\_ - AS- \_\_\_\_\_

**CABLES**

**AC LEADER (LC-X)** WHITE/BLACK | 5x16AWG | 105°C | 300V | IP67

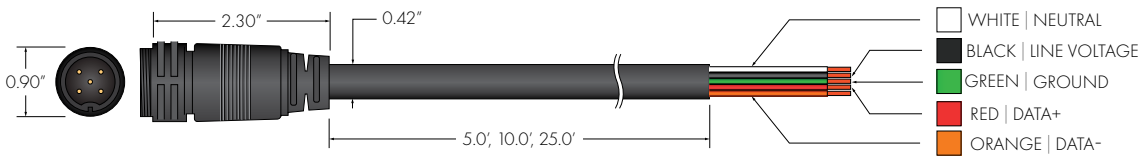

**AC JUMPER (JC-X)** WHITE/BLACK | 5 X 16 AWG | 105°C | 300V | IP67

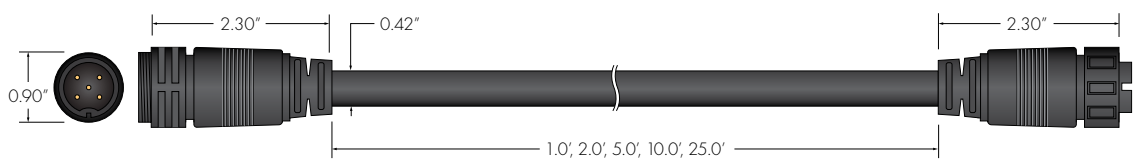

**AC CAP (EL11447)** WHITE/BLACK | 105°C | 300V | IP67



**AC TERMINATOR (EL11586)** WH/BL | 105°C | 300V

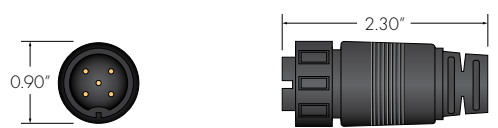

**AC T-CONNECTOR (ACT)** WHITE/BLACK | 5 X 16 AWG | 105°C | 300V | IP67

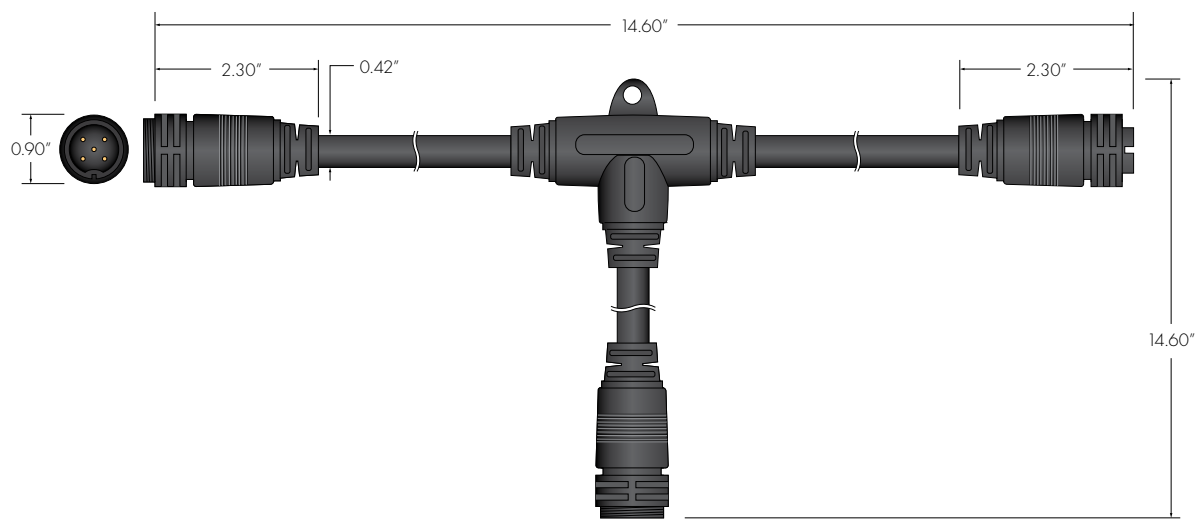

Project: ODOT SUM-8-1.75 Date: 10/07/2022 Type: F2C  
 HLB Project #:18173 Submittal: 100% Package

PROJECT: \_\_\_\_\_ TYPE: \_\_\_\_\_ CATALOG #: ME- \_\_\_\_\_ - G - \_\_\_\_\_

**PROFILE**

OUTPUT	LO (3.5W/FT), MO (9.0 W/FT), HO (15.0 W/FT)
OPTICS	10° X 10°, 10° X 60°, 10° X 90°, 20° X 20°, 20° X 60°, 40° X 40°, 40° X 60°, 40° X 90°, 60° X 60°, 60° X 90°, 80° X 80°, ASY
CCT	RGB30, RGB40, RGBA, AWH (27K-65K)
PERFORMANCE	UP TO 28771.0 PEAK CANDELA
VOLTAGE	120V OR 277V
POWER	INTEGRAL POWER SUPPLY
CONTROL	DMX+RDM
DIMENSIONS	2.60" X 2.00"
WEIGHT	2.75 LB (1.25 KG) PER FOOT
HOUSING	PRECISION EXTRUDED ALUMINUM
LENS	HIGH DENSITY TEMPERED GLASS
FINISH	HIGH DURABILITY POWDER COATING
OPERATING TEMP	-20° C TO 50° C
WARRANTY	5-YEAR LIMITED
LUMEN MAINTENANCE	75,000 HOURS
CERTIFICATION	ETL AND cETL FOR IP67, IK07, 5G/3G OPTIONS

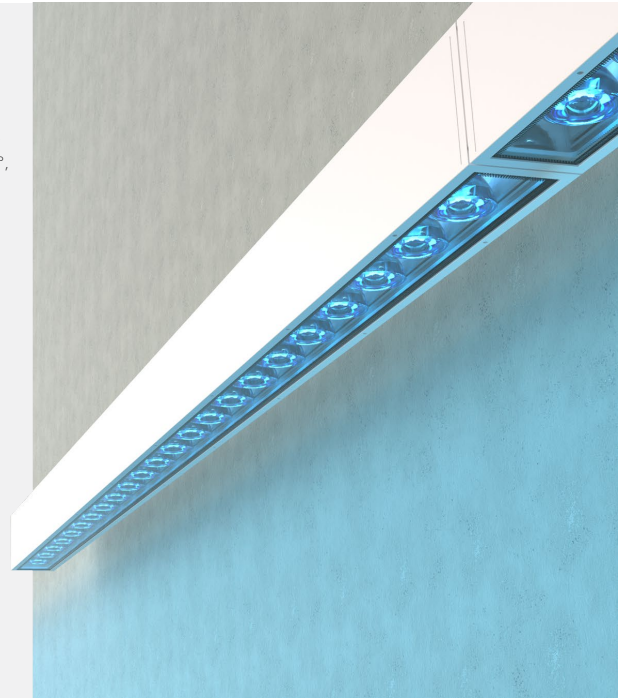

**OPTICS**

Not all available optics shown

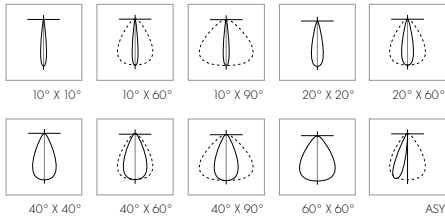

**PROFILE**

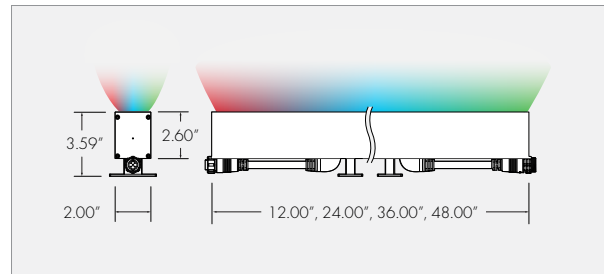

**QUAD CLUSTER LED CONFIGURATION**

The quad array integrates multiple colors (i.e. red, green, blue, white) into a single location for immediate and superior color saturation. This is ideal for direct line of sight applications where the face of the fixture is visible, creating color consistency between the luminaire and the illuminated surface. LED color combinations may be customized to suit any application (i.e. royal blue, cyan, lime, white, etc.). Please contact the factory for special branding requirements.



**OPTIONS**



Revised 08/11/2022  
Specifications subject to change without notice

Project: ODOT SUM-8-1.75

Date: 10/07/2022

Type: F2D & F2E

HLB Project #:18173

Submittal: 100% Package

APPENDIX: LUMINAIRE CATALOGUE CUTS Note: This document is for information only. Refer to specifications for all catalog numbers, etc.

PROJECT: \_\_\_\_\_ TYPE: \_\_\_\_\_ CATALOG #: ME- \_\_\_\_\_ - Q - \_\_\_\_\_ - \_\_\_\_\_ - \_\_\_\_\_ - \_\_\_\_\_ - \_\_\_\_\_ - \_\_\_\_\_

**SPECIFICATION**

ME \_\_\_\_\_ Q \_\_\_\_\_ \_\_\_\_\_ \_\_\_\_\_ \_\_\_\_\_ \_\_\_\_\_ \_\_\_\_\_ \_\_\_\_\_ \_\_\_\_\_ \_\_\_\_\_ \_\_\_\_\_ \_\_\_\_\_  
 1 2 3 4 5 6 7 8 9 10 11

**1 FIXTURE**

MEDLEY EXTERIOR	ME
-----------------	----

**2 WATTAGE**

LOW OUTPUT 3.5 W/FT	LO
MEDIUM OUTPUT 9.0 W/FT	MO
HIGH OUTPUT 15.0 W/FT	HO

**3 CCT**

RED, GREEN, BLUE, 30K	RGB30
RED, GREEN, BLUE, 40K	RGB40
RED, GREEN, BLUE, AMBER	RGBA
ACTIVE WHITE	AWH
Kelvin tunable 27K-65K	
LIFTED FULL SPECTRUM	LFS
LFS is available with Asymmetric optics only and 0-10V control only. Contact factory for custom CCTs	

**4 LED CONFIGURATION**

QUAD CLUSTER	Q
--------------	---

**5 OPTIC**

10° X 10°	1010
10° X 60°	1060
10° X 90°	1090
20° X 20°	2020
20° X 60°	2060
20° X 90°	2090
40° X 40°	4040
40° X 60°	4060
40° X 90°	4090
60° X 60°	6060
60° X 90°	6090
80° X 80°	8080
ASYMMETRIC DIRECT	AD
Direct = down-light	
ASYMMETRIC INDIRECT	AI
Indirect = up-light	

**6 MOUNTING**

SURFACE MOUNT	SM
5G ANSI C136.31 rated	
GROUND MOUNT	GM
EXTENDED ARM	EA-X
X = extended arm length specify 6", 12" or 18"	
6.00" arm is 3G ANSI C136.3 rated	
EXTENDED ARM, BACK	EAB-X
X = extended arm length specify 6", 12" or 18"	
SURFACE BACK MOUNT	SMB
FIXED MOUNT	FM
END MOUNT	EM
STAKE MOUNT	STM

**7 FIXTURE LENGTH**

12"	12
24"	24
36"	36
48"	48
Nominal lengths	

**8 VOLTAGE**

120V	120
277V	277

**9 CONTROL OPTIONS**

DMX FIXTURE RESOLUTION	DMXFX
DMX SYSTEM RESOLUTION	DMXSY
DMX FT BY FT RESOLUTION	DMXFT
DMX control system must be ordered separately	
CDS/RDM Distribution Kit is required and must be ordered separately - see below	
DMXCAT is required for on-site fixture resolution and addressing and must be ordered separately - see below	

**10 FINISH**

TEXTURED WHITE	TW
TEXTURED BLACK	TB
TEXTURED BRONZE	TBR
TEXTURED LIGHT BRONZE	TLB
TEXTURED GRAY	TG
TEXTURED SANDSTONE	TS
ANODIZED ALUMINUM	AA
Includes CRF finish	
CUSTOM COLOR	CC
Contact factory for custom color-additional charges will apply	

Separate options with dashes

**11 OPTIONS**

LOUVER	LV
Field installable snooted louver	
LLF of 10% - 15% depending on color	
VISOR	VS
Field installable visored louver	
LLF of 10% - 15% depending on color	
INTEGRAL HEX LOUVER	IHL
Not available with Asymmetric (AD & AI) optics	
DIRECT VIEW DOME LENS	DVD
Field installable	
LLF OF 30%	
Only available with 80° X 80°	
WHITE LENS	WL
LLF OF 30%	
Only available with 80° X 80°	
CONCEALED WIRING	CW
Not available with 12" fixture	
WHITE CABLING	WC
White cabling is standard with textured white finish	
CORROSION RES. FINISH	CRF
Corrosion Resistance Finish Complies with ASTM B117 standard	
CRF is recommended for coastal or extreme exterior environments	

**CONTROL & WIRING ORDER OPTIONS**

**CONTROLS - REQUIRED**

DMX/RDM DISTRIBUTION KIT (4 OUTPUTS) - IP67	CDS-RDM
DMX/RDM Distribution Kit consists of four outputs	
Each output is limited to (1) run per output - up to 32 fixtures max	
Four terminators are included for end of line termination.	
REMOTE DMX/RDM ADDRESSING AND MONITORING TOOL	DMXCAT
DMXCAT Remote Addressing and Monitoring Tool uses Bluetooth LE technology for communication with the smartphone/applications (up to 50' range)	
Allows for on-site fixture resolution and addressing	

**EXTERIOR LEADER CABLE - REQUIRED**

5.0 FT LEADER CABLE	LC-5
A leader cable is required for each single fixture and for each fixture run for connection from the first fixture to the i-box	
Black cables are standard unless White Cabling (WC) option or Textured White (TW) fixture finish is selected	
See maximum fixture run length information on page 4	

**EXTERIOR JUMPER CABLES**

1.0 FT JUMPER CABLE	JC-1
2.0 FT JUMPER CABLE	JC-2
5.0 FT JUMPER CABLE	JC-5
10.0 FT JUMPER CABLE	JC-10
25.0 FT JUMPER CABLE	JC-25
Required if fixtures are not mounted in an end-to-end continuous manner and for line voltage only	
Black cables are standard unless White Cabling (WC) option or Textured White (TW) fixture finish is selected	
See maximum fixture run length information on page 4	

Project: ODOT SUM-8-1.75 Date: 10/07/2022 Type: F2D & F2E  
 HLB Project #:18173 Submittal: 100% Package

PROJECT: \_\_\_\_\_ TYPE: \_\_\_\_\_ CATALOG #: ME- \_\_\_\_\_ - \_\_\_\_\_ - \_\_\_\_\_ - \_\_\_\_\_ - \_\_\_\_\_ - \_\_\_\_\_ - \_\_\_\_\_

**PERFORMANCE**

CCT AND LENGTH	OPTIC	LOW OUTPUT (3.5 W/FT)			MEDIUM OUTPUT (9.0 W/FT)			HIGH OUTPUT (15.0 W/FT)		
		DELIVERED LUMENS	LUMINAIRE EFFICACY	PEAK CANDELA	DELIVERED LUMENS	LUMINAIRE EFFICACY	PEAK CANDELA	DELIVERED LUMENS	LUMINAIRE EFFICACY	PEAK CANDELA
RGB40 24.00"	10° X 10°	290.0 LM	41.3 LM/W	2949	736.0 LM	41.3 LM/W	7480	1415.5 LM	41.3 LM/W	14386
	10° X 60°	261.0 LM	371 LM/W	824	662.0 LM	371 LM/W	2090	1272.5 LM	371 LM/W	4020
	20° X 20°	310.0 LM	42.0 LM/W	1664	7870 LM	42.0 LM/W	4221	1513.0 LM	42.0 LM/W	8117
	20° X 60°	280.0 LM	379 LM/W	631	711.0 LM	379 LM/W	1601	1367.5 LM	379 LM/W	3080
	40° X 40°	308.0 LM	43.8 LM/W	439	781.0 LM	43.8 LM/W	1113	1502.0 LM	43.8 LM/W	2141
	40° X 60°	276.0 LM	39.3 LM/W	271	700.0 LM	39.3 LM/W	688	13470 LM	39.3 LM/W	1324
	60° X 60°	275.0 LM	36.5 LM/W	222	6970 LM	36.5 LM/W	563	1339.5 LM	36.5 LM/W	1084
	100° X 100°	1670 LM	23.8 LM/W	82	425.0 LM	23.8 LM/W	209	816.5 LM	23.8 LM/W	402
RGB40 36.00"	10° X 10°	435.0 LM	41.3 LM/W	4424	1104.0 LM	41.3 LM/W	11221	2123.0 LM	41.3 LM/W	21578
	10° X 60°	391.0 LM	371 LM/W	1236	993.0 LM	371 LM/W	3136	1909.0 LM	371 LM/W	6030
	20° X 20°	465.0 LM	42.0 LM/W	2496	1180.0 LM	42.0 LM/W	6331	2270.0 LM	42.0 LM/W	12175
	20° X 60°	421.0 LM	379 LM/W	947	10670 LM	379 LM/W	2402	2051.0 LM	379 LM/W	4619
	40° X 40°	462.0 LM	43.8 LM/W	658	1172.0 LM	43.8 LM/W	1670	2253.0 LM	43.8 LM/W	3211
	40° X 60°	414.0 LM	39.3 LM/W	407	1051.0 LM	39.3 LM/W	1030	2021.0 LM	39.3 LM/W	1985
	60° X 60°	412.0 LM	36.5 LM/W	333	1045.0 LM	36.5 LM/W	845	2009.0 LM	36.5 LM/W	1625
	100° X 100°	251.0 LM	23.8 LM/W	123	6370 LM	23.8 LM/W	313	1225.0 LM	23.8 LM/W	602
RGB40 48.00"	10° X 10°	580.0 LM	41.3 LM/W	5898	1472.0 LM	41.3 LM/W	14961	2831.0 LM	41.3 LM/W	28771
	10° X 60°	522.0 LM	371 LM/W	1648	1323.0 LM	371 LM/W	4181	2545.0 LM	371 LM/W	8040
	20° X 20°	620.0 LM	42.0 LM/W	3328	1574.0 LM	42.0 LM/W	8441	3026.0 LM	42.0 LM/W	16233
	20° X 60°	561.0 LM	379 LM/W	1263	1422.0 LM	379 LM/W	3203	2735.0 LM	379 LM/W	6159
	40° X 40°	616.0 LM	43.8 LM/W	878	1562.0 LM	43.8 LM/W	2226	3004.0 LM	43.8 LM/W	4281
	40° X 60°	552.0 LM	39.3 LM/W	543	1401.0 LM	39.3 LM/W	1376	2694.0 LM	39.3 LM/W	2647
	60° X 60°	549.0 LM	36.5 LM/W	444	1393.0 LM	36.5 LM/W	1127	2679.0 LM	36.5 LM/W	2167
	100° X 100°	335.0 LM	23.8 LM/W	164	849.0 LM	23.8 LM/W	418	1633.0 LM	23.8 LM/W	803

**WIRING**

**MAXIMUM FIXTURES (PER LEADER CABLE)**

LOW OUTPUT (3.5 W/FT)		MEDIUM OUTPUT (9.0 W/FT)		HIGH OUTPUT (15.0 W/FT)	
120V	277V	120V	277V	120V	277V
32 FIXTURES	32 FIXTURES	32 FIXTURES	32 FIXTURES	UP TO 32 FIXTURES <b>Not to exceed 1200 Watts</b>	UP TO 32 FIXTURES <b>Not to exceed 1200 Watts</b>

PROJECT: \_\_\_\_\_ TYPE: \_\_\_\_\_ CATALOG #: ME- \_\_\_\_\_ - \_\_\_\_\_ - \_\_\_\_\_ - \_\_\_\_\_ - \_\_\_\_\_ - \_\_\_\_\_ - \_\_\_\_\_ - \_\_\_\_\_ - \_\_\_\_\_

**DIMENSIONS**

	12.00"	24.00"	36.00"	48.00"
DIM A	12.10"	23.85"	35.60"	47.35"
DIM B	9.28"	4.00" MIN   6.00" MAX	12.00" MIN   18.00" MAX	18.00" MIN   30.00" MAX

**SURFACE MOUNT (SM)**

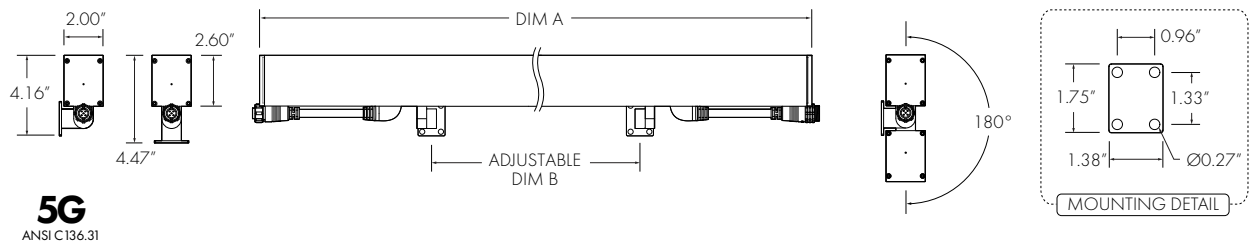

**5G**  
ANSI C136.31

**GROUND MOUNT (GM)**

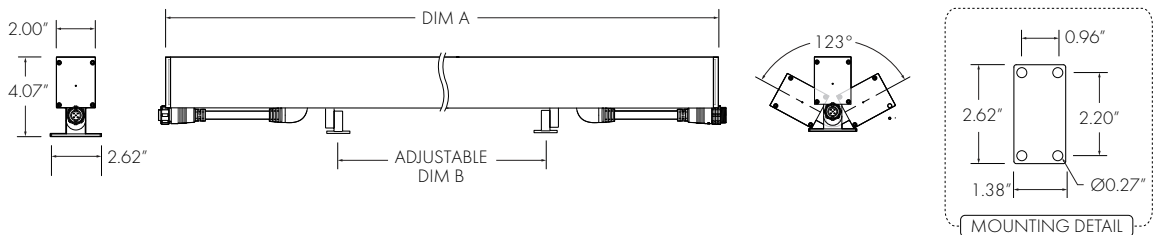

**EXTENDED ARM (EA-X)**

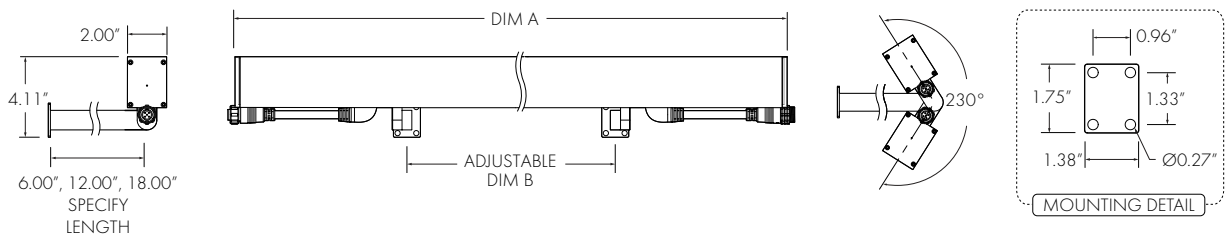

**3G**  
ANSI C136.3  
3G rated with 6.00" arm

Project: ODOT SUM-8-1.75

Date: 10/07/2022

Type: F2D & F2E

HLB Project #:18173

Submittal: 100% Package

APPENDIX: LUMINAIRE CATALOGUE CUTS Note: This document is for information only. Refer to specifications for all catalog numbers, etc.

Horton Lees Brogden Lighting Design | 38 E 32nd St 11th Floor New York NY 10016 | P: 212 674 5580 | F: 212 254 2712 | www.HLBlighting.com

PROJECT: \_\_\_\_\_ TYPE: \_\_\_\_\_ CATALOG #: ME- \_\_\_\_\_ - \_\_\_\_\_ - \_\_\_\_\_ - \_\_\_\_\_ - \_\_\_\_\_ - \_\_\_\_\_ - \_\_\_\_\_

**DIMENSIONS**

	12.00"	24.00"	36.00"	48.00"
DIM A	12.10"	23.85"	35.60"	47.35"
DIM B	9.28"	4.00" MIN   6.00" MAX	12.00" MIN   18.00" MAX	18.00" MIN   30.00" MAX

**FIXED MOUNT (FM)**

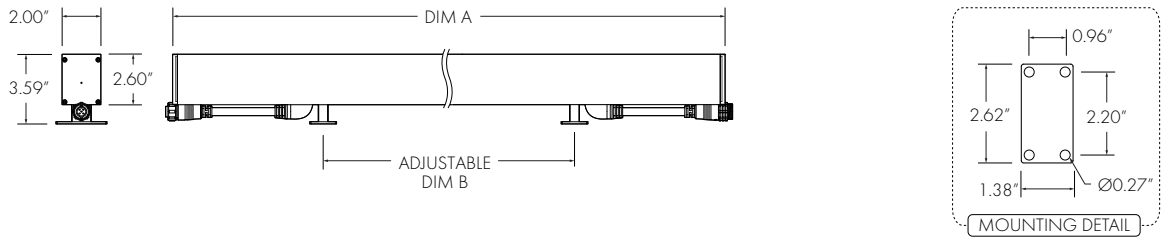

**SURFACE, BACK MOUNT (SMB)**

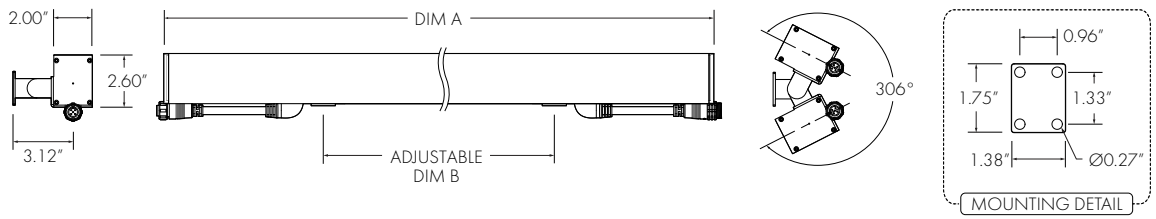

**EXTENDED ARM, BACK MOUNT (EAB-X)**

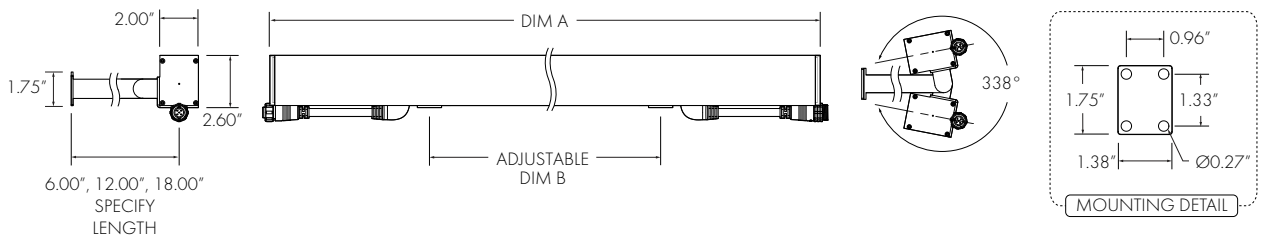

Project: ODOT SUM-8-1.75

Date: 10/07/2022

Type: F2D & F2E

HLB Project #:18173

Submittal: 100% Package

APPENDIX: LUMINAIRE CATALOGUE CUTS Note: This document is for information only. Refer to specifications for all catalog numbers, etc.

Horton Lees Brogden Lighting Design | 38 E 32nd St 11th Floor New York NY 10016 | P: 212 674 5580 | F: 212 254 2712 | www.HLBlighting.com



PROJECT: \_\_\_\_\_ TYPE: \_\_\_\_\_ CATALOG #: ME- \_\_\_\_\_ - \_\_\_\_\_ - \_\_\_\_\_ - \_\_\_\_\_ - \_\_\_\_\_ - \_\_\_\_\_ - \_\_\_\_\_ - \_\_\_\_\_

**DIMENSIONS**

	12.00"	24.00"	36.00"	48.00"
DIM A	12.10"	23.85"	35.60"	47.35"
DIM B	11.65"	22.31"	34.06"	45.81"
DIM C	10.56"	4.00" MIN   6.00" MAX	12.00" MIN   18.00" MAX	18.00" MIN   30.00" MAX

**END MOUNT (EM)**

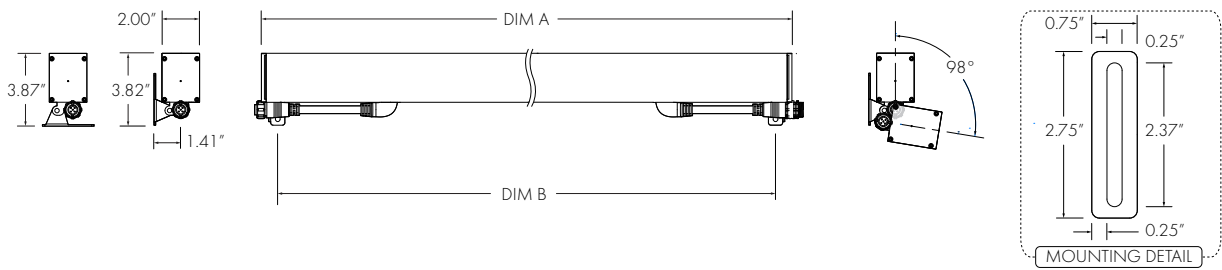

**STAKE MOUNT**

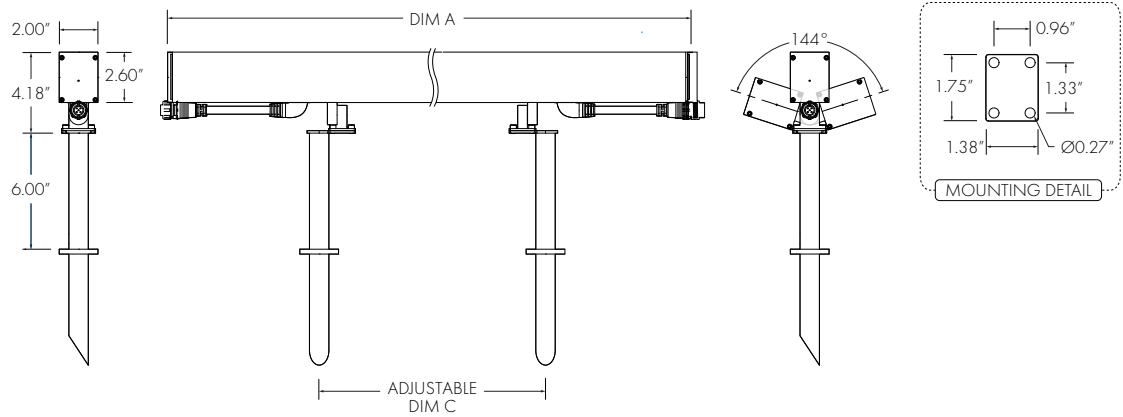

Project: ODOT SUM-8-1.75

Date: 10/07/2022

Type: F2D & F2E

HLB Project #:18173

Submittal: 100% Package

APPENDIX: LUMINAIRE CATALOGUE CUTS Note: This document is for information only. Refer to specifications for all catalog numbers, etc.

PROJECT: [ ] TYPE: [ ] CATALOG #: ME- [ ] - [ ] - [ ] - [ ] - [ ] - [ ] - [ ] - [ ] - [ ] - [ ]

**ACCESSORIES**

**LOUVER (LV)**

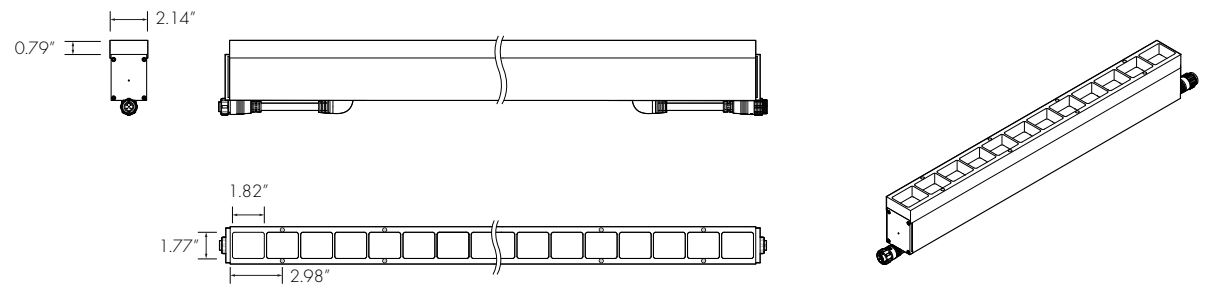

**DIRECT VIEW LENS (DV)**

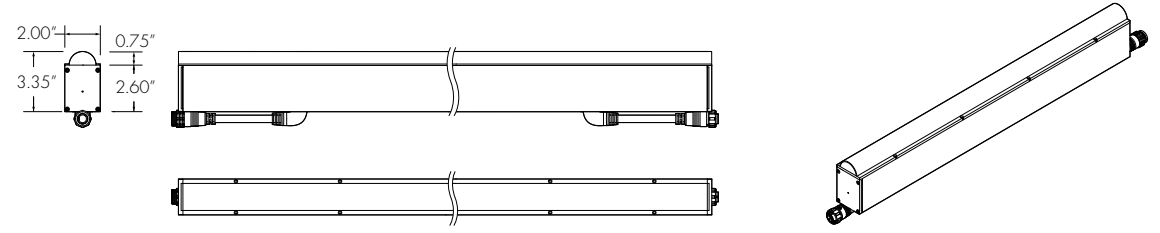

**VISOR (VS)**

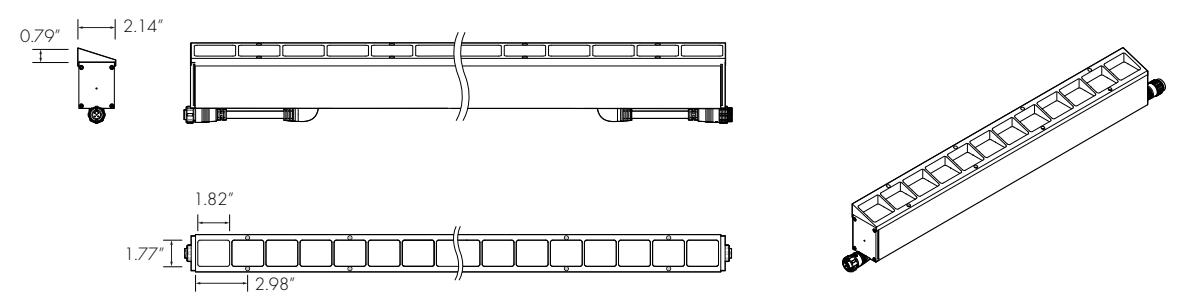

**CONCEALED WIRING (CW)**

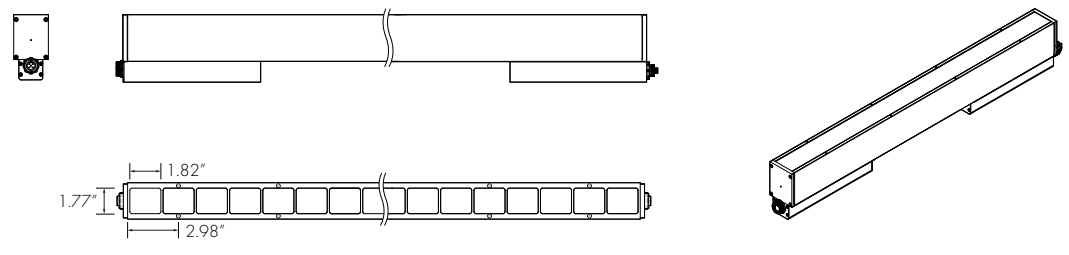

Project: ODOT SUM-8-1.75 Date: 10/07/2022 Type: F2D & F2E  
HLB Project #:18173 Submittal: 100% Package

PROJECT: \_\_\_\_\_ TYPE: \_\_\_\_\_ CATALOG #: ME- \_\_\_\_\_ - \_\_\_\_\_ - \_\_\_\_\_ - \_\_\_\_\_ - \_\_\_\_\_ - \_\_\_\_\_ - \_\_\_\_\_

**CABLES**

**AC LEADER (LC-X)** WHITE/BLACK | 5 X 16 AWG | 105°C | 300V | IP67

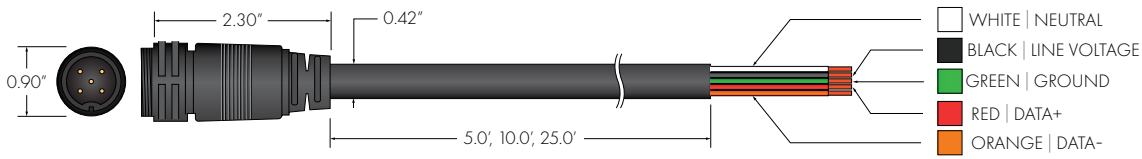

**AC JUMPER (JC-X)** WHITE/BLACK | 5 X 16 AWG | 105°C | 300V | IP67

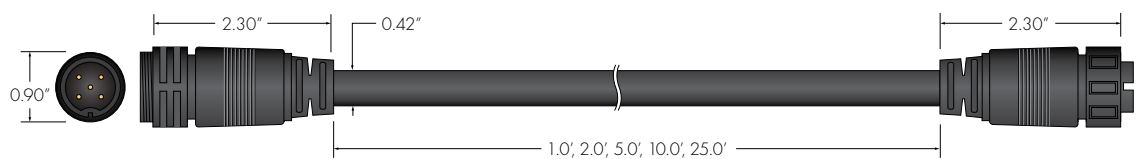

**AC CAP (EL11447)** WHITE/BLACK | 105°C | 300V | IP67



**AC TERMINATOR (EL11586)** WH/BL | 105°C | 300V

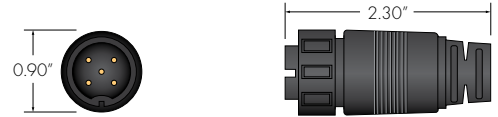

Date: \_\_\_\_\_ Quantity: \_\_\_\_\_

Company: \_\_\_\_\_

Project: \_\_\_\_\_



## PROPOINT™ Pixel RGBW Clear Lens

The PROPOINT Pixel RGBW Clear Lens is an AC line powered, high brightness luminaire. The luminaire is controllable via DMX512 with Remote Device Management (RDM). The system is connected using a daisy chain topology, allowing easy installation to form long run lengths. The PROPOINT Pixel RGBW Clear Lens is ideal for all types of exterior architectural, retail and hospitality applications, providing powerful, vibrant, full-color and white accents and media.

### Product Specifications

<b>Model</b>	PROPOINT Pixel Clear Lens
<b>Light Source</b>	4-in-1 LED cluster x 10
<b>Color Range</b>	RGBW (White CCT – 4000K standard) Other White CCT and RGBA available <sup>1</sup>
<b>Viewing Angle</b>	100°
<b>Luminous Flux</b>	632 lm
<b>Efficacy</b>	30 lm/W
<b>Lumen Maintenance</b>	L <sub>70</sub> @ 25° 81,000 hours
<b>Cover Lens</b>	2.0mm UV stable polycarbonate
<b>Housing</b>	Die Cast Aluminum
<b>Size</b>	144.8 x 81.3 x 119.4mm (5.7" x 3.2" x 4.7")
<b>Weight</b>	1.3 kgs (2.87 lbs.)
<b>Regulatory/Product Certifications</b>	cETLus, CE, FCC, RoHS, REACH, ASTM B117-16, ANSI 3G, IK10
<b>Operating Temperature</b>	-30°C to +50°C (-22°F to +122°F)
<b>Minimum Starting Temperature</b>	-20°C (-4°F)
<b>Storage Temperature</b>	-40°C to +80°C (-40°F to +176°F)
<b>Environment</b>	IP66 Outdoor, suitable for coastal environments
<b>Humidity</b>	85%, non-condensing

### Electrical Specifications

<b>Input Voltage<sup>2</sup></b>	100-277V <sub>AC</sub> 50/60Hz
<b>Power Consumption</b>	20W
<b>Power Factor</b>	≥0.9

Project: ODOT SUM-8-1.75

Date: 10/07/2022

Type: F3A

HLB Project #:18173

Submittal: 100% Package

APPENDIX: LUMINAIRE CATALOGUE CUTS Note: This document is for information only. Refer to specifications for all catalog numbers, etc.

Source Specifications

LED Source	10 4-in-1 RGBW Clusters
Viewing Angle	100°
Cover Lens	Clear UV stable polycarbonate

Candela Distribution

Light Output

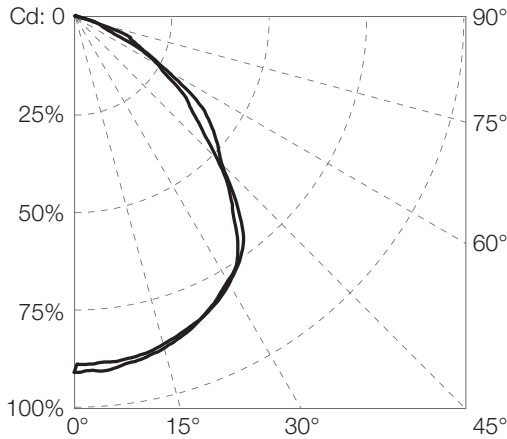

Color Temperature	Luminous Flux (lm)	Candela Distribution @100%	Efficacy (lm/W)
White (full on)	632.46	274	30.41
White (RGB off)	208.41	89.88	26.72
RGB	399.42	170.6	25.94
Red	94.2	41.16	14.06
Green	245.71	103.6	31.10
Blue	73.92	31.56	9.36

Illuminance at a Distance

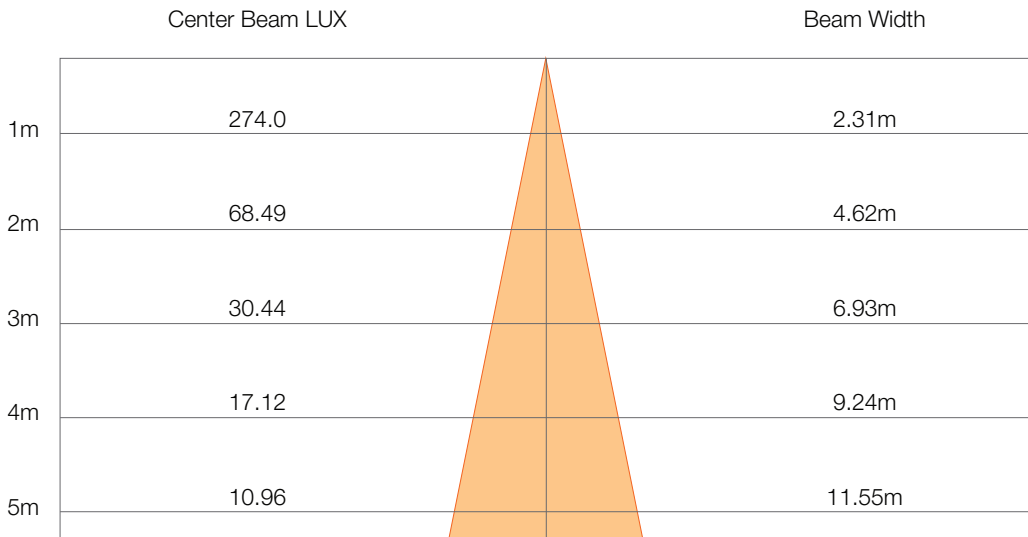

● Vert. Spread: 98.2°  
● Horiz. Spread: 98.2°

Project: ODOT SUM-8-1.75

Date: 10/07/2022

Type: F3A

HLB Project #:18173

Submittal: 100% Package

APPENDIX: LUMINAIRE CATALOGUE CUTS Note: This document is for information only. Refer to specifications for all catalog numbers, etc.

Horton Lees Brogden Lighting Design | 38 E 32nd St 11th Floor New York NY 10016 | P: 212 674 5580 | F: 212 254 2712 | www.HLBlighting.com

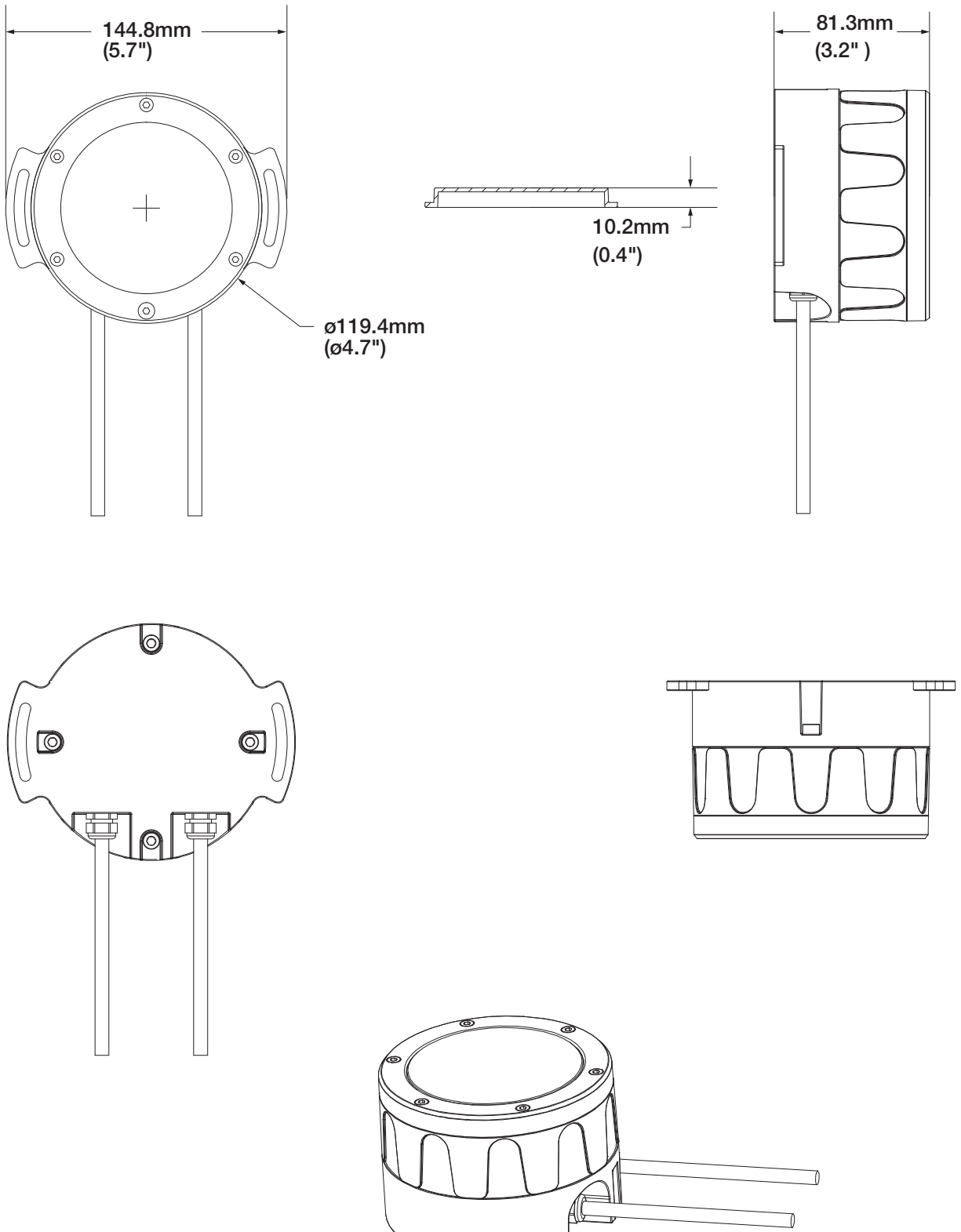

Project: ODOT SUM-8-1.75

Date: 10/07/2022

Type: F3A

HLB Project #:18173

Submittal: 100% Package

- PROPOINT Pixel fixtures ship with two cable whips: One cable whip for power input, consisting of two wires plus a ground, and one cable whip for DMX512 RDM input/output.
- No more than (32) fixtures on a single DMX512 link, max 300m total (source to last fixture).
- Data cabling from DMX source to first fixture and between subsequent PROPOINT Pixel fixtures shall be Cat5e UTP or higher (stranded type only) or other cable type suitable for DMX communication. Consult DMX standard for additional guidance.

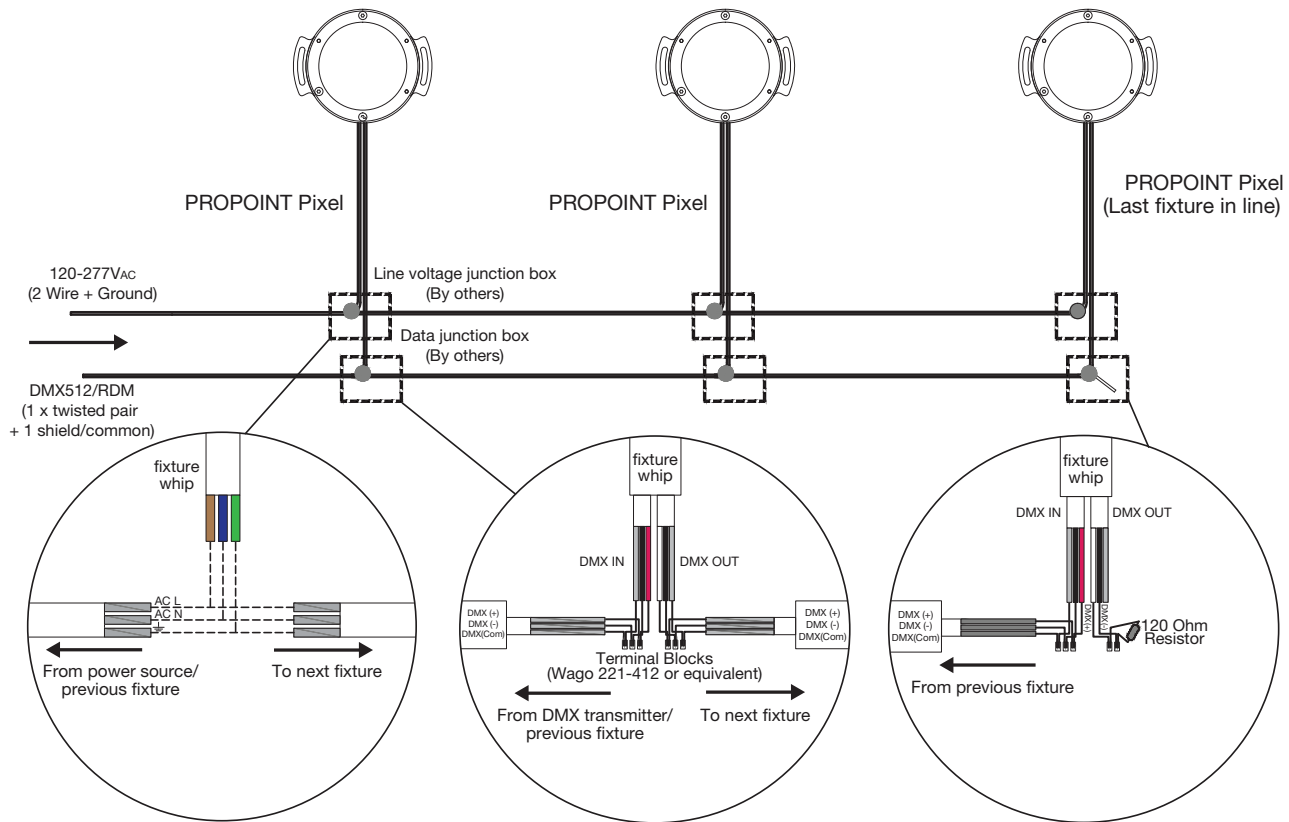

- Each DMX512 link must be properly terminated to prevent signal reflections.

### General Notes

- All data cabling must adhere to ANSI E1.11-2008 (R2013) – Entertainment Technology – USITT DMX512-A, Asynchronous Serial Digital Data Transmission Standard for Controlling Lighting Equipment and Accessories.
- Fixture is RDM compatible.
- Fixtures allow a universal input of 100VAC to 277VAC.
- Data termination shall utilize cage clamp terminal blocks, or equivalent. Wire nuts are not permissible and will void warranty.
- The method of line voltage termination, both for data and power, is at the discretion of the installing contractor, and/or engineer. Splicing and/or joining of cables must adhere to all applicable electrical codes.

Project: ODOT SUM-8-1.75

Date: 10/07/2022

Type: F3A

HLB Project #:18173

Submittal: 100% Package

APPENDIX: LUMINAIRE CATALOGUE CUTS Note: This document is for information only. Refer to specifications for all catalog numbers, etc.

Horton Lees Brogden Lighting Design | 38 E 32nd St 11th Floor New York NY 10016 | P: 212 674 5580 | F: 212 254 2712 | www.HLBlighting.com

**Model Number**

PP	X1	9	X	X	X	0	X
PROPOINT	Pixel	Control	Color	CCT	Lens	Finish	
		9: DMX	1: Static White	3: 3000K	1: Clear Lens	1: Gray	
			2: DW	4: 4000K	2: Diffused Dome	2: Black	
			4: RGBW	7: 2200K-6500K (DW)	3: Diffused Prism	3: White	
			A: RGB		4: Diffused Drum		
					5: Diffused Lens		

**Fixtures**

Model Number	Description	Item Code
PP.X1.944101	PROPOINT Pixel RGBW Clear Lens Gray	AM368860055
PP.X1.944102	PROPOINT Pixel RGBW Clear Lens Black	AM368910055
PP.X1.944103	PROPOINT Pixel RGBW Clear Lens White	AM368960055
PP.X1.944501	PROPOINT Pixel RGBW Diffused Lens Gray	AM368810055
PP.X1.944502	PROPOINT Pixel RGBW Diffused Lens Black	AM368870055
PP.X1.944503	PROPOINT Pixel RGBW Diffused Lens White	AM368920055

**Accessories**

Model Number	Description	Item Code
AM243520054	PROPOINT Termination Kit	AM243520054

Project: ODOT SUM-8-1.75

Date: 10/07/2022

Type: F3A

HLB Project #:18173

Submittal: 100% Package

APPENDIX: LUMINAIRE CATALOGUE CUTS Note: This document is for information only. Refer to specifications for all catalog numbers, etc.

Horton Lees Brogden Lighting Design | 38 E 32nd St 11th Floor New York NY 10016 | P: 212 674 5580 | F: 212 254 2712 | www.HLBlighting.com



# Specification Sheet

# decorative poles

Straight pole

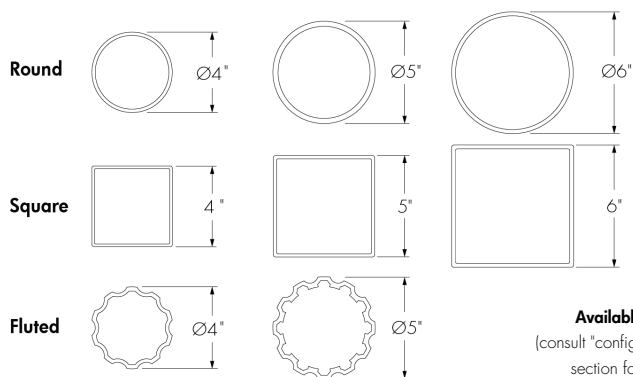

**Available pole shapes**  
(consult "configurations table" section for more details)

## Base cover options



## Certifications



## Description

Lumenpulse Straight Poles are available in steel or aluminum of various diameters and profiles to suit your outdoor design. Our Straight Poles are suitable for use with our accessories, such as Banner Arms, Basket Holders and choice of Base Cover. Lumenpulse Straight Poles are available in multiple finishes.

## Features

<b>Dimensions</b>	4 in , 5 in , 6 in
<b>Shapes</b>	Round, Square, Fluted
<b>Height</b>	Up to 30 ft, to specify height in 1 ft increments (consult configurations table for maximum height informations)
<b>Options</b>	Ground fault duplex receptacle, Ground fault duplex receptacle (while in use), Direct burial, Tamper-proof screws, Corrosion-resistant coating for hostile environments, Galvanized steel
<b>Warranty</b>	5-year limited warranty
<b>Physical</b>	
<b>Material</b>	Aluminum, Steel
<b>Access door dimensions</b>	2 1/8 in x 4 in
<b>Wall thickness</b>	1/8 in, 3/16 in, 1/4 in, 5/16 in
<b>Anchor bolts material</b>	Carbon steel partially galvanized
<b>Hardware Material</b>	Stainless steel
<b>Surface Finish</b>	Super Durable resistant exterior polyester powder coating meets AAMA 2604-98 requirements (5 years Florida exposure), a Corrosion finish (CRC) pre-finish is available to meet ASTM B-117 & ASTM D-1654 (salt spray resistance) and ASTM D-2247 requirements (humidity resistance).
<b>Pole top options</b>	2 3/8 in O.D. tenon adapter, 3 in O.D. tenon adapter, 4 in O.D. tenon adapter, Flat cap, Drilling pattern for decorative arms

**lumenpulse**™

1220 Marie-Victorin Blvd., Longueuil, QC J4G 2H9 CA T United States 617.307.5700 | Canada 1.877.937.3003 | 514.937.3003 F 514.937.6289  
info@lumenpulse.com www.lumenpulse.com www.lumenpulse.com/products/1581/straight-poles

Lumenpulse Group Inc. reserves the right to make changes to this product at any time without prior notice and such modification shall be effective immediately  
2019.10.11 copyright © 2019 Lumenpulse Group Inc. MS - R13

1 / 11

Project: ODOT SUM-8-1.75

Date: 10/07/2022

Type: FP

HLB Project #:18173

Submittal: 100% Package

APPENDIX: LUMINAIRE CATALOGUE CUTS Note: This document is for information only. Refer to specifications for all catalog numbers, etc.

Horton Lees Brogden Lighting Design | 38 E 32nd St 11th Floor New York NY 10016 | P: 212 674 5580 | F: 212 254 2712 | www.HLBlighting.com

**Environmental**

**Environment** Dry / damp / wet location

**Accessories - optional (order separately)**

**Banner arm** Single or double banner arms (available for Ø4 in and Ø5 in pole)

**Basket holder** Single or double basket holders (available for Ø4 in pole only)

Project: ODOT SUM-8-1.75

Date: 10/07/2022

Type: FP

HLB Project #:18173

Submittal: 100% Package

APPENDIX: LUMINAIRE CATALOGUE CUTS Note: This document is for information only. Refer to specifications for all catalog numbers, etc.

Horton Lees Brogden Lighting Design | 38 E 32nd St 11th Floor New York NY 10016 | P: 212 674 5580 | F: 212 254 2712 | [www.HLBlighting.com](http://www.HLBlighting.com)

Configurations table

Shapes	Round			Square			Fluted*	
	4 in	5 in	6 in	4 in	5 in	6 in	4 in	5 in
Maximum height (material)	Aluminium: 20 ft Steel: 20 ft	Aluminium: 20 ft Steel: 30 ft	Aluminium: 30 ft Steel: 30 ft	Aluminium: 20 ft Steel: 20 ft	Aluminium: 20 ft Steel: 30 ft	Steel: 30 ft	Aluminium: 20 ft	Aluminium: 20 ft
Compatible base options	P, VA, WB, WC, WF, WH, WI, WJ, WL, WM, WO, WP, WR, WS, WY, WYX	P, WA, WC, WF, WH, WI, WJ, WL, WM, WO, WP, WR, WS, WY, WYX	P, WC, WI, WL, WO, WY, WYX	P			P, WA, WB, WC, WF, WH, WI, WJ, WM, WO, WP, WR, WS, WY, WYX	P, WA, WC, WF, WH, WI, WJ, WM, WO, WP, WR, WS, WY, WYX
Compatible accessories	LR41, LR42 LH41, LH42	LR51, LR52	N/A	N/A			LR41, LR42 LH41, LH42	LR51, LR52

\*Available for 3/16 in wall thickness (M) only.

Anchorage

Anchor details

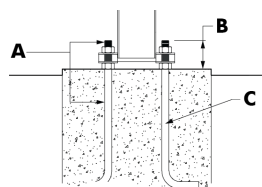

- A - Galvanized steel portion
- B - The threads of anchor bolts must protrude between 3 in and 3 1/2 in from concrete base.
- C - (4X) Anchors bolts, supplied with two nuts and flats washers for each (provided).

Bolt circle

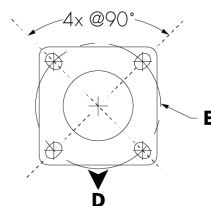

- D - Access door and street side
- E - Bolt circle

Shapes	Aluminium				Steel			
	Anchor bolts		Bolt circle		Anchor bolts		Bolt circle	
	Up to 20 ft	21 ft to 30 ft	Up to 20 ft	21 ft to 30 ft	Up to 20 ft	21 ft to 30 ft	Up to 20 ft	21 ft to 30 ft
4 in	Ø3/4 in x 26 in	N/A	Ø8.5 in	N/A	Ø3/4 in x 26 in	N/A	Ø8.5 in	N/A
5 in	Ø3/4 in x 26 in	N/A	Ø10 in	N/A	Ø3/4 in x 26 in	Ø1 in x 36 in	Ø10 in	Ø11.5 in
6 in	Ø3/4 in x 26 in	Ø1 in x 36 in	Round and Fluted: Ø10 in Square: Ø11.5 in	Ø14 in	Ø3/4 in x 26 in	Ø1 in x 36 in	Round and Fluted: Ø10 in Square: Ø11.5 in	Ø14 in



1220 Marie-Victorin Blvd., Longueuil, QC J4G 2H9 CA T United States 617.307.5700 | Canada 1.877.937.3003 | 514.937.3003 F 514.937.6289  
info@lumenpulse.com www.lumenpulse.com www.lumenpulse.com/products/1581/straight-poles

Lumenpulse Group Inc. reserves the right to make changes to this product at any time without prior notice and such modification shall be effective immediately  
2019.10.11 copyright © 2019 Lumenpulse Group Inc. MS - R13

Project: ODOT SUM-8-1.75

Date: 10/07/2022

Type: FP

HLB Project #:18173

Submittal: 100% Package

APPENDIX: LUMINAIRE CATALOGUE CUTS Note: This document is for information only. Refer to specifications for all catalog numbers, etc.

Horton Lees Brogden Lighting Design | 38 E 32nd St 11th Floor New York NY 10016 | P: 212 674 5580 | F: 212 254 2712 | www.HLBlighting.com

Direct burial and ground fault duplex receptacle options details

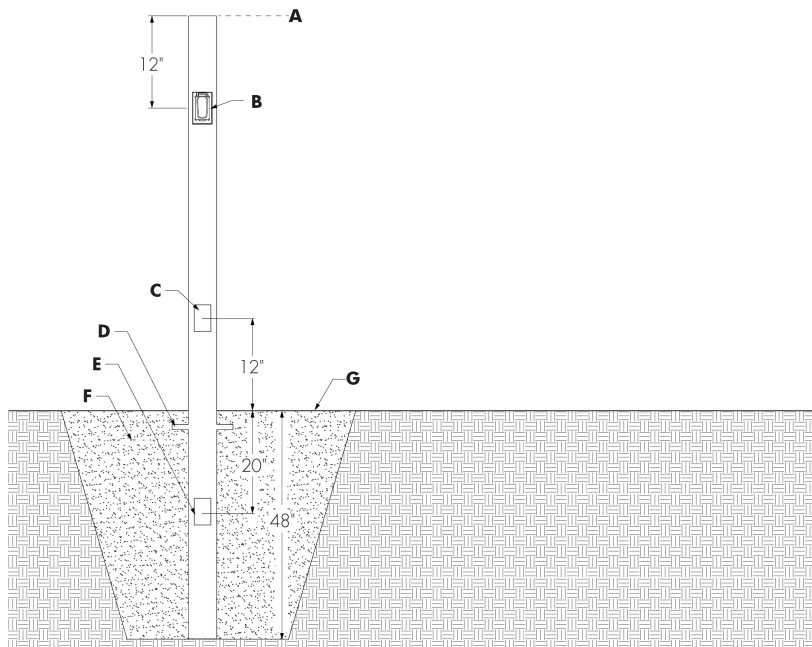

- A - External maximum height for direct burial: 26 ft (4 ft needed for landfill)
- B - Standard location of ground fault duplex receptacle (DRG and DRG IU) is 12 in from the top on door side (consult factory for others configurations).
- C - Access door
- D - Anti-rotating blade
- E - Opening for conduit
- F - Filling
- G - Finished grade

Duplex receptacle dimensions

DRG - Ground fault duplex receptacle

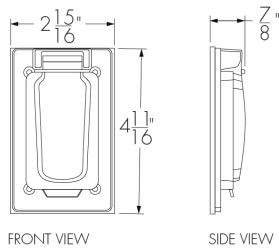

DRG IU - Ground fault duplex receptacle (while in use)\*

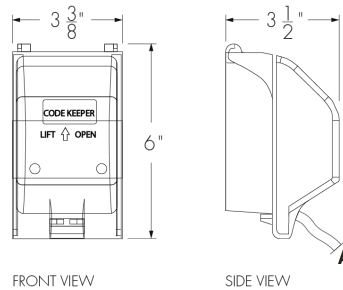

\* Weather-resistant and lockable cover (padlock by others)

A - Cord and plug from third party accessory or device.

Base cover options dimensions

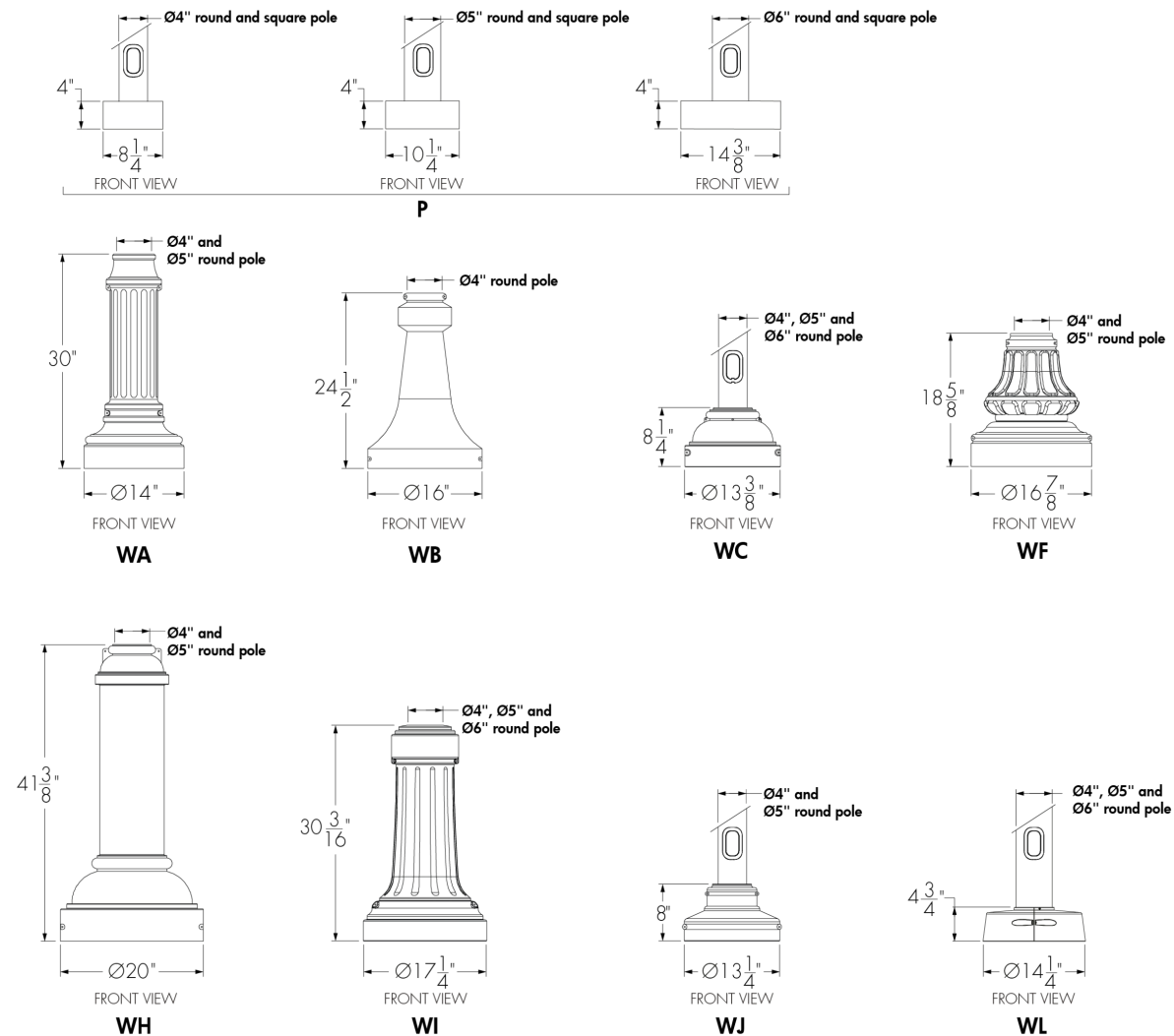

Specification Sheet

decorative poles  
Straight pole

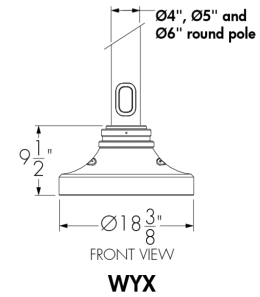
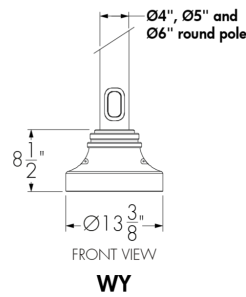
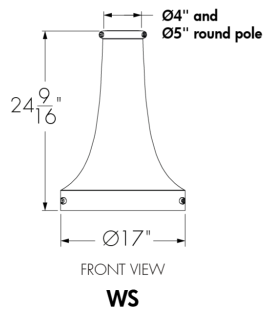
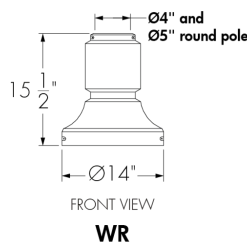
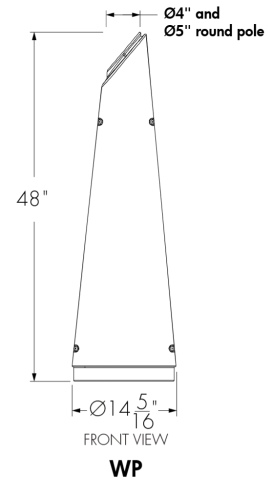
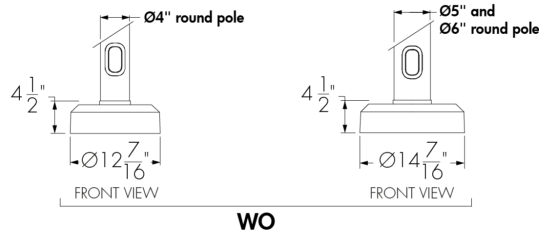
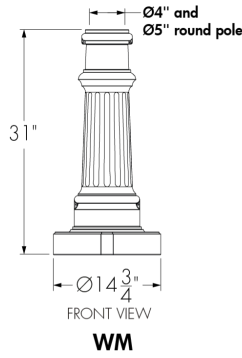

**lumenpulse™**

1220 Marie-Victorin Blvd., Longueuil, QC J4G 2H9 CA T United States 617.307.5700 | Canada 1.877.937.3003 | 514.937.3003 F 514.937.6289  
info@lumenpulse.com www.lumenpulse.com www.lumenpulse.com/products/1581/straight-poles

Lumenpulse Group Inc. reserves the right to make changes to this product at any time without prior notice and such modification shall be effective immediately  
2019.10.11 copyright © 2019 Lumenpulse Group Inc.  
MS - R13

6 / 11

Project: ODOT SUM-8-1.75

Date: 10/07/2022

Type: FP

HLB Project #:18173

Submittal: 100% Package

APPENDIX: LUMINAIRE CATALOGUE CUTS Note: This document is for information only. Refer to specifications for all catalog numbers, etc.

Horton Lees Brogden Lighting Design | 38 E 32nd St 11th Floor New York NY 10016 | P: 212 674 5580 | F: 212 254 2712 | www.HLBlighting.com

**Pole top options details**

**TN2 - 2 3/8 in O.D. tenon adapter**

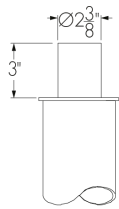

**CAP - Flat cap**

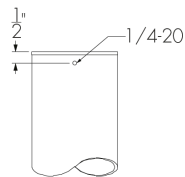

**TN3 - 3 in O.D. tenon adapter**

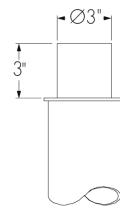

**BRK - Drilling pattern for decorative arms**

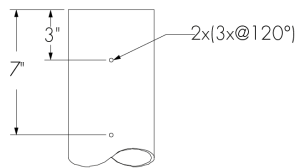

**TN4 - 4 in O.D. tenon adapter**

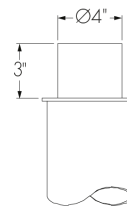

Required for PU4, PU5, PU8, CS2, CS4, CS12, CS13, DT1, DT6, MC5 decorative arms.

**Banner arms and basket holders accessories (order separately, consult related specification sheets for details)**

**LR41 - single banner arm for Ø4 in pole\***

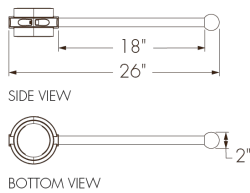

**LR51 - single banner arm for Ø5 in pole\***

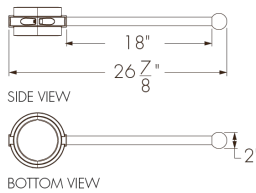

**LH41 - single basket holder for Ø4 in pole\***

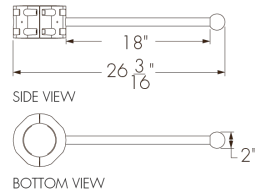

**LR42 - double banner arm for Ø4 in pole\***

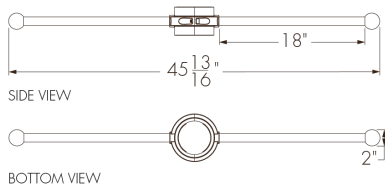

**LR52 - double banner arm for Ø5 in pole\***

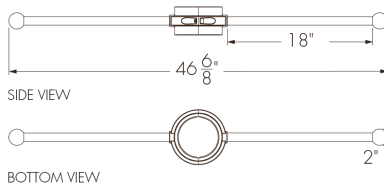

**LH42 - double basket holder for Ø4 in pole\***

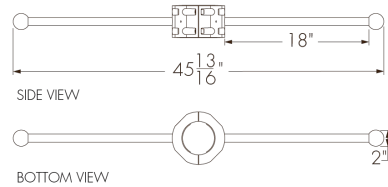

\*One unit provided only (please consult specification sheets for details).

Ordering specifications (specifications are used for EPA calculations)\*

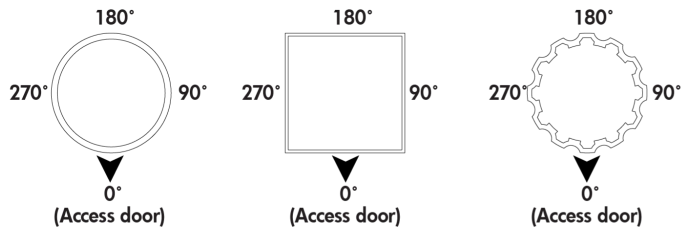

	Products code	Orientation (0°, 90°, 180°, 270°)	Height (consult "configuration table" section for maximum height)	Weight (please specify weight of accessories)	Dimensions (please specify dimensions of accessories)
1	Select:	Select:	Select:		
2	Select:	Select:	Select:		
3	Select:	Select:	Select:		
4	Select:	Select:	Select:		
5	Select:	Select:	Select:		
6	Select:	Select:	Select:		
7	Select:	Select:	Select:		
8	Select:	Select:	Select:		
9	Select:	Select:	Select:		
10	Select:	Select:	Select:		

\*Specify height and direction for all selected accessories and compatible Lumenpulse products.



**How to order**

Submitted on _____ for <input type="checkbox"/> Information <input type="checkbox"/> Approval	Project: _____
Other(s) <div style="border: 1px solid black; width: 400px; height: 50px; display: inline-block;"></div>	Distribution: _____
	Your order #: _____
	Representative: _____
	Our order #: <u>for lumenpulse use</u> _____

IMPORTANT NOTICE Lumenpulse assumes no responsibility for problems that may occur when combining third-party products.

1	2	3	4	5	6	7	8
.....							
9	10	11					

**1 . Pole <sup>(1)</sup>**

**PL-S**                      Straight poles

<sup>(1)</sup> Consult Related Products section on webpage for a selection of compatible accessories (sold separately).

**2 . Dimensions**

<b>4</b>	4 in
<b>5</b>	5 in
<b>6</b>	6 in

**3 . Material**

<b>AL</b>	Aluminum
<b>STL</b>	Steel

**4 . Shapes**

<b>R</b>	Round
<b>S</b>	Square <sup>(1)</sup>
<b>F</b>	Fluted <sup>(2)</sup> <sup>(3)</sup>

<sup>(1)</sup> Not available with aluminum pole 6 in.  
<sup>(2)</sup> Available for 3/16 in wall thickness only (M).  
<sup>(3)</sup> Available for Ø4 in and Ø5 in aluminum poles only.

Project: ODOT SUM-8-1.75                      Date: 10/07/2022                      Type: FP

HLB Project #:18173                      Submittal: 100% Package

**5 . Height <sup>(1)</sup>**

10	10 ft
11	11 ft
12	12 ft
13	13 ft
14	14 ft
15	15 ft
16	16 ft
17	17 ft
18	18 ft
19	19 ft
20	20 ft
21	21 ft
22	22 ft
23	23 ft
24	24 ft
25	25 ft
26	26 ft
27	27 ft
28	28 ft
29	29 ft
30	Maximum height 30 ft

<sup>(1)</sup> Consult Configurations table of specification sheet for maximum height information and other details.

**6 . Wall thickness <sup>(1)</sup>**

L	1/8 in
M	3/16 in
H	1/4 in
W	5/16 in

<sup>(1)</sup> Determined by Lumenpulse.

**7 . Finish**

BK	Black Sandtex®
BRZ	Bronze Sandtex®
SI	Silver Sandtex®
BKTX	Textured black
BRZTX	Textured bronze non-metallic
GRATX	Textured medium gray
GRNTX	Textured green
WHTX	Textured white
CC	Custom color and finish (please specify RAL color) <sup>(1)</sup> <sup>(2)</sup> <sup>(3)</sup>

<sup>(1)</sup> Specify RAL number followed by "TX" for textured finish (ex: RAL9007TX) or STX for Sandtex finish (ex: RAL9007STX). Textured or Sandtex finishes are recommended for the durability of all products. If a finish is not specified with the RAL number (ex: RAL9007), a glossy finish will be provided. Please consult factory for other RAL textures and glosses, or to match alternate color charts. Final color matching results may vary.

<sup>(2)</sup> Charges apply for RAL colors. Consult factory for details.

<sup>(3)</sup> Longer lead times can be expected for custom RAL color finishes.

**8 . Base cover options**

<b>P</b>	Square Base Cover P for 4 in, 5 in and 6 in pole <sup>(1)</sup>
<b>WA</b>	Round Base Cover WA for 4 in and 5 in pole <sup>(2)</sup>
<b>WB</b>	Round Base Cover WB for 4 in pole <sup>(2)</sup>
<b>WC</b>	Round Base Cover WC for 4 in, 5 in and 6 in pole <sup>(2)</sup>
<b>WF</b>	Round Base Cover WF for 4 in and 5 in pole <sup>(2)</sup>
<b>WH</b>	Round Base Cover WH for 4 in and 5 in pole <sup>(2)</sup>
<b>WI</b>	Round Base Cover WI for 4 in, 5 in and 6 in pole <sup>(2)</sup>
<b>WJ</b>	Round Base Cover WJ for 4 in and 5 in pole <sup>(2)</sup>
<b>WL</b>	Round Base Cover WL for 4 in, 5 in and 6 in pole <sup>(2)</sup>
<b>WM</b>	Square Base Cover WM for 4 in and 5 in pole <sup>(2)</sup>
<b>WO</b>	Round Base Cover WO for 4 in, 5 in and 6 in pole <sup>(2)</sup>
<b>WP</b>	Round Base Cover WP for 4 in and 5 in pole <sup>(2)</sup>
<b>WR</b>	Round Base Cover WR for 4 in and 5 in pole <sup>(2)</sup>
<b>WS</b>	Round Base Cover WS for 4 in and 5 in pole <sup>(2)</sup>
<b>WY</b>	Round Base Cover WY for 4 in, 5 in and 6 in pole <sup>(2)</sup>
<b>WYX</b>	Round Base Cover WYX for 4 in, 5 in and 6 in pole <sup>(2)</sup>

<sup>(1)</sup> Available for round, square and fluted pole.

<sup>(2)</sup> Available with round and fluted pole only.

**9 . Pole top options**

<b>TN2</b>	2 3/8 in O.D. tenon adapter
<b>TN3</b>	3 in O.D. tenon adapter
<b>TN4</b>	4 in O.D. tenon adapter
<b>CAP</b>	Flat cap
<b>BRK</b>	Drilling pattern for decorative arms

**10 . Options**

<b>DRG</b>	Ground fault duplex receptacle
<b>DRG IU</b>	Ground fault duplex receptacle (while in use)
<b>DB</b>	Direct burial <sup>(1)</sup>
<b>TP</b>	Tamper-proof screws
<b>CRC</b>	Corrosion-resistant coating for hostile environments <sup>(2)</sup>
<b>GALV</b>	Galvanized steel <sup>(3)</sup>

<sup>(1)</sup> Available for a maximum height of 16 ft for Ø4 in and Ø5 in aluminum pole and Ø4 in steel pole. Available for a maximum height of 26 ft for Ø6 in aluminum pole and for Ø5 in and Ø6 in steel pole.

<sup>(2)</sup> Automatically included when a steel pole is specified.

<sup>(3)</sup> Only available for steel poles with textured finish (immersion marks may occur).

**11 . Anchor bolts options**

<b>AB</b>	Anchor bolts <sup>(1)</sup>
-----------	-----------------------------

<sup>(1)</sup> Anchor bolts provided with double nuts, washers and template. One template provided for every 5 poles.