

- A** VARIES 8.0' TO 2.0'  
STA 398+80.21 TO STA 399+44.49  
2.0'  
STA 399+44.49 TO STA 400+44.99
- B** VARIES 34.7' TO 12.0'  
STA 398+88.06 TO STA 399+69.48  
12.0'  
STA 399+69.48 TO STA 400+44.99
- C** VARIES 0.0' TO 12.5'  
STA 399+28.15 TO STA 399+69.32  
12.5'  
STA 399+69.32 TO STA 400+44.99
- D** BEGIN FULL DEPTH PAVEMENT  
VARIES 0.0' TO 45.0'  
STA 398+78.65 TO STA 399+22.65  
VARIES 45.0' TO 12.1'  
STA 399+22.65 TO STA 400+97.15

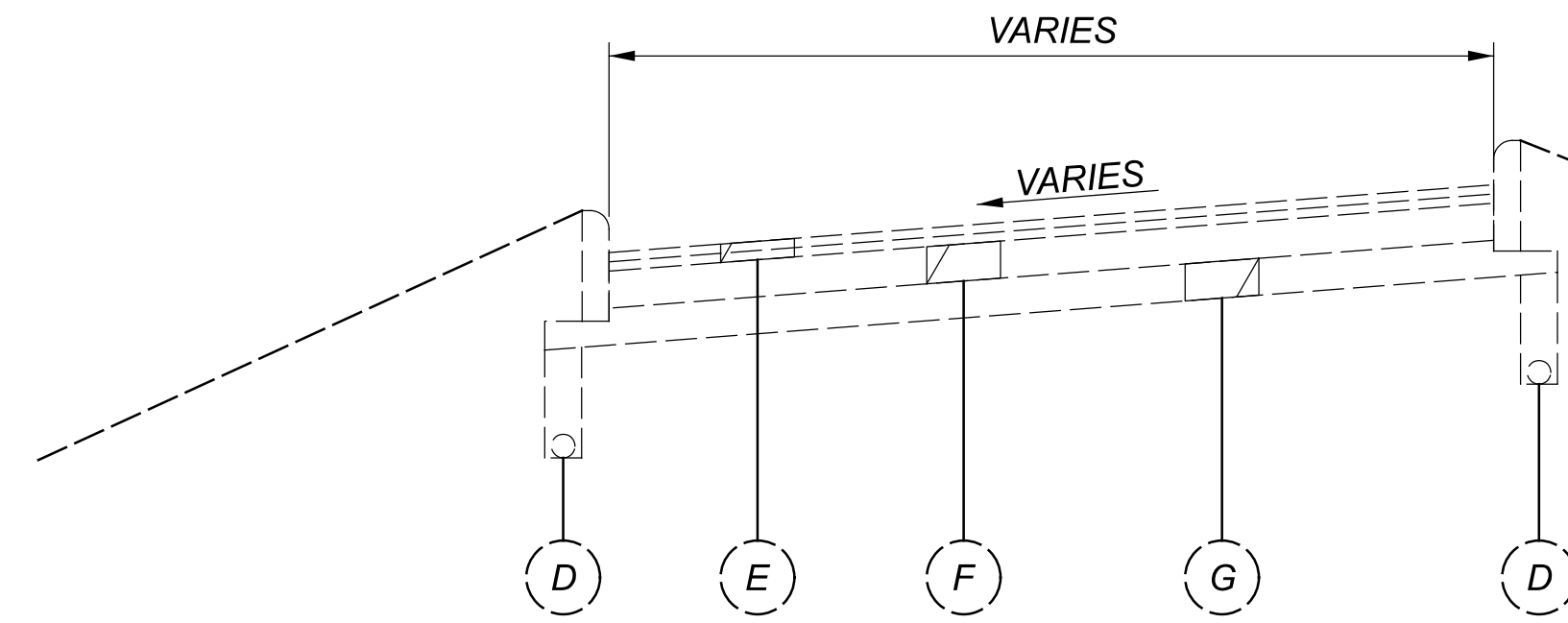

EXISTING TYPICAL SECTION - BEDFORD RD

SOUTHBOUND UTURN LANE PAVEMENT TRANSITION			
STATION		CROSS SLOPE ***	MAINLINE CROSS SLOPE
399+83.63	TO 400+47.06	-1.6% TO 1.6%	7.9% TO 7.5%
400+47.06	TO 400+95.55	1.6% TO 4.0%	7.5% TO 6.4%

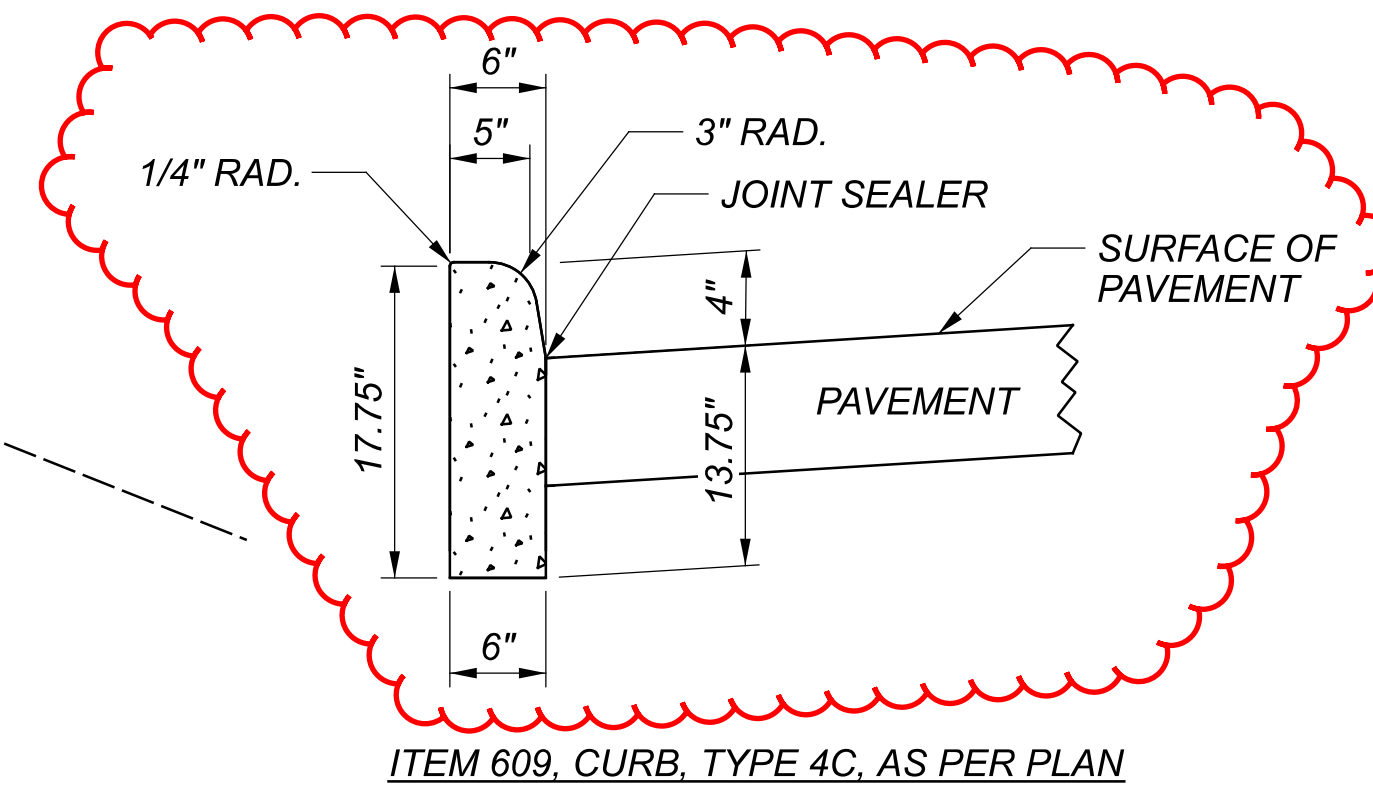

ITEM 609, CURB, TYPE 4C, AS PER PLAN

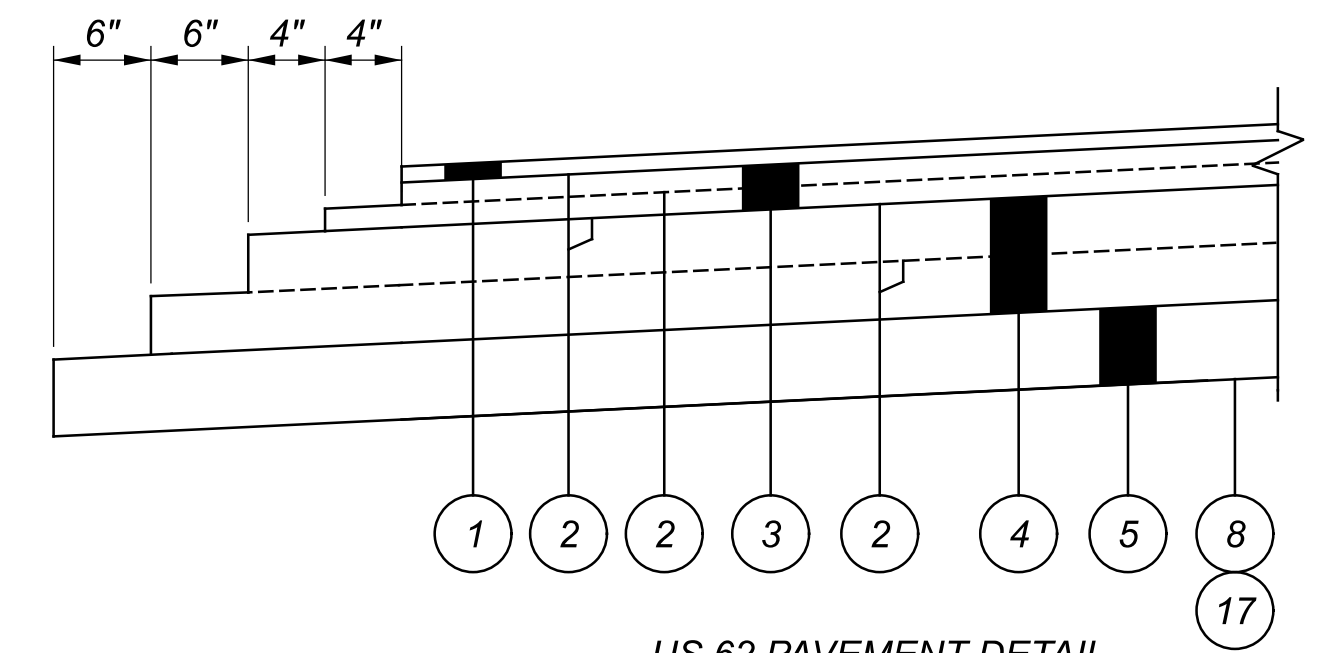

US 62 PAVEMENT DETAIL

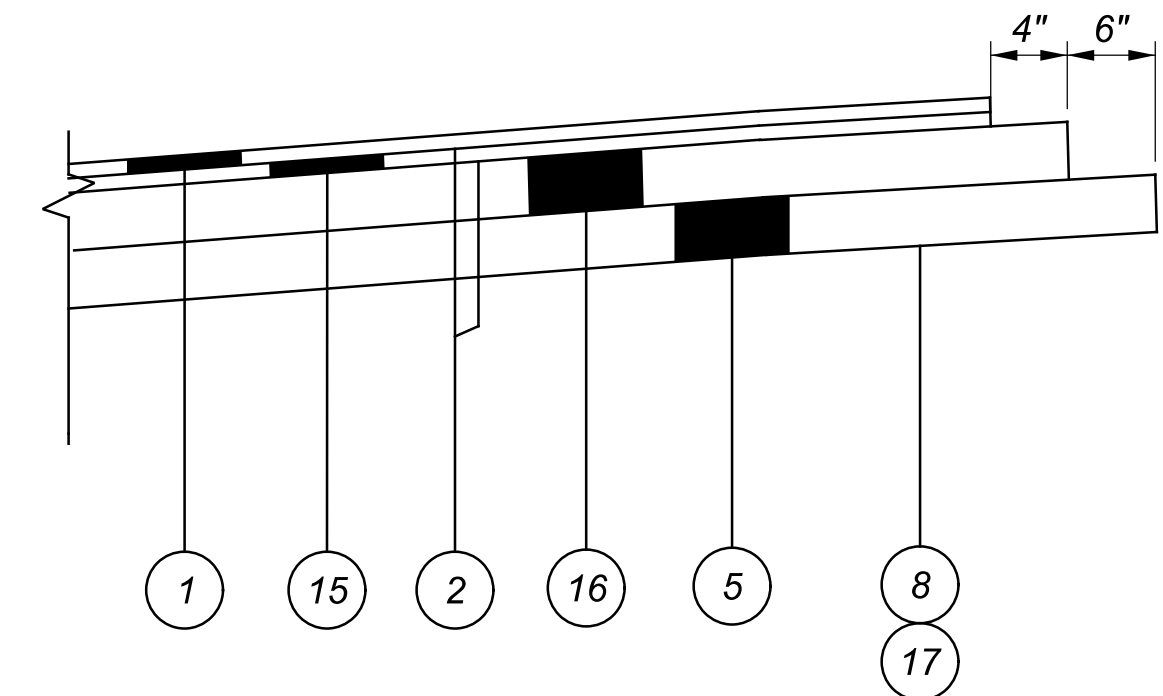

BEDFORD ROAD PAVEMENT DETAIL

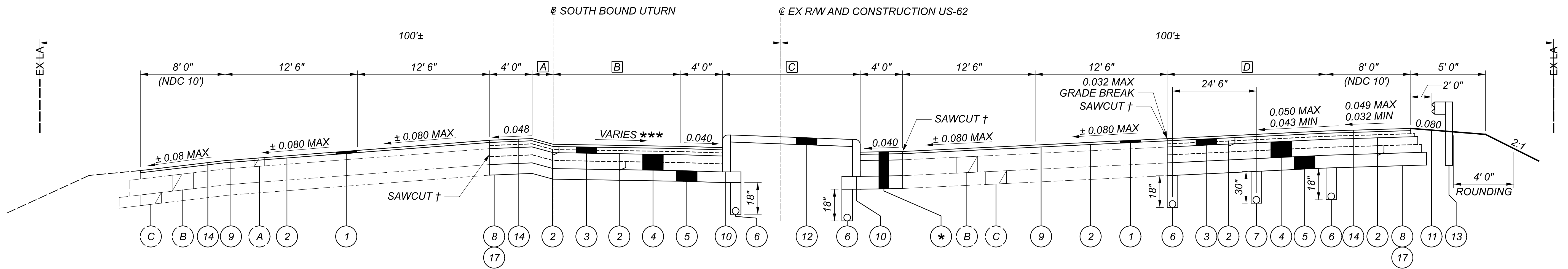

SUPERELEVATED TYPICAL SECTION - US 62  
STA 398+70.83 TO STA 400+44.99

(SEE INTERSECTION DETAILS FOR MORE INFORMATION SHEETS P.72 - P.77)

\* - SEE PAVEMENT DETAIL FOR PAVEMENT BUILD UP

EXISTING LEGEND

LEGEND

† - PR PAVEMENT ELEVATION TO MATCH EXISTING AT SAWCUT LOCATIONS. CONTRACTOR TO ENSURE SOUND EDGE AT ALL SAWCUT LOCATIONS BEFORE WIDENING.

- A** 4.75" ASPHALT CONCRETE PAVEMENT
- B** 9" REINFORCED CONCRETE BASE
- C** 6" GRANULATED SLAG
- D** UNDERDRAIN
- E** 3" ASPHALT CONCRETE PAVEMENT
- F** 6" ASPHALT CONCRETE BASE
- G** 6" AGGREGATE BASE
- 1** ITEM 441 - 1.25" ASPHALT CONCRETE SURFACE COURSE, TYPE 1, (449), PG70-22M, AS PER PLAN
- 2** ITEM 407 - NON-TRACKING TACK COAT
- 3** ITEM 441 - 3.5" ASPHALT CONCRETE INTERMEDIATE COURSE, TYPE 2, (449) (2 - 1.75" LIFTS)
- 4** ITEM 301 - 9" ASPHALT CONCRETE BASE, PG64-22, (449)
- 5** ITEM 304 - 6" AGGREGATE BASE
- 6** ITEM 605 - 6" BASE PIPE UNDERDRAIN, WITH GEOTEXTILE FABRIC
- 7** ITEM 605 - 6" SHALLOW PIPE UNDERDRAIN, WITH GEOTEXTILE FABRIC
- 8** ITEM 204 - SUBGRADE COMPACTION
- 9** ITEM 254 - PAVEMENT PLANING, ASPHALT CONCRETE, 1.25" DEPTH
- 10** ITEM 609 - CURB, TYPE 4C, AS PER PLAN
- 11** ITEM 659 - SEEDING AND MULCHING
- 12** ITEM 609 - 4" CONCRETE TRAFFIC ISLAND
- 13** ITEM 606 - GUARDRAIL, TYPE MGS
- 14** ITEM 618 - RUMBLE STRIPS, SHOULDER (ASPHALT CONCRETE)
- 15** ITEM 441 - 1.75" ASPHALT CONCRETE INTERMEDIATE COURSE, TYPE 2, (448)
- 16** ITEM 301 - 6" ASPHALT CONCRETE BASE, PG64-22, (449)
- 17** ITEM 204 - PROOF ROLLING

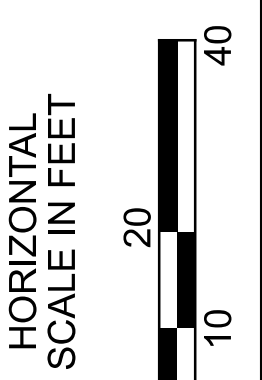
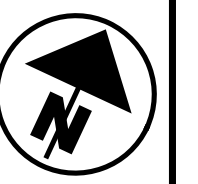

CROSS REFERENCES	
SHEET NO	DESCRIPTION
P.72 - P.77	INTERSECTION DETAILS
P.78 - P.82	STORM SEWER PROFILES
P.101 - P.106	LIGHTING PLANS
P.68 - P.71	CROSS SECTIONS

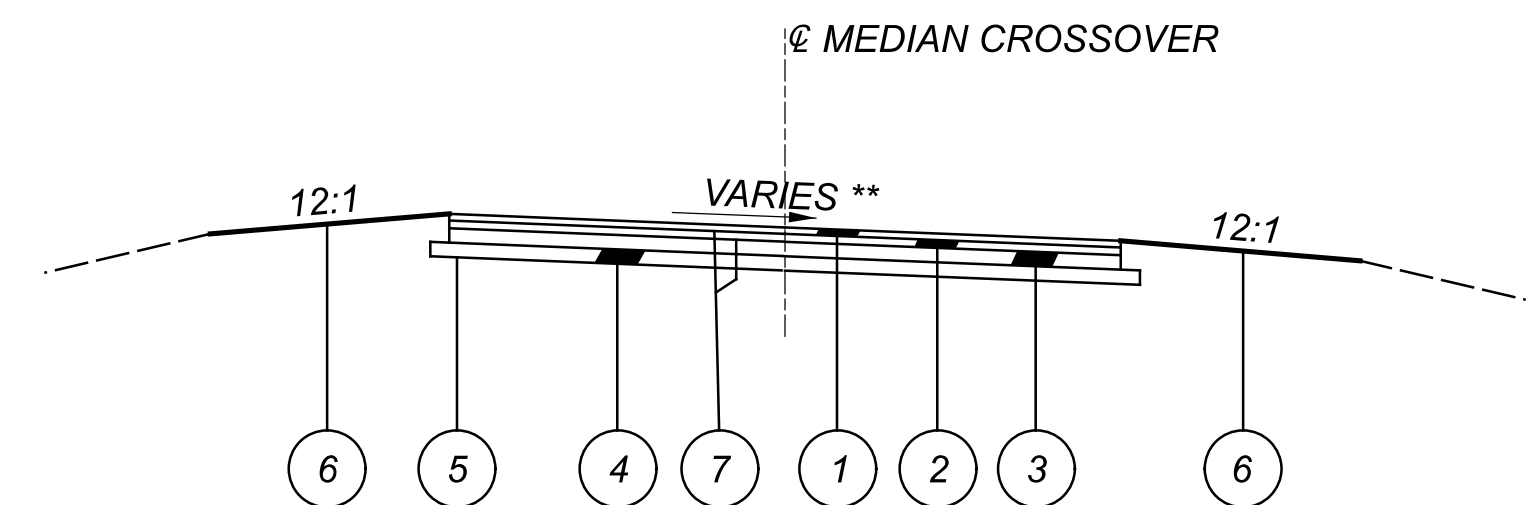
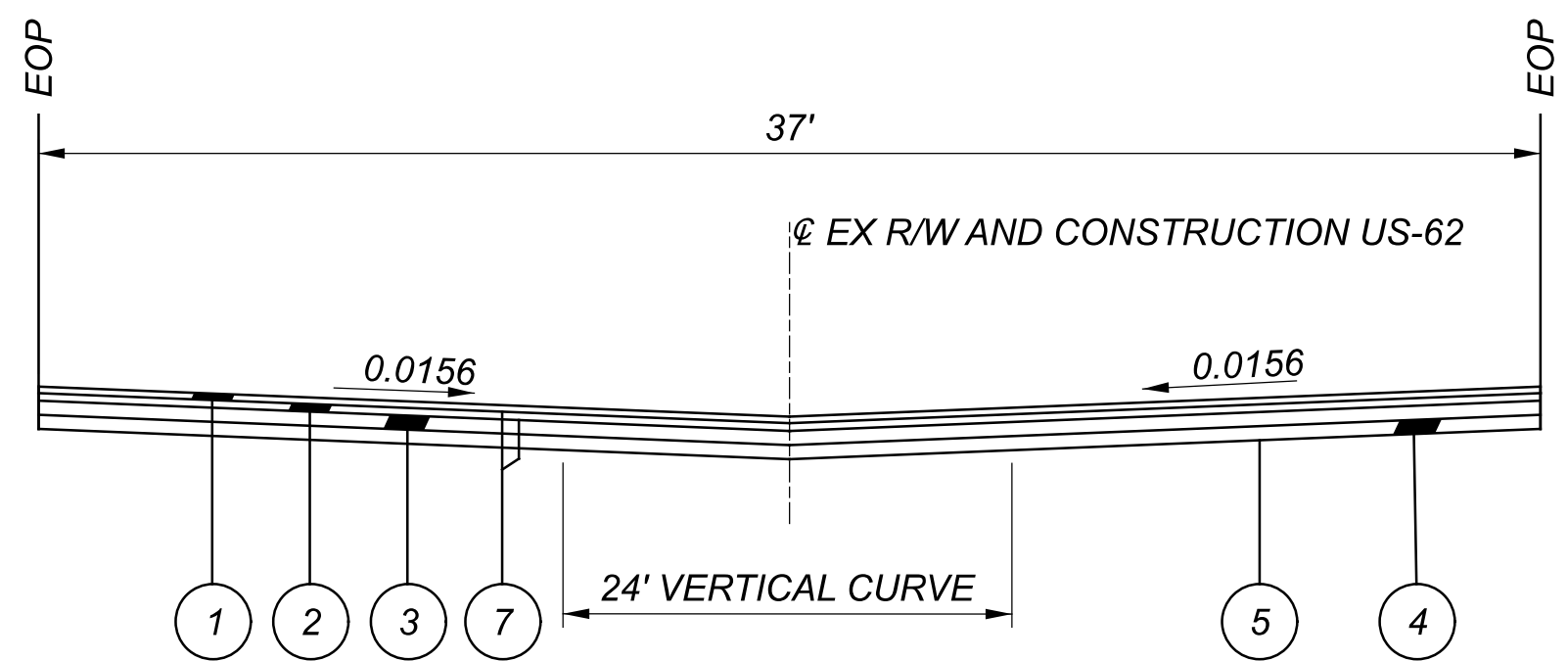

- (A) BEGIN TRANSITION FROM 4.00% CROSS SLOPE TO 1.56% CROSS SLOPE
- (B) END TRANSITION FROM 4.00% CROSS SLOPE TO 1.56% CROSS SLOPE
- (C) BEGIN TRANSITION FROM 1.56% CROSS SLOPE TO 4.00% CROSS SLOPE
- (D) END TRANSITION FROM 1.56% CROSS SLOPE TO 4.00% CROSS SLOPE

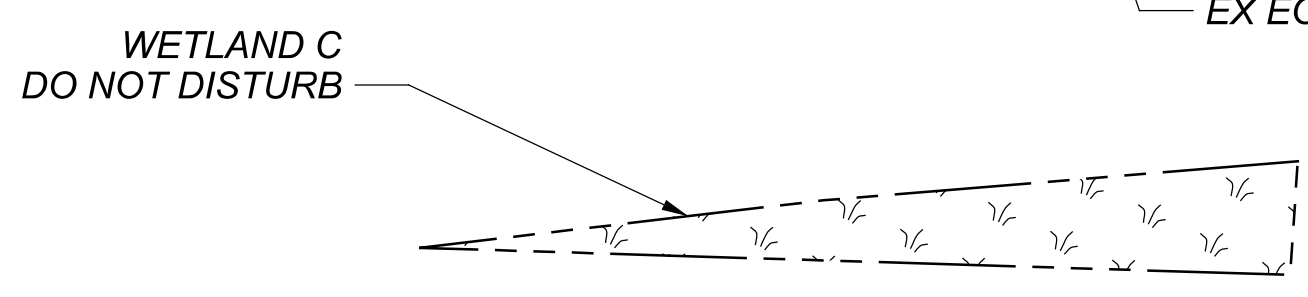
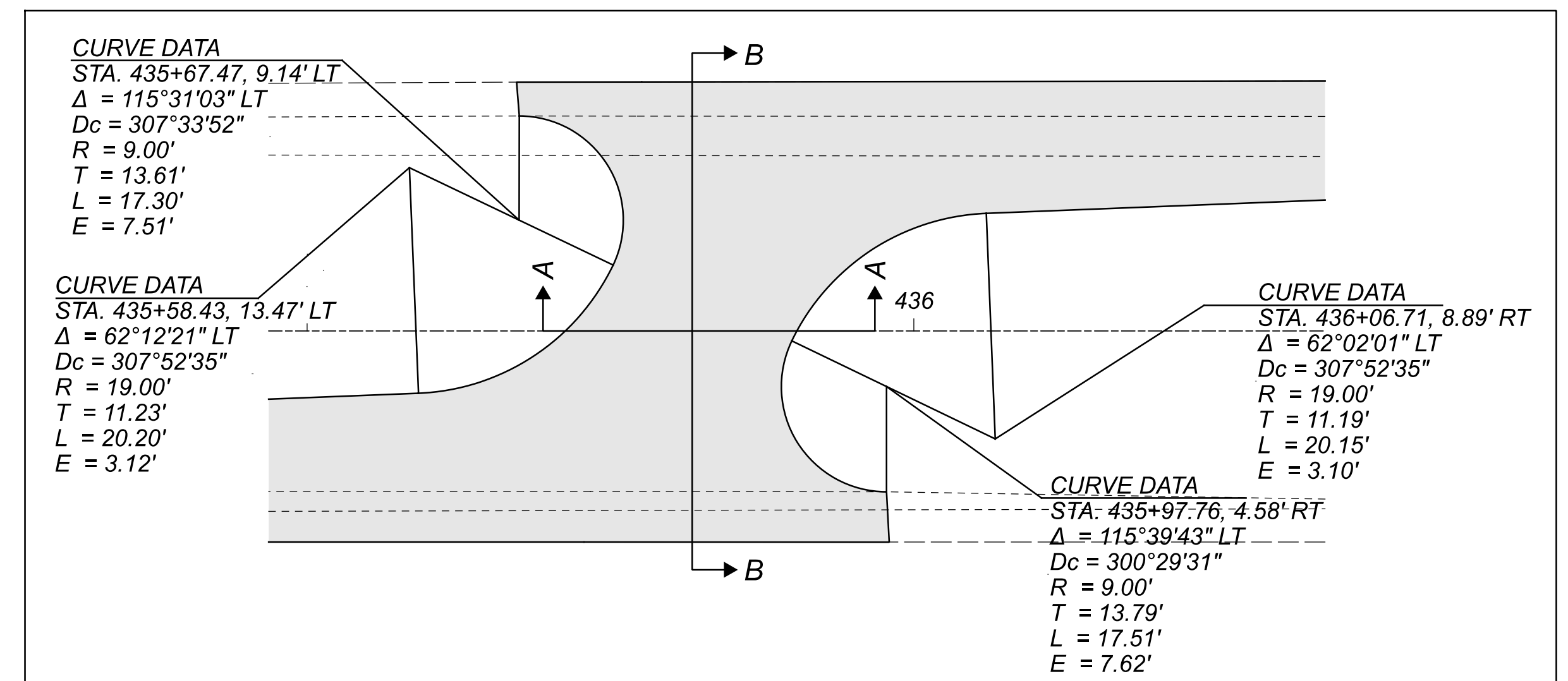
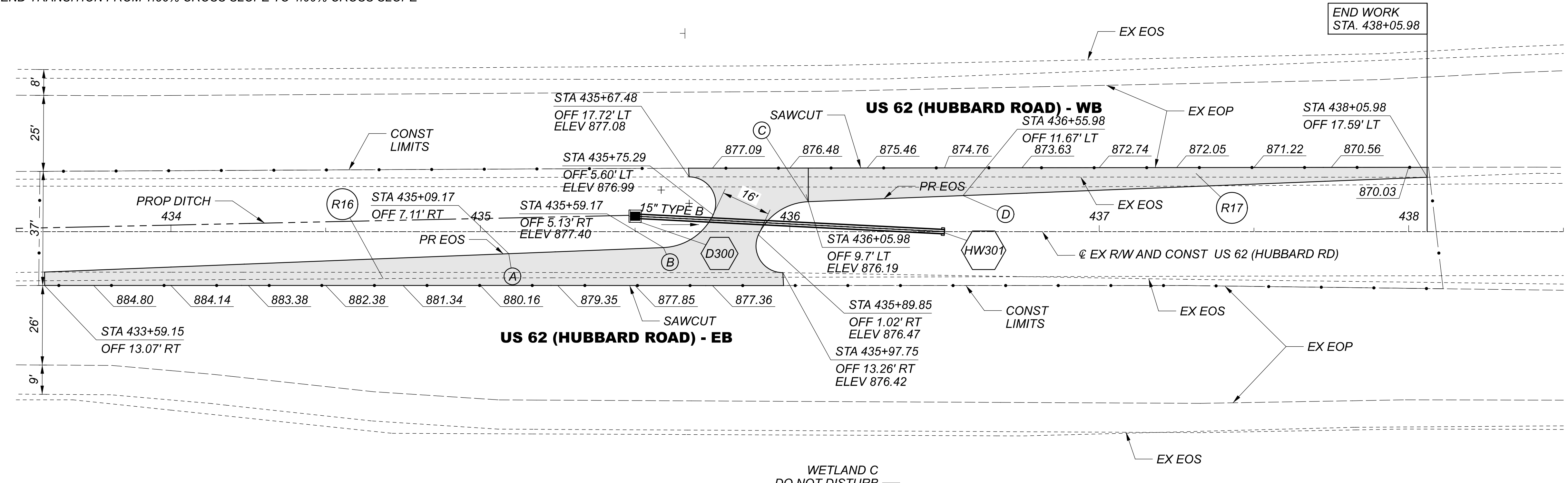

**LEGEND**

- ① ITEM 441 - 1.25" ASPHALT CONCRETE SURFACE COURSE, TYPE 1, (449), PG70-22, AS PER PLAN
- ② ITEM 441 - 1.75" ASPHALT CONCRETE INTERMEDIATE COURSE, TYPE 2, (449)
- ③ ITEM 301 - 6" ASPHALT CONCRETE BASE, PG64-22, (449)
- ④ ITEM 304 - 6" AGGREGATE BASE
- ⑤ ITEM 204 - SUBGRADE COMPACTION
- ⑥ ITEM 659 - SEEDING AND MULCHING
- ⑥ ITEM 407 - NON-TRACKING TACK COAT

LEGEND	
	- PROPOSED PAVEMENT
	EOP - EDGE OF PAVEMENT
	EOS - EDGE OF SHOULDER
	TBR - TO BE REMOVED

\*\* - MATCH EXISTING LONGITUDINAL SLOPE OF ROADWAY

TRU-62-7.47

MODEL: I0589\_GPS PAPER: 34x22 (in.) DATE: 1/20/2023 TIME: 10:40:09 AM USER: jhneurfg  
 J:\20200412\0001\04\_TRU-62-7.47\_Bedford\_Broadway\110589\_400-Engineer\Roadway\Sheets\110589\_GP005.dgn

ROADWAY PLAN SHEET - US 62  
 STA. 433+50.00 TO STA. 438+50.00

DESIGN AGENCY  
  
 DESIGNER JPT  
 REVIEWER HRB 09/01/22  
 PROJECT ID 110589  
 SHEET TOTAL P.51 114

SEE BENCHING NOTE P.10

 SPECIAL BENCHING VOLUME THIS SHEET: 54 CY

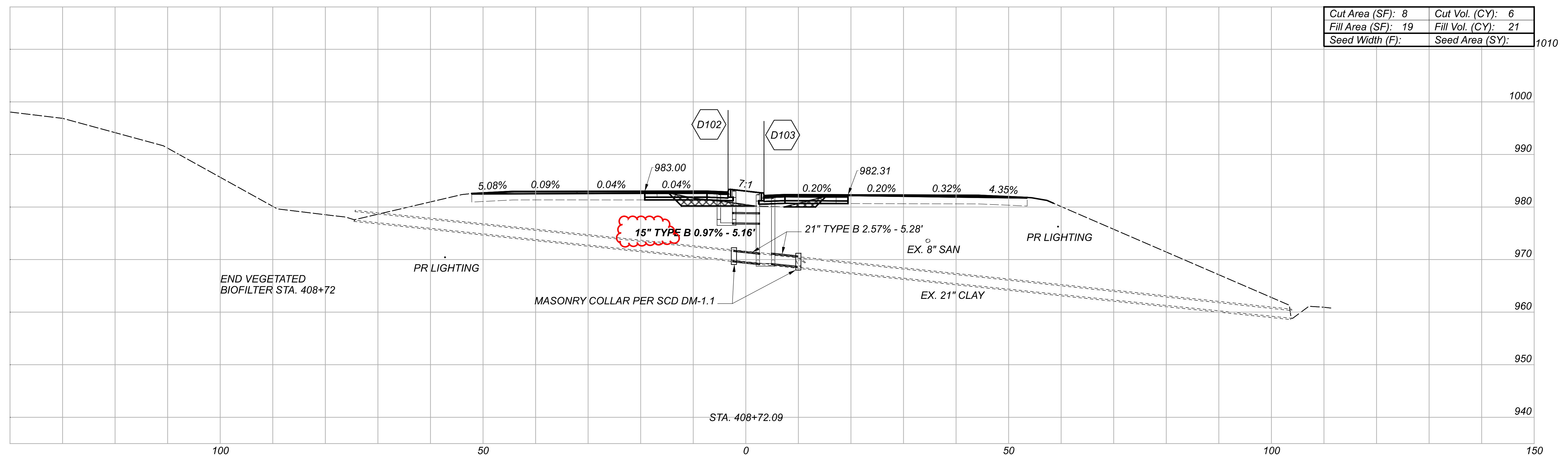
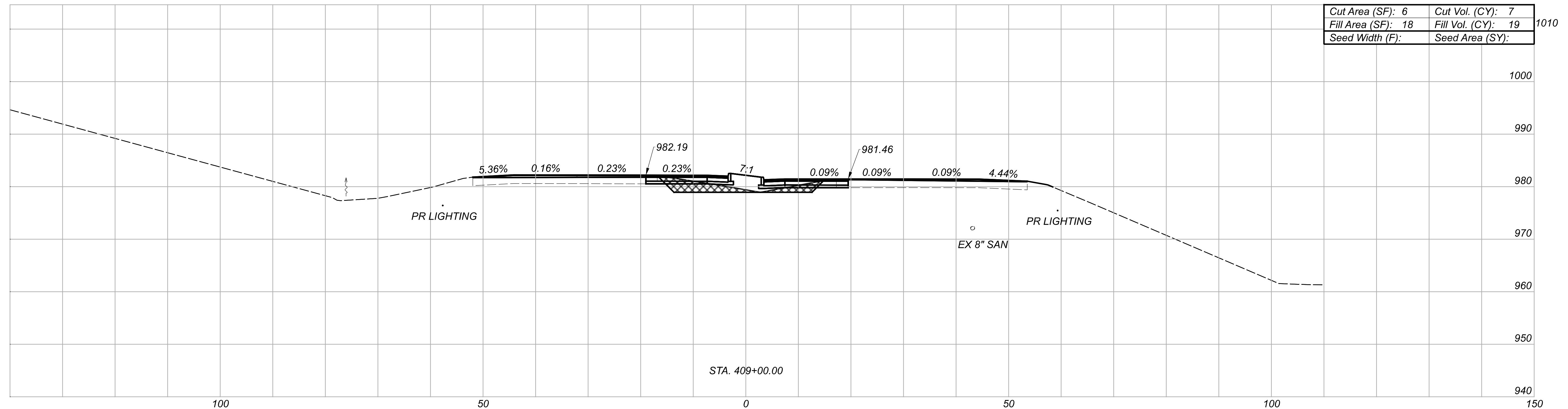

CROSS SECTIONS  
 STA. 408+72.09 TO STA. 409+00.00

DESIGN AGENCY



DESIGNER

JPT

REVIEWER

HRB 09/01/22

PROJECT ID

110589

Sheet Totals

Seeding	Cut	Fill
13	40	

SHEET	TOTAL
P.63	114