

STATE OF OHIO
DEPARTMENT OF TRANSPORTATION

WAS-7-39.35

**NEWPORT TOWNSHIP
WASHINGTON COUNTY**

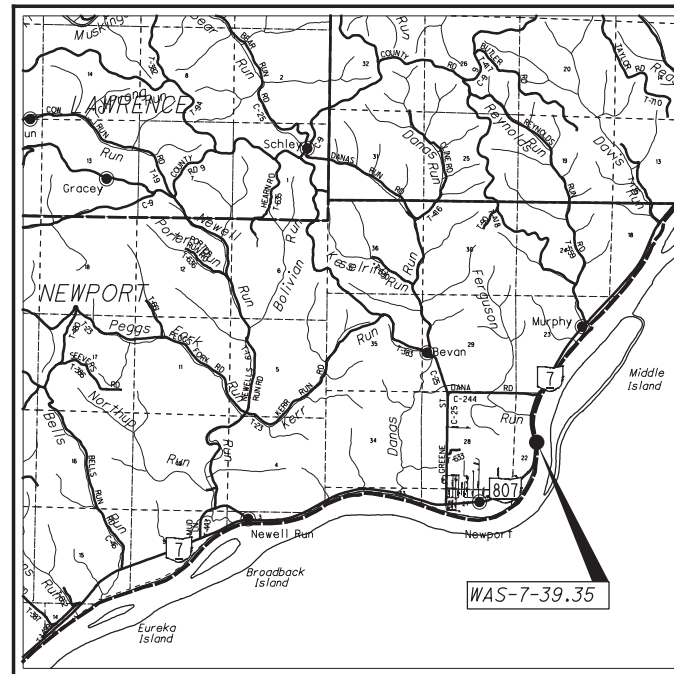

LOCATION MAP

LATITUDE: 39°23'52" LONGITUDE: 81°12'43"



PORTION TO BE IMPROVED	—————
INTERSTATE HIGHWAY	—————
FEDERAL ROUTES	—————
STATE ROUTES	—————
COUNTY & TOWNSHIP ROADS	—————
OTHER ROADS	—————

DESIGN DESIGNATION

CURRENT ADT (2021)	4,400
DESIGN YEAR ADT (2041)	4,500
DESIGN HOURLY VOLUME (2041)	500
DIRECTIONAL DISTRIBUTION	70%
TRUCKS (24 HOUR B&C)	12%
DESIGN SPEED	55
LEGAL SPEED	55
DESIGN FUNCTIONAL CLASSIFICATION:	
RURAL ARTERIAL	
NHS PROJECT	YES

DESIGN EXCEPTIONS

NONE

UNDERGROUND UTILITIES
Contact Two Working Days Before You Dig

OHIO811.org
Before You Dig

OHIO811, 8-1-1, or 1-800-362-2764
(Non-members must be called directly)

PLAN PREPARED BY:
OHIO DEPARTMENT OF
TRANSPORTATION PLANNING
AND ENGINEERING - DISTRICT 10

INDEX OF SHEETS:

TITLE SHEET	1
TYPICAL SECTION	2
GENERAL NOTES	3-5
MAINTENANCE OF TRAFFIC	6
GENERAL SUMMARY	7
CALCULATIONS	8
PLAN AND PROFILE	9-10
CROSS SECTIONS	11-28
SLOPE DRAPE DETAILS	29-30
SHOTCRETE AND ROCK BOLT DETAILS	31-32
SOIL PROFILE - ROCKFALL	

PROJECT DESCRIPTION

ROCKFALL MITIGATION BY REMOVING LOOSE AND OVERHANGING ROCK BY HAND SCALING WITH INSTALLATION OF SLOPE DRAPES AND SHOTCRETE.

EARTH DISTURBED AREAS

PROJECT EARTH DISTURBED AREA:	1.30	ACRES
ESTIMATED CONTRACTOR EARTH DISTURBED AREA:	0.50	ACRES
NOTICE OF INTENT EARTH DISTURBED AREA:	N/A*	ACRES

* - MAINTENANCE PROJECT

2019 SPECIFICATIONS

THE STANDARD SPECIFICATIONS OF THE STATE OF OHIO, DEPARTMENT OF TRANSPORTATION, INCLUDING SUPPLEMENTAL SPECIFICATIONS LISTED IN THE PLANS AND CHANGES LISTED IN THE PROPOSAL SHALL GOVERN THIS IMPROVEMENT.

* I HEREBY APPROVED THESE PLANS AND DECLARE THAT THE MAKING OF THIS IMPROVEMENT WILL NOT REQUIRE THE CLOSING TO TRAFFIC OF THE HIGHWAY AND THAT PROVISIONS FOR THE MAINTENANCE AND SAFETY OF TRAFFIC WILL BE AS SET FORTH ON THE PLANS AND ESTIMATES.

ENGINEERS SEAL	STANDARD CONSTRUCTION DRAWINGS	SUPPLEMENTAL SPECIFICATIONS	
<p>SIGNED: Justin D Wiseman DATE: 6/30/2021</p>	BP-3.1 1/17/20	800 1/17/20	
	DM-4.2 7/20/12	832 10/19/18	
	DM-4.3 1/15/16	862 10/16/15	
	DM-4.4 1/15/16		
	MT-96.11 1/17/20		
	MT-96.20 7/15/16		
	MT-96.26 1/18/19		
	MT-97.10 4/19/19		
	MT-101.70 1/17/20		
	MT-101.75 1/17/20		
	MT-105.10 1/17/20		
	RM-4.1 1/17/20		
			SPECIAL PROVISIONS
			WATERWAY PERMIT 7/1/21
			ROCK BOLT SPECIFICATION 09/17/21

APPROVED _____
DATE 6/30/2021 DISTRICT DEPUTY DIRECTOR

APPROVED _____
DATE _____ DIRECTOR, DEPARTMENT OF TRANSPORTATION

FEDERAL PROJECT NO. NON-FEDERAL
CONSTRUCTION PROJECT NO. -
PID NO. 113778
RAILROAD INVOLVEMENT NONE
WAS-7-39.35
1/32

I:\ProjectData\WAS-7-39.35\Design\Roadway\Sheets\113778-GT001.dgn Sheet 6/30/2021 12:35:25 PM jwiseman

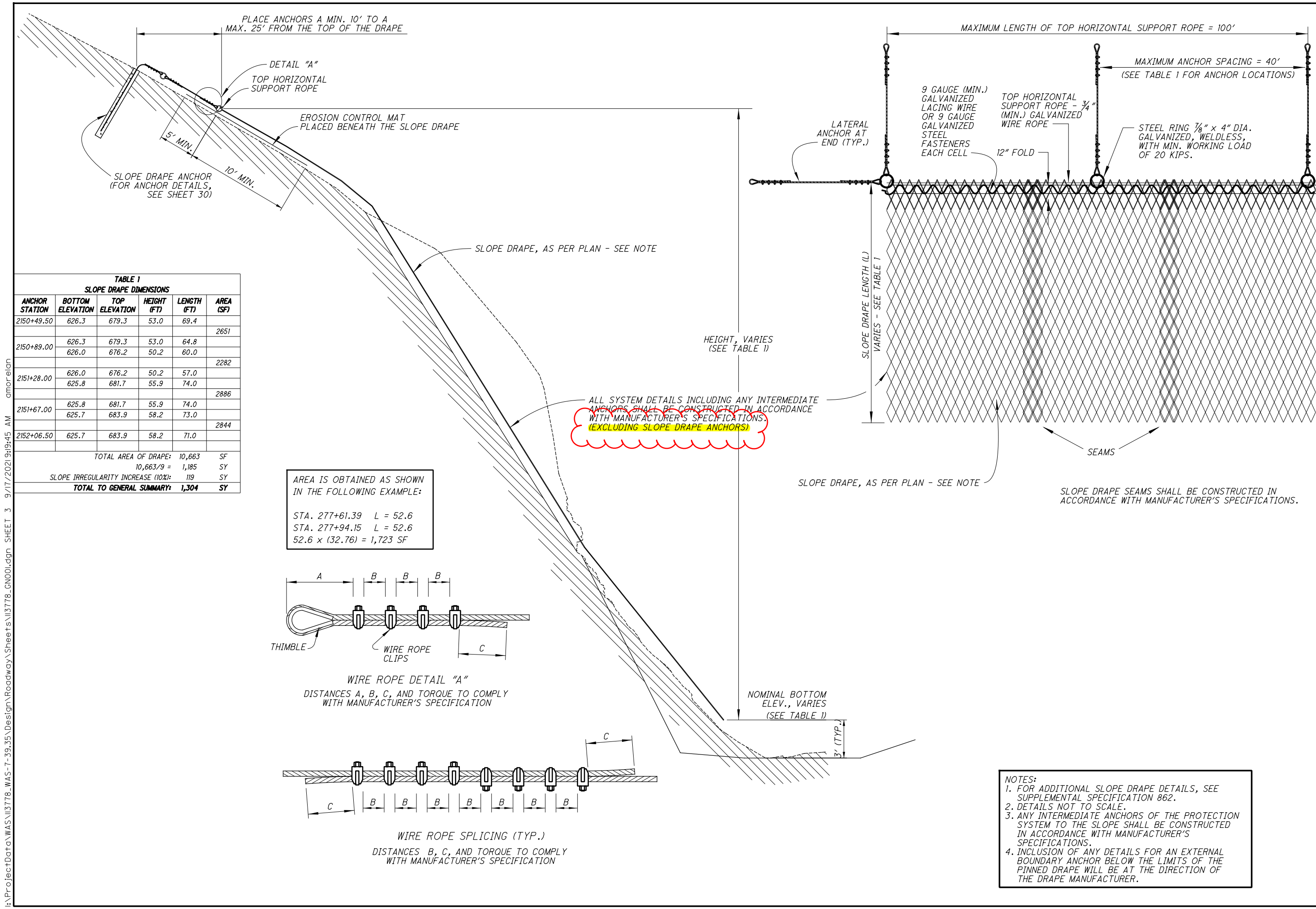
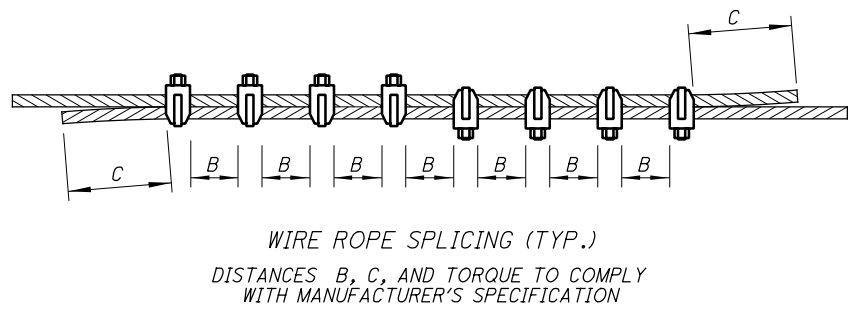
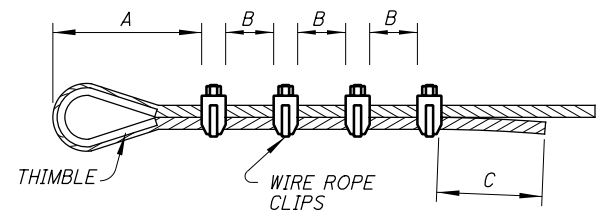

TABLE 1
SLOPE DRAPE DIMENSIONS

ANCHOR STATION	BOTTOM ELEVATION	TOP ELEVATION	HEIGHT (FT)	LENGTH (FT)	AREA (SF)		
2150+49.50	626.3	679.3	53.0	69.4	2651		
2150+89.00	626.3	679.3	53.0	64.8			
	626.0	676.2	50.2	60.0	2282		
2151+28.00	626.0	676.2	50.2	57.0	2886		
	625.8	681.7	55.9	74.0			
2151+67.00	625.8	681.7	55.9	74.0	2844		
	625.7	683.9	58.2	73.0			
2152+06.50	625.7	683.9	58.2	71.0			
TOTAL AREA OF DRAPE:					10,663	SF	
					10,663/9 =	1,185	SY
SLOPE IRREGULARITY INCREASE (10%):					119	SY	
TOTAL TO GENERAL SUMMARY:					1,304	SY	

AREA IS OBTAINED AS SHOWN IN THE FOLLOWING EXAMPLE:
 STA. 277+61.39 L = 52.6
 STA. 277+94.15 L = 52.6
 52.6 x (32.76) = 1,723 SF



- NOTES:
- FOR ADDITIONAL SLOPE DRAPE DETAILS, SEE SUPPLEMENTAL SPECIFICATION 862.
 - DETAILS NOT TO SCALE.
 - ANY INTERMEDIATE ANCHORS OF THE PROTECTION SYSTEM TO THE SLOPE SHALL BE CONSTRUCTED IN ACCORDANCE WITH MANUFACTURER'S SPECIFICATIONS.
 - INCLUSION OF ANY DETAILS FOR AN EXTERNAL BOUNDARY ANCHOR BELOW THE LIMITS OF THE PINNED DRAPE WILL BE AT THE DIRECTION OF THE DRAPE MANUFACTURER.

I:\ProjectData\WAS-7-39.35\Design\Roadway\Sheets\13778.GN001.dgn SHEET 3 9/17/2021 9:45 AM amorelan