

# STATE OF OHIO

## DEPARTMENT OF TRANSPORTATION

# WOO-65/18-0.00/18.53 PART 1

FOR PART 2, SEE WOO-CR 189- 4.35 (WAPAKONETA RD)  
PID 111253

VILLAGE OF GRAND RAPIDS  
WOOD COUNTY  
GRAND RAPIDS TOWNSHIP  
WASHINGTON TOWNSHIP  
BLOOM TOWNSHIP

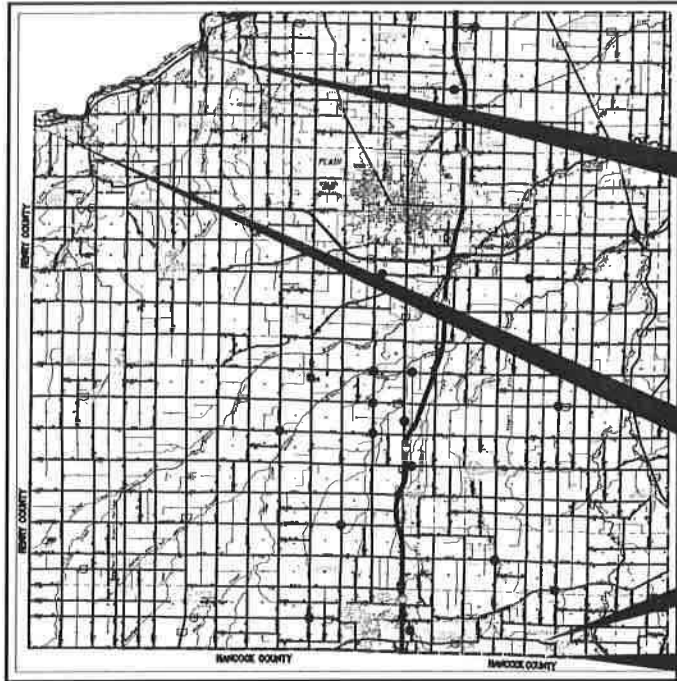

LOCATION MAP

LATITUDE: 41°25'12" LONGITUDE: -83°49'12"



END PROJECT  
STA. 311+27.68  
SLM: 5.89

BEGIN PROJECT  
STA. 1+19.84  
SLM: 0.00

BEGIN PROJECT  
STA. 52+90.31  
SLM: 18.53

END PROJECT  
STA. 102+26.23  
SLM: 19.48

### FEDERAL PROJECT NUMBER

E150259

### RAILROAD INVOLVEMENT

TOLEDO, LAKE ERIE, WESTERN RAILWAY, CSX

### PROJECT DESCRIPTION

RESURFACE SR 65 FROM HENRY COUNTY LINE TO SR 235.  
RESURFACE SR 18 FROM SLM 18.53 TO SLM 19.48. PERFORM NECESSARY RELATED WORK.

### EARTH DISTURBED AREAS

PROJECT EARTH DISTURBED AREA: N/A ACRES  
ESTIMATED CONTRACTOR EARTH DISTURBED AREA: N/A ACRES  
NOTICE OF INTENT EARTH DISTURBED AREA: N/A ACRES

PORTION TO BE IMPROVED	_____
INTERSTATE HIGHWAY	_____
FEDERAL ROUTES	_____
STATE ROUTES	_____
COUNTY & TOWNSHIP ROADS	_____
OTHER ROADS	_____

### DESIGN DESIGNATION

	SR 65	SR 18
CURRENT ADT (2022)	4300	1500
DESIGN YEAR ADT (2034)	4300	1600
DESIGN HOURLY VOLUME (2022)	450	150
DIRECTIONAL DISTRIBUTION	52%	10%
TRUCKS (24 HOUR B&C)	5%	5%
DESIGN SPEED	Varies	Varies
LEGAL SPEED	Varies	Varies
DESIGN FUNCTIONAL CLASSIFICATION:		
Rural Major Collector		
NHS PROJECT		NO

### DESIGN EXCEPTIONS

NONE

### ADA DESIGN WAIVERS

NONE

### INDEX OF SHEETS:

TITLE SHEET	1
TYPICAL SECTIONS	2-4
GENERAL NOTES	5
MAINTENANCE OF TRAFFIC NOTES	6
GENERAL SUMMARY	7,8
SUBSUMMARY	9-13
PLAN SHEETS	14-24
CROSS SECTIONS	25-28

### 2019 SPECIFICATIONS

THE STANDARD SPECIFICATIONS OF THE STATE OF OHIO, DEPARTMENT OF TRANSPORTATION, INCLUDING SUPPLEMENTAL SPECIFICATIONS LISTED IN THE PLANS AND CHANGES LISTED IN THE PROPOSAL SHALL GOVERN THIS IMPROVEMENT.

I HEREBY APPROVE THESE PLANS AND DECLARE THAT THE MAKING OF THIS IMPROVEMENT WILL NOT REQUIRE THE CLOSING TO TRAFFIC OF THE HIGHWAY EXCEPT AS NOTED ON SHEET 6, AND THAT PROVISIONS FOR THE MAINTENANCE AND SAFETY OF TRAFFIC WILL BE AS SET FORTH ON THE PLANS AND ESTIMATES.

**UNDERGROUND UTILITIES**  
Contact Two Working Days  
Before You Dig

**OHIO811.org**  
Before You Dig

OHIO811, 8-1-1, or 1-800-362-2764  
(Non members must be called directly)

PLAN PREPARED BY:  
ODOT DISTRICT 2  
317 E POE RD  
BOWLING GREEN, OHIO

ENGINEER'S SEAL:



SIGNED: *Julie M. Fahy*  
DATE: 6-25-2021

STANDARD CONSTRUCTION DRAWINGS				SUPPLEMENTAL SPECIFICATIONS		SPECIAL PROVISIONS	
BP-3.1	1/17/20	DBR-3-11	7/15/11				
BP-4.1	7/19/13						
BP-3.2	1/18/19	MT-97.10	4/19/19				
BP-5.1	1/18/19	MT-97.12	1/20/17	800	7/26/21		
BP-7.1	7/17/20	MT-99.20	4/19/19	832	10/19/18		
		MT-101.60	1/17/20	874	4/17/20		
		MT-101.90	1/17/20	875	1/18/19		
MGS-1.1	1/19/18	MT-105.10	1/17/20				
MGS-2.1	1/19/18						
MGS-3.1	1/19/18						
MGS-3.2	1/18/13	TC-65.10	1/17/14				
MGS-4.2	7/19/13	TC-65.11	7/21/17				
MGS-4.3	1/18/13	TC-71.10	1/19/18				
MGS-5.2	7/15/16						
MGS-5.3	7/15/16						
MGS-6.1	1/19/18						
MGS-6.2	7/19/19						

Added SCD

APPROVED: *Pat McCully, PE*  
DATE: 6/25/21 DISTRICT DEPUTY DIRECTOR

APPROVED: *Jack Marchbanks/NEA*  
DATE: 9-9-21 DIRECTOR, DEPARTMENT OF TRANSPORTATION

TITLE SHEET

DESIGN AGENCY



DESIGNER

JWZ

REVIEWER

JMF 06-25-21

PROJECT ID

95796

SHEET TOTAL

1 28

WOO-65/18-0.00/18.53

MODEL: Sheet PAPER SIZE: 17x11 (in.) DATE: 6/25/2021 TIME: 2:23:32 PM USER: jldingre  
pvc:\ohiodot-pw\benley.com\ohiodot-pw-02\Documents\01 Active Projects\District 02\Wood\95796\400-Engineering\Roadway\Sheets\95796\_GT001.dgn



**ITEM 614, MAINTAINING TRAFFIC**

NO WORK SHALL BE PERFORMED AND ALL EXISTING LANES SHALL BE OPEN TO TRAFFIC DURING THE FOLLOWING DESIGNATED HOLIDAYS OR EVENTS:

- APPLE BUTTER FESTIVAL OCTOBER, 2022
- CHRISTMAS FOURTH OF JULY
- NEW YEAR'S LABOR DAY
- MEMORIAL DAY THANKSGIVING
- (OTHER HOLIDAY OR EVENT)

THE PERIOD OF TIME THAT THE LANES ARE TO BE OPEN DEPENDS ON THE DAY OF THE WEEK ON WHICH THE HOLIDAY OR EVENT FALLS. THE FOLLOWING SCHEDULE SHALL BE USED TO DETERMINE THIS PERIOD:

DAY OF HOLIDAY OR EVENT	TIME ALL LANES MUST BE OPEN TO TRAFFIC
SUNDAY	12:00N FRIDAY THROUGH 6:00AM MONDAY
MONDAY	12:00N FRIDAY THROUGH 6:00AM TUESDAY
TUESDAY	12:00N MONDAY THROUGH 6:00AM WEDNESDAY
WEDNESDAY	12:00N TUESDAY THROUGH 6:00AM THURSDAY
THURSDAY	12:00N WEDNESDAY THROUGH 6:00AM FRIDAY
THURSDAY	(THANKSGIVING ONLY)
FRIDAY	6:00AM WEDNESDAY THROUGH 6:00AM MONDAY
FRIDAY	12:00N THURSDAY THROUGH 6:00AM MONDAY
SATURDAY	12:00N FRIDAY THROUGH 6:00AM MONDAY

SHOULD THE CONTRACTOR FAIL TO MEET ANY OF THESE REQUIREMENTS, THE CONTRACTOR SHALL BE ASSESSED A DISINCENTIVE IN THE AMOUNT OF \$5000 FOR EACH DAY THE ABOVE DESCRIBED LANE CLOSURE RESTRICTIONS ARE VIOLATED

LENGTH AND DURATION OF LANE CLOSURES AND RESTRICTIONS SHALL BE AT THE APPROVAL OF THE ENGINEER. IT IS THE INTENT TO MINIMIZE THE IMPACT TO THE TRAVELING PUBLIC. LANE CLOSURES OR RESTRICTIONS OVER SEGMENTS OF THE PROJECT IN WHICH NO WORK IS ANTICIPATED WITHIN A REASONABLE TIME FRAME, AS DETERMINED BY THE ENGINEER, SHALL NOT BE PERMITTED. THE LEVEL OF UTILIZATION OF MAINTENANCE OF TRAFFIC DEVICES SHALL BE COMMENSURATE WITH THE WORK IN PROGRESS.

NOTICE OF CLOSURE SIGNS (W20-H13) SHALL BE ERECTED BY THE CONTRACTOR PRIOR TO THE SCHEDULED ROAD OR RAMP CLOSURE IN ACCORDANCE WITH THE NOTICE OF CLOSURE TIME TABLE BELOW. AT THE APPROVAL OF THE ENGINEER, PORTABLE CHANGEABLE MESSAGE SIGNS MAY BE USED IN LIEU OF THE STANDARD FLATSHEET SIGN FOR CLOSURE DURATIONS OF LESS THAN 1 WEEK.

THE SIGNS SHALL BE ERECTED ON THE RIGHT-HAND SIDE OF THE ROAD/RAMP FACING TRAFFIC. THEY SHALL BE PLACED SO AS NOT TO INTERFERE WITH THE VISIBILITY OF ANY OTHER TRAFFIC CONTROL SIGNS. ON ROADWAYS, THEY SHOULD BE ERECTED AT OR NEAR THE POINT OF CLOSURE. THE SIGNS MAY BE ERECTED ANYWHERE ON RAMPS AS LONG AS THEY ARE VISIBLE TO THE MOTORISTS USING THE RAMP. ON ENTRANCE RAMPS, THE SIGN SHALL BE ERECTED WELL IN ADVANCE OF THE MERGE AREA TO AVOID DISTRACTING MOTORISTS.

**Notice of Closure Sign Time Table**

Item	Duration of Closure	Sign Displayed to Public
Ramp & Road	>= 2 weeks	14 calendar days prior to closure
Closures	> 12 hours & < 2 weeks	7 calendar days prior to closure
	< 12 hours	2 business days prior to closure

THE SIGN SHALL DISPLAY THE DATE OF THE CLOSURE IN MMM-DD FORMAT AND THE NUMBER OF DAYS OF THE CLOSURE. THE LAST LINE OF THE W20-H13 SIGN LISTS A PHONE NUMBER WHICH A MOTORIST MAY CALL FOR ADDITIONAL INFORMATION. THIS PHONE NUMBER SHALL BE 419-373-4428.

**ITEM 614, MAINTAINING TRAFFIC (ROAD CLOSED SIGN)**

THE CONTRACTOR SHALL PROVIDE, ERECT AND MAINTAIN STANDARD 48 X 30 INCH ROAD CLOSED SIGNS, SIGN SUPPORTS, BARRICADES AND LIGHTS, AS DETAILED IN SCD MT-101.60 AT THE FOLLOWING LOCATIONS DURING PERIODS IN WHICH THE AFFECTED ROADS ARE CLOSED TO TRAFFIC.

- NORTH SIDE OF SR 65 & 2ND ST. INTERSECTION
- SOUTH SIDE OF SR 65 & FRONT ST. INTERSECTION

ALL WORK AND TRAFFIC CONTROL DEVICES SHALL BE IN ACCORDANCE WITH CMS 614 AND OTHER APPLICABLE PORTIONS OF THE SPECIFICATIONS, AS WELL AS THE OHIO MANUAL OF UNIFORM TRAFFIC CONTROL DEVICES. PAYMENT FOR ALL LABOR, EQUIPMENT AND MATERIALS SHALL BE INCLUDED IN THE LUMP SUM CONTRACT PRICE FOR ITEM 614, MAINTAINING TRAFFIC UNLESS SEPARATELY ITEMIZED IN THE PLAN.

**ITEM 614, REPLACEMENT SIGN**

FLATSHEET SIGNS FURNISHED BY THE CONTRACTOR IN ACCORDANCE WITH THE REQUIREMENTS OF THE PLANS, SPECIFICATIONS AND PROPOSAL WHICH BECOME DAMAGED BY TRAFFIC FOR REASONS BEYOND THE CONTROL OF THE CONTRACTOR SHALL BE REPLACED IN KIND WHEN ORDERED BY THE ENGINEER. REPLACEMENT SIGNS SHALL BE NEW. OTHER MATERIALS MAY BE IN USED, BUT GOOD, CONDITION SUBJECT TO APPROVAL BY THE ENGINEER.

PAYMENT FOR THE NEW SIGNS SHALL BE MADE AT THE CONTRACT PRICE PER EACH FOR ITEM 614, REPLACEMENT SIGN, AND SHALL INCLUDE THE COST OF REMOVING AND DISPOSING OF DAMAGED SIGNS, HARDWARE AND SUPPORTS, AND PROVIDING THE NECESSARY REPLACEMENT HARDWARE, SUPPORTS, ETC.

AN ESTIMATED QUANTITY OF 5 EACH HAS BEEN PROVIDED IN THE GENERAL SUMMARY.

**ITEM 614, REPLACEMENT DRUM**

DRUMS FURNISHED BY THE CONTRACTOR IN ACCORDANCE WITH THE REQUIREMENTS OF THE PLANS, SPECIFICATIONS AND PROPOSAL WHICH BECOME DAMAGED BY TRAFFIC FOR REASONS BEYOND THE CONTROL OF THE CONTRACTOR SHALL BE REPLACED IN KIND WHEN ORDERED BY THE ENGINEER. REPLACEMENT DRUMS SHALL BE NEW.

PAYMENT FOR THE NEW DRUMS SHALL BE MADE AT THE CONTRACT PRICE PER EACH FOR ITEM 614, REPLACEMENT DRUM, AND SHALL INCLUDE THE COST OF REMOVING AND DISPOSING OF THE DAMAGED DRUM, AND PROVIDING AND MAINTAINING THE REPLACEMENT DRUM IN ACCORDANCE WITH THE CONTRACT REQUIREMENTS FOR THE ORIGINAL DRUM.

AN ESTIMATED QUANTITY OF 5 EACH HAS BEEN PROVIDED IN THE GENERAL SUMMARY.

**PLACEMENT OF ASPHALT CONCRETE**

TWO-WAY TRAFFIC SHALL BE MAINTAINED AT ALL TIMES EXCEPT THAT ONE-WAY TRAFFIC WILL BE PERMITTED FOR MINIMUM PERIODS OF TIME CONSISTENT WITH THE REQUIREMENTS OF THE SPECIFICATIONS FOR PROTECTION OF COMPLETED ASPHALT CONCRETE COURSES.

**TEMPORARY WEDGING**

ALL TEMPORARY ASPHALT WEDGING/REMOVAL OF WEDGE REQUIRED TO PROVIDE A SMOOTH TRANSITION FROM MILLED SURFACES TO EXISTING SURFACES THROUGHOUT THE PROJECT (INCLUDING DRIVE APPROACHES AND CONCRETE PAVEMENT AREAS IN GRAND RAPIDS) ARE TO BE INCLUDED IN ITEM 614 MAINTAINING TRAFFIC.

**WORK ZONE MARKINGS AND SIGNS**

THE FOLLOWING ESTIMATED QUANTITIES HAVE BEEN CARRIED TO THE GENERAL SUMMARY FOR USE AT LOCATIONS IDENTIFIED BY THE ENGINEER FOR WORK ZONE PAVEMENT MARKINGS AND SIGNS PER THE REQUIREMENTS OF CMS 614.04 AND 614.11.

ITEM 614 - WORK ZONE MARKING SIGN	28 EACH
ITEM 614 - WORK ZONE EDGE LINE, CLASS I	39 MILE
ITEM 614 - WORK ZONE CENTERLINE, CLASS I	24 MILE
ITEM 614 - WORK ZONE STOP LINE, CLASS III	306 FT

Moved Note from this Column, to that Column

Added Note

**ODOT NOTIFICATION CONTACT INFORMATION**

THE ODOT PROJECT ENGINEER SHALL FORWARD THE CONSTRUCTION NOTIFICATION INFORMATION THE FOLLOWING DEPARTMENTS WITHIN THE TIMELINE OUTLINED IN TEM PART 642-58 TO ENSURE COMPLIANCE WITH FEDERAL NOTIFICATION REQUIREMENTS:

DISTRICT PUBLIC INFORMATION OFFICER (PIO) BY PHONE AT: (419) 373-4428 OR EMAIL AT: D02.PIO@DOT.OHIO.GOV

DISTRICT PERMIT SECTION BY PHONE AT: (419) 373-4301 OR EMAIL AT: D02.PERMITS@DOT.OHIO.GOV

**NOTIFICATION OF TRAFFIC RESTRICTIONS**

THROUGHOUT THE DURATION OF THE PROJECT, THE CONTRACTOR SHALL NOTIFY THE PROJECT ENGINEER IN WRITING OF ALL TRAFFIC RESTRICTIONS AND UPCOMING MAINTENANCE OF TRAFFIC CHANGES. THE CONTRACTOR SHALL ENSURE THE WRITING OF ALL TRAFFIC RESTRICTIONS AND UPCOMING MAINTENANCE OF TRAFFIC CHANGES. THE CONTRACTOR SHALL ENSURE THE WRITTEN NOTIFICATION IS SUBMITTED IN A TIMELY MANNER TO ALLOW THE PROJECT ENGINEER TO MEET THE REQUIRED TIME FRAMES SET FORTH IN THE TABLE BELOW TO INFORM THE SPECIAL HAULING PERMITS SECTION (HAULING.PERMITS@DOT.OHIO.GOV) AND THE DISTRICT PUBLIC INFORMATION OFFICE (PIO). THIS NOTIFICATION SHALL BE RECEIVED BY THE PROJECT ENGINEER PRIOR TO THE PHYSICAL SETUP OF ANY APPLICABLE SIGNS OR MESSAGE BOARDS.

INFORMATION SHOULD INCLUDE, BUT IS NOT LIMITED TO, ALL CONSTRUCTION ACTIVITIES THAT IMPACT OR INTERFERE WITH TRAFFIC AND SHALL LIST THE SPECIFIC LOCATION, TYPE OF WORK, ROAD STATUS, DATE AND TIME OF RESTRICTION, DURATION OF RESTRICTION, NUMBER OF LANES MAINTAINED, NUMBER OF LANES CLOSED, MINIMUM VERTICAL CLEARANCE, MINIMUM WIDTH OF DRIVABLE PAVEMENT, DETOUR ROUTES, IF APPLICABLE, AND ANY OTHER INFORMATION REQUESTED BY THE PROJECT ENGINEER.

ITEM	DURATION OF CLOSURE	NOTICE DUE TO PERMITS & PIO
RAMP & ROAD CLOSURES	>= 2 WEEKS	21 CALENDAR DAYS PRIOR TO CLOSURE
	> 12 HOURS & < 2 WEEKS	14 CALENDAR DAYS PRIOR TO CLOSURE
	< 12 HOURS	4 CALENDAR DAYS PRIOR TO CLOSURE
LANE CLOSURES & RESTRICTIONS	>= 2 WEEKS	14 CALENDAR DAYS PRIOR TO CLOSURE
	< 2 WEEKS	5 BUSINESS DAYS PRIOR TO CLOSURE

START OF CONSTRUCTION & TRAFFIC PATTERN CHANGES	N/A	14 CALENDAR DAYS PRIOR TO IMPLEMENTATION
---	-----	--

ANY UNFORESEEN CONDITIONS NOT SPECIFIED IN THE PLANS REQUIRING TRAFFIC RESTRICTIONS SHALL ALSO BE REPORTED TO THE PROJECT ENGINEER USING THE NOTIFICATION TIME TABLE.

**SR 65 INTERSECTION MAINTENANCE OF TRAFFIC**

THE ROAD SHALL BE CLOSED TO TRAFFIC AND DETOURED AS PER THE ROAD CLOSURE DETOUR. ROAD CLOSURE SHOULD NOT EXCEED 5 DAYS. DAMAGES IN THE AMOUNT OF \$5000 SHALL BE ASSESSED FOR EACH CALENDAR DAY THE ROADWAY REMAINS CLOSED TO TRAFFIC BEYOND THE SPECIFIED LIMIT.

SR 65	SR 65 SHALL BE CLOSED TO TRAFFIC FROM STA. 53+50 TO STA. 58+50.  SR 65 CLOSURE DETOUR:  EASTBOUND SR 65 NORTH TO SR 110 WEST SR 110 WEST TO SR 109 NORTH SR 109 NORTH TO OLD US 24 EAST OLD US 24 EAST TO SR 295 SOUTH SR 295 SOUTH TO SR 65 EAST  WESTBOUND SR 65 WEST TO SR 295 NORTH SR 295 NORTH TO OLD US 24 WEST OLD US 24 WEST TO SR 109 SOUTH SR 109 SOUTH TO SR 65 EAST SR 65 EAST TO SR 65 SOUTH
DESIGNATED LOCAL DETOUR ROUTE	WAPAKONETA RD TO US-6 TO SR 235 TO KELLOG RD  KELLOG RD TO SR 235 TO US 6 TO WAPAKONETA RD

PART 1 AND PART 2 CAN BE DONE CONCURRENTLY.

Added Note

Added Detour

**CSXT RAILROAD SPECIAL PROVISIONS**

ROADWAY FLAGGERS MUST BE PRESENT ON EACH SIDE OF THE RAILROAD CROSSING, ANYTIME TRAFFIC IS DIRECTED INTO OPPOSING TRAFFIC LANES AT THE RAILROAD CROSSING.

CHANNELIZATION/MOT DEVICES SHALL BE PLACED A MINIMUM OF 15 FT FROM CENTER LINE OF RAILROAD TRACKS.

**DESIGNATED LOCAL DETOUR ROUTE**

IN ADDITION TO THE OFFICIAL, SIGNED DETOUR ROUTE, A LOCAL ROUTE HAS BEEN DETERMINED TO BE THE SECONDARY, UNSIGNED DETOUR ROUTE OR "DESIGNATED LOCAL DETOUR ROUTE." THIS ROUTE IS SHOWN ABOVE ON THIS SHEET. DURING THE TIME THAT TRAFFIC IS DETOURED, THE CONTRACTOR SHALL MAINTAIN THIS ROUTE IN A CONDITION WHICH IS REASONABLY SMOOTH AND FREE FROM HOLES, RUTS, RIDGES, BUMPS, DUST AND STANDING WATER. ONCE THE DETOUR IS REMOVED AND TRAFFIC RETURNED TO ITS NORMAL PATTERN, THE DESIGNATED LOCAL DETOUR ROUTE SHALL BE RESTORED TO A CONDITION THAT IS EQUIVALENT TO THAT WHICH EXISTED PRIOR TO ITS USE FOR THIS PURPOSE. ALL SUCH WORK SHALL BE PERFORMED WHEN AND AS DETERMINED BY THE ENGINEER.

THE FOLLOWING ESTIMATED QUANTITIES ARE PROVIDED FOR USE AS DETERMINED BY THE ENGINEER TO MAINTAIN AND SUBSEQUENTLY RESTORE THE DESIGNATED LOCAL DETOUR ROUTE.

ITEM 301, ASPHALT CONCRETE BASE	100 CU. YD.
ITEM 441, ASPHALT CONCRETE SURFACE COURSE, TYPE 1, (446), PG 70-22M	100 CU. YD.

Added Note

DESIGN AGENCY



DESIGNER

JWZ

REVIEWER

JMF MM-DD-YY

PROJECT ID

95796

SHEET

TOTAL

6 | 28



WOO-65/18-0.00/18.53

MODEL: Sheet PAPER: 17x11 (in.) DATE: 9/30/2021 TIME: 9:06:29 AM USER: jzems  
 p:\v\hoboc-pw-bentley.com\shhoboc-pw-02\Documents\01 Active Projects\District 02\Wood\95796\400-Engineering\Foodway\Sheets\95796\_GS001.dgn

STATION RANGE	TYPICAL SECTION	SIDE	DISTANCE (D) FT	AVERAGE WIDTH (W) FT	SURFACE AREA (A) A=DxW/9 SY	CADD GENERATED AREA SY	209	254	407	407	442	441	617	875	202	203	301	304							
							LINEAR GRADING MILE	PAVEMENT PLANING, ASPHALT CONCRETE SY	NON-TRACKING TACK COAT 0.085 GAL	NON-TRACKING TACK COAT 0.055 GAL	ASPHALT CONCRETE SURFACE COURSE, 12.5 MM, TYPE A (446) CY	ASPHALT CONCRETE INTERMEDIATE COURSE, TYPE 2, (446) CY	COMPACTED AGGREGATE CY	LONGITUDINAL JOINT ADHESIVE LB	PAVEMENT REMOVED SY	EXCAVATION CY	ASPHALT CONCRETE BASE, PG64-22 CY	AGGREGATE BASE CY							
<b>SR 65</b>																									
1+19.84 TO 5+00.00		LT/RT	380.16	23.90	1009.54		0.14	1009.54	85.81	55.52	42.06	49.07	15.25	95.04											
5+00.00 TO 10+00.00		LT/RT	500.00	24.00	1333.33		0.19	1333.33	113.33	73.33	55.56	64.81	20.06	125.00											
10+00.00 TO 15+00.00		LT/RT	500.00	23.60	1311.11		0.19	1311.11	111.44	72.11	54.63	63.73	20.06	125.00											
15+00.00 TO 20+00.00		LT/RT	500.00	36.50	2027.78		0.19	2027.78	172.36	111.53	84.49	98.57	20.06	125.00											
20+00.00 TO 31+50.00		LT/RT	1150.00	24.60	3143.33		0.44	3143.33	267.18	172.88	130.97	152.80	46.14	287.50											
31+50.00 TO 43+00.00		LT/RT	1150.00	23.50	3002.78		0.44	3002.78	255.24	165.15	125.12	145.97	46.14	287.50											
43+00.00 TO 53+00.00		LT/RT	1000.00	23.30	2588.89		0.38	2588.89	220.06	142.39	107.87	125.85	40.12	250.00											
53+00.00 TO 59+00.00		LT/RT	600.00	29.60	1973.33		0.23	1973.33	167.73	108.53	82.22	95.93	24.07	150.00											
59+00.00 TO 64+00.00		LT/RT	500.00	25.30	1405.56		0.19	1405.56	119.47	77.31	58.56	68.33	20.06	125.00											
64+00.00 TO 80+00.00		LT/RT	1600.00	24.60	4373.33		0.61	4373.33	371.73	240.53	182.22	212.59	64.20	400.00											
80+00.00 TO 90+00.00		LT/RT	1000.00	25.90	2877.78		0.38	2877.78	244.61	158.28	119.91	139.89	40.12	250.00											
90+00.00 TO 91+88.00		LT/RT	188.00	26.60	555.64		0.07	555.64	47.23	30.56	23.15	27.01	7.54	47.00											
93+65.00 TO 95+00.00		LT/RT	135.00	26.60	399.00		0.05	399.00	33.92	21.95	16.63	19.40	5.42	33.75											
95+00.00 TO 100+00.00		LT/RT	500.00	25.20	1400.00		0.19	1400.00	119.00	77.00	58.33	68.06	20.06	125.00											
100+00.00 TO 203+00.00		LT/RT	10300.00	23.60	27008.89		3.90	27008.89	2295.76	1485.49	1125.37	1312.93	413.27	2575.00											
203+00.00 TO 252+00.00		LT/RT	4900.00	23.60	12848.89		1.86	12848.89	1092.16	706.69	535.37	624.60	196.60	1225.00											
252+00.00 TO 257+00.00		LT/RT	500.00	28.00	1555.56		0.19	1555.56	132.22	85.56	64.81	75.62	20.06	125.00											
257+00.00 TO 262+00.00		LT/RT	500.00	23.90	1327.78		0.19	1327.78	112.86	73.03	55.32	64.54	20.06	125.00											
262+00.00 TO 311+27.68		LT/RT	4927.68	23.90	13085.73		1.87	13085.73	1112.29	719.72	545.24	636.11	197.72	1231.92											
<b>Widening SR 65</b>																									
53+47.00 TO 58+25.00		RT	478.00	8.70		499.00			55.00		21.00	28.00			499.00	357.00	83.00	111.00							
<b>Intersections</b>																									
Saylor Ln		RT	88.00	12.00		89.60			89.60	7.62	4.93	3.73	4.36												
Beach St.		RT/LT	69.00	12.00		183.90			183.90	15.63	10.11	7.66	8.94												
West St.		RT/LT	51.00	13.50		200.10			200.10	17.01	11.01	8.34	9.73												
Beaver St.		RT/LT	95.00	15.00		251.10			251.10	21.34	13.81	10.46	12.21												
Mill St.		RT/LT	87.00	15.00		256.90			256.90	21.84	14.13	10.70	12.49												
Wapakoneta Rd.		RT	52.00	79.00		242.70			242.70	20.63	13.35	10.11	11.80												
E. 2nd St.		RT	32.00	23.00		56.50			56.50	4.80	3.11	2.35	2.75												
Front St.		LT	88.00	54.40		239.30			239.30	20.34	13.16	9.97	11.63												
Monroe St.		RT	37.00	16.00		46.20			46.20	3.93	2.54	1.93	2.25												
E. Bridge St.		RT	64.00	16.00		75.40			75.40	6.41	4.15	3.14	3.67												
SR 295		LT	137.00	55.00		317.90			317.90	27.02	17.48	13.25	15.45												
Woodburn Ave.		RT	66.00	7.00		35.70			35.70	3.03	1.96	1.49	1.74												
Sycamore Rd.		RT	68.00	10.00		52.70			52.70	4.48	2.90	2.20	2.56												
Benschoter Rd.		RT	75.00	9.00		61.20			61.20	5.20	3.37	2.55	2.98												
Weston Rd.		RT	110.00	13.00		130.50			130.50	11.09	7.18	5.44	6.34												
<b>SUBTOTALS</b>							11.70	85467.95	7319.77	4700.75	3582.15	4182.71	1237.01	7707.71	499.00	357.00	83.00	111.00							
<b>TOTALS CARRIED TO GENERAL SUMMARY</b>							12	85468	7320	4701	3583	4183	1238	7708	499	357	83	111							

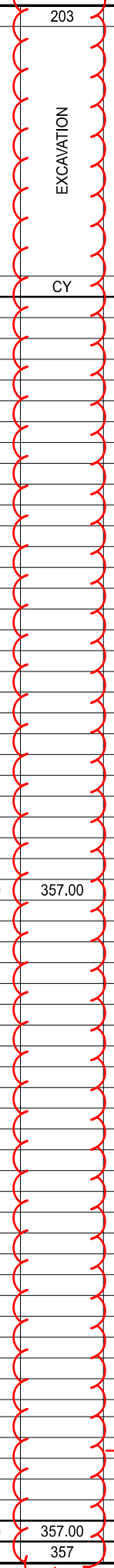

Added Item

**SUBSUMMARY SHEET SR 65**

---

DESIGN AGENCY  

DESIGNER  
**JWZ**

REVIEWER  
**JMF MM-DD-YY**

PROJECT ID  
**95796**

SHEET TOTAL  
**9 28**



W00-65/18-0.00/18.53

MODEL: Sheet PAPER SIZE: Tlxil (in.) DATE: 9/23/2021 TIME: 4:51:20 PM USER: jzleams  
pw:\ohlodot-pw.bentley.com\ohlodot-pw-02\Documents\01 Active Projects\District 02\Wood\95796\400-Engineering\Roadway\Sheets\95796\_CPO10.dgn

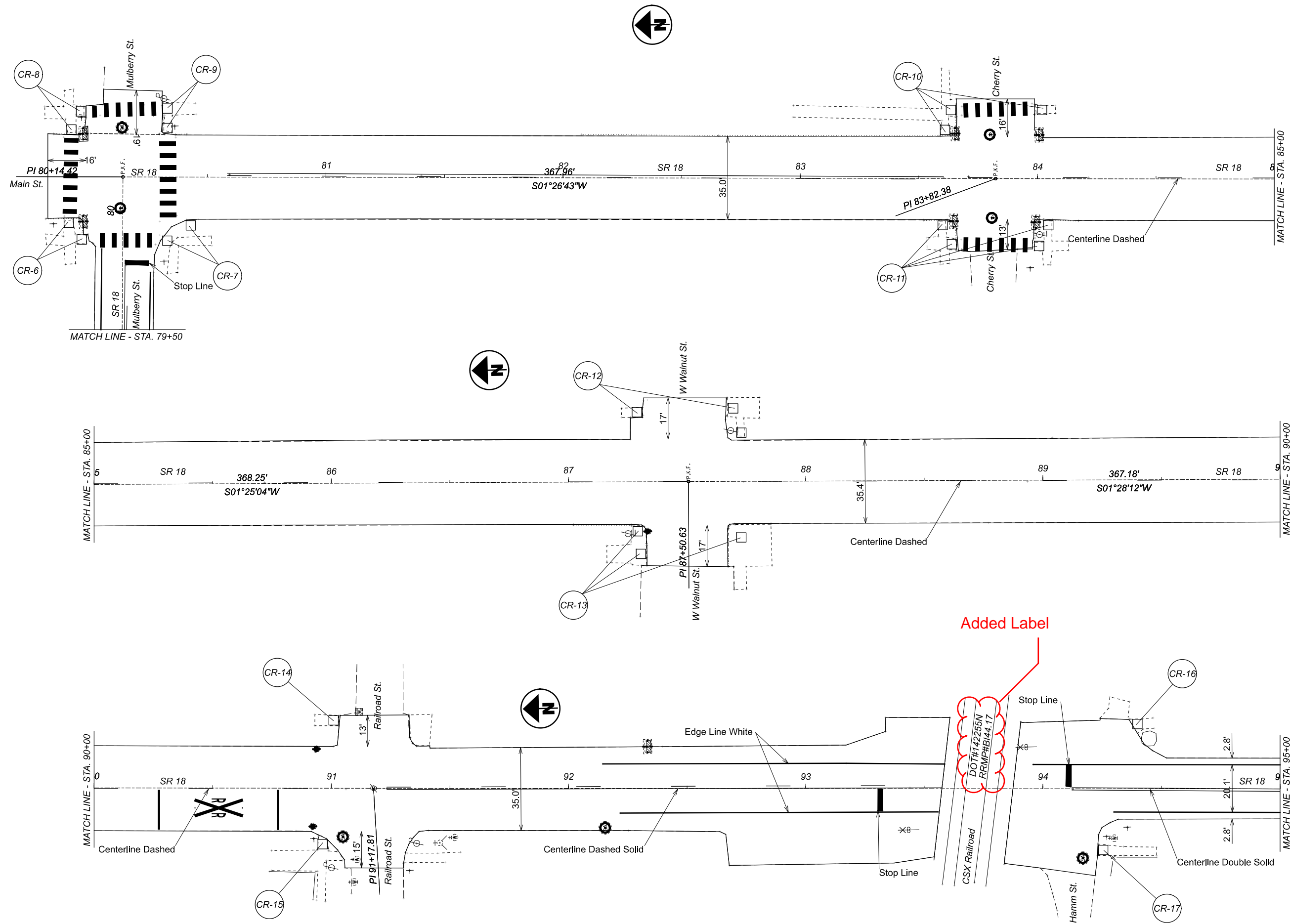

PLAN SHEET - SR 18  
STA. 79+50 to STA. 95+00

DESIGN AGENCY



DESIGNER

JWZ

REVIEWER

JMF MM-DD-YY

PROJECT ID

95796

SHEET TOTAL

23 28