

Wyandot County State Highway "H"  
 Bucyrus-Upper Sandusky Road  
 I.C.H. No. 200 Petition No 1212  
 Surveyed Spring 1915  
 W.E. Martin Res. Engr.

Scale:  
 1" = 100' horz  
 1" = 10' vert

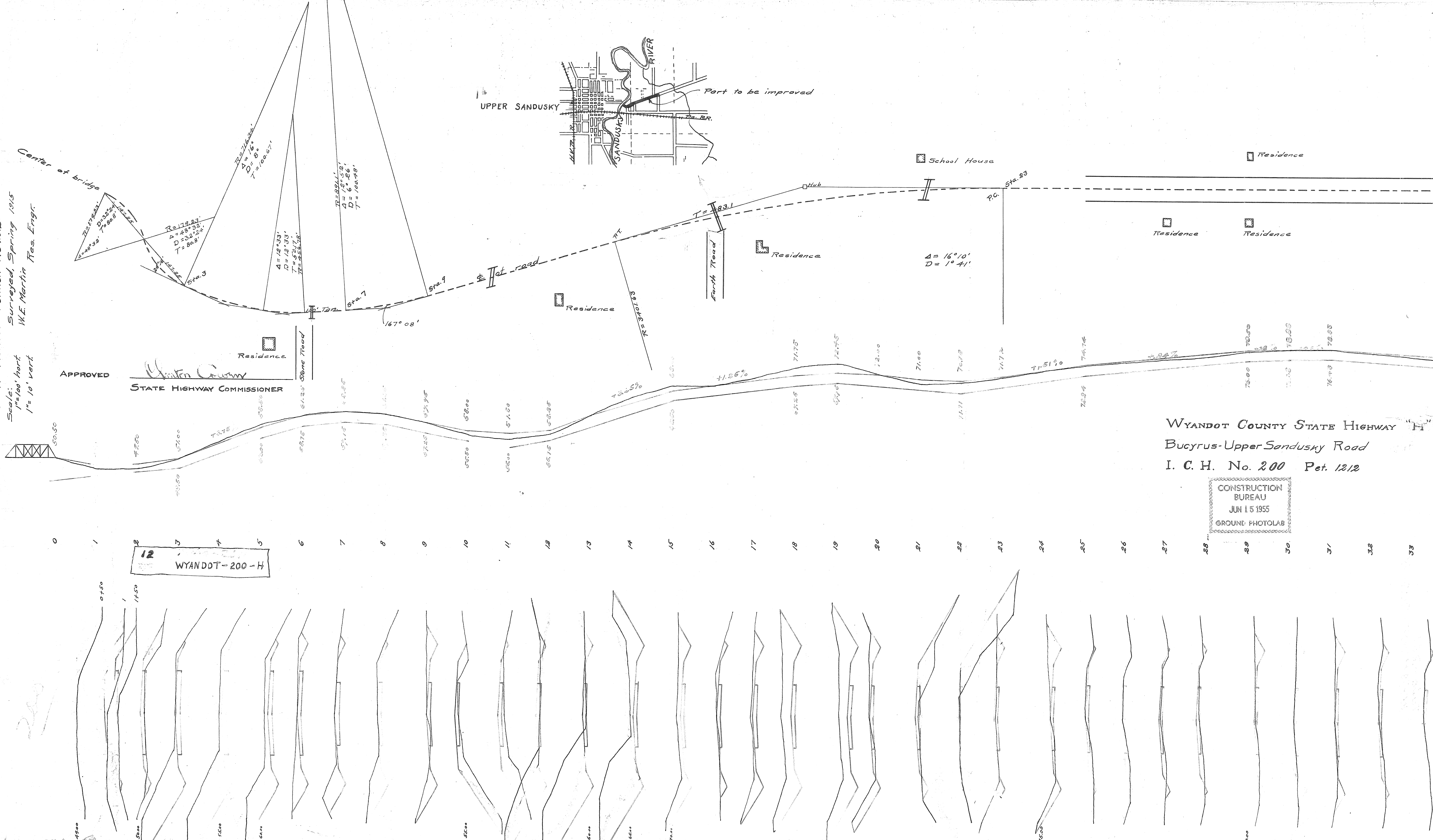

12  
 WYANDOT-200-H

WYANDOT COUNTY STATE HIGHWAY "H"  
 Bucyrus-Upper Sandusky Road  
 I. C. H. No. 200 Pet. 1212

CONSTRUCTION BUREAU  
 JUN 15 1955  
 GROUND PHOTOLAB

