

CALCULATED	SKL	CHECKED	JMF
0	10	0	0

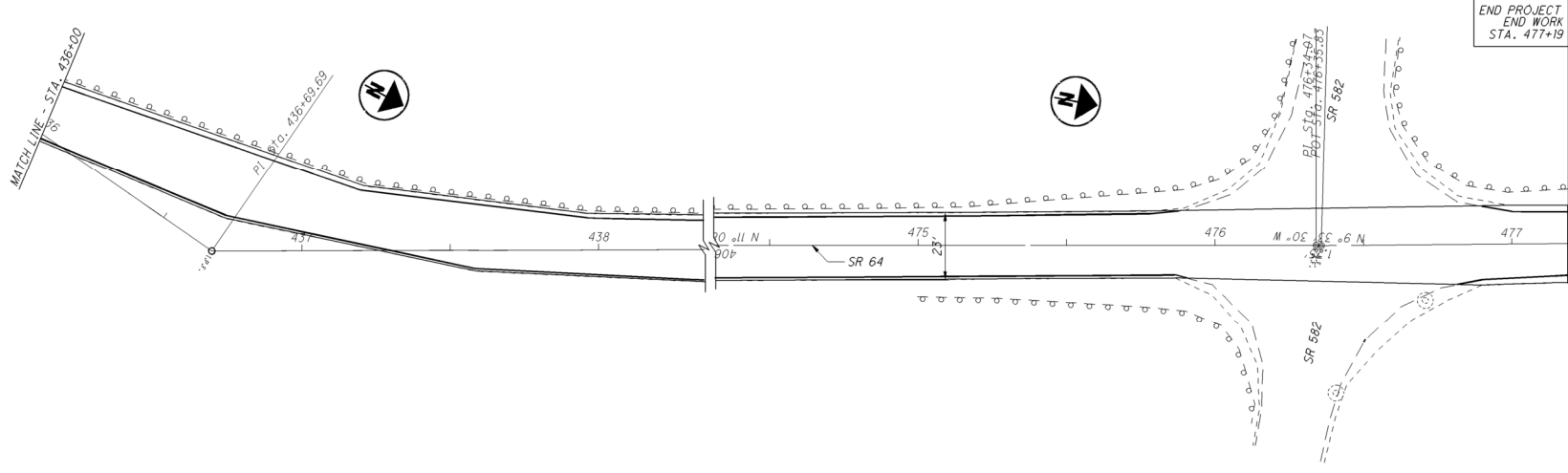

PLAN SHEET - SR 64
STA. 336+00 TO STA. 435+00

WOO-64-4.12



I:\projects\WOOD\88495\structures\WOOD064-0746C\sheet\064-0746CSP001.dgn 03-APR-2013 10:52AM bnfll

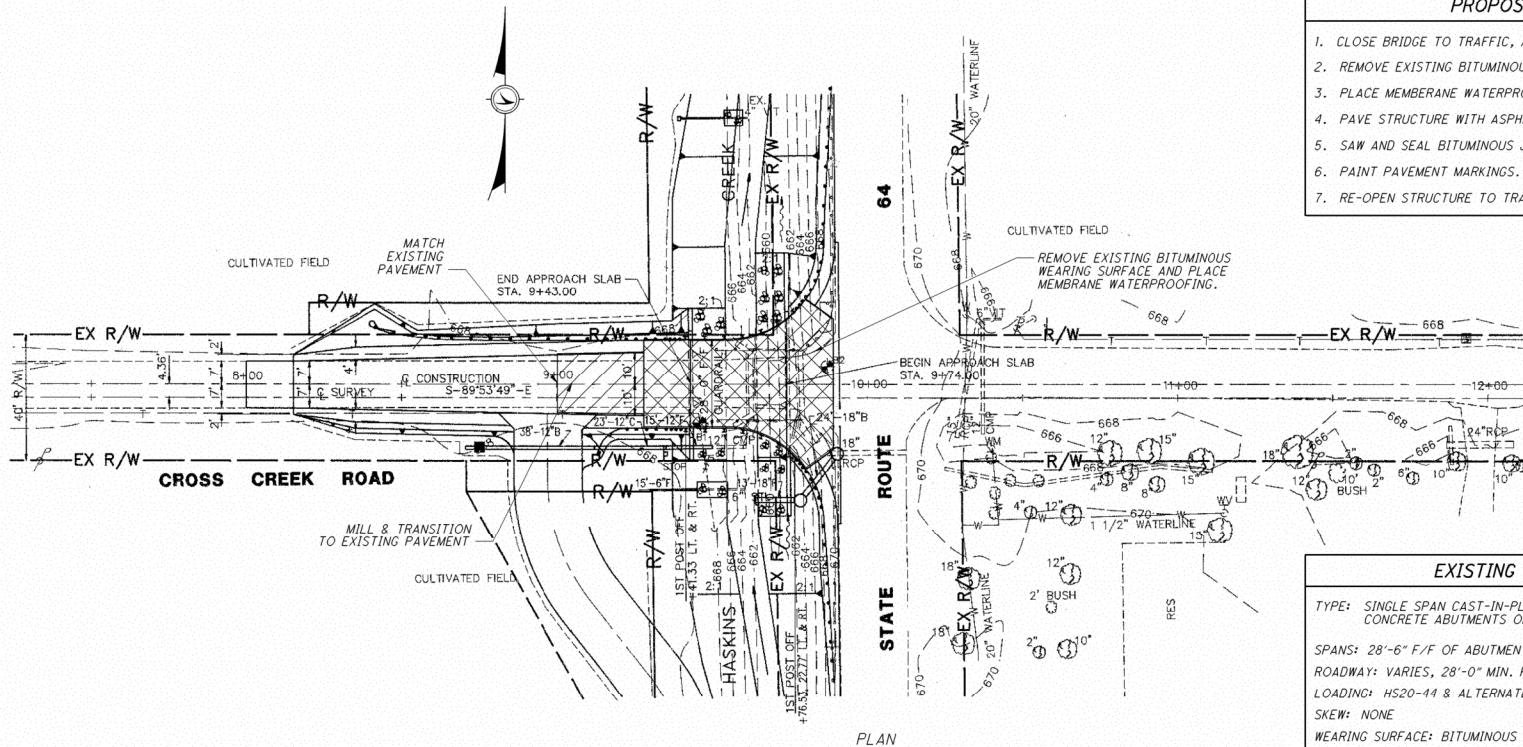

PLAN

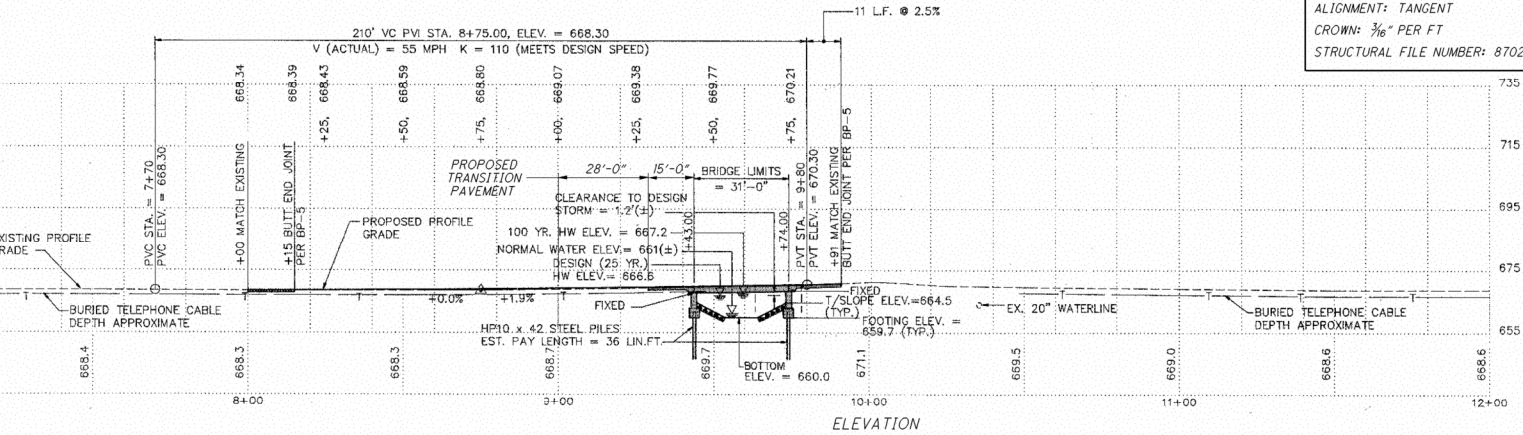

REGION AGENCY OHIO DEPARTMENT OF TRANSPORTATION	DESIGNED	DATE
	DRAWN	REVIEWED
WOOD COUNTY STA. 9+43.00 STA. 9+74.00	BPN	STRUCTURE FILE NUMBER 8702381
	DAH	
SITE PLAN BRIDGE NO. W00-64-0746 OVER HASKINS CREEK	WOOD COUNTY	DATE
	PID No. 88495	
1 / 3		
12		
14		

ESTIMATED QUANTITIES				FUNDING 02/STR/PV				
ITEM	EXTENSION	TOTAL	UNIT	DESCRIPTION	ABUT.	PIERS	SUPER.	GEN.
202	23501	295	SQ YD	WEARING COURSE REMOVED, AS PER PLAN			106	189
407	10000	22	GALLON	TACK COAT			8	14
448	47020	16	CU YD	ASPHALT CONCRETE SURFACE COURSE, TYPE 1, PG 64-22			6	10
512	33010	122	SQ YD	TYPE 3 WATERPROOFING			106	16
SPECIAL	51631200	154	FT	SAWING AND SEALING BITUMINOUS CONCRETE JOINTS				154
SPECIAL	51822300	80	FT	STEEL DRIP STRIP			80	

EXISTING STRUCTURE VERIFICATION

DETAILS AND DIMENSIONS SHOWN ON THESE PLANS PERTAINING TO THE EXISTING STRUCTURE HAVE BEEN OBTAINED FROM PLANS OF THE EXISTING STRUCTURE AND FROM FIELD OBSERVATIONS AND MEASUREMENTS. CONSEQUENTLY, THEY ARE INDICATIVE OF THE EXISTING STRUCTURE AND THE PROPOSED WORK BUT THEY SHALL BE CONSIDERED TENTATIVE AND APPROXIMATE. THE CONTRACTOR IS REFERRED TO CMS SECTIONS 102.05 AND 513.04.

CONTRACT BID PRICES SHALL BE BASED UPON RECOGNITION OF THE UNCERTAINTIES DESCRIBED ABOVE AND UPON A PREBID EXAMINATION OF THE EXISTING STRUCTURE BY THE CONTRACTOR. HOWEVER, ALL PROJECT WORK SHALL BE BASED UPON ACTUAL DETAILS AND DIMENSIONS WHICH HAVE BEEN VERIFIED BY THE CONTRACTOR IN THE FIELD.

MAINTAINING TRAFFIC:

THE CONTRACTOR WILL BE PERMITTED TO CLOSE THE BRIDGE TO THROUGH TRAFFIC FOR A PERIOD NOT TO EXCEED 4 DAYS. IF THE BRIDGE REMAINS CLOSED BEYOND THE TIME ALLOTTED WITHOUT REASON, THE DEPARTMENT WILL ASSESS LIQUIDATED DAMAGES AS PER 108.07. THE CONTRACTOR WILL BE RESPONSIBLE FOR TYPE 3 BARRICADES AS PER STANDARD DRAWING MT-101.60 LOCATED AT THE LIMITS OF THE CLOSURE. THE WOOD COUNTY ENGINEER (419-354-9060) WILL ESTABLISH AND MAINTAIN THE DETOUR. SEVEN (7) WORKING DAYS PRIOR TO CLOSING THE BRIDGE TO TRAFFIC, THE CONTRACTOR SHALL NOTIFY THE ENGINEER IN WRITING. COST OF MAINTAINING TRAFFIC SHALL BE LUMP SUM AND INCLUDED WITH ITEM 614 AS SHOWN ON SHEET 5.

ITEM 202, WEARING COURSE REMOVED, AS PER PLAN:

THE CONTRACTOR SHALL EXERCISE EXTREME CARE WHEN MACHINE GRINDING ON THE BRIDGE SUPERSTRUCTURE. THE CONTRACTOR SHOULD VERIFY THE GRINDER DEPTH TO INSURE THAT NO DAMAGE TO THE EXISTING BOX BEAMS AND OTHER ITEMS TO REMAIN WILL OCCUR. DAMAGE TO THESE ITEMS DUE TO IMPROPER REMOVAL PROCEDURE WILL BE REPAIRED OR REPLACED AT THE OPTION OF THE ENGINEER. ALL COST FOR REPAIRS OR REPLACEMENT SHALL BE BORN BY THE CONTRACTOR. ALL COSTS FOR REMOVAL OF THE DRIP STRIP SHALL BE CONSIDERED INCIDENTAL TO ITEM 202, WEARING COURSE REMOVED, AS PER PLAN AND SHALL INCLUDE ALL COST FOR LABOR, MATERIALS AND EQUIPMENT TO COMPLETE THE WORK TO THE SATISFACTION OF THE ENGINEER.

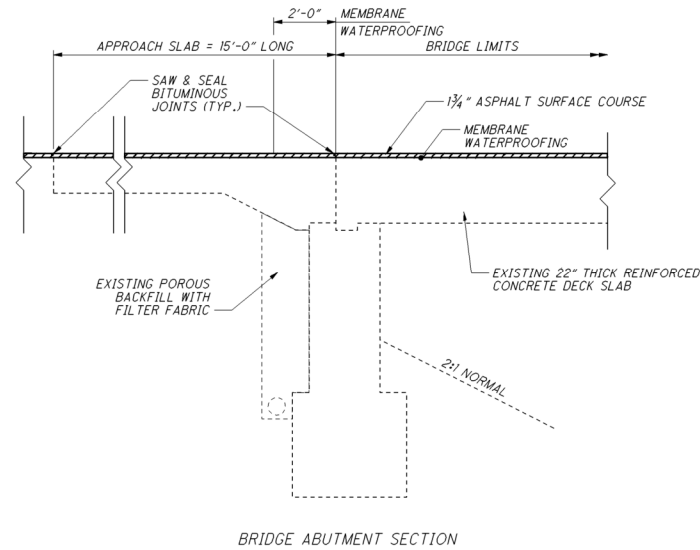

BRIDGE ABUTMENT SECTION

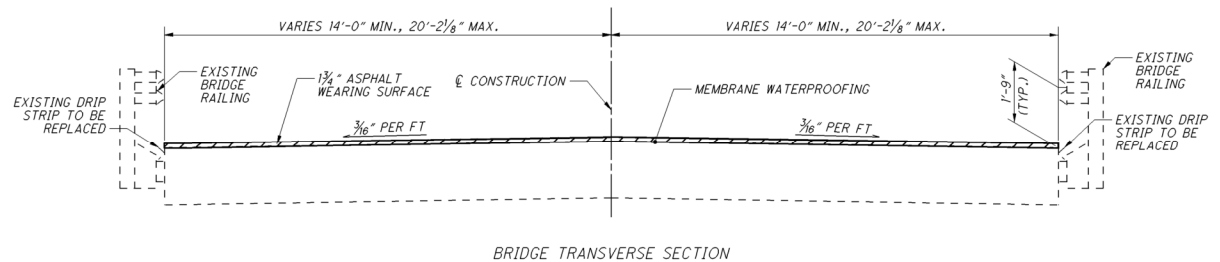

BRIDGE TRANSVERSE SECTION

REGION AGENCY
OHIO DEPARTMENT
OF TRANSPORTATION

REVIEWED DATE
DRAWN BPN
DESIGNED BPN
CHECKED DAH

STRUCTURE FILE NUMBER
8702381

STRUCTURE DETAILS, NOTES AND QUANTITIES
BRIDGE NO. W00-64-0746
OVER HASKINS CREEK

W00-64-4.12
PID No. 88495

2 / 3

13
14

I:\projects\W00\88495\structures\W00064-0746\03_sheets\064-0746\CTS001.dgn 03-APR-2013 10:50AM bnoil

I:\projects\WOOD\88495\structures\WOOD064_0746C\sheets\064_0746C\MD001.dgn 17-DEC-2012 8:44 AM jbdjng

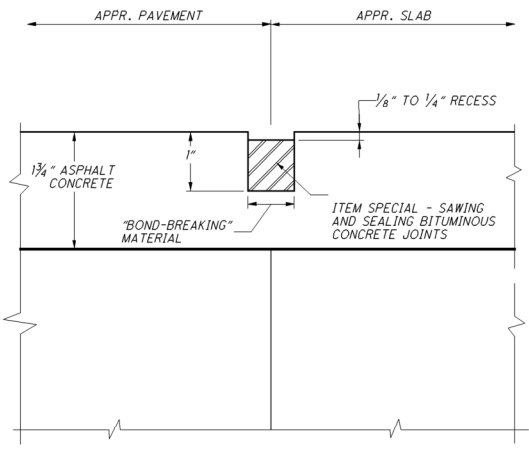

SEALING OF JOINTS AT ABUTMENTS AND ENDS OF APPROACH SLABS

ITEM SPECIAL-SAWING AND SEALING BITUMINOUS CONCRETE JOINTS

1) DESCRIPTION:

THIS WORK SHALL CONSIST OF CUTTING AND SEALING TRANSVERSE JOINTS IN THE NEW BITUMINOUS CONCRETE OVERLAY. BITUMINOUS CONCRETE JOINTS SHALL BE CONSTRUCTED DIRECTLY OVER, AND IN LINE WITH, THE EXISTING UNDERLYING TRANSVERSE JOINT OF THE APPROACH SLAB & APPROACH PAVEMENT.

2) MATERIALS:

THE JOINT SEALANT SHALL MEET THE REQUIREMENTS OF ITEM 705.04, JOINT SEALANTS, HOT-POURED, FOR CONCRETE AND ASPHALT PAVEMENTS. ACCEPTABLE ALTERNATE MATERIALS ARE:

A SILICONE SEALANT MEETING FEDERAL SPECIFICATIONS TT-S-001543A CLASS A (ONE-PART SILICONE SEALANTS) AND TT-S-00230C CLASS A (ONE-COMPONENT SEALANTS), SUCH AS THOSE MANUFACTURED BY GENERAL ELECTRIC, SILICONE PRODUCTS DIVISION, 4015 EXECUTIVE PARK DRIVE, CINCINNATI, OHIO 45242 (513-243-1953) OR DOW CORNING, 400 TECHNE CENTER, SUITE 103, MILFORD, OHIO 45150 (513-831-3586); OR SOF-SEAL, A COLD-APPLIED, LOW-MODULUS, TWO-COMPONENT POLY-MERIC COMPOUND HORIZONTAL SEALANT AS MANUFACTURED BY W.R.MEADOWS, INC., P.O.BOX 543, ELGIN, ILLINOIS 60121 (800-342-5976).

3) CONSTRUCTION DETAILS:

A) GENERAL: THE CONTRACTOR SHALL CONDUCT HIS OPERATION SO THAT THE CUTTING, CLEANING AND SEALING OF TRANSVERSE JOINTS IS A CONTINUOUS OPERATION THAT WILL BE PERFORMED AS SOON AS PRACTICAL AFTER THE PAVING, BUT NO LATER THAN FOUR (4) DAYS AFTER PLACEMENT OF THE ASPHALT CONCRETE SURFACE COURSE. TRAFFIC SHALL NOT BE ALLOWED TO KNEAD TOGETHER OR DAMAGE JOINT CUT PRIOR TO SEALING.

B) CUTTING OF TRANSVERSE JOINTS: THE CONTRACTOR SHALL SAW OR ROUT TRANSVERSE JOINTS TO THE DIMENSIONS SHOWN IN THE DETAILS ON THIS SHEET. THE CUT JOINTS SHALL LIE DIRECTLY ABOVE EACH APPROACH SLAB END.

THE BLADE OR BLADES SHALL BE OF SUCH SIZE THAT THE FULL WIDTH AND DEPTH OF THE CUT CAN BE MADE WITH ONE PASS. DRY OR WET CUTTING WILL BE ALLOWED. JOINTS SHALL EXTEND THE FULL WIDTH OF THE BRIDGE.

C) CLEANING JOINTS: DRY SAWED JOINTS SHALL BE THOROUGHLY CLEANED WITH A SUFFICIENT AMOUNT OF COMPRESSED AIR TO REMOVE ANY DIRT, DUST, OR DELETERIOUS MATTER. WET SAWED JOINTS SHALL BE WASHED CLEAN OF ALL CUTTINGS BY FLUSHING WITH A JET OF WATER AND WITH OTHER TOOLS AS NECESSARY. AFTER FLUSHING, THE JOINT SHALL BE BLOWN OUT WITH COMPRESSED AIR. WHEN THE SURFACES ARE THOROUGHLY CLEAN AND DRY, AND JUST PRIOR TO PLACING THE JOINT SEALER, COMPRESSED AIR HAVING A PRESSURE OF AT LEAST 90 P.S.I. SHALL BE USED TO BLOW OUT THE JOINT AND REMOVE ALL TRACES OF DUST.

IN THE EVENT FRESHLY CUT JOINTS BECOME CONTAMINATED BEFORE THEY ARE SEALED, THEY SHALL BE RECLEANED OF ALL FOREIGN MATERIAL BY HIGH PRESSURE WATER JET.

D) SEALING JOINTS: THE JOINT SHALL BE THOROUGHLY DRY WHEN THE SEALANT IS PLACED. AFTER CLEANING AND DRYING, A BOND-BREAKER MATERIAL SHALL BE APPLIED TO THE BOTTOM OF THE GROOVE.

HOT-POURED JOINT SEALANT MATERIAL SHALL BE HEATED IN A KETTLE OR MELTER CONSTRUCTED AS A DOUBLE BOILER, WITH THE SPACE BETWEEN THE INNER AND OUTER SHELLS FILLED WITH OIL OR OTHER HEAT TRANSFER MEDIUM. POSITIVE TEMPERATURE CONTROL AND MECHANICAL AGITATION SHALL BE PROVIDED. HEATING MUST BE IN STRICT ACCORDANCE WITH THE MANUFACTURER'S RECOMMENDATION. JOINT SEALER MATERIAL SHALL NEVER BE KEPT HEATED AT THE POURING TEMPERATURE FOR MORE THAN FOUR (4) HOURS AND SHALL NEVER BE REHEATED. SEALER LEFT IN THE APPLICATOR AT THE END OF A DAY'S WORK SHALL NOT BE USED.

HOT-POURED SEALANT SHALL BE APPLIED IMMEDIATELY THROUGH A NOZZLE, WHICH MUST PROJECT INTO THE SAWED JOINT, FILLING FROM THE BOTTOM UP. THE SEALANT SHALL COMPLETELY FILL THE JOINT IN SUCH A MANNER THAT, AFTER COOLING, THE LEVEL OF THE SEALANT WILL NOT BE HIGHER THAN 1/8" BELOW THE PAVEMENT SURFACE. ANY DEPRESSION IN THE COOLED SEAL GREATER THAN 3/16" SHALL BE BROUGHT UP TO THE SPECIFIED LIMIT BY FURTHER ADDITION OF HOT-POURED SEALANT. CARE SHALL BE TAKEN IN THE SEALING OF THE JOINTS SO THAT THE FINAL APPEARANCE WILL PRESENT A NEAT FINE LINE.

THE COLD APPLIED SEALANT MATERIALS (POLYURETHANE, SILICONE, AND POLYMERIC COMPOUNDS) SHALL BE INSTALLED AS PER MANUFACTURERS' RECOMMENDATIONS, EXCEPT AS MODIFIED BY THIS DRAWING. THE SEALANT SHALL BE INSTALLED WHEN THE AMBIENT TEMPERATURE IS 40 DEGREES F OR HIGHER. TRAFFIC SHALL NOT BE ALLOWED ON THE JOINT FOR ONE HOUR AFTER APPLICATION OF THE SEALANT.

4) METHOD OF MEASUREMENT:

THE QUANTITY TO BE PAID FOR UNDER THIS ITEM WILL BE THE NUMBER OF LINEAR FEET OF JOINTS SAWED AND SEALED AS PER THE ABOVE REQUIREMENTS.

5) BASIS OF PAYMENT:

THE UNIT PRICE PER LINEAR FOOT FOR ITEM SPECIAL-SAWING AND SEALING BITUMINOUS CONCRETE JOINTS SHALL INCLUDE THE COST OF ALL LABOR, MATERIALS, AND EQUIPMENT NECESSARY TO COMPLETE THE WORK, INCLUDING THE FURNISHING AND PLACING OF THE JOINT SEALER MATERIAL.

THIS ITEM SHALL MEET THE MATERIAL (SECTION 2) AND SEALING (SECTION 3D) SPECIFICATIONS OF ITEM SPECIAL-SAWING AND SEALING BITUMINOUS CONCRETE JOINTS.

DESIGNED		CHECKED		DRAWN		REVIEWED		DATE		REGION AGENCY	
BPN		DAH		BPN		BPN				OHIO DEPARTMENT	
BPN		DAH		BPN		BPN				OF TRANSPORTATION	
BPN		DAH		BPN		BPN				STRUCTURE FILE NUMBER	
BPN		DAH		BPN		BPN				8702381	
SAWING AND SEALING BITUMINOUS CONCRETE											
BRIDGE NO. WOO-64-0746 OVER HASKINS CREEK											
WOO-64-4.12				PID No. 88495							
3		3		14		14					

FEDERAL PROJECT NO. E100712

PID NO. 88495

CONSTRUCTION PROJECT NO.

RAILROAD INVOLVEMENT NONE

WOO-64-4.12

1/14

PROJECT DESCRIPTION

UPGRADING 5.03 MILES OF WOOD COUNTY SR 64 BY RESURFACING, INCLUDING PAVEMENT REPAIRS AND ANY RELATED WORK.

PROJECT EARTH DISTURBED AREA: 0.0 ACRES
ESTIMATED CONTRACTOR EARTH DISTURBED AREA: 0.0 ACRES
NOTICE OF INTENT EARTH DISTURBED AREA: N/A - NOT REQUIRED

2010 SPECIFICATIONS

THE STANDARD SPECIFICATIONS OF THE STATE OF OHIO, DEPARTMENT OF TRANSPORTATION, INCLUDING CHANGES AND SUPPLEMENTAL SPECIFICATIONS LISTED IN THE PROPOSAL SHALL GOVERN THIS IMPROVEMENT.

I HEREBY APPROVE THESE PLANS AND DECLARE THAT THE MAKING OF THIS IMPROVEMENT WILL NOT REQUIRE THE CLOSING TO TRAFFIC OF THE HIGHWAY EXCEPT FOR THE SIDE ROADS AS DESCRIBED ON SHEET 13 AND THAT PROVISIONS FOR THE MAINTENANCE AND SAFETY OF TRAFFIC WILL BE AS SET FORTH ON THE PLANS AND ESTIMATES.

APPROVED: *John M. Russett P.E.*
DATE: 13 DEC 12 DISTRICT DEPUTY DIRECTOR

APPROVED: *Gregory J. ...*
DATE: 7-18-13 DIRECTOR, DEPARTMENT OF TRANSPORTATION

STATE OF OHIO
DEPARTMENT OF TRANSPORTATION

WOO-64-4.12
CITY OF BOWLING GREEN
VILLAGE OF HASKINS
PLAIN & MIDDLETON TOWNSHIPS
WOOD COUNTY

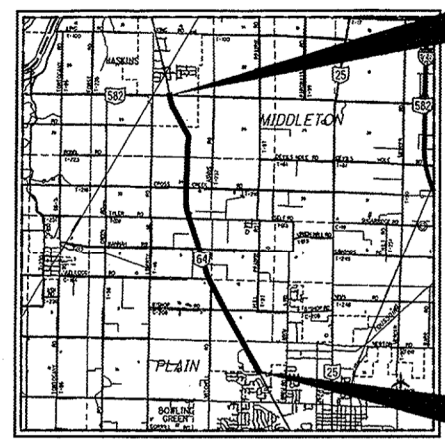

END PROJECT
END WORK
STA. 477+19

BEGIN PROJECT
BEGIN WORK
STA. 217+68

INDEX OF SHEETS:

TITLE SHEET	1
TYPICAL SECTIONS	2
GENERAL NOTES	3
MAINTENANCE OF TRAFFIC NOTES	5
GENERAL SUMMARY	6
SUBSUMMARIES	7
PLAN SHEETS	8-11
STRUCTURES UNDER 20'	12-14
WOO-64-0746	

LOCATION MAP

LATITUDE: 41°25'22" LONGITUDE: 83°41'35"

SCALE IN MILES

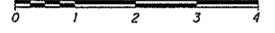

PORTION TO BE IMPROVED	_____
INTERSTATE HIGHWAY	_____
FEDERAL ROUTES	_____
STATE ROUTES	_____
COUNTY & TOWNSHIP ROADS	_____
OTHER ROADS	_____

DESIGN DESIGNATION

CURRENT ADT (2013)	4400
DESIGN YEAR ADT (2025)	4800
DESIGN HOURLY VOLUME (2025)	530
DIRECTIONAL DISTRIBUTION	55%
TRUCKS (24 HOUR B&C)	2%
DESIGN SPEED	60 MPH
LEGAL SPEED	55 MPH
DESIGN FUNCTIONAL CLASSIFICATION:	
RURAL MAJOR COLLECTOR	
NHS PROJECT	NO

DESIGN EXCEPTIONS

NONE

ROADWAY:

SIGNED: *James T. Bradley*
DATE: 12-12-12

ROADWAY:

SIGNED: *Julie M. Fahy*
DATE: 12-12-12

STANDARD CONSTRUCTION DRAWINGS

STANDARD CONSTRUCTION DRAWINGS				SUPPLEMENTAL SPECIFICATIONS	
BP-3.1	4/20/12	TC-61.30	4/20/12	800	1/18/13
BP-4.1	7/16/04	TC-65.10	4/20/12	823	7/20/12
		TC-65.11	4/20/12	832	5/5/09
DN-4.3	7/20/12	TC-73.10	4/20/12		
DN-4.4	7/20/12				
		MT-97.12	7/20/12		
		MT-99.20	7/20/12		
		MT-105.10	7/20/12		

UNDERGROUND UTILITIES
CONTACT BOTH SERVICES
CALL TWO WORKING DAYS
BEFORE YOU DIG

CALL 1-800-362-2764 (TOLL FREE)

OHIO UTILITIES PROTECTION SERVICE
NON-MEMBERS
MUST BE CALLED DIRECTLY

OIL & GAS PRODUCERS UNDERGROUND
PROTECTION SERVICE CALL: 1-800-925-0988

PLAN PREPARED BY:
OHIO DEPT. OF TRANSPORTATION
DISTRICT TWO
BOWLING GREEN, OHIO

WOO - SR-64-4.12
130245 PID - 88495
Dist 2 4/11/2013
Contract Proposal Available @ www.contracts.dot.state.oh.us/home

PROJECTS\WOOD\88495\WOOD\Sheet

I:\projects\W00-64-4.12\roadway\sheet\88495-G\001.dgn 17-DEC-2012 8:43AM jbdjng

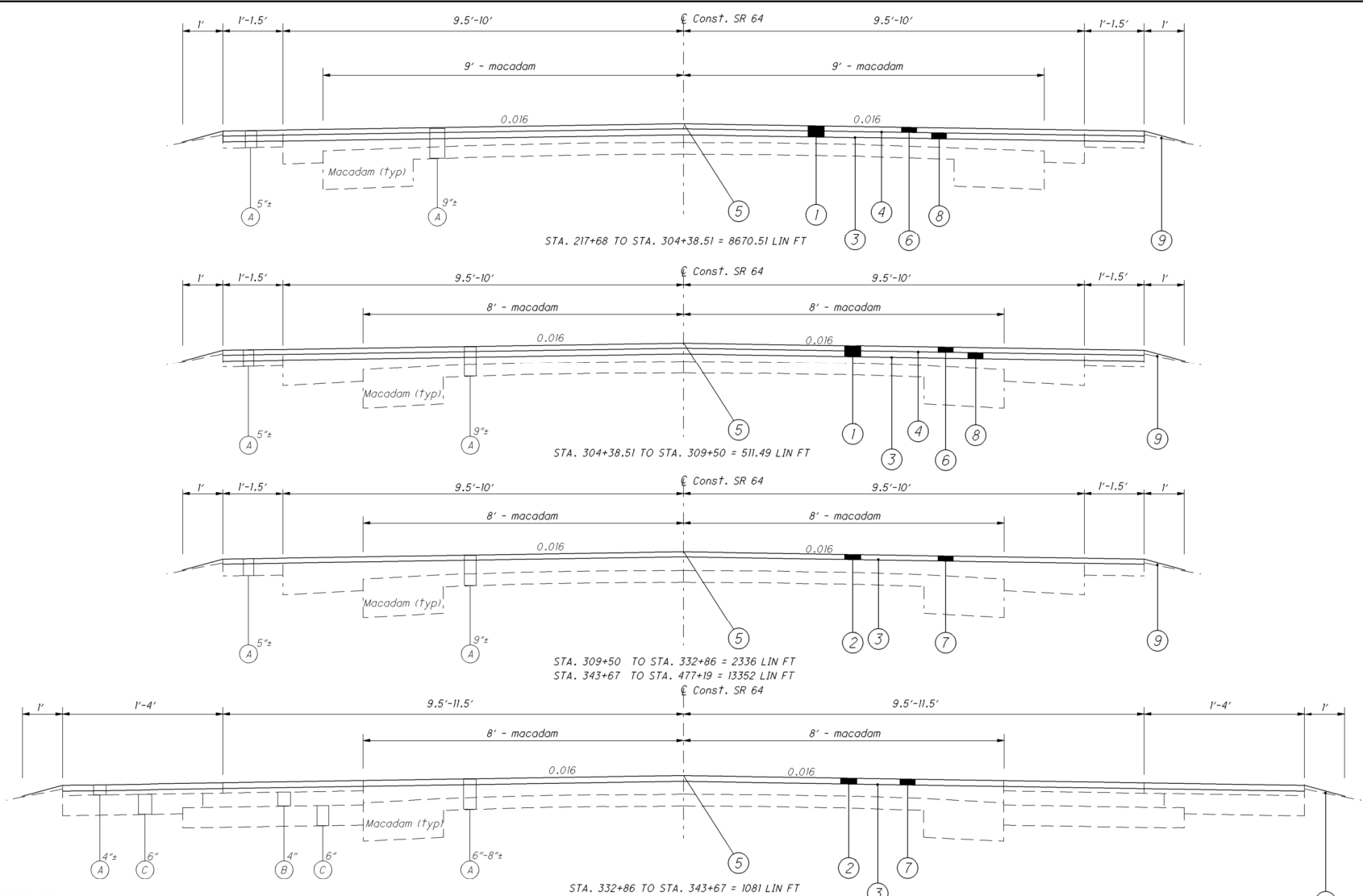

- PROPOSED**
- ① Item 254 - Pavement Planing, Asphalt Concrete - 3/4"
 - ② Item 254 - Pavement Planing, Asphalt Concrete - 1 3/4"
 - ③ Item 407 - Tack Coat (0.075 gal/sq yd)
 - ④ Item 407 - Tack Coat for Intermediate Course (0.04 gal/sq yd)
 - ⑤ Item 409 - Sealing, Misc. Longitudinal Joint Sealer at Cold Joints (Typical)
 - ⑥ Item 448 - Asphalt Concrete Surface Course, Type 1, PG 64-22 - 1/2"
 - ⑦ Item 448 - Asphalt Concrete Surface Course, Type 1, PG 64-22 - 1 3/4"
 - ⑧ Item 448 - Asphalt Concrete Intermediate Course, Type 2, PG 64-22 - 1 3/4"
 - ⑨ Item 617 - Compacted Aggregate

- EXISTING LEGEND**
- Ⓐ ASPHALT CONCRETE (MACADAM BASE APPROX. 3.5")
 - Ⓑ BITUMINOUS AGGREGATE BASE
 - Ⓒ AGGREGATE BASE

TYPICAL SECTIONS

W00-64-4.12

UTILITIES

THERE ARE NO UNDERGROUND UTILITIES SHOWN ON THIS PLAN. THE NATURE OF THE WORK REQUIRED BY THIS PROJECT WILL NOT AFFECT ANY KNOWN UNDERGROUND UTILITIES THAT EXIST UNDER OR ADJACENT TO THE WORK AREA.

ROUNDING

THE ROUNDING AT SLOPE BREAKPOINTS SHOWN ON THE TYPICAL SECTIONS APPLIES TO ALL CROSS-SECTIONS EVEN THOUGH OTHERWISE SHOWN.

WORK LIMITS

THE WORK LIMITS SHOWN ON THESE PLANS ARE FOR PHYSICAL CONSTRUCTION ONLY. PROVIDE THE INSTALLATION AND OPERATION OF ALL WORK ZONE TRAFFIC CONTROL AND WORK ZONE TRAFFIC CONTROL DEVICES REQUIRED BY THESE PLANS WHETHER INSIDE OR OUTSIDE THESE WORK LIMITS.

CONTINGENCY QUANTITIES

THE CONTRACTOR SHALL NOT ORDER MATERIALS OR PERFORM WORK FOR ITEMS DESIGNATED BY PLAN NOTE TO BE USED AS DIRECTED BY THE ENGINEER UNLESS AUTHORIZED BY THE ENGINEER. THE ACTUAL WORK LOCATIONS AND QUANTITIES USED FOR SUCH ITEMS SHALL BE INCORPORATED INTO THE FINAL CHANGE ORDER GOVERNING COMPLETION OF THIS PROJECT.

PROFILE AND ALIGNMENT

PLACE THE PROPOSED PAVEMENT TO FOLLOW THE ALIGNMENT AND PROFILE OF THE EXISTING PAVEMENT. THE PROPOSED ASPHALT CONCRETE OVERLAY SHALL BE AS SHOWN ON THE TYPICAL SECTIONS.

PERMIT NOTIFICATION

THE CONTRACTOR SHALL GIVE A 15 DAY NOTICE PRIOR TO ANY LANE RESTRICTION TO AVOID ANY CONFLICT OF PERMITTED LOADS DURING THIS CONSTRUCTION. THE CONTRACTOR SHALL NOTIFY THE FOLLOWING:

OHIO DEPARTMENT OF TRANSPORTATION
DISTRICT 2 - PERMIT OFFICE
317 EAST POE ROAD
BOWLING GREEN, OHIO 43402
PH: 419-373-4414

ELEVATION DATUM

ALL ELEVATIONS ARE ORTHOMETRIC HEIGHTS USING THE NORTH AMERICAN VERTICAL DATUM OF 1988 (NAVD 88) AND THE GEOID03 GEOID. HORIZONTAL POSITIONS ARE BASED ON THE OHIO STATE PLANE NORTH ZONE, A LAMBERT CONFORMAL CONIC MAP PROJECTION, THE NORTH AMERICAN DATUM OF 1983 ADJUSTED TO THE NATIONAL SPATIAL REFERENCE SYSTEM OF 2007 (NAD 83 (NSRS 2007)), AND THE GR580 ELLIPSOID.

SMOOTHNESS

WOO-64 SHALL USE PN470.

ITEM 604, ITEMS ADJUSTED TO GRADE

THE FOLLOWING ESTIMATED QUANTITY IS TO BE USED FOR ADJUSTMENTS REQUIRED FOR THE FOLLOWING ITEM, AS DIRECTED BY THE ENGINEER:

ITEM 604, MONUMENT BOX ADJUSTED TO GRADE 2 EACH

ITEM 253, PAVEMENT REPAIR:

PAVEMENT SHALL BE PLANNED BEFORE PAVEMENT REPAIRS ARE PERFORMED.

ALL EXISTING PAVEMENT AREAS WHICH WILL BE IN CONTACT WITH THE PAVEMENT REPAIR SHALL BE COATED WITH PG GRADE LIQUID ASPHALT (SIDES AND BOTTOM) AT AN APPLICATION RATE OF 0.25 GAL. PER SQ YD.)

THE FOLLOWING ESTIMATED QUANTITY IS TO BE USED FOR 8" PAVEMENT REPAIR FOR SR 64 AS DIRECTED BY THE ENGINEER AND BASED ON THE PERCENTAGE SHOWN BELOW.

SR 64 (4.12-9.03) 20% 2945 CU YD

QUANTITY CARRIED TO THE GENERAL SUMMARY.

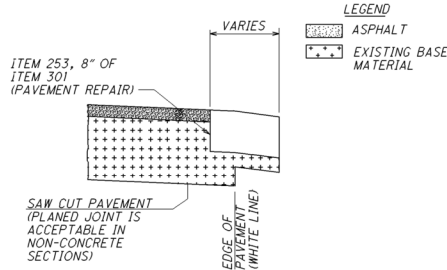

TRAFFIC CONTROL QUANTITIES

THE CONTRACTOR WILL BE PROVIDED WITH THE "NO PASSING ZONE LOG" FOR THE CENTER LINE PAVEMENT MARKING AT THE PRE-CONSTRUCTION MEETING. THE FOLLOWING QUANTITIES ARE FOR INFORMATION ONLY:

YELLOW CENTER LINE	
DASHED	3.37 MILE
DASHED SOLID	1.29 MILE
DOUBLE SOLID	0.25 MILE

RPM's		TWO WAY YELLOW/YELLOW
325	8	TWO WAY WHITE/RED

ITEM QTY	UNIT	DESCRIPTION
621	333	EACH RPM
621	275	EACH RAISED PAVEMENT MARKER REMOVED
642	9.82	MILE EDGE LINE, 4"
642	4.91	MILE CENTER LINE
644	23	FT STOP LINE
644	259	FT CHANNELIZING LINE, 8"
644	3	EACH LANE ARROW

ALL TRAFFIC CONTROL QUANTITIES ARE CARRIED TO THE GENERAL SUMMARY.

ITEM 409, SEALER, MISC.: LONGITUDINAL JOINT SEALER

409.01 DESCRIPTION

THE WORK SHALL CONSIST OF FURNISHING AND INSTALLING A HOT-APPLIED ASPHALTIC JOINT ADHESIVE/SEALER ON LONGITUDINAL COLD CONSTRUCTION JOINTS IN ASPHALT CONCRETE PAVEMENTS AS SHOWN IN THE PLANS IN ACCORDANCE WITH THESE SPECIAL PROVISIONS.

409.02 MATERIALS

MATERIALS SHALL MEET THE FOLLOWING REQUIREMENTS:

Characteristic	Test	Value
Brookfield Viscosity @ 400° F	ASTM D 3236	4000-10000 cp
Cone Penetration @ 77° F	ASTM D 5329	60-100
Flow @ 140° F	ASTM D 5329	5mm max.
Resilience @ 77° F	ASTM D 5329	30% min.
Ductility @ 77° F	ASTM D 113	30 cm min.
Ductility @ 39.2° F	ASTM D 113	30 cm min.
Tensile Adhesion @ 77° F	ASTM D 5329	500% min.
Softening Point	ASTM D 36	170° F min.
Asphalt Compatibility	ASTM D 5329	Pass

THE MATERIAL SHALL BE "CRAFCO PAVEMENT JOINT ADHESIVE, PRODUCT NO. 34524" OR APPROVED EQUAL.

409.03 INSTALLATION

INSTALLATION SHALL BE IN ACCORDANCE WITH THE RECOMMENDATIONS OF THE MANUFACTURER.

409.04 BASIS OF PAYMENT

WORK UNDER THIS ITEM SHALL BE PAID FOR AT THE CONTRACT UNIT PRICE BID PER POUND, FURNISHED AND PLACED. PRICE AND PAYMENT SHALL BE FULL COMPENSATION FOR ALL MATERIALS, LABOR, EQUIPMENT, TOOLS, AND INCIDENTALS NECESSARY TO PERFORM THE WORK, COMPLETE IN PLACE AND ACCEPTED.

PAYMENT SHALL BE MADE UNDER:

ITEM 409 - SEALER, MISC.: LONGITUDINAL JOINT SEALER

WOO SR 64 - STA. 217+68 TO STA. 477+19
 25951 x 1 POUND = 6488 LBS.
 4 FT.

QUANTITY CARRIED TO THE GENERAL SUMMARY.

ITEM 209, PREPARING SUBGRADE FOR SHOULDER PAVING, AS PER PLAN

PREPARE THE SHOULDER FOR PAVING A CONSISTENT SAFETY EDGE IN BOTH THICKNESS AND WIDTH.

PRIOR TO PAVING THE SAFETY EDGE, GRADE AN ADDITIONAL WIDTH OF 10" OF EMBANKMENT, AGGREGATE, OR OTHER MATERIAL THAT EXISTS AT THE OUTSIDE EDGE OF PAVED ROADWAY TO PROVIDE A CROSS SECTION FOR A UNIFORM THICKNESS AND WIDTH OF SAFETY EDGE.

COMPACT THE GRADED SHOULDER ACCORDING TO 617.05, OR AS DIRECTED BY THE ENGINEER.

DO NOT DISTURB SHOULDER AT DITCH/GUARDRAIL LOCATIONS.

0.28 MILES - WOO SR 64 (4.12-4.26)
 5.02 MILES - WOO SR 64 (4.26-9.03)
 A QUANTITY OF 5.30 MILES HAS BEEN CARRIED TO THE GENERAL SUMMARY FOR PREPARING SUBGRADE FOR SHOULDERS.

ITEM 448, ASPHALT CONCRETE - SAFETY EDGE

IN ADDITION TO THE REQUIREMENTS OF 401.12, ATTACH A DEVICE TO THE SCREED OF THE PAVER THAT CONFINES THE MATERIAL AT THE END GATE AND EXTRUDES THE ASPHALT MATERIAL IN SUCH A WAY THAT RESULTS IN A COMPACTED WEDGE SHAPE PAVEMENT EDGE OF APPROXIMATELY 30 DEGREES (NOT STEEPER THAN 40 DEGREES). ENSURE THE DEVICE MAINTAINS CONTACT WITH THE EXISTING SURFACE, AND ALLOW FOR AUTOMATIC TRANSITION TO CROSS ROADS, DRIVEWAYS AND OBSTRUCTIONS. DO NOT USE CONVENTIONAL SINGLE PLATE STRIKE OFF.

CONSTRUCTION OF SAFETY EDGE CAN BE OMITTED AT LOCATIONS WHERE EXISTING WIDTH OF GRADED SHOULDER OR BERM IS LESS THAN 12". PROJECTS WITH VARYING CONDITIONS SHOULD USE SAFETY EDGE WHERE POSSIBLE. PLAN PREPARATION HAS MADE EVERY REASONABLE ATTEMPT TO IDENTIFY POSSIBLE SAFETY EDGE LOCATIONS.

USE THE TRANSTECH SHOULDER WEDGE MAKER, THE CARLSON SAFETY EDGE END GATE, THE ADVANT-EDGER, THE TROXLER SAFETYSLOPE OR A SIMILAR APPROVED EQUAL DEVICE THAT PRODUCES THE SAME WEDGE CONSOLIDATION RESULTS. CONTACT INFORMATION FOR THESE WEDGE SHAPE COMPACTION DEVICES IS THE FOLLOWING:

ADVANT-EDGE PAVING EQUIPMENT LLC
 P.O. BOX 9163
 NISKAYUNA, NY 12309-0163
 518-280-6090
 WWW.ADVANTEDGEPAVING.COM

CARLSON SAFETY EDGE END GATE
 18425 50TH AVENUE EAST
 TACOMA, WA 98446
 253-875-8000

TRANSTECH SYSTEMS, INC.
 1594 STATE STREET
 SCHENECTADY, NY 12304
 1-800-724-6306
 WWW.TRANSTECHSYS.COM

TROXLER ELECTRONIC LABORATORIES, INC.
 3008 E. CORNWALLIS RD.
 RESEARCH TRIANGLE PARK, NC 27709
 1-877-TROXLER
 WWW.TROXLERLABS.COM

IF ELECTING TO USE A SIMILAR DEVICE, PROVIDE PROOF THAT THE DEVICE HAS BEEN USED ON PREVIOUS PROJECTS WITH ACCEPTABLE RESULTS OR CONSTRUCT A TEST SECTION PRIOR TO THE BEGINNING OF WORK AND DEMONSTRATE WEDGE COMPACTION TO THE SATISFACTION OF THE ENGINEER. SHORT SECTIONS OF HANDWORK WILL BE ALLOWED WHEN NECESSARY FOR TRANSITIONS AND TURNOUTS OR OTHERWISE AUTHORIZED BY THE ENGINEER.

IN ADDITION TO THE REQUIREMENTS OF 401.16, MAKE THE FIRST ROLLER PASS 8 TO 12 INCHES (200 TO 300 MM) AWAY FROM TAPERED EDGE. DO NOT ROLL THE TAPER.

ADDITIONAL QUANTITIES OF:

SR 64 (4.12-4.26)	
ITEM 448, ASPHALT CONCRETE SURFACE COURSE - 1/2"	3 CU YD
ITEM 448, ASPHALT CONCRETE INTERMEDIATE COURSE - 1 1/4"	1 CU YD
SR 64 (4.26-5.78)	
ITEM 448, ASPHALT CONCRETE SURFACE COURSE - 1/2"	13 CU YD
ITEM 448, ASPHALT CONCRETE INTERMEDIATE COURSE - 1 1/4"	5 CU YD
SR 64 (5.78-9.03)	
ITEM 448, ASPHALT CONCRETE SURFACE COURSE - 2 1/2"	23 CU YD

HAVE BEEN CARRIED TO THE GENERAL SUMMARY FOR THE SAFETY EDGE.
 SEE DETAILS SHEET 4/14.

CALCULATED
SKL
CHECKED
JMF

GENERAL NOTES

WOO - 64 - 4 - 12

3
14

I:\projects\W00-64-4.12\roadway\sheet\Edge_detail_update_new.dgn 17-DEC-2012 8:43AM jbding

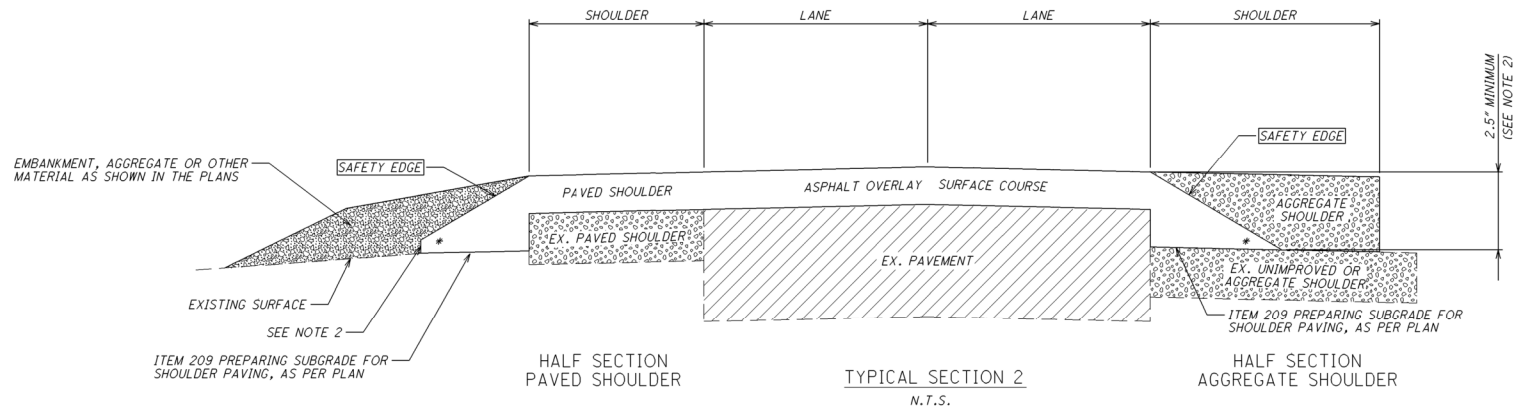
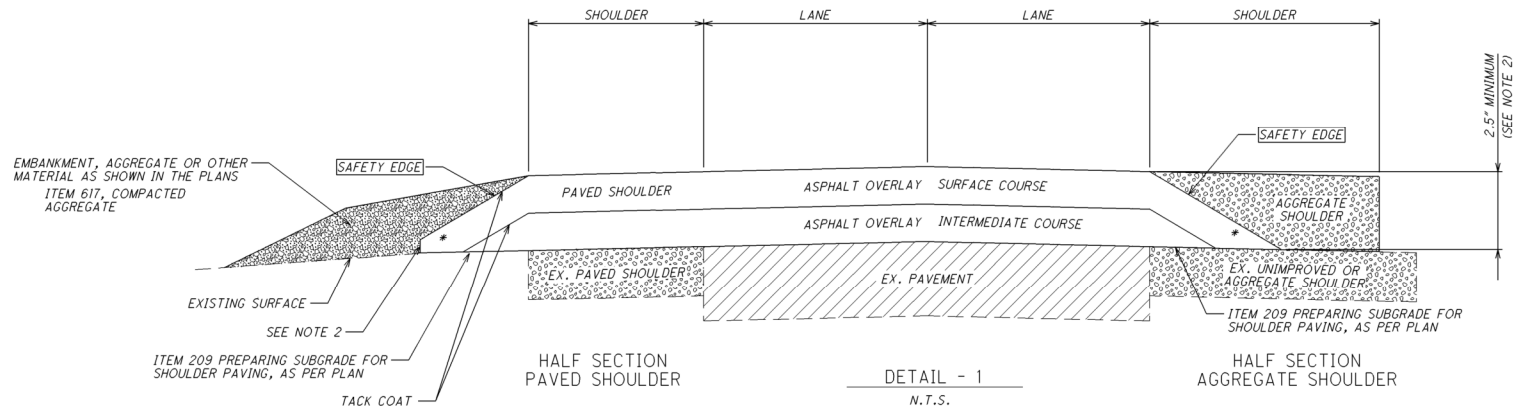

NOTES:

- 1.) SAFETY EDGES ARE REQUIRED AT THE OUTSIDE EDGES OF THE PAVED ROADWAY (EDGE OF TRAVEL LANE OR EDGE OF PAVED SHOULDER).
- 2.) CONSTRUCT THE SAFETY EDGE THE FULL ASPHALT CONCRETE OVERLAY THICKNESS OR 2.5" (63MM) WHICHEVER IS GREATER, NOT TO EXCEED THE MAXIMUM SAFETY EDGE THICKNESS OF 6" (150MM). CONSTRUCT A NEAR-VERTICAL FACE BELOW THE SAFETY EDGE FOR THICKNESS GREATER THAN 6" (150 MM).
- 3.) BLADE AND SHAPE EXISTING SHOULDER MATERIAL TO FORM A UNIFORM SURFACE UNDER THE SAFETY EDGE PRIOR TO PLACEMENT OF THE ASPHALT CONCRETE OVERLAY.
- 4.) FOR NEW PAVEMENT CONSTRUCT THE SAFETY EDGE THE FULL THICKNESS OF THE SURFACE AND INTERMEDIATE COURSES, NOT TO EXCEED 3.25" (82 MM).

* 40° MAX

I:\projects\W00\88495\roadway\sheets\88495-MN001.dgn 17-DEC-2012 8:43AM jbdjng

ITEM 614, MAINTAINING TRAFFIC

NO WORK SHALL BE PERFORMED AND ALL EXISTING LANES SHALL BE OPEN TO TRAFFIC DURING THE FOLLOWING DESIGNATED HOLIDAYS OR EVENTS:

CHRISTMAS	FOURTH OF JULY
NEW YEARS	LABOR DAY
EASTER	THANKSGIVING
MEMORIAL DAY	

THE PERIOD OF TIME THAT THE LANES ARE TO BE OPEN DEPENDS ON THE DAY OF THE WEEK ON WHICH THE HOLIDAY OR EVENT FALLS. THE FOLLOWING SCHEDULE SHALL BE USED TO DETERMINE THIS PERIOD:

DAY OF THE WEEK	TIME ALL LANES MUST BE OPEN TO TRAFFIC
SUNDAY	12:00N FRIDAY THROUGH 12:00N MONDAY
MONDAY	12:00N FRIDAY THROUGH 12:00N TUESDAY
TUESDAY	12:00N MONDAY THROUGH 12:00N WEDNESDAY
WEDNESDAY	12:00N TUESDAY THROUGH 12:00N THURSDAY
THURSDAY	12:00N WEDNESDAY THROUGH 12:00N MONDAY
FRIDAY	12:00N THURSDAY THROUGH 12:00N MONDAY
SATURDAY	12:00N FRIDAY THROUGH 12:00N MONDAY

NO EXTENSIONS OF TIME SHALL BE GRANTED FOR DELAYS IN MATERIAL DELIVERIES, UNLESS SUCH DELAYS ARE INDUSTRY-WIDE, OR FOR LABOR STRIKES, UNLESS SUCH STRIKES ARE AREA-WIDE.

SHOULD THE CONTRACTOR FAIL TO MEET ANY OF THESE REQUIREMENTS, THE CONTRACTOR SHALL BE ASSESSED LIQUIDATED DAMAGES IN ACCORDANCE WITH CMS 108.07.

LENGTH AND DURATION OF LANE CLOSURES AND RESTRICTIONS SHALL BE AT THE APPROVAL OF THE ENGINEER. IT IS THE INTENT TO MINIMIZE THE IMPACT TO THE TRAVELING PUBLIC. LANE CLOSURES OR RESTRICTIONS OVER SEGMENTS OF THE PROJECT IN WHICH NO WORK IS ANTICIPATED WITHIN A REASONABLE TIME FRAME, AS DETERMINED BY THE ENGINEER, SHALL NOT BE PERMITTED. THE LEVEL OF UTILIZATION OF MAINTENANCE OF TRAFFIC DEVICES SHALL BE COMMENSURATE WITH THE WORK IN PROGRESS.

ALL WORK AND TRAFFIC CONTROL DEVICES SHALL BE IN ACCORDANCE WITH CMS 614 AND OTHER APPLICABLE PORTIONS OF THE SPECIFICATIONS, AS WELL AS THE OHIO MANUAL OF UNIFORM TRAFFIC CONTROL DEVICES. PAYMENT FOR ALL LABOR, EQUIPMENT AND MATERIALS SHALL BE INCLUDED IN THE SUMP SUM CONTRACT PRICE FOR ITEM 614, MAINTAINING TRAFFIC UNLESS SEPARATELY ITEMIZED IN THE PLAN.

PLACEMENT OF ASPHALT CONCRETE

TWO-WAY TRAFFIC SHALL BE MAINTAINED AT ALL TIMES EXCEPT THAT ONE-WAY TRAFFIC WILL BE PERMITTED FOR MINIMUM PERIODS OF TIME CONSISTENT WITH THE REQUIREMENTS OF THE SPECIFICATIONS FOR PROTECTION OF COMPLETED ASPHALT CONCRETE COURSES.

WORK ZONE MARKINGS AND SIGNS

THE FOLLOWING ESTIMATED QUANTITIES HAVE BEEN CARRIED TO THE GENERAL SUMMARY FOR USE AT LOCATIONS IDENTIFIED BY THE ENGINEER FOR WORK ZONE PAVEMENT MARKINGS AND SIGNS PER THE REQUIREMENTS OF CMS 614.04 AND 614.11.

ITEM 614 - WORK ZONE MARKING SIGN	11 EACH
ITEM 614 - WORK ZONE CENTER LINE, CLASS II	12 MILE

ITEM 614, REPLACEMENT SIGN

FLATSHEET SIGNS FURNISHED BY THE CONTRACTOR IN ACCORDANCE WITH THE REQUIREMENTS OF THE PLANS, SPECIFICATIONS AND PROPOSAL WHICH BECOME DAMAGED BY TRAFFIC FOR REASONS BEYOND THE CONTROL OF THE CONTRACTOR SHALL BE REPLACED IN KIND WHEN ORDERED BY THE ENGINEER. REPLACEMENT SIGNS SHALL BE NEW. OTHER MATERIALS MAY BE IN USED, BUT GOOD, CONDITION SUBJECT TO APPROVAL BY THE ENGINEER.

PAYMENT FOR THE NEW SIGNS SHALL BE MADE AT THE CONTRACT PRICE PER EACH FOR ITEM 614, REPLACEMENT SIGN, AND SHALL INCLUDE THE COST OF REMOVING AND DISPOSING OF DAMAGED SIGNS, HARDWARE AND SUPPORTS, AND PROVIDING THE NECESSARY REPLACEMENT HARDWARE, SUPPORTS, ETC.

AN ESTIMATED QUANTITY OF 5 EACH HAS BEEN PROVIDED IN THE GENERAL SUMMARY.

ITEM 614, REPLACEMENT DRUM

DRUMS FURNISHED BY THE CONTRACTOR IN ACCORDANCE WITH THE REQUIREMENTS OF THE PLANS, SPECIFICATIONS AND PROPOSAL WHICH BECOME DAMAGED BY TRAFFIC FOR REASONS BEYOND THE CONTROL OF THE CONTRACTOR SHALL BE REPLACED IN KIND WHEN ORDERED BY THE ENGINEER. REPLACEMENT DRUMS SHALL BE NEW.

PAYMENT FOR THE NEW DRUMS SHALL BE MADE AT THE CONTRACT PRICE PER EACH FOR ITEM 614, REPLACEMENT DRUM, AND SHALL INCLUDE THE COST OF REMOVING AND DISPOSING OF THE DAMAGED DRUM, AND PROVIDING AND MAINTAINING THE REPLACEMENT DRUM IN ACCORDANCE WITH THE CONTRACT REQUIREMENTS FOR THE ORIGINAL DRUM.

AN ESTIMATED QUANTITY OF 5 EACH HAS BEEN PROVIDED IN THE GENERAL SUMMARY.

PLANED SURFACES

NO PLANED SURFACES SHALL BE OPEN TO THE PUBLIC FOR MORE THAN 5 DAYS.

CALCULATED
SKL
CHECKED
JMF

MAINTENANCE OF TRAFFIC GENERAL NOTES

W00-64-4.12

5
14

I:\projects\W00-64-4.12\roadway\sheet\88495-66001.dgn 28-JAN-2013 9:15 AM jfchy

SHEET NUMBER							PARTICIPATION		ITEM	ITEM EXT.	GRAND TOTAL	UNIT	DESCRIPTION	SEE SHEET NO.
3	5	7	01/SK2/PV/BG	02/STR/PV										
ROADWAY														
5.3			0.28	5.02	209	72051	5.30	MILE	PREPARING SUBGRADE FOR SHOULDER PAVING, AS PER PLAN	3				
2			-	2	604	39500	2	EACH	MONUMENT BOX ADJUSTED TO GRADE					
EROSION CONTROL														
			-	1500	832	30000	1500	EACH	EROSION CONTROL					
PAVEMENT														
2945			84	2861	253	02000	2945	CU YD	PAVEMENT REPAIR					
		44036	-	44036	254	01000	44036	SQ YD	PAVEMENT PLANING, ASPHALT CONCRETE - 1 3/4"					
		24599	1853	22746	254	01000	24599	SQ YD	PAVEMENT PLANING, ASPHALT CONCRETE - 3 1/4"					
		5148	139	5009	407	10000	5148	GALLON	TACK COAT					
		984	74	910	407	14000	984	GALLON	TACK COAT FOR INTERMEDIATE COURSE					
6488			184	6304	409	98010	6488	POUND	SFAL INC. MISC.: LONGITUDINAL JOINT SEALER	3				
6		1196	91	1111	448	46050	1202	CU YD	ASPHALT CONCRETE INTERMEDIATE COURSE, TYPE 2, PG64-22					
39		3166	80	3125	448	47020	3205	CU YD	ASPHALT CONCRETE SURFACE COURSE, TYPE 1, PG64-22					
		933	29	904	617	10100	933	CU YD	COMPACTED AGGREGATE					
TRAFFIC CONTROL														
333			10	323	621	00100	333	EACH	RPM					
275			8	267	621	54000	275	EACH	RAISED PAVEMENT MARKER REMOVED					
9.82			0.28	9.54	642	00090	9.82	MILE	EDGE LINE, 4"					
4.91			0.14	4.77	642	00290	4.91	MILE	CENTER LINE					
259			-	259	644	00400	259	FT	CHANNELIZING LINE, 8"					
23			-	23	644	00500	23	FT	STOP LINE					
3			-	3	644	01300	3	EACH	LANE ARROW					
STRUCTURES														
FOR W00-64-0746 STRUCTURE QUANTITIES SEE SHEET 13														
MAINTENANCE OF TRAFFIC														
		11	1	10	614	12460	11	EACH	WORK ZONE MARKING SIGN					
		5	1	4	614	12500	5	EACH	REPLACEMENT SIGN					
		5	1	4	614	12600	5	EACH	REPLACEMENT DRUM					
		12	1	11	614	21400	12	MILE	WORK ZONE CENTER LINE, CLASS II					
					614	10000		LUMP	MAINTAINING TRAFFIC					
					623	10000		LUMP	CONSTRUCTION LAYOUT STAKES					
					624	10000		LUMP	MOBILIZATION					

I:\projects\W00-64-4.12\roadway\sheets\884-95-GS001.dgn 17-DEC-2012 8:43 AM jbd\jng

SHEET NO.	STATION TO STATION			COUNTY	SIDE	LENGTH = L	AVERAGE WIDTH = W	SURFACE AREA = A A=(LxW)	254		407		448			617	
									PAVEMENT PLANING, ASPHALT CONCRETE - 1 3/4"	PAVEMENT PLANING, ASPHALT CONCRETE - 3 1/4"	TACK COAT (0.015 gal/sq yd)	TACK COAT FOR INTERMEDIATE COURSE (0.04 gal/sq yd)	1 1/2" ASPHALT CONCRETE SURFACE COURSE, TYPE 1, PG 64-22	1 3/4" ASPHALT CONCRETE SURFACE COURSE, TYPE 1, PG 64-22	1 3/4" ASPHALT CONCRETE INTERMEDIATE COURSE, TYPE 2, PG64-22	COMPACTED AGGREGATE	
									SO YD	SO YD	GAL	GAL	CU YD	CU YD	CU YD		CU YD
									A/9=	A/9=	(A/9)0.075=	(A/9)0.04=	(A*1.5)/27=	(A*1.75)/27=	(A*1.75)/27=		Varies x2'xL/27x2
SLM 4.12 to 4.26 8	217+68.00	224+93.00	WOO	LT/RT	725	23	16675			1852.78	138.96	74.11	77.20	90.07			29.09
SLM 4.26 to 9.15 SLM 4.26 to 5.78 8, 9	224+93.00	309+50.00	WOO	LT/RT	8457	23	194511			21612.33	1620.93	864.49	900.51	1050.60			339.32
SLM 5.78 to 9.15 9, 10 10, 11	309+50.00 343+67.00	332+86.00 477+19.00	WOO WOO	LT/RT LT/RT	2336 13352	23	53728 307096	5969.78 34121.78			447.73 2559.13		290.20 1658.70				72.10 412.10
EXTRA AREAS																	
SHEET NO.	INTERSECTION	STATION	COUNTY	SIDE	LENGTH = L	MOUTH	THROAT	APPROX. AREA = A BY CADD									
SLM 4.12 to 4.26																	Varies
SLM 4.26 to 9.15 SLM 4.26 to 5.78 8	NewTon Rd/Turn Lane	242+42 to 247+04	WOO	RT	550		7414	7414		823.78	61.78	32.95	34.32	40.04			11.03
9	Bishop Rd	278+63.00	WOO	RT	10	56.9	21.8	602		66.89	5.02	2.68	2.79	3.25			0.40
SLM 4.26 to 9.15 9	Bishop Rd	278+63.00	WOO	LT	22	92.6	43.6	741		82.33	6.18	3.29	3.43	4.00			0.88
SLM 5.78 to 9.15 9	Kellogg Rd	308+85.00	WOO	LT	14	125.7	47.50	1447		160.78	12.06	6.43	6.70	7.82			0.56
10	Hannah Rd/SR 64	332+86 to 343+67	WOO	LT/RT	2162		35286	35286	3920.67		294.05			190.59			66.73
10	Crosscreek Rd	392+30.00	WOO	LT	10		208	208	23.11		1.73			1.12			0.31
SLM 4.12 to 4.26 TOTALS									0.00	1852.78	138.96	74.11	77.20	0.00	90.07		29.09
SLM 4.26 to 9.15 TOTALS									44035.33	22746.11	5008.61	909.84	947.75	2140.61	1105.71		903.44
TOTALS									44035.33	24598.89	5147.57	983.96	1024.95	2140.61	1195.78		932.53
TOTALS CARRIED TO GENERAL SUMMARY									44036	24599	5148	984	3166	1196		933	

7 14	CALCULATED	PAVEMENT SUBSUMMARY
	SKL CHECKED	
	JMF	

