

O.D.O.T. DISTRICT 2 SURVEY OFFICE (USE ONLY)

PERSONNEL _____ REFERENCE NO. 13 H SHEET 7 OF 9
 NOTES HOMAN DATE 7/10/12 ROUTE SR 66, SR 2
 H.C. ROUSOS WEATHER SUNNY COUNTY FULTON
 R.C. HOMAN TEMP. 75° TOWNSHIP GERMAN
 SECTION 29
 T 7 N R 4 E

TYPE MONUMENT PK NAIL
 ON SURFACE - ~~BELOW~~ ON
 LEFT - ☉ PAV'T - RIGHT ON
11.6' TO RT EDGE PAVEMENT
 S.L.M. 256+97

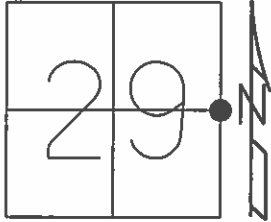

Grid: Northing: 686195.232 Easting: 1473950.855

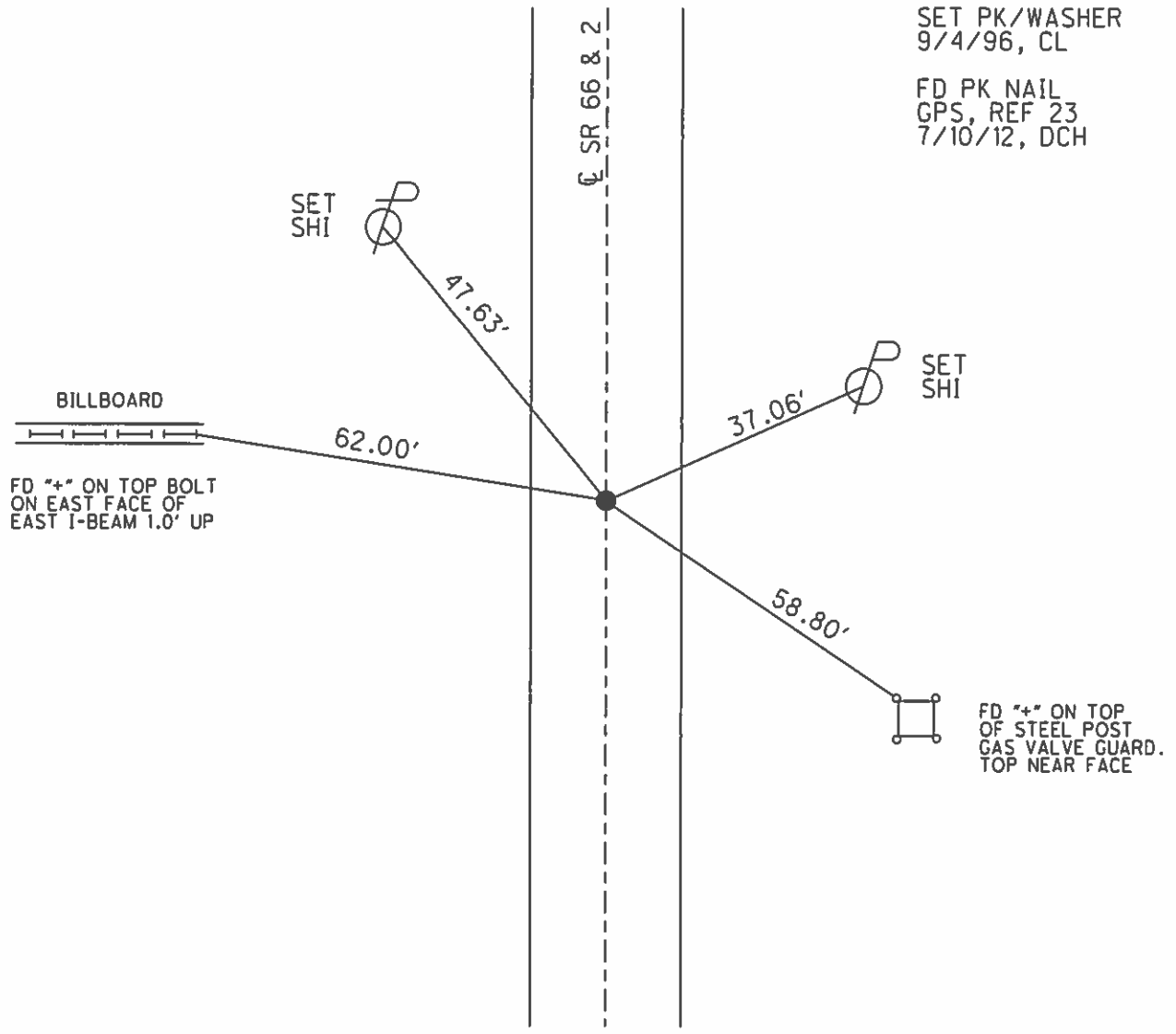

O.D.O.T. DISTRICT 2 SURVEY OFFICE (USE ONLY)

PERSONNEL	REFERENCE NO.	<u>9</u>	SHEET	<u>7</u>	OF	<u>8</u>
NOTES	<u>HOMAN</u>	DATE	<u>7/10/12</u>	ROUTE	<u>SR 66, SR 2</u>	
H.C.	<u>ROUSOS</u>	WEATHER	<u>SUNNY</u>	COUNTY	<u>FULTON</u>	
R.C.	<u>HOMAN</u>	TEMP.	<u>75°</u>	TOWNSHIP	<u>GERMAN</u>	
				SECTION	<u>29</u>	
				T	<u>7</u>	R
					<u>4</u>	<u>E</u>

TYPE MONUMENT PK NAIL
 ON SURFACE - ~~BELOW~~ ON
 LEFT - ☉ PAV'T - RIGHT ON
11.6' TO RT EDGE PAVEMENT
 S.L.M. 256+97

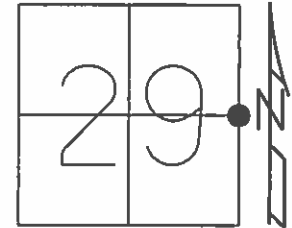

Grid: Northing: 686195.232 Easting: 1473950.855

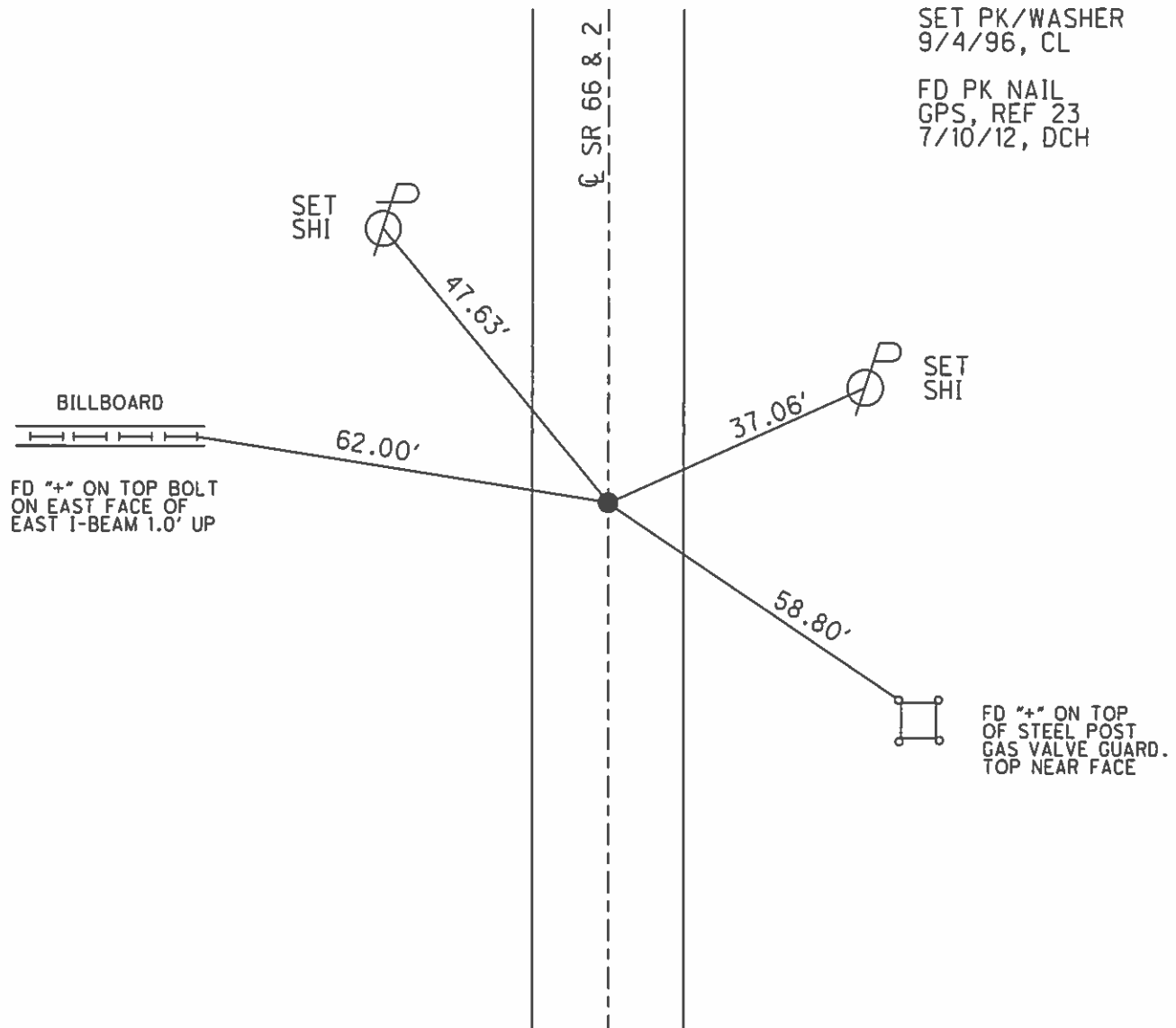

O.D.O.T. DISTRICT 2 SURVEY OFFICE

PERSONNEL

REFERENCE NO. 13 H

SHEET 22 OF 23

NOTES LOEHRKE

H.C. ROUSOS

R.C. CANTERBURY

DATE 8-9-95

WEATHER CLOUDY

TEMP. +75°F

Set P.K./WASHER
5-4-96

ROUTE S.R. # 25266

COUNTY FULTON

TOWNSHIP GERMAN

SECTION 29

T 7 N R 4 E

TYPE MONUMENT SM. RR SPIKE

ON SURFACE - ~~BELOW~~ ON SURFACE

~~LEFT - & PAVT. - RIGHT~~ ON &

11.6 TO RT EDGE PAVEMENT

S.L.M. 256 + 97

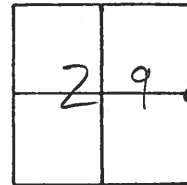

SET SHI. NE/S.

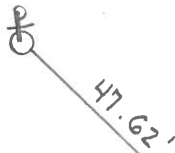

BILLBOARD



62.01'

FOUND "+" ON HEAD OF
BOLT ON EAST FACE
OF EAST I-BEAM 1.0' UP.

S.R. # 25266

CL PAVT.



SET SHI. SW/S

58.95'



FD. "+" ON TOP OF STEEL
POST OF GAS VALVE GUARD.

PERSONNEL TITLE PERSONNEL TITLE

Beach
Armbruster
Knape

COUNTY Fulton

DATE 11 July 58

S. R. 66

WEATHER

SEC. 2.96

TEMP.

DESCRIPTION All Measurements are Horizontal

JOB NO. 02276

LEFT

CENTER LINE

RIGHT

Sta. 156 + 28.8

S.W. Cor. Sec. 28, German Twp.
N. Corp. Archbold (E. side S.R. 66)
Jct. Co. Rd. "D" (LUTZ RD.)

Exposed
11/7/62

Found Lead Pipe in Conc. part
4" below Bituminous surface.
Drove 4" x 3/8" Steel punch into Lead pipe
to extend to 1 1/2" below Bit. Surface.

OK 10-26-61 W. Knape

#87

13G

RES.
Brick
Found.

73.67'

36.95'

39.36'

51.42'

43.25'

old spk. N.E. side 18" Maple
Embedded

old shiner embedded
in NNE side 13" Maple

old shiner NW. side 26" Maple

NOTE: This point is 3'± South of the ctr. of the Lutz Rd. pavement.

Sta 176 + 13.1 N. Corp Archbold West side S. R. "66

OK 10-26-61 W. Knape

13H

Sta. 182 + 73.4 ±

W. 1/4 post, Sec. 28
German Twp.

shiner

48.53'

FOUND 1" Iron Pin in 12" conc.
on Bit. Surface.

43.96'

shiner SE Side
E. Sign Post

85.17'

S.W.

119.94'

Duplex ESE side

PERSONNEL TITLE PERSONNEL TITLE

COUNTY Fulton DATE OK 1-22-58

S. R. #66 WEATHER _____

SEC. _____ TEMP. _____

DESCRIPTION From Archbold - North JOB NO. _____

LEFT CENTER LINE RIGHT

N. Corp. line of Archbold Shiner in black top - Lead pipe Sec. Cor. 28-29-32-33 German Twp. Sec. (2.97) - #66 Sec. (4.36) - #2	(13G) #87	✓ S.E. spk in N.E. side 15' maple 51.57' S.S.E. to shiner N.W. side 20' maple 43.2 S.W. to shiner N.E. side 12" maple 39.49
1/4 Cor. 28-29 German Twp. 3/4" iron rod in 12" sq. conc. box Sec. (3.47) - 66 Sec. (4.86) 2	(13H) #88	✓ E.S.E. to N.W. cor. conc. walk 85.22 W. to S. side of E. post of sign 44.0 N.W. to shiner in T.P. 48.57
Sec. Cors. 20-21 28-29 German twp. Sec. (3.97) - 66 Sec. (5.36) - 2 3/4" iron rod in 12" sq. conc. box	(14) #89	✓ N.E. to t-in conc. fdn. of church 77.33 S.W. to t-on E. end curb 62.20' S.S.W. to t-on S. end curb 61.0'
1/4 cor. sec. 20-21 German Twp. Sec. (4.47) Et #6 3/4" iron rod in sq. conc. box	#90	✓ N.N.W. to spike S.W. side of P.P. 95.82' W. to t-on N. end 12" C.M.P. (plumb) 34.05 W. to t-on S. end 12" C.M.P. (plumb) 31.35
Sec. Cors. 16-17-20-21 German Twp. 1" iron rod in 12" sq conc box Sec. (4.97) Et #66	#91	✓ N.E. to Anchor pole 53.95' S.W. to H. Pole 93.65' W. to spike S.W. side 18' catalpa 78.62' N.W. to S.E. cor. porch fdn. 99.70' N.N.W. to spk. S.W. side 24" walnut 74.93