

O.D.O.T. DISTRICT 2 SURVEY OFFICE (USE ONLY)

PERSONNEL

REFERENCE NO. 21 C

SHEET 11 OF 11

NOTES NIESE

DATE 3/5/21

ROUTE SR 2

H.C. RHOADES

WEATHER SUNNY

COUNTY FULTON

R.C. _____

TEMP. 35°

TOWNSHIP GERMAN

DWG BY NIESE

PID PAVETRAIN

SECTION 24

T 7 N R 5 E

TYPE MONUMENT MONBOX

ON SURFACE - ~~BELOW~~ ON

OFFSET \varnothing PAVEMENT 3' ~~±~~ : RT

9.1' TO RT EDGE PAVEMENT

STATION: 484+62

HORZ.DATUM: NAD83 2011

GEOID: NAVD88 2012A

GRID: NORTHING: _____

EASTING: _____

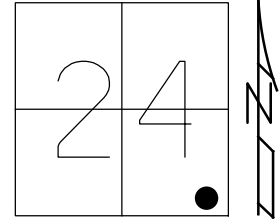

RECORD:
 FD MONBOX
 "+" TOP LID
 TIED TO IPIN
 5/13/02, DCH
 FD MONBOX
 COVERED W/ ASPHALT
 9/25/20, JFO
 3/5/21, JMR

NOTCH 1' UP
 ADOPT A HWY
 SIGN POST

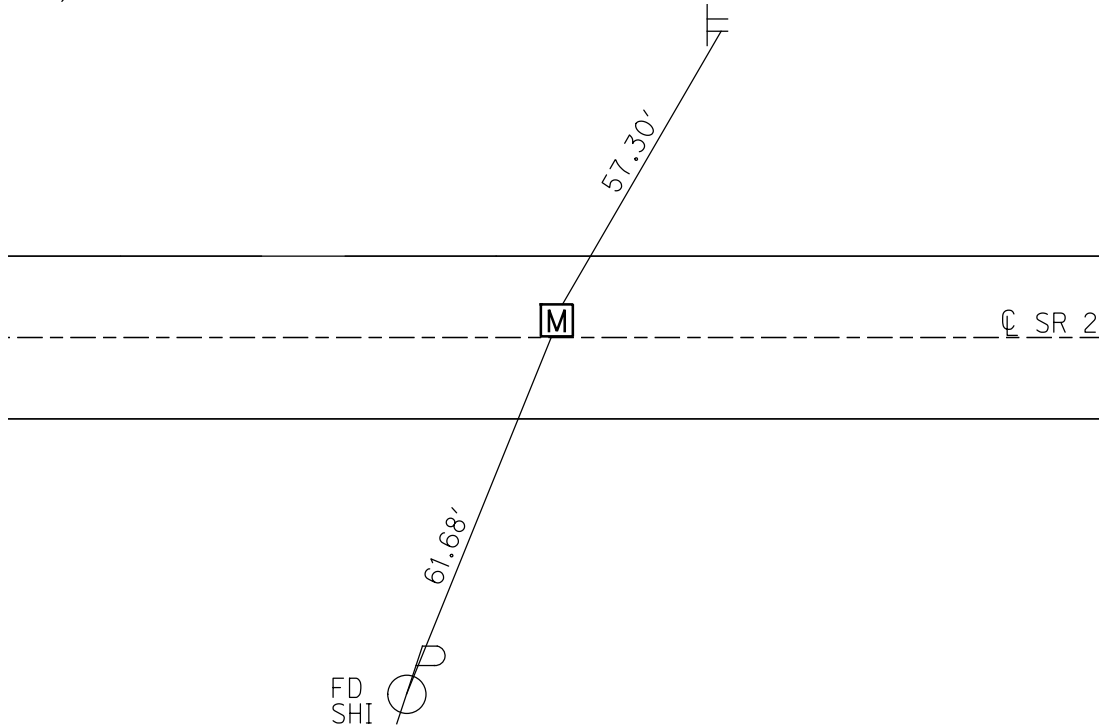

O.D.O.T. DISTRICT 2 SURVEY OFFICE (USE ONLY)

PERSONNEL _____ REFERENCE NO. 21 C SHEET 11 OF 11
 NOTES RHOADES DATE 9/25/20 ROUTE SR 2
 H.C. O'DONNELL WEATHER SUNNY COUNTY FULTON
 R.C. AUBLE TEMP. 54° TOWNSHIP GERMAN
 DWG BY RHOADES PID PAVETRAIN SECTION 24
 T 7 N R 5 E

TYPE MONUMENT MONBOX
 ON SURFACE - ~~BELOW~~ ON
 OFFSET \odot PAVEMENT 3' ~~±~~ : RT
9.1' TO RT EDGE PAVEMENT
 STATION: 484+62

HORZ.DATUM: NAD83 2011 GEOID: NAVD88 2012A
 GRID: NORTHING: _____ EASTING: _____

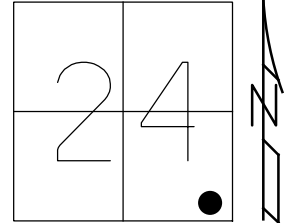

RECORD:
 FD MONBOX
 "+" TOP LID
 TIED TO IPIN
 5/13/02, DCH
 FD MONBOX
 COVERED W/ASPHALT
 9/25/20, JFO

NOTCH 1' UP
 ADOPT A HWY
 SIGN POST

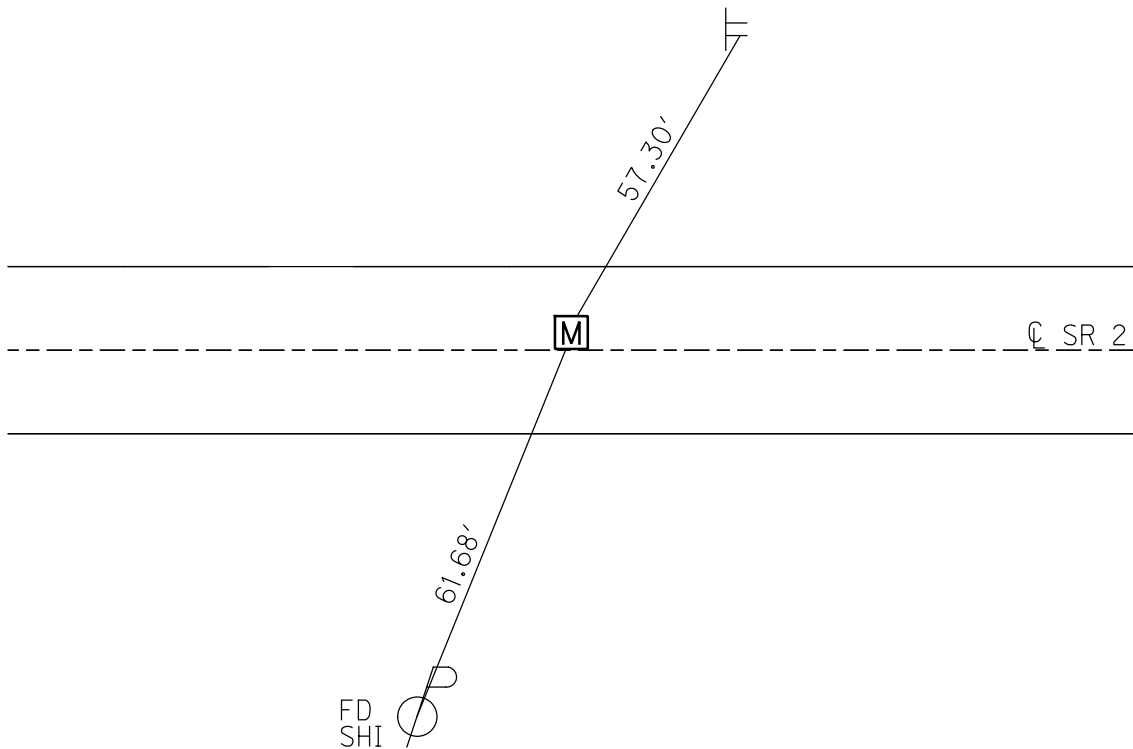

O.D.O.T. DISTRICT 2 SURVEY OFFICE (USE ONLY)

PERSONNEL _____ REFERENCE NO. 21 C SHEET 11 OF 11

NOTES ROUSOS DATE 5/13/02 ROUTE SR 2

H.C. HOMAN WEATHER WINDY COUNTY FULTON

R.C. MICHALAK TEMP. 52° TOWNSHIP GERMAN

SECTION 24

T 7 N R 5 E

TYPE MONUMENT MON.BOX

ON SURFACE - ~~BELOW~~ ON

LEFT - ☉ PAV'T - ~~RIGHT~~ 2.5'

9.2' TO RT EDGE PAVEMENT

S.L.M. 492+05

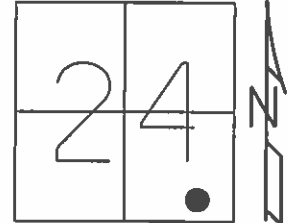

GRID: NORTHING: 681229.896 EASTING: 1453524.326

TIED IN EXIST
X ON TOP OF LID

MONUMENT BOX NOT
BROUGHT UP TO GRADE
11-27-02 D.C.H

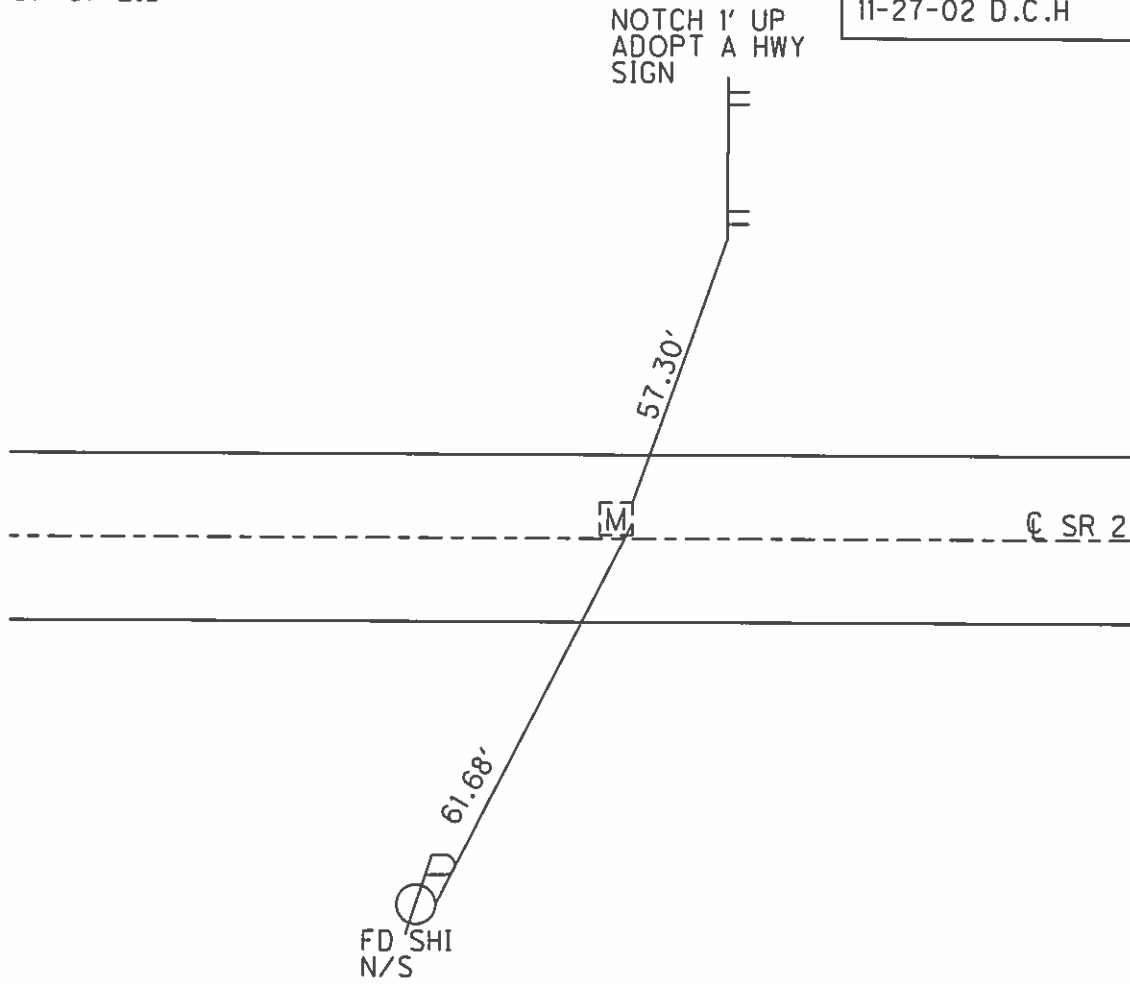

O.D.O.T. DISTRICT 2 SURVEY OFFICE

PERSONNEL

REFERENCE NO. 21-C

SHEET 12 OF 13

NOTES 1. Stone

H.C. D. Curtis

DATE 17 Aug. 87

ROUTE SR 2

R.C. J. Houschelder

WEATHER Warm

COUNTY Fulton

TEMP. 80°

TOWNSHIP GERMAN

SECTION 24

T 7 N R 5 E

TYPE MONUMENT MONUMENT BOX

ON SURFACE - ~~BELOW~~ YES

LEFT - ~~C~~ PAV'T. - RIGHT 2.5

9.2 TO LT EDGE PAVEMENT

S.L.M. 492 + 05

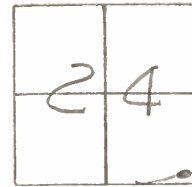

OK & TO SURFACE
4-29-88

