

PROJECT DESCRIPTION
 A DISTRICT ALLOCATION FUNDED PROJECT TO RESURFACE US-20 FROM SR-108 (SOUTH) TO LUCAS COUNTY LINE; PERFORM NECESSARY RELATED WORK. REPLACE CULVERT AT FUL-20-25.10.

PROJECT CONTROL
 STATE PLANE GRID - OHIO NORTH NAD 83 (2011)
 PROJECT ADJUSTMENT FACTOR - 1.0000000
 GEOID MODEL - 2012A

NOTE: THE EXISTING R/W WIDTH AND LOCATION WERE DETERMINED USING O.D.O.T. PLANS TITLED "TOLEDO-ANGOLA ROAD S.H. (I.C.H.) NO. 21 SEC. "N" DATED MARCH 1929, A BOUNDARY SURVEY FOR CHARLES HUNT ATTY. AND EDWARD J. SCHMITZ JR. PERFORMED BY JAMES M. LOCK IN OCTOBER 1993, AND RECORDS ON FILE WITH THE FULTON COUNTY ENGINEERS OFFICE FOR SECTIONS 22 AND 27, T-9-S, R-4-E, AMBOY TOWNSHIP.

PLANS PREPARED BY:
 FIRM NAME : O.D.O.T.
 R/W DESIGNER: MARTIN J. FARKAS
 R/W REVIEWER: DAVID E. SEASLY
 FIELD REVIEWER: MARTIN J. FARKAS
 PRELIMINARY FIELD REVIEW DATE: 3/4/2016
 TRACINGS FIELD REVIEW DATE: 3/4/2016
 OWNERSHIP UPDATED BY: MARTIN J. FARKAS
 DATE COMPLETED: 3/7/2016
 PLAN COMPLETION DATE: 3/7/2016

TYPES OF TITLE LEGEND:
 SH = STANDARD HIGHWAY EASEMENT

- MONUMENT LEGEND**
- ☐ EXISTING R/W MONUMENT BOX
 - ▣ PROPOSED R/W MONUMENT BOX
 - ⊙ EXISTING CONCRETE MONUMENT
 - PROPOSED CONCRETE MONUMENT
 - ⚡ RAILROAD SPIKE FOUND
 - ⚡ RAILROAD SPIKE SET
 - ⊙ I.P.F. IRON PIN FOUND
 - ⊙ I.P.F. IRON PIN FOUND W/ ID CAP
 - I.P.S. IRON PIN SET W/ ID CAP
 - ⊙ P.F. IRON PIPE FOUND
 - ⊙ P.S. IRON PIPE SET
 - ⊙ R.K.F. P.K. NAIL FOUND
 - ⊙ R.K.S. P.K. NAIL SET
 - ⊙ M.N.F. MAG NAIL FOUND
 - ⊙ M.N.S. MAG NAIL SET

- STRUCTURE KEY**
- RESIDENTIAL
 - COMMERCIAL
 - ▨ OUT-BUILDING

RIGHT OF WAY LEGEND SHEET

PROJECT LOC. FUL-20-13.54 CULVERT LOC. FUL-20-25.10

FULTON COUNTY
 AMBOY TOWNSHIP
 T-9-S, R-4-E
 SECTIONS 22 & 27

INDEX OF SHEETS:

LEGEND SHEET	1
PROPERTY MAP	2
SUMMARY OF ADDITIONAL R/W	3
R/W DETAIL	4

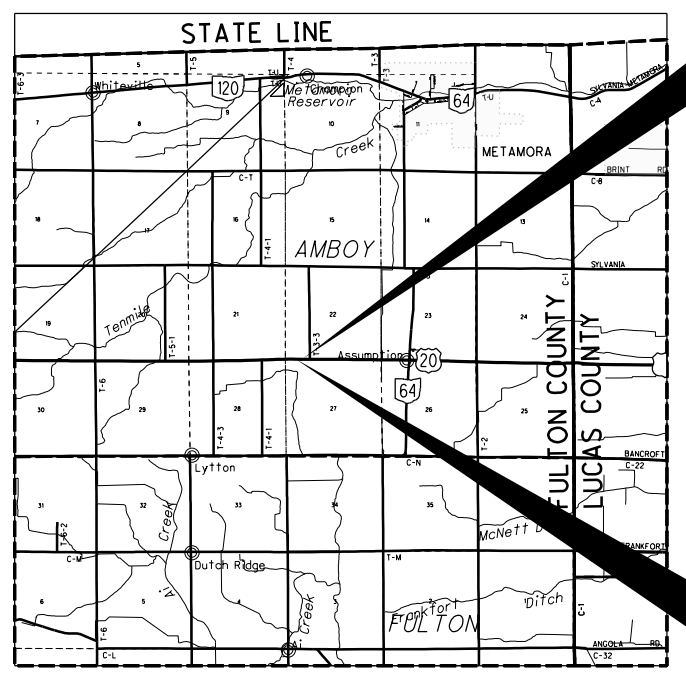

END ACQUISITION
 @ STATE ROUTE 100
 S.L.M. 25.11

BEGIN ACQUISITION
 @ U.S. 20
 S.L.M. 25.09

UTILITY OWNERS		
AT&T 130 N. ERIE ST. ROOM 714 TOLEDO, OH 43624 (419) 245-7304	CENTURYLINK 175 ASHLAND RD. MANSFIELD, OH 44902 (419) 755-7183	TOLEDO EDISON 6099 ANGOLA ROAD HOLLAND, OH 43528 (419) 249-5218
LEVEL 3 COMMUNICATIONS 1025 ELDORADO BLVD. BROOMFIELD, CO 80021 (512) 742-1428	PANHANDLE EASTERN PIPE LINE CO. 3990 CROOKED LAKE ROAD HOWELL, MI 48843 (517) 546-4770	
VILLAGE OF METAMORA, OHIO P.O. BOX 299 METAMORA, OH 43540 (419) 644-2051	FULTON COUNTY PUBLIC UTILITIES 9306 CO. RD. 14 SUITE A WAUSEON, OH 43567 (419) 337-9263	

NOTES: THE LOCATION OF THE UNDERGROUND UTILITIES SHOWN ON THE PLANS ARE OBTAINED FROM THE OWNER OF THE UTILITIES AS REQUIRED BY SECTION 153.64 O.R.C.

CONVENTIONAL SYMBOLS

- | | |
|--|--|
| County Line —————
Township Line - - - - -
Section Line - - - - -
Corporation Line ——— or ———
Fence Line (Ex) — x — x — (Pr) — x — x —
Center Line —————
Right of Way (Ex) ——— Ex R/W ———
Right of Way (Pr) ——— R/W ———
Standard Highway Ease.(Ex) ——— Ex SH ———
Temporary Right of Way ——— TMP ———
Channel Ease. (Pr) ——— CH ———
Utility Ease. (Ex) ——— Ex U ———
Railroad ——— or ———
Guardrail (Ex) — o — o — o — o — (Pr) — o — o — o — o —
Construction Limits ——— . ——— . ——— . ——— . ———
Edge of Pavement (Ex) ——— - - - - -
Edge of Pavement (Pr) ——— - - - - -
Edge of Shoulder (Ex) ——— - - - - -
Edge of Shoulder (Pr) ——— - - - - - | Ditch / Creek (Ex) ——— - - - - -
Ditch / Creek (Pr) ——— - - - - -
Tree Line (Ex) ——— - - - - -
Ownership Hook Symbol / , Example /
Property Line Symbol P , Example P
Break Line Symbol \ , Example \
Tree (Pr) ☼ , Tree (Ex) ☼ , Shrub (Ex) ☼
Tree (Remove) ✕ , Shrub (Remove) ✕
Evergreen (Ex) ☼ , Stump ☼
Evergreen (Remove) ✕ , Stump (Remove) ✕
Wetland (Pr) ~ , Grass (Pr) ~ , Aerial Target Δ
Post (Ex) ○ , Mailbox (Ex) ☐ , Mailbox (Pr) ☐
Light (Ex) ✨ , Telephone Marker (Ex) HTEL
Fire Hydrant (Ex) ⚡ , Water Meter (Ex) ⚡
Water Valve (Ex) ⚡ , Utility Valve Unknown (Ex.) ⚡
Telephone Pole (Ex) ⚡ , Power Pole (Ex) ⚡
Light Pole (Ex) ⚡ |
|--|--|

I, David E. Seasly, P. S. have conducted a survey of the existing conditions for the Ohio Department of Transportation on 6 November 2015. The results of that survey are contained herein. The horizontal coordinates expressed herein are based on the Ohio State Plane Coordinates System North Zone on NAD83 (2011) - Geoid Model 2012A datum. The Project Coordinates (US Survey Feet) are relative to State Plane Grid Coordinates (US Survey Feet) by a Project Adjustment Factor of 1.0000000. As a part of this project I have reestablished the locations of the existing property lines and the existing centerline of Right of Way for property takes contained herein. As a part of this project I have established the proposed property lines, calculated the Gross Take, present roadway occupied (PRO), Net Take and Net Residue; as well as prepared the legal descriptions necessary to acquire the parcels as shown herein. As a part of this work I have set right of way monuments at the property corners, property line intersection, points along the right of way and/or angle points on the right of way, Section Corners and other points as shown herein. All of my work contained herein was conducted in accordance with Ohio Administrative Code 4733-37 commonly known as "Minimum Standards for Boundary Surveys in the State of Ohio" unless noted. The words I and my as used herein are to mean either myself or someone working under my direct supervision.

 David E. Seasly, Professional Land Surveyor 7050

Date: 3-10-16

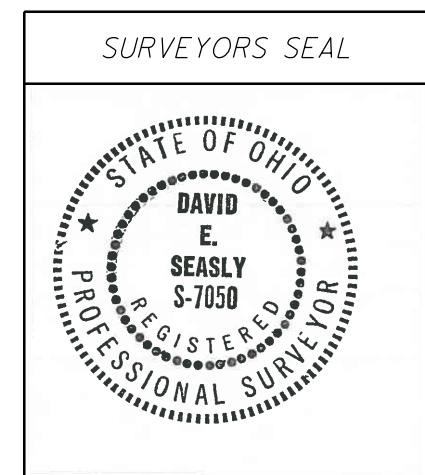

MONUMENT LEGEND

- ☐ EXISTING R/W MONUMENT BOX
- ▣ PROPOSED R/W MONUMENT BOX
- ⊙ EXISTING CONCRETE MONUMENT
- PROPOSED CONCRETE MONUMENT
- ⚡ RAILROAD SPIKE FOUND
- ⚡ RAILROAD SPIKE SET
- I.P.F. IRON PIN FOUND
- ⊙ I.P.F. IRON PIN FOUND W/ ID CAP
- I.P.S. IRON PIN SET W/ ID CAP
- ⊙ I.P.F. IRON PIPE FOUND
- ⊙ I.P.S. IRON PIPE SET
- ⊙ P.K.F. P.K. NAIL FOUND
- P.K.S. P.K. NAIL SET
- ⊙ M.N.F. MAG NAIL FOUND
- M.N.S. MAG NAIL SET

FUL-20-25.10
 FULTON COUNTY
 AMBOY TOWNSHIP
 T-9-S, R-4-E
 SECTIONS 22 & 27

10 DOROTHY R. CASH, TRUSTEE

11 JOHN MACHACEK, JR., INC.

* 10' WIDE UTILITY EASEMENT GRANTED TO THE TOLEDO EDISON COMPANY AS DESCRIBED IN D.V. 210, PG. 477. THIS AREA ALSO CONTAINS THE EASEMENT AREA GRANTED TO THE TOLEDO EDISON COMPANY IN D.V. 131, PG. 133.

PARCEL 10 IS SUBJECT TO A BLANKET EASEMENT GRANTED TO THE OHIO FUEL GAS COMPANY AS DESCRIBED IN D.V. 131, PG. 430. THIS EASEMENT CONVEYS THE RIGHT TO CONSTRUCT, OPERATE, AND MAINTAIN UP TO TWO LINES ON THE SUBJECT PARCEL.

PARCEL 10 IS SUBJECT TO A BLANKET EASEMENT GRANTED TO THE PANHANDLE EASTERN PIPE LINE COMPANY AS DESCRIBED IN E.V. 185, PG. 184. THIS EASEMENT CONVEYS THE RIGHT TO CONSTRUCT, OPERATE, AND MAINTAIN A LINE ON THE SUBJECT PARCEL.

PARCEL 11 IS SUBJECT TO A BLANKET EASEMENT GRANTED TO THE TOLEDO EDISON COMPANY IN D.V. 131, PG. 585. THIS EASEMENT CONVEYS THE RIGHT TO CONSTRUCT AND MAINTAIN LINES ON THE ABUTTING ROADS AND PUBLIC HIGHWAYS INCLUDING FUTURE WIDENINGS.

PARCEL 11 IS SUBJECT TO A 50' WIDE PIPELINE EASEMENT GRANTED TO KINDER MORGAN COCHIN LLC, A DELAWARE LIMITED LIABILITY COMPANY, AS RECORDED IN O.R. 329, PG. 2557. THIS EASEMENT CONVEYS THE RIGHT TO CONSTRUCT AND MAINTAIN LINES IN THE AREA GENERALLY DEPICTED IN EXHIBIT "A" (O.R. 329, PG. 2563). THE EXHIBIT "A" ON FILE WITH FULTON COUNTY IS ILLEGIBLE AND KINDER MORGAN COCHIN DID NOT RESPOND TO A REQUEST FOR A COPY. THE EXACT LOCATION OF THE PIPELINE EASEMENT IS UNKNOWN AT THIS TIME.

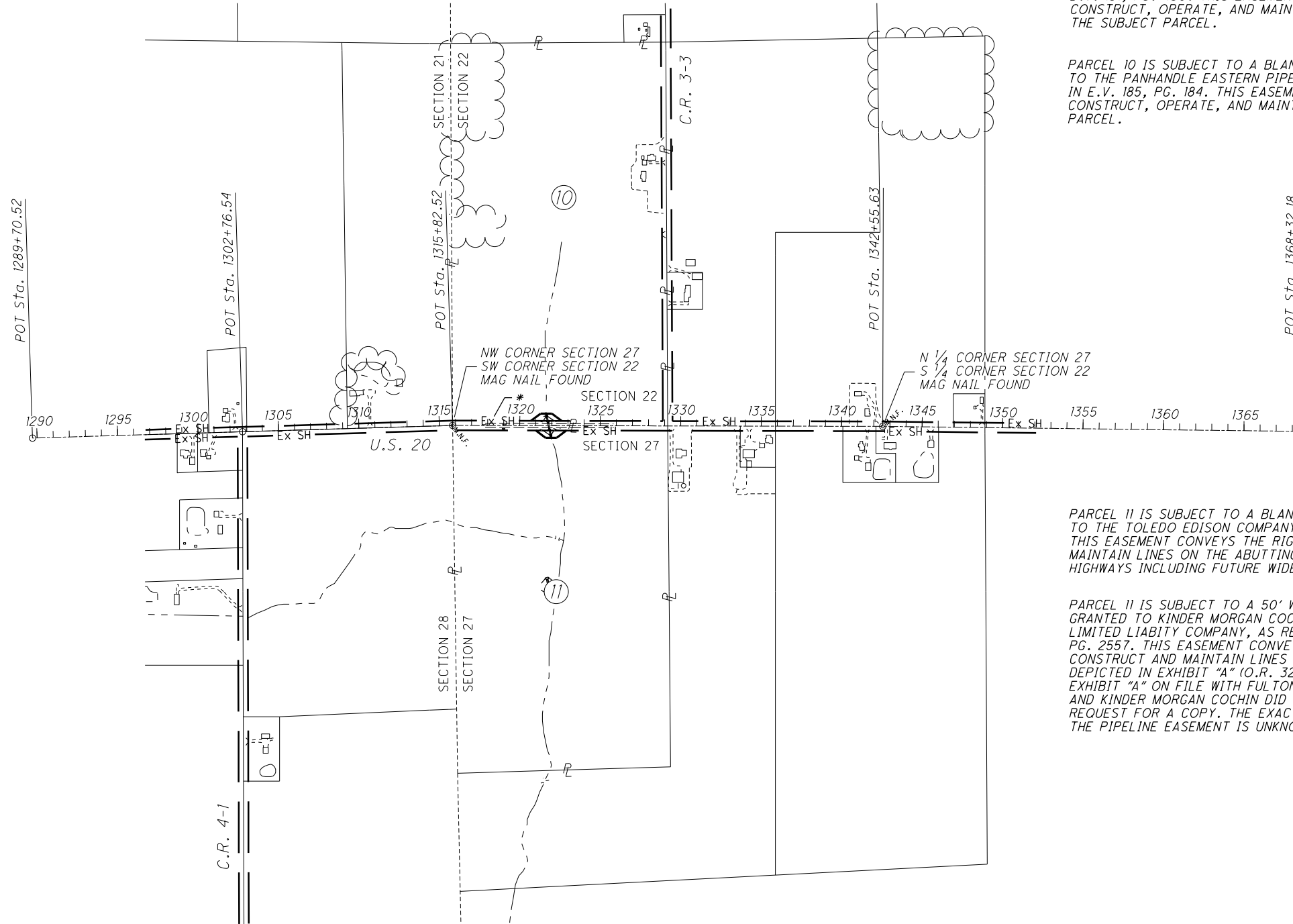

STRUCTURE KEY

- RESIDENTIAL
- COMMERCIAL
- ▨ OUT-BUILDING

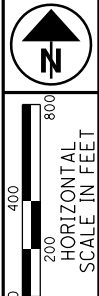

PID NO.
95725

R/W DESIGNER: MJF
 R/W REVIEWER: DES

PROPERTY MAP

FUL-20-13.76

2 / 4

REV. BY	DATE	DESCRIPTION
MJF	4/13/16	REVISED 10-SH AND 11-SH
DATE COMPLETED 7 March 2016		

56
58

I:\ProjectData\FUL\95725_FUL-20-13.76_Design\RW_Sheets\95725_RMD01.dgn_Sheet 1/13/2017 8:53:40 AM mforakas

TOTAL NUMBER OF :
 2 OWNERSHIPS 0 TOTAL TAKES
 2 PARCELS 0 OWNERSHIPS W/ STRUCTURES INVOLVED

NET TAKE = GROSS TAKE - PRO IN TAKE (c) = CALCULATED AREA
 NET RESIDUE = RECORD AREA - TOTAL PRO - NET TAKE

* DENOTES RIGHT OF WAY ENCROACHMENT
 for recorded deed information
 double click on paperclip

ALL AREAS IN ACRES

PARCEL NO.	OWNER	SHEET NO.	OWNERS RECORD	AUDITOR'S PARCEL	RECORD AREA	TOTAL P.R.O.	GROSS TAKE	P.R.O. IN TAKE	NET TAKE	STRUC-TURE	NET RESIDUE		TYPE FUND	REMARKS	AS ACQUIRED	
											LEFT	RIGHT			BOOK	PAGE
10-SH	DOROTHY R. CASH, TRUSTEE	2,4	D.V. 276, PG. 810	01-001496-00.000	80	2.542	0.134	0.000	0.134		77.324		STATE	SEE SHEETS 2, 4 FOR EASEMENT INFORMATION TOLEDO EDISON COMPANY EASEMENT OVERLAP = 0.025 AC	OR 0336	1462
11-SH	JOHN MACHACEK, JR, INC.	2,4	D.V. 271, PG. 715	01-001964-00.000	65.35	0.921	0.134	0.000	0.134			64.295	STATE	SEE SHEETS 2, 4 FOR EASEMENT INFORMATION	OR 0335	2137

I:\ProjectData\FUL\95725_FUL-20-13.54\Design\RW\Sheets\95725_RS001.dgn_Sheet 1/13/2017 8:54:39 AM mfarakas

FEDERAL PROJECT NO. **E140757**
 PID NO. **95725**
 STATE JOB NO. **427630**
 R/W DESIGNER MJF
 R/W REVIEWER DES
SUMMARY OF ADDITIONAL RIGHT OF WAY
FUL-20-13.76
 3 / 4

NOTE: ALL TEMPORARY PARCELS TO BE OF 12 MONTH DURATION.

NOTE: UNDER NO CIRCUMSTANCES ARE TEMPORARY EASEMENTS TO BE USED FOR STORAGE OF MATERIAL OR EQUIPMENT BY THE CONTRACTOR UNLESS NOTED OTHERWISE.

GRANTEE:
 ALL RIGHT OF WAY ACQUIRED IN THE NAME OF THE STATE OF OHIO
 UNLESS OTHERWISE SHOWN.

TYPES OF TITLE LEGEND:
 SH = STANDARD HIGHWAY EASEMENT

REV. BY	DATE	DESCRIPTION
MJF	4/13/16	REVISED 10-SH AND 11-SH
FIELD REVIEW BY Martin J. Farkas DATE: 3/4/2016		
OWNERSHIP VERIFIED BY Martin J. Farkas DATE: 3/7/2016		
DATE COMPLETED 7 March 2016		

57
58

BASIS FOR BEARINGS:

ALL BEARINGS SHOWN ARE FOR PROJECT USE ONLY. BEARINGS ON THIS PLAT ARE BASED UPON OHIO STATE NORTH ZONE NAD 83 (2011), GEOID MODEL 2012A. THE SOUTH LINE OF SECTION 22, TOWN 9 SOUTH, RANGE 4 EAST, AMBOY TOWNSHIP, FULTON COUNTY WAS ESTABLISHED THROUGH GPS OBSERVATIONS OF FOUND MONUMENTS AND DETERMINED TO BE BEARING SOUTH 89° 52' 53" EAST.

FUL-20-25.10
FULTON COUNTY
AMBOY TOWNSHIP
T-9-S, R-4-E
SECTIONS 22 & 27

PARCEL 10 IS SUBJECT TO A BLANKET EASEMENT GRANTED TO THE OHIO FUEL GAS COMPANY AS DESCRIBED IN D.V. 131, PG. 430. THIS EASEMENT CONVEYS THE RIGHT TO CONSTRUCT, OPERATE, AND MAINTAIN UP TO TWO LINES ON THE SUBJECT PARCEL.

PARCEL 10 IS SUBJECT TO A BLANKET EASEMENT GRANTED TO THE PANHANDLE EASTERN PIPE LINE COMPANY AS DESCRIBED IN E.V. 185, PG. 184. THIS EASEMENT CONVEYS THE RIGHT TO CONSTRUCT, OPERATE, AND MAINTAIN A LINE ON THE SUBJECT PARCEL.

MONUMENT LEGEND

- ◻ EXISTING R/W MONUMENT BOX
- ◻ PROPOSED R/W MONUMENT BOX
- ⊙ EXISTING CONCRETE MONUMENT
- PROPOSED CONCRETE MONUMENT
- ✱ RAILROAD SPIKE FOUND
- ✱ RAILROAD SPIKE SET
- I.P.F. IRON PIN FOUND
- ⊙ I.P.F. IRON PIN FOUND W/ ID CAP
- I.P.S. IRON PIN SET W/ ID CAP
- ⊙ I.P.S. IRON PIPE FOUND
- I.P.S. IRON PIPE SET
- P.K.F. P.K. NAIL FOUND
- P.K.S. P.K. NAIL SET
- M.N.F. MAG NAIL FOUND
- M.N.S. MAG NAIL SET

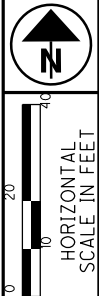

PID NO. **95725**
R/W DESIGNER MJF
R/W REVIEWER DES

RIGHT OF WAY DETAIL SHEET
STA. 1319+50.00 TO STA. 1324+50.00

FUL-20-13.76

4 / 4
58
58

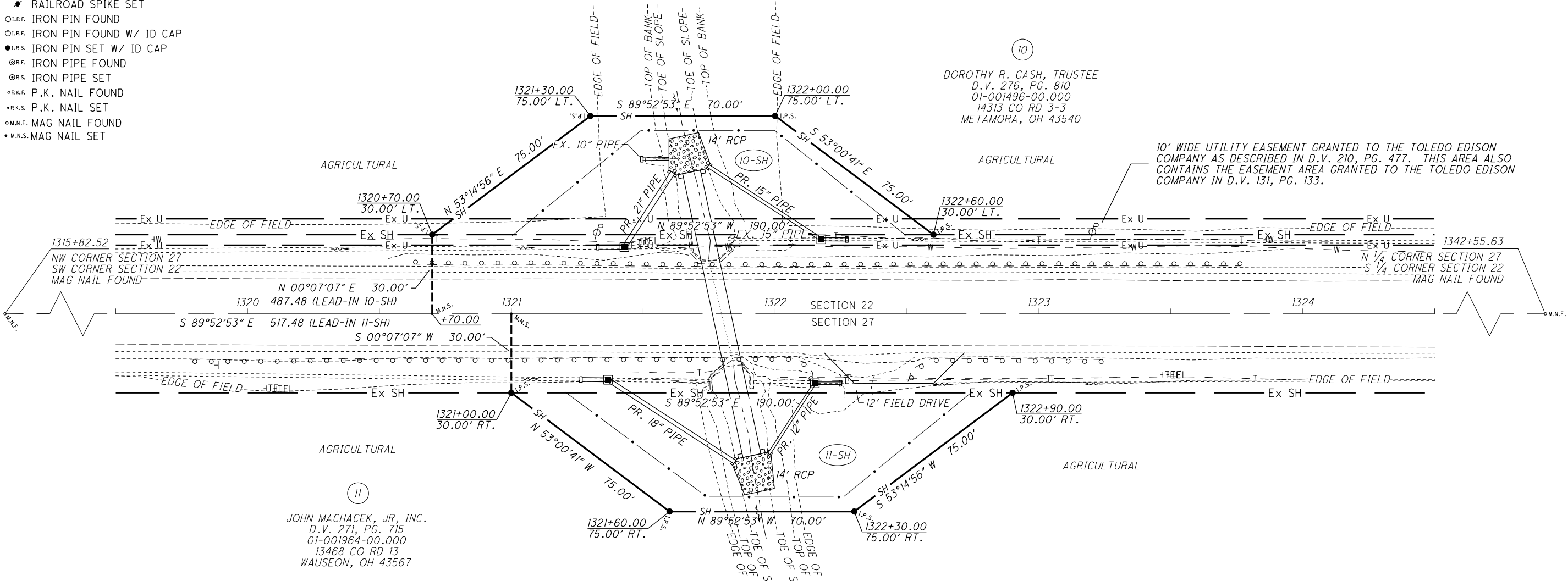

PARCEL 11 IS SUBJECT TO A BLANKET EASEMENT GRANTED TO THE TOLEDO EDISON COMPANY IN D.V. 131, PG. 585. THIS EASEMENT CONVEYS THE RIGHT TO CONSTRUCT AND MAINTAIN LINES ON THE ABUTTING ROADS AND PUBLIC HIGHWAYS INCLUDING FUTURE WIDENINGS.

PARCEL 11 IS SUBJECT TO A 50' WIDE PIPELINE EASEMENT GRANTED TO KINDER MORGAN COCHIN LLC, A DELAWARE LIMITED LIABILITY COMPANY, AS RECORDED IN O.R. 329, PG. 2557. THIS EASEMENT CONVEYS THE RIGHT TO CONSTRUCT AND MAINTAIN LINES IN THE AREA GENERALLY DEPICTED IN EXHIBIT "A" (O.R. 329, PG. 2563). THE EXHIBIT "A" ON FILE WITH FULTON COUNTY IS ILLEGIBLE AND KINDER MORGAN COCHIN DID NOT RESPOND TO A REQUEST FOR A COPY. THE EXACT LOCATION OF THE PIPELINE EASEMENT IS UNKNOWN AT THIS TIME.

STRUCTURE KEY

- ◻ RESIDENTIAL
- COMMERCIAL
- ▨ OUT-BUILDING

REV. BY	DATE	DESCRIPTION
MJF	4/26/16	ADDED PROPOSED FIELD DRIVE
MJF	4/13/16	REVISED 10-SH AND 11-SH
DATE COMPLETED 7 March 2016		

I:\ProjectData\FUL\95725_FUL-20-13.54\Design\RW\Sheets\95725-RD001.dgn Sheet 1/13/2017 8:59:07 AM mfarakas