

O.D.O.T. DISTRICT 2 SURVEY OFFICE (USE ONLY)

PERSONNEL _____ REFERENCE NO. 1 G SHEET 9 OF 22
NOTES CANTERBURY DATE 8-13-03 ROUTE SR 64
H.C. NUHFER WEATHER FAIR COUNTY FULTON
R.C. BRUMBAUGH TEMP. 78° TOWNSHIP SWAN CREEK
SECTION 12
T 7 N R 8 E

TYPE MONUMENT PK NAIL
ON SURFACE - ~~BELOW~~ ON _____
LEFT - ☉ PAV'T - RIGHT - _____
- TO - _____ EDGE PAVEMENT
S.L.M. 43+22
GRID: NOTHING: - _____ EASTING: - _____

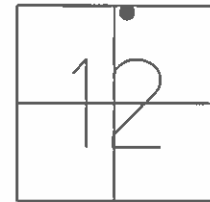

DNF
REFERENCES
DESTROYED
4-17-03, MC
7/26/16, JFO

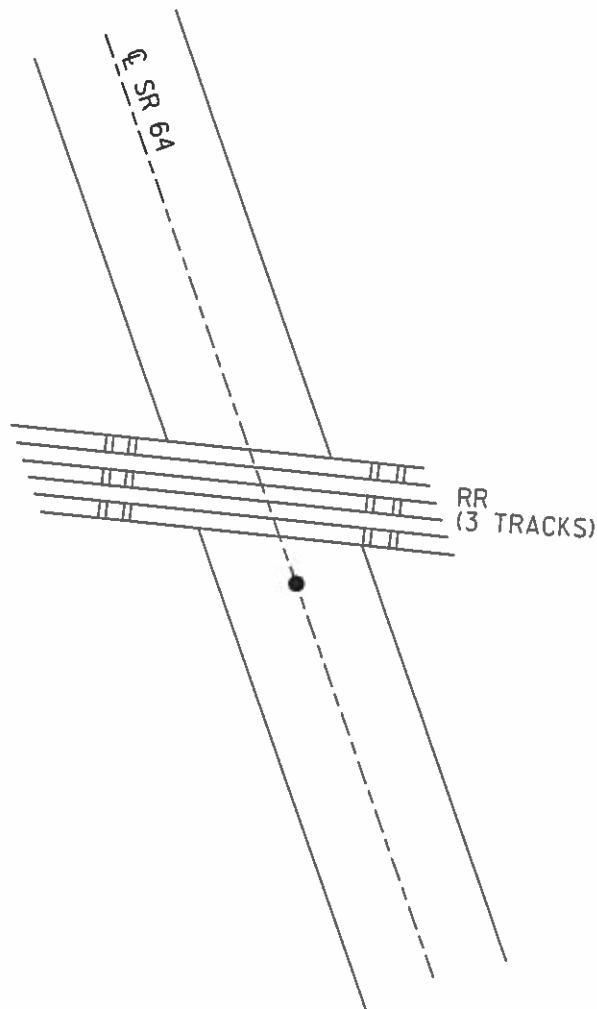

O.D.O.T. DISTRICT 2 SURVEY OFFICE

PERSONNEL

REFERENCE NO. 1-9

SHEET 7 OF 18

NOTES CANTERBURY

H.C. NUMBER

R.C. BRUMBAUGH

DATE 8-13-03

WEATHER FAIR

TEMP. +78°

ROUTE SR 64

COUNTY Fulton

TOWNSHIP SWAN CREEK

SECTION 12

T 7 N R 8 E

TYPE MONUMENT PK NAIL

ON SURFACE - BELOW SURFACE

LEFT - & PAV'T. - RIGHT

 TO EDGE PAVEMENT

S.L.M. 43+22

Swanton	
12	
CORP	



DID NOT FIND

REFERENCES + NAIL GONE, 4-17-03

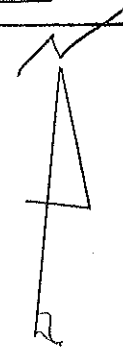
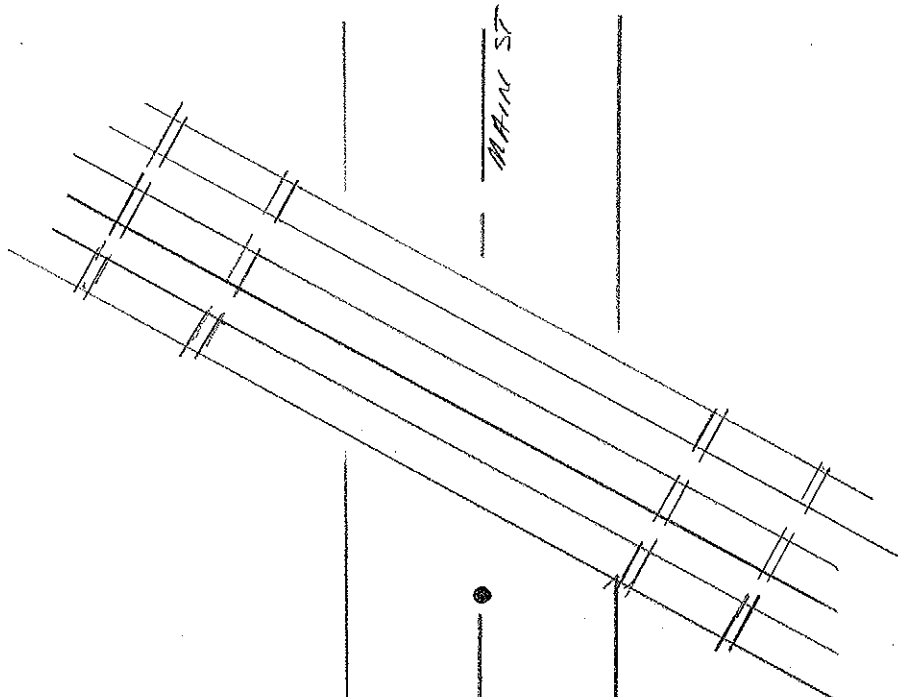

RR TRACKS
(3 TRACKS)

SR 64

O.D.O.T. DISTRICT 2 SURVEY OFFICE

PERSONNEL

REFERENCE NO. 1G

SHEET 5 OF 160

NOTES L. Stone

H.C. D. Curtis

R.C. J. Householder

DATE 1 April 88

WEATHER Cloudy

TEMP. 50°

ROUTE SR #64

COUNTY Fulton

TOWNSHIP Swan Creek

SECTION _____

T _____ R _____

TYPE MONUMENT PK Nail

ON SURFACE - BELOW Surface

LEFT - & PAV'T. - RIGHT _____

_____ TO _____ EDGE PAVEMENT

S.L.M. 43+22

SWANTON	
CORP.	

